

DETAIL FOR INFILTRATION SWALE SHOWN ON DWG No. 14-09222-GR1					
ALL DIMENSIONS AND ELEVATIONS ARE IN METRES UNLESS OTHERWISE NOTED. DRAWINGS ARE NOT DIGITALLY CORRECT. LAUGHTO TO BE COMPLETED BY OFFSETS.					
BENCHMARKS MTO BENCHMARK BM 81.8108. ELEVATION 167.059 TABLET ON CULVERT, SOUTHWEST CORNER OF DUNDAS STREET AND TRAFALGAR ROAD (1978 DATUM).					
5	SEP 2015		ISSUED FOR REVIEW		
4	AUG 2015		ISSUED FOR REVIEW		
3	NOV 2014		CONCEPTUAL ONLY - SUBMITTED IN SUPPORT OF DRAFT PLAN APPLICATION		
2	NOV 2013		CONCEPTUAL ONLY - SUBMITTED IN SUPPORT OF DRAFT PLAN APPLICATION		
1	JUN 2013		CONCEPTUAL ONLY - SUBMITTED IN SUPPORT OF DRAFT PLAN APPLICATION		
No	Date	By			
Design	S.W.		Ch'kd	A.W.	Date
Drawn	CAD 10/12		Ch'kd		DECEMBER 2012
Scale	AS NOTED				References
CONSULTANT					
 MMM GROUP 1105 GERRARD STREET E. #200, SCARBOROUGH, ONTARIO M1V 4X4 1.905.862.1100 1.905.862.0035 www.mmm.ca					
MUNICIPALITY					
 Halton REGION					
 TOWN OF OAKVILLE					
TITLE 407 WEST EMPLOYMENT AREA CROSS-SECTION DETAILS					
Municipal Drawing No			Regional Drawing No		
MMM File No 14-09222			Drawing No D1		

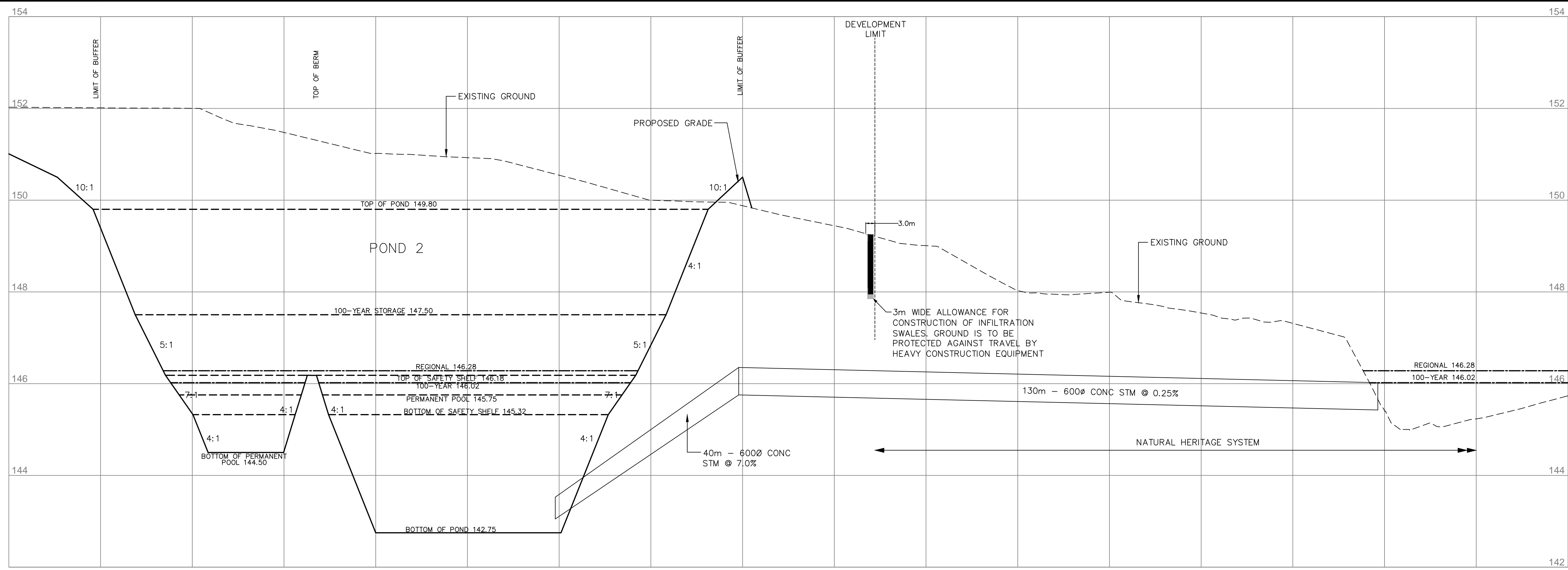

SECTION F-F
H: 1:500 V: 1:100

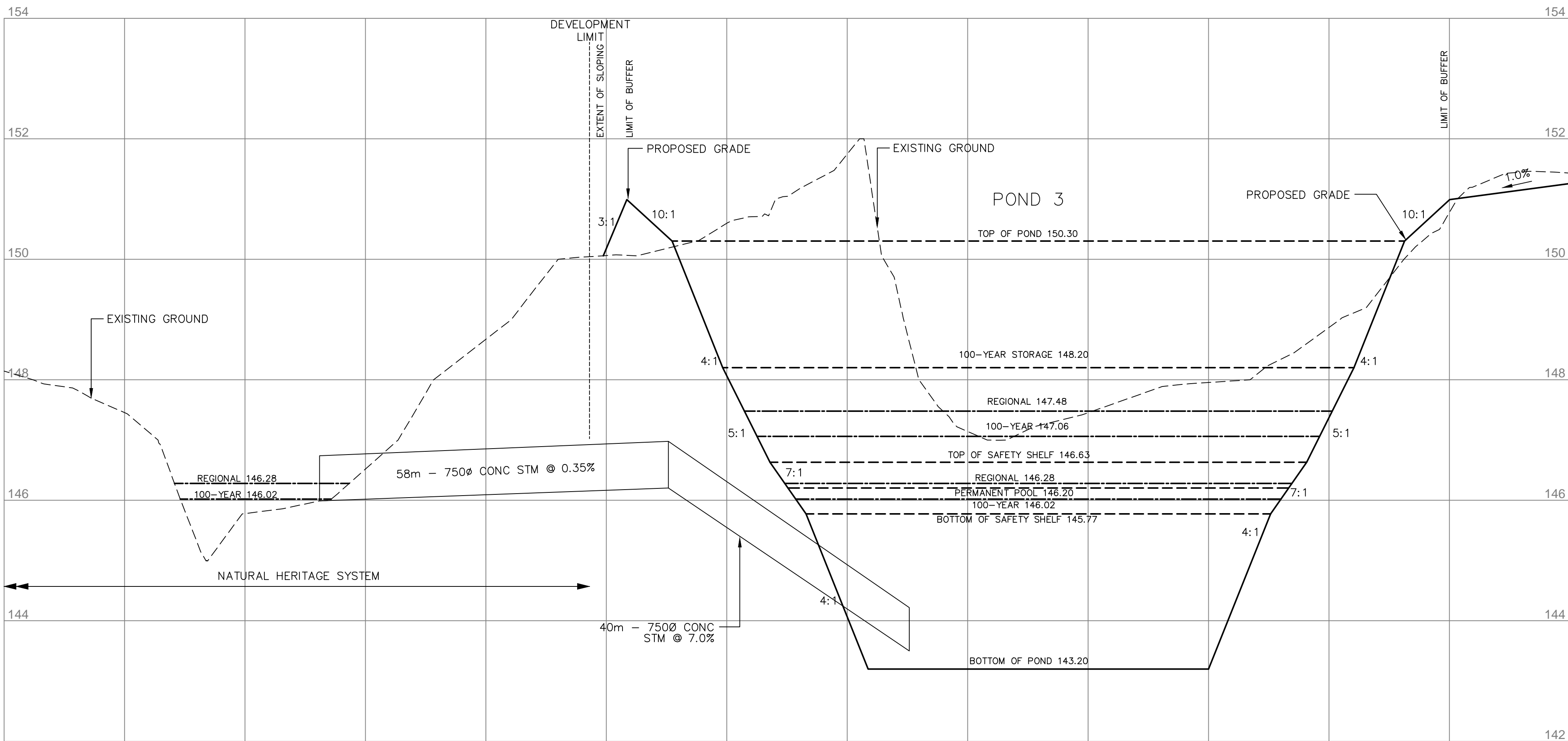

SECTION G-G
H: 1:500 V: 1:100

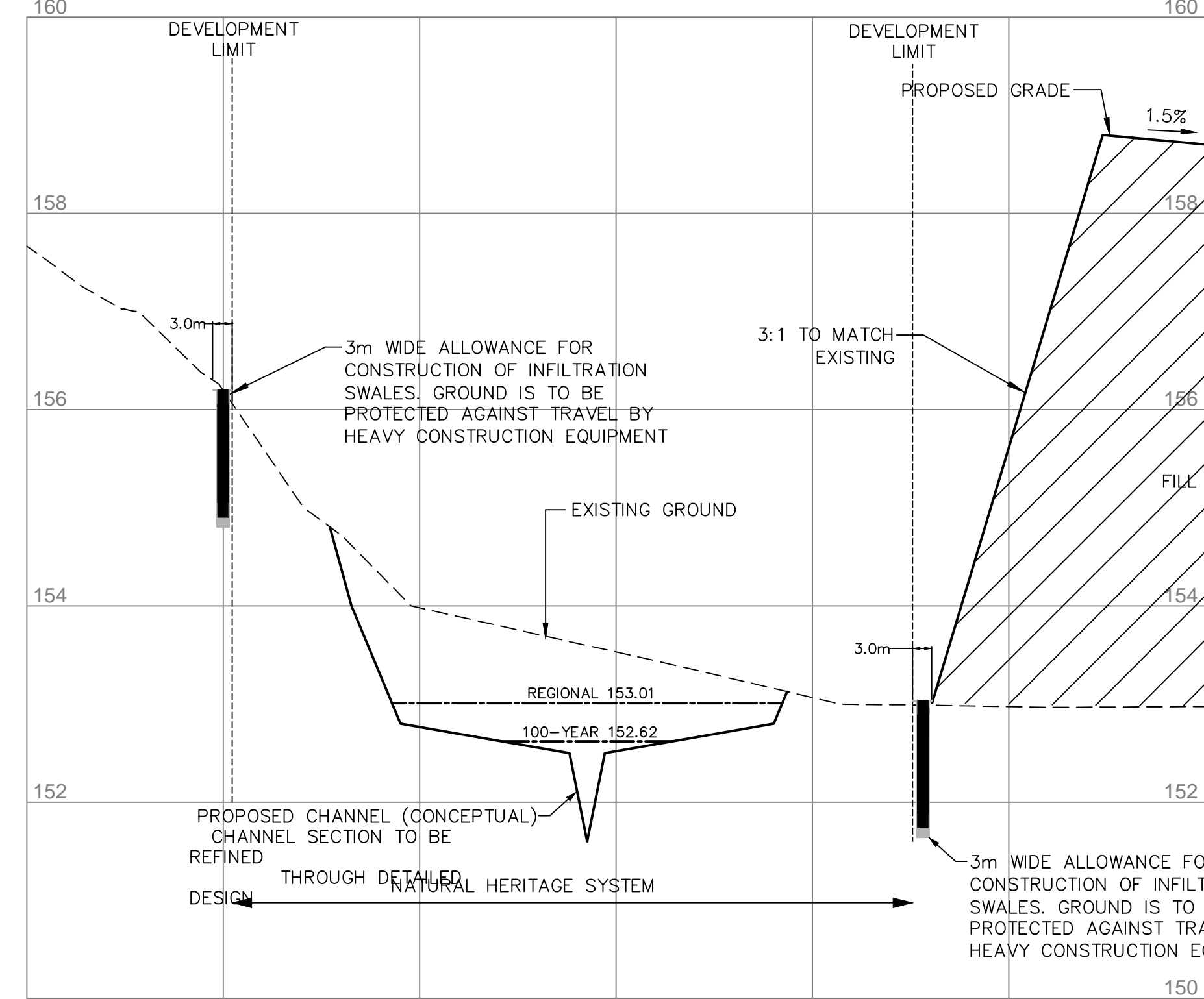

SECTION I-I
H: 1:500 V: 1:100

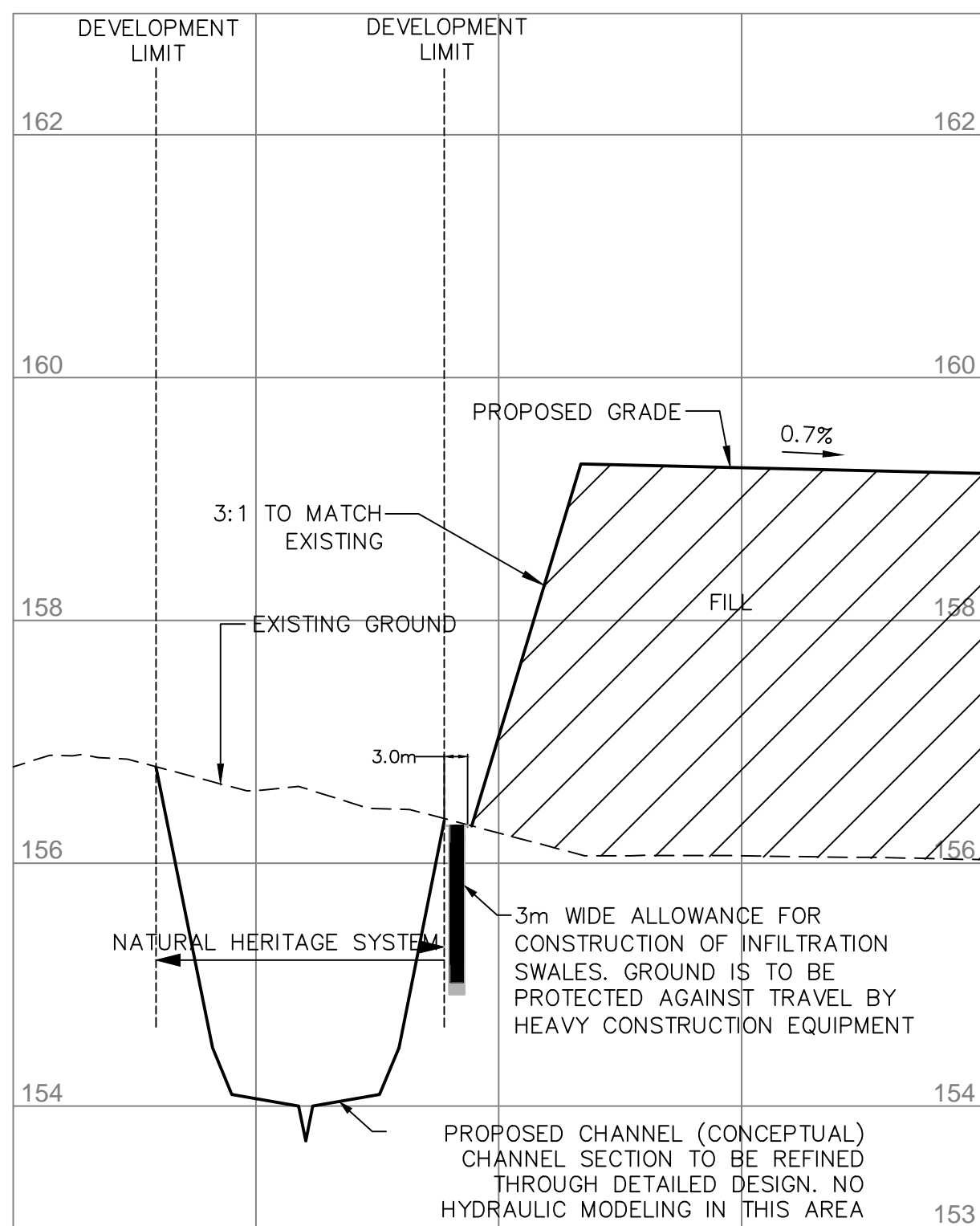

SECTION J-J
H: 1:500 V: 1:100

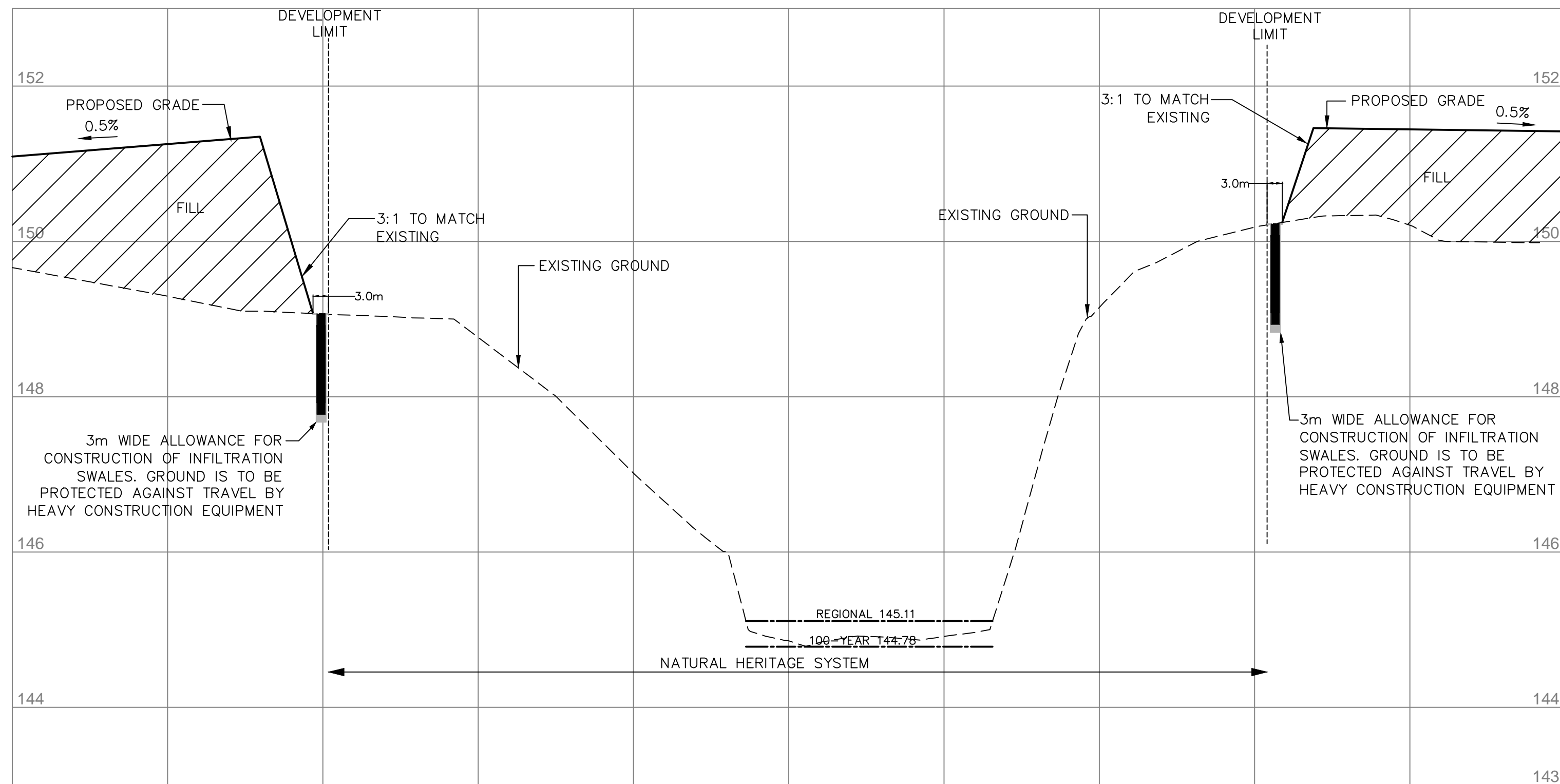

SECTION H-H
H: 1:500 V: 1:100

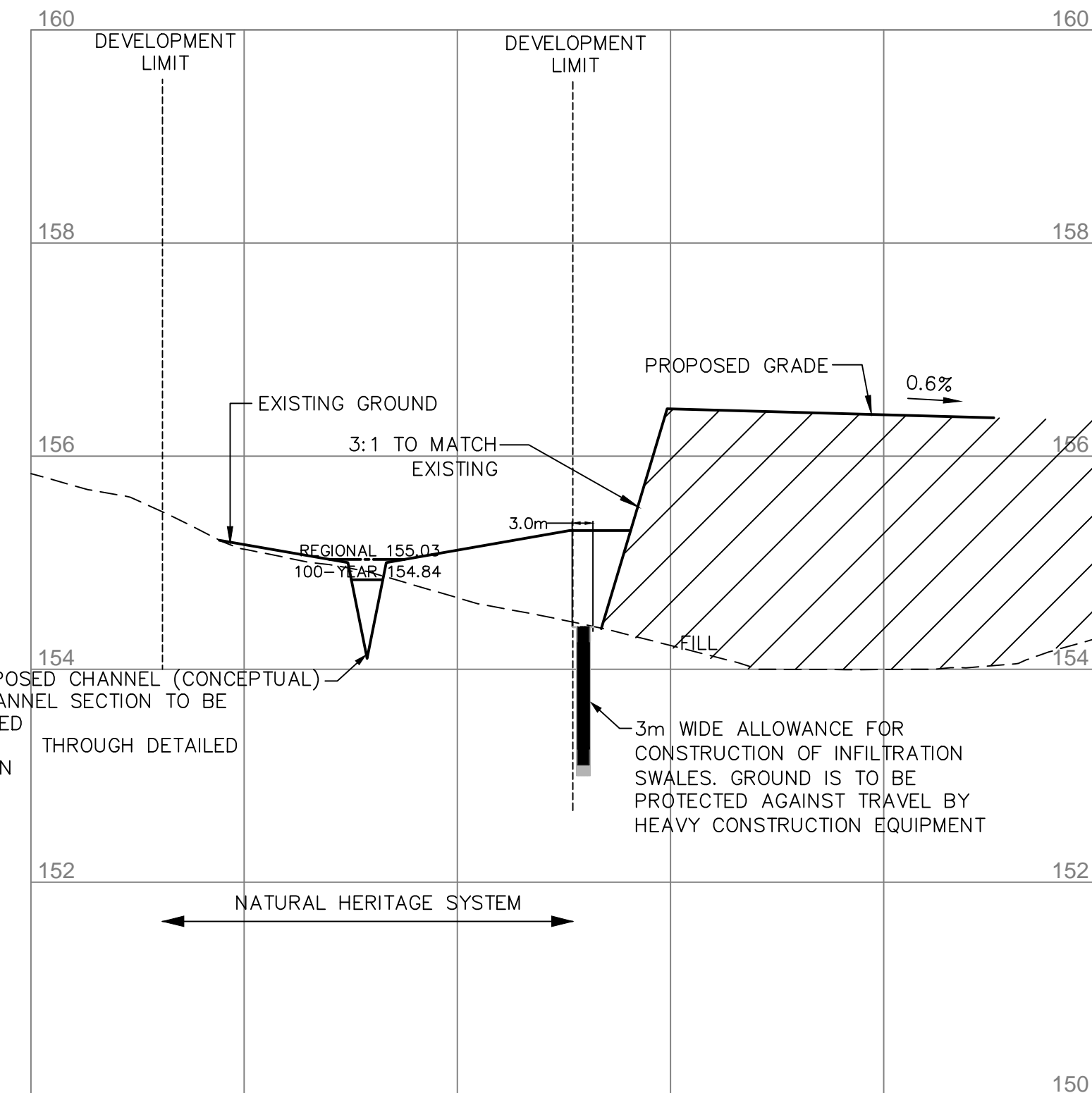

SECTION K-K
H: 1:500 V: 1:100

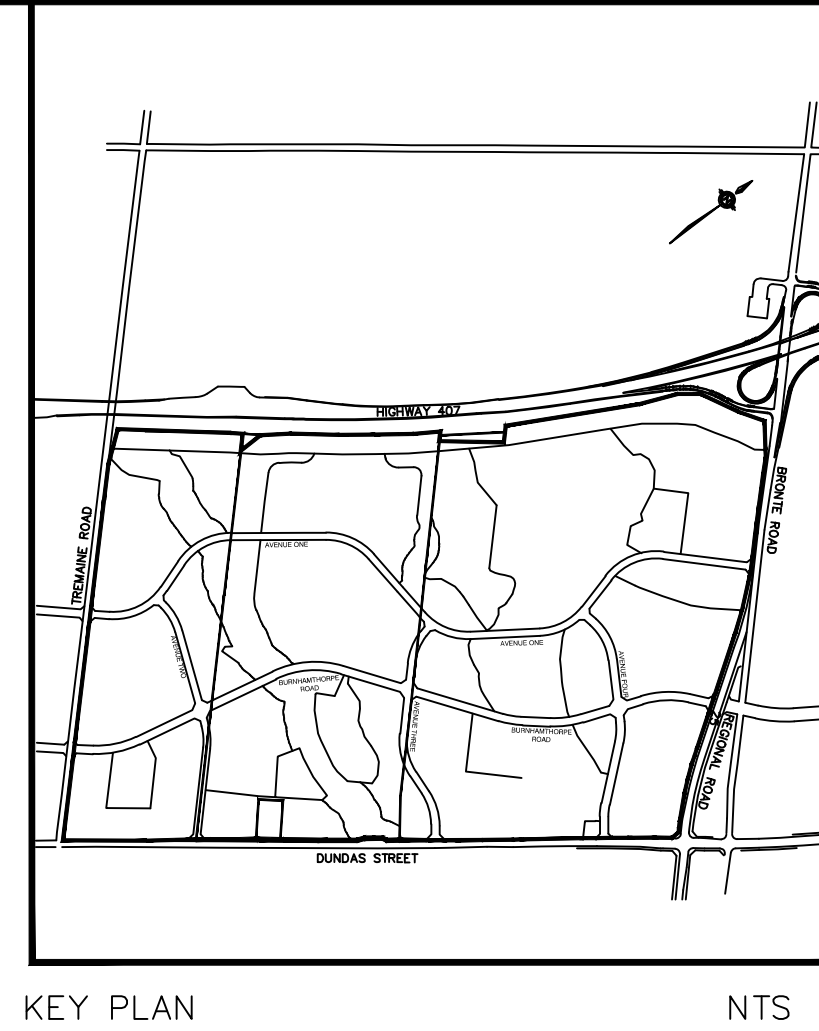

KEY PLAN

NTS

DETAIL FOR INFILTRATION SWALE SHOWN
ON DWG No. 14-09222-001

ALL DIMENSIONS AND ELEVATIONS ARE IN METRES
UNLESS OTHERWISE NOTED.
DRAWINGS ARE NOT DIGITALLY CORRECT.
LAYOUT TO BE COMPLETED BY OFFSETS.

BENCHMARKS
MTO BENCHMARK BM 81.8108 ELEVATION 167.059
TABLET ON CULVERT, SOUTHWEST CORNER OF
DUNDAS STREET AND TRAFALGAR ROAD (1978 DATUM).

5	SEP 2015	ISSUED FOR REVIEW
4	AUG 2015	ISSUED FOR REVIEW
3	NOV 2014	CONCEPTUAL ONLY - SUBMITTED IN SUPPORT OF DRAFT PLAN APPLICATION
2	NOV 2013	CONCEPTUAL ONLY - SUBMITTED IN SUPPORT OF DRAFT PLAN APPLICATION
1	JUN 2013	CONCEPTUAL ONLY - SUBMITTED IN SUPPORT OF DRAFT PLAN APPLICATION

No	Date	By
Design	S.W.	Ch'kd A.W.
Drawn	CAD 10/12	Ch'kd
Scale	AS NOTED	
References		DECEMBER 2012

CONSULTANT

MMM GROUP
100 Commerce Valley Dr. West, Thornhill, ON, Canada L3T 0A1
905.886.1199 905.882.2025 www.mmm.ca

MUNICIPALITY

Halton Regional Municipality of Halton

TOWN OF OAKVILLE

TITLE

**407 WEST EMPLOYMENT AREA
CROSS-SECTION DETAILS**

Municipal Drawing No	Regional Drawing No
MMM File No 14-09222	Drawing No D2

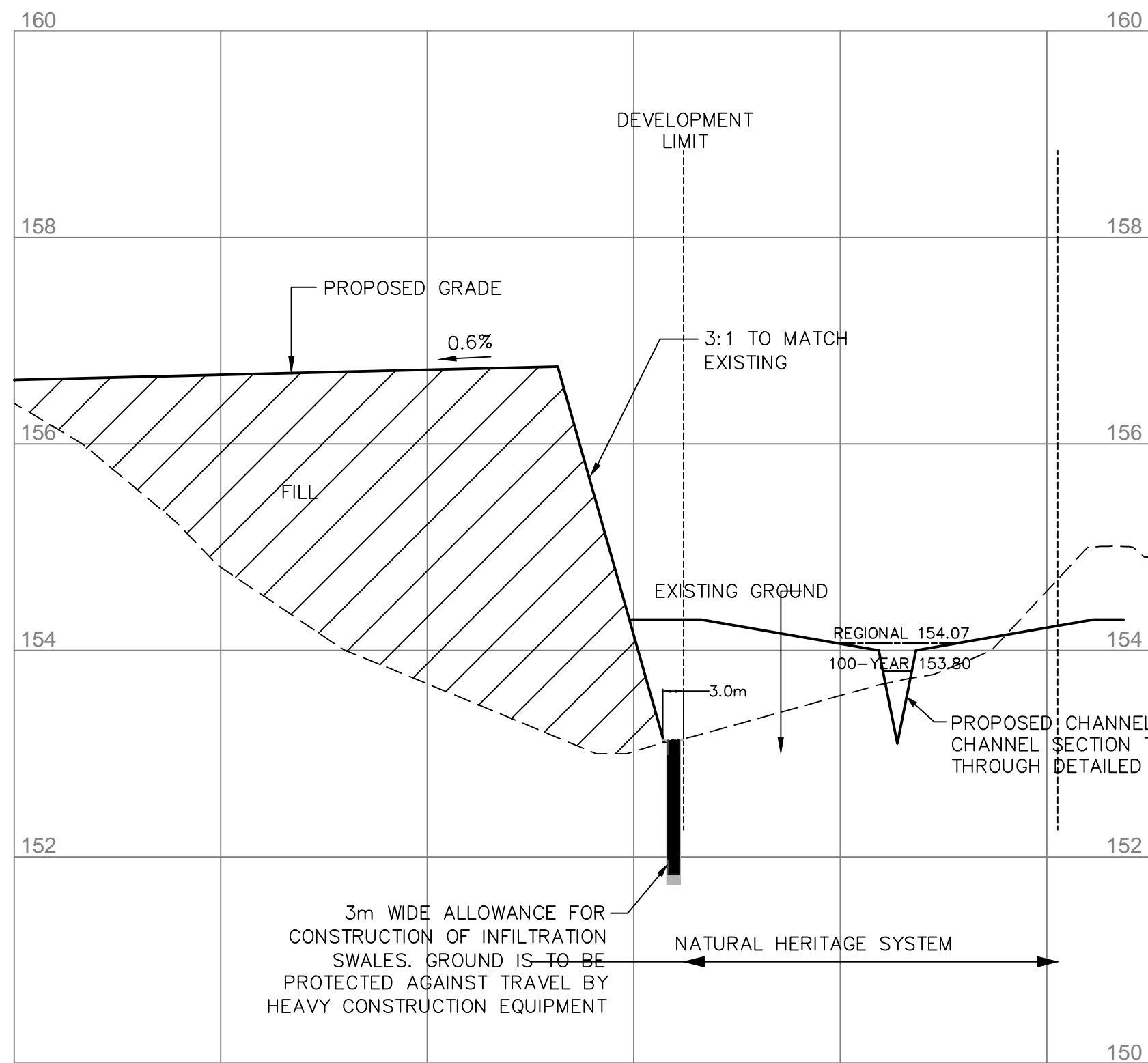

SECTION L-L
H: 1:500 V: 1:100

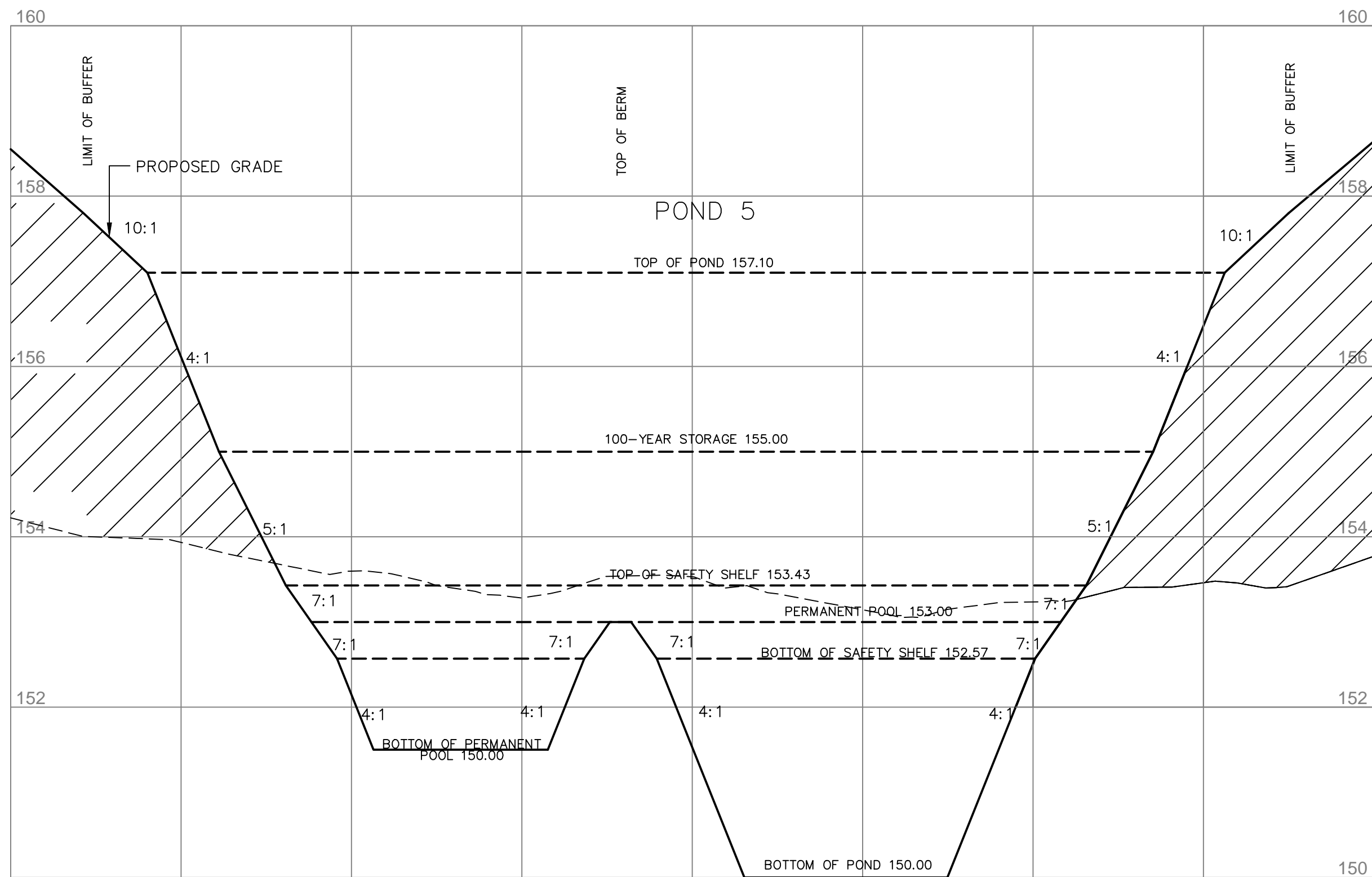

SECTION M-M
H: 1:500 V: 1:100

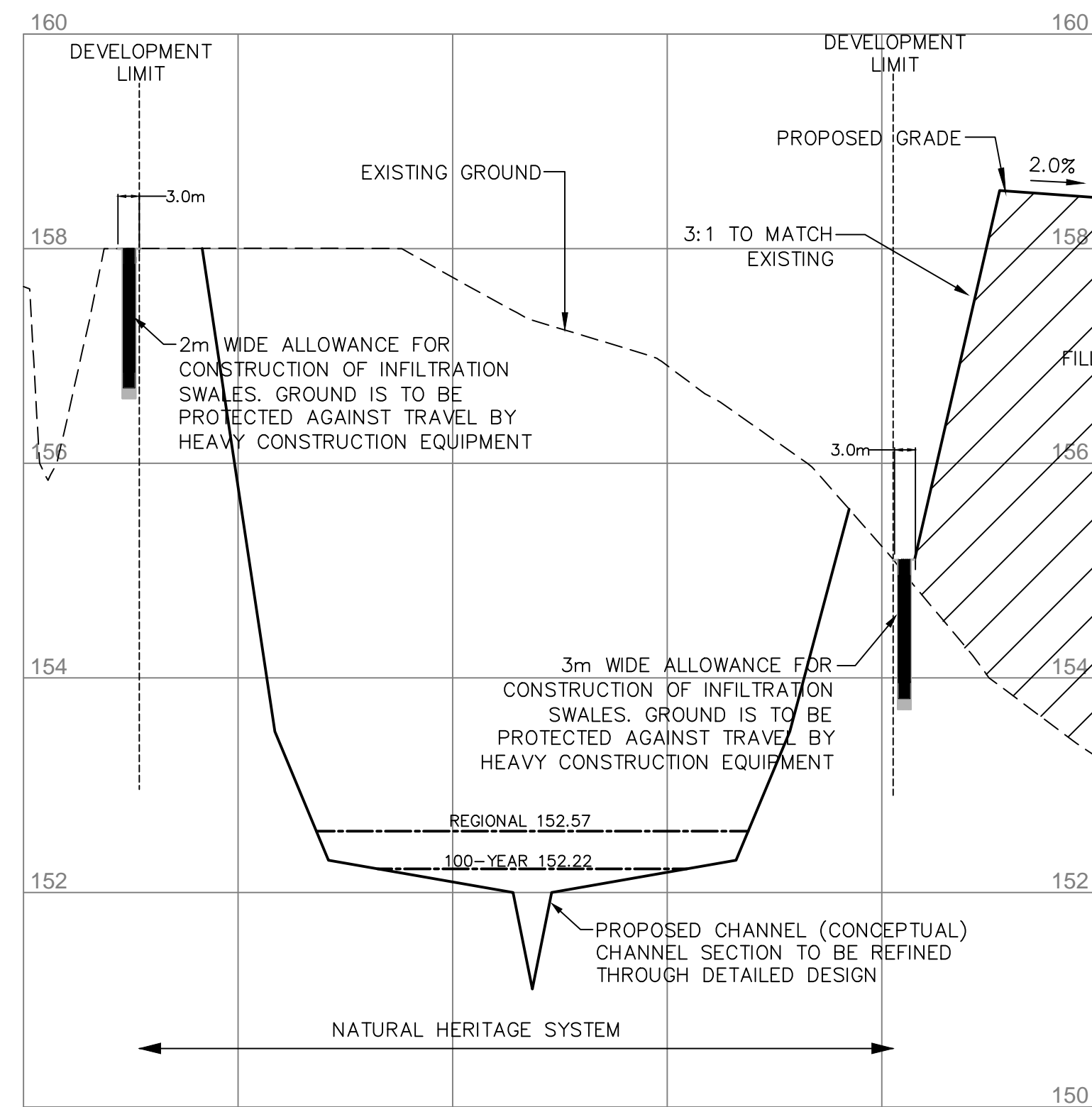

SECTION N-N
H: 1:500 V: 1:100

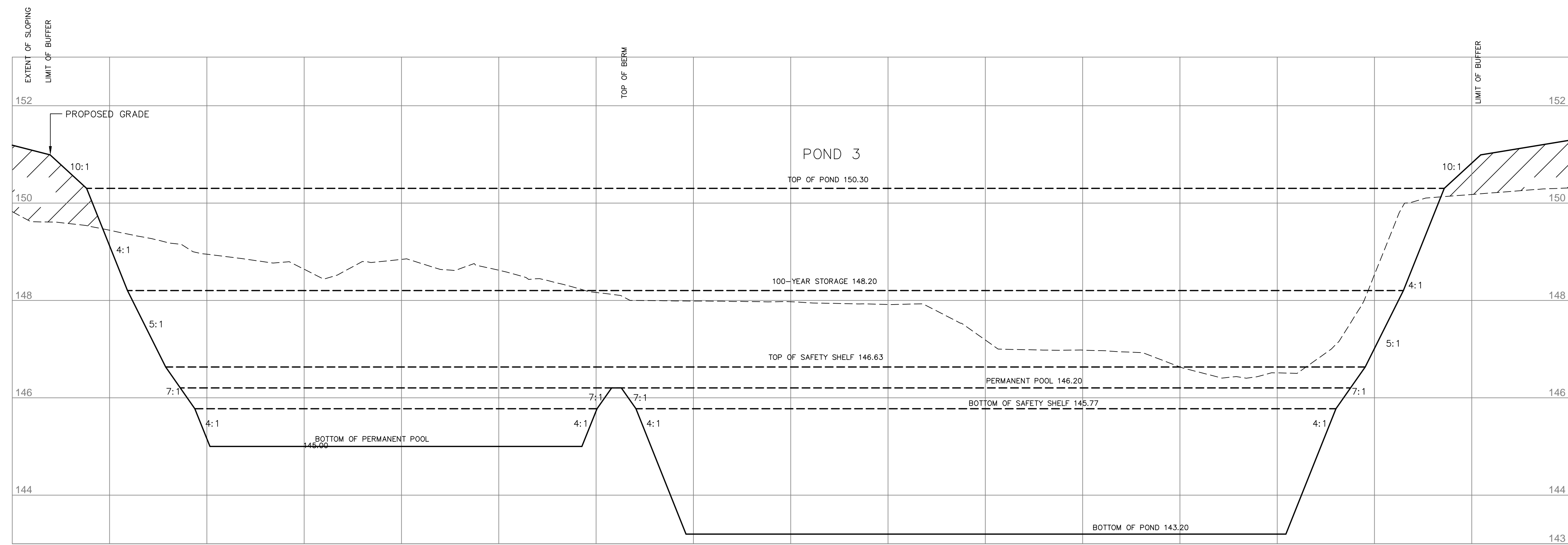

SECTION O-O
H: 1:500 V: 1:100

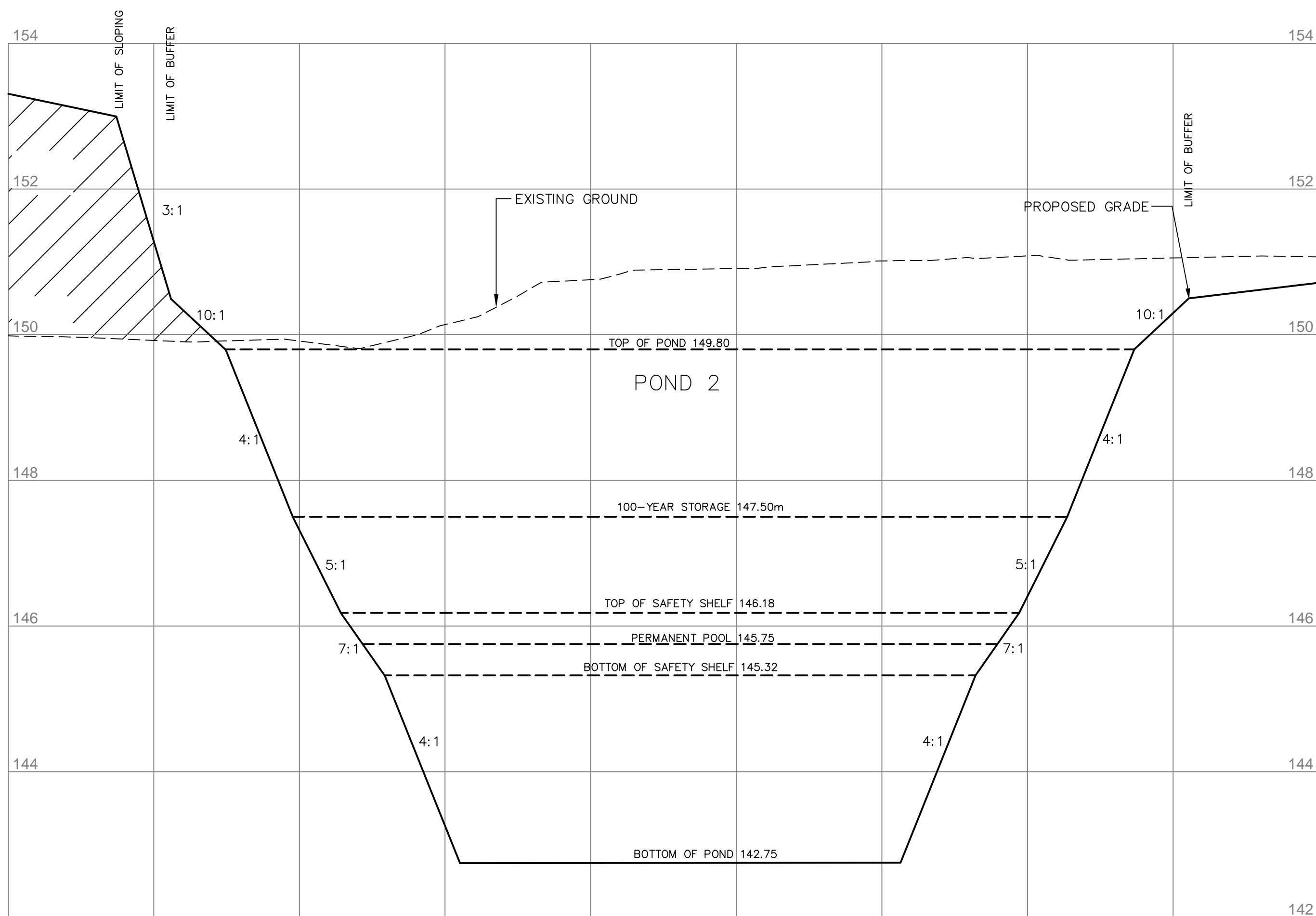

SECTION P-P
H: 1:500 V: 1:100

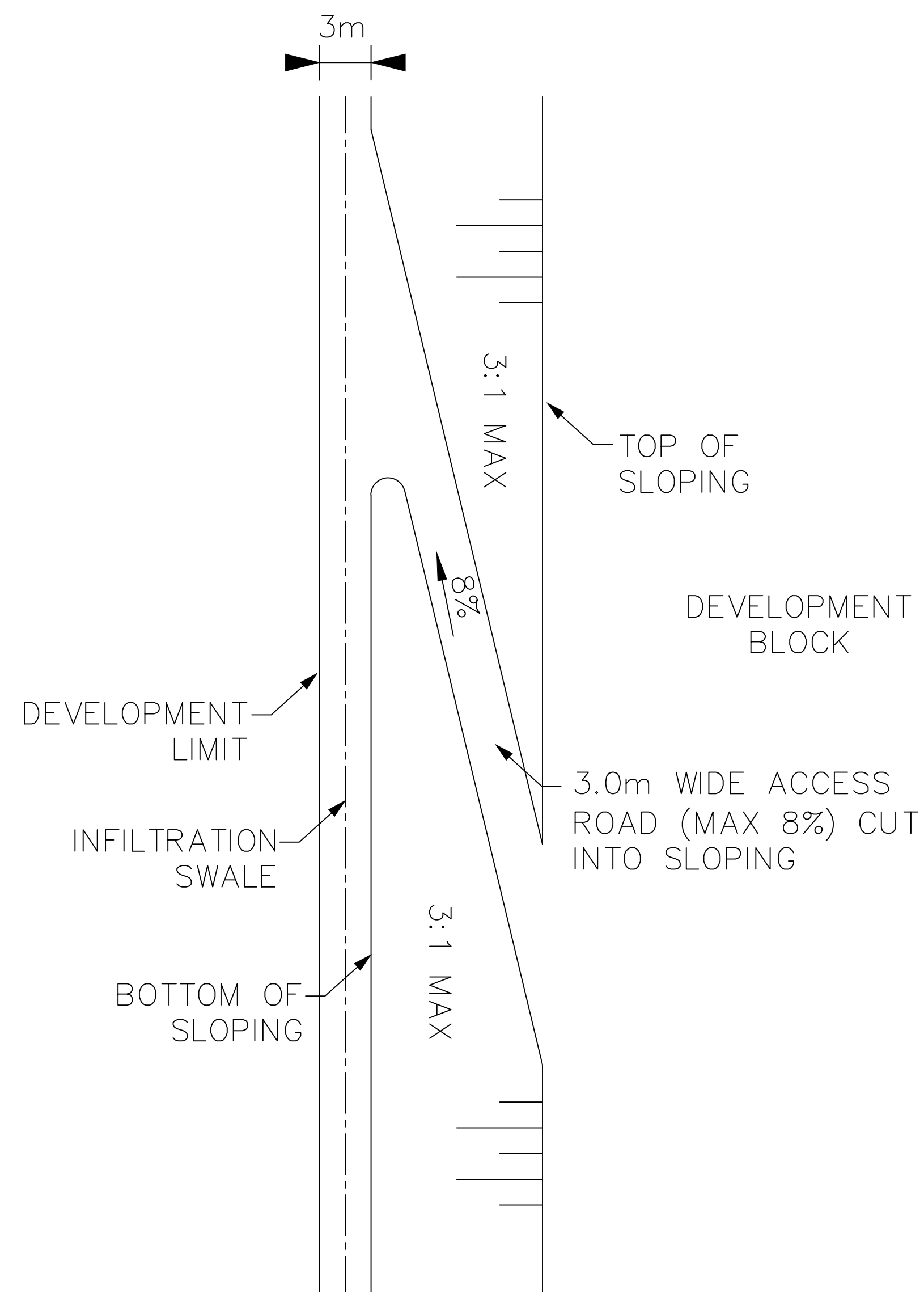

TYPICAL INFILTRATION SWALE
ACCESS DETAIL
SCALE: 1:250

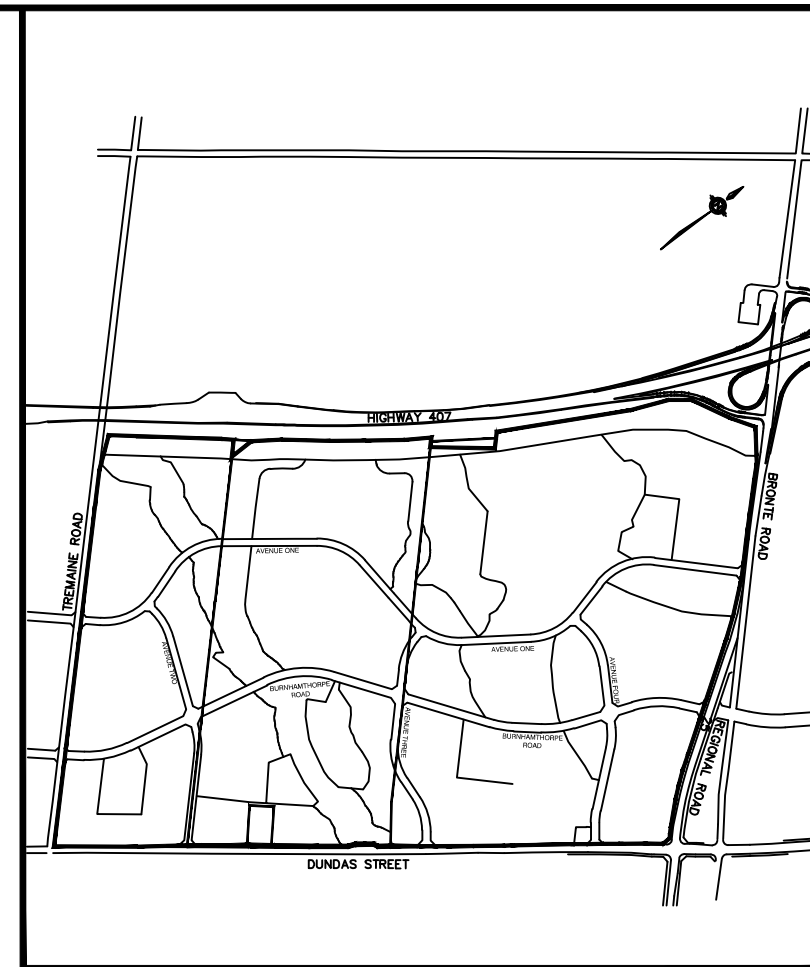

KEY PLAN NTS

DETAIL FOR INFILTRATION SWALE SHOWN
ON DWG No. 14-09222-GR1

ALL DIMENSIONS AND ELEVATIONS ARE IN METRES
UNLESS OTHERWISE NOTED.
DRAWINGS ARE NOT DIGITALLY CORRECT.
LAYOUT TO BE COMPLETED BY OFFSETS.

BENCHMARKS
MTO BENCHMARK BM 81.8108 ELEVATION 167.059
TABLET ON CULVERT, SOUTHWEST CORNER OF
DUNDAS STREET AND TRAFALGAR ROAD (1978 DATUM).

5	SEP 2015	ISSUED FOR REVIEW
4	AUG 2015	ISSUED FOR REVIEW
3	NOV 2014	CONCEPTUAL ONLY-SUBMITTED IN SUPPORT OF DRAFT PLAN APPLICATION
2	NOV 2013	CONCEPTUAL ONLY-SUBMITTED IN SUPPORT OF DRAFT PLAN APPLICATION
1	JUN 2013	CONCEPTUAL ONLY-SUBMITTED IN SUPPORT OF DRAFT PLAN APPLICATION

No	Date	By
Design	S.W.	Ch'kd
Drawn	CAD 10/12	Ch'kd
Scale	AS NOTED	

CONSULTANT

MMM GROUP
100 Commerce Valley Dr. West, Thornhill, ON, Canada L3T 0A1
905.880.1199 905.882.2025 www.mmm.ca

MUNICIPALITY

Halton Regional Municipality of Halton

TOWN OF OAKVILLE

TITLE

407 WEST EMPLOYMENT AREA
CROSS-SECTION DETAILS

Municipal Drawing No

Regional Drawing No

MMM File No

14-09222

Drawing No

D3

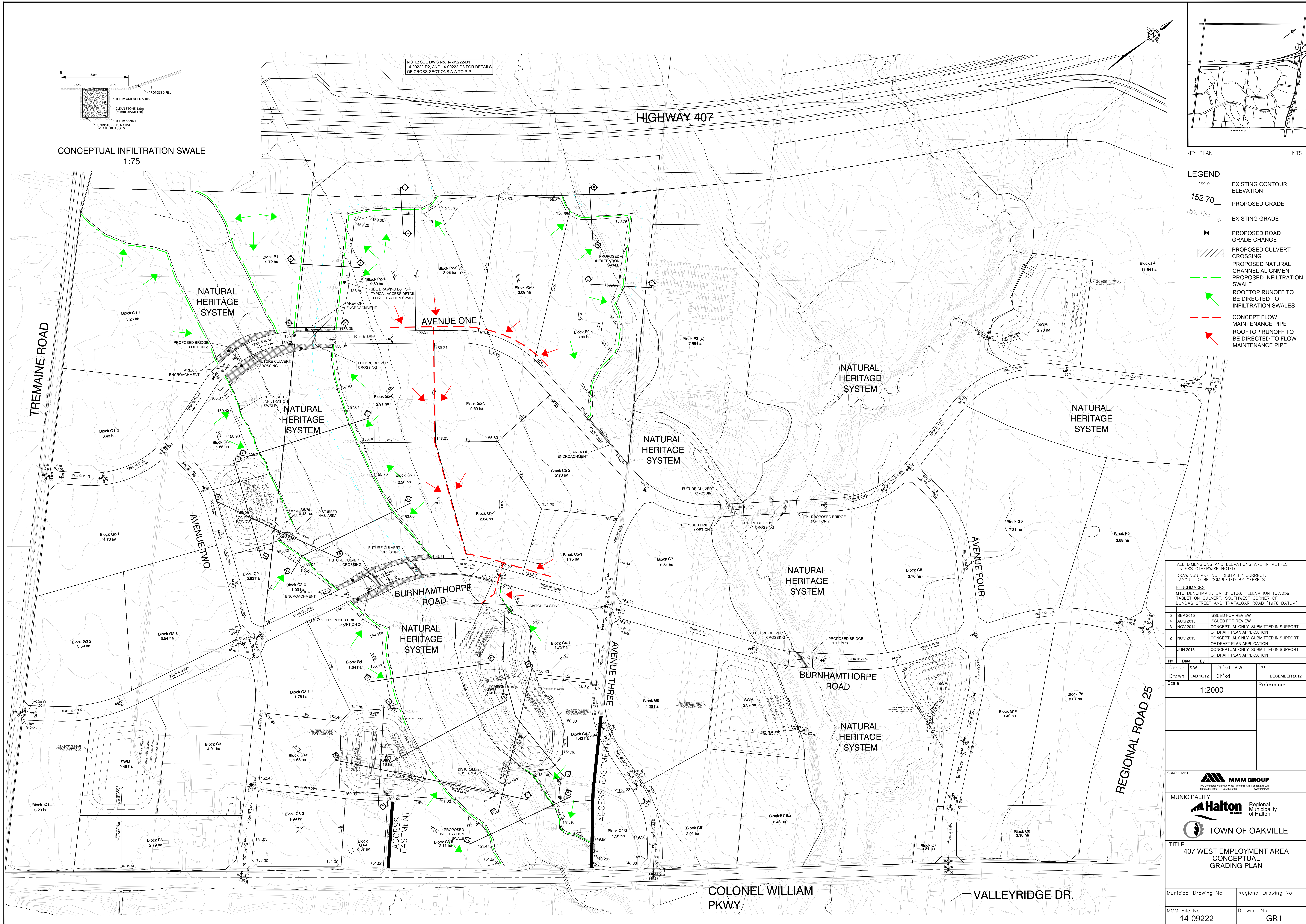

NOTE: SEE DWG NO. 14-09222-D1,
14-09222-D2, AND 14-09222-D3 FOR DETAILS
OF CROSS-SECTIONS A-A TO P-P.

CONCEPTUAL INFILTRATION SWALE
1:75

- LEGEND**
- 150.0 — EXISTING CONTOUR ELEVATION
 - 152.70 + PROPOSED GRADE
 - 152.13 ± + EXISTING GRADE
 - PROPOSED ROAD GRADE CHANGE
 - PROPOSED CULVERT CROSSING
 - PROPOSED NATURAL CHANNEL ALIGNMENT
 - PROPOSED INFILTRATION SWALE
 - ROOFTOP RUNOFF TO BE DIRECTED TO INFILTRATION SWALES
 - CONCEPT FLOW MAINTENANCE PIPE
 - ROOFTOP RUNOFF TO BE DIRECTED TO FLOW MAINTENANCE PIPE

ALL DIMENSIONS AND ELEVATIONS ARE IN METRES UNLESS OTHERWISE NOTED.
DRAWINGS ARE NOT DIGITALLY CORRECT. LAYOUT TO BE COMPLETED BY OFFSETS.
BENCHMARKS
MTO BENCHMARK BM 81.8108 ELEVATION 167.059
TABLET ON CULVERT, SOUTHWEST CORNER OF DUNDAS STREET AND TRAFALGAR ROAD (1978 DATUM).

5	SEP 2015	ISSUED FOR REVIEW
4	AUG 2015	ISSUED FOR REVIEW
3	NOV 2014	CONCEPTUAL ONLY - SUBMITTED IN SUPPORT OF DRAFT PLAN APPLICATION
2	NOV 2013	CONCEPTUAL ONLY - SUBMITTED IN SUPPORT OF DRAFT PLAN APPLICATION
1	JUN 2013	CONCEPTUAL ONLY - SUBMITTED IN SUPPORT OF DRAFT PLAN APPLICATION

No	Date	By	Design	S.W.	Ch'kd	A.W.	Date
Drawn	CAD 10/12						DECEMBER 2012
Scale	1:2000						References

CONSULTANT
MMM GROUP
100 Commerce Valley Dr. Mississauga, Ontario L4X 1V3
905.880.1199 905.880.2025 www.mmm.ca

MUNICIPALITY
Halton Region
Regional Municipality of Halton
TOWN OF OAKVILLE

TITLE
**407 WEST EMPLOYMENT AREA
CONCEPTUAL
GRADING PLAN**

Municipal Drawing No	Regional Drawing No
MMM File No 14-09222	Drawing No GR1