

590 Argus Road

OPA / ZBA APPLICATION

Oakville, Ontario

Drawing List

Landscape Architecture:

- L001 Title Sheet
- L101 Landscape Plan
- L102 Planting Plan
- L103 Tree Canopy Cover Plan
- L104 Pedestrian Circulation Plan
- L405 3rd Floor Amenity Space Plan
- L406 4th Floor Amenity Space Plan
- L501 Town of Oakville Details
- L502 Surfacing Details
- L503 Planting Details

Rev. No.	Date	Revision Notes
01	2023-03-20	ISSUED FOR OPA/ZBA
02	2023-10-24	ISSUED FOR OPA/ZBA
03	2024-02-27	ISSUED FOR OPA/ZBA
04	2024-03-20	ISSUED FOR OPA/ZBA

NOT FOR CONSTRUCTION

Zoning By-Law Amendment, Official Plan Amendment and Draft Plan of Subdivision 590 Argus Road
File: Z.1614.81, OPA 1614.81 & 24T-23001/1614

Architect
Teepie Architects Inc.
5 Camden Street, Toronto ON
M5V 1V2

Civil Engineer
Trafalgar Engineering Limited
1-481 Morden Road, Oakville ON
L6K 2W6

Traffic Engineer
BA Consulting Group Limited
300-45 St. Clair Avenue West, Toronto ON
M4V 1K9

Solid Waste Management
R.J. Burnside & Associates Limited
1455 Pickering Parkway, Pickering ON
L1V 7G7

Planning
Bousfields Inc.
3 Church Street, Toronto ON
M5E 1M2

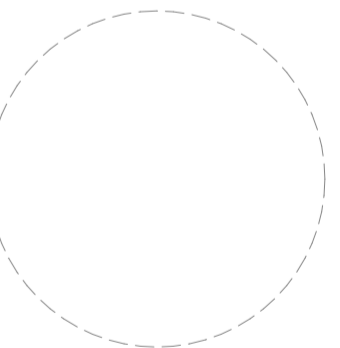
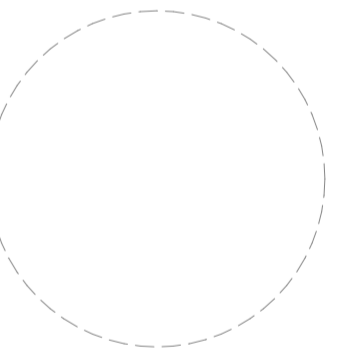

This drawing must not be scaled. The contractors shall verify all dimensions and other data on site prior to commencement of work. Discrepancies, errors, and omissions are to be reported to Public City Architecture Inc. prior to proceeding with the Work.

Drawings and specifications as instruments of service are the property of Public City Architecture Inc.; the copyright in the same being reserved.

No reproduction or revision to these drawings may be made without the permission of Public City Architecture Inc., and when made, must bear their name. All prints to be returned to Public City Architecture Inc. upon request.

Project
590 Argus Road Development
Oakville, Ontario

Drawing
Title Sheet

Drawn By
TL
Scale
As Noted
Date
2024-03-20

Reviewed By
LW
Project No.
Drawing No.
L001

Rev. No.	Date	Revision Notes
01	2023-03-20	ISSUED FOR OPA/ZBA
02	2023-10-24	ISSUED FOR OPA/ZBA
03	2024-02-14	ISSUED FOR OPA/ZBA
04	2024-02-27	ISSUED FOR OPA/ZBA
05	2024-03-20	ISSUED FOR OPA/ZBA

NOT FOR CONSTRUCTION

Zoning By-law Amendment, Official Plan Amendment and Draft Plan of Subdivision
590 Argus Road
 File: Z.1614.81, OPA 1614.81 & 24T-23001/1614

Architect
 Teeple Architects Inc.
 5 Camden Street, Toronto ON
 M5V 1V2

Civil Engineer
 Trafalgar Engineering Limited
 1-481 Morden Road, Oakville ON
 L6K 2W6

Traffic Engineer
 BA Consulting Group Limited
 300-45 St. Clair Avenue West, Toronto ON
 M4V 1K9

Solid Waste Management
 R.J. Burnside & Associates Limited
 1455 Pickering Parkway, Pickering ON
 L1V 7G7

Planning
 Bousfields Inc.
 3 Church Street, Toronto ON
 M5E 1M2

This drawing must not be scaled. The contractors shall verify all dimensions and other data on site prior to commencement of work. Discrepancies, errors, and omissions are to be reported to Public City Architecture Inc. prior to proceeding with the Work.

Drawings and specifications as instruments of service are the property of Public City Architecture Inc.; the copyright in the same being reserved.

No reproduction or revision to these drawings may be made without the permission of Public City Architecture Inc. and when made, must bear their name. All prints to be returned to Public City Architecture Inc. upon request.

Project
590 Argus Road Development
 Oakville, Ontario

Drawing
Landscape Plan

Drawn By
 TL

Reviewed By
 LW

Scale
 1:250

Date
 2024-03-20

Project No.
 Drawing No.
L101

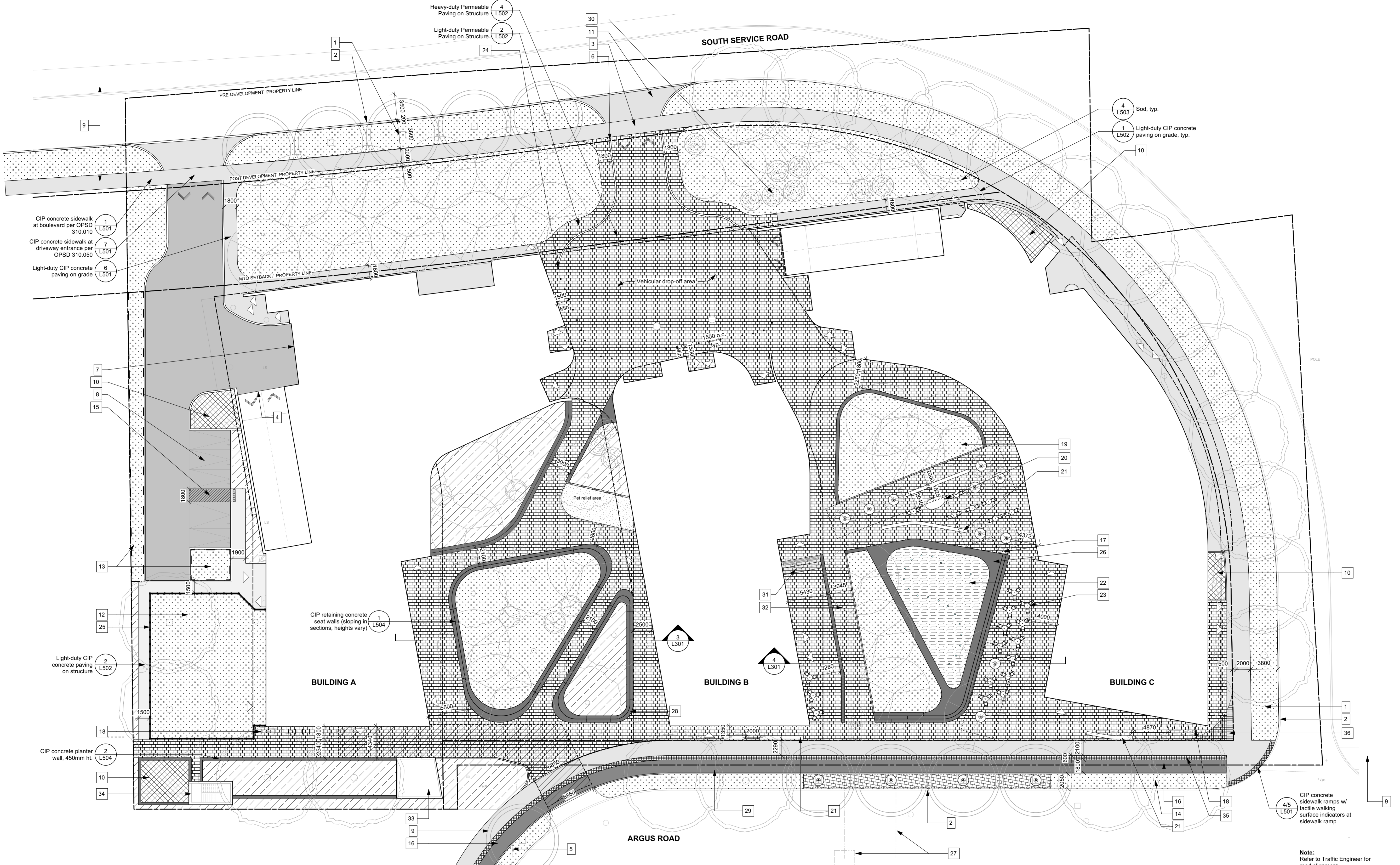

L101 Notes

- 3800mm wide sod strip at South Service Road, typ.
- Concrete curb per Town of Oakville STD 6.1, refer to Civil
- CIP concrete sidewalk at driveway entrance per OPSD 310.050. See 7/L501.
- Parkade entry ramp, refer to Arch.
- Storm sewer pipe, refer to Civil
- 150mm h. CIP concrete curb at driveway
- Waste pick-up and loading access, refer to Arch.
- Loading/parking spaces for Potential Day Care, refer to Arch.
- Future sidewalk (by others)
- Air shaft grates, refer to Arch.
- Concrete vehicular curb ramps, refer to Civil and Traffic.
- Outdoor activity area for potential daycare, refer to Arch.
- Snow Storage, 97 sq m
- 2350mm wide sod strip at Argus Road, typ.
- Pedestrian Access w/ drop curb and tactile plate, refer to Arch.
- 1.8m bike lane, refer to Traffic and Civil Engineering
- Trench drain, refer to Civil
- Bike parking mounted to CIP concrete paving, typ.

- Sloped lawn, flush with CIP concrete planters walls
- Sculptural fireplace/chimney feature
- Freestanding Concrete Bench surface mounted to CIP footing, T.B.D
- Skim water feature with individual fountain jets and perimeter trench drains
- Moveable bistro seating
- Vehicular rated traffic bollards
- Fence on CIP concrete curb
- CIP retaining concrete seat walls (sloping in sections, heights vary)
- Water pipe, refer to Civil
- CIP retaining concrete seat walls (sloping in sections, heights vary)
- Flush concrete curb
- Coniferous trees located outside of view triangle, refer to Traffic Eng.
- CIP concrete stair, 2 risers
- Sloped walkway
- Switchgear room, refer to Arch.
- P1 access stairs, refer to Arch.
- 600mm tactile surface indicator between sidewalk and bike lane
- Denotes 7.5m Daylighting Corner Rounding & Surface Easement

Legend

- Proposed Property Boundary
- Line of building above
- Extent of underground parkade (refer to Arch.)
- Approx. extent of Structural Soil Cells
- Concrete Unit Pavers
- CIP Concrete Paving
- Water feature
- Asphalt Paving
- Sod
- Planting Beds w/ Natural Bark Mulch

Note:
 Refer to Traffic Engineer for road alignment



Rev. No.	Date	Revision Notes
01	2023-03-20	ISSUED FOR OPA/ZBA
02	2023-10-24	ISSUED FOR OPA/ZBA
03	2024-02-14	ISSUED FOR OPA/ZBA
04	2024-02-27	ISSUED FOR OPA/ZBA
05	2024-03-20	ISSUED FOR OPA/ZBA

NOT FOR CONSTRUCTION

Zoning By-law Amendment, Official Plan Amendment and Draft Plan of Subdivision
590 Argus Road
 File: Z.1614.81, OPA 1614.81 & 24T-23001/1614

Architect
 Teeple Architects Inc.
 5 Camden Street, Toronto ON
 M5V 1Y2

Civil Engineer
 Trafalgar Engineering Limited
 1-481 Morden Road, Oakville ON
 L6K 2W6

Traffic Engineer
 BA Consulting Group Limited
 300-45 St. Clair Avenue West, Toronto ON
 M4V 1K9

Solid Waste Management
 R.J. Burnside & Associates Limited
 1455 Pickering Parkway, Pickering ON
 L1V 7G7

Planning
 Bousfields Inc.
 3 Church Street, Toronto ON
 M5E 1M2

This drawing must not be scaled. The contractors shall verify all dimensions and other data on site prior to commencement of work. Discrepancies, errors, and omissions are to be reported to Public City Architecture Inc. prior to proceeding with the Work.

Drawings and specifications as instruments of service are the property of Public City Architecture Inc.; the copyright in the same being reserved.

No reproduction or revision to these drawings may be made without the permission of Public City Architecture Inc., and when made, must bear their name. All prints to be returned to Public City Architecture Inc. upon request.

Project
590 Argus Road Development
 Oakville, Ontario

Drawing
Planting Plan

Drawn By
 TL

Reviewed By
 LW

Scale
 1:250

Project No.

Date
 2024-03-20

Drawing No.
L102

L102 Notes

- Planting bed w/ natural bark mulch and shrub planting, typ. See 3/L503.
- Extent of soil cell system below
- Water pipe, refer to Civil
- Storm sewer pipe, refer to Civil
- 2350mm wide sod strip at Argus Road, typ.



PLANTING SCHEDULE

Symbol	Qty	Common Name	Botanical Name	Spacing	Scheduled Size
TREES ON R.O.W					
Deciduous Trees					
	17	Tulip Tree	<i>Liriodendron tulipifera</i>	8000	
	10	Red Maple	<i>Acer rubrum</i>	8000	

Symbol	Qty	Common Name	Botanical Name	Spacing	Scheduled Size
TREES ON PRIVATE PROPERTY					
Deciduous - Large Stature Trees					
	4	Tulip Tree	<i>Liriodendron tulipifera</i>	14000	
Deciduous - Medium Stature Trees					
	24	Honeylocust	<i>Gleditsia triacanthos var. inermis 'Skyline'</i>	8000	
	8	Turkish Hazel	<i>Corylus colurna</i>	5000	

Symbol	Qty	Common Name	Botanical Name	Spacing	Scheduled Size
Deciduous - Small Stature Trees (3-9m spread)					
	3	Ironwood	<i>Ostrya virginiana</i>	900	
	10	Showy Mountain Ash	<i>Sorbus decora</i>	900	
Coniferous Trees					
	3	Blue Colorado Spruce	<i>Picea pungens var. 'glauca'</i>	5500	
	11	Hoopsii Blue Spruce	<i>Picea pungens 'hoopsii'</i>	1524	Salt Tolerant, Drought Tolerant



Legend

- Proposed Property Boundary
- Line of building (above)
- Extent of underground parkade (refer to Arch.)
- Approx. extent of Structural Soil Cells
- Sod
- Planting Beds w/ Natural Bark Mulch

Rev. No.	Date	Revision Notes
01	2023-03-20	ISSUED FOR OPA/ZBA
02	2023-10-24	ISSUED FOR OPA/ZBA
03	2024-02-14	ISSUED FOR OPA/ZBA
04	2024-02-27	ISSUED FOR OPA/ZBA
05	2024-03-20	ISSUED FOR OPA/ZBA

NOT FOR CONSTRUCTION

Zoning By-law Amendment, Official Plan Amendment and Draft Plan of Subdivision
 590 Argus Road
 File: Z.1614.81, OPA 1614.81 & 24T-23001/1614

Architect
 Teeple Architects Inc.
 5 Camden Street, Toronto ON
 M5V 1V2

Civil Engineer
 Trafalgar Engineering Limited
 1-481 Morden Road, Oakville ON
 L6K 2W6

Traffic Engineer
 BA Consulting Group Limited
 300-45 St. Clair Avenue West, Toronto ON
 M4V 1K9

Solid Waste Management
 R.J. Burnside & Associates Limited
 1455 Pickering Parkway, Pickering ON
 L1V 7G7

Planning
 Bousfields Inc.
 3 Church Street, Toronto ON
 M5E 1M2



This drawing must not be scaled. The contractors shall verify all dimensions and other data on site prior to commencement of work. Discrepancies, errors, and omissions are to be reported to Public City Architecture Inc. prior to proceeding with the Work.

Drawings and specifications as instruments of service are the property of Public City Architecture Inc.; the copyright in the same being reserved.

No reproduction or revision to these drawings may be made without the permission of Public City Architecture Inc., and when made, must bear their name. All prints to be returned to Public City Architecture Inc. upon request.

Project
 590 Argus Road Development
 Oakville, Ontario

Drawing
Tree Canopy Cover Plan

Drawn By
 TL

Reviewed By
 LW

Scale
 1:250

Date
 2024-02-27

Drawing No.
L103

Canopy Calculation Chart Template

File Number
 File Name
 Canopy Cover Target 20%

Tree #	Species	Stature (S, M, L)	Soil Volume per Tree (m3)	Canopy Area (m2)	Canopy Area Sub-total (m2)
01-02	Liriodendron tulipifera	L	30	297	
03-04	Liriodendron tulipifera	L	30	297	
05-13	Gleditsia trachanthos var. inermis 'Skyline'	M	30	700.8	
14-16	Gleditsia trachanthos var. inermis 'Skyline'	M	30	235.5	
17	Gleditsia trachanthos var. inermis 'Skyline'	M	30	287.2	
18-19	Corylus colurna	M	30		
20	Corylus colurna	M	30		
21	Sorbus decora	S	30		
22	Ostrya virginiana	S	30		
23-25	Corylus colurna	M	30	424	
26-28	Gleditsia trachanthos var. inermis 'Skyline'	M	30		
29	Sorbus decora	S	30		
30-31	Ostrya virginiana	S	30		
32-33	Corylus colurna	M	30	157.2	
34-36	Gleditsia trachanthos var. inermis 'Skyline'	M	30	187.3	
37-44	Sorbus decora	S	30	56.5	
45-47	Gleditsia trachanthos var. inermis 'Skyline'	M	30	221.6	
48-49	Gleditsia trachanthos var. inermis 'Skyline'	M	30	146.4	
Subtotal of Proposed Canopy					3010.5
Existing Canopy on Site					N/A
Existing Canopy Overhanging Site					N/A
Subtotal of Existing Overhanging Canopy					N/A
Total # of Trees					49
Total Canopy Area (m2)					3010.5

Canopy Summary	
Total Site Area (m2)	12004
Site Canopy Cover	25.079%
Canopy Cover Target by Land Use	20%

Parking Area Summary	
Total Parking Spaces Proposed	N/A
Total # of Trees in or within 5m of Parking Area	N/A

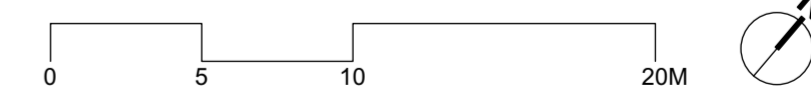

Legend

- Proposed Property Boundary
- - - Line of building (above)
- - - - - Extent of underground parkade (refer to Arch.)
- Approx. extent of Structural Soil Cells
- Tree Canopy Area

Note:
 Refer to Traffic Engineer for road alignment

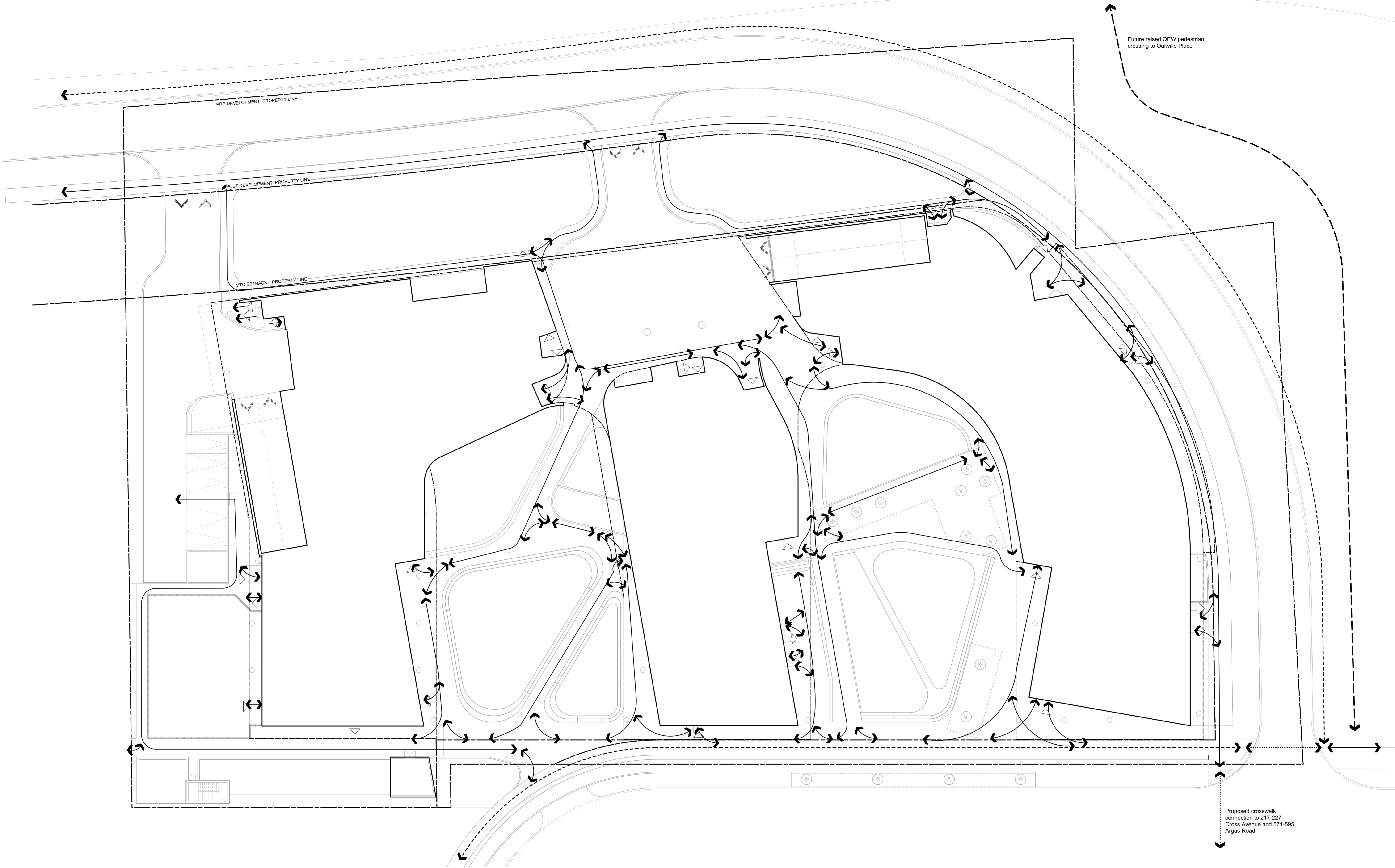

Rev. No.	Date	Revision Notes
01	2023-03-20	ISSUED FOR OPA/ZBA
02	2023-10-24	ISSUED FOR OPA/ZBA
03	2024-02-14	ISSUED FOR OPA/ZBA
04	2024-02-27	ISSUED FOR OPA/ZBA
05	2024-03-20	ISSUED FOR OPA/ZBA

NOT FOR CONSTRUCTION

Zoning By-law Amendment, Official Plan Amendment and Draft Plan of Subdivision
590 Argus Road
 File: Z.1614.81, OPA 1614.81 & 24T-23001/1614

Architect
 Teeple Architects Inc.
 5 Camden Street, Toronto ON
 M5V 1V2

Civil Engineer
 Trafalgar Engineering Limited
 1-481 Morden Road, Oakville ON
 L6K 2W6

Traffic Engineer
 BA Consulting Group Limited
 300-45 St. Clair Avenue West, Toronto ON
 M4V 1K9

Solid Waste Management
 R.J. Burnside & Associates Limited
 1455 Pickering Parkway, Pickering ON
 L1V 7G7

Planning
 Bousfields Inc.
 3 Church Street, Toronto ON
 M5E 1M2

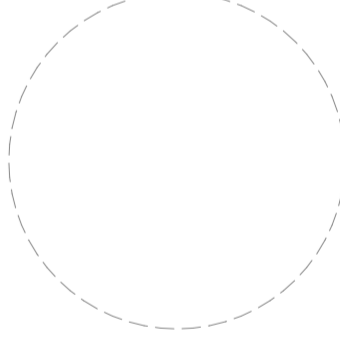

This drawing must not be scaled. The contractors shall verify all dimensions and other data on site prior to commencement of work. Discrepancies, errors, and omissions are to be reported to Public City Architecture Inc. prior to proceeding with the Work.

Drawings and specifications as instruments of service are the property of Public City Architecture Inc.; the copyright in the same being reserved.

No reproduction or revision to these drawings may be made without the permission of Public City Architecture Inc., and when made, must bear their name. All prints to be returned to Public City Architecture Inc. upon request.

Project
590 Argus Road Development
 Oakville, Ontario

Drawing
Pedestrian Circulation Plan

Drawn By
 TL

Reviewed By
 LW

Scale
 1:250

Project No.

Date
 2024-02-27

Drawing No.

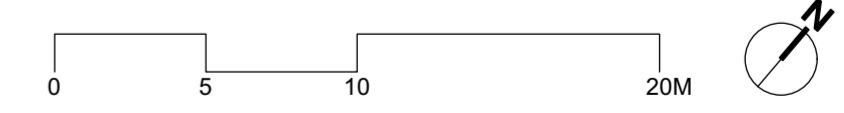

- Legend**
- Proposed Property Boundary
 - - - Line of building (above)
 - - - - - Extent of underground parkade (refer to Arch.)
 - Proposed Pedestrian Sidewalk Connections
 - Proposed Pedestrian Connections
 - Proposed Crosswalk Connections
 - Future Pedestrian Connection



Rev. No.	Date	Revision Notes
01	2024-02-14	ISSUED FOR OPAZBA
02	2024-02-27	ISSUED FOR OPAZBA
03	2024-03-20	ISSUED FOR OPAZBA



NOT FOR CONSTRUCTION

Zoning By-law Amendment, Official Plan Amendment and Draft Plan of Subdivision
590 Argus Road
 File: Z.1614.81, OPA 1614.81 & 24T-23001/1614

Architect
 Teeple Architects Inc.
 5 Camden Street, Toronto ON
 M5V 1V2

Civil Engineer
 Trafalgar Engineering Limited
 1-481 Morden Road, Oakville ON
 L6K 2W6

Traffic Engineer
 BA Consulting Group Limited
 300-45 St. Clair Avenue West, Toronto ON
 M4V 1K9

Solid Waste Management
 R.J. Burnside & Associates Limited
 1455 Pickering Parkway, Pickering ON
 L1V 7G7

Planning
 Bousfields Inc.
 3 Church Street, Toronto ON
 M5E 1M2

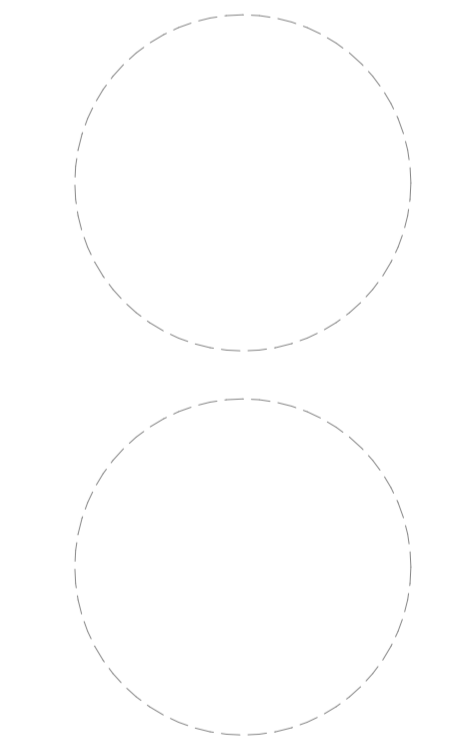
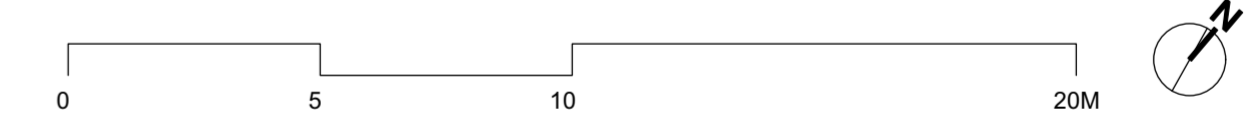

This drawing must not be scaled. The contractors shall verify all dimensions and other data on site prior to commencement of work. Discrepancies, errors, and omissions are to be reported to Public City Architecture Inc. prior to proceeding with the Work.

Drawings and specifications as instruments of service are the property of Public City Architecture Inc.; the copyright in the same being reserved.

No reproduction or revision to these drawings may be made without the permission of Public City Architecture Inc., and when made, must bear their name. All prints to be returned to Public City Architecture Inc. upon request.

Project
590 Argus Road Development
 Oakville, Ontario

Drawing
3rd Floor Amenity
Space Plan - Diagram

Drawn By
 TL

Reviewed By
 LW

Scale
 As Noted

Project No.

Date
 2023-10-24

Drawing No.



Rev. No.	Date	Revision Notes
01	2024-02-14	ISSUED FOR OPAZBA
02	2024-02-27	ISSUED FOR OPAZBA
03	2024-03-20	ISSUED FOR OPAZBA

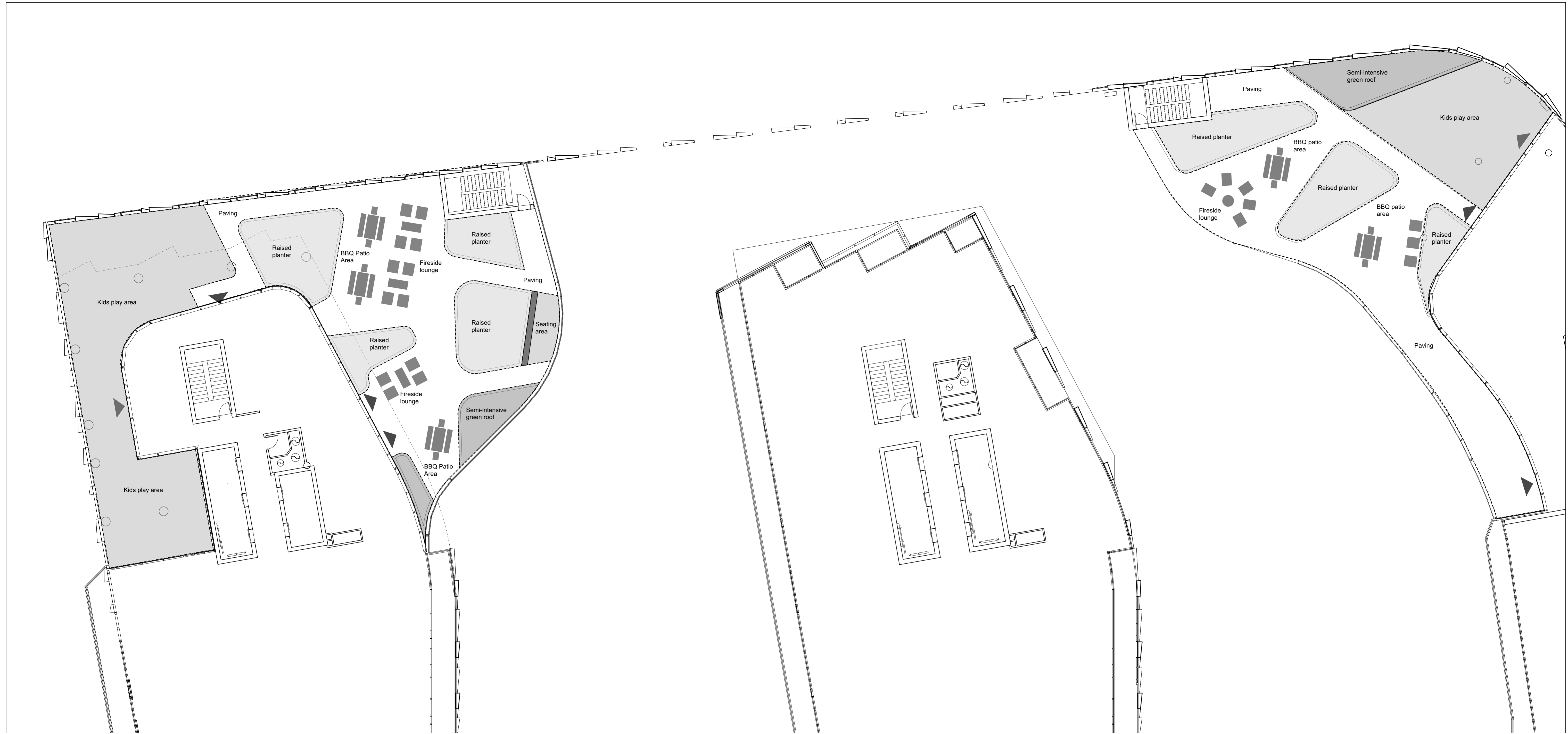

NOT FOR CONSTRUCTION

Zoning By-law Amendment, Official Plan Amendment and Draft Plan of Subdivision
590 Argus Road
 File: Z.1614.81, OPA 1614.81 & 24T-23001/1614

Architect
 Teeple Architects Inc.
 5 Camden Street, Toronto ON
 M5V 1V2

Civil Engineer
 Trafalgar Engineering Limited
 1-481 Morden Road, Oakville ON
 L6K 2W6

Traffic Engineer
 BA Consulting Group Limited
 300-45 St. Clair Avenue West, Toronto ON
 M4V 1K9

Solid Waste Management
 R.J. Burnside & Associates Limited
 1455 Pickering Parkway, Pickering ON
 L1V 7G7

Planning
 Bousfields Inc.
 3 Church Street, Toronto ON
 M5E 1M2

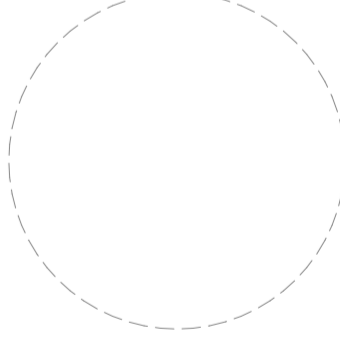
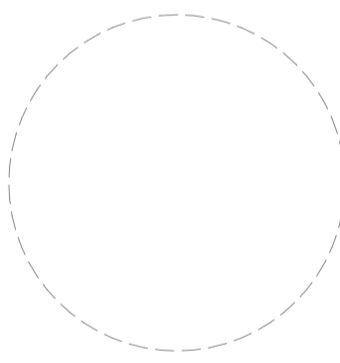

This drawing must not be scaled. The contractors shall verify all dimensions and other data on site prior to commencement of work. Discrepancies, errors, and omissions are to be reported to Public City Architecture Inc. prior to proceeding with the Work.

Drawings and specifications as instruments of service are the property of Public City Architecture Inc.; the copyright in the same being reserved.

No reproduction or revision to these drawings may be made without the permission of Public City Architecture Inc., and when made, must bear their name. All prints to be returned to Public City Architecture Inc. upon request.

Project
590 Argus Road Development
 Oakville, Ontario

Drawing
4th Floor Amenity
Space Plan - Diagram

Drawn By
 TL
 Scale
 As Noted

Reviewed By
 LW
 Project No.

Date
 2023-10-24

Drawing No.

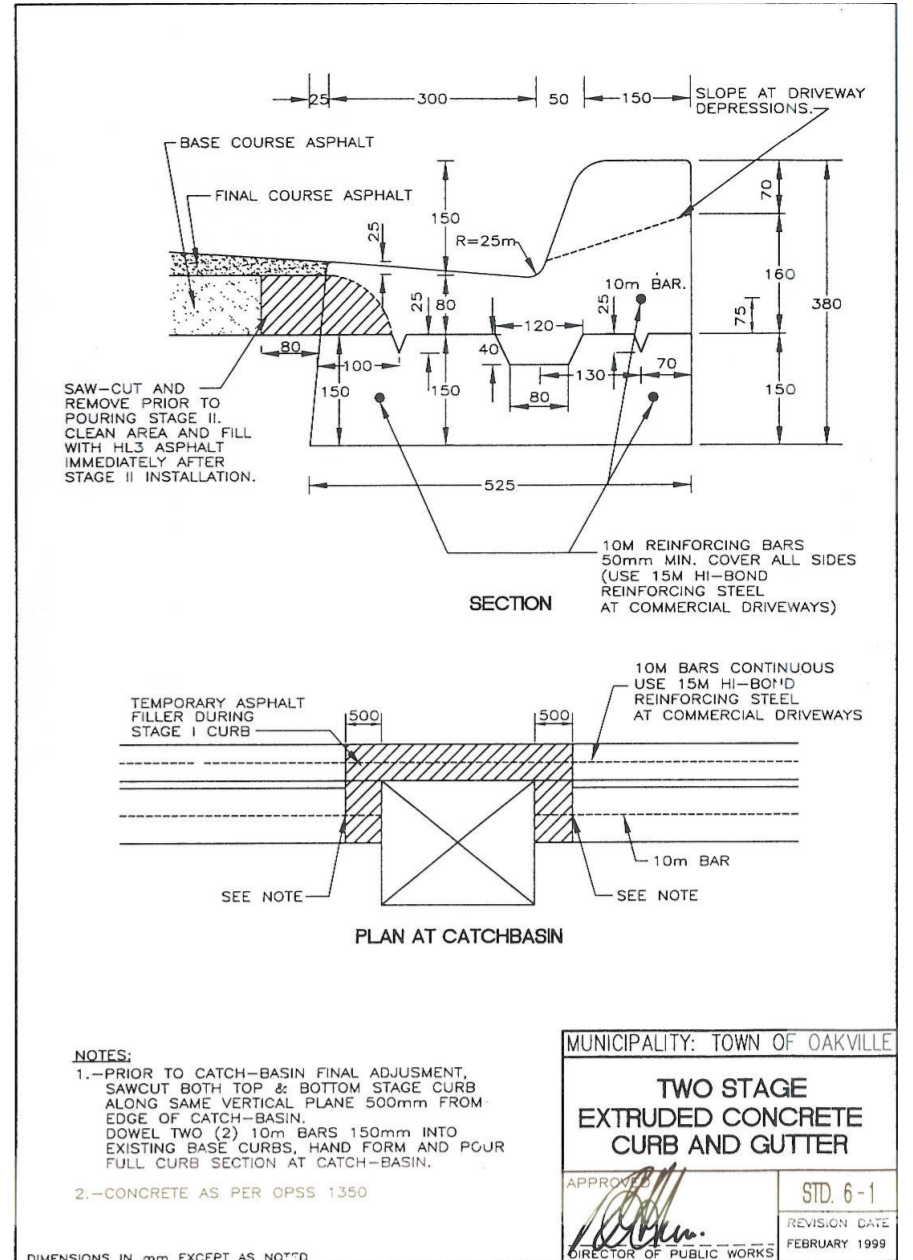
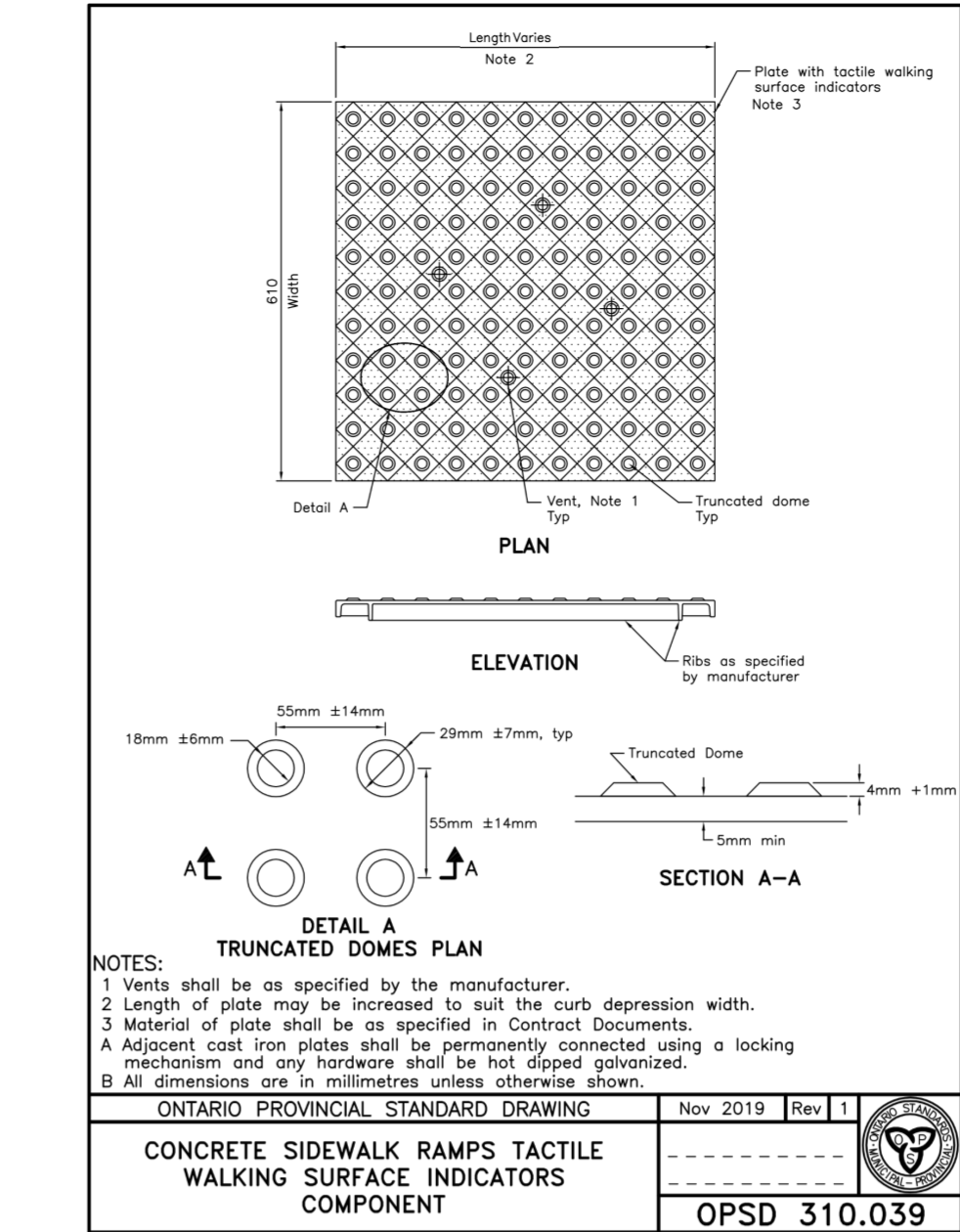
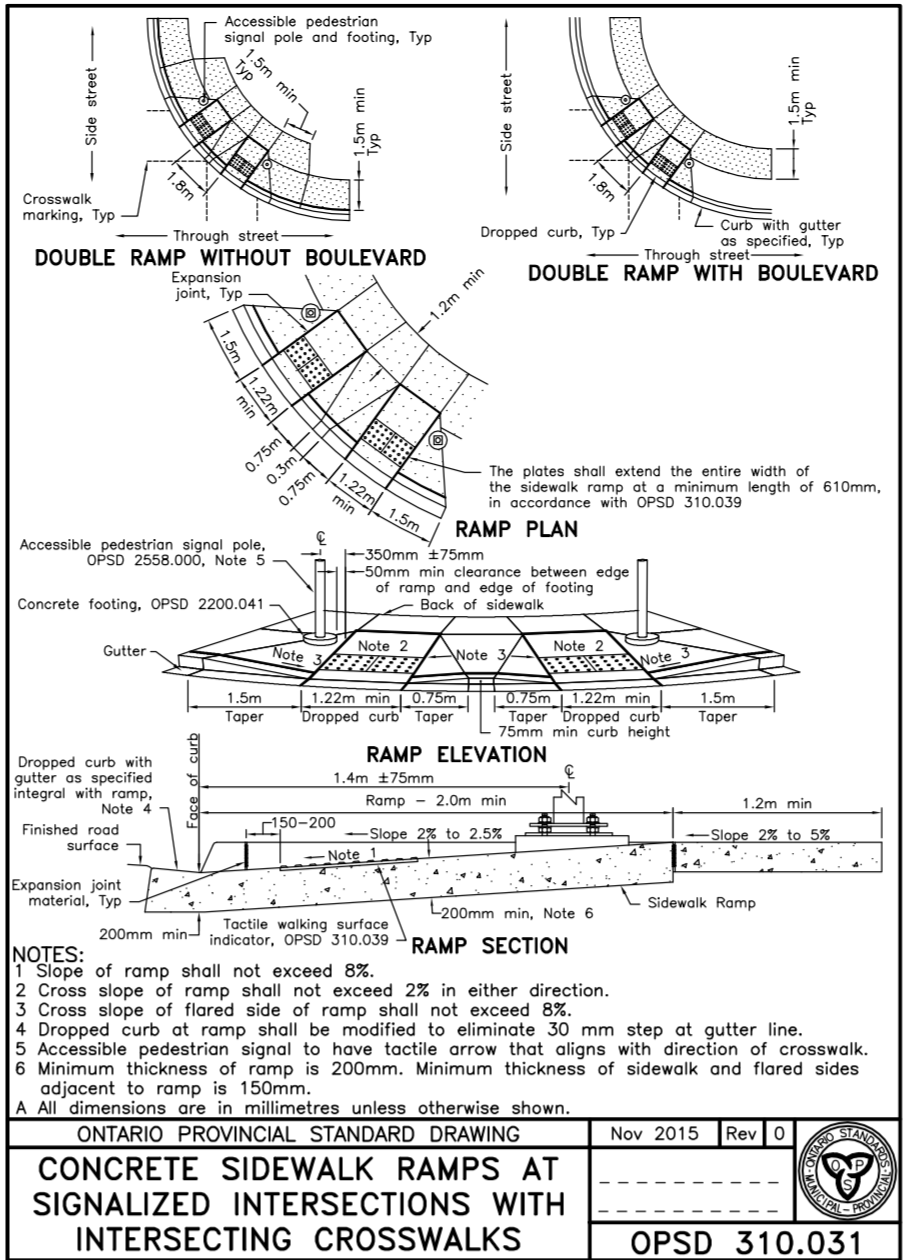
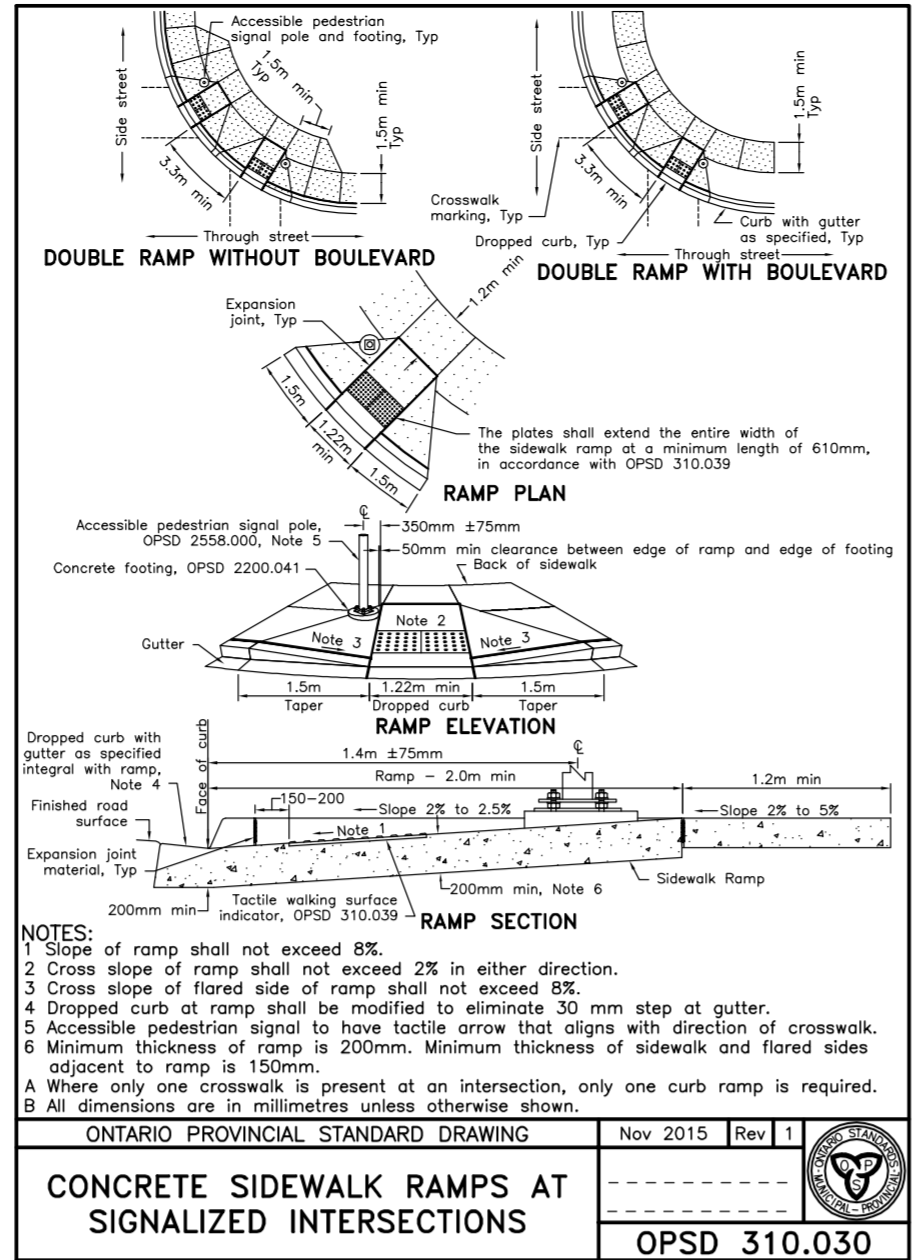
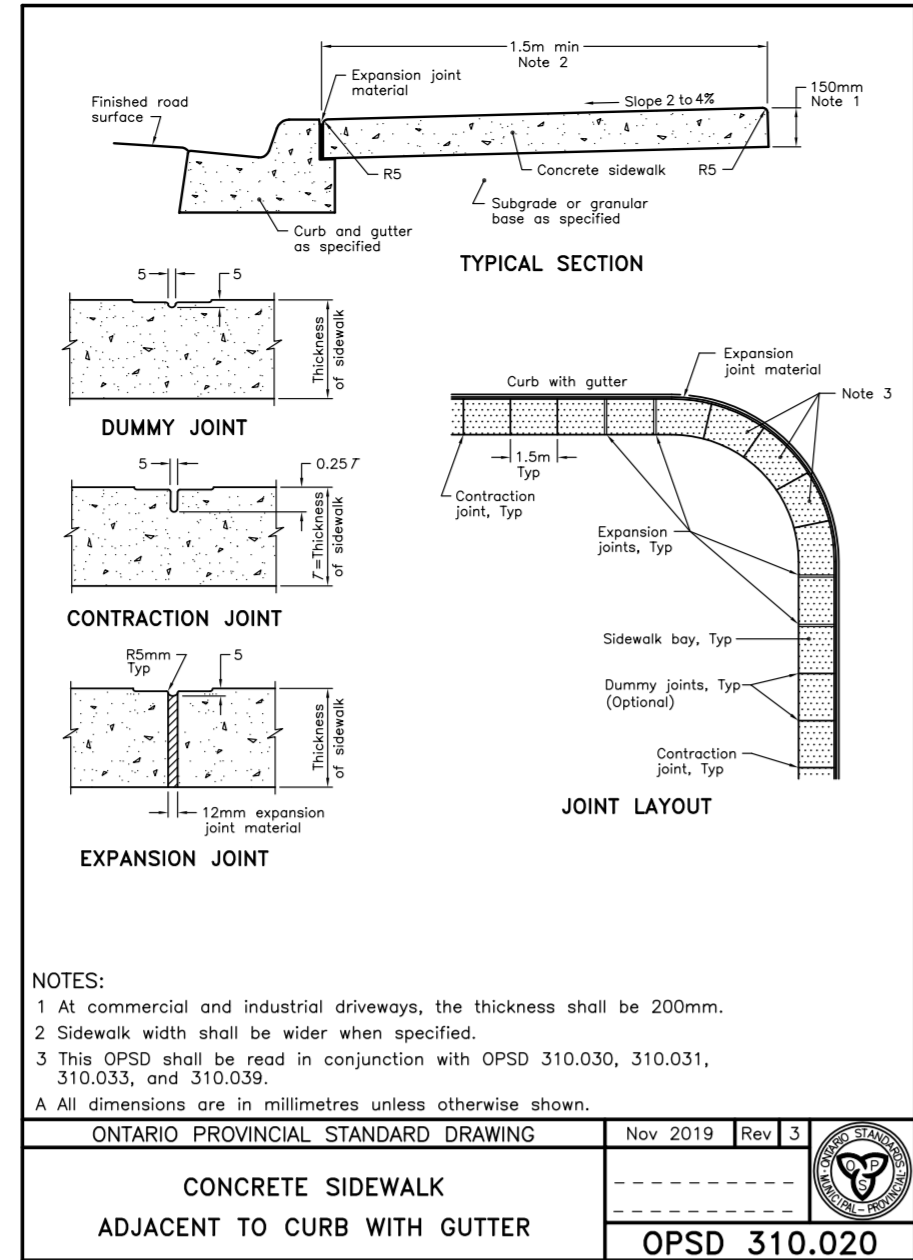
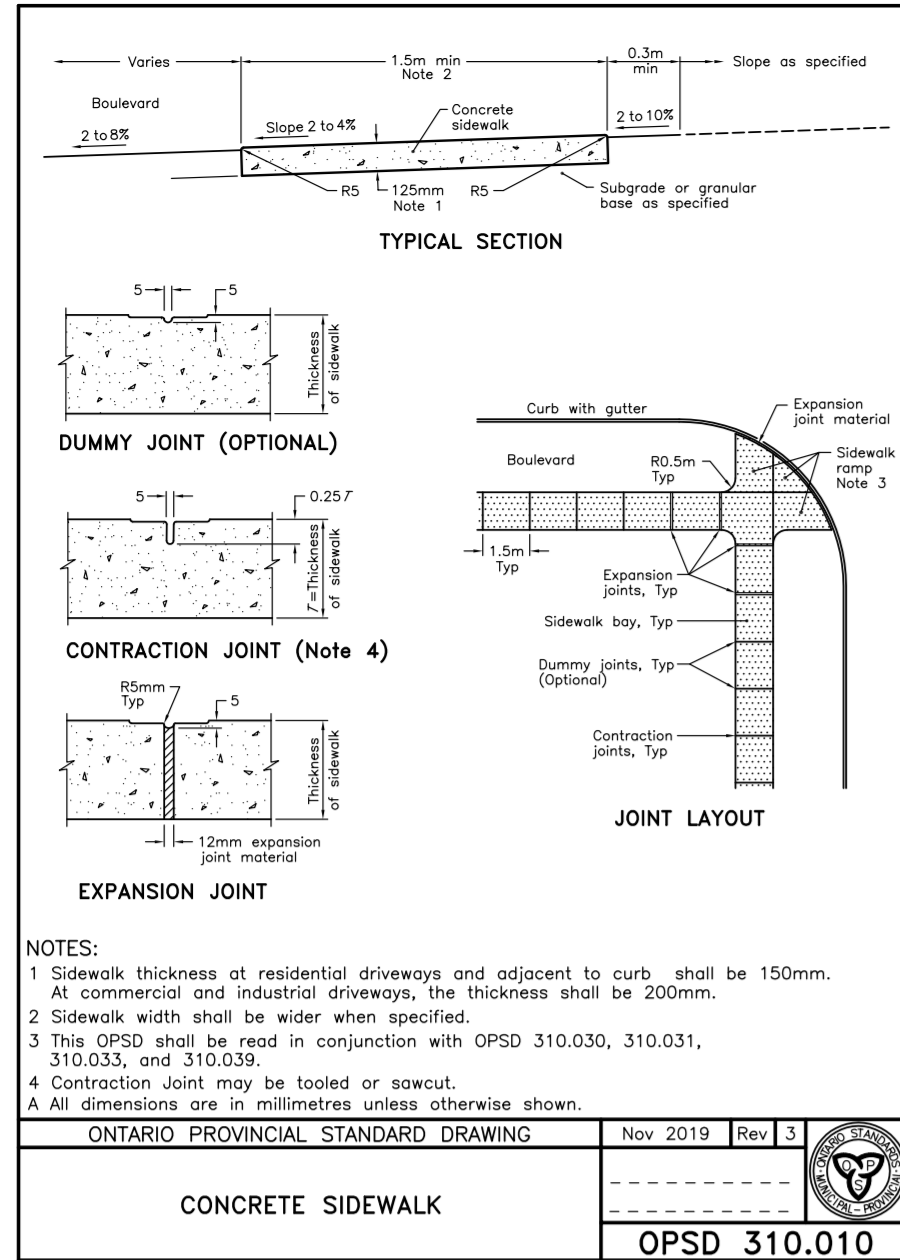

1 CIP Concrete Sidewalk at Boulevard
Scale: NTS

2 CIP Concrete Sidewalk with Curb and Gutter
Scale: NTS

3 CIP Concrete Sidewalk Ramps
Scale: NTS

4 CIP Concrete Sidewalk Ramps w/ Intersecting Crosswalks
Scale: NTS

5 Tactile Walking Surfacing Indicators at Sidewalk Ramp
Scale: NTS

6 CIP Concrete Curb and Gutter
Scale: NTS

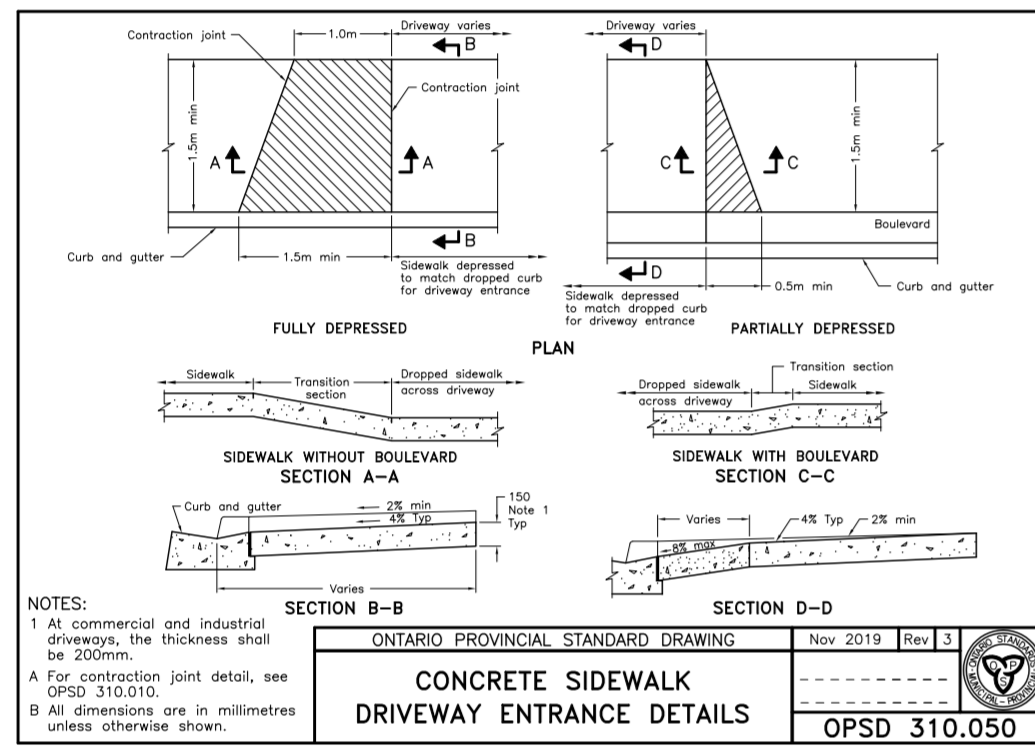

7 CIP Concrete Sidewalk at Driveway Entrance
Scale: NTS

PUBLICITY
 Public City Architecture Inc
 Toronto 16-1636 Dundas Street W, Toronto ON, M6K 1V1
 416 573 1707
 Winnipeg 11-600 Clifton Street, Winnipeg MB, R3G 2X6
 204 475 9323
 publicityarchitecture.com

Owner
 Distrikt Developments
 1-90 Wingold Ave.
 Toronto, Ontario
 M8B 1P5

Distrikt
DISTRIKT

Rev. No.	Date	Revision Notes
01	2023-03-20	ISSUED FOR OPAZBA
02	2023-10-24	ISSUED FOR OPAZBA
03	2024-02-14	ISSUED FOR OPAZBA
04	2024-02-27	ISSUED FOR OPAZBA
05	2024-03-20	ISSUED FOR OPAZBA

NOT FOR CONSTRUCTION

Zoning By-Law Amendment, Official Plan Amendment and Draft Plan of Subdivision
590 Argus Road
 File: Z.1614.81, OPA 1614.81 & 24T-2001/1614

Architect
 Teeple Architects Inc.
 5 Camden Street, Toronto ON
 M5W 1V2

Civil Engineer
 Trafalgar Engineering Limited
 1-481 Morden Road, Oakville ON
 L6K 2W6

Traffic Engineer
 BA Consulting Group Limited
 300-45 St. Clair Avenue West, Toronto ON
 M4V 1K2

Solid Waste Management
 F.J. Burnside & Associates Limited
 1455 Pickering Parkway, Pickering ON
 L1V 7G7

Planning
 Bousfields Inc.
 3 Church Street, Toronto ON
 M5E 1M2

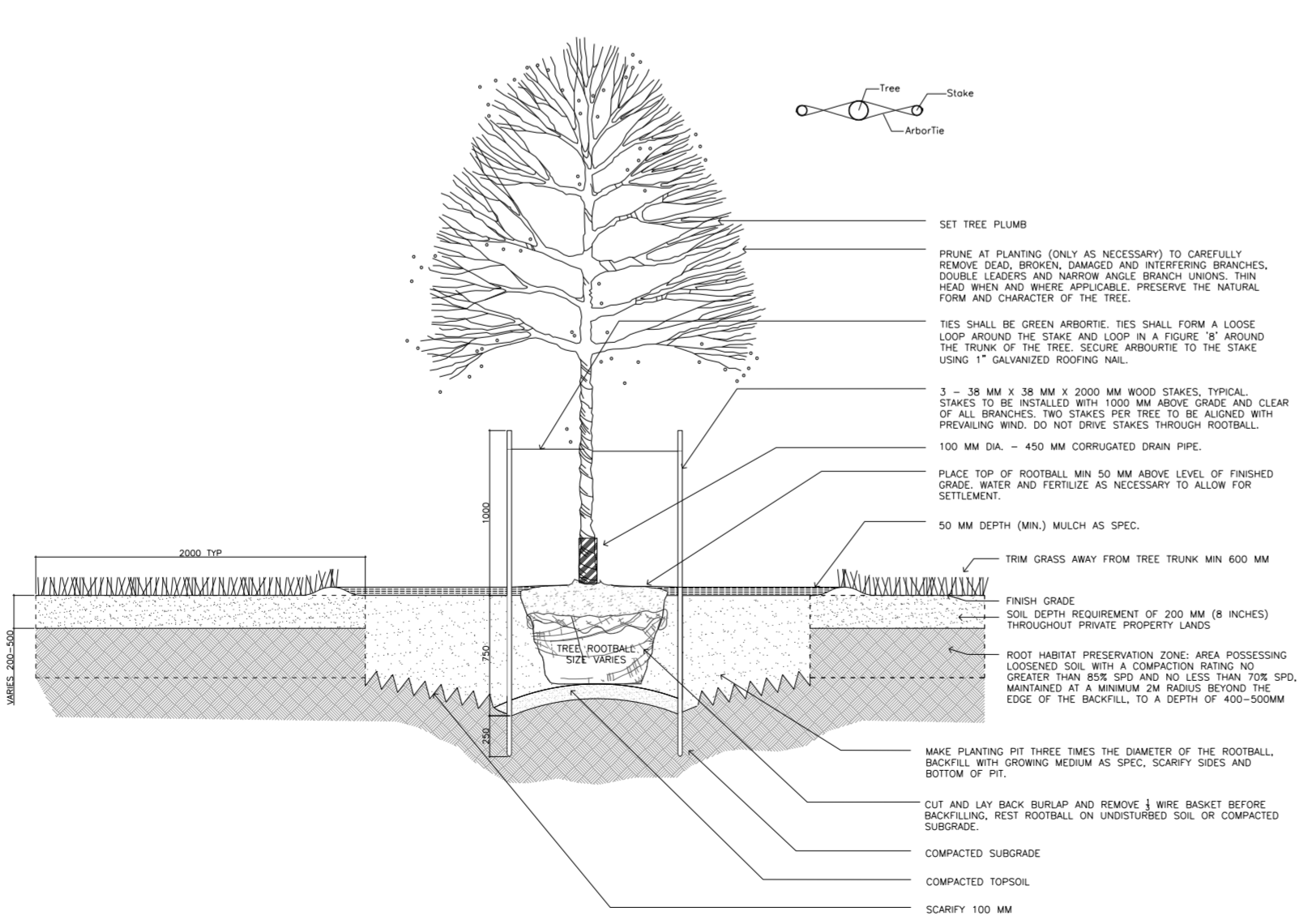

1 TREE PLANTING ON PRIVATE PROPERTY
Scale: NTS

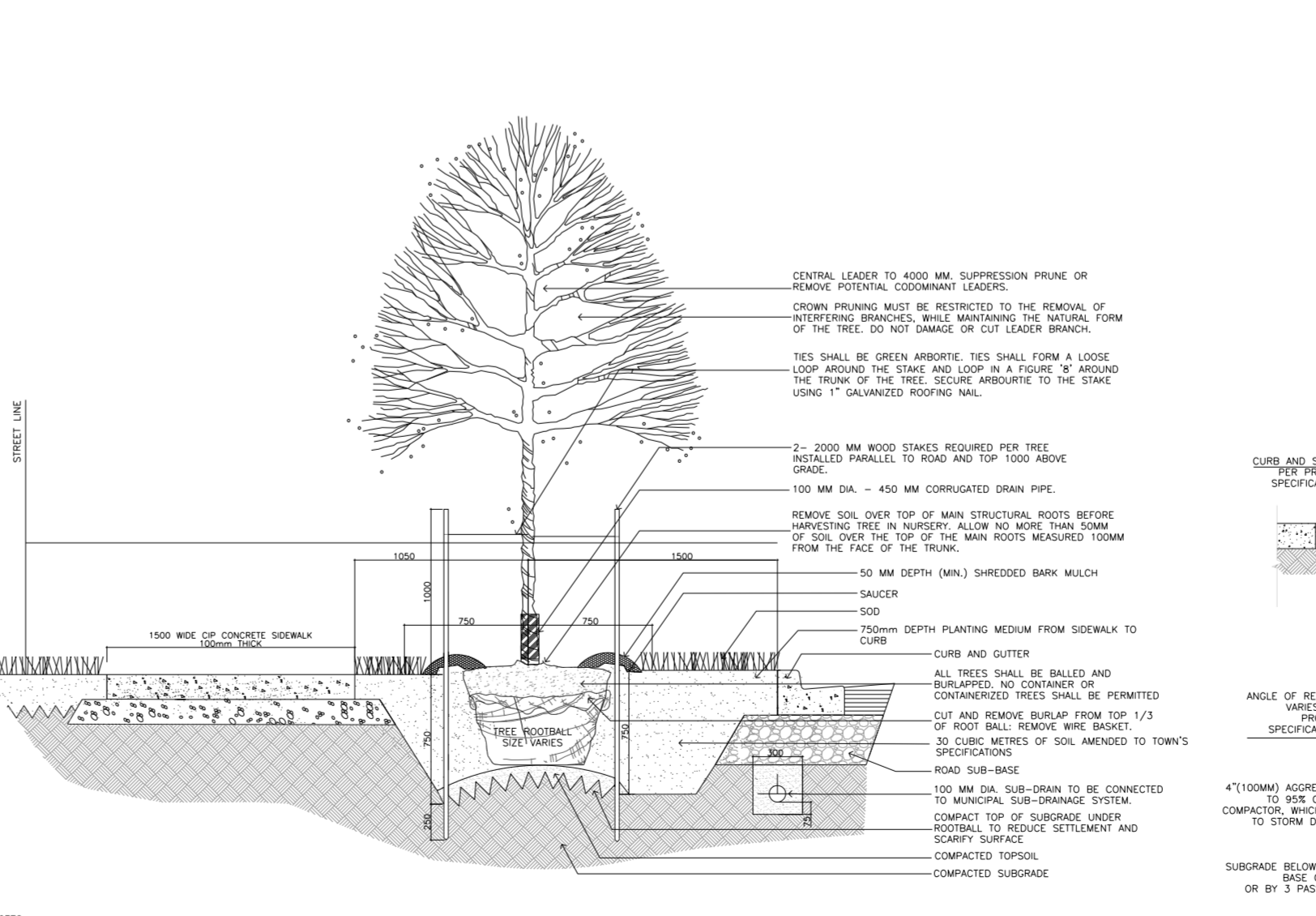

2 2.55m Wide Public Boulevard Tree Planting Detail
Scale: NTS

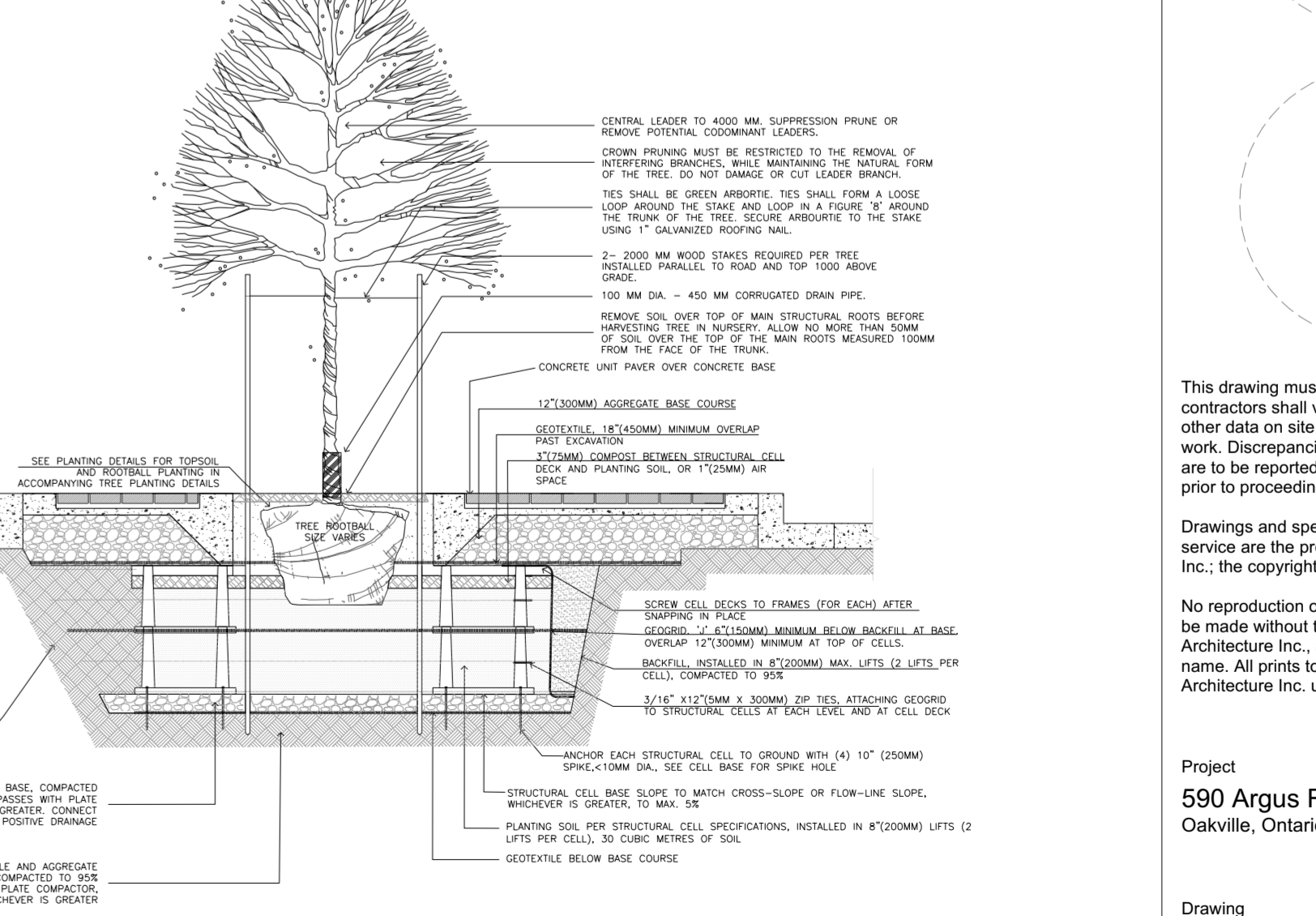

3 Tree Planting in Typical Streetscape, Using Structural Cells
Scale: NTS

This drawing must not be scaled. The contractors shall verify all dimensions and other data on site prior to commencement of work. Discrepancies, errors, and omissions are to be reported to Public City Architecture Inc. prior to proceeding with the Work.

Drawings and specifications as instruments of service are the property of Public City Architecture Inc.; the copyright in the same being reserved.

No reproduction or revision to these drawings may be made without the permission of Public City Architecture Inc. and when made, must bear their name. All prints to be returned to Public City Architecture Inc. upon request.

Project
590 Argus Road Development
 Oakville, Ontario

Drawing
 Town of Oakville Details

Drawn By
 TL
 Scale
 As Noted
 Date
 2024-02-27

Reviewed By
 LW
 Project No.
 Drawing No.
L501



Rev. No.	Date	Revision Notes
01	2023-03-20	ISSUED FOR OPA/ZBA
02	2023-10-24	ISSUED FOR OPA/ZBA
03	2024-02-14	ISSUED FOR OPA/ZBA
04	2024-02-27	ISSUED FOR OPA/ZBA
05	2024-03-20	ISSUED FOR OPA/ZBA

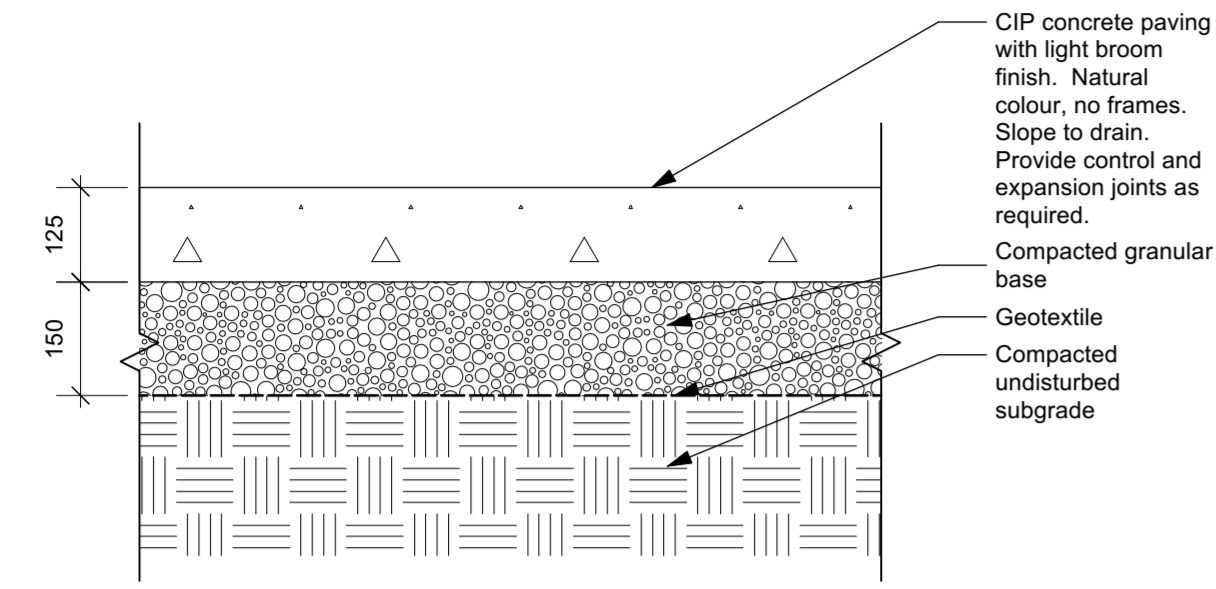

1 Light-duty CIP Concrete Paving on Grade
 Scale: 1:10

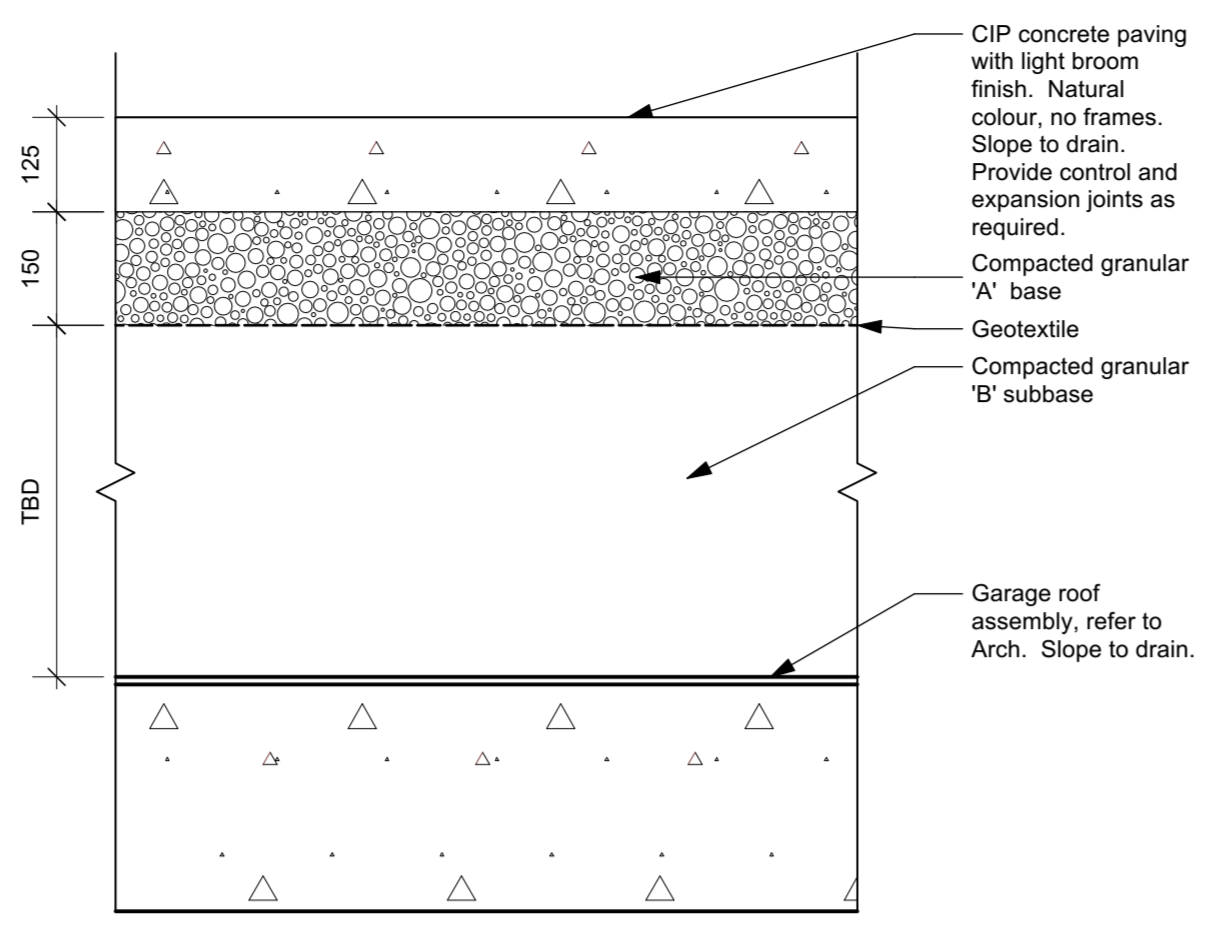

2 Light-duty CIP Concrete Paving on Structure
 Scale: 1:10

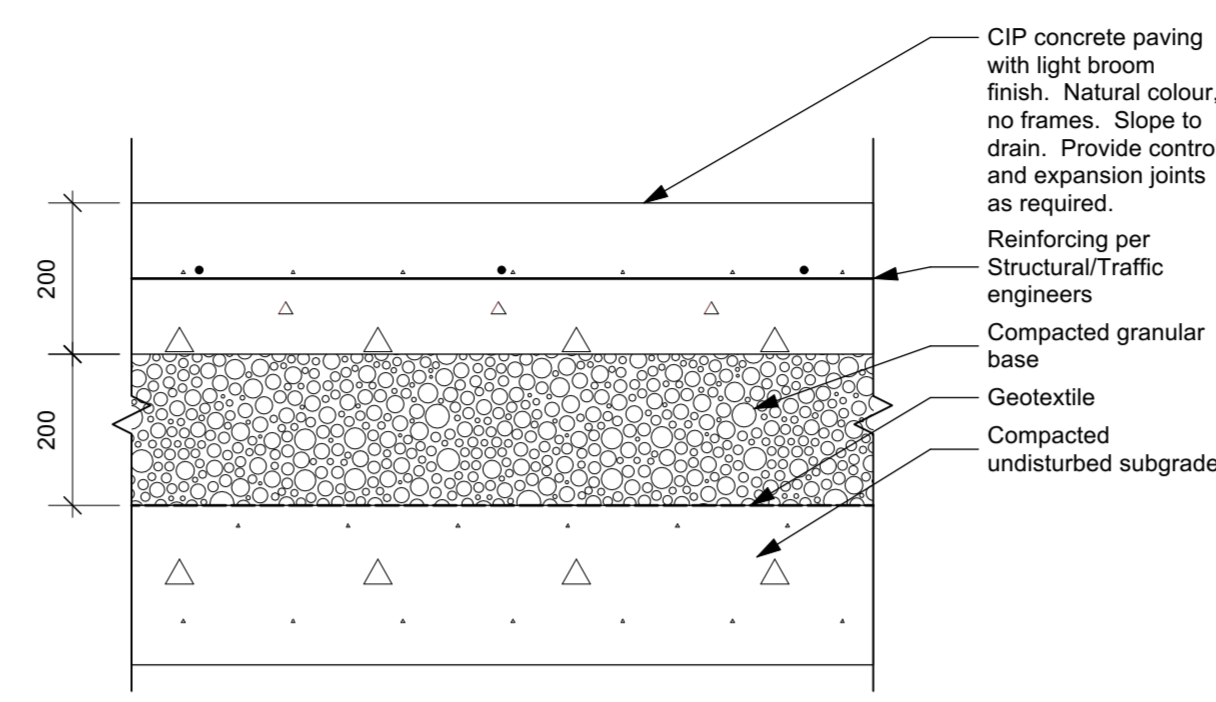

3 Heavy-duty CIP Concrete Paving on Grade
 Scale: 1:10

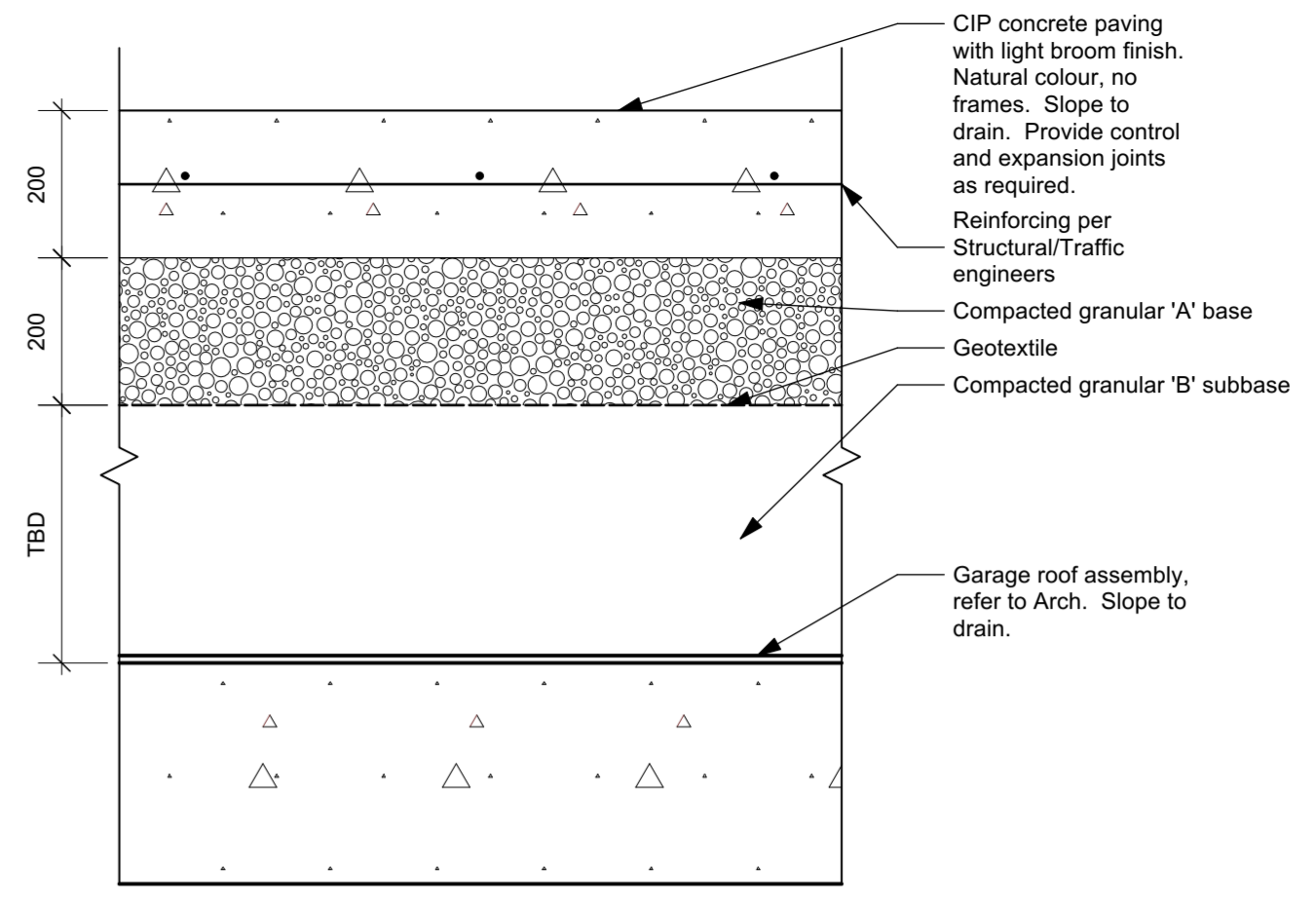

4 Heavy-duty CIP Concrete Paving on Structure
 Scale: 1:10

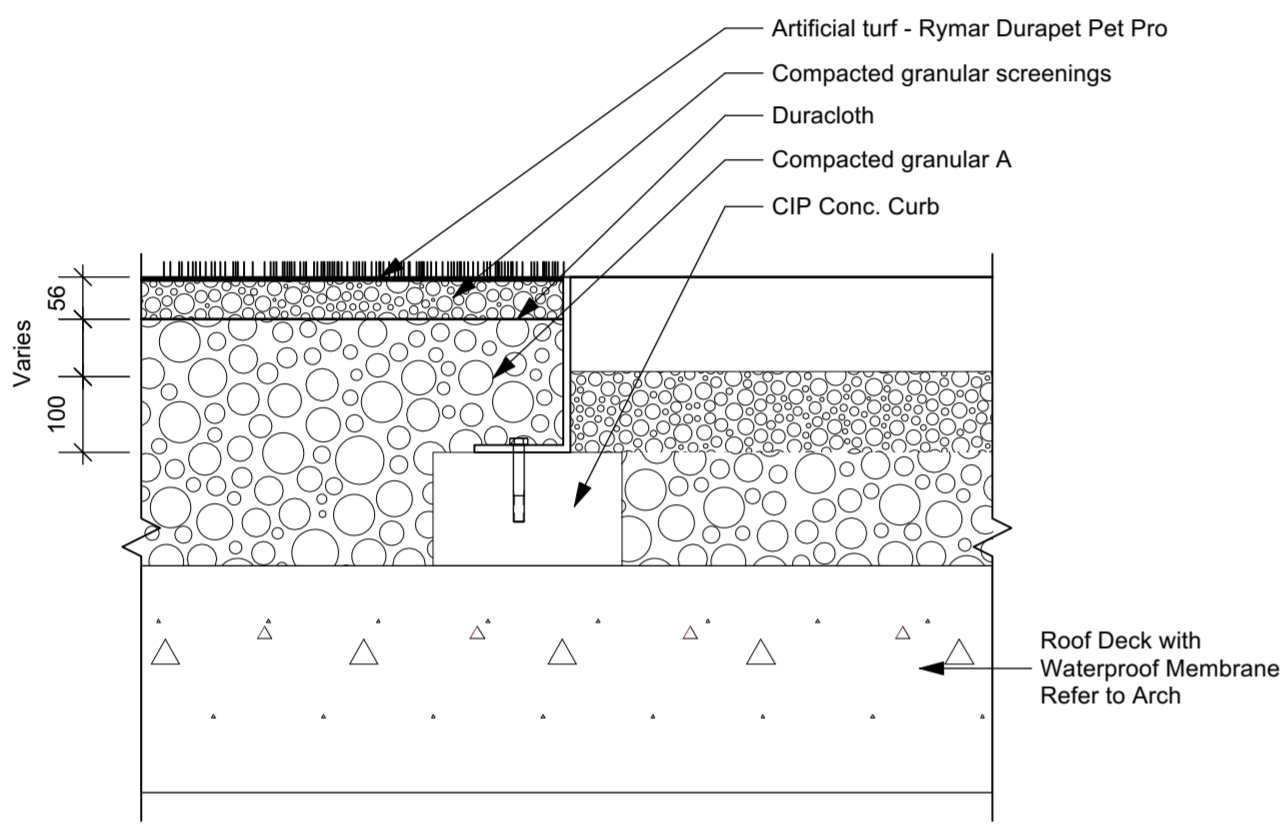

5 Artificial Turf on Roof Deck, typ.
 Scale: 1:10

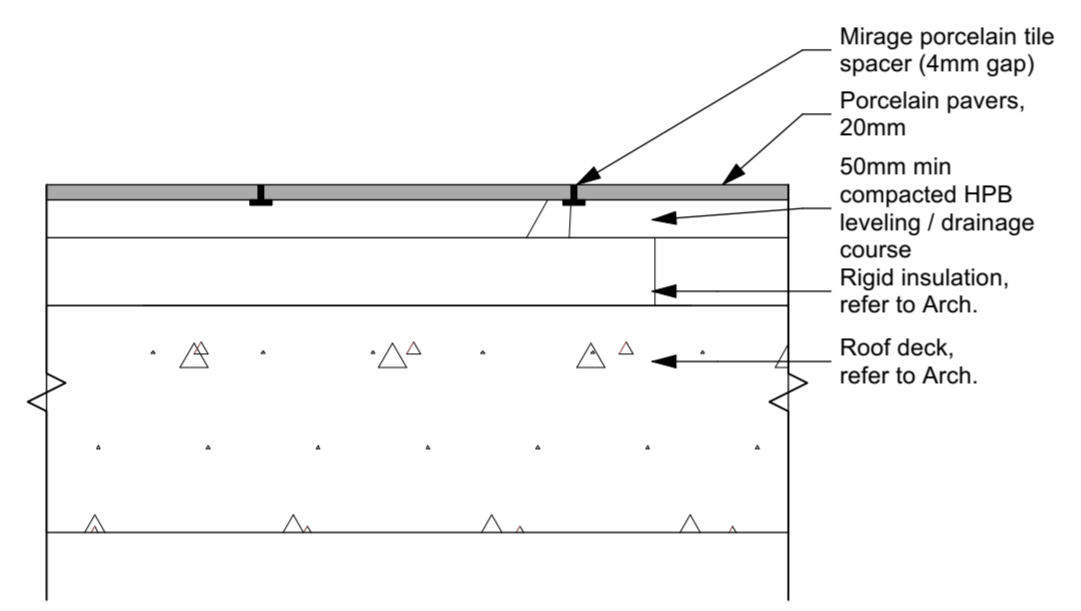

6 Porcelain Paver
 Scale: 1:10

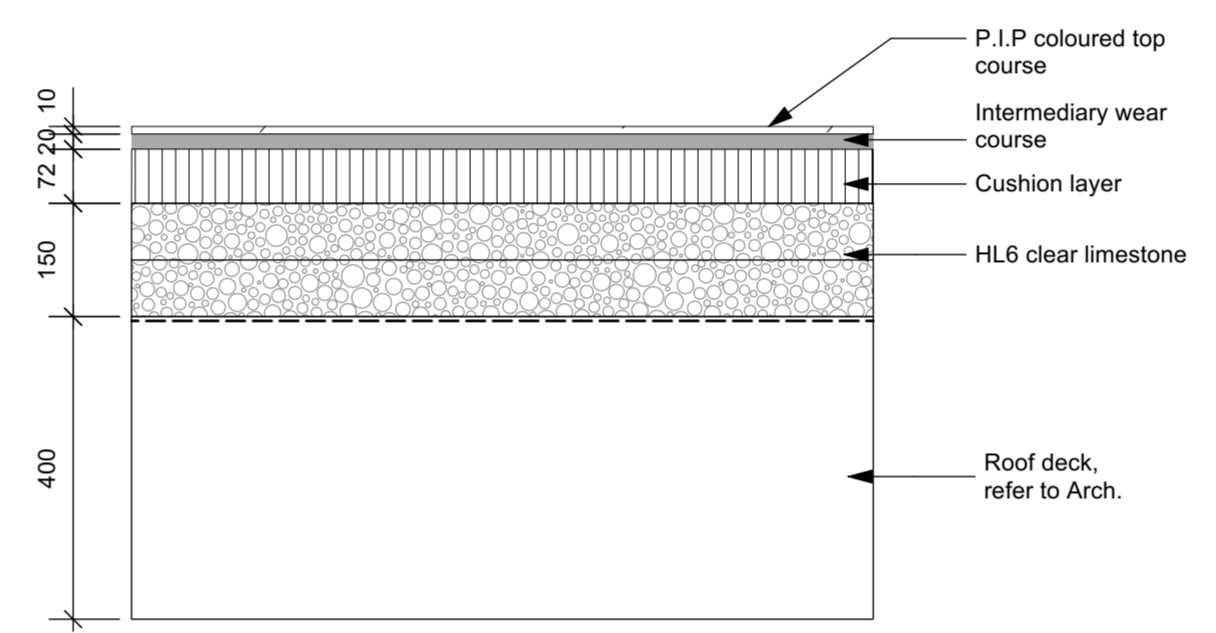

7 Rubber Play Surfacing
 Scale: 1:10

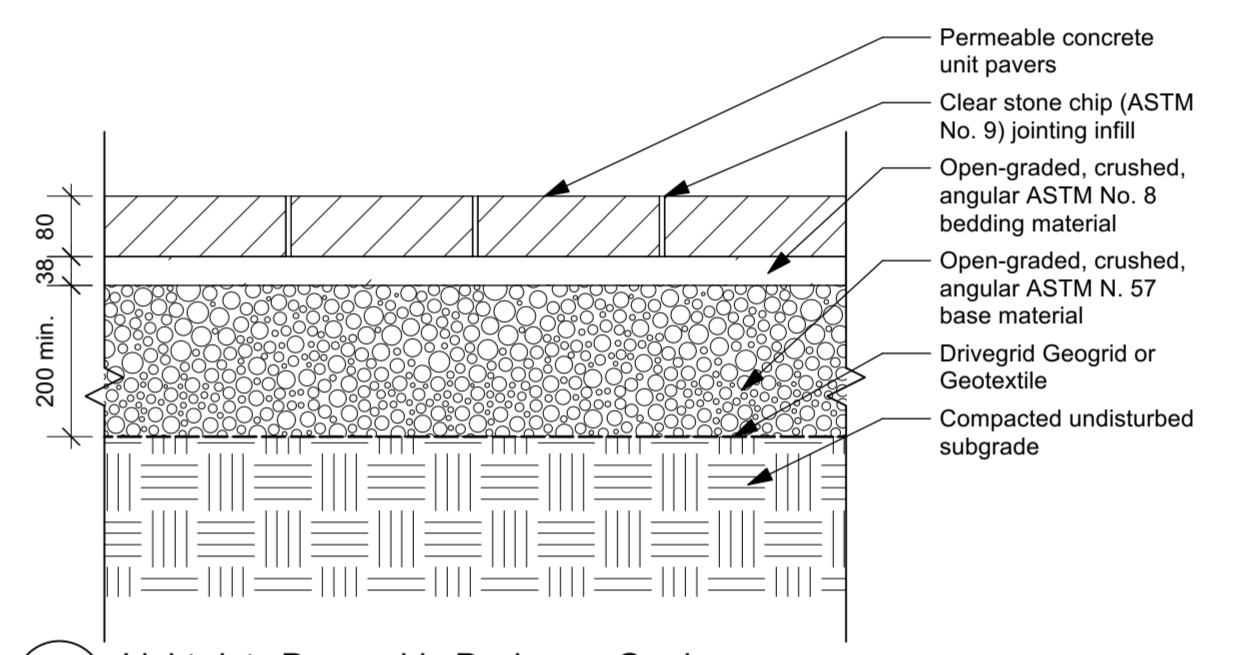

8 Light-duty Permeable Paving on Grade
 Scale: 1:10

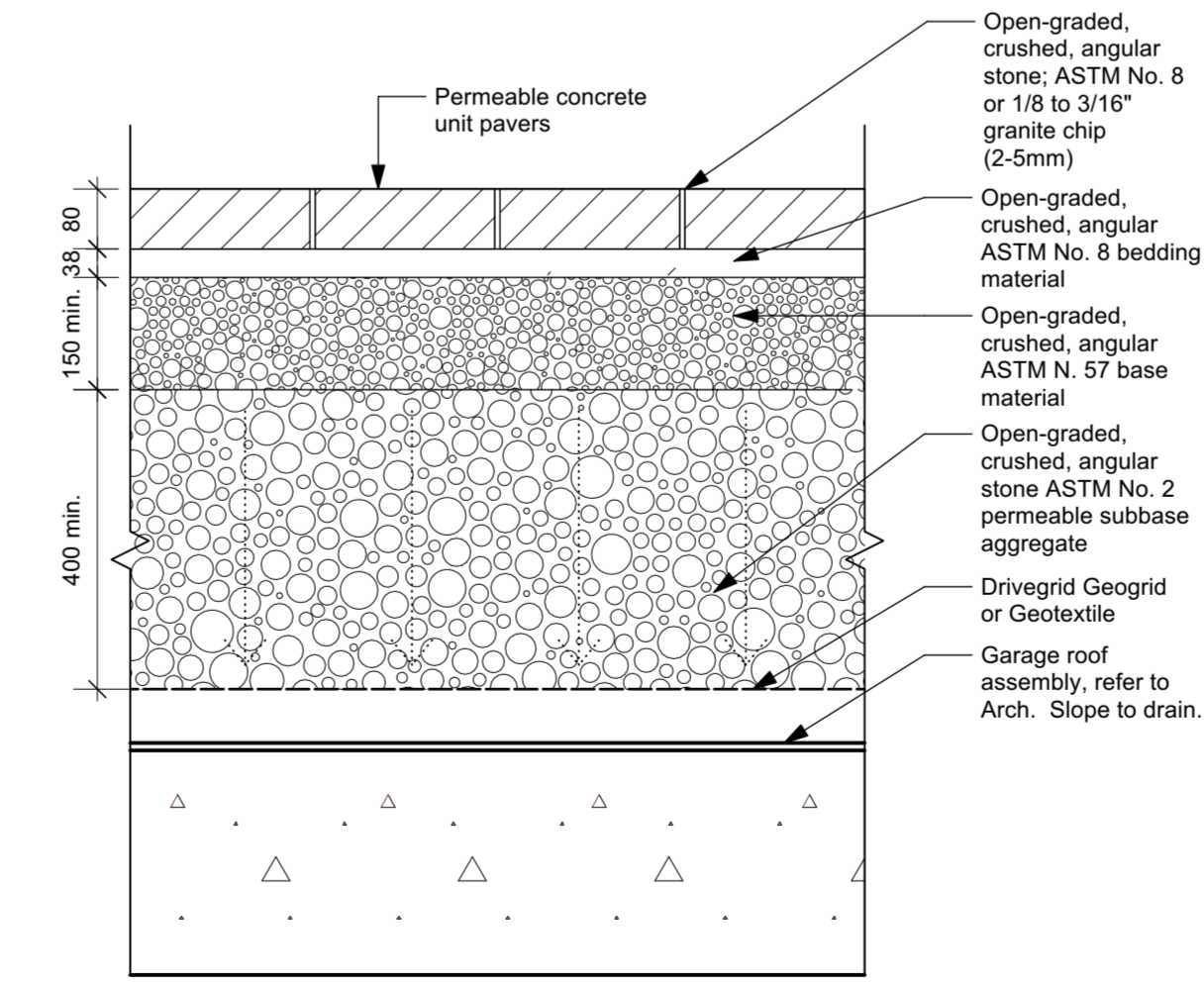

9 Heavy-duty Permeable Paving on Structure
 Scale: 1:10

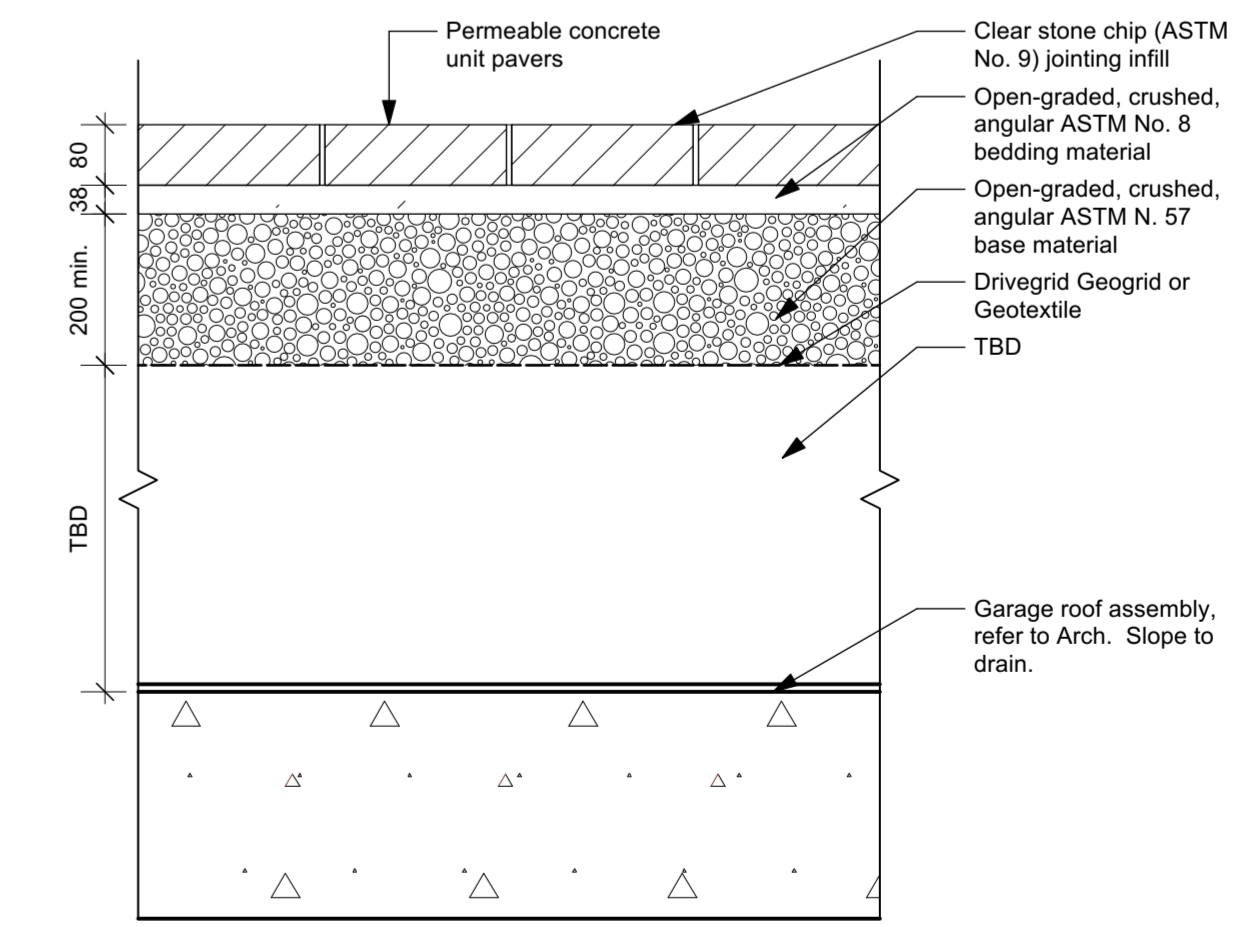

10 Light-duty Permeable Paving on Structure
 Scale: 1:10

NOT FOR CONSTRUCTION

Zoning By-law Amendment, Official Plan Amendment and Draft Plan of Subdivision
590 Argus Road
 File: Z.1614.81, OPA 1614.81 & 24T-23001/1614

Architect
 Teeple Architects Inc.
 5 Carleton Street, Toronto ON
 M4V 1V2

Civil Engineer
 Trafalgar Engineering Limited
 1-481 Morden Road, Oakville ON
 L6K 2W6

Traffic Engineer
 BA Consulting Group Limited
 300-45 St. Clair Avenue West, Toronto ON
 M4V 1K9

Solid Waste Management
 R.J. Burnside & Associates Limited
 1455 Pickering Parkway, Pickering ON
 L1V 7G7

Planning
 Bousfields Inc.
 3 Church Street, Toronto ON
 M5E 1M2

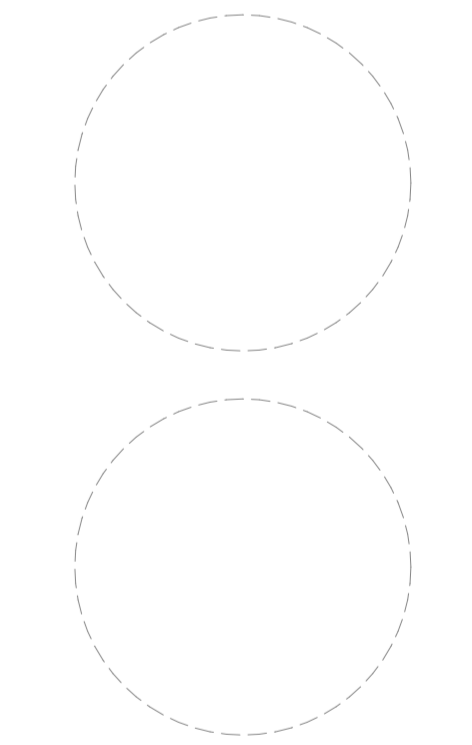

This drawing must not be scaled. The contractors shall verify all dimensions and other data on site prior to commencement of work. Discrepancies, errors, and omissions are to be reported to Public City Architecture Inc. prior to proceeding with the Work.

Drawings and specifications as instruments of service are the property of Public City Architecture Inc.; the copyright in the same being reserved.

No reproduction or revision to these drawings may be made without the permission of Public City Architecture Inc. and when made, must bear their name. All prints to be returned to Public City Architecture Inc. upon request.

Project
590 Argus Road Development
 Oakville, Ontario

Drawing
Landscape Surfacing Details

Drawn By
 TL
 Scale
 As Noted
 Date
 2024-02-27

Reviewed By
 LW
 Project No.
 Drawing No.
L502

Rev. No.	Date	Revision Notes
01	2023-03-20	ISSUED FOR OPA/ZBA
02	2023-10-24	ISSUED FOR OPA/ZBA
03	2024-02-14	ISSUED FOR OPA/ZBA
04	2024-02-27	ISSUED FOR OPA/ZBA
05	2024-03-20	ISSUED FOR OPA/ZBA

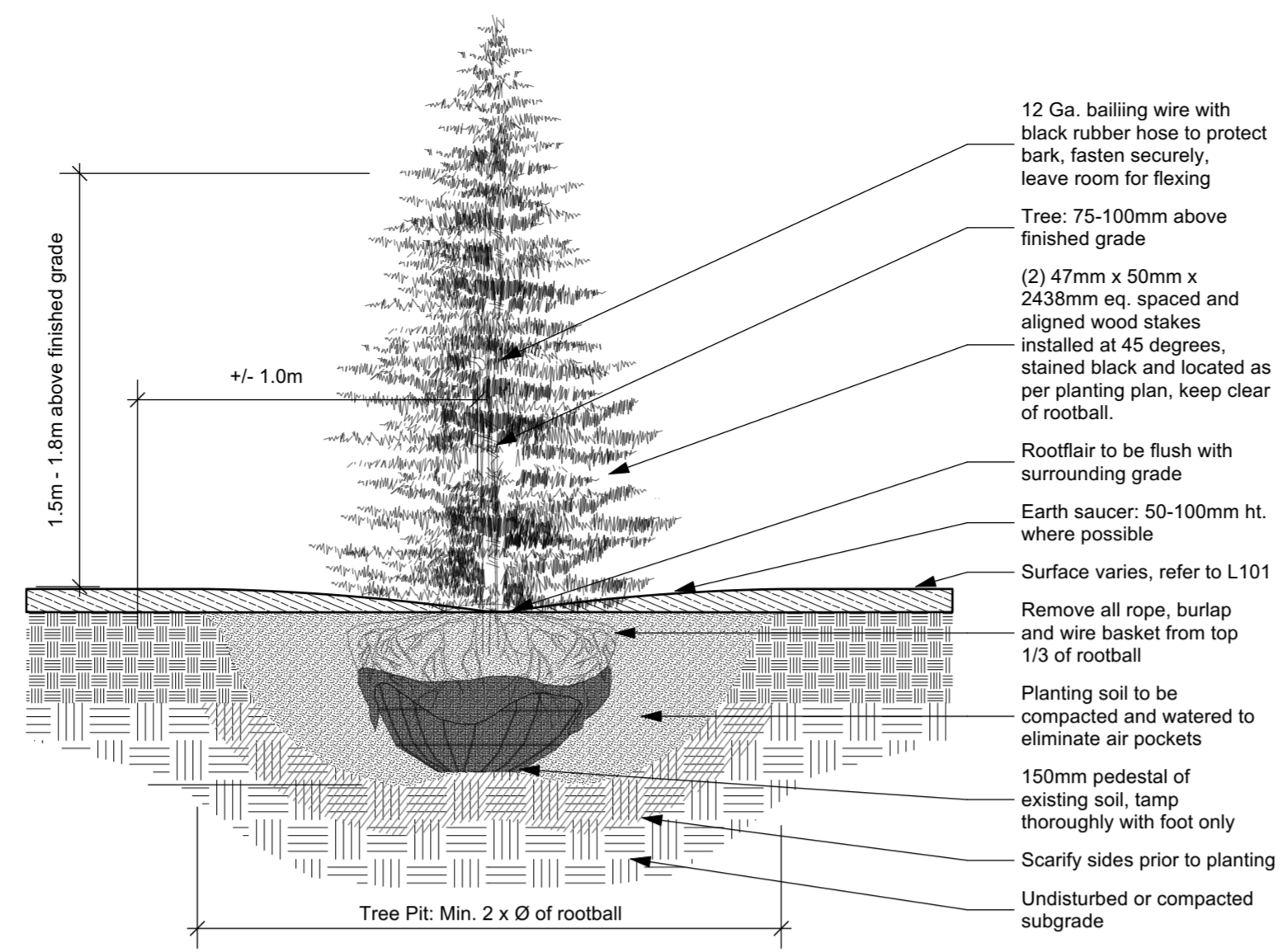

1 **Coniferous Tree Planting**
 Scale: 1:20

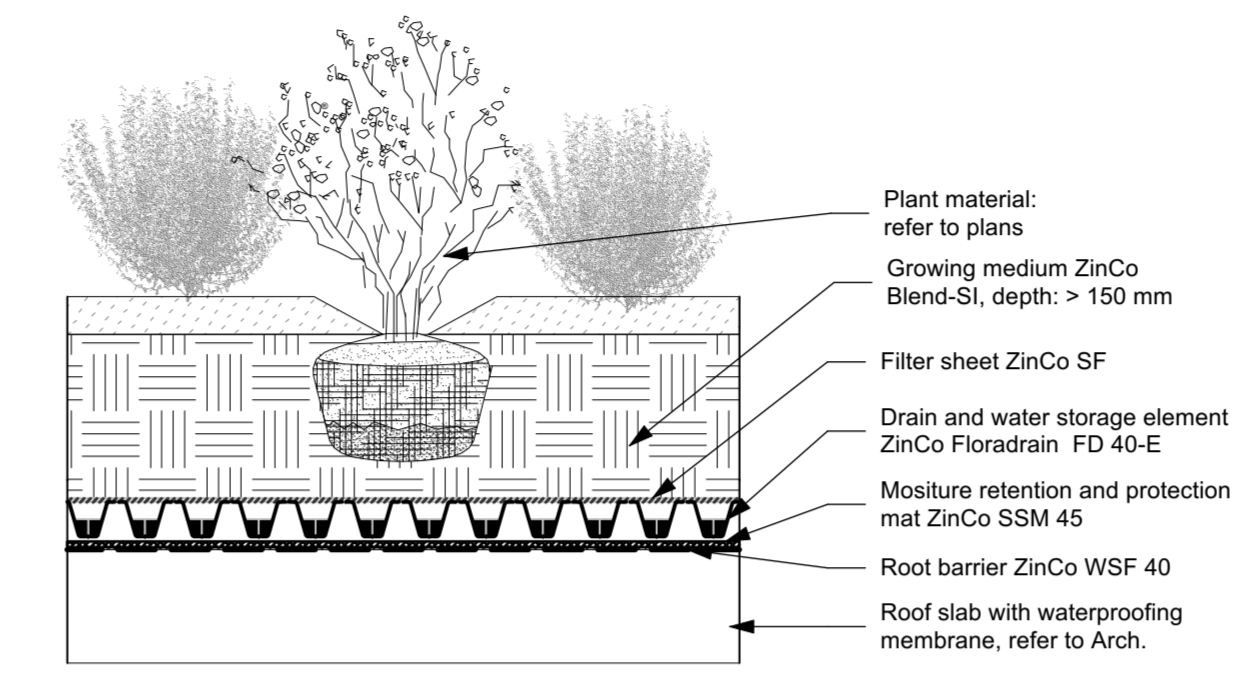

2 **Semi Intensive Green Roof Planting Perennial Garden by Zinco**
 Scale: 1:20

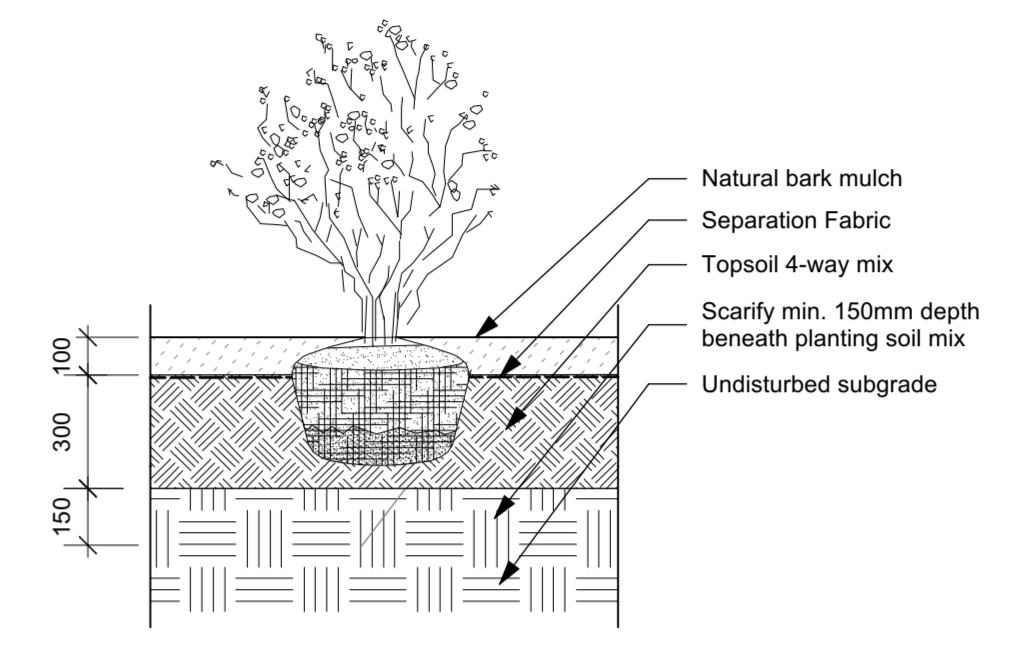

3 **Shrub planting, typ.**
 Scale: 1:20

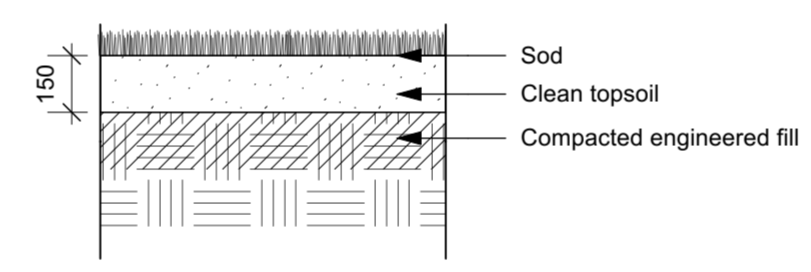

4 **Sod**
 Scale: 1:20

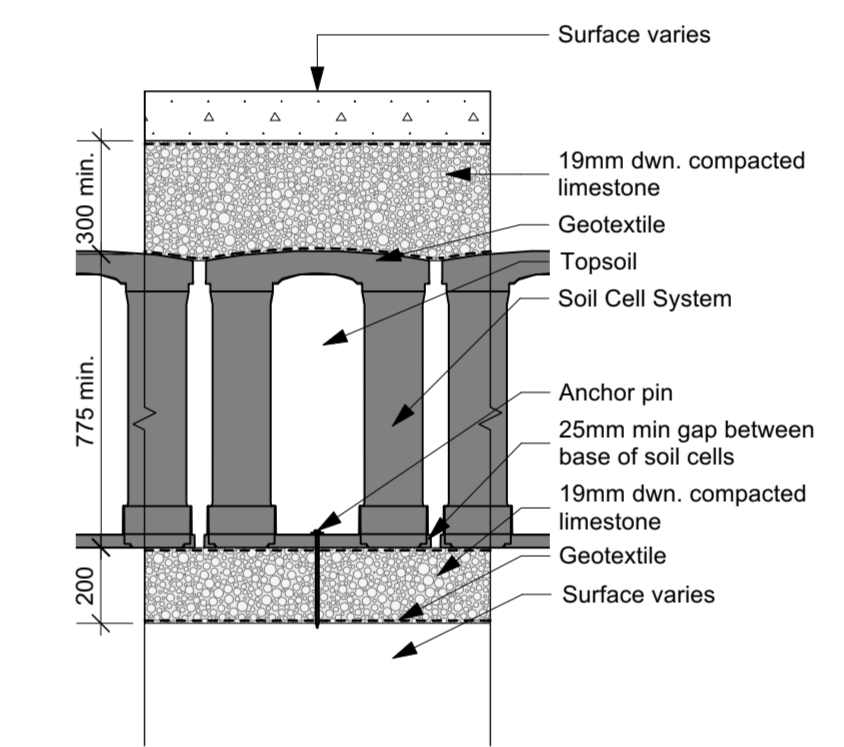

5 **Soil Cell**
 Scale: 1:20

NOT FOR CONSTRUCTION

Zoning By-Law Amendment, Official Plan Amendment and Draft Plan of Subdivision
590 Argus Road
 File: Z.1614.81, OPA 1614.81 & 24T-23001/1614

Architect
 Teeple Architects Inc.
 5 Camden Street, Toronto ON
 M5V 1V2

Civil Engineer
 Trafalgar Engineering Limited
 1-481 Morden Road, Oakville ON
 L6K 2W6

Traffic Engineer
 BA Consulting Group Limited
 300-45 St. Clair Avenue West, Toronto ON
 M4V 1K9

Solid Waste Management
 R.J. Burnside & Associates Limited
 1455 Pickering Parkway, Pickering ON
 L1V 7G7

Planning
 Bousfields Inc.
 3 Church Street, Toronto ON
 M5E 1M2

This drawing must not be scaled. The contractors shall verify all dimensions and other data on site prior to commencement of work. Discrepancies, errors, and omissions are to be reported to Public City Architecture Inc. prior to proceeding with the Work.

Drawings and specifications as instruments of service are the property of Public City Architecture Inc.; the copyright in the same being reserved.

No reproduction or revision to these drawings may be made without the permission of Public City Architecture Inc., and when made, must bear their name. All prints to be returned to Public City Architecture Inc. upon request.

Project
590 Argus Road Development
 Oakville, Ontario

Drawing
Landscape Planting Details

Drawn By
 TL
 Scale
 As Noted

Date
 2024-02-27

Reviewed By
 LW
 Project No.

Drawing No.