

PLAN OF  
PART OF LOT \_\_\_\_\_  
REGISTERED PLAN \_\_\_\_\_  
TOWN OF OAKVILLE  
REGIONAL MUNICIPALITY OF HALTON

GEODETIC BENCHMARK

NO.	ELEVATION	DESCRIPTION

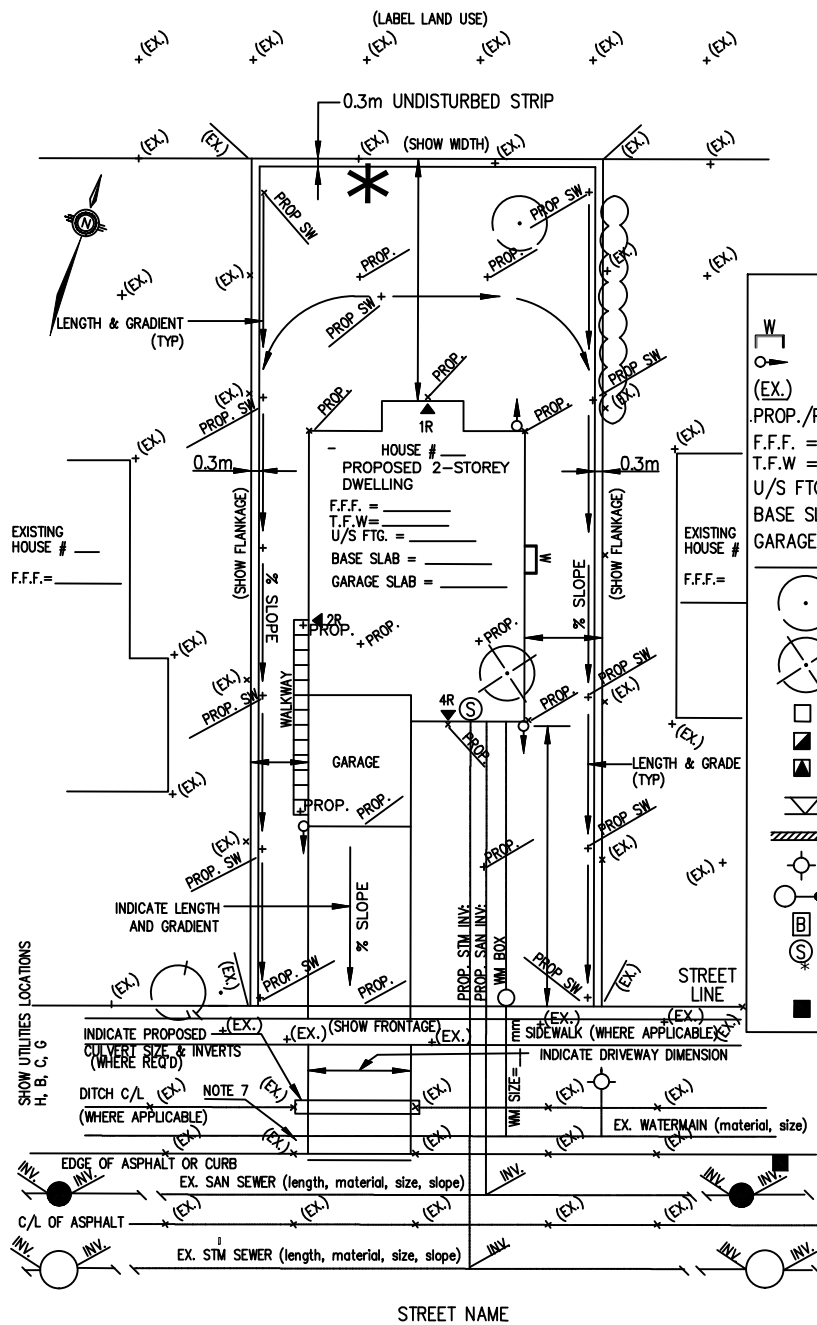

LEGEND

	WINDOW WELL
	RAINWATER LEADER
(EX.)	EXISTING ELEVATION REQ'D
PROP./PROP SW	PROPOSED ELEVATION REQ'D
F.F.F. =	FINISHED FIRST FLOOR ELEVATION REQ'D
T.F.W. =	TOP OF FOUNDATION WALL
U/S FTG. =	UNDERSIDE OF FOOTING ELEVATION REQ'D
BASE SLAB =	BASEMENT SLAB ELEVATION REQ'D
GARAGE SLAB =	GARAGE SLAB ELEVATION REQ'D
C/L OF PROPOSED SWALE	C/L OF PROPOSED SWALE
	EXISTING TREE TO BE PRESERVED
	EXISTING TREE TO BE REMOVED
	REAR LOT CATCH BASIN
	TELECOMMUNICATION PEDESTRAL
	HYDRO TRANSFORMER
	WATERPROOFING AND DAMP-PROOFING
	RETAINING WALL C/W TOP/BOTTOM EL.
	FIRE HYDRANT
	STREET LIGHT
	BELL PEDESTAL
	SUMP PUMP, IF REQ'D
	ENGINEERED FILL
	CATCH BASIN

NOTES:

1. Refer to Town of Oakville Development Engineering Procedure and Guidelines.
2. Refer to Town of Oakville Grading and Servicing Plan Guide for Residential Infill Developments.
3. Include Std. Dwg. 1D - Swale Cross-Section Detail and 1E - Acceptable Sump Pump Details of the Grading and Servicing Plan Guide, where applicable.

As per OBC 9.14.6.1.(1),  
I, \_\_\_\_\_ (name), certify that the  
proposed building will be located and the  
site grading has been designed so that it  
will not adversely affect adjacent properties.

Signature \_\_\_\_\_ Date \_\_\_\_\_

Standard Drawing Name <b>SCHEMATIC LOT GRADING AND SERVICING PLAN FOR RESIDENTIAL INFILL</b>	Revision: 0	Revision Date: MAR 2023
	Scale: NTS	Std. Dwg. Number: 1A

