

| Bronte Green Street Tree Canopy Cover Calculation (Residential) |              |  |                                 |
|---|--------------|--|---------------------------------|
| (using NOUSMIP crown area parameters) <sup>1</sup>              |              |  |                                 |
|   | No. of Trees | Crown Area/Tree <sup>1</sup><br>(m <sup>2</sup> /tree) | Total Area<br>(m <sup>2</sup> ) |
| <b>Large Stature Trees (14m crown)</b>                          | 222          | 154  | 34188                           |
|   |              | Subtotal m <sup>2</sup>                                | 34188                           |
| <b>Medium Stature Trees (10-13m crown)</b>                      | 801          | 78.5   | 62878.5                         |
|   |              | Subtotal m <sup>2</sup>                                | 62878.5                         |
| <b>Small Stature Trees (3-9m crown)</b>                         | 0            | 7  | 0                               |
|   |              | Subtotal m <sup>2</sup>                                | 0                               |
|   | 1023         | Total m <sup>2</sup>                                   | 97066.5                         |
|   |              | Canopy overlap m <sup>2</sup>                          | 240                             |
|   |              | Grandtotal m <sup>2</sup>                              | 96,827                          |
| (using NOUSMIP crown area parameters) <sup>1</sup>              |              |  |                                 |
|   |              | equivalent to approx. 9,6827ha                         |                                 |
|   |              | Residential Area = 41.5ha (415010m <sup>2</sup> )      |                                 |
|   |              | Subdivision Canopy Cover = approx. 23.33%              |                                 |
|   |              | Land use Canopy Cover Target 20%                       |                                 |

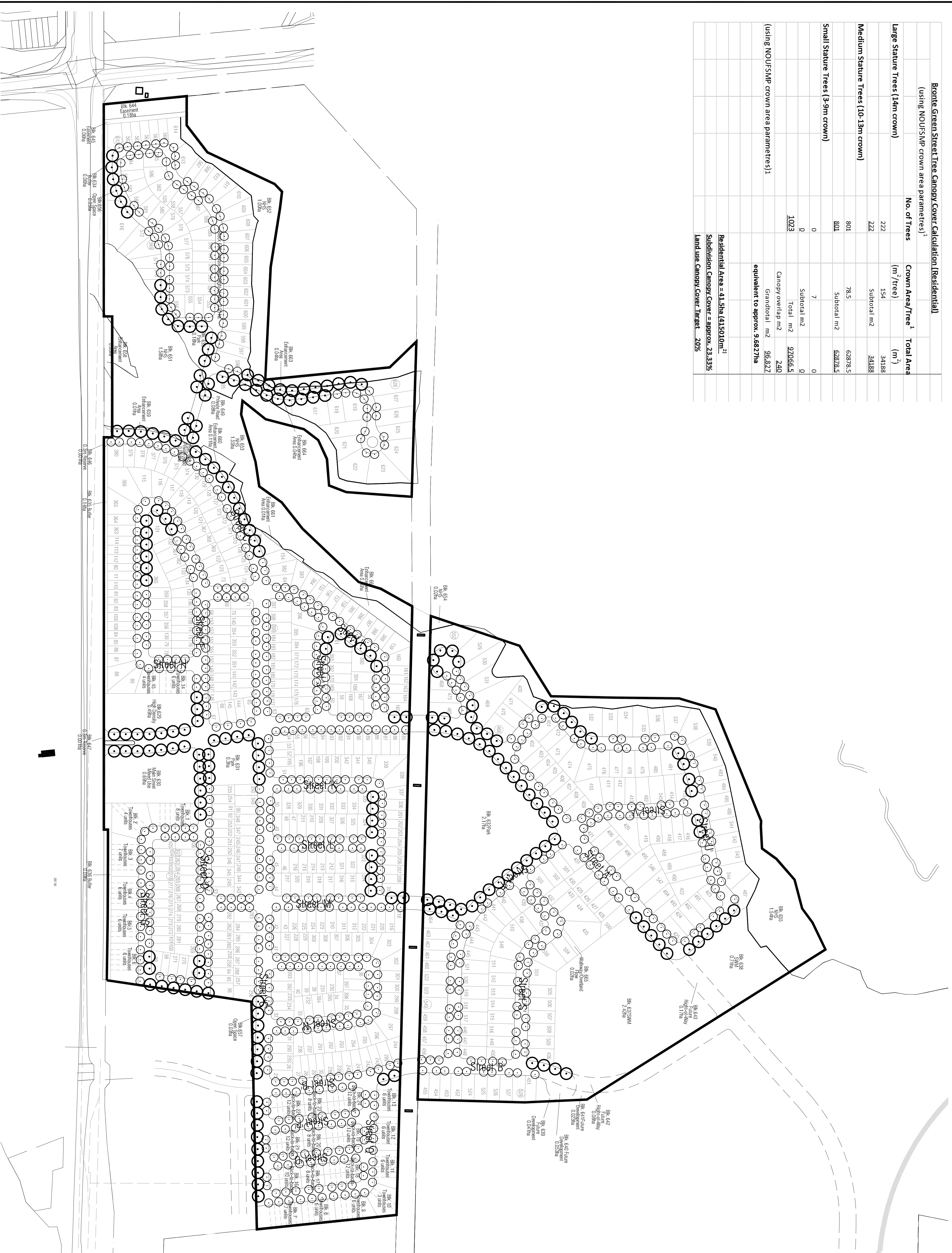

- Notes:
1. Proposed tree locations are schematic. Final locations to be determined in coordination with driveway and CUP information when available.
  2. Soil volumes to be calculated, when tree locations are finalized (excluding NHS). A Tree Preservation Plan will be prepared when proposed grading plans are complete.
  3. Canopy calculations for parkland, SMM and Commercial lands to be determined at detail design stage.
  4. Canopy calculations for parkland, SMM and Commercial lands to be determined at detail design stage.

- Proposed large canopy tree (14m diameter circle)
- 14m, 14m spacing
- Proposed medium canopy tree (10m diameter circle)
- 10m, 10m spacing

|          |             |            |
|----------|-------------|------------|
| Drawn    | Scale       | Dwg File   |
| Checked  | Date        | 2344-FF    |
| Approved | Project No. | 2344       |
|          |             | <b>CC1</b> |

**Client**  
BRONTE GREEN CORPORATION  
TOWN OF OAKVILLE

**CONCEPTUAL CANOPY COVER PLAN FOR RESIDENTIAL LAND USE**

**COSBURN LANDSCAPE GIBBERSON ARCHITECTS**

30 Centuria Drive, Suite 210, Markham, Ontario L3R 9S8  
Telephone: 905-975-9888 Fax: 905-975-9920 info@cgla.ca

All drawings are the property of the consultant and may not be used or reproduced without permission. The contractor shall check and verify all dimensions on site. This drawing must not be scaled.

Approved by: \_\_\_\_\_ Date: \_\_\_\_\_

This drawing is not to be used for construction unless signed by the Landscape Architect.

Revisions

| No. | By | Date |
|-----|----|------|
|     |    |      |
|     |    |      |
|     |    |      |