

SOVEREIGN STREET

ST. ANNS COURT

EAST STREET

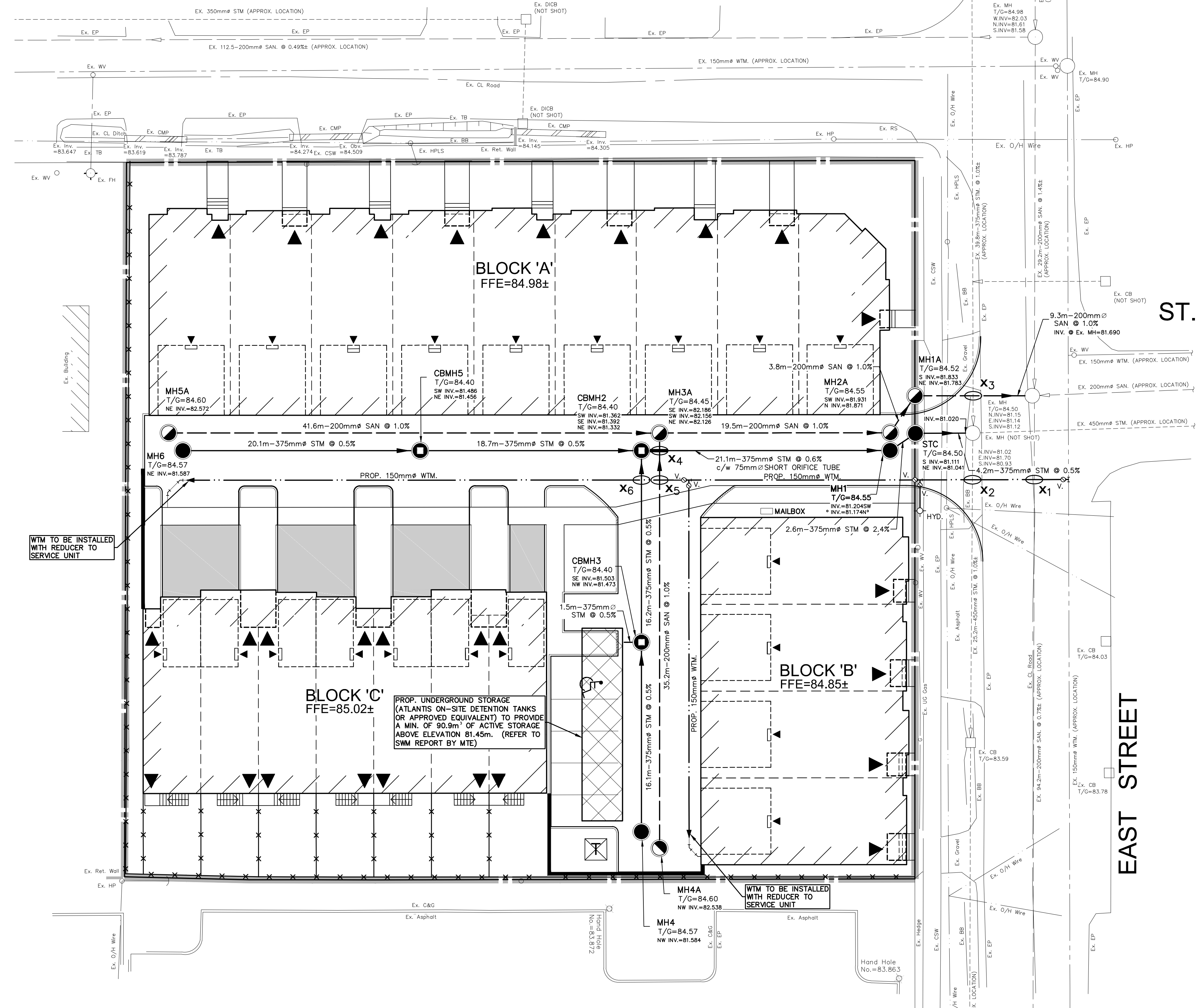

LEGEND OF EXISTING FEATURES

- SITE BOUNDARY
- EX. 300mm \varnothing SAN
- EX. 200mm \varnothing WTM
- EX. 375mm \varnothing STM
- EXISTING BUILDING
- EXISTING FENCE
- EXISTING RETAINING WALL
- EXISTING EMBANKMENT (SLOPE AS NOTED)
- EXISTING MAN DOOR

SEWER CROSSING CHART

NOTE:
 1) Maintain minimum 0.5m vertical clearance when watermains are below any sewers; minimum 0.15m when they are above any sewers. Where watermain is deflected, ensure 1.7m cover is achieved or watermain is insulated.
 2) Maintain vertical clearance at all other crossings.
 3) Existing and proposed watermain depths are approximate only. Notify Design Engineer of any discrepancies.
 4) Contractor to verify all existing inverts prior to product ordering. Notify Design Engineer of any discrepancies.

CROSSING #	SEWER TYPE	SEWER SIZE (mm \varnothing)	CROSSING ELEVATION
X1	EX. SAN	200mm \varnothing	OBV=81.27±
	WTM	150mm \varnothing	INV=82.56
X2	EX. STM	450mm \varnothing	OBV=81.34±
	WTM	150mm \varnothing	INV=82.45
X3	SAN	200mm \varnothing	INV=82.73
	EX. STM	375mm \varnothing	OBV=81.43±
X4	SAN	200mm \varnothing	INV=82.19
	STM	375mm \varnothing	OBV=81.70
X5	SAN	200mm \varnothing	OBV=82.40
	WTM	150mm \varnothing	INV=82.65
X6	STM	375mm \varnothing	OBV=82.31
	WTM	150mm \varnothing	INV=82.65

LEGEND OF PROPOSED FEATURES

- 14.6m-200mm \varnothing SAN @ 1.5%
- 21.3m-300mm \varnothing STM @ 1.3%
- 200mm \varnothing WTM
- PROPOSED BUILDING
- MAN DOOR
- (PROP. CURB) CONC. CURB & GUTTER
- SEWER CROSSING (REFER TO CROSSING CHART)
- ASPHALT DRIVEWAY
- PROP. GARAGE

WTM TO BE INSTALLED WITH REDUCER TO SERVICE UNIT

PROP. UNDERGROUND STORAGE (ATLANTIS ON-SITE DETENTION TANKS OR APPROVED EQUIVALENT) TO PROVIDE A MIN. OF 90.9m³ OF ACTIVE STORAGE ABOVE ELEVATION 81.45m. (REFER TO SWM REPORT BY MTE)

WTM TO BE INSTALLED WITH REDUCER TO SERVICE UNIT

PRELIMINARY SITE SERVICING PLAN

PROJECT NAME: SOVEREIGN STREET TOWNHOUSES

LOCATION: 2286 - 2298 SOVEREIGN STREET

CLIENT: WYATT DEVELOPMENT GROUP

SCALE: 1:200 MTE PROJECT NO.: 41641-200 DATE: Dec.13/16 FIGURE NO.: **C2.2**