

BLOCK 384

LOCKERS LEGEND		PARKING LEGEND			
HORIZONTAL BIKE LOCKER		residential	visitor	barrier free type A	barrier free type B
VERTICAL BIKE LOCKER					
HORIZONTAL STACKED BIKE LOCKER		7M DRIVEWAY			
STORAGE LOCKER					
CONVEX MIRROR (C.M.)					

This drawing is an instrument of service, is provided by and is the property of Graziani & Corazza Architects Inc. The contractor must verify and accept responsibility for all dimensions and conditions on site and must notify Graziani & Corazza Architects Inc. of any variations from the supplied information. Graziani & Corazza Architects Inc. is not responsible for the accuracy of survey, staking, marking, electrical, etc., engineering information shown on this drawing. Refer to the appropriate engineering drawings showing property lines and easements. Contractors must confirm all applicable codes and requirements of the applicable building standards. Upon execution of any construction, any variation or change to the existing electronic system shall be the contractor's responsibility.

Conditions for electronic information transfer  
 Electronic information is supplied to the other specified firms to assist them in the creation of their own drawings. The recipient firm must obtain the complete responsibility/liability of the information to their particular responsibility.

Graziani & Corazza Architects Inc. shall not be responsible for:  
 1. Errors, omissions, omissions due to loss of information in whole or part.  
 2. Information in any way or change to the existing electronic system shall be the contractor's responsibility.

1. NOV.02.2022 ISSUED FOR SPA 4.01

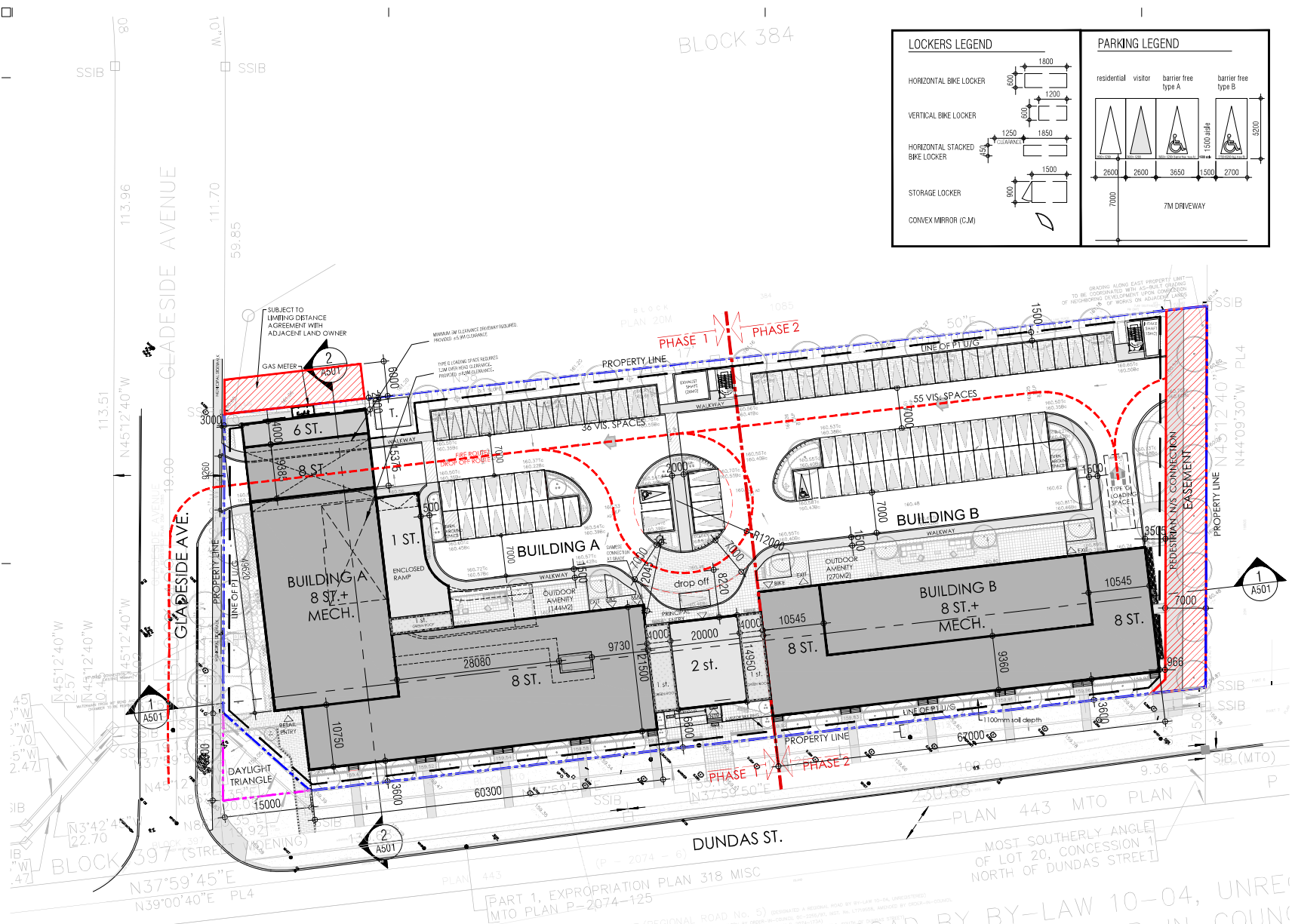

Issued for revisions

**GRAZIANI CORAZZA ARCHITECTS INC.**  
 JOHNNY GIAMETTI  
 2295

PROPOSED DEVELOPER

**DUNDAS & NEYAGAWA**

AVAILABLE	ON/PAID
Project Architect:	J. Chirrielli
Assistant Designer:	A. Hassan
Drawn By:	J. Chirrielli
Checked By:	D. Bice
Plot Date:	NOV.02.2022
Job #:	1944.21

**SITE PLAN**

1:300 A101

TITLEBLOCK SIZE: 610 x 90

DUNDAS STREET (REGIONAL ROAD No. 5) (DESIGNATED A REGIONAL ROAD BY BY-LAW 10-04, UNRECORDED, AND A REGIONAL ROAD BY ORDER-IN-COUNCIL OF THE REGIONAL MUNICIPALITY OF HALTON BY ORDER-IN-COUNCIL HR120129) (PART 1, M.T.O. PLAN P-2074-17, RECORDED TO THE REGIONAL MUNICIPALITY OF HALTON BY BY-LAW 10-04, UNRECORDED, AND A REGIONAL ROAD BY ORDER-IN-COUNCIL HR120129) (PART 1, M.T.O. PLAN P-2074-17, RECORDED TO THE REGIONAL MUNICIPALITY OF HALTON BY BY-LAW 10-04, UNRECORDED, AND A REGIONAL ROAD BY ORDER-IN-COUNCIL HR120129)