

FOR WINSTON CHURCHILL BLVD ROAD WIDENING DESIGN REFER TO PLANS BY EMC GROUP LTD.

FOR WINSTON CHURCHILL BLVD HYDRO RELOCATION & STREET LIGHT DESIGN REFER TO PLANS BY RTG SYSTEMS.

NOTE: SURVEY DATA USED FOR THE EXISTING TOPOGRAPHY PREPARED BY KRCMAR DATED: FEB 3, 2015

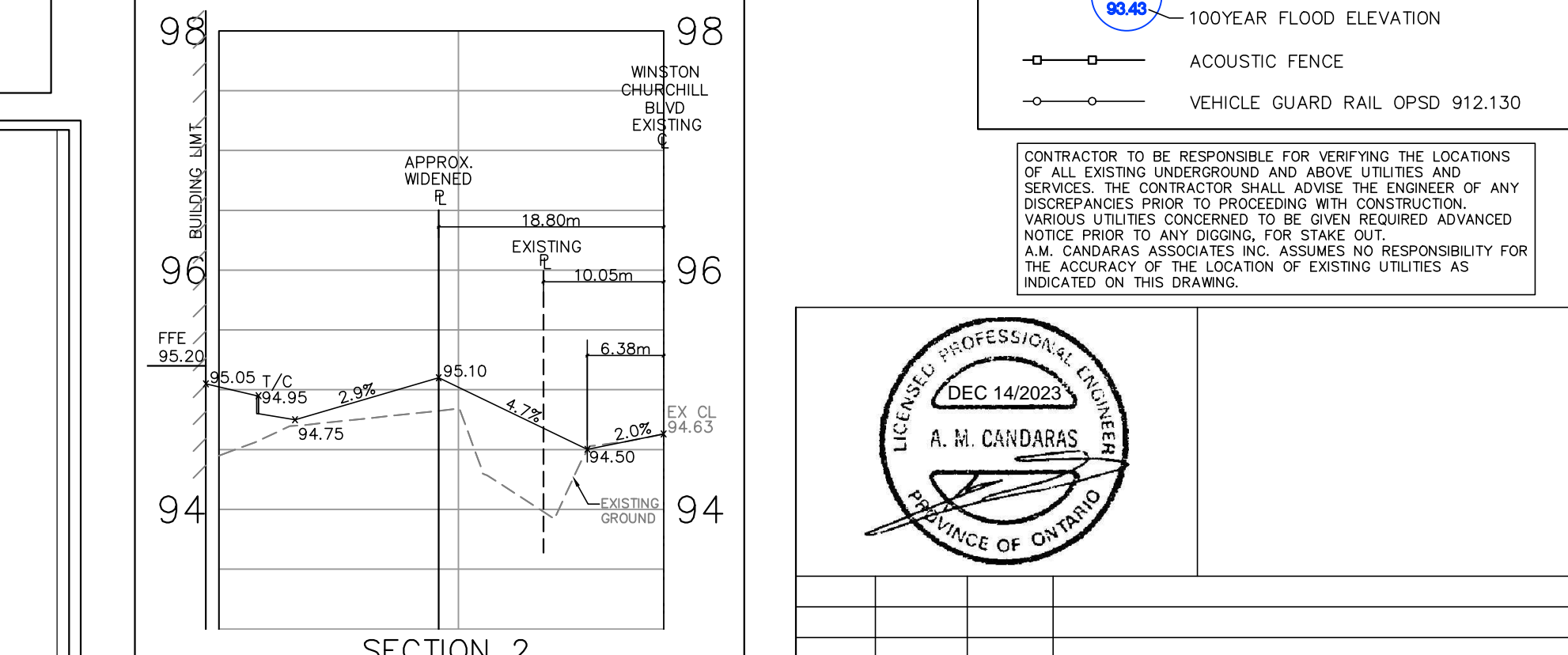
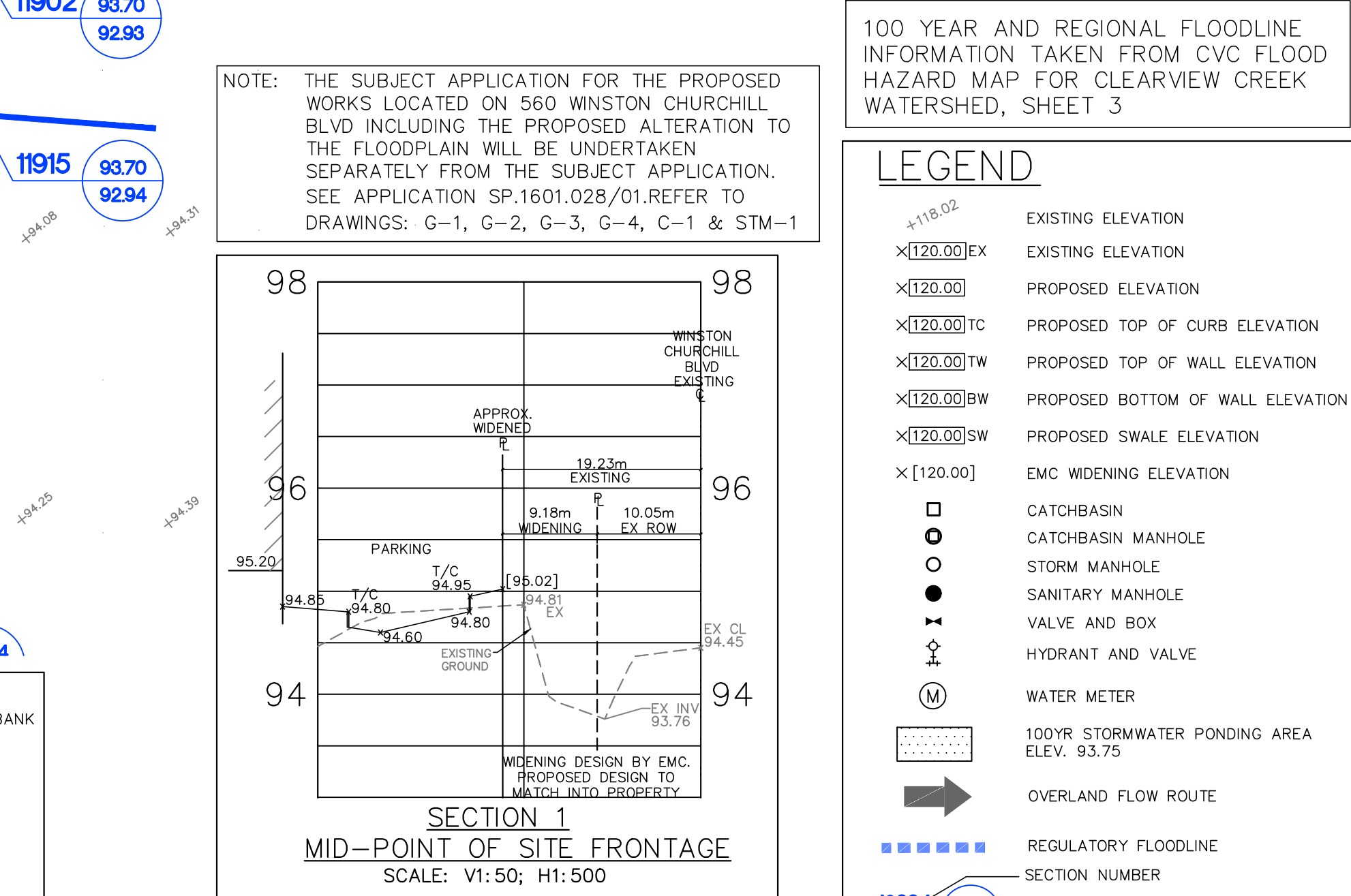
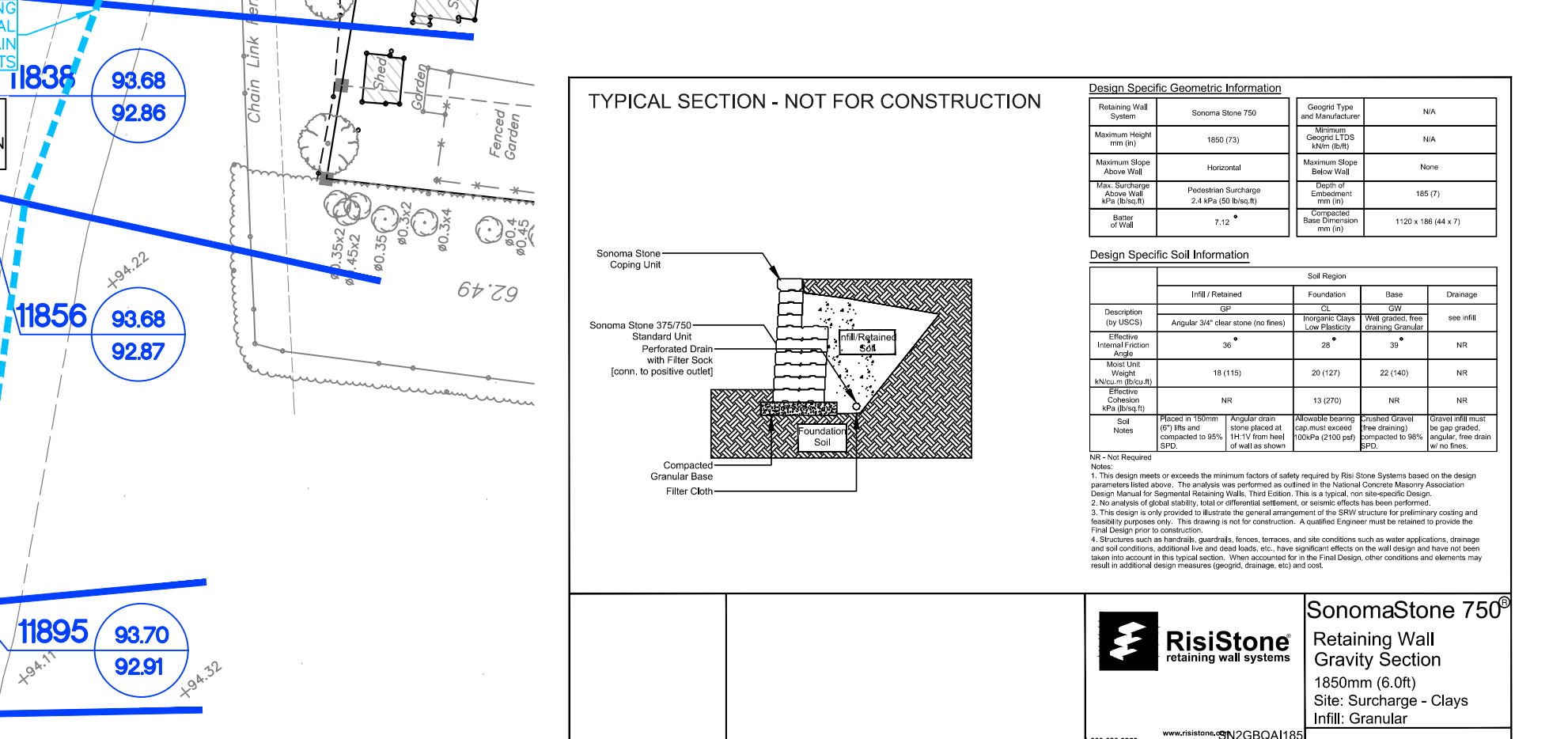
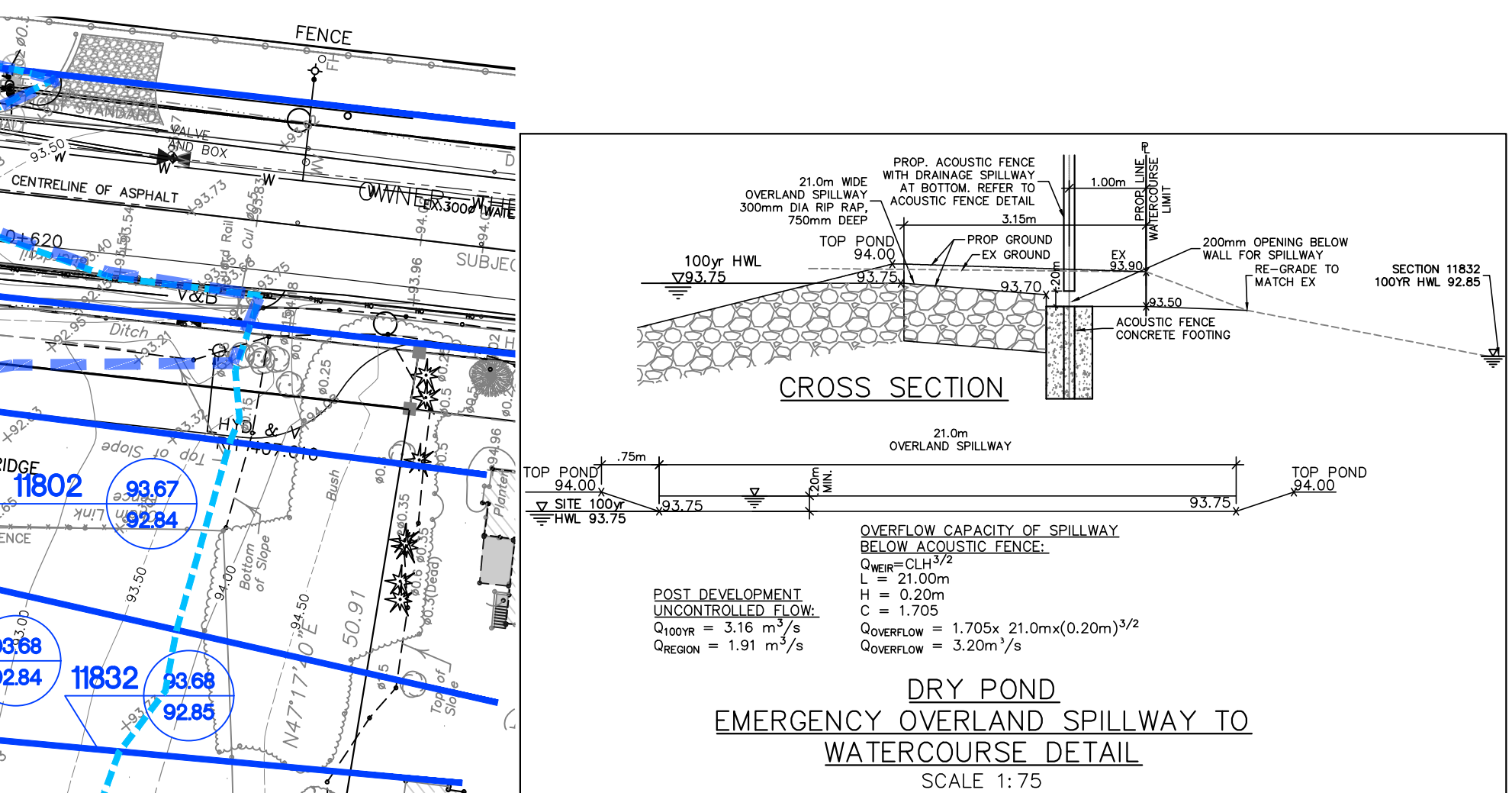
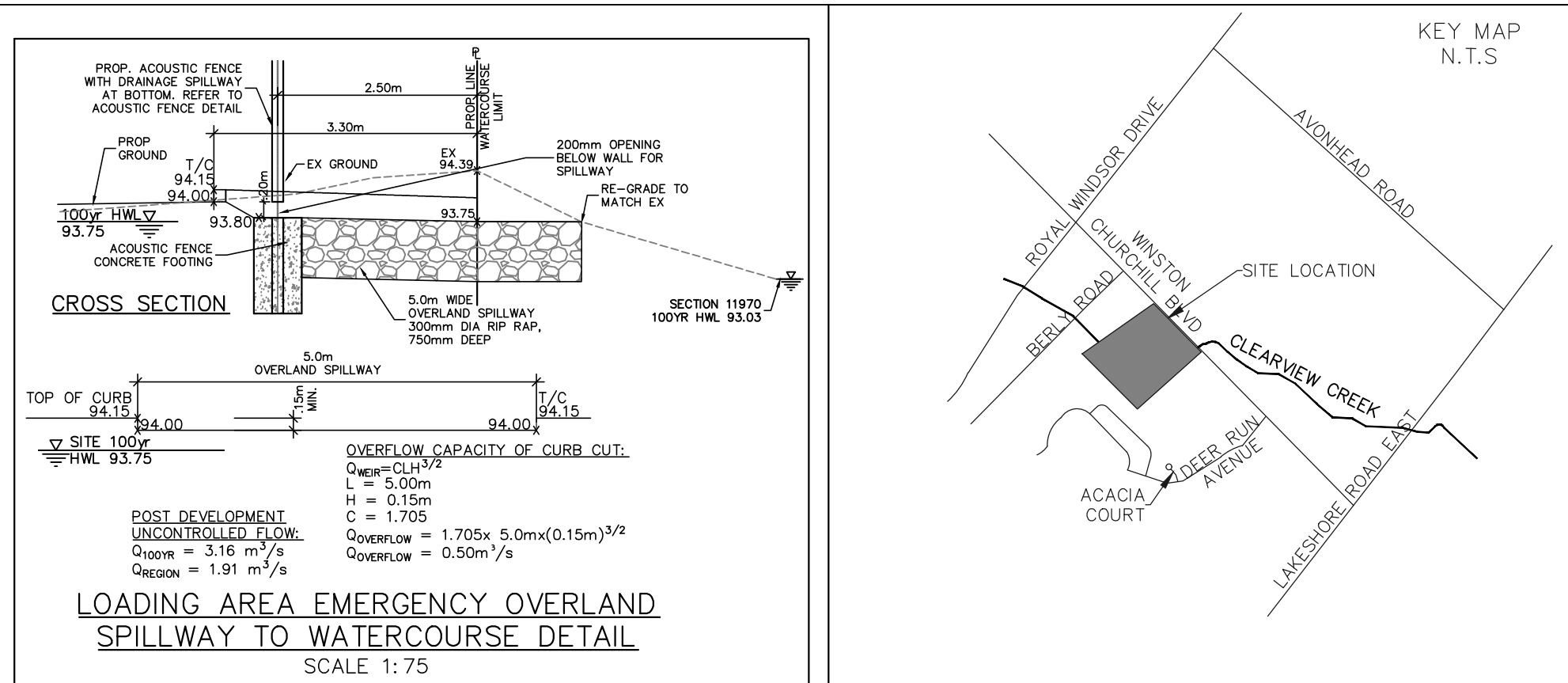

100 YEAR AND REGIONAL FLOODING INFORMATION TAKEN FROM CVC FLOOD HAZARD MAP FOR CLEARVIEW CREEK WATERSHED, SHEET 3

LEGEND

- EXISTING ELEVATION
- PROPOSED ELEVATION
- PROPOSED TOP OF CURB ELEVATION
- PROPOSED BOTTOM OF WALL ELEVATION
- PROPOSED SMALL ELEVATION
- EMC WIDENING ELEVATION
- CATCHBASIN
- CATCHBASIN MANHOLE
- STORM MANHOLE
- SANITARY MANHOLE
- VALVE AND BOX
- HYDRANT AND VALVE
- WATER METER
- 100% STORMWATER PONDING AREA ELEV. 93.75
- OVERLAND FLOW ROUTE
- REGULATORY FLOODLINE
- REGIONAL FLOOD ELEVATION
- 100YEAR FLOOD ELEVATION
- ACoustic FENCE
- VEHICLE GUARD RAIL OPD 912.130

CONTRACTOR IS RESPONSIBLE FOR VERIFYING THE LOCATION OF ALL EXISTING UTILITIES AND WORK UTILITIES AND SERVICES THE CONTRACTOR SHALL ADVISE THE ENGINEER OF ANY DISCREPANCIES PRIOR TO PROCEEDING WITH CONSTRUCTION. A.M.C. ASSOCIATES INC. ASSUMES NO RESPONSIBILITY FOR THE ACCURACY OF THE LOCATION OF EXISTING UTILITIES AS INDICATED ON THE DRAWINGS.

DEC 14 2023  
A.M.C. ASSOCIATES INC.  
REGISTERED PROFESSIONAL ENGINEER  
PROVINCE OF ONTARIO

4	DEC 14/23	RPA	FOURTH SUBMISSION
3	DEC 19/22	FP	THIRD SUBMISSION
2	DEC 15/21	FP	SECOND SUBMISSION
1	APR 9/21	FP	FIRST SUBMISSION

Revisions:

No.	Date	By	REVISIONS
1			

a.m.c. associates inc.  
consulting engineers  
8551 Weston rd., suite 203  
Woodbridge ont. L4L 9R4  
905-850-8000 Fax 905-850-8099  
Email: civil@amc.on.ca

**772 WINSTON CHURCHILL BLVD.**  
SPA 1601.029/01  
Region of Peel No. C602647

**TOWN OF OAKVILLE  
REGION OF HALTON**

**ABOVE GROUND GRADING AND SWM PLAN - EAST SITE AREA**

SCALE: 1:500 DATE: APR 2021 PROJ NO: 2060  
DRAWN: F.P. CHKD: A.M.C. PLAN NO:  
DESIGNED: A.M.C. SHEET 1 OF 6 **G-1**

