

1 - Deciduous Tree Planting N.T.S.

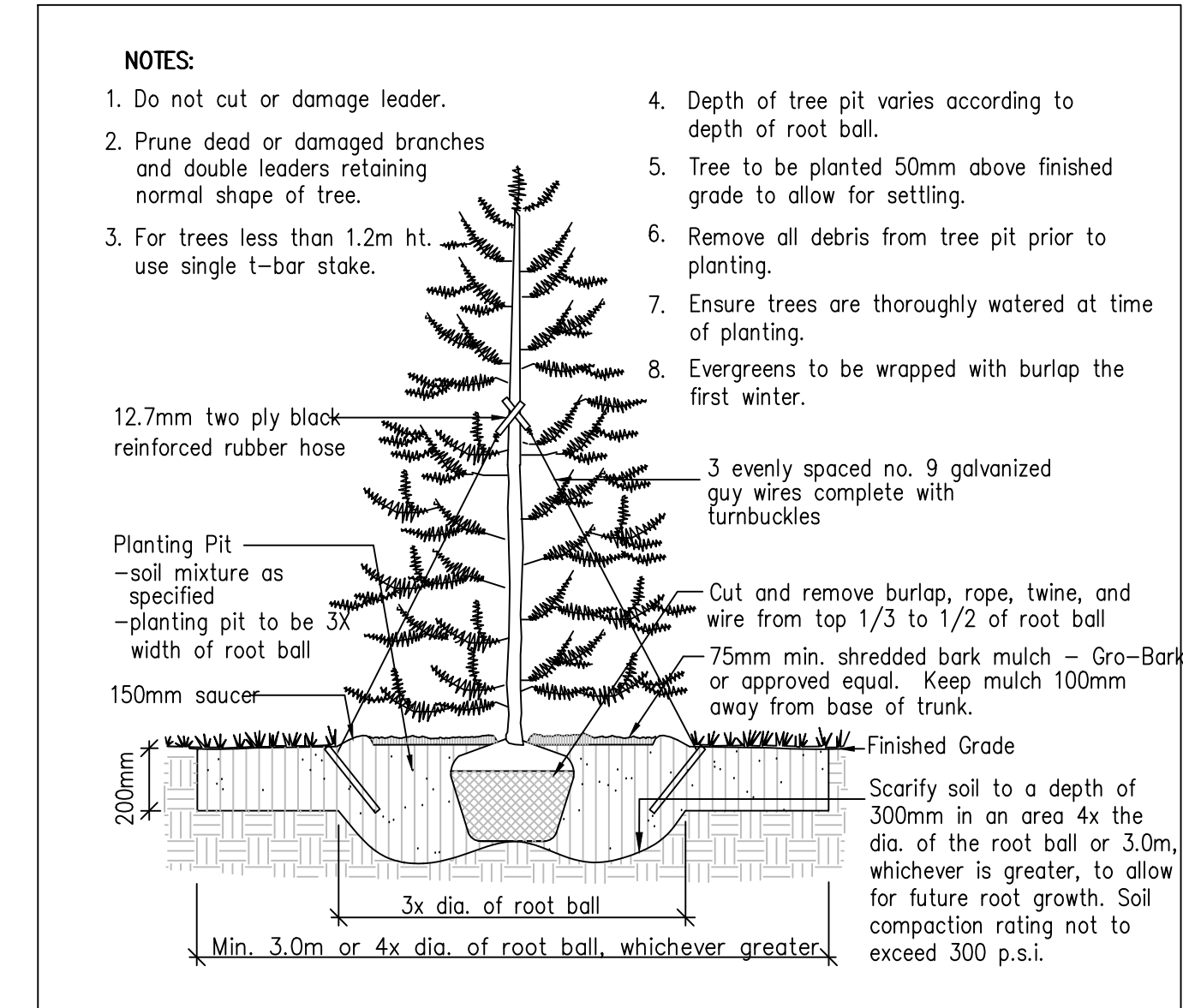

2 - Coniferous Tree Planting N.T.S.

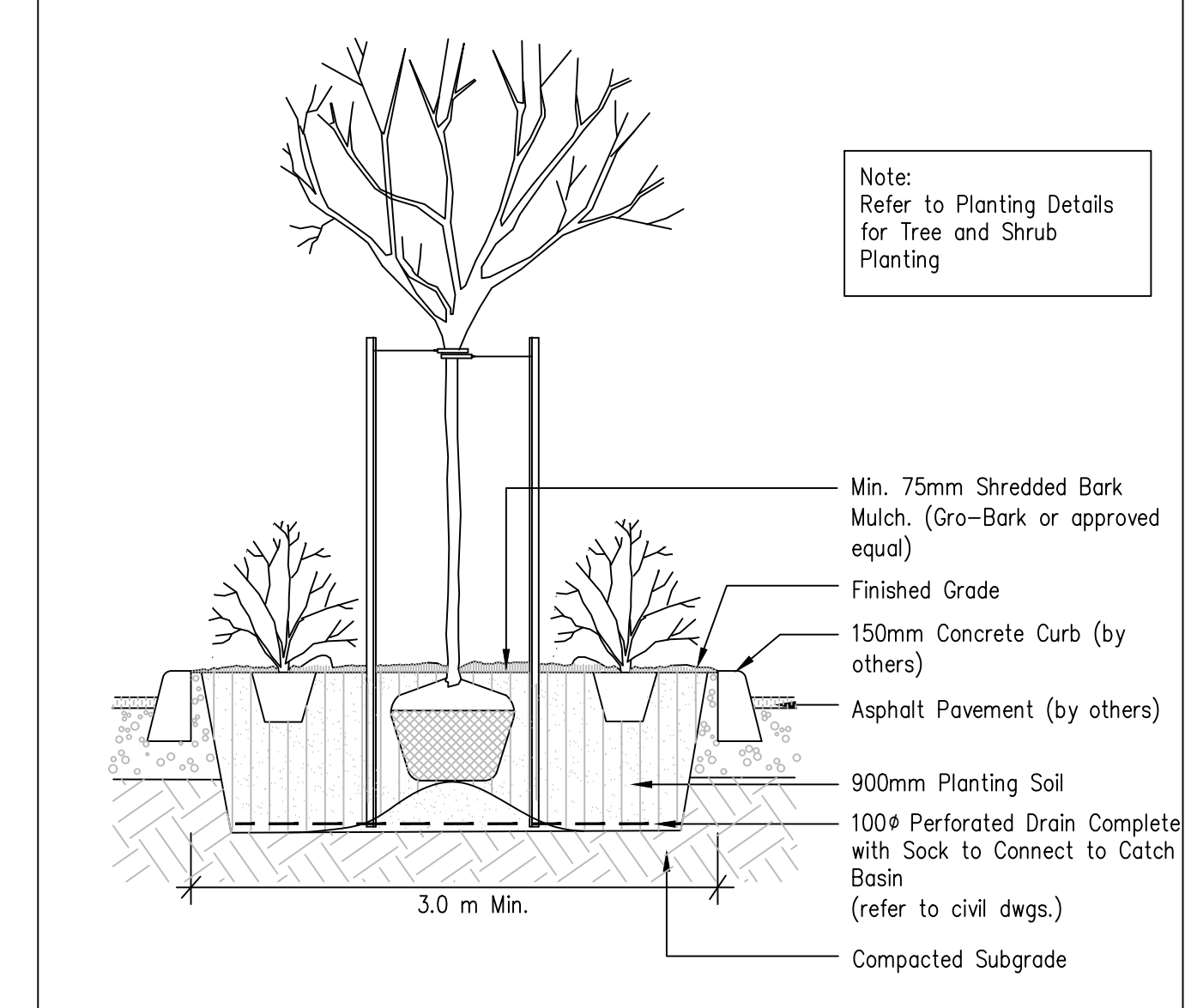

3 - Planting Island - Section (900mm depth) N.T.S.

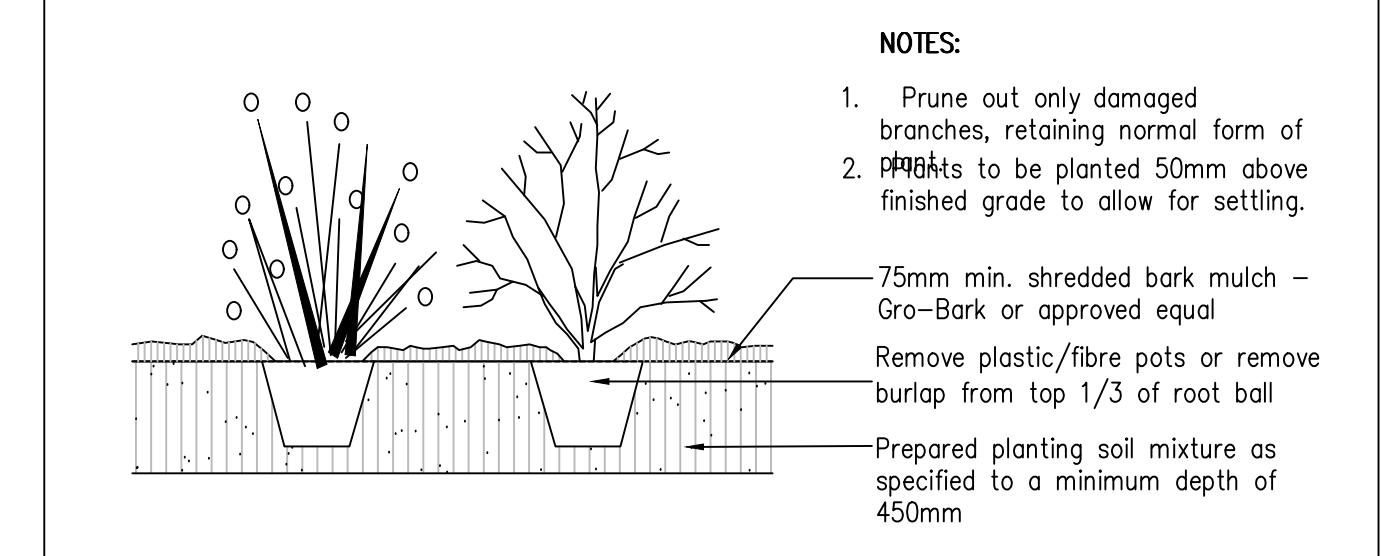

4 - Shrub and Perennial Planting N.T.S.

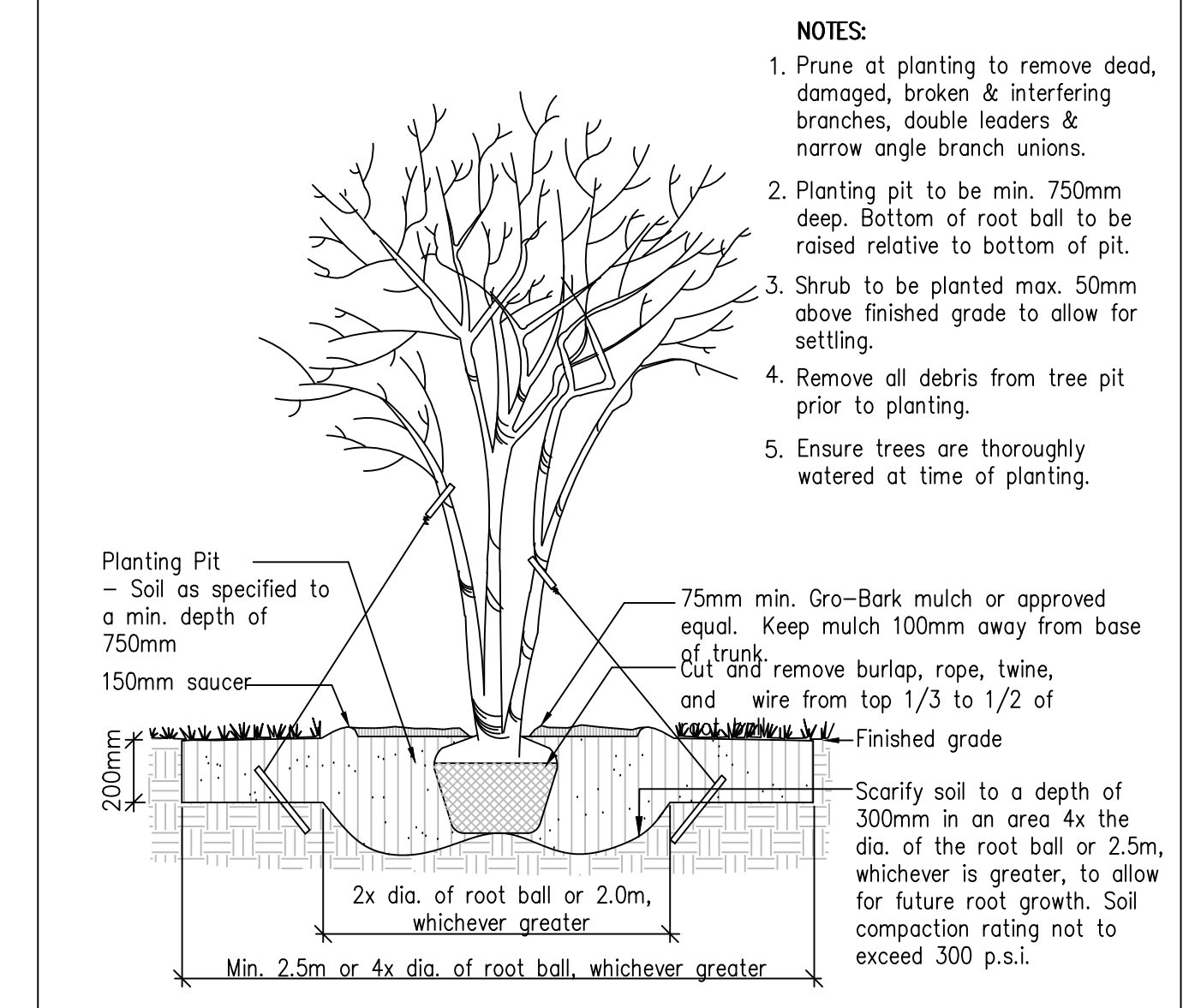

5 - Large Multi-Stem Shrub Planting N.T.S.

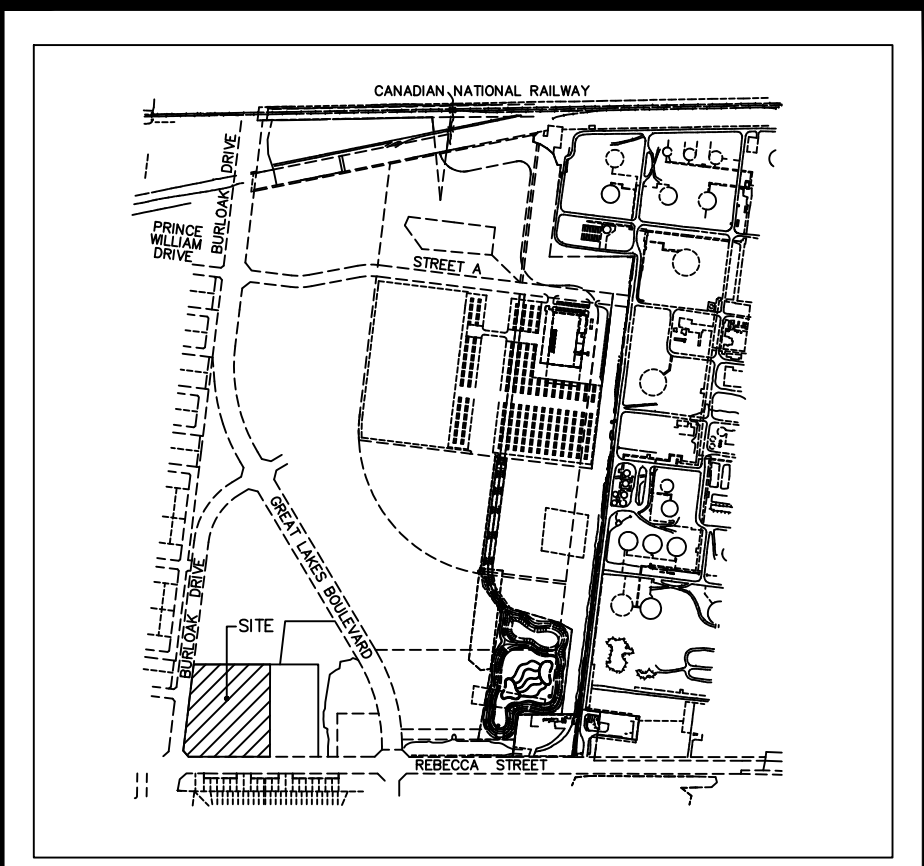

No.	Date	Revision	By
7	Nov 2/21	Reissued for SPA Submission	TT
6	Jun 30/21	Reissued for SPA Submission	TT
5	Feb 26/21	Issued for Drawing Coordination	JC
4	Nov 11/21	Reissued for SPA Submission	JC
3	Jan 15/21	Issued for SPA Submission	JC
2	Jan 08/21	Drawing Coordination	JC
1	Sept 24/20	Drawing Coordination	JC

**Client:** Burloak Market Place Inc.

**Architect:** CMV Group  
247 Spadina Avenue, 4th Floor  
Toronto, ON, M5T 3A8

**Civil:** Urbantech Consulting  
2030 Bristol Circle, Suite 105  
Oakville, ON, L6H 0H2

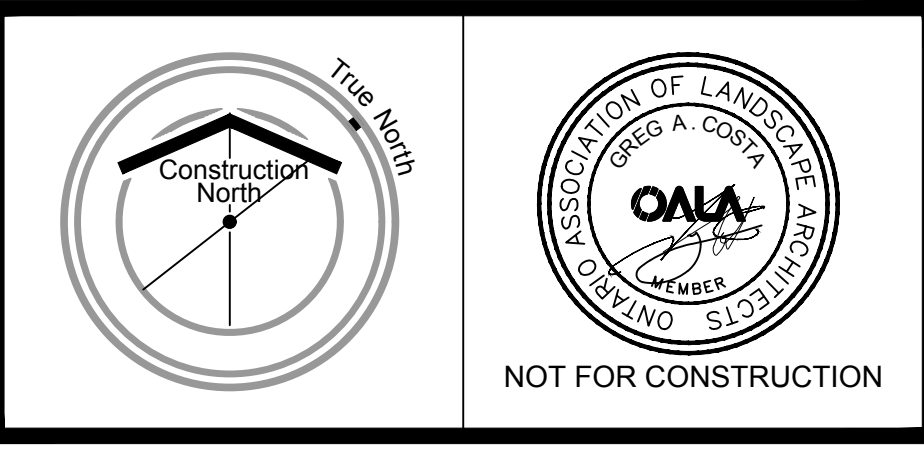

**PLANNING URBAN DESIGN & LANDSCAPE ARCHITECTURE**  
MHBC PLANNING

230-205 WESTON ROAD  
WOODBINE, ON, L4E 6P7  
P: 905.886.9929  
WWW.MHBCPLAN.COM

**Project:** Burloak Marketplace  
3515 - 3545 Rebecca Drive  
Oakville, ON

Title: Landscape Plan & Details	
Scale: 1:250	Date: September 2020
Designed: JC	Drawn: TT
Job No.: 17106 E	Drawing No.: L-2

**Plant List**

TREES	QTY	BOTANICAL NAME	COMMON NAME	SIZE	CONTAINER	MAX. SPACING
AA	3	Acer x freemanii 'Armstrong'	Armstrong Maple	60mm Cal.	W.B.	80cm O.C.
AJ	3	Acer x freemanii 'Jeffers'	Aulnum Blaze Maple	60mm Cal.	W.B.	80cm O.C.
AI	4	Acer tataricum	Tataricum Maple	60mm Cal.	W.B.	80cm O.C.
CA	8	Carya ovata	Shagbark Hickory	60mm Cal.	W.B.	80cm O.C.
CO	11	Celtis occidentalis	Common Hackberry	60mm Cal.	W.B.	80cm O.C.
GA	7	Ginkgo biloba 'Autumn Gold'	Autumn Gold Maidenhair Tree	60mm Cal.	W.B.	80cm O.C.
GS	12	Gleditsia triacanthos var. inermis 'Shademaster'	Shademaster Locust	60mm Cal.	W.B.	80cm O.C.
LI	8	Liriodendron tulipifera	Tulip Tree	60mm Cal.	W.B.	80cm O.C.
PP	13	Picea pungens	Colorado Spruce	180cm ht.	W.B.	100cm O.C.
PB	4	Pinus culleniana 'Bradford'	Bradford Ornamental Pear	60mm Cal.	W.B.	80cm O.C.
QM	4	Quercus macrocarpa	Burr Oak	60mm Cal.	W.B.	80cm O.C.
QR	3	Quercus robur	English Oak	60mm Cal.	W.B.	80cm O.C.
TA	7	Tilia americana 'Redmond'	Richmond Bosswood	60mm Cal.	W.B.	80cm O.C.
TO	7	Thuja occidentalis 'Holmstrup'	Holmstrup Cedar	180cm ht.	W.B.	100cm O.C.
UA	8	Ulmus americana 'Valley Forge'	Valley Forge Elm	60mm Cal.	W.B.	80cm O.C.
SHRUBS	QTY	BOTANICAL NAME	COMMON NAME	SIZE	CONTAINER	MAX. SPACING
AMC	6	Ameiandier canadensis	Shadblow Serviceberry Multistem	250cm ht.	W.B.	80cm O.C.
DC	61	Deutzia gracilis	Slender Deutzia	60cm ht.	Pot	80cm O.C.
EC	26	Euonymus fortunei 'Canadale Gold'	Canadale Gold Euonymus	60cm spr.	Pot	80cm O.C.
HA	40	Hydrangea arborescens 'Annabelle'	Annabelle Hydrangea	60cm ht.	Pot	100cm O.C.
HP	37	Hydrangea paniculata 'Tree Wee'	Panicled Hydrangea	60cm ht.	Pot	100cm O.C.
JA	53	Juniperus sibirica 'Arcadia'	Arcadia Juniper	60cm spr.	Pot	100cm O.C.
JS	47	Juniperus sibirica 'Skandia'	Skandia Juniper	60cm spr.	Pot	120cm O.C.
PD	30	Physocarpus opulifolius 'Dart's Gold'	Dart's Gold Ninebark	60cm ht.	Pot	100cm O.C.
PD	49	Physocarpus opulifolius 'Diablo'	Diablo Ninebark	60cm ht.	Pot	120cm O.C.
PG	259	Potentilla fruticosa 'Goldfinger'	Goldfinger Cinquefoil	60cm ht.	Pot	80cm O.C.
SC	102	Rosa x 'Noaschnee'	Flower Carpet White	60cm ht.	Pot	80cm O.C.
RN	153	Rosa x 'Noaschnee'	False Spirea	60cm ht.	Pot	200cm O.C.
SS	17	Sorbaria sorbifolia	Anthony Waterer Burmaid Spirea	60cm ht.	Pot	65cm O.C.
SA	124	Spiraea x bumalda 'Anthony Waterer'	Anthony Waterer Burmaid Spirea	60cm ht.	Pot	65cm O.C.
SC	102	Spiraea x bumalda 'Goldflame'	Goldflame Spirea	60cm ht.	Pot	100cm O.C.
SC	84	Stephanandra incisa 'Crispa'	Cutleaf Stephanandra	60cm ht.	Pot	100cm O.C.
TC	69	Taxus cuspidata 'Montloa'	Emerald Spreader Yew	60cm ht.	Pot	140cm O.C.
GRASSES	QTY	BOTANICAL NAME	COMMON NAME	SIZE	CONTAINER	MAX. SPACING
AS	131	Andropogon scoparius	Little Blue Stem	1 gal.	Pot	35cm O.C.
PH	112	Pennisetum alopecuroides 'Hornet'	Hornet Fountain Grass	1 gal.	Pot	45cm O.C.
PERENNIALS	QTY	BOTANICAL NAME	COMMON NAME	SIZE	CONTAINER	MAX. SPACING
HSD	57	Hemerocallis x 'Stello de Oro'	Stello de Oro Daylily	1 gal.	Pot	45cm O.C.
RH	25	Rudbeckia hirta	Black-eyed Susan	1 gal.	Pot	45cm O.C.

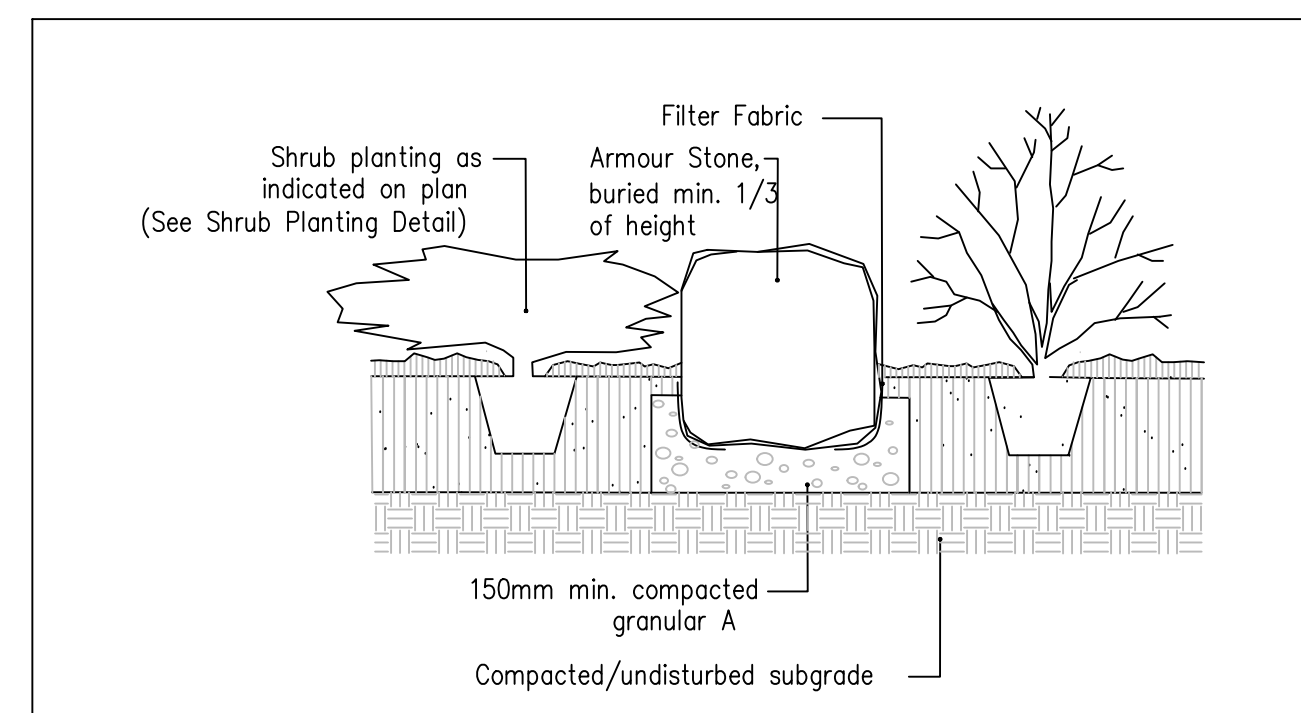

6 - Decorative Armour Stone N.T.S.

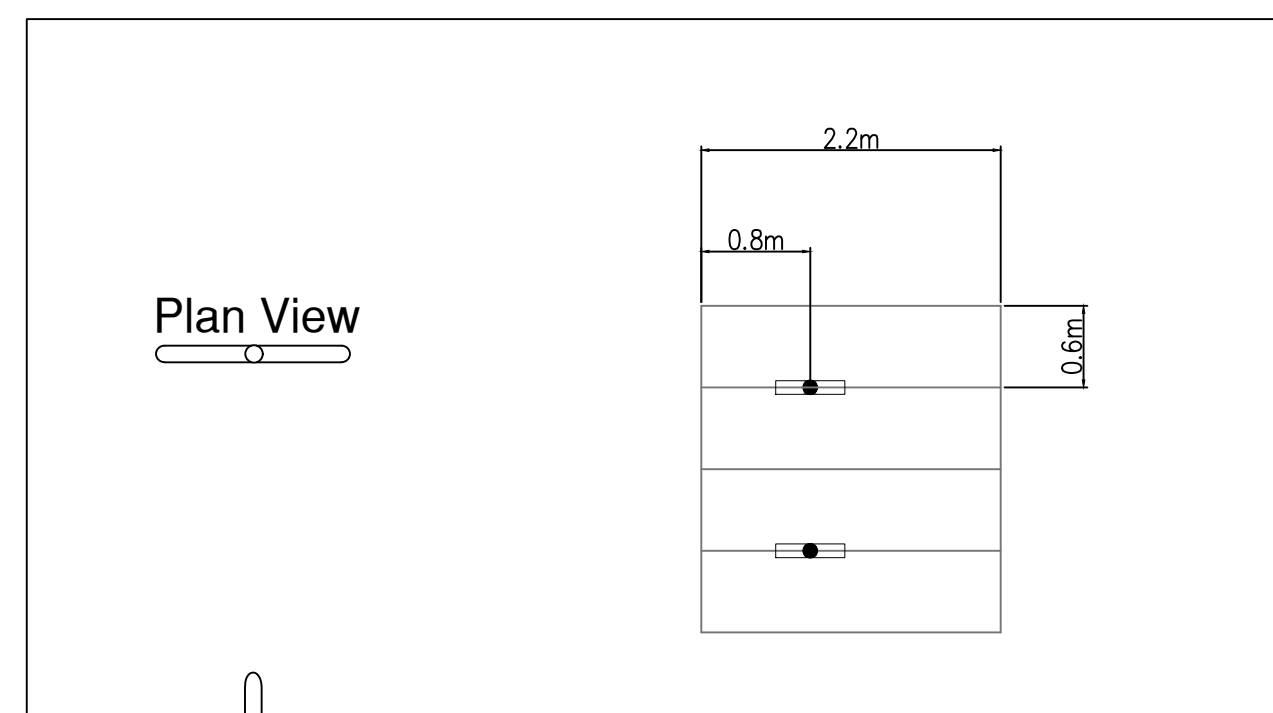

7 - Bicycle Rack N.T.S.

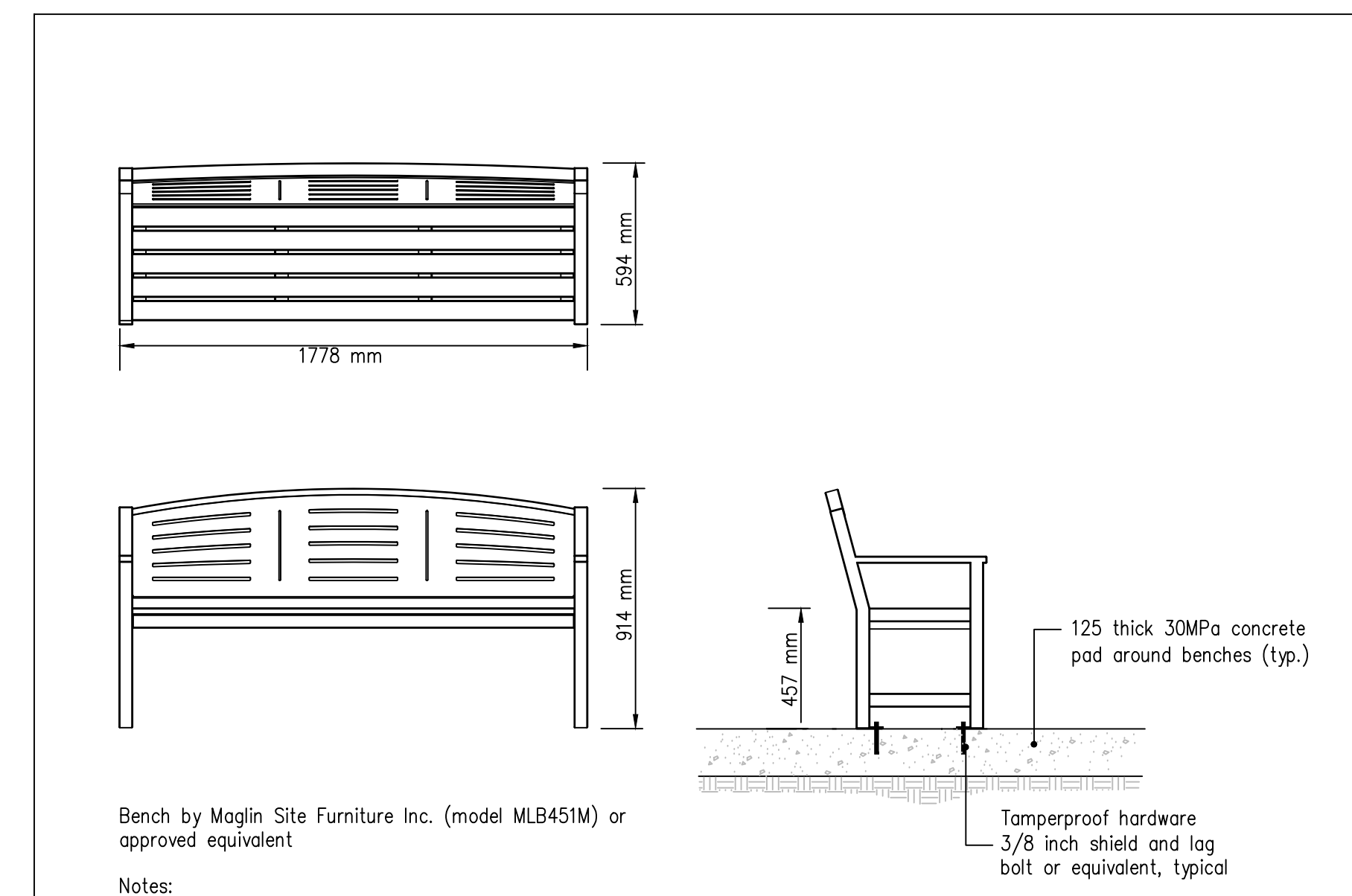

8 - Bench Detail N.T.S.

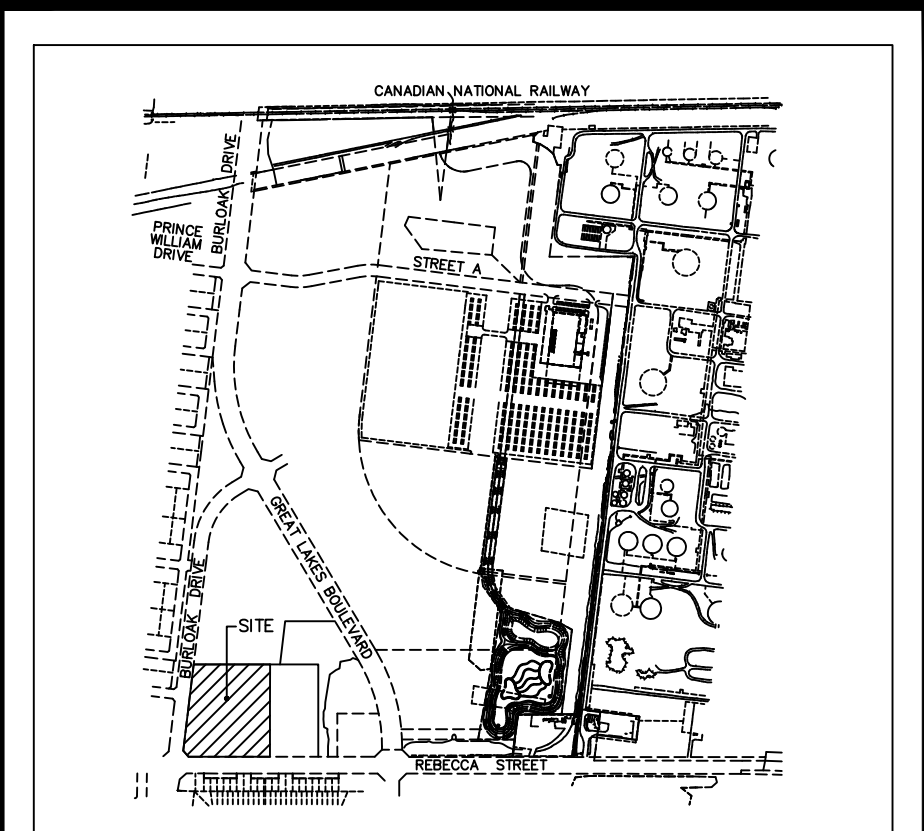

Key Plan N.T.S.

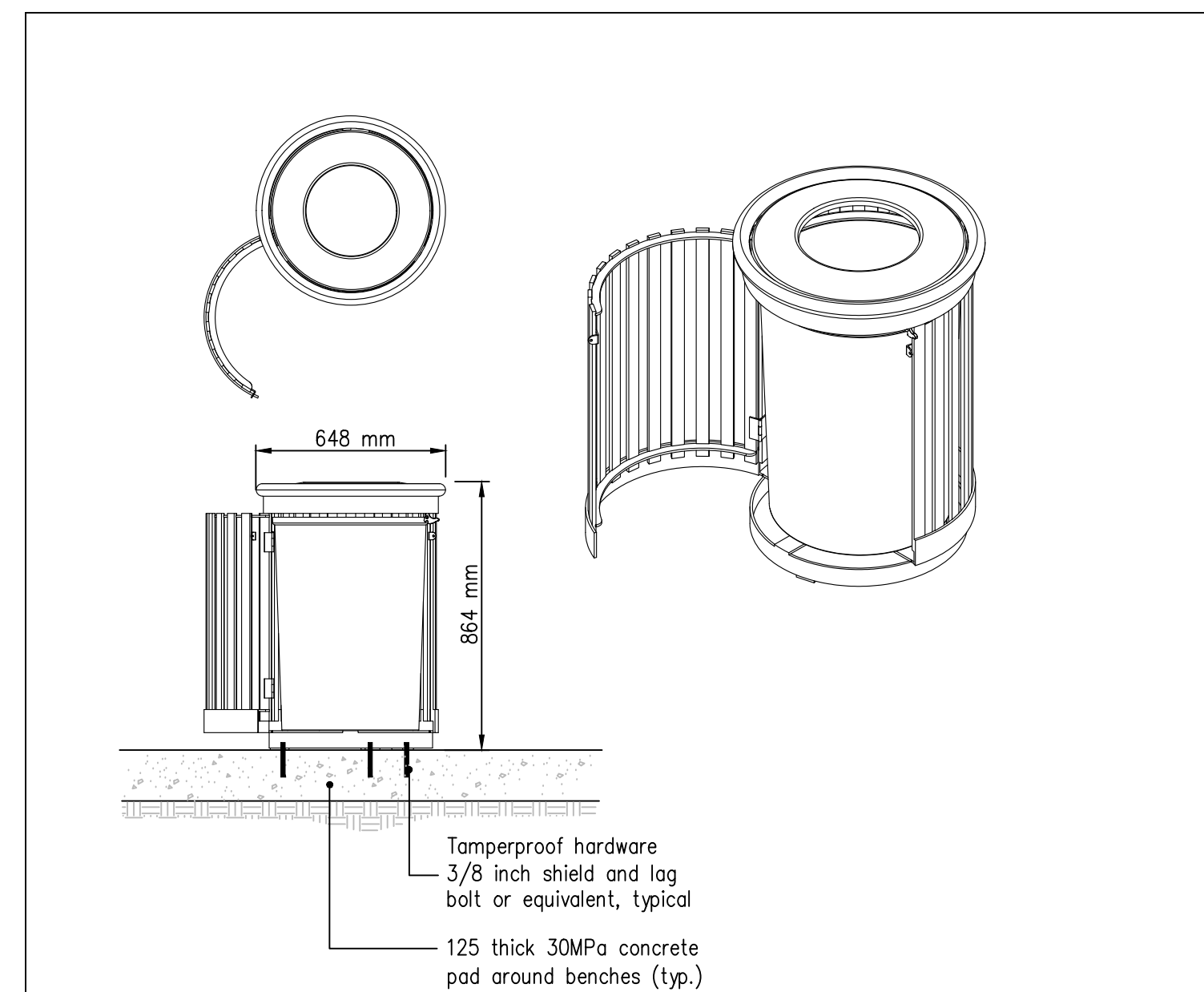

9 - Trash Receptacle N.T.S.

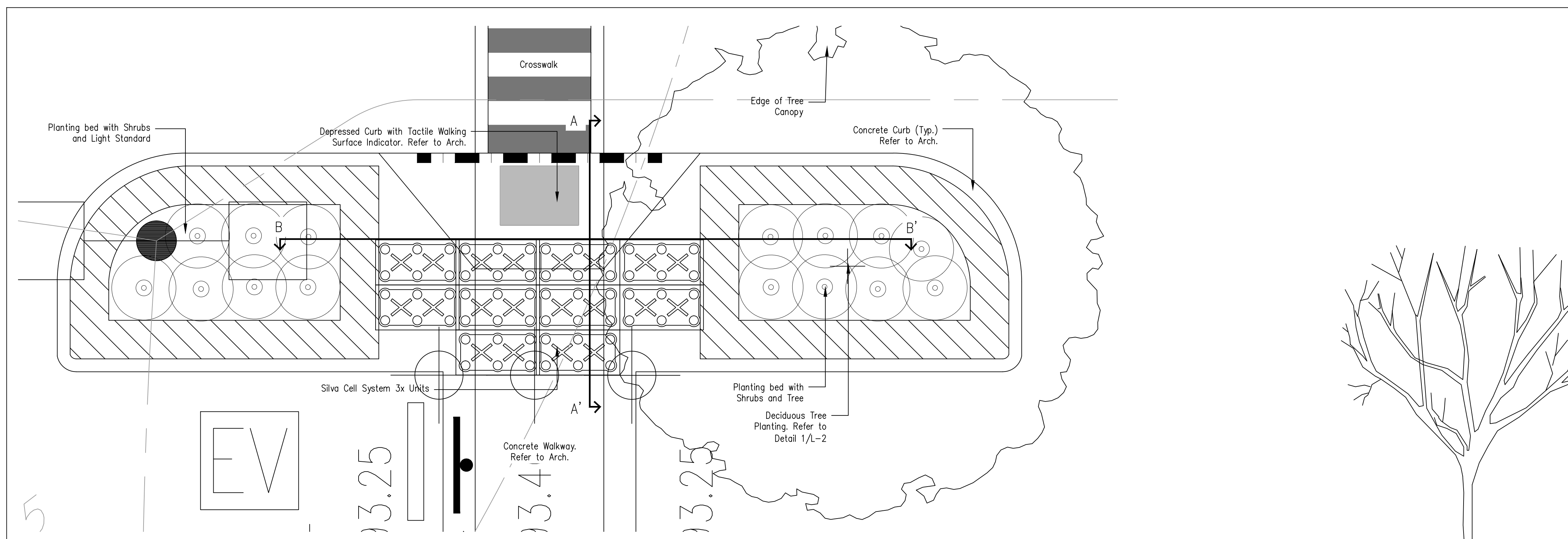

10 - Silva Cell System 3x N.T.S.

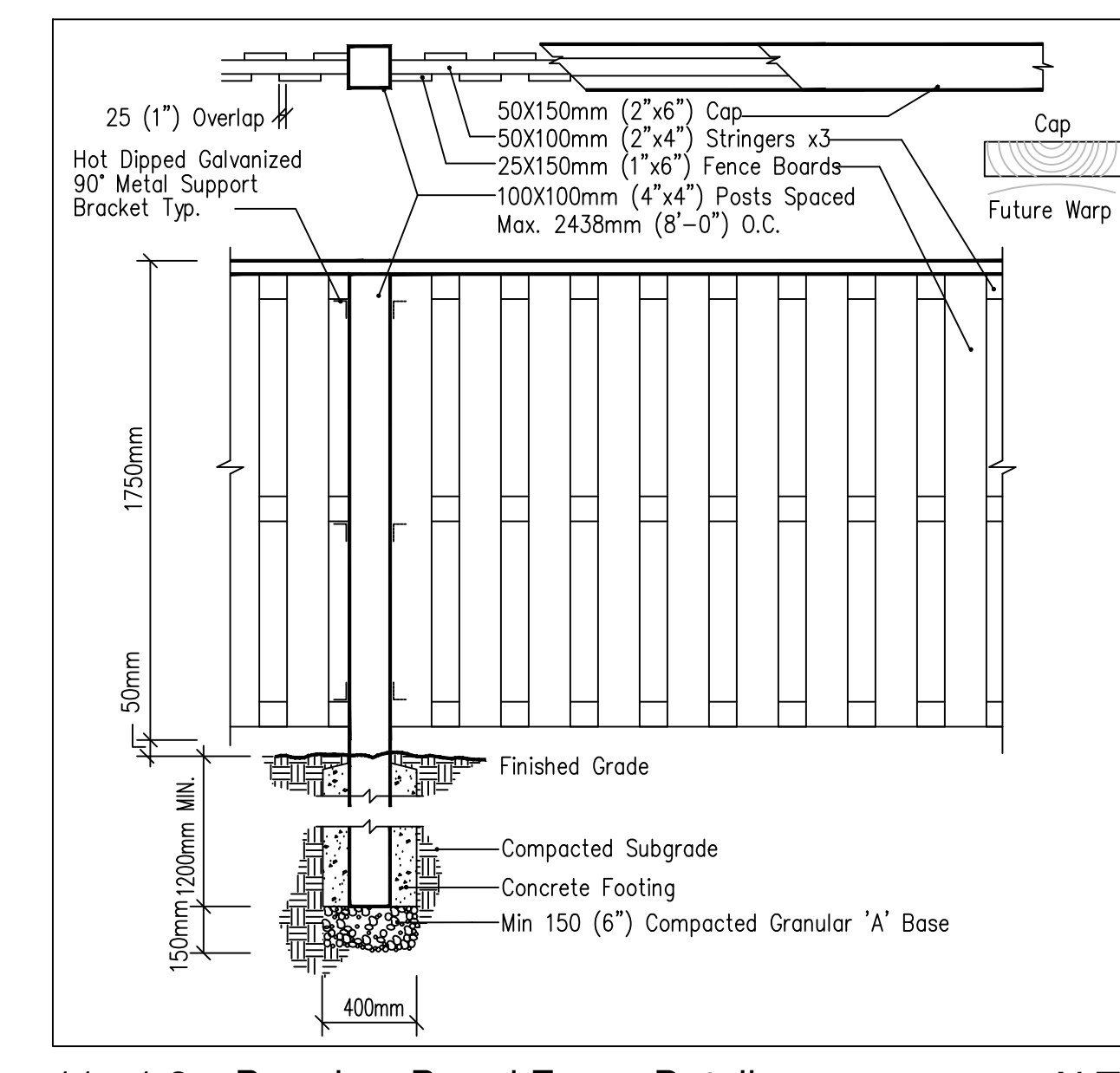

11 - 1.8m Board on Board Fence Detail N.T.S.

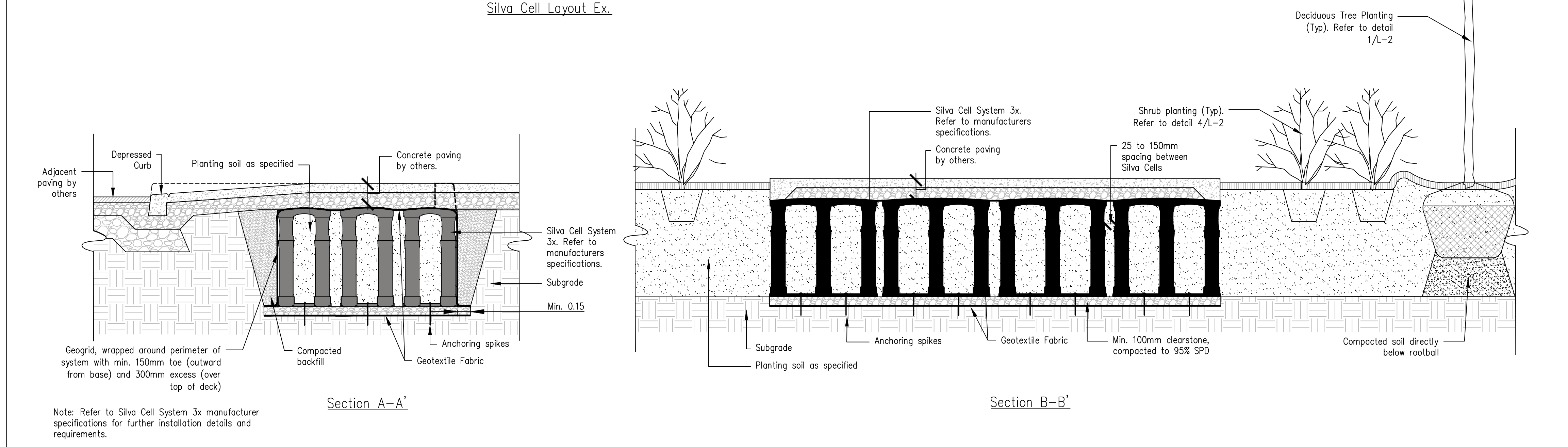

12 - Section A-A' and Section B-B' N.T.S.

**General Notes:**

- Base information provided by OMV Architects
- Grading information provided by Urbantech Consulting
- Contractor to verify all dimensions and conditions on site prior to the commencement of work.
- Obtain all necessary permits before commencement of construction. Report any discrepancies in the drawings, specifications and contract documents to the Landscape Architect before commencement of construction.
- The Landscape Contractor is responsible for contacting the Landscape Architect upon completion of the landscape works for site review leading to substantial performance.
- Grades within the site and of properly line shall not exceed a 3:1 slope (33%).
- All elevations are in metric units and can be converted to feet by dividing by 0.3048
- Limestone rocks to be placed in planting beds shall have a minimum size of 0.75x0.75x0.75m. Size of rocks to reflect placement in bed on plan, and the height/width of surrounding plant material to ensure visibility over time.
- The contractor to contact the Landscape Architect for a field review 2 business days prior to completion.
- TOPSOIL & FINISH GRADING**
- All soil shall be tested by SGS or approved soil testing laboratory at the source before delivery to the site. Submit soil test results for review and approval.
- The contractor is responsible for amendments as recommended by soil testing laboratory.
- Topsoil to be free of subsoil, stones 50mm in diameter or larger, roots, weeds, debris and toxic material.

**MAINTENANCE**

- Contractor to provide all maintenance until acceptance.
- Maintenance to include all weeding, pruning, fertilization, and watering as necessary to maintain optimal plant health.
- PLANTING**
- The quantities indicated on the plan supersede the totals of the plant list.
- All shrubs and groups of conifers to be installed in continuous planting beds.
- All shrubs to be installed in continuous planting beds.
- Planting soil to the following minimum depths after settlement:
  - 450mm for shrubs beds
  - 750mm for large shrubs
  - 900mm for tree planting - min. 1.0m around each tree (from centre of trunk)
- Prepare planting soil by mixing all elements evenly. Excavate and provide planting soils to depths indicated by planting details.
- All plant material to conform to the Canadian Nursery Trades Association Metric Guide Specifications and Standards.
- Obtain approval from Landscape Architect of schedule 7 days in advance of shipment of plant material.
- Obtain approval from Landscape Architect of plant material and planting locations prior to planting.
- Deliver plant material only in quantities that can be planted the same day.

**PLANTING SOIL**

- Planting soil mixture to consist of:
  - 2 parts friable sandy loam topsoil as per specification below.
  - 1 part leaf and yard compost as per organic matter specification below.
  - 1 part aged pine bark as per organic matter specification below.
  - Bone meal - 0.6kg per cubic meter of soil.
  - Final mixture pH 6.0-7.5.
  - Final Gradation:
    - Organic Matter Content: ≥80% by weight
    - Size Gradation:
      - Minimum 95% less than 19mm
- Final mixture shall meet similar particle size distribution as original sandy loam topsoil.
- All particles in the final mixture shall be less than 12.7mm in the smallest dimension and 50mm in the largest dimension.
- Amend with nutrients as per laboratory recommendations.
- Contractor to provide SGS Topsoil analysis of the final planting soil mixture to confirm the final composition and pH prior to delivery to the site.
- Sandy Loam Topsoil
  - Final mixture shall be a light to dark brown in colour, friable, and consisting of (by dry weight):
    - 55-60% Sand
    - 25-35% Silt
    - 10-15% Clay
  - Note: Sand, silt and clay sum to be 100%
- Organic Matter
  - The following specifications for organic matter materials shall be met:
    - Leaf and Yard Waste Compost:
      - Derived from well composted leaf and yard waste. Meets the Ministry of Environment's Ontario Compost Quality Standards for category AA compost.
      - pH: 7.0 to 8.0
      - EC: less than 4.5 mS/cm
      - Organic Matter Content (dry weight): ≥ 45%
    - Aged Pine Bark:
      - Shall consist of a minimum of 98% pine, containing very little wood fibre (less than 10%). Shall not be a blend of wood or sawdust.
      - Aged pine bark shall be processed through a managed aging process.
      - Bark must be composted to a chocolate brown-black colour and not orange-red.
      - pH: less than 4.5
      - EC: less than 2.8
      - Organic Matter Content: ≥80% by weight
      - Size Gradation:
        - Minimum 95% less than 19mm

**Tree Preservation Notes:**

- Existing trees which are to remain within or adjacent to construction areas shall be protected with fencing erected beyond the "trip line". Groups of trees and other existing plantings to be protected, shall be done in a like manner with fencing around the entire clump(s). Areas within the protective fencing shall remain undisturbed and shall not be used for the storage of building materials or equipment.
- No rigging cables shall be wrapped around or installed in trees. Surplus soil, equipment, debris or materials shall not be placed over root systems of the trees within the protective fencing. No contaminants will be dumped or flushed where feeder roots of trees exist.
- The warranty period for all municipal boulevard trees shall be 2 years from acceptance.
- The Landscape Subcontractor shall remedy any defects and pay for any damage to other work, within a period of one year. All plant materials used as replacement for unacceptable plant materials shall be of the same quality and requirements prescribed for original materials.
- The costs of replacement during the warranty period resulting from theft, vandalism, carelessness or neglect on the part of others, or any causes due to circumstances beyond the control of the Landscape Subcontractor shall be borne by the Owner.

**MIGRATORY BIRDS CONVENTION ACT NOTE**

- Removal of trees and other vegetation is not permitted during the breeding (nesting) bird season (generally April 1 to August 31) to avoid the harm or destruction of nests, eggs and young of bird species per the Migratory Birds Convention Act (MBCA). If vegetation removal is required during this period, then a qualified avian biologist should undertake a bird nest survey prior to construction. If active nests are observed, then the development of a site-specific mitigation plan in consultation with the Canadian Wildlife Service may be required. Many birds predate and exceed the breeding bird window (e.g. early April, mid-August to early September), and nesting surveys prior to removals do not reliably identify all nests in the vicinity of the proposed works. It is the proponent's responsibility to avoid contravention of the MBCA.

**NOT FOR CONSTRUCTION**

NOT FOR CONSTRUCTION

**PLANNING URBAN DESIGN & LANDSCAPE ARCHITECTURE**

PLANNING URBAN DESIGN & LANDSCAPE ARCHITECTURE  
 MHBC PLANNING  
 230-7850 WESTON ROAD  
 WOODBINE, ON L4B 3P2  
 P: 905.709.9933 F: 905.709.9938  
 WWW.MHBCPLAN.COM

No.	Date	Revision	By
7	Nov 2/21	Reissued for SPA Submission	TT
6	Jun 30/21	Reissued for SPA Submission	TT
5	Feb 26/21	Issued for Drawing Coordination	JC
4	Feb 11/21	Reissued for SPA Submission	JC
3	Jan 15/21	Issued for SPA Submission	JC
2	Jan 08/21	Drawing Coordination	JC
1	Sept 24/20	Drawing Coordination	JC

Client: **Burloak Market Place Inc.**

Architect: **CMV Group**  
 247 Spadina Avenue, 4th Floor  
 Toronto, ON, M5T 3A8

Civil: **Urbantech Consulting**  
 2030 Bristol Circle, Suite 105  
 Oakville, ON, L6H 0H2

NOT FOR CONSTRUCTION

PLANNING URBAN DESIGN & LANDSCAPE ARCHITECTURE  
 MHBC PLANNING  
 230-7850 WESTON ROAD  
 WOODBINE, ON L4B 3P2  
 P: 905.709.9933 F: 905.709.9938  
 WWW.MHBCPLAN.COM

Project: **Burloak Marketplace**  
 3515 - 3545 Rebecca Drive  
 Oakville, ON

Title: **Details & Notes**

Scale: 1:250	Date: September 2020
Designed: JC	Drawn: TT
Job No.: 17106 E	Drawing No.: L-3