

- LEGEND:**
- SUBDIVISION PROPERTY LINE
  - SITE PLAN PROPERTY LINE
  - 2.4m WOOD ACOUSTIC FENCE
  - 1.2m DECORATIVE METAL FENCE
  - 1.2m CHAINLINK FENCE
  - 1.8m CHAINLINK FENCE
  - SOD
  - RIVER ROCK
  - ASPHALT DRIVE, REFER TO CIVIL
  - PROPOSED UNIT PAVING
  - CONCRETE SIDEWALK, REFER TO CIVIL
  - PROPOSED CONIFEROUS SHRUB
  - PROPOSED DECIDUOUS SHRUB
  - PROPOSED PERENNIAL/GRASS
  - PROPOSED MULTI-STEM SHRUB
  - PROPOSED SUBDIVISION DECIDUOUS STREET TREE
  - PROPOSED DECIDUOUS TREES
  - PROPOSED PERENNIAL/GRASS KEY
  - PROPOSED RIVER ROCK KEY
  - DOUBLE/SINGLE CATCH BASIN, REFER TO CIVIL
  - FIRE HYDRANT, REFER TO CIVIL
  - STREET LIGHT, REFER TO CIVIL
  - TRANSFORMER, REFER TO CIVIL
  - TACTILE PAD, REFER TO CIVIL
  - CURB CUT, REFER TO CIVIL

R3: IRE ISSUED FOR REVIEW	2024.01.09	SS
R2: ISSUED FOR REVIEW	2023.12.14	SS
R1: SITE PLAN PRE-SUBMISSION REVIEW	2023.06.23	HP
no.	revision	date

THESE DRAWINGS ARE THE PROPERTY OF CGLA CONSULTANTS INC. AND SHALL NOT BE ALTERED, MODIFIED, REVERSED, OR CHANGED WITHOUT THE WRITTEN CONSENT OF CGLA CONSULTANTS INC. SEAL IS NOT VALID WITHOUT SIGNATURE OF THE LANDSCAPE ARCHITECT. DRAWINGS CANNOT BE USED FOR TENDER/CONSTRUCTION UNLESS SIGNED BY LANDSCAPE ARCHITECT.

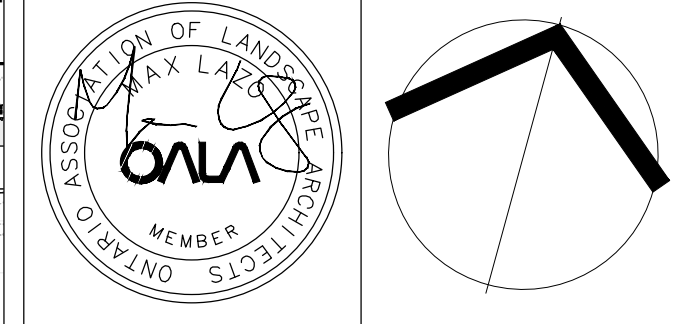

Client: CRYSTAL HOMES

Project Title: OAKBROOK, BLOCK 1 & 2 SITE PLAN

TOWN OF OAKVILLE

Drawing Title: LANDSCAPE PLAN

Reviewed: HP Drawn: AN

Scale: 1:400 Date: 06/13/23

Project Number: 2693-SP

Drawing Number: L1A

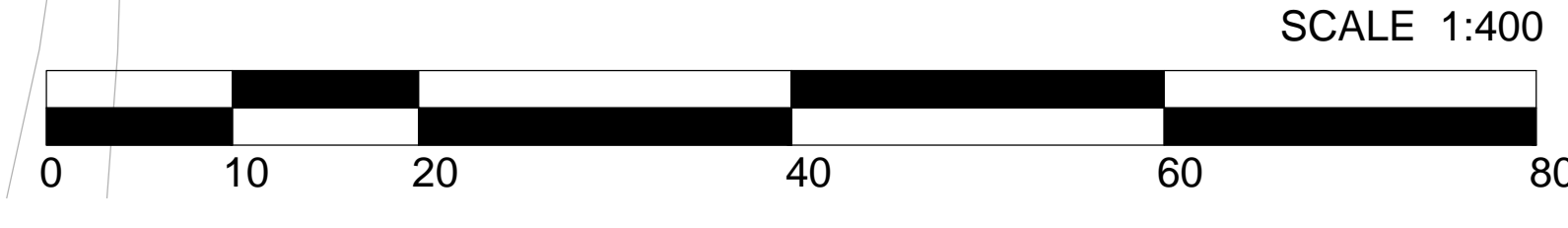



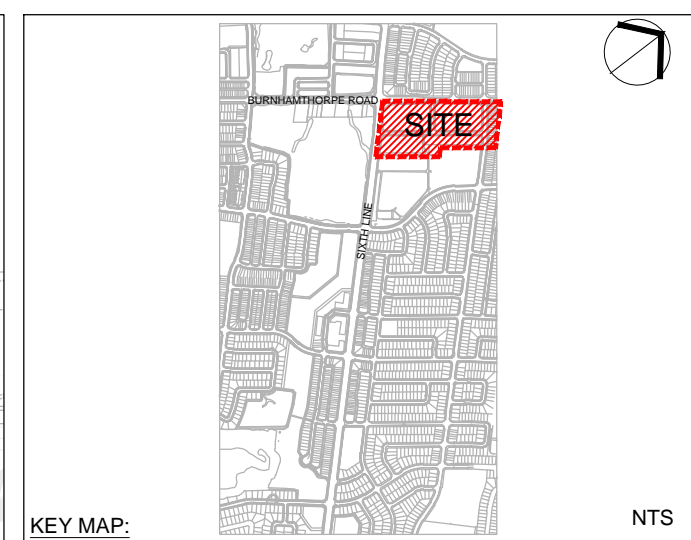
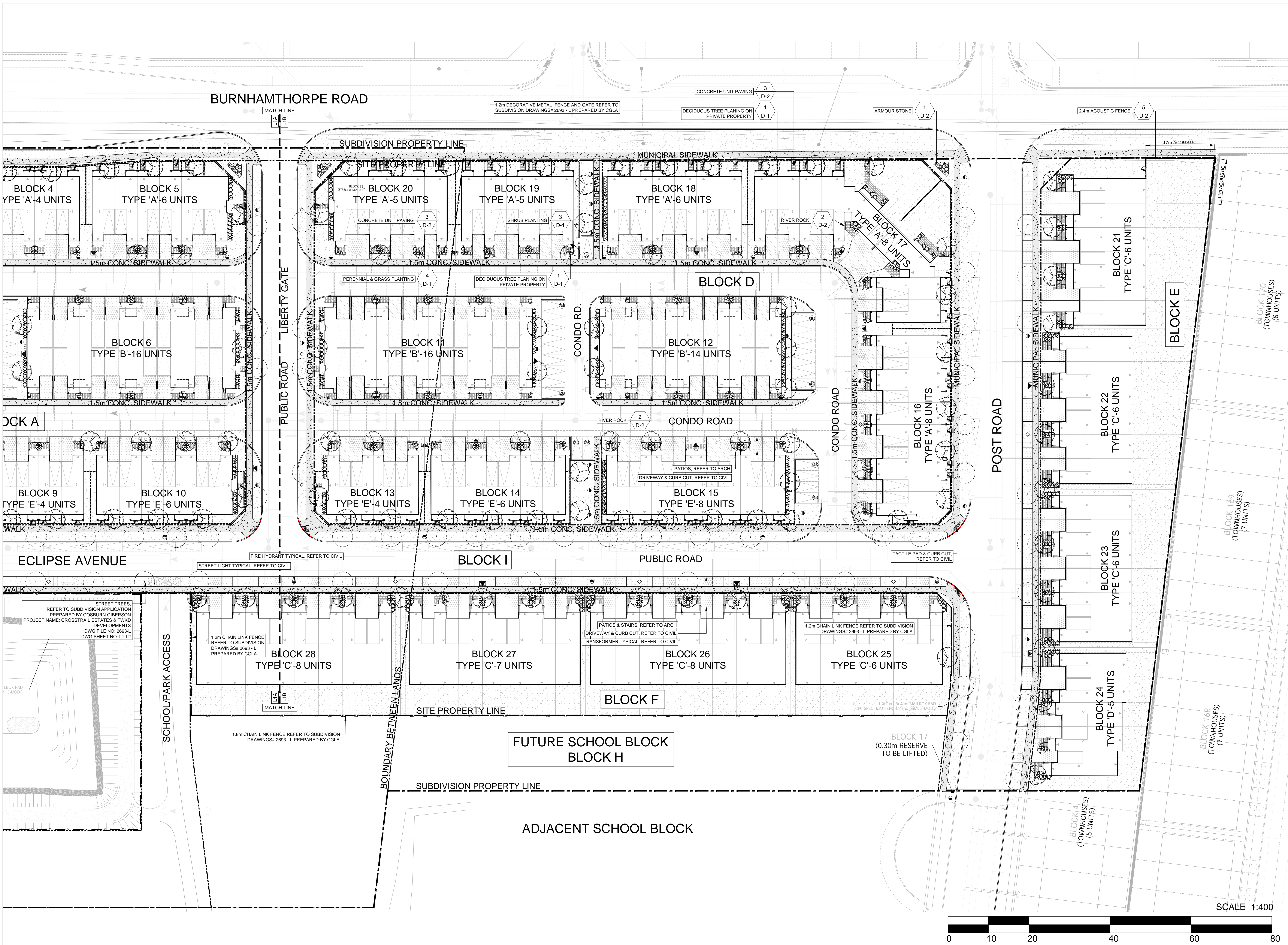

- LEGEND:**
- SUBDIVISION PROPERTY LINE
  - SITE PLAN PROPERTY LINE
  - 2.4m WOOD ACUSTIC FENCE
  - 1.2m DECORATIVE METAL FENCE
  - 1.2m CHAINLINK FENCE
  - 1.8m CHAINLINK FENCE
  - SOD
  - RIVER ROCK
  - ASPHALT DRIVE, REFER TO CIVIL
  - PROPOSED UNIT PAVING
  - CONCRETE SIDEWALK, REFER TO CIVIL
  - PROPOSED CONIFEROUS SHRUB
  - PROPOSED DECIDUOUS SHRUB
  - PROPOSED PERENNIAL/GRASS
  - PROPOSED MULTI-STEM SHRUB
  - PROPOSED SUBDIVISION DECIDUOUS STREET TREE
  - PROPOSED DECIDUOUS TREES
  - PROPOSED PROPOSED STONE KEY
  - DETAIL NO. SHEET NO.
  - DOUBLE/SINGLE CATCH BASIN, REFER TO CIVIL
  - FIRE HYDRANT, REFER TO CIVIL
  - STREET LIGHT, REFER TO CIVIL
  - TRANSFORMER, REFER TO CIVIL
  - TACTILE PAD, REFER TO CIVIL
  - CURB CUT, REFER TO CIVIL

R3: RE-ISSUED FOR REVIEW	2024.01.09	SS
R2: ISSUED FOR REVIEW	2023.12.14	SS
R1: SITE PLAN PRE-SUBMISSION REVIEW	2023.06.23	HP
no.	revision	date

THESE DRAWINGS ARE THE PROPERTY OF CGLA CONSULTANTS INC. AND SHALL NOT BE ALTERED, MODIFIED, REVISED OR CHANGED WITHOUT THE WRITTEN CONSENT OF CGLA CONSULTANTS INC. NO PART SHALL BE REPRODUCED OR TRANSMITTED IN ANY FORM OR BY ANY MEANS, ELECTRONIC OR MECHANICAL, INCLUDING PHOTOCOPYING, RECORDING, OR BY ANY INFORMATION STORAGE AND RETRIEVAL SYSTEM. LANDSCAPE ARCHITECT DRAWINGS CANNOT BE USED FOR TENDER/CONSTRUCTION UNTIL SIGNED BY LANDSCAPE ARCHITECT.

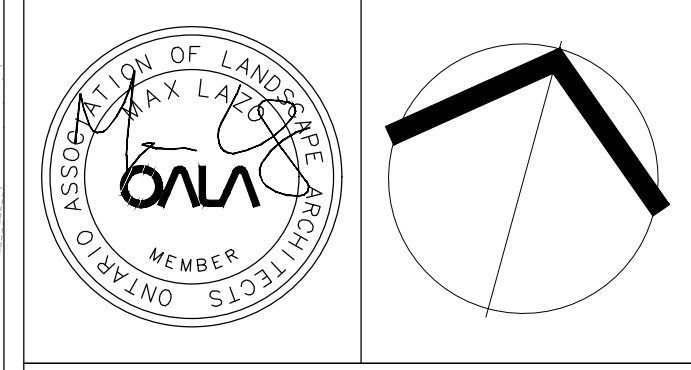

Client:  
**CRYSTAL HOMES**

Project Title:  
**OAKBROOK, BLOCK 1 & 2  
SITE PLAN**

TOWN OF OAKVILLE

Drawing Title:  
**LANDSCAPE  
PLAN**

Reviewed:	HP	Drawn:	AN
Scale:	1:400	Date:	06/13/23
Project Number:	2693-SP		
Drawing Number	L1B		

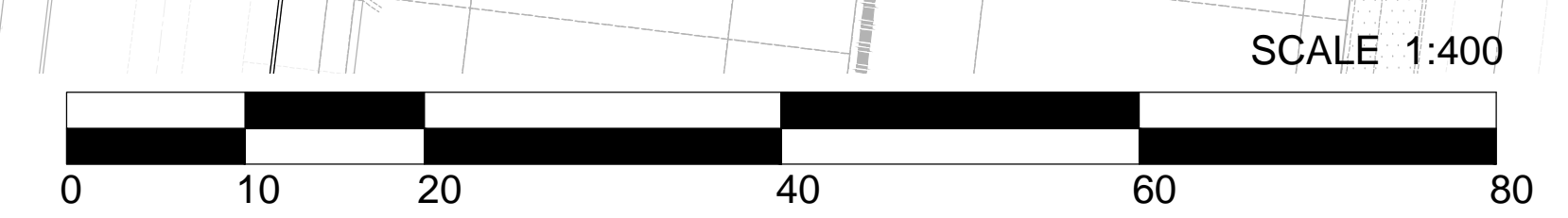



BURNHAMTHORPE ROAD

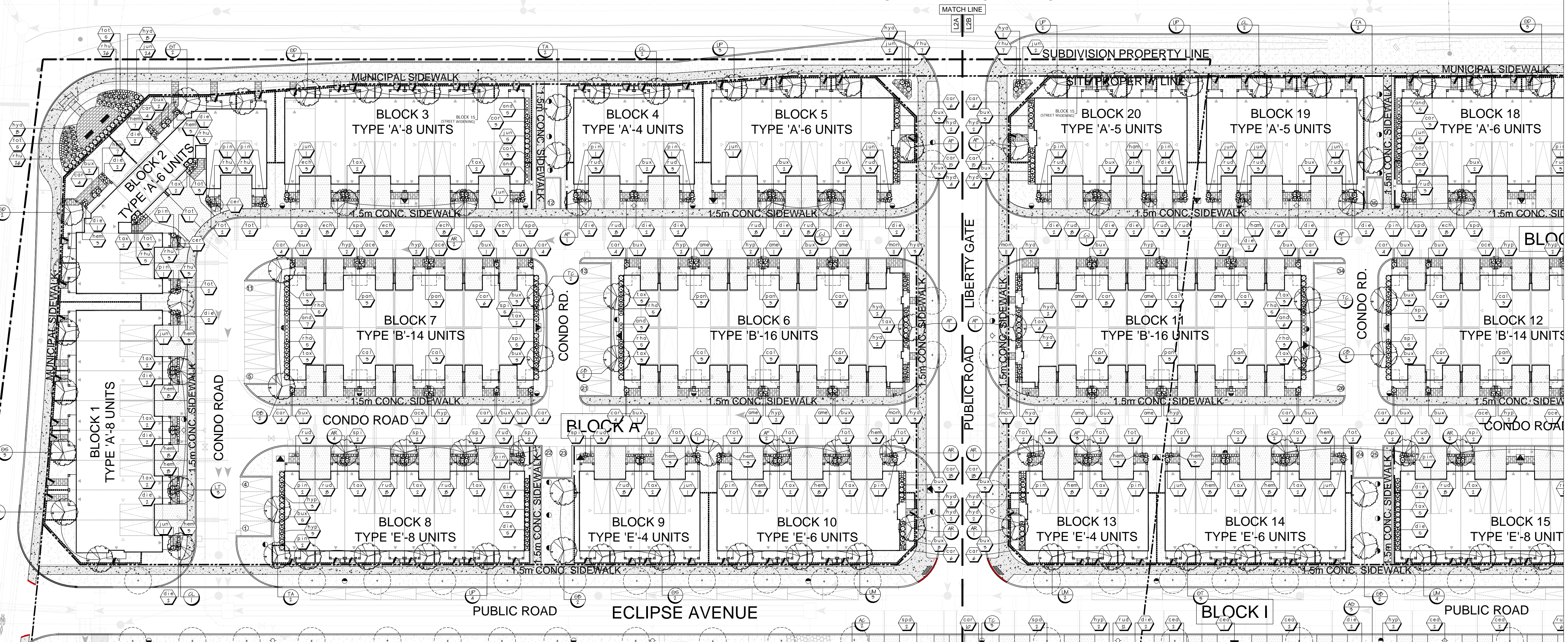

KEY	QTY	BOTANICAL NAME	COMMON NAME	SIZE/ CONDITION	SPACING O/C
<b>DECIDUOUS TREES</b>					
AR	13	Acer rubrum	Red Maple	70mm cal. WB	10m
AF	11	Acer x freemanii 'Celebration'	Celebration maple	70mm cal. WB	10m
AC	9	Aesculus camea 'Briotii'	Ruby-Red Horsechestnut	70mm cal. WB	10m
AG	7	Aesculus Glabra	Ohio Buckeye	70mm cal. WB	10m
CB	5	Carpinus betulus	European Hornbeam	70mm cal. WB	10m
CJ	6	Cercidiphyllum japonicum	Katsura Tree	70mm cal. WB	10m
CL	9	Cladrasis lutea	Yellow-wood	70mm cal. WB	10m
GB	7	Ginkgo biloba	Ginkgo Tree	70mm cal. WB	10m
GD	11	Gymnocladus dioicus 'Espresso'	Espresso Kentucky Coffee	70mm cal. WB	10m
GT	8	Gleditsia triacanthos 'Skyline'	Skyline Honeylocust	70mm cal. WB	10m
GS	9	Gleditsia triacanthos 'Shademaster'	Shademaster Honeylocust	70mm cal. WB	10m
LT	8	Liriodendron tulipifera	Tulip Tree	70mm cal. WB	10m
UM	9	Ulmus Acolade 'Morton'	Morton Elm	70mm cal. WB	10m
UP	10	Ulmus Americana 'Princeton'	Princeton Elm	70mm cal. WB	10m
TA	10	Tilia americana 'Redmond'	Redmond Basswood	70mm cal. WB	10m
TC	10	Tilia cordata	Little Leaf Linden	70mm cal. WB	10m
<b>DECIDUOUS SHRUBS</b>					
ace	7	Acer ginnala	Amur Maple	Multi-stem - 1.5m ht.	As Shown
ame	10	Amelanchier canadensis	Canadian Serviceberry	Multi-stem - 1.5m ht.	As Shown
cea	17	Ceanothus americanus	New Jersey Tea	2 gal. pot	0.6m
cer	3	Cercis canadensis	Eastern Redbud	Multi-stem - 1.5m ht.	As Shown
cor	12	Cornus sericea	Red osier Dogwood	2 gal. pot	1m
die	96	Dierilla lonicera	Northern Bush Honeysuckle	2 gal. pot	0.6m
fof	71	Fothergilla gardenii	Dwarf Fothergilla	2 gal. pot	0.75m
ham	5	Hamamelis virginiana	American Witch-hazel	Multi-stem - 1.5m ht.	As Shown
hya	39	Hydrangea arborescens 'Annabelle'	Annabelle Hydrangea	2 gal. pot	1m
hyp	20	Hydrangea paniculata 'Bombshell'	Bombshell Hydrangea	2 gal. pot	0.6m
hys	56	Hypericum perforatum	St. John's Wort	2 gal. pot	0.6m
rhu	161	Rhus aromatica 'Gro-Low'	Gro-Low Sumac	2 gal. pot	0.6m
rha	38	Rhus aromatica	Fragrant Sumac	2 gal. pot	1m
spa	24	Spiraea alba	Meadowsweet	2 gal. pot	0.75m
spi	39	Spiraea japonica 'Anthony Waterer'	Anthony Waterer Spirea	2 gal. pot	0.75m
<b>CONIFEROUS SHRUBS</b>					
bux	154	Buxus 'Green Velvet'	Green Velvet boxwood	2 gal. pot	0.6m
jun	55	Juniperus communis	Common Juniper	2 gal. pot	0.75m
pin	33	Pinus mugo 'Dwarf'	Dwarf Mugo Pine	2 gal. pot	0.75m
tax	106	Taxus x media 'Andersonii'	Anderson Yew	2 gal. pot	0.75m
<b>GRASSES</b>					
and	43	Andropogon gerardii	Big Bluestem	1 gal. pot	0.6m
car	252	Carex pensylvanica	Oak Sedge	1 gal. pot	0.5m
cal	24	Calamagrostis acutiflora	Karl Forester	1 gal. pot	0.6m
pan	24	Panicum virgatum	Switchgrass	1 gal. pot	0.6m
<b>PERENNIALS</b>					
ech	102	Echinacea purpurea	Purple Coneflower	1 gal. pot	0.45m
hem	203	Hemerocallis 'Stella d'Oro'	Stella d'Oro Daylily	1 gal. pot	0.45m
mon	113	Monarda 'Balmy Purple'	Balmy Purple Bee Balm	1 gal. pot	0.45m
rud	208	Rudbeckia hirta	Black-eyed Susan	1 gal. pot	0.45m

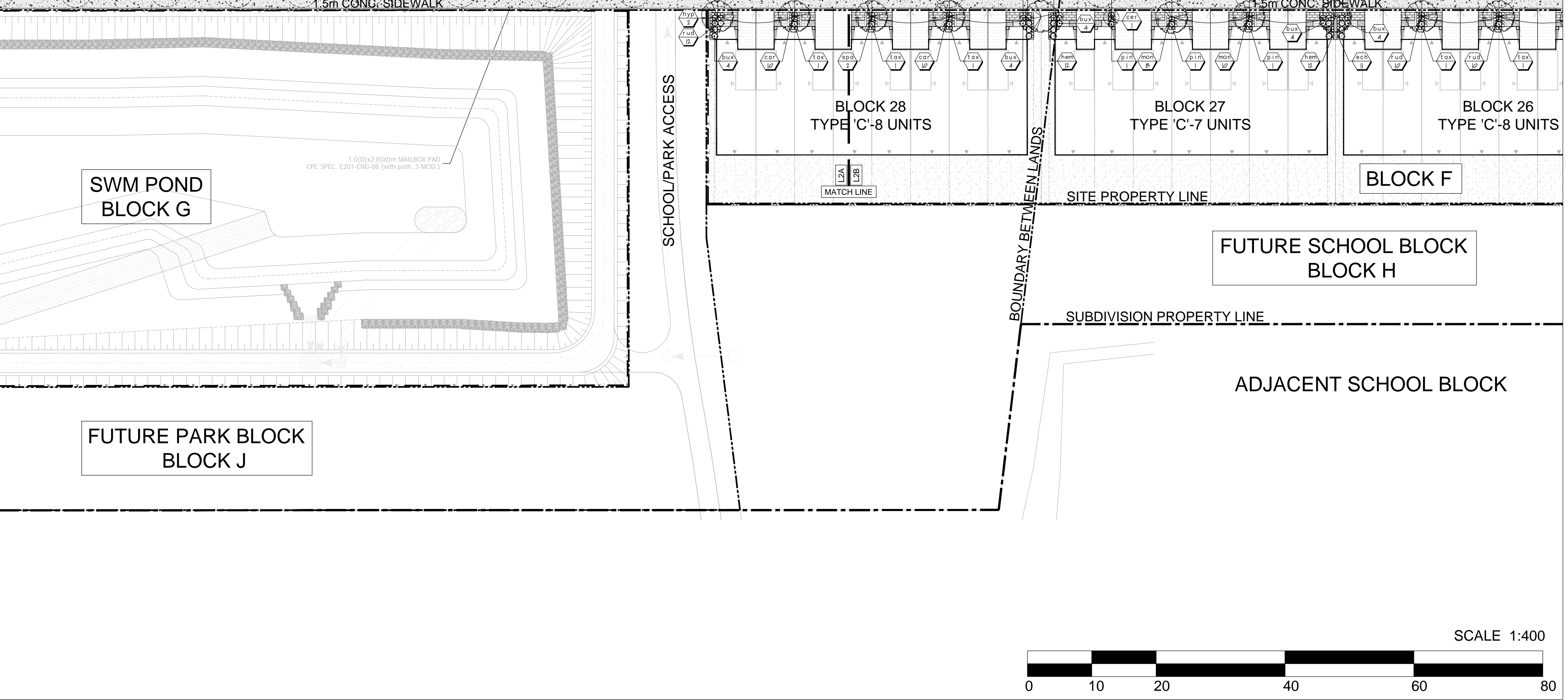

KEY MAP: NTS

**LEGEND:**

- SUBDIVISION PROPERTY LINE
- - - SITE PLAN PROPERTY LINE
- 2.4m WOOD ACOUSTIC FENCE
- 1.2m DECORATIVE METAL FENCE
- 1.2m CHAINLINK FENCE
- 1.8m CHAINLINK FENCE
- SOI
- ▨ RIVER ROCK
- ▨ ASPHALT DRIVE, REFER TO CIVIL
- ▨ PROPOSED UNIT PAVING
- ▨ CONCRETE SIDEWALK, REFER TO CIVIL
- PROPOSED CONIFEROUS SHRUB
- PROPOSED DECIDUOUS SHRUB
- PROPOSED PERENNIAL/GRASS
- PROPOSED MULTI-STEM SHRUB
- PROPOSED DECIDUOUS TREES
- ▨ PROPOSED ARMOUR STONE
- SPECIES QUANTITY - PROPOSED TREE KEY
- SPECIES QUANTITY - PROPOSED SHRUB KEY
- DOUBLE/SINGLE CATCH BASIN, REFER TO CIVIL
- ◆ FIRE HYDRANT, REFER TO CIVIL
- ◆ STREET LIGHT, REFER TO CIVIL
- ◆ TRANSFORMER, REFER TO CIVIL
- ▨ TACTILE PAD, REFER TO CIVIL
- ▨ CURB CUT, REFER TO CIVIL

R3	RE-ISSUED FOR REVIEW	2024/01/09	SS
R2	ISSUED FOR REVIEW	2023/12/14	SS
R1	SITE PLAN PRE-SUBMISSION REVIEW	2023/06/23	HP
no.	revision	date	by

THESE DRAWINGS ARE THE PROPERTY OF CGLA CONSULTANTS INC. AND SHALL NOT BE ALTERED, MODIFIED, REPRODUCED, COPIED, OR CHANGED WITHOUT THE WRITTEN CONSENT OF CGLA CONSULTANTS INC. SEAL IS NOT VALID WITHOUT SIGNATURE OF THE LANDSCAPE ARCHITECT. DRAWINGS CANNOT BE USED FOR TENDER/CONSTRUCTION UNLESS SIGNED BY LANDSCAPE ARCHITECT.

30 CENTURIAN DRIVE, UNIT 105  
MARKHAM, ONTARIO, L3R 8B8  
Telephone: 905-475-6988 Email: info@cgl.ca www.cgl.ca

Client:  
**CRYSTAL HOMES**

Project Title:  
**OAKBROOK, BLOCK 1 & 2 SITE PLAN**

TOWN OF OAKVILLE

Drawing Title:  
**PLANTING PLAN**

Reviewed:	HP	Drawn:	AN
Scale:	1:400	Date:	06/13/23
Project Number:	2693-SP		
Drawing Number	<b>L2A</b>		



BURNHAMTHORPE ROAD

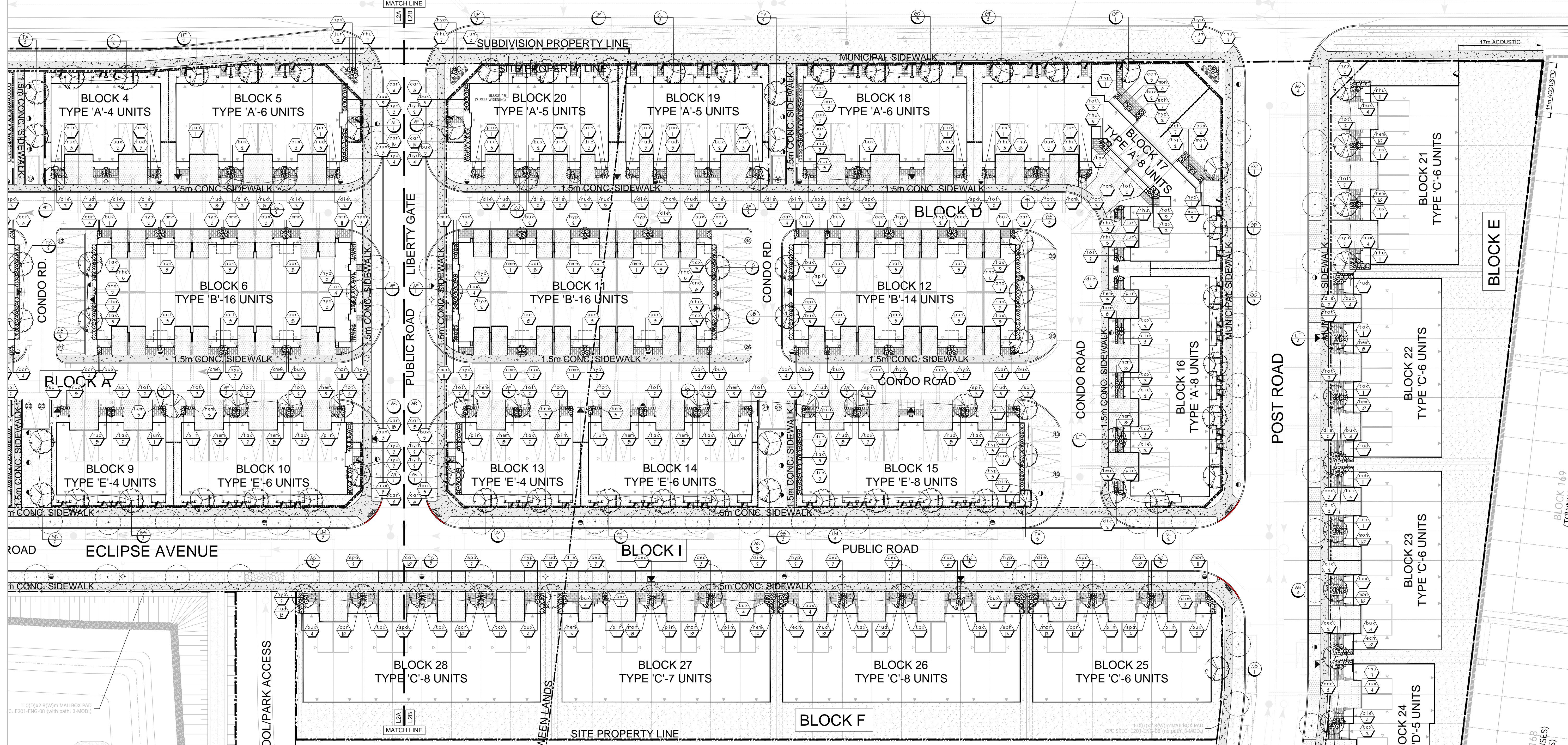

**PROPOSED PLANT LIST**

KEY	QTY	BOTANICAL NAME	COMMON NAME	SIZE/ CONDITION	SPACING O/C
<b>DECIDUOUS TREES</b>					
AR	13	Acer rubrum	Red Maple	70mm cal. WB	10m
AF	11	Acer x freemanii 'Celebration'	Celebration maple	70mm cal. WB	10m
AC	9	Aesculus camea 'Briotii'	Ruby-Red Horsechestnut	70mm cal. WB	10m
AG	7	Aesculus Glabra	Ohio Buckeye	70mm cal. WB	10m
CB	5	Carpinus betulus	European Hornbeam	70mm cal. WB	10m
CJ	6	Cercidiphyllum japonicum	Katsura Tree	70mm cal. WB	10m
CL	9	Cladrasis lutea	Yellow-wood	70mm cal. WB	10m
GB	7	Ginkgo biloba	Ginkgo Tree	70mm cal. WB	10m
GD	11	Gymnocladus dioicus 'Espresso'	Espresso Kentucky Coffee	70mm cal. WB	10m
GS	8	Gleditsia triacanthos 'Skyline'	Skyline Honeylocust	70mm cal. WB	10m
GT	9	Gleditsia triacanthos 'Shademaker'	Shademaker Honeylocust	70mm cal. WB	10m
LS	8	Liriodendron tulipifera	Tulip Tree	70mm cal. WB	10m
UM	9	Ulmus Acolade 'Morton'	Morton Elm	70mm cal. WB	10m
UP	10	Ulmus Americana 'Princeton'	Princeton Elm	70mm cal. WB	10m
TA	10	Tilia americana 'Redmond'	Redmond Basswood	70mm cal. WB	10m
TC	10	Tilia cordata	Little Leaf Linden	70mm cal. WB	10m

**PROPOSED PLANT LIST**

KEY	QTY	BOTANICAL NAME	COMMON NAME	SIZE/ CONDITION	SPACING O/C
<b>DECIDUOUS SHRUBS</b>					
ace	13	Acer ginnala	Amur Maple	Multi-stem - 1.5m ht.	As Shown
ame	10	Amelanchier canadensis	Canadian Serviceberry	Multi-stem - 1.5m ht.	As Shown
cea	17	Ceanothus americanus	New Jersey Tea	2 gal. pot	0.6m
cer	3	Cercis canadensis	Eastern Redbud	Multi-stem - 1.5m ht.	As Shown
cor	12	Comus sericea	Red osier Dogwood	2 gal. pot	1m
die	96	Dienella lonicera	Northern Bush Honeysuckle	2 gal. pot	0.6m
fof	71	Fothergilla gardenii	Dwarf Fothergilla	2 gal. pot	0.75m
ham	5	Hamamelis virginiana	American Witch-hazel	Multi-stem - 1.5m ht.	As Shown
hya	39	Hydrangea arborescens 'Annabelle'	Annabelle Hydrangea	2 gal. pot	1m
hyd	20	Hydrangea paniculata 'Bombshell'	Bombshell Hydrangea	2 gal. pot	0.6m
hyp	56	Hypericum perforatum	St. John's-Wort	2 gal. pot	0.6m
rhu	161	Rhus aromatica 'Gro-Low'	Gro-Low Sumac	2 gal. pot	0.6m
rha	38	Rhus aromatica	Fragrant Sumac	2 gal. pot	1m
spa	24	Spiraea alba	Meadowsweet	2 gal. pot	0.75m
spi	39	Spiraea japonica 'Anthony Waterer'	Anthony Waterer Spirea	2 gal. pot	0.75m
<b>CONIFEROUS SHRUBS</b>					
bux	154	Buxus 'Green Velvet'	Green Velvet boxwood	2 gal. pot	0.6m
jun	55	Juniperus communis	Common Juniper	2 gal. pot	0.75m
pin	33	Pinus mugo 'Dwarf'	Dwarf Mugo Pine	2 gal. pot	0.75m
tax	106	Taxus x media 'Andersonii'	Anderson Yew	2 gal. pot	0.75m
<b>GRASSES</b>					
and	43	Andropogon gerardii	Big Bluestem	1 gal. pot	0.6m
car	252	Carex pensylvanica	Oak Sedge	1 gal. pot	0.5m
cal	24	Calamagrostis acutiflora	Karl Forester	1 gal. pot	0.6m
pan	24	Panicum virgatum	Switchgrass	1 gal. pot	0.6m
<b>PERENNIALS</b>					
ech	102	Echinacea purpurea	Purple Coneflower	1 gal. pot	0.45m
hem	203	Hemerocallis 'Stella d'Oro'	Stella d'Oro Daylily	1 gal. pot	0.45m
mon	113	Monarda 'Balm Purple'	Balm Purple Bee Balm	1 gal. pot	0.45m
nud	208	Rudbeckia hirta	Black-eyed Susan	1 gal. pot	0.45m

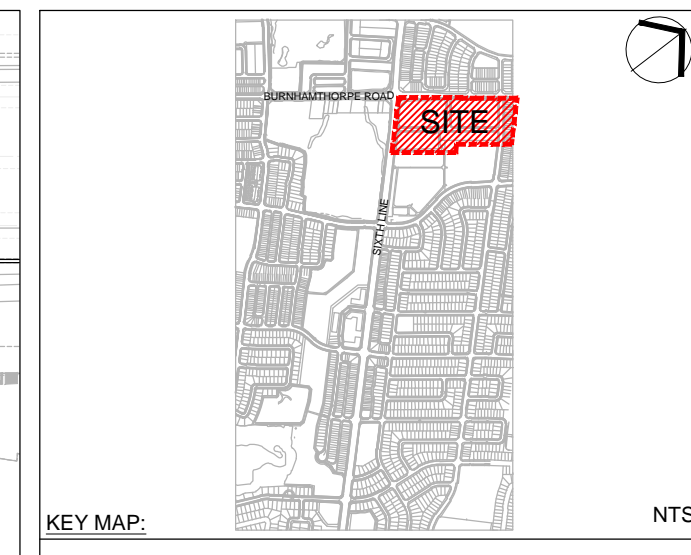

- LEGEND:**
- SUBDIVISION PROPERTY LINE
  - SITE PLAN PROPERTY LINE
  - 2.4m WOOD ACOUSTIC FENCE
  - 1.2m DECORATIVE METAL FENCE
  - 1.2m CHAINLINK FENCE
  - 1.8m CHAINLINK FENCE
  - SOD
  - RIVER ROCK
  - ASPHALT DRIVE, REFER TO CIVIL
  - PROPOSED UNIT PAVING
  - CONCRETE SIDEWALK, REFER TO CIVIL
  - PROPOSED CONIFEROUS SHRUB
  - PROPOSED DECIDUOUS SHRUB
  - PROPOSED PERENNIAL/GRASS
  - PROPOSED MULTI-STEM SHRUB
  - PROPOSED SUBDIVISION DECIDUOUS STREET TREE
  - PROPOSED DECIDUOUS TREES
  - PROPOSED TREE KEY
  - PROPOSED ARMOUR STONE
  - SPECIES QUANTITY
  - PROPOSED SHRUB KEY
  - SPECIES QUANTITY
  - DOUBLE/SINGLE CATCH BASIN, REFER TO CIVIL
  - FIRE HYDRANT, REFER TO CIVIL
  - STREET LIGHT, REFER TO CIVIL
  - TRANSFORMER, REFER TO CIVIL
  - TACTILE PAD, REFER TO CIVIL
  - CURB CUT, REFER TO CIVIL

R3	RE ISSUED FOR REVIEW	2024.01.09	SS
R2	ISSUED FOR REVIEW	2023.12.14	SS
R1	SITE PLAN PRE-SUBMISSION REVIEW	2023.06.23	HP
no.	revision	date	by

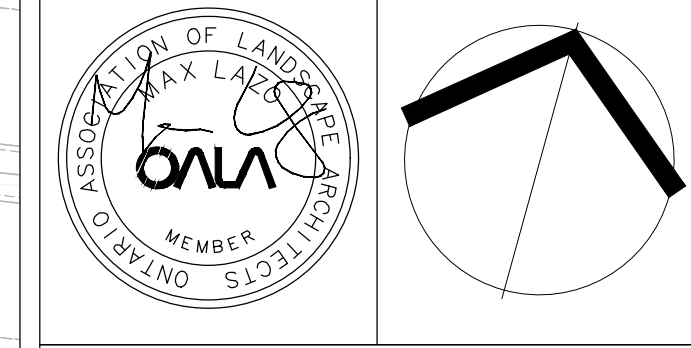

**CGLA**  
30 CENTURIAN DRIVE, UNIT 105  
MARKHAM, ONTARIO, L3R 8B8  
Telephone: 905-475-6988 Email: info@cgl.ca www.cgl.ca

Client:  
**CRYSTAL HOMES**

Project Title:  
**OAKBROOK, BLOCK 1 & 2  
SITE PLAN**

TOWN OF OAKVILLE

Drawing Title:  
**PLANTING  
PLAN**

Reviewed: HP Drawn: AN

Scale: 1:400 Date: 06/13/23

Project Number: 2693-SP

Drawing Number

SCALE 1:400



L2B



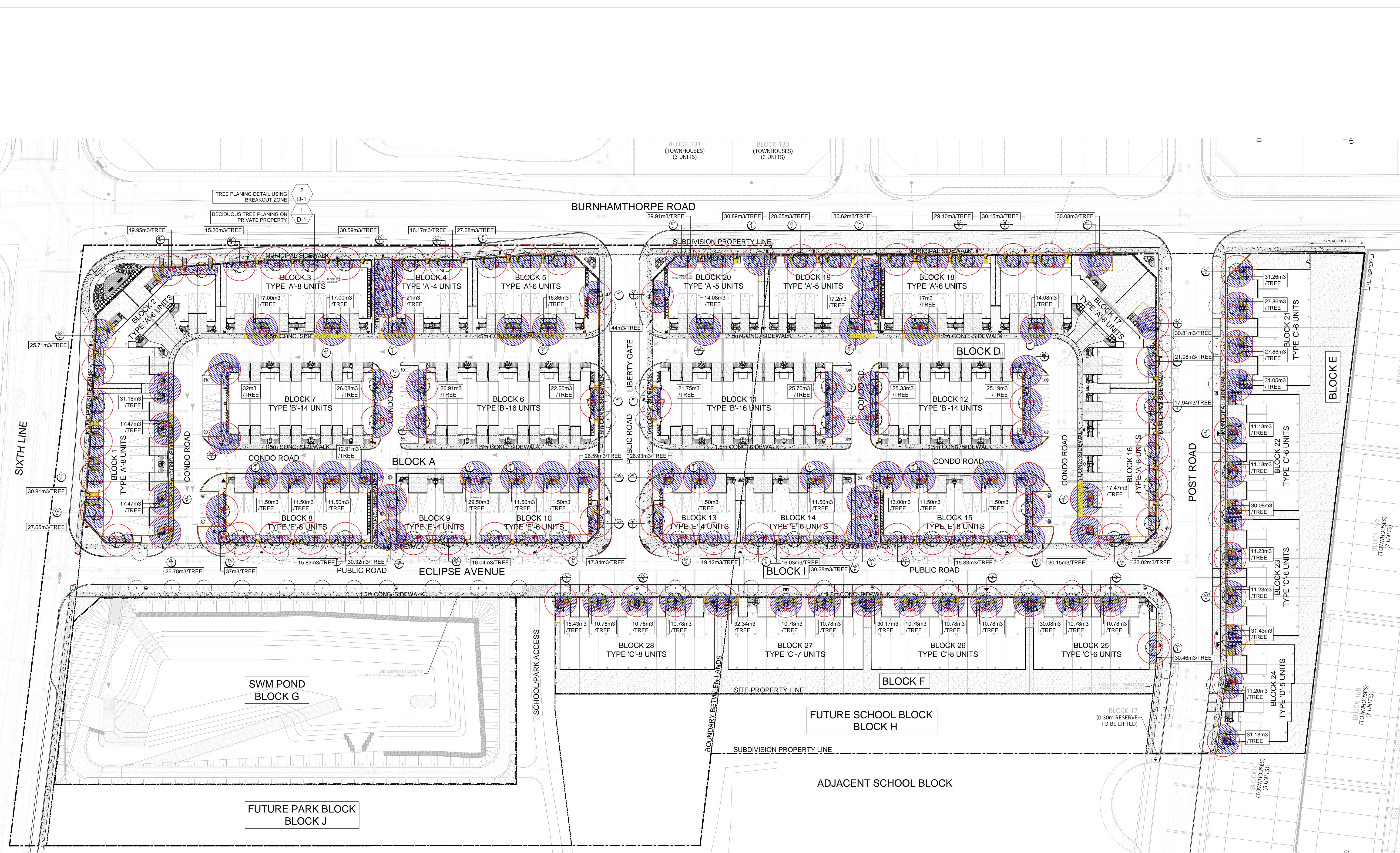

NOTE:  
FOR TREE CANOPY CALCULATION CHART, REFER TO L3B.

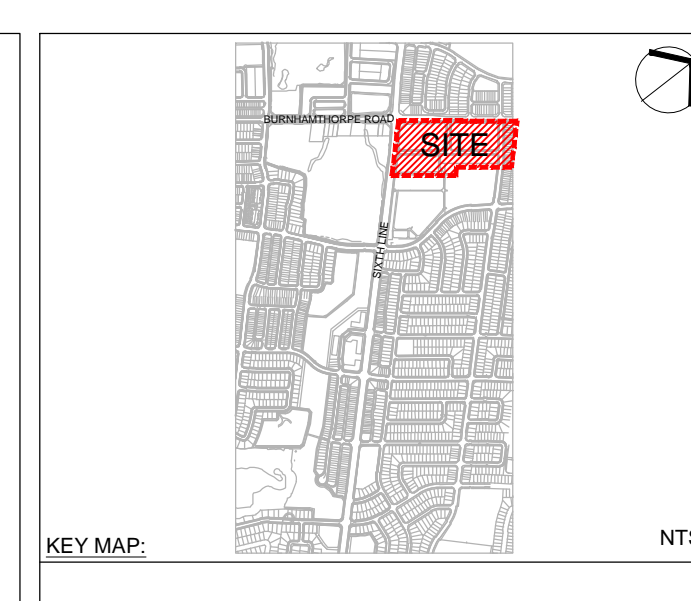

- LEGEND:**
- SUBDIVISION PROPERTY LINE
  - SITE PLAN PROPERTY LINE
  - 2.4m WOOD ACOUSTIC FENCE
  - 1.2m DECORATIVE METAL FENCE
  - 1.2m CHAINLINK FENCE
  - 1.8m CHAINLINK FENCE
  - PROPOSED SOIL ZONE
  - SOD
  - RIVER ROCK
  - ASPHALT DRIVE, REFER TO CIVIL
  - PROPOSED UNIT PAVING
  - CONCRETE SIDEWALK, REFER TO CIVIL
  - BREAKOUT ZONE
  - PROPOSED CONIFEROUS SHRUB
  - PROPOSED DECIDUOUS SHRUB
  - PROPOSED PERENNIAL/GRASS
  - PROPOSED MULTI-STEM SHRUB
  - PROPOSED SUBDIVISION DECIDUOUS STREET TREE
  - PROPOSED DECIDUOUS TREES
  - PROPOSED ARMOUR STONE
  - PROPOSED CANOPY AREA
  - PROPOSED CROWN AREA
  - PROPOSED TREE NUMBER
  - SPECIES QUANTITY PROPOSED TREE KEY
  - DOUBLE/SINGLE CATCH BASIN, REFER TO CIVIL
  - FIRE HYDRANT, REFER TO CIVIL
  - STREET LIGHT, REFER TO CIVIL
  - TRANSFORMER, REFER TO CIVIL
  - TACTILE PAD, REFER TO CIVIL
  - CURB CUT, REFER TO CIVIL

R3	RE ISSUED FOR REVIEW	2024.01.09	SS
R2	ISSUED FOR REVIEW	2023.12.14	SS
R1	SITE PLAN PRE-SUBMISSION REVIEW	2023.06.23	HP
no.	revision	date	by

THESE DRAWINGS ARE THE PROPERTY OF CGLA CONSULTANTS INC. AND SHALL NOT BE ALTERED, MODIFIED, REVISED OR CHANGED WITHOUT THE WRITTEN CONSENT OF CGLA CONSULTANTS INC. THIS IS NOT VALID WITHOUT SIGNATURE OF THE LANDSCAPE ARCHITECT. DRAWINGS CANNOT BE USED FOR TENDER/CONSTRUCTION UNLESS SIGNED BY LANDSCAPE ARCHITECT.

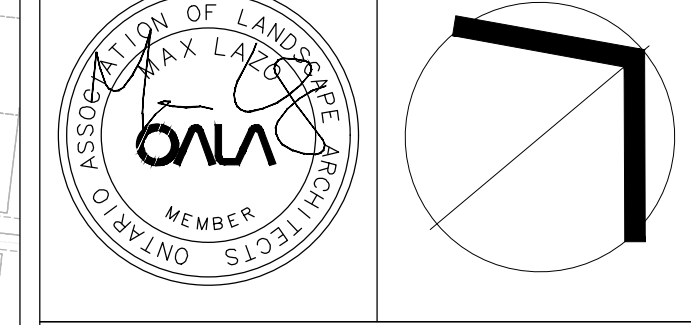

**CGLA**  
30 CENTURIAN DRIVE, UNIT 105  
MARKHAM, ONTARIO, L3R 8B8  
Telephone: 905-475-6988 Email: info@cgl.ca www.cgl.ca

Client:  
**CRYSTAL HOMES**

Project Title:  
**OAKBROOK, BLOCK 1 & 2  
SITE PLAN**

TOWN OF OAKVILLE

Drawing Title:  
**TREE CANOPY PLAN**

Reviewed: HP Drawn: AN

Scale: 1:550 Date: 06/13/23

Project Number: 2693-SP

Drawing Number  
**L3A**

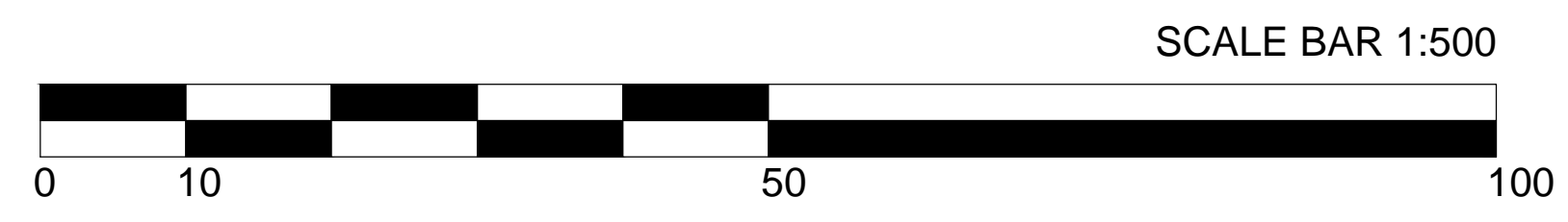



**CANOPY CALCULATION CHART - SITE PLAN CONTROL**  
 File Project Number: 2639-SP  
 File Name: Oakbrook Oakville (Block 1 & 2)  
 City File Number:  
 Canopy Cover Target: 20% (Residential)

TREE KEY	BOTANICAL NAME	COMMON NAME	SIZE/ CONDITION	SPACING O/C	TREE NO.(T)	QTY.	STATURE (S.M.L)	SOIL VOL. PER PLANT ZONE (m3)	SOIL VOL. PER TREE (m3)	CROWN AREA PER TREE (m2)	CANOPY AREA (m2)	CANOPY AREA SUB-TOTAL (m2)
<b>MEDIUM STATURE TREES (10-13m SPREAD)</b>												
CL	Cladrastis lutea	Yellow-wood	70mm cal. WB	10m	T1-T2	2	M	55.29	27.65	78.50	157.00	
GS	Gleditsia triacanthos 'Shademaster'	Shademaster Honeylocust	70mm cal. WB	10m	T3-T5	3	M	92.73	30.91	78.50	235.50	
GD	Gymnocladus dioicus 'Espresso'	Espresso Kentucky Coffee	70mm cal. WB	10m	T6-T7	2	M	51.42	25.71	78.50	157.00	
GT	Gleditsia triacanthos 'Skyline'	Skyline Honeylocust	70mm cal. WB	10m	T8-T9	2	M	39.9	19.95	78.50	157.00	
GD	Gymnocladus dioicus 'Espresso'	Espresso Kentucky Coffee	70mm cal. WB	10m	T10-T13	4	M	60.8	15.20	78.50	314.00	
CL	Cladrastis lutea	Yellow-wood	70mm cal. WB	10m	T14-T15	2	M	32.34	16.17	78.50	157.00	
UP	Ulmus Americana 'Princeton'	Princeton Elm	70mm cal. WB	10m	T16-T18	3	M	83.03	27.68	78.50	235.50	
UP	Ulmus Americana 'Princeton'	Princeton Elm	70mm cal. WB	10m	T19-T20	2	M	59.82	29.91	78.50	157.00	
UP	Ulmus Americana 'Princeton'	Princeton Elm	70mm cal. WB	10m	T21	1	M	30.89	30.89	78.50	78.50	
CL	Cladrastis lutea	Yellow-wood	70mm cal. WB	10m	T22-T23	2	M	57.30	28.65	78.50	157.00	
TA	Tilia americana "Redmond"	Redmond Basswood	70mm cal. WB	10m	T24-T25	2	M	61.24	30.62	78.50	157.00	
GD	Gymnocladus dioicus 'Espresso'	Espresso Kentucky Coffee	70mm cal. WB	10m	T26-T28	3	M	87.3	29.10	78.50	235.50	
GT	Gleditsia triacanthos 'Skyline'	Skyline Honeylocust	70mm cal. WB	10m	T29-T30	2	M	60.30	30.15	78.50	157.00	
GT	Gleditsia triacanthos 'Skyline'	Skyline Honeylocust	70mm cal. WB	10m	T31	1	M	30.08	30.08	78.50	78.50	
GD	Gymnocladus dioicus 'Espresso'	Espresso Kentucky Coffee	70mm cal. WB	10m	T32	1	M	30.81	30.81	78.50	78.50	
GD	Gymnocladus dioicus 'Espresso'	Espresso Kentucky Coffee	70mm cal. WB	10m	T33	1	M	21.08	21.08	78.50	78.50	
GS	Gleditsia triacanthos 'Shademaster'	Shademaster Honeylocust	70mm cal. WB	10m	T34-T37	4	M	71.77	17.94	78.50	314.00	
CL	Cladrastis lutea	Yellow-wood	70mm cal. WB	10m	T38-T39	2	M	46.04	23.02	78.50	157.00	
UM	Ulmus Acolade 'Morton'	Morton Elm	70mm cal. WB	10m	T40-T43	4	M	63.33	15.83	78.50	314.00	
GT	Gleditsia triacanthos 'Skyline'	Skyline Honeylocust	70mm cal. WB	10m	T44-T46	3	M	48.08	16.03	78.50	235.50	
UM	Ulmus Acolade 'Morton'	Morton Elm	70mm cal. WB	10m	T47-T48	2	M	38.24	19.12	78.50	157.00	
UM	Ulmus Acolade 'Morton'	Morton Elm	70mm cal. WB	10m	T49-T51	3	M	53.52	17.84	78.50	235.50	
GS	Gleditsia triacanthos 'Shademaster'	Shademaster Honeylocust	70mm cal. WB	10m	T52-T53	2	M	32.07	16.04	78.50	157.00	
UP	Ulmus Americana 'Princeton'	Princeton Elm	70mm cal. WB	10m	T54-T57	4	M	63.31	15.83	78.50	314.00	
TA	Tilia americana "Redmond"	Redmond Basswood	70mm cal. WB	10m	T58-T59	2	M	74	37.00	78.50	157.00	
AR	Acer rubrum	Red Maple	70mm cal. WB	10m	T60	1	M	11.50	11.50	78.50	78.50	
AR	Acer rubrum	Red Maple	70mm cal. WB	10m	T61	1	M	11.50	11.50	78.50	78.50	
AR	Acer rubrum	Red Maple	70mm cal. WB	10m	T62	1	M	11.50	11.50	78.50	78.50	
AR	Acer rubrum	Red Maple	70mm cal. WB	10m	T63	1	M	12.91	12.91	78.50	78.50	
GB	Ginkgo biloba	Ginkgo Tree	70mm cal. WB	10m	T64-T65	2	M	60.64	30.32	78.50	157.00	
CJ	Cercidiphyllum japonicum	Katsura Tree	70mm cal. WB	10m	T66	1	M	29.50	29.50	78.50	78.50	
AF	Acer x freemaniai 'Celebration'	Celebration Maple	70mm cal. WB	10m	T67	1	M	11.50	11.50	78.50	78.50	
AF	Acer x freemaniai 'Celebration'	Celebration Maple	70mm cal. WB	10m	T68	1	M	11.50	11.50	78.50	78.50	
AR	Acer rubrum	Red Maple	70mm cal. WB	10m	T69-T70	2	M	53.18	26.59	78.50	157.00	
AR	Acer rubrum	Red Maple	70mm cal. WB	10m	T71-T72	2	M	53.86	26.93	78.50	157.00	
AF	Acer x freemaniai 'Celebration'	Celebration Maple	70mm cal. WB	10m	T73	1	M	11.50	11.50	78.50	78.50	
CJ	Cercidiphyllum japonicum	Katsura Tree	70mm cal. WB	10m	T74	1	M	11.50	11.50	78.50	78.50	
GB	Ginkgo biloba	Ginkgo Tree	70mm cal. WB	10m	T75-T76	2	M	60.56	30.28	78.50	157.00	
CJ	Cercidiphyllum japonicum	Katsura Tree	70mm cal. WB	10m	T77	1	M	13.00	13.00	78.50	78.50	
AR	Acer rubrum	Red Maple	70mm cal. WB	10m	T78	1	M	11.50	11.50	78.50	78.50	
AR	Acer rubrum	Red Maple	70mm cal. WB	10m	T79	1	M	11.50	11.50	78.50	78.50	
TA	Tilia americana "Redmond"	Redmond Basswood	70mm cal. WB	10m	T80-T82	3	M	90.46	30.15	78.50	235.50	
LT	Liriodendron tulipifera	Tulip Tree	70mm cal. WB	10m	T83	1	M	17.47	17.47	78.50	78.50	
AR	Acer rubrum	Red Maple	70mm cal. WB	10m	T84	1	M	14.08	14.08	78.50	78.50	
AF	Acer x freemaniai 'Celebration'	Celebration Maple	70mm cal. WB	10m	T85	1	M	17.00	17.00	78.50	78.50	
AF	Acer x freemaniai 'Celebration'	Celebration Maple	70mm cal. WB	10m	T86	1	M	17.20	17.20	78.50	78.50	
CJ	Cercidiphyllum japonicum	Katsura Tree	70mm cal. WB	10m	T87	1	M	14.08	14.08	78.50	78.50	

AF	Acer x freemaniai 'Celebration'	Celebration Maple	70mm cal. WB	10m	T88	1	M	44.00	44.00	78.50	78.50		
AF	Acer x freemaniai 'Celebration'	Celebration Maple	70mm cal. WB	10m	T89	1	M	37.00	37.00	78.50	78.50		
CJ	Carpinus caroliniana	American hornbeam	70mm cal. WB	10m	T90-T91	2	M	33.72	16.86	78.50	157.00		
AF	Acer x freemaniai 'Celebration'	Celebration Maple	70mm cal. WB	10m	T92	1	M	21.00	21.00	78.50	78.50		
TA	Tilia americana "Redmond"	Redmond Basswood	70mm cal. WB	10m	T93-T94	2	M	61.18	30.59	78.50	157.00		
AR	Acer rubrum	Red Maple	70mm cal. WB	10m	T95	1	M	17.00	17.00	78.50	78.50		
AR	Acer rubrum	Red Maple	70mm cal. WB	10m	T96	1	M	17.00	17.00	78.50	78.50		
LT	Liriodendron tulipifera	Tulip Tree	70mm cal. WB	10m	T97	1	M	31.18	31.18	78.50	78.50		
LT	Liriodendron tulipifera	Tulip Tree	70mm cal. WB	10m	T98	1	M	17.47	17.47	78.50	78.50		
LT	Liriodendron tulipifera	Tulip Tree	70mm cal. WB	10m	T99	1	M	17.47	17.47	78.50	78.50		
CL	Cladrastis lutea	Yellow-wood	70mm cal. WB	10m	T100	1	M	26.78	26.78	78.50	78.50		
GB	Ginkgo biloba	Ginkgo Tree	70mm cal. WB	10m	T101-T102	2	M	64.00	32.00	78.50	157.00		
TC	Tilia cordata	Little Leaf Linden	70mm cal. WB	10m	T103-T104	2	M	52.16	26.08	78.50	157.00		
CB	Carpinus betulus	European Hornbeam	70mm cal. WB	10m	T105-T106	2	M	53.82	26.91	78.50	157.00		
AF	Acer x freemaniai 'Celebration'	Celebration Maple	70mm cal. WB	10m	T107	1	M	22.00	22.00	78.50	78.50		
AF	Acer x freemaniai 'Celebration'	Celebration Maple	70mm cal. WB	10m	T108	1	M	21.75	21.75	78.50	78.50		
TC	Tilia cordata	Little Leaf Linden	70mm cal. WB	10m	T109-T110	2	M	51.40	25.70	78.50	157.00		
CB	Carpinus betulus	European Hornbeam	70mm cal. WB	10m	T111-T112	2	M	50.66	25.33	78.50	157.00		
GB	Ginkgo biloba	Ginkgo Tree	70mm cal. WB	10m	T113-T115	3	M	75.56	25.19	78.50	235.50		
AC	Aesculus carnea 'Briotii'	Ruby-Red Horsechestnut	70mm cal. WB	10m	T116	1	M	31.26	31.26	78.50	78.50		
AC	Aesculus carnea 'Briotii'	Ruby-Red Horsechestnut	70mm cal. WB	10m	T117	1	M	27.86	27.86	78.50	78.50		
AC	Aesculus carnea 'Briotii'	Ruby-Red Horsechestnut	70mm cal. WB	10m	T118	1	M	27.86	27.86	78.50	78.50		
AC	Aesculus carnea 'Briotii'	Ruby-Red Horsechestnut	70mm cal. WB	10m	T119	1	M	31.05	31.05	78.50	78.50		
LT	Liriodendron tulipifera	Tulip Tree	70mm cal. WB	10m	T120	1	M	11.18	11.18	78.50	78.50		
LT	Liriodendron tulipifera	Tulip Tree	70mm cal. WB	10m	T121	1	M	11.18	11.18	78.50	78.50		
LT	Liriodendron tulipifera	Tulip Tree	70mm cal. WB	10m	T122	1	M	30.08	30.08	78.50	78.50		
LT	Liriodendron tulipifera	Tulip Tree	70mm cal. WB	10m	T123	1	M	11.23	11.23	78.50	78.50		
AG	Aesculus Glabra	Ohio Buckeye	70mm cal. WB	10m	T124	1	M	11.23	11.23	78.50	78.50		
AG	Aesculus Glabra	Ohio Buckeye	70mm cal. WB	10m	T125	1	M	31.43	31.43	78.50	78.50		
AG	Aesculus Glabra	Ohio Buckeye	70mm cal. WB	10m	T126	1	M	11.20	11.20	78.50	78.50		
AG	Aesculus Glabra	Ohio Buckeye	70mm cal. WB	10m	T127	1	M	31.18	31.18	78.50	78.50		
CB	Carpinus betulus	European Hornbeam	70mm cal. WB	10m	T128	1	M	30.46	30.46	78.50	78.50		
AC	Aesculus carnea 'Briotii'	Ruby-Red Horsechestnut	70mm cal. WB	10m	T129	1	M	10.78	10.78	78.50	78.50		
AC	Aesculus carnea 'Briotii'	Ruby-Red Horsechestnut	70mm cal. WB	10m	T130	1	M	10.78	10.78	78.50	78.50		
AC	Aesculus carnea 'Briotii'	Ruby-Red Horsechestnut	70mm cal. WB	10m	T131	1	M	30.08	30.08	78.50	78.50		
TC	Tilia cordata	Little Leaf Linden	70mm cal. WB	10m	T132	1	M	10.78	10.78	78.50	78.50		
TC	Tilia cordata	Little Leaf Linden	70mm cal. WB	10m	T133	1	M	10.78	10.78	78.50	78.50		
TC	Tilia cordata	Little Leaf Linden	70mm cal. WB	10m	T134	1	M	10.78	10.78	78.50	78.50		
AG	Aesculus Glabra	Ohio Buckeye	70mm cal. WB	10m	T135	1	M	30.17	30.17	78.50	78.50		
AG	Aesculus Glabra	Ohio Buckeye	70mm cal. WB	10m	T136	1	M	10.78	10.78	78.50	78.50		
AG	Aesculus Glabra	Ohio Buckeye	70mm cal. WB	10m	T137	1	M	10.78	10.78	78.50	78.50		
TC	Tilia cordata	Little Leaf Linden	70mm cal. WB	10m	T138	1	M	32.34	32.34	78.50	78.50		
TC	Tilia cordata	Little Leaf Linden	70mm cal. WB	10m	T139	1	M	10.78	10.78	78.50	78.50		
TC	Tilia cordata	Little Leaf Linden	70mm cal. WB	10m	T140	1	M	10.78	10.78	78.50	78.50		
AC	Aesculus carnea 'Briotii'	Ruby-Red Horsechestnut	70mm cal. WB	10m	T141	1	M	10.78	10.78	78.50	78.50		
AC	Aesculus carnea 'Briotii'	Ruby-Red Horsechestnut	70mm cal. WB	10m	T142	1	M	15.43	15.43	78.50	78.50		
<b>TOTAL NO. OF TREES:</b>											<b>142</b>	<b>SUBTOTAL OF PROPOSED CANOPY:</b>	<b>11,147.00</b>

<b>EXISTING CANOPY ON SITE</b>													
/	/	/	/	/	/	/	/	/	/	/	/	/	
/	/	/	/	/	/	/	/	/	/	/	/	/	
/	/	/	/	/	/	/	/	/	/	/	/	/	
<b>SUBTOTAL OF EXISTING CANOPY:</b>											<b>0.00</b>		
<b>MULTIPLIED BY BONUS FACTOR OF 1.5:</b>											<b>0.00</b>		
<b>EXISTING CANOPY OVERHANGING SITE</b>													
/	/	/	/	/	/	/	/	/	/	/	/	/	
/	/	/	/	/	/	/	/	/	/	/	/	/	
/	/	/	/	/	/	/	/	/	/	/	/	/	
<b>SUBTOTAL OF EXISTING OVERHANGING CANOPY:</b>											<b>0.00</b>		
<b>TOTAL PROPOSED CANOPY OVERLAP AREA (m2)</b>											<b>83.00</b>		
<b>TOTAL PROPOSED CANOPY OVERHANGING PROJECT SITE/BUILDING (m2)</b>											<b>4,391.39</b>		
<b>TOTAL CANOPY AREA (m2):</b>											<b>6,672.81</b>		

<b>CANOPY SUMMARY:</b>	
TOTAL SITE AREA (m2):	38,910.92
SITE CANOPY COVER(%):	17.15
CANOPY COVER TARGET BY LAND USE (%):	20.00
<b>PARKING AREA SUMMARY:</b>	
TOTAL PARKING SPACES PROPOSED:	46
TOTAL NUMBER OF TREES IN OR WITHIN 5m OF PARKING AREA:	27

NOTE:  
FOR TREE CANOPY PLAN, REFER TO L3A.



KEY MAP:

NTS

LEGEND:



GENERAL NOTES FOR TREE PLANTING

SPECIES AND STANDARDS OF TREES

FINAL TREE SPECIES CHOICE IS TO BE APPROVED BY DEVELOPMENT ENGINEERING URBAN FORESTRY. SPECIES AND CULTIVARS OF TREES, AS WELL AS THE STANDARD FOR THAT SPECIES AND CULTIVAR ARE TO COMPLY WITH THE CANADIAN STANDARDS FOR NURSERY STOCK, CANADIAN NURSERY LANDSCAPE ASSOCIATION, AS REVISED.

ORIGIN

INFORMATION CONCERNING THE GEOGRAPHICAL ORIGIN OF SEED OR CUTTINGS USED TO PRODUCE THE TREES USED IN THIS CONTRACT SHALL BE MADE AVAILABLE TO DEVELOPMENT ENGINEERING URBAN FORESTRY ON DEMAND. IF THE PLANT MATERIAL IS OF AN ORIGIN UNSUITABLE CLIMATICALLY TO THE OAKVILLE AREA IN THE OPINION OF DEV. ENG. URBAN FORESTRY, IT WILL BE REFUSED.

FORM AND VIGOUR OF TREES

ALL TREES SHALL BE TRUE TO TYPE, STRUCTURALLY SOUND WITH NO EVIDENCE OF DEAD BRANCHES, SUNSCALD, FROST CRACKS, ABRADED OR BROKEN BARK AND BE FREE OF INSECT OR DISEASE INFESTATION. ALL TREES SHALL HAVE FULL, WELL DEVELOPED CROWNS WITH ONE DISTINCTIVE VERTICAL LEADER, AND ROOT SYSTEM TYPICAL OF THE SPECIES. ALL PARTS SHALL BE MOIST AND SHOW ACTIVE GREEN CAMBIUM WHEN CUT. ALL TREES MUST MEET THESE SPECIFICATIONS AT THE TIME OF PLANTING. THE PROJECT ARBORIST OR LANDSCAPE ARCHITECT IS TO CONFIRM COMPLIANCE WITH THE STANDARDS.

CONFORMITY TO SPECIES AND VARIETY

ALL TREES SHALL CONFORM TO SPECIES AND/OR VARIETY NAMED IN THE SPECIES LIST. NO SUBSTITUTIONS WILL BE ACCEPTED UNLESS APPROVED BY DEVELOPMENT ENGINEERING URBAN FORESTRY.

SIZE OF TREES

UNLESS OTHERWISE STATED BY DEVELOPMENT ENGINEERING URBAN FORESTRY ALL DECIDUOUS TREES PLANTED SHALL BE 300 CM - 350 CM (9'8" AND 11'5") IN OVERALL HEIGHT, AND AT LEAST 60 MM IN CALIPER. ALL 300 CM TREES MUST HAVE A MINIMUM OF 185 CM OF CLEAR STEM, MEASURED FROM THE GROUND, UNLESS APPROVED BY DEVELOPMENT ENGINEERING URBAN FORESTRY.

SHIPPING OF TREES

TREES MUST BE TRANSPORTED TO THE PLANTING SITE IN A MANNER THAT WILL MINIMIZE DAMAGE TO CROWNS, BOLES OR ROOTS. BALLED AND BURLAPPED (BB) TREES MUST HAVE NO CRACKS IN THE BALL TO BE ACCEPTED. TREES, WHETHER BALLED OR BURLAPPED, MUST HAVE THEIR ROOT SYSTEMS IN A MOIST STATE AT ALL TIMES.

TEMPORARY STORAGE

IF CONDITIONS PRECLUDE IMMEDIATE USE OF TREE STOCK, BALLED AND BURLAPPED TREES SHALL BE STORED IN A SHELTERED SPOT PROTECTED FROM SUN AND WIND. THE ROOT BALLS SHALL BE KEPT IN A MOIST STATE AT ALL TIMES BY WATERING AS REQUIRED.

PLANTING AND TREE SPECIES LOCATIONS

RESIDENTIAL STREET TREES

ALL STREET TREE PLANTING LOCATIONS MUST CONFORM TO THE APPROVED STREET TREE PLANTING PLAN AND ANY DEVIATION TO THE PLAN MUST BE APPROVED BY DEVELOPMENT ENGINEERING URBAN FORESTRY.

COMMERCIAL STREET TREES

STREET TREE PLANTING LOCATIONS SHALL BE INSTALLED AS PER EITHER THE APPROVED LANDSCAPING PLAN OR STREET TREE PLANTING PLAN THAT FORMS PART OF THE DEVELOPMENT PROJECT AND ANY CHANGE FROM THE PLAN MUST BE APPROVED BY DEVELOPMENT ENGINEERING URBAN FORESTRY.

TREE SPECIES MIX CONFIGURATION

TREE GROUPINGS ARE NOT TO EXCEED 3 OF ANY ONE SPECIES TYPE IN A ROW ON ONE SIDE OF THE ROAD, AND NO MORE THAN 4 TREES IN TOTAL FOR GROUPINGS THAT ARE DIVIDED WITH THE OPPOSITE SIDE OF THE ROAD.

BACKFILLING

BACKFILLING\* IS TO BE PLACED IN LAYERS APPROXIMATELY 15 CM IN DEPTH AND FIRMLY TAMPED IN PLACE IN SUCH A MANNER THAT THE TREE RETAINS ITS VERTICAL POSITION WITHOUT SUPPORT. PARTICULAR CARE IS TO BE TAKEN TO ENSURE THAT NO AIR POCKETS REMAIN UNDER OR AROUND ROOTS AND THAT DAMAGE DOES NOT OCCUR TO THE ROOT SYSTEM. THE FILL SHALL BE THOROUGHLY WATERED IMMEDIATELY AFTER PLANTING. BACKFILLED SOIL IS TO BE PLACED TO BRING THE TOP LEVEL OF THE ROOT BALL 7.6 CM HIGHER THAN THE EXISTING SURROUNDING GRADE TO ALLOW FOR SETTLING.

AT GRADE, A RIDGE OF SOIL LOCATED AT THE EDGE OF THE PLANTING HOLE SHALL BE FORMED TO A HEIGHT OF 9 CM, TO ACT AS A CATCH BASIN FOR ANY SUBSEQUENT WATERING'S AND TO RETAIN MULCH.

BALLED AND BURLAPPED TREES SHALL HAVE THE BURLAP CUT AND REMOVED TO APPROXIMATELY ONE-HALF THE ROOT BALL HEIGHT TO PREVENT THE BURLAP FROM ACTING AS A WICK THEREBY DRYING OUT THE BALL. ALL ROPES USED TO CONTAIN THE ROOT BALL SHALL BE CUT UNLESS MADE OF 100% NATURAL FABRIC THAT WILL DECAY. FOR ROOT BALLS ENCASED IN WIRE BASKETS THE ENTIRE WIRE BASKET MUST BE CUT AND REMOVED PRIOR TO THE BACKFILLING PHASE.

PRUNING

THE CROWN OF THE TREE SHALL BE PRUNED FROM THE BOTTOM UP AT THE TIME OF PLANTING TO REMOVE ALL DEAD AND DAMAGED BRANCHES. THE TERMINAL OR LEADER IS NOT TO BE PRUNED UNLESS BROKEN. ALL CUTS SHALL BE MADE USING APPROVED STANDARDS AND GUIDELINES FOR PRUNING SET OUT BY THE ANSI A300 PRUNING STANDARDS (2001 EDITION), AND THE ILLUSTRATED GUIDE TO PRUNING, 2ND EDITION (2002 ISA), LEAVING NO STUBS. ON ALL CUTS OVER 2 CM IN DIAMETER AND BRUISES OR SCARS ON THE BARK, THE INJURED CAMBIUM SHALL BE TRACED BACK TO LIVING TISSUE AND REMOVED. WOUNDS SHALL BE SMOOTHED AND SHAPED SO AS NOT TO RETAIN WATER. LARGE WOUNDS PRODUCED BY ANY MEANS OTHER THAN BRANCH PRUNING MAY RENDER THE TREE UNACCEPTABLE, REQUIRING REPLACEMENT SUBJECT TO THE DIRECTIONS OF DEVELOPMENT ENGINEERING URBAN FORESTRY.

STAKING

ALL BALLED AND BURLAPPED TREES SHALL, IMMEDIATELY AFTER PLANTING, BE SUPPORTED BY TWO WOODEN STAKES DRIVEN OUTSIDE THE BALL IN LINE WITH THE DIRECTION OF THE PREVAILING WIND (WEST-EAST).

FOR THIS TYPE OF TREE, BB, THE STAKES ARE TO BE DRIVEN AT LEAST 70 CM BELOW GRADE LINE. THE STAKES MUST BE DRIVEN DEEP ENOUGH THAT THERE IS AT LEAST 5 CM BETWEEN THE TOP OF THE STAKE AND THE FIRST BRANCH. STAKE PLACEMENT SHALL BE SUCH THAT NO MAIN ROOTS ARE SEVERED BY THE STAKE BEING DRIVEN INTO THE GROUND. METAL STAKES ARE PROHIBITED.

MULCHING

THE FOLLOWING SPECIFICATION WILL BE APPLIED: NON SHREDDED WOODCHIPS MEASURING BETWEEN 2.5 CM AND 5.0 CM IN WIDTH AND PLACED TO A DEPTH OF BETWEEN 5.0 CM TO 7.5 CM SPREAD THE FOLLOWING DISTANCE FROM THE ROOT COLLAR:

Table with 2 columns: DBH (CM), AVERAGE RADIUS FROM ROOT COLLAR (M). Rows: 0 TO 10 (1.8), 11 TO 40 (2.4).

WOODCHIPS ARE NOT TO BE IN CONTACT WITH THE TREE TRUNK AND MUST BE APPLIED NO LATER THAN 48 HOURS AFTER PLANTING.

ALL PLANTINGS SHALL BE INSPECTED BY THE PROJECT ARBORIST OR LANDSCAPE ARCHITECT FOR COMPLIANCE. PLANTINGS WHICH DO NOT MEET THE SPECIFICATIONS LISTED ABOVE, OR WHICH NEED STRAIGHTENING OR CORRECTION AS TO SETTLING, WILL NOT BE ACCEPTED BY THE TOWN UNTIL SUCH PROBLEMS ARE CORRECTED.

WARRANTY AND MAINTENANCE

ALL TREES TO HAVE A TWO (2) YEAR WARRANTY AND MAINTENANCE PERIOD FROM DATE OF SUBSTANTIAL COMPLETION. ALL REPLACEMENT TREES WILL HAVE A ONE (1) YEAR WARRANTY AND MAINTENANCE PERIOD FROM DATE OF PLANTING.

MINIMUM ROOT BALL DIAMETER

- THE MINIMUM ACCEPTABLE ROOT BALL DIAMETER FOR BALLED AND BURLAPPED TREES SHALL BE: 70 CM FOR 60 MM CALIPER TREES, 85 CM FOR 75 MM CALIPER TREES, 100 CM FOR 100 MM CALIPER TREES, 65 CM FOR 150 CM TALL CONIFER STOCK

TREE PLANTING OFFSETS

(STREET TREE SETBACK DISTANCES - COMPILED BY DEV. ENG. URBAN FORESTRY)

STRUCTURESPACING (METRES)

- FIRE HYDRANTMIN. 3.0M, PAD MOUNTED TRANSFORMERSMIN. 3.0M - DOOR SIDE MIN. 1.2M - CLOSED SIDES, \*LIGHT STANDARDS & HYDRO POLESMIN. 3.0M, STOP SIGNS MIN. 6.0M TREE CROWN CLEARANCE 2.0M IN HT, OVERHEAD WIRESMIN. 1.5M, UNION GAS LINESMIN. 1.2M, DRIVEWAYSMIN. 2.0M, PAD MOUNTED MAILBOXESMIN. 1.5M, UNDERGROUND STORAGE TANKSMIN. 3.0M

\*PLANT SMALL OR MEDIUM TYPE STATURE TREES WHEN PLANTING WITHIN 6M OF THE LIGHT STANDARD OR HYDRO POLE

TREE PLANTING SPACING

TREE STATURE SPACING BETWEEN TREES (METRES)

- LARGE STATURE = 12.0 m TO 14.0 m, MEDIUM STATURE = 8.0 m TO 9.0 m, SMALL STATURE = 3.0 m TO 8.0 m

ALL SUBDIVISION STREET TREE PLANTINGS THAT COMPLY WITH THE NORTH OAKVILLE URBAN STRATEGIC MANAGEMENT PLAN ARE TO BE CENTRED IN THE BOULEVARD BETWEEN CURBS AND SIDEWALK.

DAYLIGHT TRIANGLES - ANY TREE PLANTED NEAR AN INTERSECTION SHALL BE NO CLOSER TO THE STREET CORNER THAN THE EXTENSION LINE OF THE DAYLIGHT TRIANGLE.

SMALL STATURE TYPE TREES TO BE PLANTED 10M MINIMUM FROM LARGE STATURE TREES.

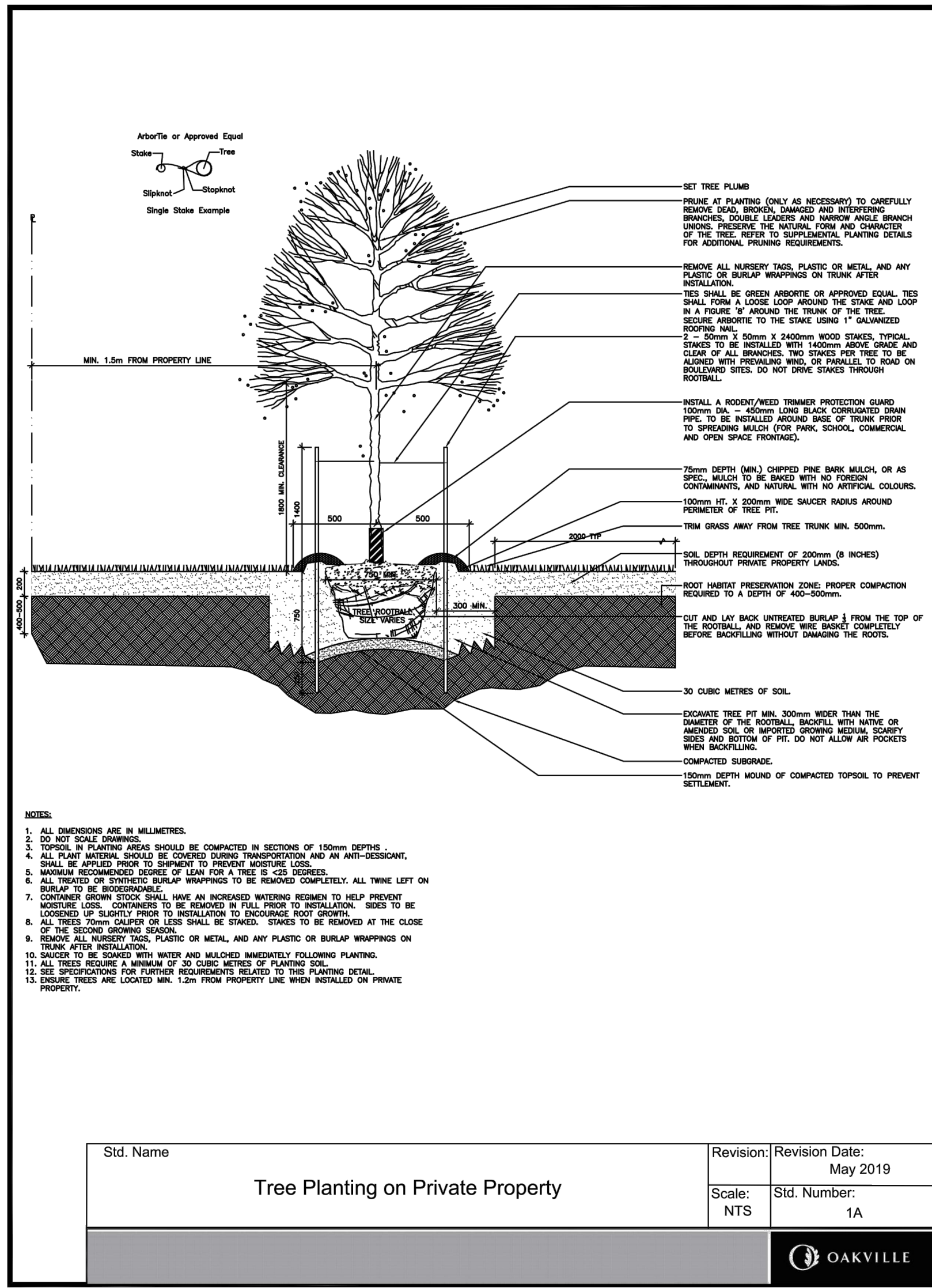

DECIDUOUS TREE PLANTING ON PRIVATE PROPERTY

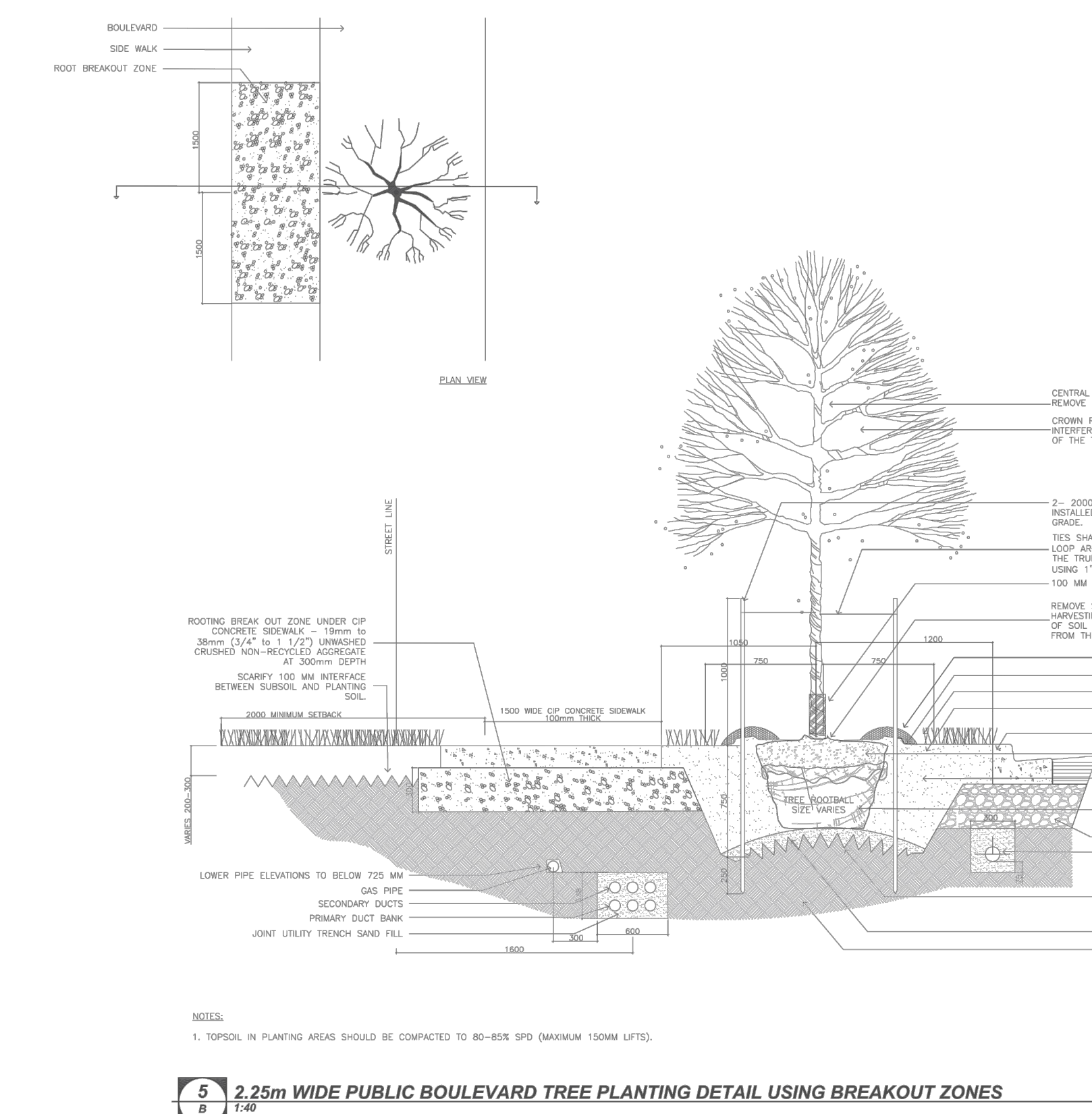

TREE PLANTING DETAIL USING BREAKOUT ZONE

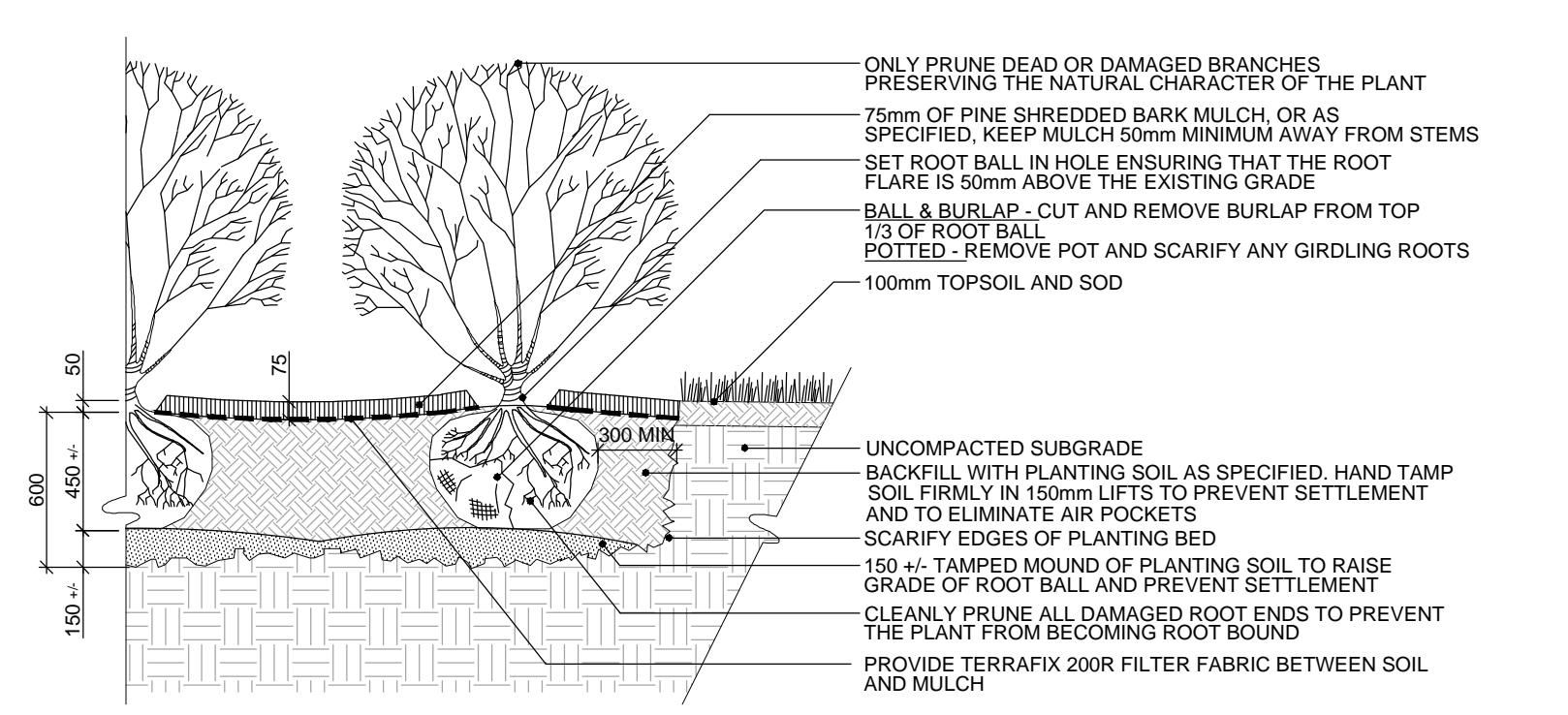

INSTALLATION METHODS: (AS NOTED ON PLANT LIST) 1. CONTAINER: CUT AND REMOVE ALL POTS, STRINGS, AND COCO COIR DISCS ETC. 2. BARE ROOT: SPREAD ROOTS EVENLY OVER TAMPED MOUND OF PLANTING SOIL. WORK SOIL BETWEEN ROOTS. 3. BALL AND BURLAP: CUT AND REMOVE MATERIALS (BURLAP, STRING, NAILS) FROM TOP 1/3 OF ROOT BALL ONCE POSITIONED (IF APPLICABLE)

SHRUB PLANTING

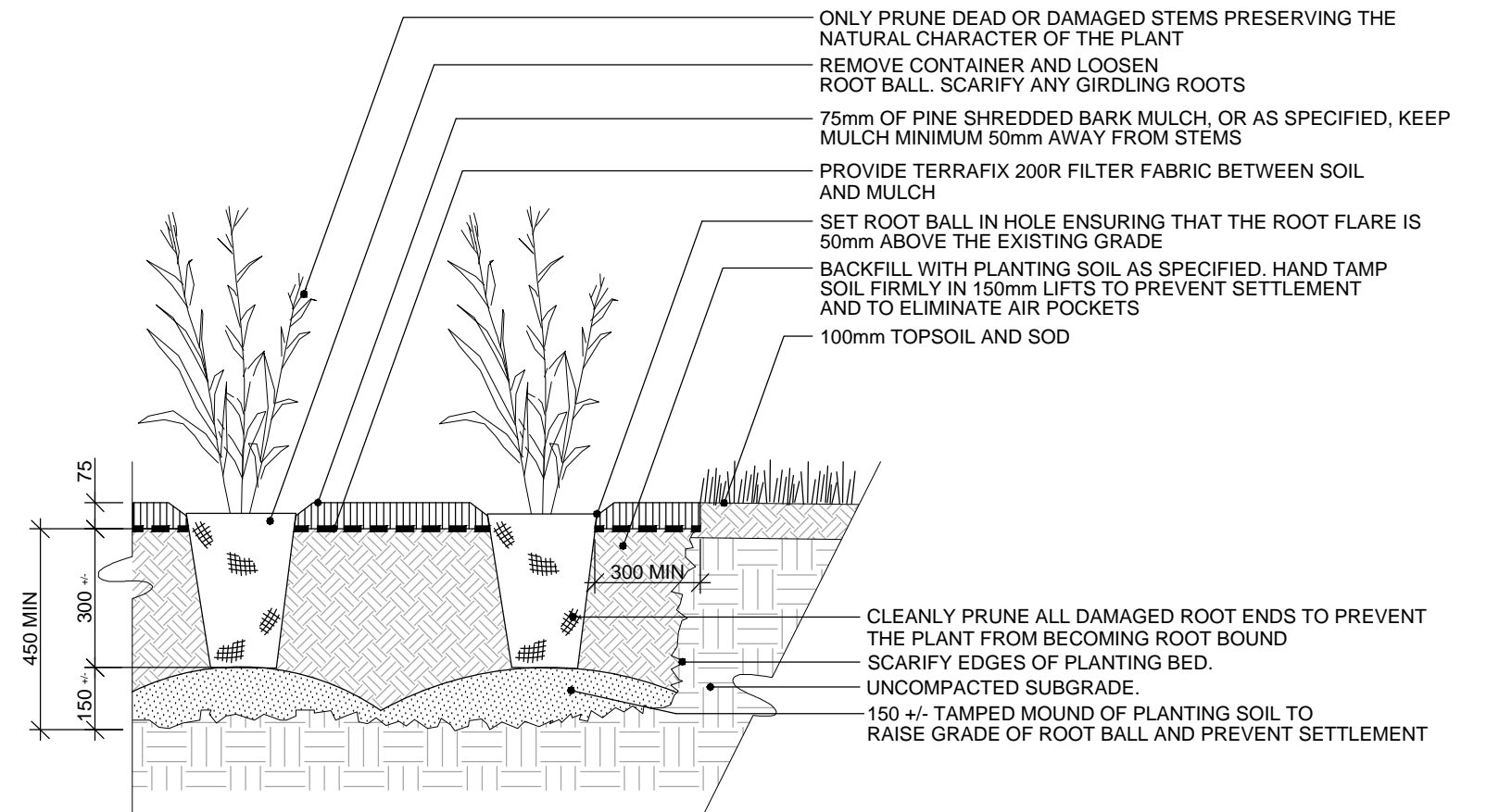

INSTALLATION METHOD: (AS NOTED ON PLANT LIST) 1. CONTAINER: CUT AND REMOVE ALL POTS, STRINGS, AND COCO COIR DISCS ETC. NOTES: 1. ALL DIMENSIONS ARE IN MILLIMETERS UNLESS OTHERWISE NOTED. 2. PRUNE ANY VISIBLE GIRDLING ROOTS ONCE EXCESS SOIL IS REMOVED AND LOOSEN ANY ROOTS THAT ENCRICLE THE ROOT BALL. POT BOUND SHRUBS ARE NOT ACCEPTABLE. SLIT THE ROOT BALL VERTICALLY 3 TIMES EVENLY AROUND THE CIRCUMFERENCE OF THE ROOT BALL TO A 13mm DEPTH. 3. ENSURE ALL TAGS, ROPES, STRAPS, COCO COIR DISCS, AND CONTAINERS ARE REMOVED FROM PLANT AND DISPOSED OF. 4. ONCE PLANTED, REGRADE PLANTING BED TO REMOVE LARGE CLUMPS OF SOIL AND STONE PRIOR TO MULCHING.

PERENNIAL PLANTING

Revision table with columns: no., revision, date, by. Rows: R3 RE ISSUED FOR REVIEW (2024.01/09 SS), R2 ISSUED FOR REVIEW (2023.12/14 SS), R1 SITE PLAN PRE-SUBMISSION REVIEW (2023.06/23 HP).

THESE DRAWINGS ARE THE PROPERTY OF CGLA CONSULTANTS INC. AND SHALL NOT BE ALTERED, MODIFIED, REUSED OR CHANGED WITHOUT THE WRITTEN CONSENT OF CGLA CONSULTANTS INC. SEAL IS VOID WITHOUT SIGNATURE OF THE LANDSCAPE ARCHITECT. DRAWINGS CANNOT BE USED FOR TENDER/CONSTRUCTION UNLESS SIGNED BY LANDSCAPE ARCHITECT.

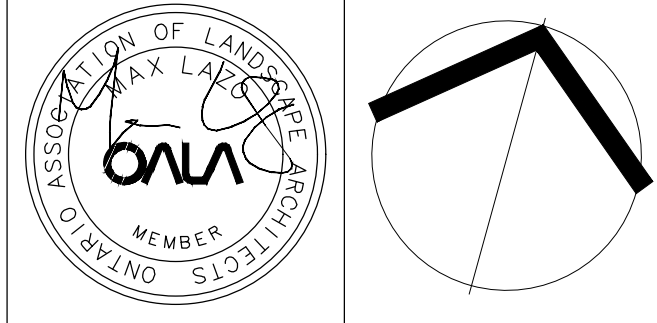

CGLA logo and contact information: 30 CENTURIAN DRIVE UNIT 105 MARKHAM, ONTARIO, L3R 8B8. Telephone: 905-475-6988. Email: info@cgl.ca. www.cgl.ca

Client: CRYSTAL HOMES

Project Title: OAKBROOK, BLOCK 1 & 2 SITE PLAN

TOWN OF OAKVILLE

Drawing Title: LANDSCAPE DETAILS

Reviewed: HP Drawn: AN

Scale: AS SHOWN Date: 06/13/23

Project Number: 2693-SP

Drawing Number: D1



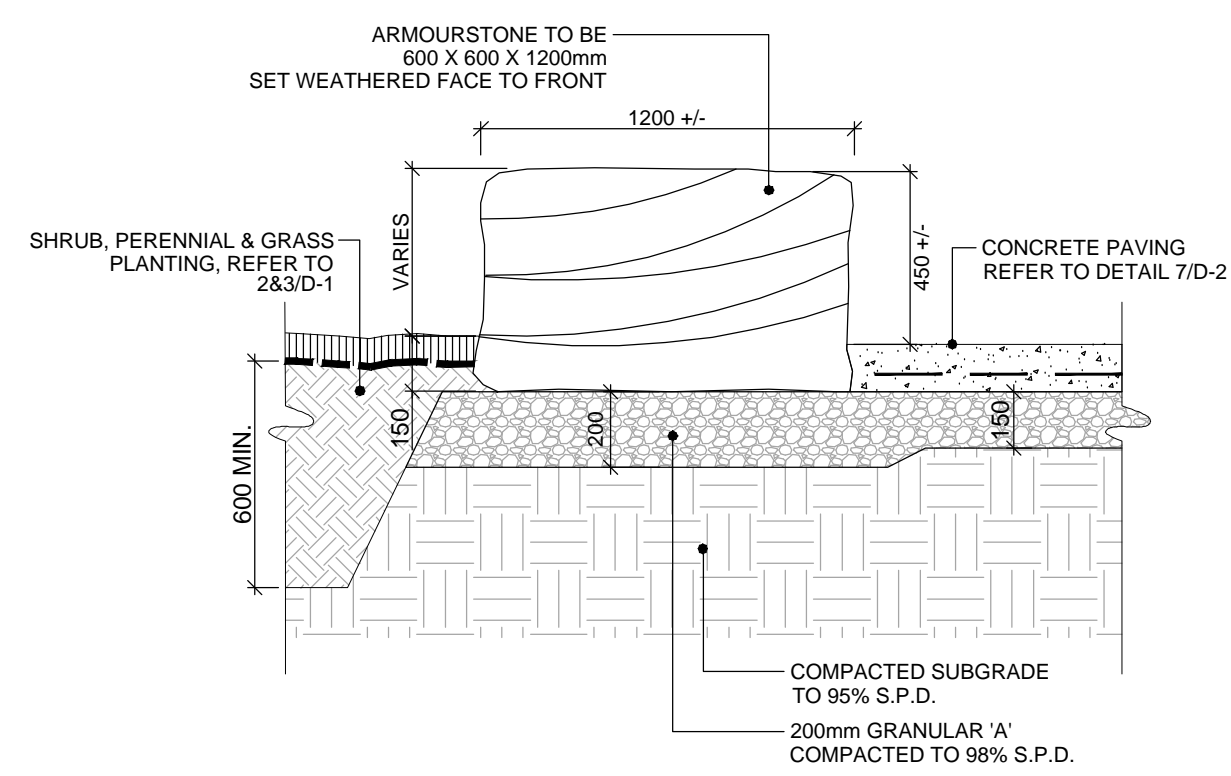

**1**  
D-2  
**ARMOUR SEATWALL (1 STACK)**  
N.T.S.

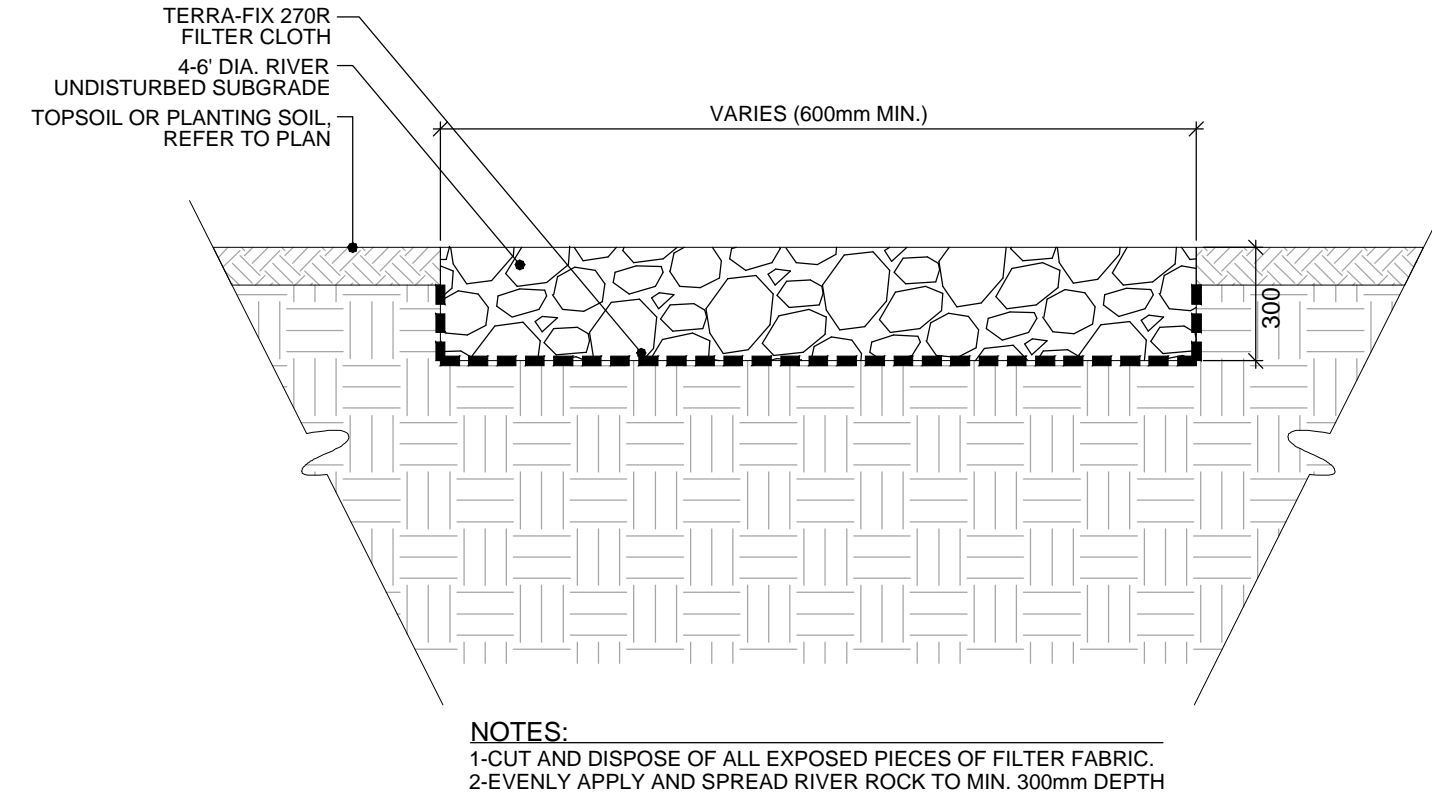

**2**  
D-2  
**RIVERROCK**  
N.T.S.

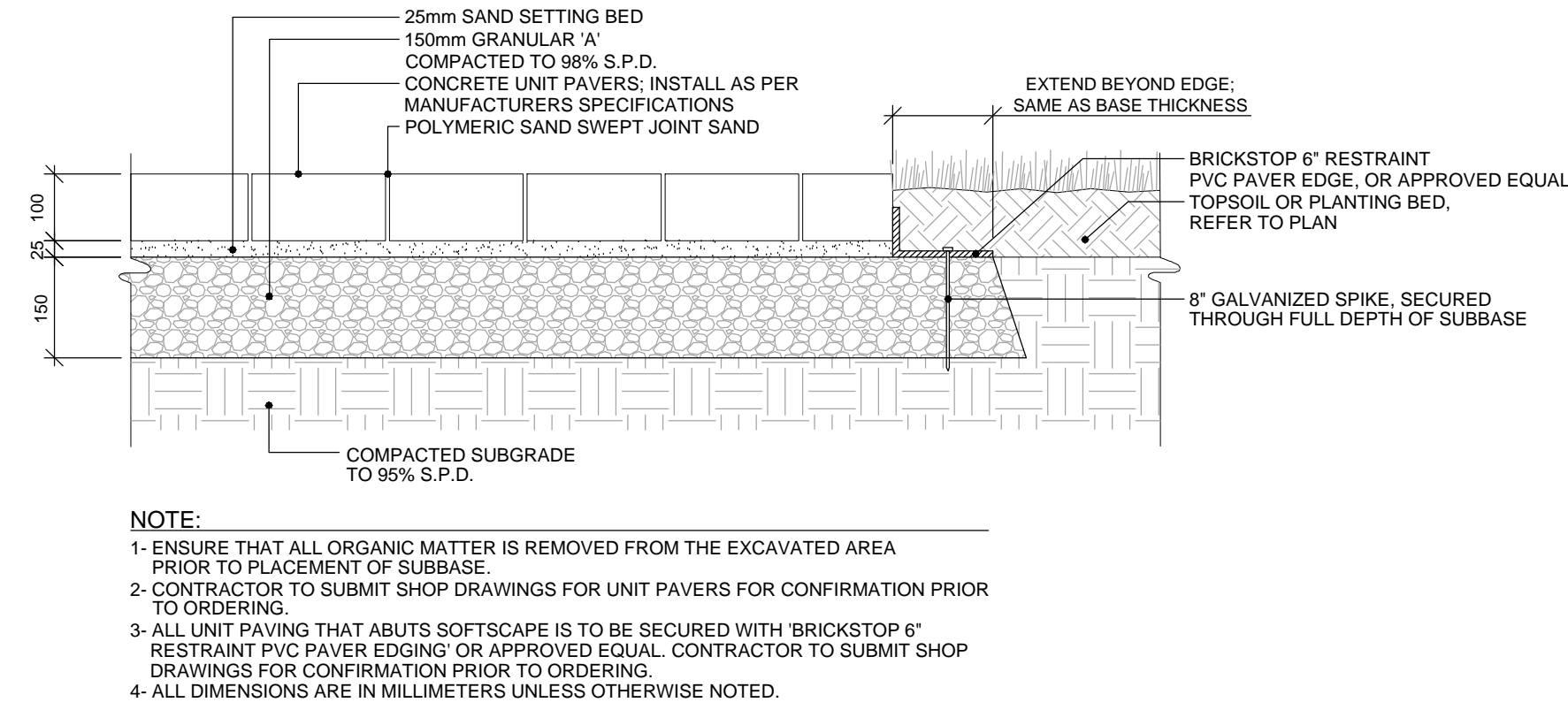

**NOTE:**  
 1- ENSURE THAT ALL ORGANIC MATTER IS REMOVED FROM THE EXCAVATED AREA PRIOR TO PLACEMENT OF SUBBASE.  
 2- CONTRACTOR TO SUBMIT SHOP DRAWINGS FOR UNIT PAVERS FOR CONFIRMATION PRIOR TO ORDERING.  
 3- ALL UNIT PAVING THAT ABUTS SOFTSCAPE IS TO BE SECURED WITH 'BRICKSTOP 6" RESTRAINT PVC PAVER EDGING' OR APPROVED EQUAL. CONTRACTOR TO SUBMIT SHOP DRAWINGS FOR CONFIRMATION PRIOR TO ORDERING.  
 4- ALL DIMENSIONS ARE IN MILLIMETERS UNLESS OTHERWISE NOTED.

**3**  
D-2  
**CONCRETE UNIT PAVING**  
N.T.S.

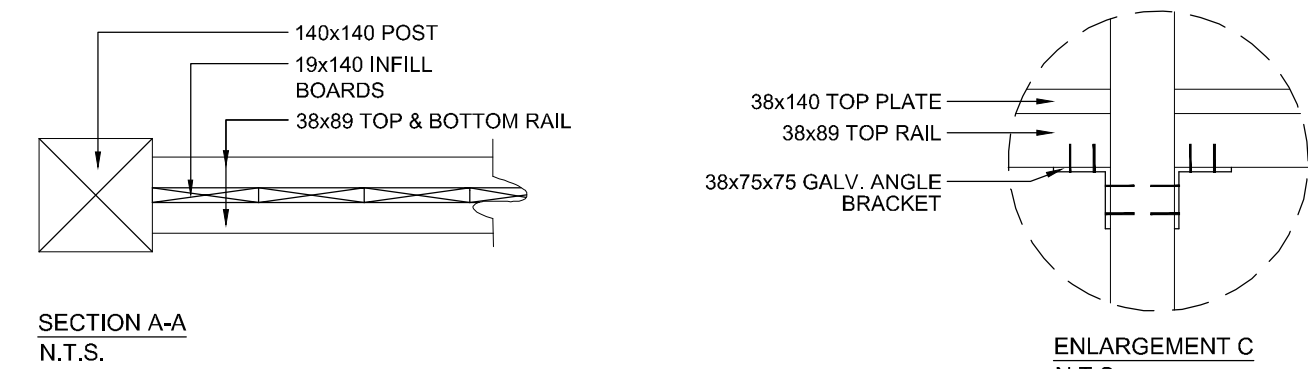

**SECTION A-A**  
N.T.S.

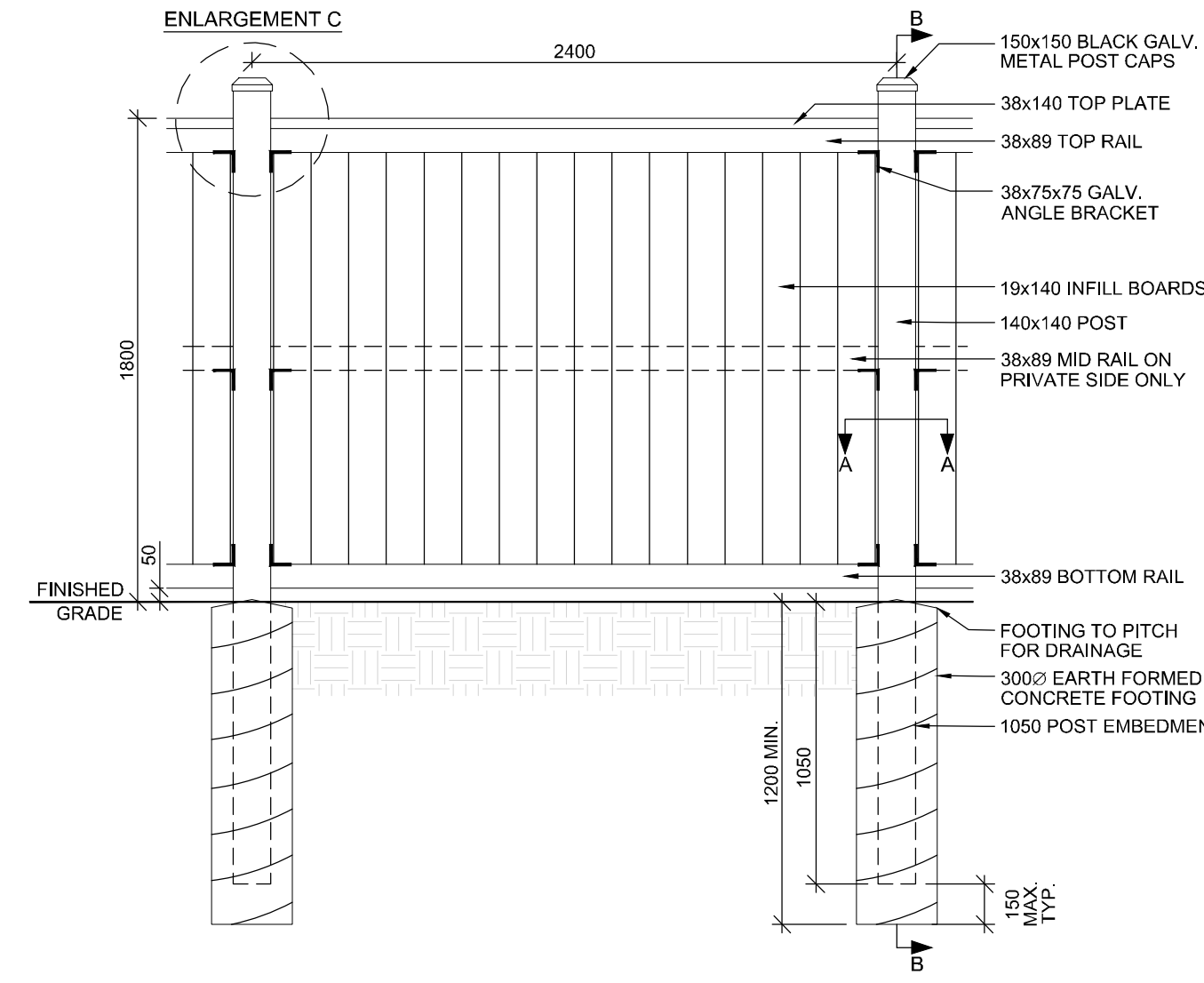

**ENLARGEMENT C**  
N.T.S.

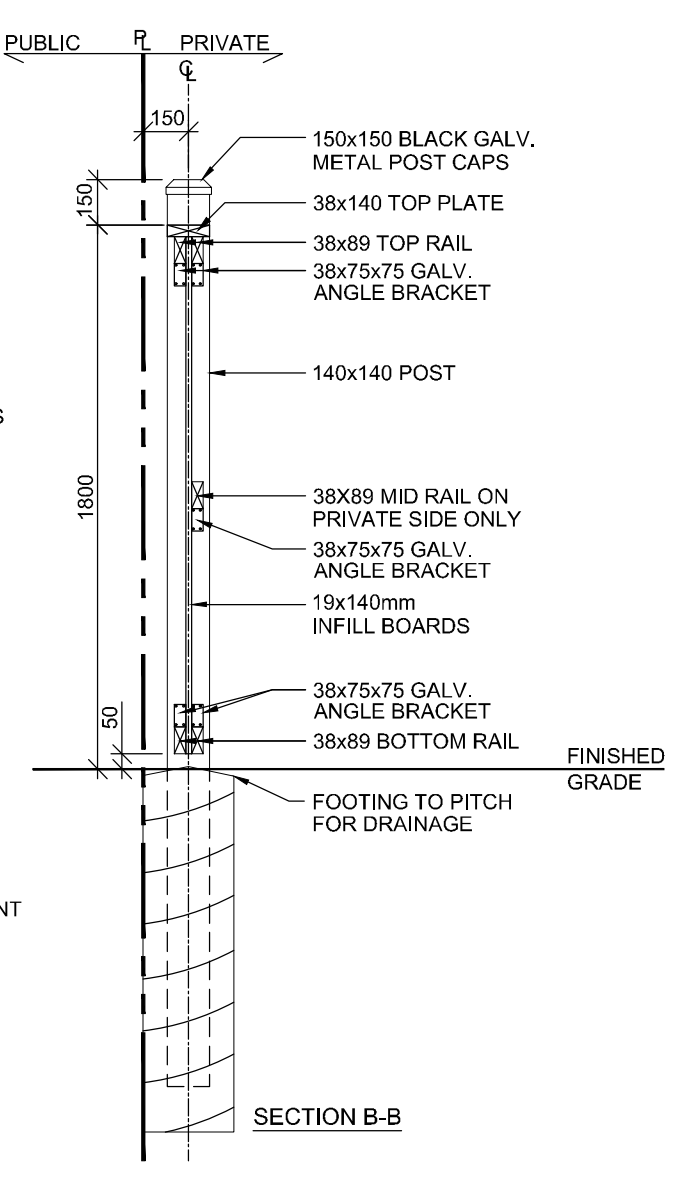

**SECTION B-B**

**4**  
D-2  
**1.8m WOOD PRIVACY FENCE**  
N.T.S.

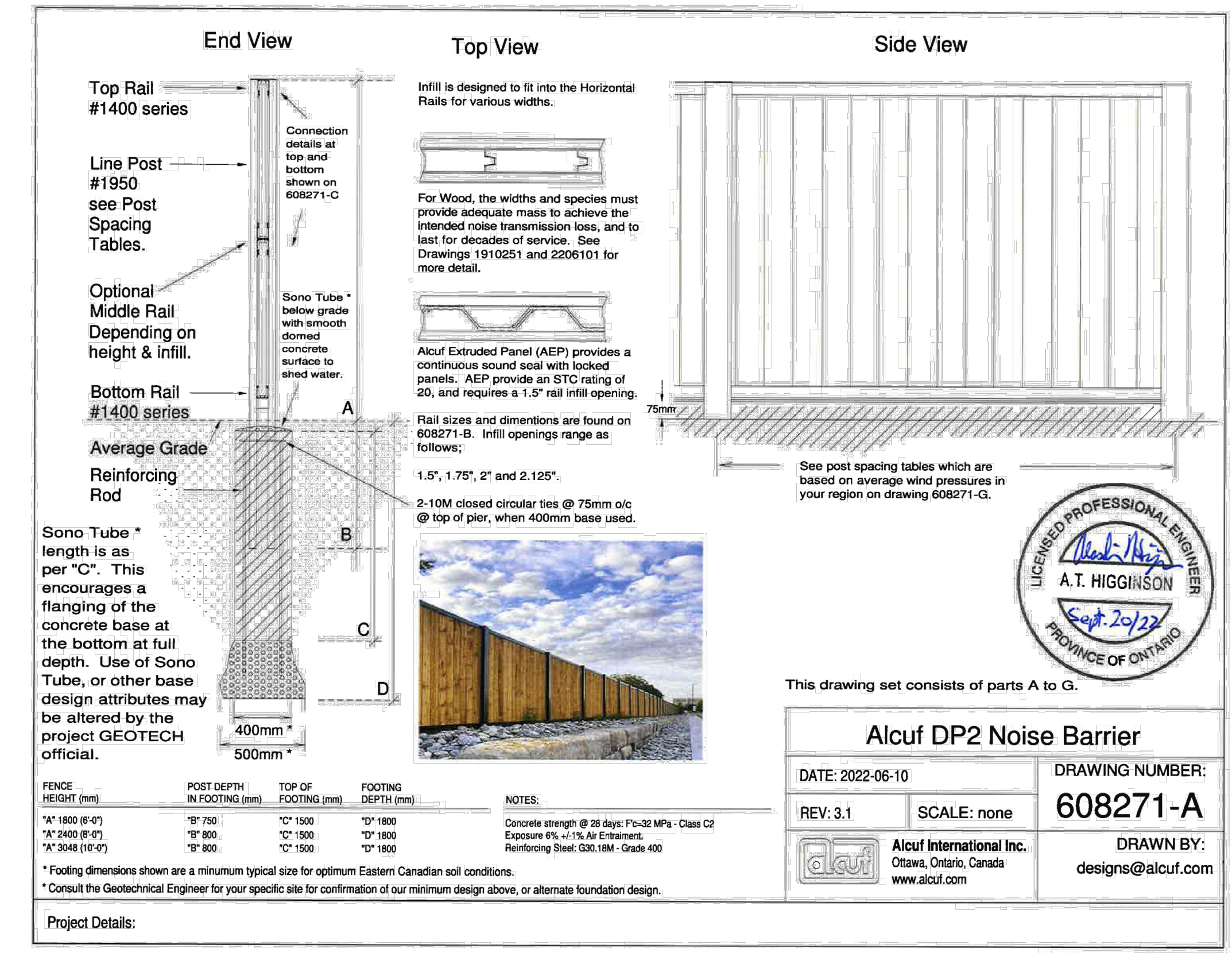

**5**  
D-2  
**2.4m WOOD ACOUSTIC FENCE**  
N.T.S.

REVISION	DATE	BY
R3	2024.01.09	SS
R2	2023.12.14	SS
R1	2023.06.23	HP

THESE DRAWINGS ARE THE PROPERTY OF CGLA CONSULTANTS INC. AND SHALL NOT BE ALTERED, MODIFIED, REPRODUCED OR CHANGED WITHOUT THE WRITTEN CONSENT OF CGLA CONSULTANTS INC. THIS IS NOT VALID WITHOUT SIGNATURE OF THE LANDSCAPE ARCHITECT. DRAWINGS CANNOT BE USED FOR TENDER/CONSTRUCTION UNLESS SIGNED BY LANDSCAPE ARCHITECT.

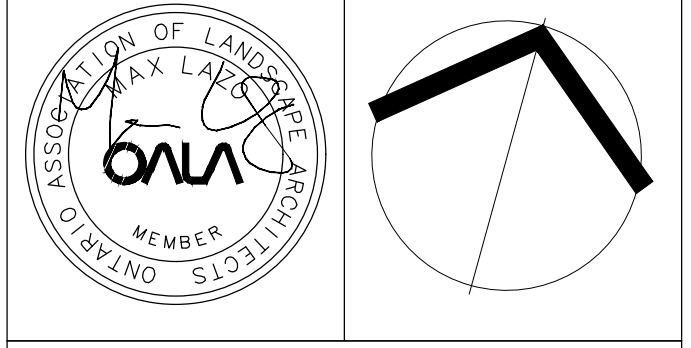

Client:  
**CRYSTAL HOMES**

Project Title:  
**OAKBROOK, BLOCK 1 & 2 SITE PLAN**

TOWN OF OAKVILLE

Drawing Title:  
**LANDSCAPE DETAILS**

Reviewed: HP Drawn: AN

Scale: AS SHOWN Date: 06/13/23

Project Number: 2693-SP

Drawing Number  
**D2**