

Contractor shall check all dimensions on the work and report any discrepancies to the Landscape Architect before proceeding. All drawings and specifications are the property of the Landscape Architect and must be retained until the completion of the work. This drawing is not to be used for construction until signed by the Landscape Architect.

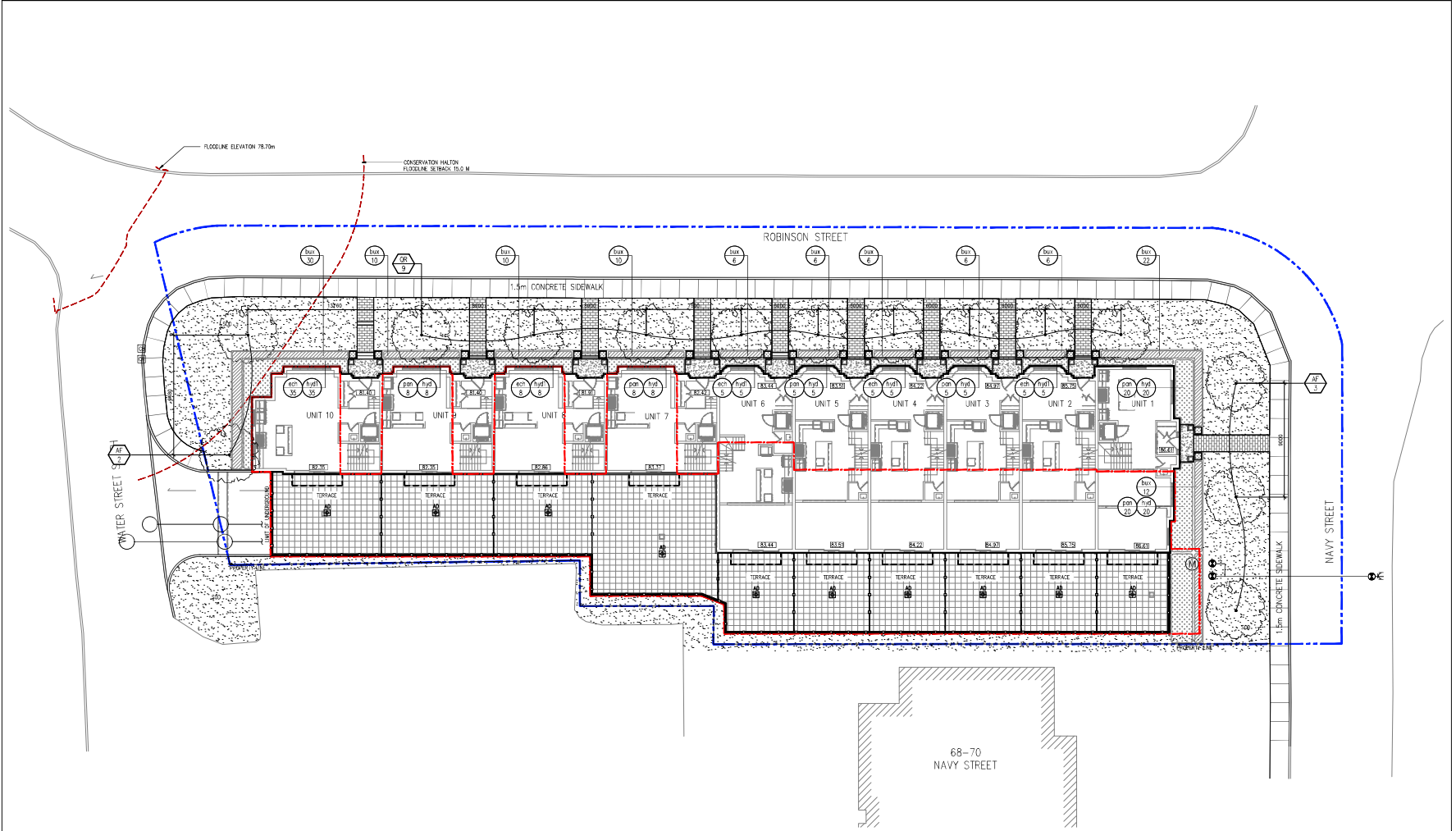

- LEGEND**
- PROPERTY LINE
 - - - LINE OF BUILDING ABOVE
 - - - LINE OF UNDERGROUND PARKING
 - - - 1.8m WOOD PRIVACY FENCE (DETAIL UNDER DESIGN REVIEW)
- LANDSCAPE**
- DECIDUOUS TREE
 - CONIFEROUS SHRUB
 - CONIFEROUS SHRUB
 - SOD
- SURFACE TREATMENTS**
- ▨ PRECAST UNIT PAVING 1
 - ▨ PRECAST UNIT PAVING 2
 - ▨ CONCRETE SIDEWALK
 - ▨ CONCRETE PAVING
- PLANTING KEY**
- TREE SPECIES
 - SHRUB SPECIES
 - QUANTITY
 - QUANTITY
- UTILITIES**
- ▭ AREA DRAIN
 - CATCH BASIN
 - MAN HOLE
 - WATER MAIN

1	Issued for Recording 2nd Submission	May 03/23
2	Issued for Construction	Apr 03/23
3	Issued for Recording	Jun 13/22
No.	Description	Date
Revision		
City Approval Stamp		



431 BONCEVALES AVENUE, TORONTO, ON M4B 2M1 CANADA
 T 416 540 8700 F 416 540 7100 WWW.DESIGNARCHITECTS.COM
 Project

Roseville Properties Inc.
 106-114 Robinson St. & 71 Water St., Oakville, Ontario

Z:\174.28
 Title

Planting Plan

Date: 06/13/22 Sheet
 Scale: 1:150
 Drawn: an
 Checked: m
 Job No.: 23-001

L1.1

KEY	QTY	BOTANICAL NAME	COMMON NAME	CALIPER	SPACING/ CONDITION	NATIVE	DROUGHT
DECIDUOUS TREES							
AF	5	ACER X FREEMANII	FREEMAN MAPLE	70	WB	Y	Y
QR	9	QUERCUS RUBRA	RED OAK	70	WB	Y	Y
SHRUBS							
bux	124	BUXUS 'GREEN VELVET'	GREEN VALVET		600mm o/c-3 Gal Pot	N	Y
hyd	66	HYDRANGEA PANICULATA 'BOMBSHELL'	BOMBSHELL HYDRANGEA		500mm o/c-3 Gal Pot	N	Y
hyd1	58	HYDRANGEA ARBORESCENS 'ANNABELLE'	ANNABELLE HYDRANGEA		500mm o/c-3 Gal Pot	N	Y
PERENNIALS, GRASSES & GROUNDCOVER							
ech	56	TECHINACEA PURPUREA	PURPLE CONEFLOWER		400mm o/c-1 Gal Pot	Y	Y
pan	66	PANICUM VIRGATUM	SWITCHGRASS		500mm o/c-2 Gal Pot	Y	Y

GENERAL NOTE:
 MINIMUM REQUIRED LANDSCAPING COVERAGE: 10%
 LANDSCAPE COVERAGE PROVIDED: 24.2% (666.1m²)