

No.	ISSUED	DATE
1	ISSUED FOR SPA	APR.06'21
2	ISSUED FOR SPA (LEED)	MAY.06'21
3	ISSUED FOR SPA (LEED)	DEC.15'21

No.	REVISION	DATE
-----	----------	------



30 Great Gulf Drive, Unit 20 | Concord ON | L4K 0K7
T. 905.660.0722 | www.baldassarra.ca

MANUEL JORDAO & ASSOCIATES LTD.
ELECTRICAL ENGINEERING

556 EDWARD AVENUE, UNIT 82
RICHMOND HILL, ONTARIO
L4C 9Y5 CANADA

PHONE: (905) 780-8590 FAX: (905) 780-8591
Email: mjordao@mjaeng.com
WEB SITE: www.mjaeng.com



772 Winston Churchill Blvd.
Oakville, Ontario

Oakville, Ontario

SITE PLAN

DATE:	DRAWN BY:	CHECKED:	SCALE:
MAR. 2021	HG	OE	1:1000
PROJECT No.	DRAWING No.		

2021-011 **ESL**

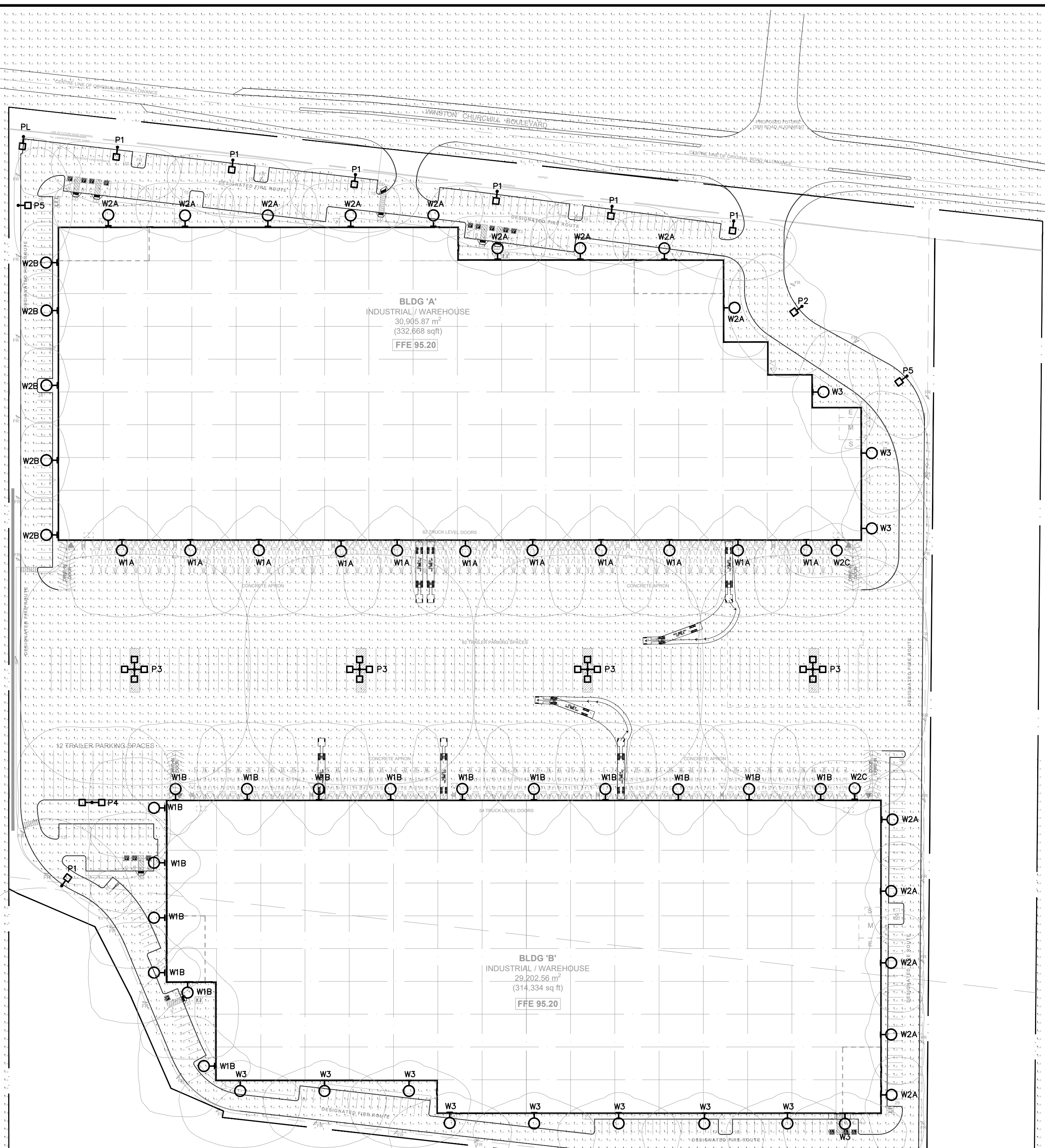

ELECTRICAL SITE PLAN
SCALE: 1:1000

Calculation Summary							
Label	CalcType	Units	Avg	Max	Min	Avg/Min	Max/Min
LIGHTSPILL	Illuminance	Fc	0.00	0.2	0.0	N.A.	N.A.
SITE	Illuminance	Fc	1.36	4.2	0.3	4.53	14.00

- NOTES :**
- ALL EXTERIOR LIGHTING FIXTURES ARE DARK SKY FRIENDLY
 - ALL EXTERIOR WALL MOUNTED AND POLE MOUNTED LUMINAIRES ARE LED
 - ALL EXTERIOR LUMINAIRES TO BE CONTROLLED BY PHOTOCELL AND TIMECLOCK 'OFF'.
 - OVERALL SITE LIGHTING WILL BE REDUCED TO AVERAGE OF 1 FC ORL LESS AFTER 11:00PM OR THE CLOSE OF BUSINESS WHICHEVER IS LATER.
 - ALL LIGHTING DEVICES SHALL BE FULL CUT OFF AND NIGHT SKY FRIENDLY AND SHALL BE MITIGATED AT THE SOURCE SO THAT NO LIGHT (0.0FC) WILL BE DIRECTLY PROJECTED ONTO ADJACENT PROPERTIES.



TYPE 'P1'
LED LUMINAIRE MOUNTED ON 24 FT. HIGH ROUND 5" TAPERED STEEL GALVANIZED POLE. LUMINAIRES TO BE C/W 114W LED, BLC DISTRIBUTION, 12,721 LUMENS, 4000K, 347 VOLT, AND ALL NECESSARY HARDWARE AND ACCESSORIES FOR A COMPLETE INSTALLATION. COLOUR AS SELECTED BY ARCHITECT FROM STANDARD FINISHES. POLE TO BE MOUNTED ON 36" CONCRETE BASE C/W ALL ACCESSORIES FOR A COMPLETE INSTALLATION. POLES TO BE PAINTED TO MATCH LUMINAIRES, MANUFACTURED BY GARDCO CAT. # P26-64L-600-NW-G2-BLC

TYPE 'P2'
LED LUMINAIRE MOUNTED ON 24 FT. HIGH ROUND 5" TAPERED STEEL GALVANIZED POLE. LUMINAIRES TO BE C/W 101W LED, TYPE 4 DISTRIBUTION, 14,351 LUMENS, 4000K, 347 VOLT, AND ALL NECESSARY HARDWARE AND ACCESSORIES FOR A COMPLETE INSTALLATION. COLOUR AS SELECTED BY ARCHITECT FROM STANDARD FINISHES. POLE TO BE MOUNTED ON 36" CONCRETE BASE C/W ALL ACCESSORIES FOR A COMPLETE INSTALLATION. POLES TO BE PAINTED TO MATCH LUMINAIRES, MANUFACTURED BY GARDCO CAT. # P26-48L-700-NW-G2-4

TYPE 'P1'
LED LUMINAIRE MOUNTED ON 24 FT. HIGH ROUND 5" TAPERED STEEL GALVANIZED POLE. LUMINAIRES TO BE C/W 132W LED, LCL (LEFT) DISTRIBUTION, 4,650 LUMENS, 4000K, 347 VOLT, AND ALL NECESSARY HARDWARE AND ACCESSORIES FOR A COMPLETE INSTALLATION. COLOUR AS SELECTED BY ARCHITECT FROM STANDARD FINISHES. POLE TO BE MOUNTED ON 36" CONCRETE BASE C/W ALL ACCESSORIES FOR A COMPLETE INSTALLATION. POLES TO BE PAINTED TO MATCH LUMINAIRES, MANUFACTURED BY GARDCO CAT. # P26-64L-700-NW-G2-LCL (LEFT)

TYPE 'P5'
LED LUMINAIRE MOUNTED ON 24 FT. HIGH ROUND 5" TAPERED STEEL GALVANIZED POLE. LUMINAIRES TO BE C/W 74.5W LED, BLC DISTRIBUTION, 8,235 LUMENS, 4000K, 347 VOLT, AND ALL NECESSARY HARDWARE AND ACCESSORIES FOR A COMPLETE INSTALLATION. COLOUR AS SELECTED BY ARCHITECT FROM STANDARD FINISHES. POLE TO BE MOUNTED ON 36" CONCRETE BASE C/W ALL ACCESSORIES FOR A COMPLETE INSTALLATION. POLES TO BE PAINTED TO MATCH LUMINAIRES, MANUFACTURED BY GARDCO CAT. # P26-48L-500-NW-G2-BLC

TYPE 'P3'
LED LUMINAIRE (4 @ 90) MOUNTED ON 38 FT. HIGH ROUND 5" TAPERED STEEL GALVANIZED POLE. LUMINAIRES TO BE C/W 101W LED, TYPE 5W DISTRIBUTION, 14,819 LUMENS, 4000K, 347 VOLT, AND ALL NECESSARY HARDWARE AND ACCESSORIES FOR A COMPLETE INSTALLATION. COLOUR AS SELECTED BY ARCHITECT FROM STANDARD FINISHES. POLE TO BE MOUNTED ON 36" CONCRETE BASE C/W ALL ACCESSORIES FOR A COMPLETE INSTALLATION. POLES TO BE PAINTED TO MATCH LUMINAIRES, MANUFACTURED BY GARDCO CAT. # P26-48L-700-NW-G2-5W

TYPE 'P4'
LED LUMINAIRE (BACK TO BACK) MOUNTED ON 24 FT. HIGH ROUND 5" TAPERED STEEL GALVANIZED POLE. LUMINAIRES TO BE C/W 101W LED, TYPE 5W DISTRIBUTION, 14,819 LUMENS, 4000K, 347 VOLT, AND ALL NECESSARY HARDWARE AND ACCESSORIES FOR A COMPLETE INSTALLATION. COLOUR AS SELECTED BY ARCHITECT FROM STANDARD FINISHES. POLE TO BE MOUNTED ON 36" CONCRETE BASE C/W ALL ACCESSORIES FOR A COMPLETE INSTALLATION. POLES TO BE PAINTED TO MATCH LUMINAIRES, MANUFACTURED BY GARDCO CAT. # P26-48L-700-NW-G2-5W

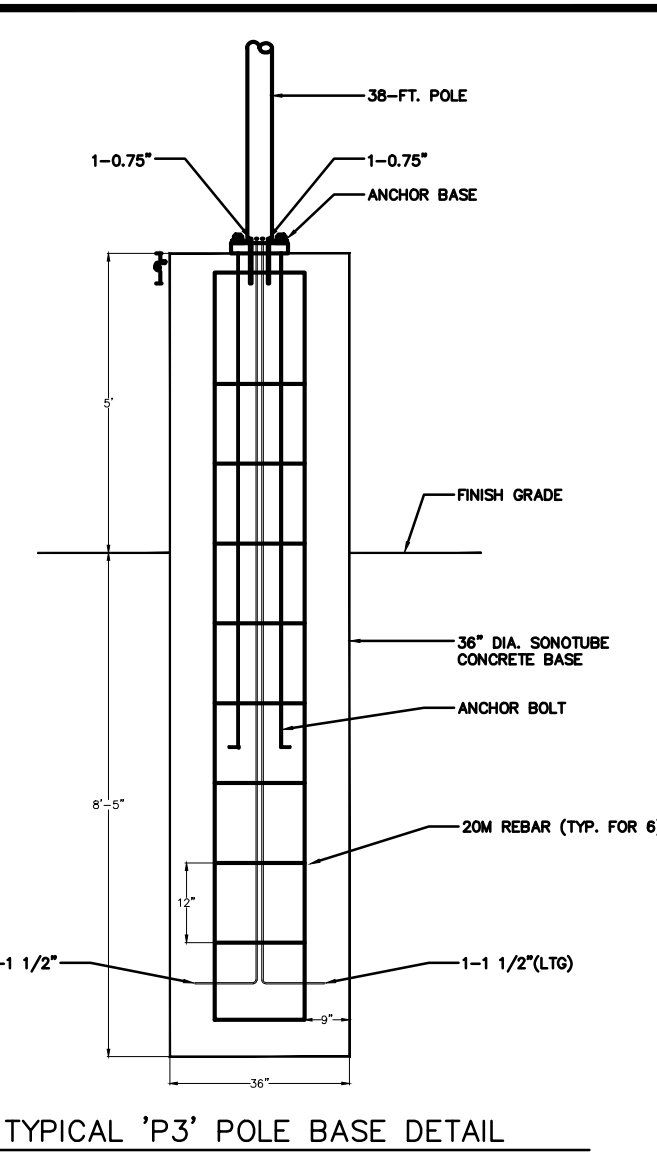

TYPICAL 'P3' POLE BASE DETAIL
N.T.S.

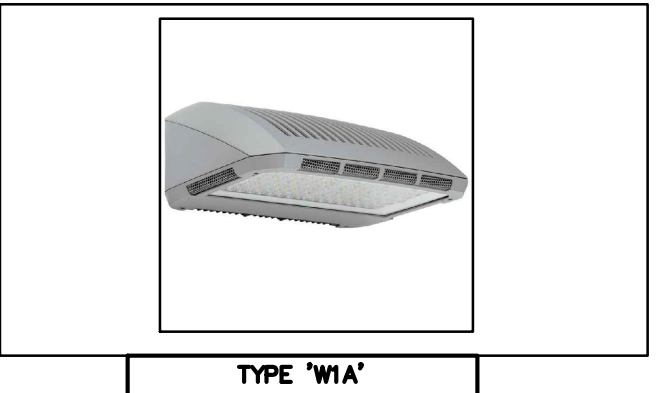

TYPE 'W1A'
WALL MOUNTED (Ø 35" AFF) LED LUMINAIRE FIXTURE C/W 139W, 14,022 LUMENS, 4000K TYPE 4 DISTRIBUTION & 347 DRIVER, MANUFACTURED BY PHILIPS GARDCO CAT. # 161L-46L-900-NW-G2-4 COLOUR AS SELECTED BY ARCHITECT FROM STANDARD FINISHES

TYPE 'W1B'
WALL MOUNTED (Ø 30" AFF) LED LUMINAIRE FIXTURE C/W 139W, 14,022 LUMENS, 4000K TYPE 4 DISTRIBUTION & 347 DRIVER, MANUFACTURED BY PHILIPS GARDCO CAT. # 161L-46L-900-NW-G2-4 COLOUR AS SELECTED BY ARCHITECT FROM STANDARD FINISHES

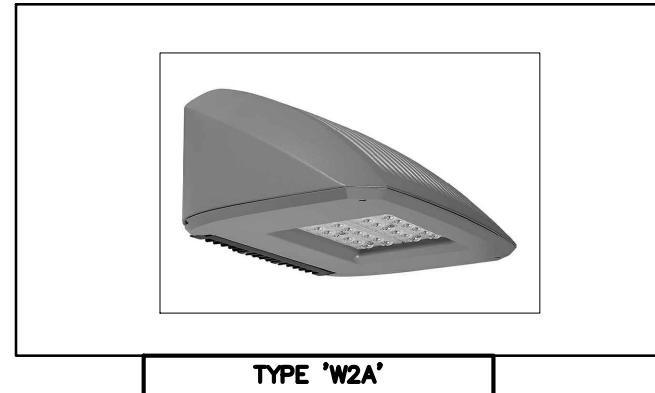

TYPE 'W2A'
WALL MOUNTED (Ø 25" AFF) LED LUMINAIRE FIXTURE C/W 52W, 6,733 LUMENS, 4000K TYPE 3 DISTRIBUTION & 347 DRIVER, MANUFACTURED BY PHILIPS GARDCO CAT. # 121L-32L-530-NW-G4-3 COLOUR AS SELECTED BY ARCHITECT FROM STANDARD FINISHES

TYPE 'W2B'
WALL MOUNTED (Ø 22" AFF) LED LUMINAIRE FIXTURE C/W 52W, 6,733 LUMENS, 4000K TYPE 3 DISTRIBUTION & 347 DRIVER, MANUFACTURED BY PHILIPS GARDCO CAT. # 121L-32L-530-NW-G4-3 COLOUR AS SELECTED BY ARCHITECT FROM STANDARD FINISHES

TYPE 'W2C'
WALL MOUNTED (Ø 20" AFF) LED LUMINAIRE FIXTURE C/W 52W, 6,733 LUMENS, 4000K TYPE 3 DISTRIBUTION & 347 DRIVER, MANUFACTURED BY PHILIPS GARDCO CAT. # 121L-32L-530-NW-G4-3 COLOUR AS SELECTED BY ARCHITECT FROM STANDARD FINISHES

TYPE 'W3'
WALL MOUNTED (Ø 30" AFF) LED LUMINAIRE FIXTURE C/W 52W, 6,733 LUMENS, 4000K TYPE 3 DISTRIBUTION & 347 DRIVER, MANUFACTURED BY PHILIPS GARDCO CAT. # 121L-32L-1000-NW-G4-4 COLOUR AS SELECTED BY ARCHITECT FROM STANDARD FINISHES

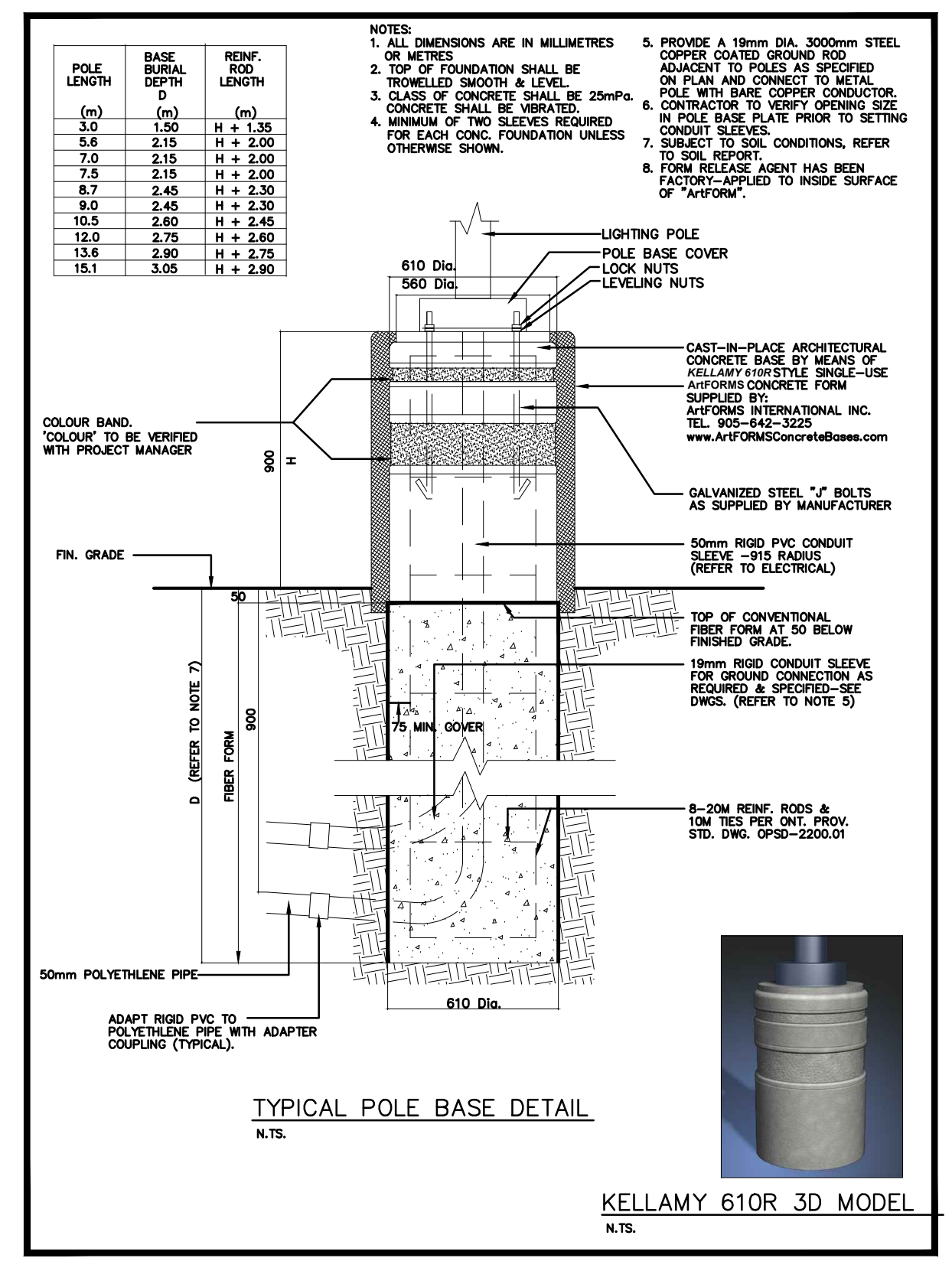

TYPICAL POLE BASE DETAIL
N.T.S.
KELLAMY 610R 3D MODEL
N.T.S.