

SIXTH LINE

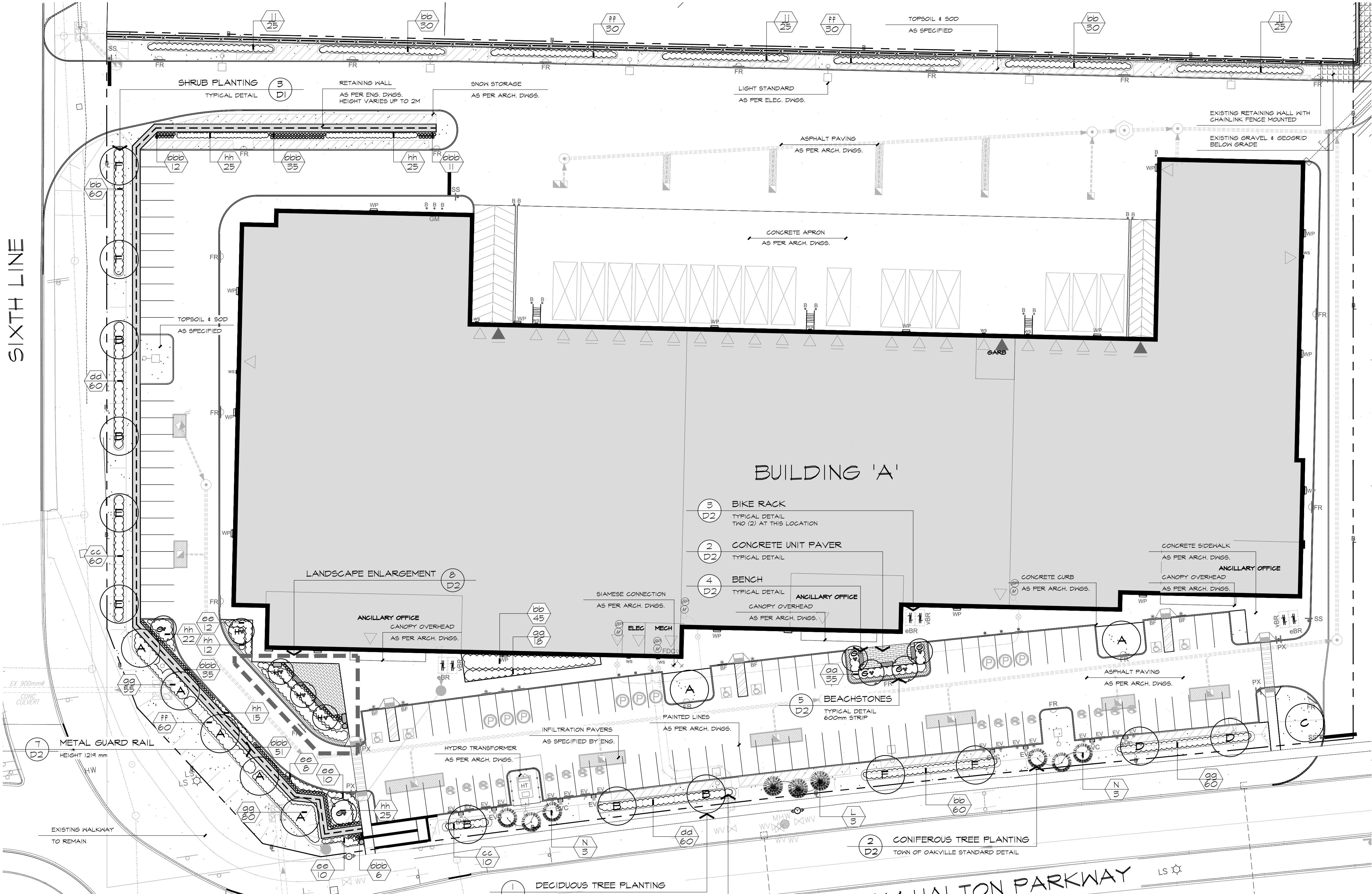

REFERENCE PLANT LIST

KEY	COMMON NAME	KEY	COMMON NAME
DECIDUOUS TREES		CONIFEROUS SHRUBS	
A	RED MAPLE	aa	MINT JULEP JUNIPER
B	COMMON HACKBERRY	DECIDUOUS SHRUBS	
C	SHADEMASTER HONEYLOCUST	bb	RED OSIER DOGWOOD
D	KENTUCKY COFFEE TREE	cc	BUSH HONEYSUCKLE
E	TULIP TREE	dd	LITTLE DEVIL DWARF NINEBARK
F	BASSWOOD	ee	GRO LOW FRAGRANT SUMAC
ORNAMENTAL TREES		ff	MEADOW ROSE
G	DONNY SERVICEBERRY	gg	GOLDFLAME SPIREA
H	EASTERN REDBUD	hh	KELSEY RED OSIER DOGWOOD
CONIFEROUS TREES		jj	COMMON NINEBARK
L	COLORADO SPRUCE	PERENNIALS, GROUND COVERS AND GRASSES	
N	EASTERN WHITE PINE	aaa	DWARF FOUNTAIN GRASS
		bbb	KARL FOERSTER FEATHER REED GRASS

FOR MASTER PLANT LIST SEE SHEET D-1

- 1 D1 DECIDUOUS TREE PLANTING  
TOWN OF OAKVILLE STANDARD DETAIL
- 4 D1 TYPICAL PLANTING LAYOUT  
TOWN OF OAKVILLE STANDARD DETAIL

LEGEND

- PROPOSED DECIDUOUS TREE
- PROPOSED CONIFEROUS TREE
- PROPOSED SHRUBS
- PROPOSED ORNAMENTAL GRASS
- BIKE RACK
- ROCKERY STONE
- BENCH
- EXISTING CHAINLINK FENCE
- GUARD RAIL
- CONCRETE UNIT PAVER
- BEACHSTONES
- LIGHT STANDARD
- SNOW STORAGE
- TOP SOIL AND SOD

BASE INFORMATION OBTAINED ELECTRONICALLY FROM  
BALDASSARRA ARCHITECTS INC. PROJ. NO. P-23064 (905-660-0722)

no.	date	version	by
3.	MAR 24 2025	ISSUED FOR SUBMISSION	EK/MM
2.	FEB 4 2025	ISSUED FOR 2ND SUBMISSION	ED/MM
1.	JULY 22 2024	ISSUED FOR REVIEW	RD/SO

All information hereon to be checked and verified at the site and any discrepancies must be reported to and clarified by the landscape architect before commencing work. All drawings, specifications, details, digital information, etc., prepared by the landscape architect are instruments of service and as such are his property and must be returned at his request.



**ALEXANDER BUDREVICS**  
LANDSCAPE ARCHITECTS

885 Don Mills Road, Second Tower, Suite 212  
Toronto, Ontario, Canada, M3C 1W3

416.444.5201  
416.444.5208

www.budrevics.com

project SP. 1215.006/01

**TAFIA BLOCK 7**  
15 WILLIAM HALTON PARKWAY EAST  
OAKVILLE, ONTARIO

BALDASSARRA ARCHITECTS INC.

drawing

LANDSCAPE PLAN

date	APRIL 28, 2024	drawn	MM
scale*	1:300	file	3721 L-1 V3-250324
direction			
project no.	3721		
sheet no.	L-1		

\*NOTED SCALE IS APPLICABLE ONLY WHEN PRINTED ON ARCH D (34"x36") SIZE SHEET

KEY MAP

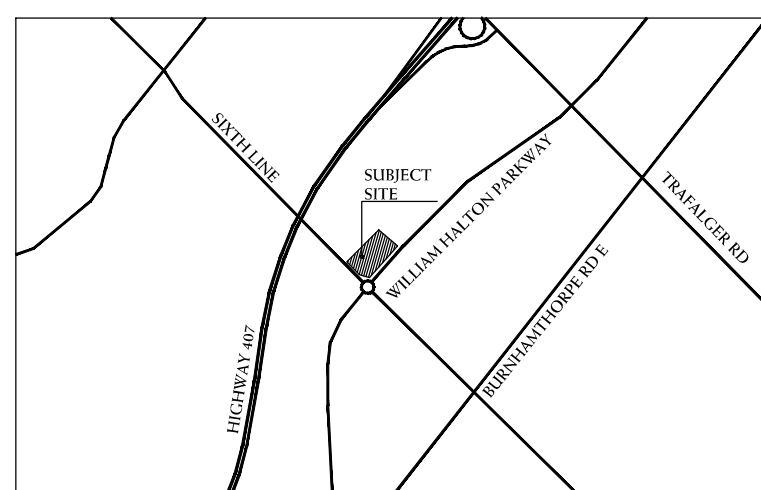

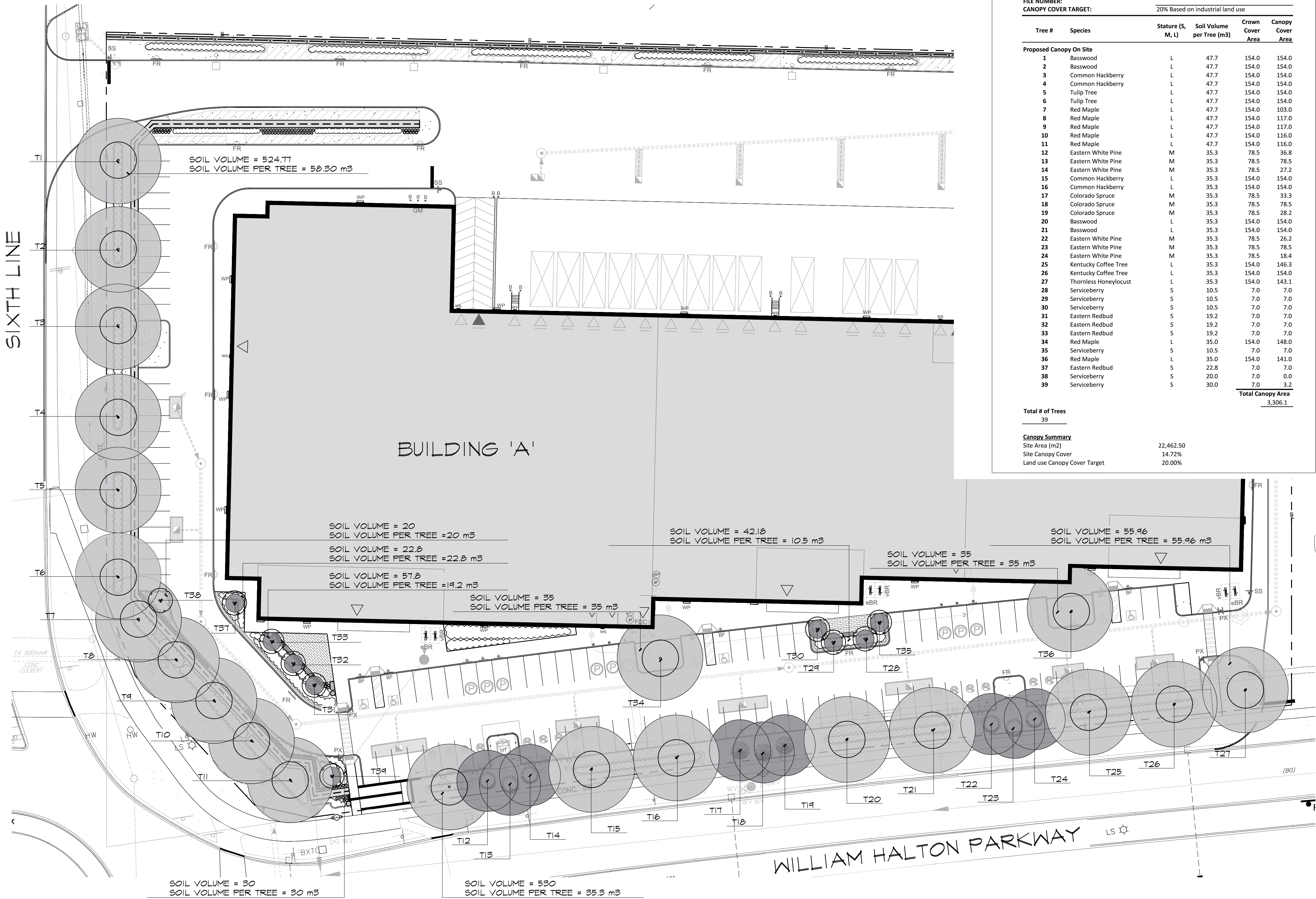

TOWN OF OAKVILLE CANOPY CALCULATION CHART

FILE NAME: Tafia Block 7  
FILE NUMBER:  
CANOPY COVER TARGET: 20% Based on industrial land use

Tree #	Species	Stature (S, M, L)	Soil Volume per Tree (m3)	Crown Cover Area	Canopy Cover Area
Proposed Canopy On Site					
1	Basswood	L	47.7	154.0	154.0
2	Basswood	L	47.7	154.0	154.0
3	Common Hackberry	L	47.7	154.0	154.0
4	Common Hackberry	L	47.7	154.0	154.0
5	Tulip Tree	L	47.7	154.0	154.0
6	Tulip Tree	L	47.7	154.0	154.0
7	Red Maple	L	47.7	154.0	103.0
8	Red Maple	L	47.7	154.0	117.0
9	Red Maple	L	47.7	154.0	117.0
10	Red Maple	L	47.7	154.0	116.0
11	Red Maple	L	47.7	154.0	116.0
12	Eastern White Pine	M	35.3	78.5	36.8
13	Eastern White Pine	M	35.3	78.5	78.5
14	Eastern White Pine	M	35.3	78.5	27.2
15	Common Hackberry	L	35.3	154.0	154.0
16	Common Hackberry	L	35.3	154.0	154.0
17	Colorado Spruce	M	35.3	78.5	33.3
18	Colorado Spruce	M	35.3	78.5	78.5
19	Colorado Spruce	M	35.3	78.5	28.2
20	Basswood	L	35.3	154.0	154.0
21	Basswood	L	35.3	154.0	154.0
22	Eastern White Pine	M	35.3	78.5	26.2
23	Eastern White Pine	M	35.3	78.5	78.5
24	Eastern White Pine	M	35.3	78.5	18.4
25	Kentucky Coffee Tree	L	35.3	154.0	146.3
26	Kentucky Coffee Tree	L	35.3	154.0	154.0
27	Thornless Honeylocust	L	35.3	154.0	143.1
28	Serviceberry	S	10.5	7.0	7.0
29	Serviceberry	S	10.5	7.0	7.0
30	Serviceberry	S	10.5	7.0	7.0
31	Eastern Redbud	S	19.2	7.0	7.0
32	Eastern Redbud	S	19.2	7.0	7.0
33	Eastern Redbud	S	19.2	7.0	7.0
34	Red Maple	L	35.0	154.0	148.0
35	Serviceberry	S	10.5	7.0	7.0
36	Red Maple	L	35.0	154.0	141.0
37	Eastern Redbud	S	22.8	7.0	7.0
38	Serviceberry	S	20.0	7.0	0.0
39	Serviceberry	S	30.0	7.0	3.2
				Total Canopy Area	3,306.1

Total # of Trees  
39

Canopy Summary

Site Area (m2) 22,462.50  
Site Canopy Cover 14.72%  
Land use Canopy Cover Target 20.00%

LEGEND

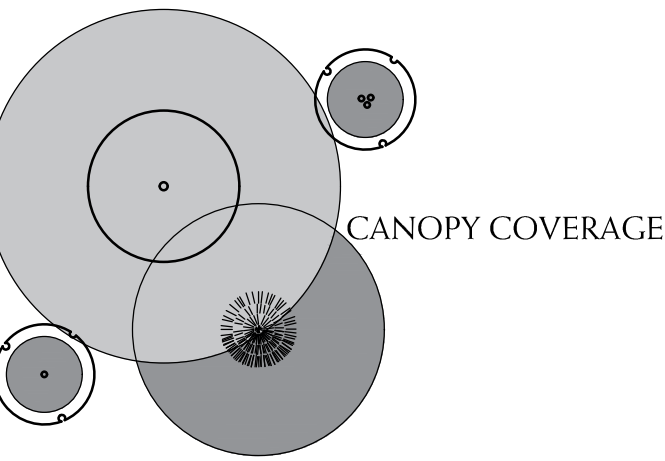

BASE INFORMATION OBTAINED ELECTRONICALLY FROM  
BALDASSARA ARCHITECTS INC. PROJ. NO. P-23064 (905-660-0722)

3.	MAR 24 2025	ISSUED FOR SUBMISSION	EK/MM
2.	FEB 4 2025	ISSUED FOR 2ND SUBMISSION	ED/MM
1.	JULY 22 2024	ISSUED FOR REVIEW	RD/SO
no.	date	version	by

All information hereon to be checked and verified at the site and any discrepancies must be reported to and clarified by the landscape architect before commencing work. All drawings, specifications, details, digital information, etc., prepared by the landscape architect are instruments of service and as such are his property and must be returned at his request.



**ALEXANDER BUDREVICS**  
ASSOCIATES LIMITED  
LANDSCAPE ARCHITECTS

885 Don Mills Road, Second Tower, Suite 212  
Toronto, Ontario, Canada, M3C 1W3

416.444.5201  
416.444.5208

www.budrevics.com

project SP. 1215.006/01

**TAFIA BLOCK 7**  
15 WILLIAM HALTON PARKWAY EAST  
OAKVILLE, ONTARIO

BALDASSARRA ARCHITECTS INC.

drawing

CANOPY COVERAGE  
PLAN

date	APRIL 28, 2024	drawn	MM
scale*	1:300	file	3721 C1 V3-250324
direction			
project no.	3721		
sheet no.	C-1		

NOTE:  
IRRIGATION TO BE INSTALLED  
IN ALL PLANTING BEDS.

\*NOTED SCALE IS APPLICABLE ONLY WHEN PRINTED ON ARCH D (34"x36") SIZE SHEET

## GENERAL

THESE SPECIFICATIONS ARE TO BE READ IN CONJUNCTION WITH THE GENERAL CONDITIONS OF THE CONTRACT AS PREPARED BY AND AVAILABLE AT THE OFFICE OF ALEXANDER BUDREVICH & ASSOCIATES LTD.

PRIOR TO COMMENCING WORK, THE CONTRACTOR SHALL:

1. FAMILIARIZE HIMSELF WITH THE PLANS, DETAILS, AND SPECIFICATIONS OF THIS PROJECT.
2. VISIT THE SITE TO ASCERTAIN AND TAKE ACCOUNT OF EXISTING CONDITIONS AND ANY VARIATIONS FROM THE PLANS IN WORK BY OTHERS.
3. FINALIZE ALL DESIGN ALTERNATIVES IN CONSULTATION WITH THE LANDSCAPE ARCHITECT.

PRIOR TO EXCAVATING, THE CONTRACTOR SHALL VERIFY THE LOCATION OF ALL UNDERGROUND UTILITIES. IN THE EVENT OF A CONFLICT BETWEEN A PROPOSED TREE LOCATION AND THE EXISTING LOCATION OF THE TREE SHALL BE DETERMINED ON SITE BY THE LANDSCAPE ARCHITECT.

**POURED-IN-PLACE CONCRETE WORK**  
THE CONTRACTOR SHALL OBTAIN WRITTEN APPROVAL OF FORMWORK PRIOR TO POURING CONCRETE. ALL CONCRETE, STEEL REINFORCING, AND FORMWORK SHALL BE AS DETAILED AND SPECIFIED ON THE DRAWINGS.

THE STYLE, COLOUR, AND FINISH OF CONCRETE ELEMENTS SHALL BE APPROVED BY THE OWNER AND/OR LANDSCAPE ARCHITECT PRIOR TO THE COMMENCEMENT OF CONCRETE WORK.

ALL STRUCTURAL CONCRETE WORK SHALL CONFORM TO LOCAL BUILDING CODES AND REGULATIONS.

THE STYLE, COLOUR, AND FINISH OF CONCRETE ELEMENTS SHALL BE APPROVED BY THE OWNER AND/OR LANDSCAPE ARCHITECT PRIOR TO THE COMMENCEMENT OF CONCRETE WORK.

ALL STRUCTURAL CONCRETE WORK SHALL CONFORM TO LOCAL BUILDING CODES AND REGULATIONS.

**BRICKWORK, STONEMASONRY & CONCRETE UNIT PAVING**  
WHERE APPLICABLE, THE CONTRACTOR SHALL OBTAIN WRITTEN APPROVAL FROM THE  
LANDSCAPE ARCHITECT OF ALL STRUCTURAL CONCRETE WORK BEFORE COMMENCING

WHERE APPLICABLE, THE CONTRACTOR SHALL OBTAIN WRITTEN APPROVAL FROM THE LANDSCAPE ARCHITECT OF ALL STRUCTURAL CONCRETE WORK BEFORE COMMENCING BRICKWORK, STONEMWORK OR PAVING WORK.

ALL BRICKWORK, STONEMWORK, AND CONCRETE UNIT PAVING SHALL BE AS DETAILED AND SPECIFIED ON THE DRAWINGS, UNLESS THE LANDSCAPE ARCHITECT AND/OR THE OWNER APPROVE SUBSTITUTIONS IN WRITING.

PRIOR TO STARTING THIS PORTION OF WORK, THE CONTRACTOR SHALL SUBMIT SAMPLE OF ALL PROPOSED BRICKWORK, STONEMWORK, AND CONCRETE UNIT PAVERS FOR

APPROVAL BY THE LANDSCAPE ARCHITECT AND/OR THE OWNER WITH RESPECT TO STYLE, COLOUR, AND FINISH. THE CONTRACTOR MAY ALSO BE ASKED TO SUBMIT SAMPLES OF ALTERNATIVES TO THE MATERIALS SPECIFIED ON THE DRAWINGS.

ALL BRICKWORK, STONEMASONRY, AND CONCRETE UNIT PAVING SHALL CONFORM TO LOCAL BUILDING CODES AND OTHER MUNICIPAL REQUIREMENTS.

PRIOR TO ORDERING MATERIAL FOR THIS PORTION OF WORK, THE CONTRACTOR SHALL SUBMIT SAMPLES OF ALL PROPOSED METALWORK FOR THE APPROVAL OF THE LANDSCAPE ARCHITECT AND/OR THE OWNER WITH RESPECT TO STYLE, COLOUR, AND FINISH. THE CONTRACTOR MAY ALSO BE ASKED TO SUBMIT SAMPLES OF ALTERNATIVES TO THE MATERIALS SPECIFIED ON THE DRAWINGS.

LENGTHS FOR FENCING SHALL BE MEASURED IN THE FIELD BY THE CONTRACTOR; SCALE MEASUREMENTS FROM THE DRAWINGS SHALL NOT BE RELIED UPON FOR DETERMINING THE NUMBER OF SECTIONS OF FENCE OR THE SIZE OF GATES THAT WILL BE NEEDED.

**MAINTENANCE**  
THE CONTRACTOR SHALL MAINTAIN ALL LANDSCAPED AREAS FOR A PERIOD OF FOUR (4) GROWING MONTHS FROM THE DATE OF SUBSTANTIAL COMPLETION.

THE CONTRACTOR SHALL MAINTAIN ALL LANDSCAPED AREAS FOR A PERIOD OF FOUR (4) GROWING MONTHS FROM THE DATE OF SUBSTANTIAL COMPLETION.

MAINTENANCE SHALL INCLUDE:

- PROPER IRRIGATION TO ENSURE OPTIMUM GROWTH OF TREES, SHRUBS, AND SOD
- GRASS MOWING TO MAINTAIN AN APPROXIMATE HEIGHT OF 50mm
- THE CULTIVATION AND WEEDING OF TREE PITS AND PLANTING BEDS
- INSECT AND DISEASE CONTROL.

AT THE END OF THE SPECIFIED MAINTENANCE PERIOD, PROVIDED ALL PLANT MATERIAL IS ALIVE AND IN A HEALTHY GROWING CONDITION, THE OWNER WILL ASSUME THE RESPONSIBILITY OF MAINTAINING THE LANDSCAPE WORK.

WRITTEN NOTICE OF PERFORMANCE ACCEPTANCE BY THE LANDSCAPE ARCHITECT FOR SUBSTANTIAL COMPLETION OF THE PROJECT LANDSCAPE WORKS SHALL MARK THE START OF THE GUARANTEE PERIOD.

SHOULD LOCAL LAW REQUIRE MUNICIPAL ACCEPTANCE, THE LANDSCAPE ARCHITECT WILL  
SUBMIT THE SUBSTANTIAL COMPLETION CERTIFICATE TO THE MUNICIPALITY SO THAT THE  
MAY PROCEED TO INSPECT THE WORK, ISSUE THEIR PERFORMANCE ACCEPTANCE  
CERTIFICATE, AND REDUCE THE AMOUNT OF SECURITIES.

ALL PLANT MATERIAL SHALL BE GUARANTEED FOR ONE (1) YEAR FROM THE DATE ON THE PERFORMANCE ACCEPTANCE CERTIFICATE ISSUED BY THE LANDSCAPE ARCHITECT. PLANTS THAT EXPIRE OR OTHERWISE FAIL TO THRIVE DURING THE GUARANTEE PERIOD SHALL BE REPLACED AT THE EXPENSE OF THE CONTRACTOR.

SIMILARLY, ALL OTHER LANDSCAPE WORK PERFORMED UNDER THIS CONTRACT SHALL BE FULLY GUARANTEED FOR ONE (1) YEAR FROM THE DATE OF PERFORMANCE, ACCEPTANCE BY THE LANDSCAPE ARCHITECT.

ALL WORK SHALL BE INSPECTED AT THE END OF THE GUARANTEE PERIOD BY THE LANDSCAPE ARCHITECT. ANY DEFICIENCIES SHALL BE RECTIFIED BY THE CONTRACTOR TO THE SATISFACTION OF THE LANDSCAPE ARCHITECT AND THE OWNER. THE LANDSCAPE ARCHITECT WILL THEN ISSUE A FINAL ACCEPTANCE CERTIFICATE.

SHOULD LOCAL LAW REQUIRE MUNICIPAL ACCEPTANCE, THE LANDSCAPE ARCHITECT WILL  
SUBMIT THE FINAL ACCEPTANCE CERTIFICATE TO THE MUNICIPALITY SO THAT THEY MAY  
PROCEED TO INSPECT THE WORK, GIVE FINAL APPROVAL, AND RELEASE ALL  
OUTSTANDING LANDSCAPE SECURITIES.

KEY	QUANTITY	BOTANICAL NAME	COMMON NAME	CALIPER	HEIGHT	SPREAD	ROOT	REMARKS	SPACING
<b>DECIDUOUS TREES</b>									
A	7	ACER RUBRUM	RED MAPLE	60mm	3500mm	1500mm	9.B.	EQUAL FORM	- - - -
B	5	CELTIS OCCIDENTALIS	COMMON HACKBERRY	60mm	3500mm	1200mm	9.B.	EQUAL FORM	- - - -
C	1	GLEDTISIA TRIACANTHOS VAR. INERMIS 'SHADEMASTER'	SHADEMASTER HONEYLOCUST	60mm	3500mm	1500mm	9.B.	EQUAL FORM	- - - -
D	2	GYMNOGLADUS DIOICIS	KENTUCKY COFFEE TREE	60mm	3500mm	1500mm	9.B.	EQUAL FORM	- - - -
E	2	LIRIODENDRON TULIPIFERA	TULIP TREE	60mm	3500mm	1500mm	9.B.	EQUAL FORM	- - - -
F	4	TILIA AMERICANA	BASSWOOD	60mm	3000mm	1500mm	9.B.	EQUAL FORM	- - - -
<b>ORNAMENTAL TREES</b>									
G	6	AMELANCHIER CANADENSIS	DOWNY SERVICEBERRY	3 x 50mm	2500mm	1200mm	9.B.	MULTI-STEM	- - - -
H	4	CERCIS CANADENSIS	EASTERN REDBUD	3 x 50mm	2500mm	1200mm	9.B.	MULTI-STEM	- - - -
<b>CONIFEROUS TREES</b>									
L	3	PICEA PENSILS	COLORADO SPRUCE	- - - -	2000mm	1000mm	9.B.	SPECIMEN	- - - -
N	6	PINUS STROBUS	EASTERN WHITE PINE	- - - -	2000mm	1000mm	9.B.	SPECIMEN	- - - -
<b>CONIFEROUS SHRUBS</b>									
aa	35	JUNIFERUS CHINENSIS 'MINT JULEP'	MINT JULEP JUNIPER	- - - -	500mm	1000mm	POTTED	MIN. 10 STEMS	800mm
<b>DECIDUOUS SHRUBS</b>									
bb	225	CORNUS SERICEA	RED OSIER DOGWOOD	- - - -	800mm	- - - -	POTTED	MIN. 10 STEMS	750mm
cc	70	DIERVILLA LONICERA	BUSH HONEYSUCKLE	- - - -	500mm	- - - -	POTTED	MIN. 10 STEMS	650mm
dd	120	PHYSOCARPUS OPULIFOLIUS 'LITTLE DEVIL'	LITTLE DEVIL DWARF NINEBARK	- - - -	600mm	- - - -	POTTED	MIN. 10 STEMS	650mm
ee	70	RHUS AROMATICA 'GRO LOW'	GRO LOW FRAGRANT SUMAC	- - - -	600mm	- - - -	POTTED	MIN. 10 STEMS	800mm
ff	120	ROSA BLANDA	MEADOW ROSE	- - - -	500mm	- - - -	POTTED	MIN. 10 STEMS	650mm
gg	213	SPIREA BUNALDA 'GOLDFLAME'	GOLDFLAME SPIREA	- - - -	600mm	- - - -	POTTED	MIN. 10 STEMS	650mm
hh	164	CORNUS SERICEA 'KELSEY'	KELSEY RED OSIER DOGWOOD	- - - -	500mm	- - - -	POTTED	MIN. 10 STEMS	650mm
jj	75	PHYSOCARPUS OPULIFOLIUS	COMMON NINEBARK	- - - -	800mm	- - - -	POTTED	MIN. 10 STEMS	750mm
<b>PERENNIALS, GROUND COVERS AND GRASSES</b>									
aaa	22	PENNISETUM ALODEGROIDES 'HAMELN'	DWARF FOUNTAIN GRASS	- - - -	- - - -	- - - -	1 gal. POT	MIN. 2 YRS. GTH	400mm
bbb	150	CALAMAGROSTIS X ACUTIFLORA KARL FOERSTER'	KARL FOERSTER FEATHER REED GRASS	- - - -	- - - -	- - - -	1 gal. POT	MIN. 2 YRS. GTH	400mm

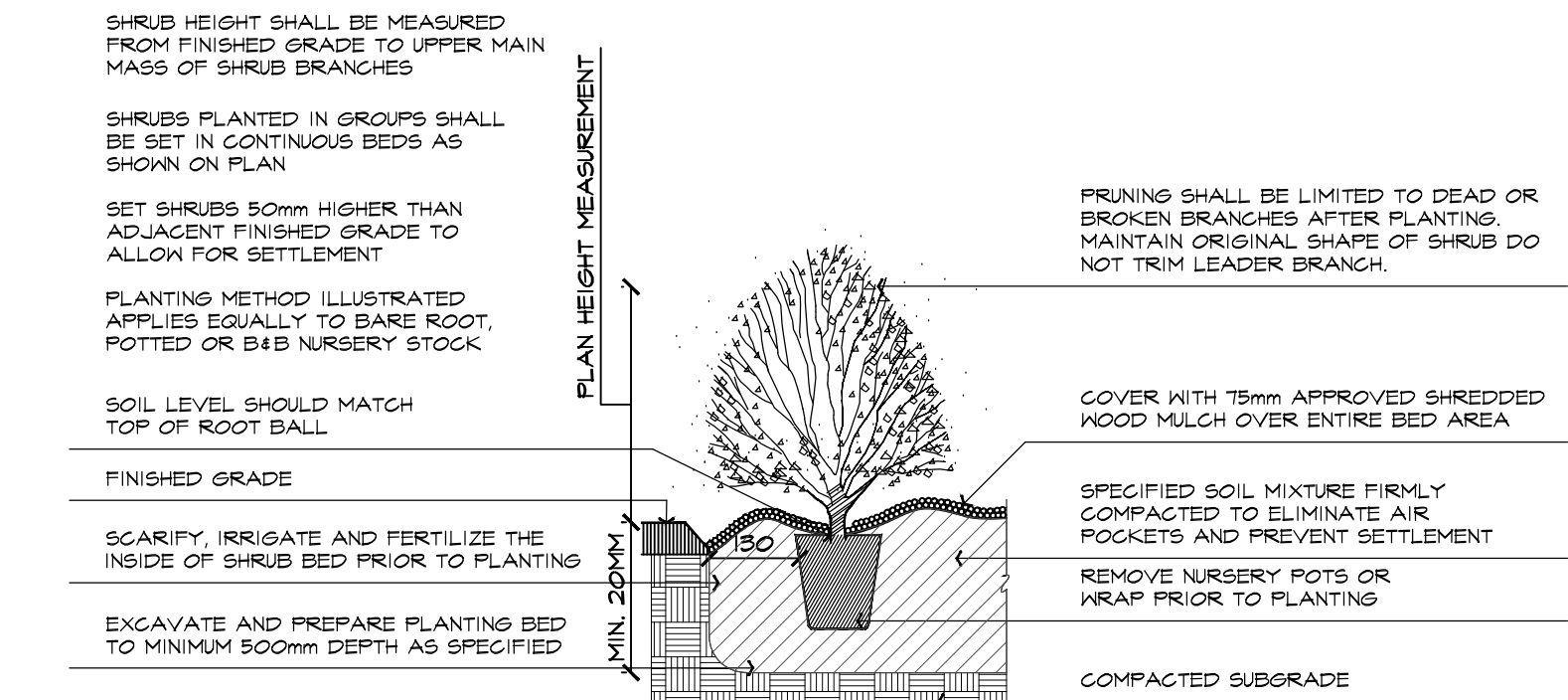

3 SHRUB PLANTING DETAIL SCALE 1:25  
TYPICAL INSTALLATION ABAL P301-240124

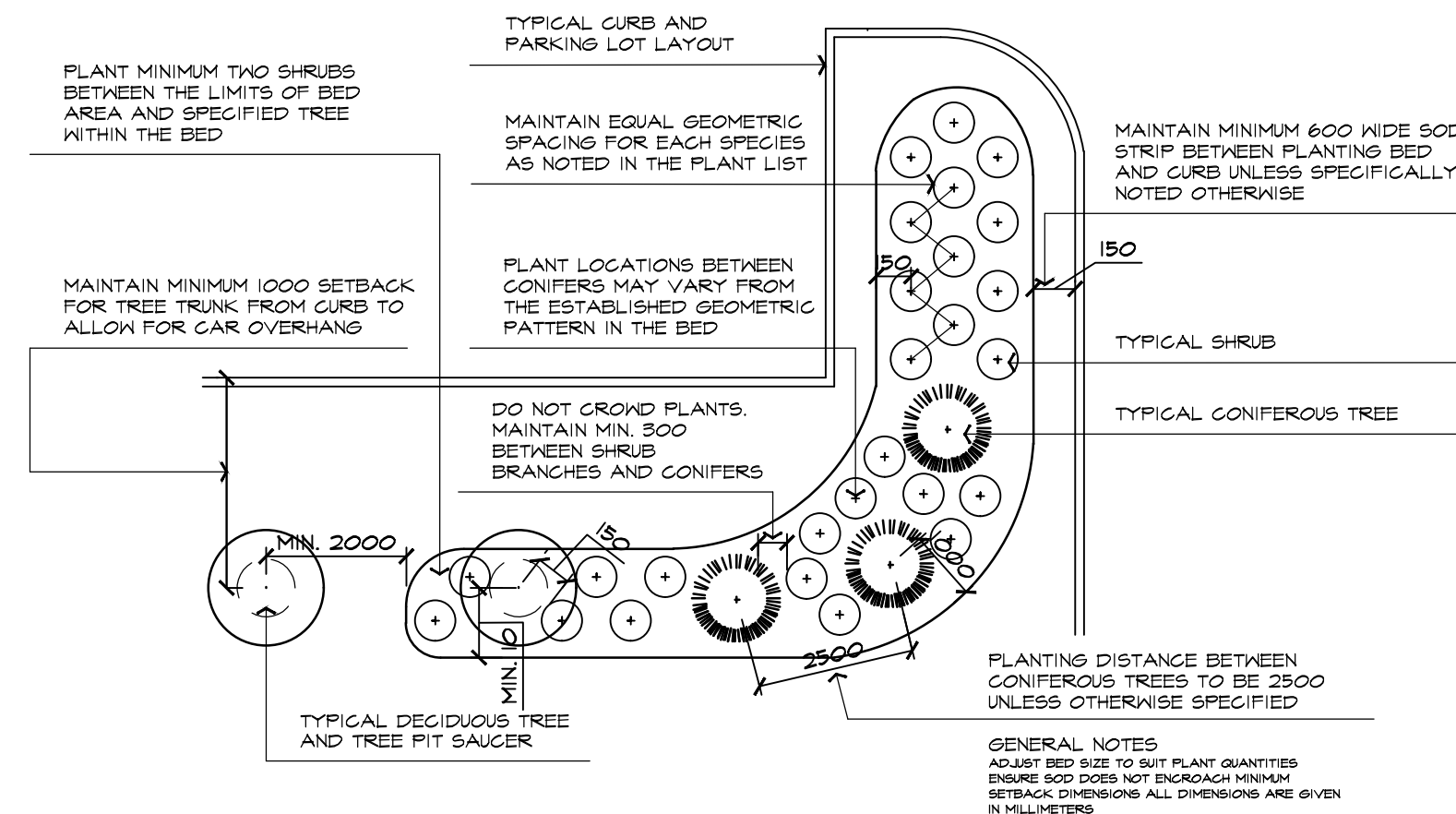

4 TYPICAL PLANTING LAYOUT SCALE 1:100  
 SYMBOLS REPRESENT INSTALLED PLANT SIZE  
 ABAL P40I-240I24

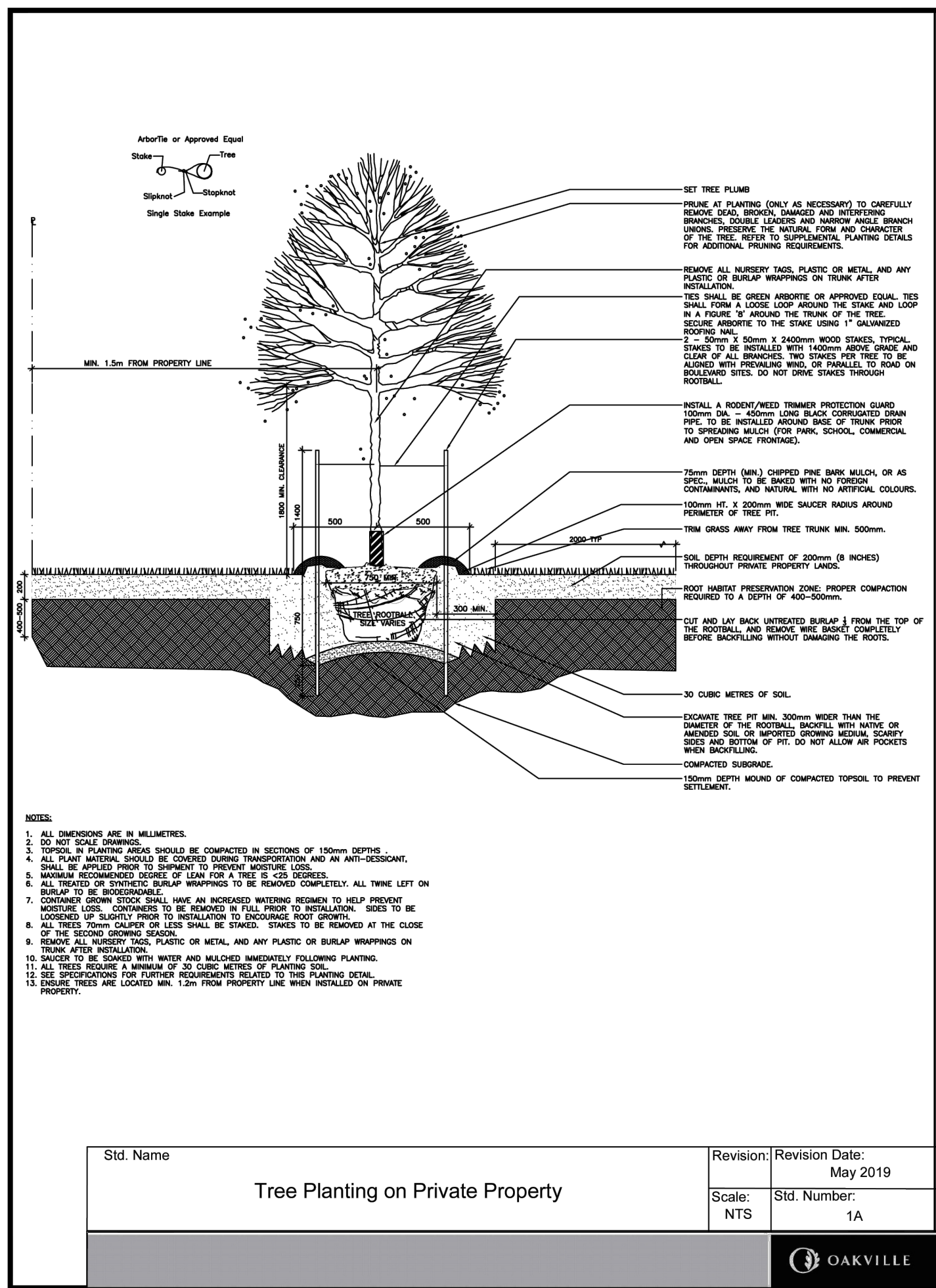

# DECIDUOUS TREE PLANTING DETAIL

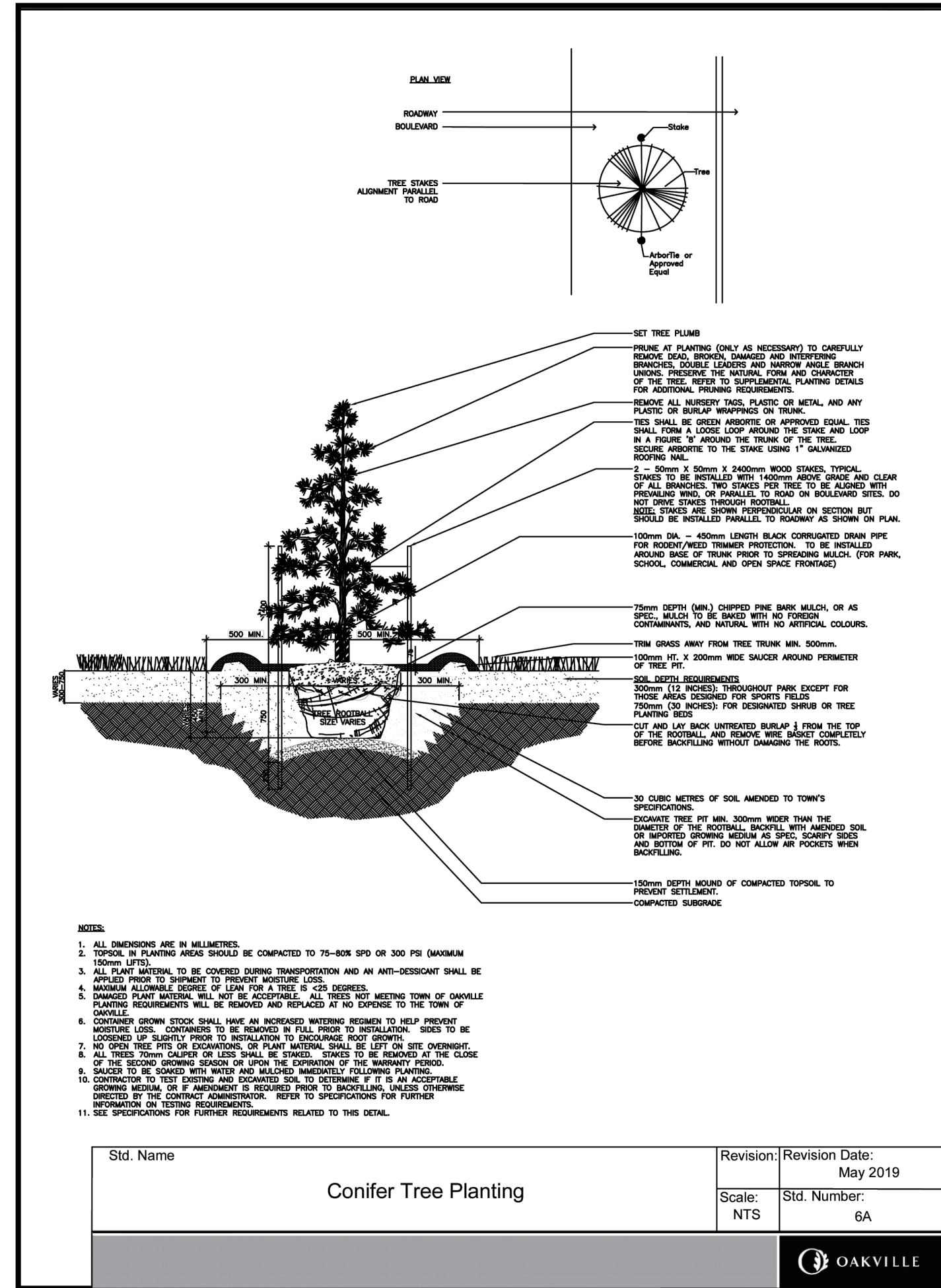

# CONIFEROUS TREE PLANTING DETAIL

3.	MAR 24 2025	ISSUED FOR SUBMISSION	EK/ MM
2.	FEB 4 2025	ISSUED FOR 2ND SUBMISSION	ED/ MM
1.	JULY 22 2024	ISSUED FOR REVIEW	RD/ SO
no.	date	version	by

All information hereon to be checked and verified at the site and any discrepancies must be reported to and clarified by the landscape architect before commencing work. All drawings, specifications, details, digital information, etc., prepared by the landscape architect are instruments of service and as such are his property and must be returned at his request.



ALEXANDER BUDREVICS  
A ASSOCIATES LIMITED  
LANDSCAPE ARCHITECTS

895 Don Mills Road, Second Tower, Suite 212  
Toronto, Ontario, Canada, M3C 1W3

☎ 416.444.5301  
☎ 416.444.5308

[www.budrevics.com](http://www.budrevics.com)

project SP. 1215.006/01

**TAFIA BLOCK 7**  
15 WILLIAM HALTON PARKWAY EAST  
OAKVILLE, ONTARIO

**BALDASSARRA ARCHITECTS INC.**

drawing

## LANDSCAPE DETAILS & SPECIFICATIONS

date	APRIL 28, 2024	drawn	MM
scale*	AS SHOWN	file	3721 D-1 V3-250324
direction		project no.	3721
		sheet no.	D-1

**MBE-0870-00021**  
Legacy # MLB870-PCS-C



MATERIALS:	<p>                     Bench ends are made from solid cast aluminum. The seat employs high density paper composite (HDPC) slots - Sandstone color.                 </p>
FINISH:	<p>                     All steel components are protected with E-Coat rust proofing. The Maglin Powdercoat System provides a durable finish on all metal surfaces.                 </p>
INSTALLATION:	<p>                     The bench is delivered pre-assembled. Holes (0.5") are provided in each foot for securing to base.                 </p>
TO SPECIFY:	<p>                     Select MBE-0870-00021                      Choose:                          - Powdercoat Color                 </p>

HEIGHT: 32.2" (81.7cm)      LENGTH: 69.5" (176.5cm)      DEPTH: 24.4 (62.1cm)      WEIGHT: 123.68lbs (56.1kg)

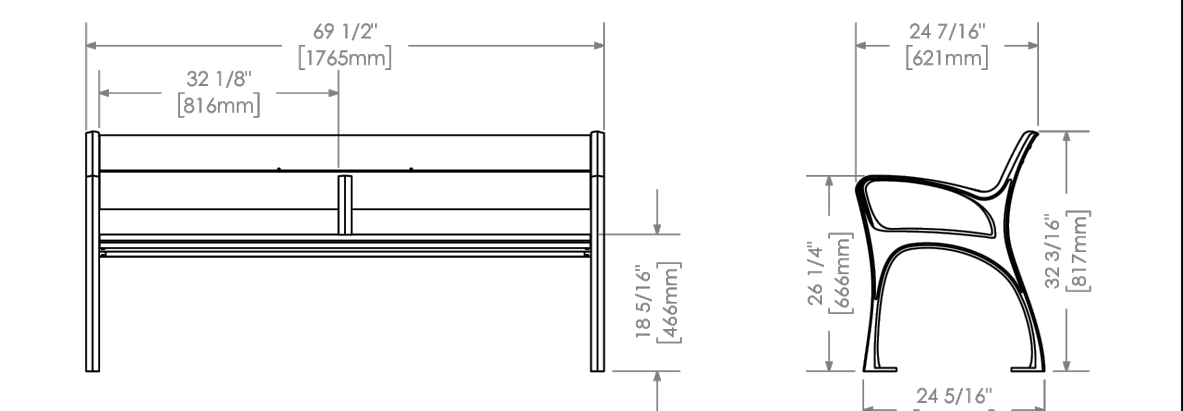



**MAGLIN™**  
 Site Furniture

T 800 716 6506  
 F 877 260 9393  
[www.maglin.com](http://www.maglin.com)  
[sales@maglin.com](mailto:sales@maglin.com)

- All drawings, specifications, design and details on this page remain the property of Maglin Site Furniture Inc. and may not be used without Maglin authorization.  
 - Details and specifications may vary due to continuing improvements of our products.

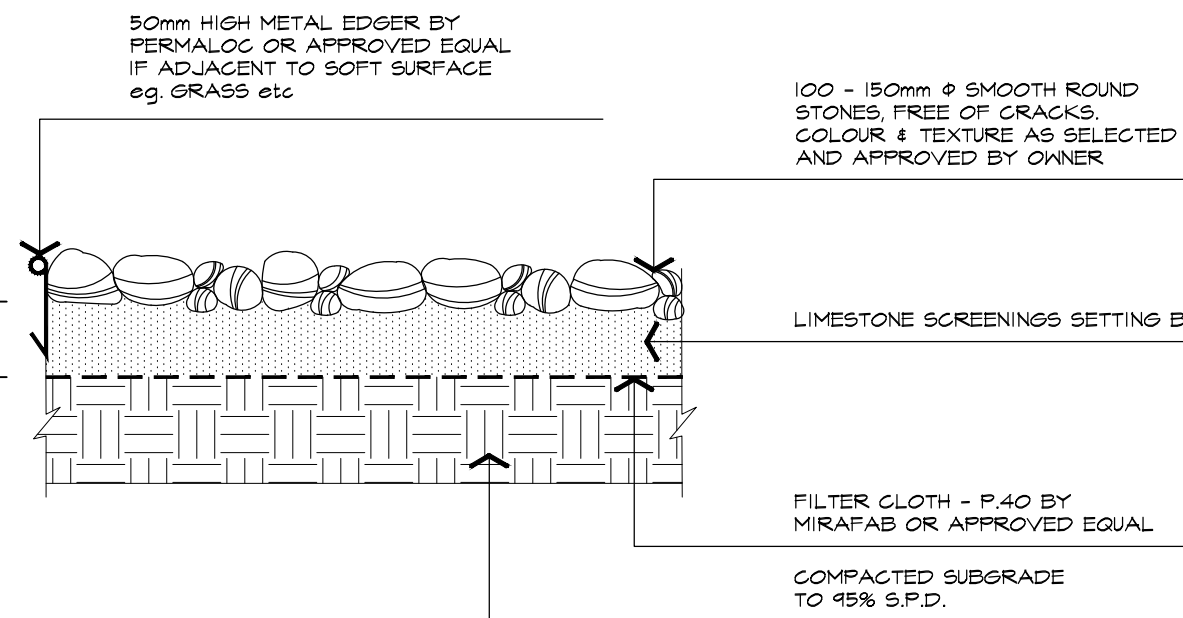
MANUFACTURER: MAGLIN  
PRODUCT: 800 SERIES BENCH - MBE-0870-0002  
COLOUR: HDPC SANDSTONE FOR SLABS & GUNMETAL FINE TEXTURED (MATTE) FOR METAL  
QUANTITY: AS APPROVED BY CLIENT PRIOR TO ORDERING  
FIVE (5) TOTAL ON SITE  
OR APPROVED SUBSTITUTE



## TYPICAL INSTALLATION ABAL H60I-200508

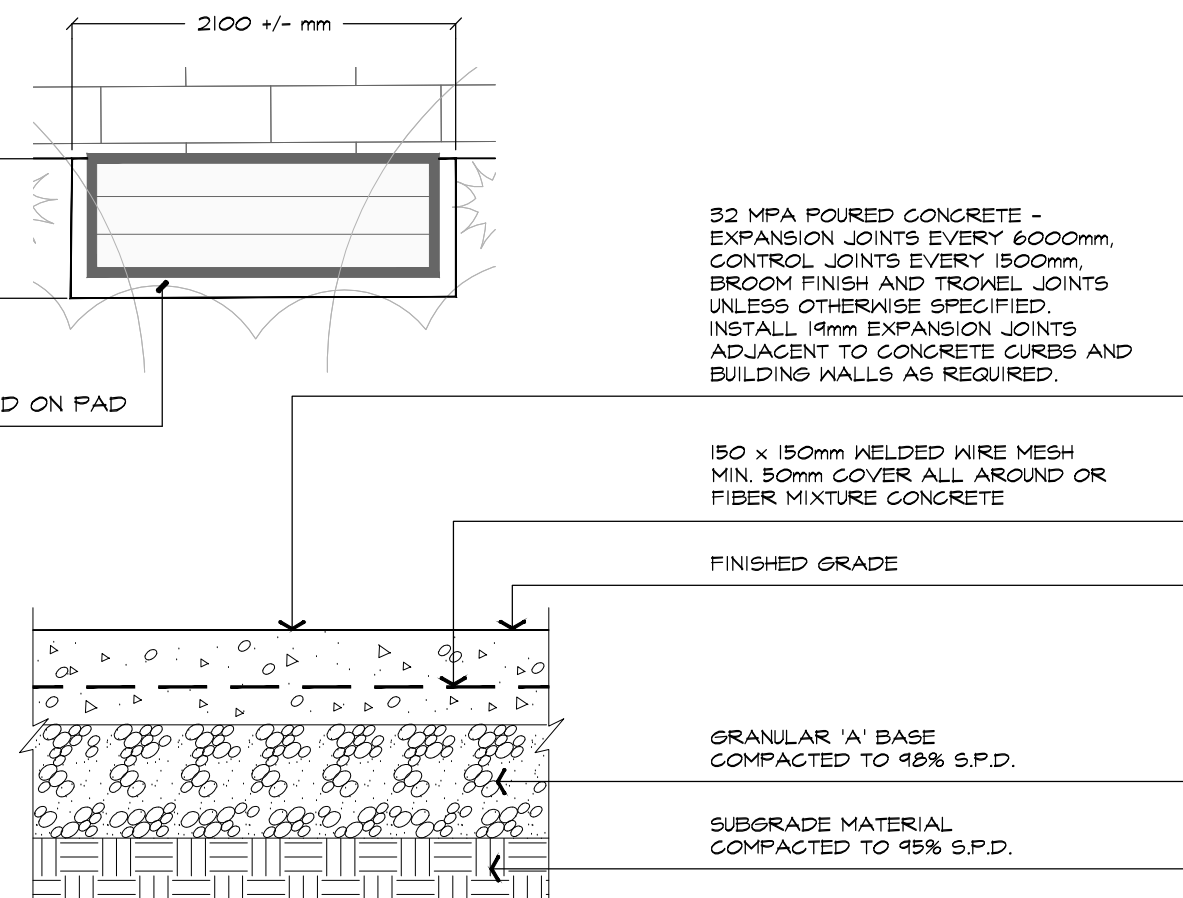

## TYPICAL INSTALLATION ABAL H201-200417

SINGLE TIER AT GRADE

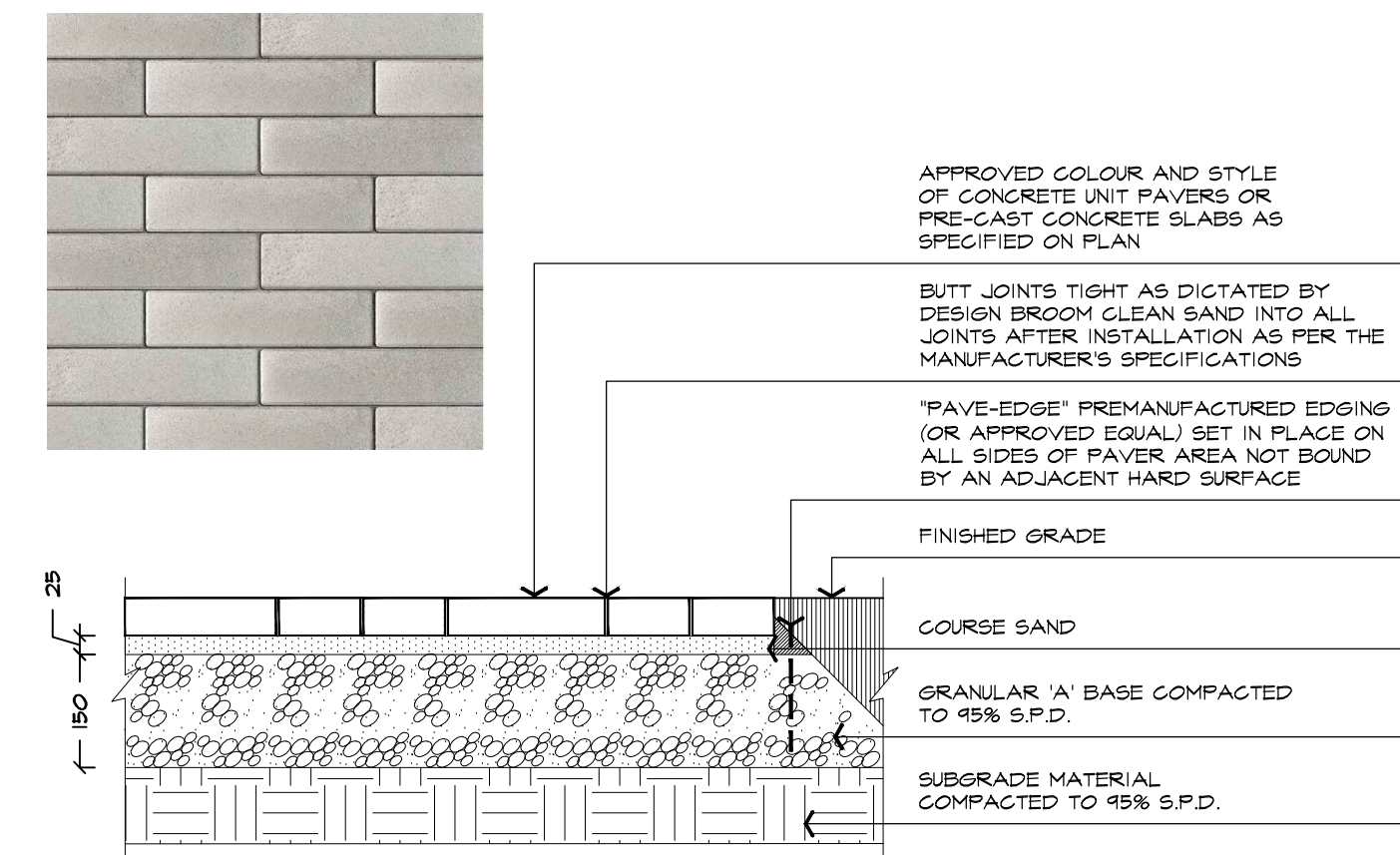
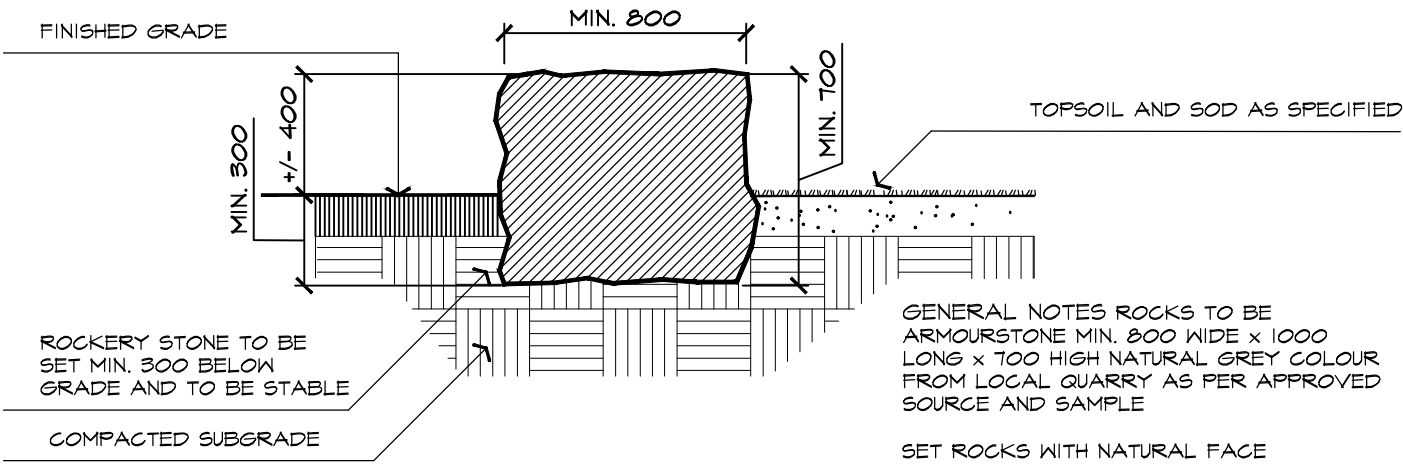

## TYPICAL INSTALLATION ABAL H301-200903

TYPICAL INSTALLATION  
SUPPLIER: UNILOCK (DANNY GATTO - 416 697 0156)  
PRODUCT: PROMENADE PLANK PAVER  
COLOUR: OPAL BLEND (34 SRI VALUE)  
\*OR APPROVED SUBSTITUTE

ola® Blue Rock  
ation Guide

Date: September 9, 2016  
www.landscapereforms.com Ph: 800.521.2646

**HANDLE WITH CARE!** Bola's finish can be scuffed by contact with tools, concrete, or other abrasive surfaces. Protect the finish from damage during installation. Use touch-up paint to repair any powder coat finish abrasions.

**INSTALLATION:**

1. Core drill 3" diameter (minimum) holes 6" deep.
2. Prepare the holes for outdoor anchoring cement, such as Kwikset™ or Por-rok®. Follow the manufacturer's instructions for blowing out dust with water, scrubbing, and removing excess water.
3. Place the bike rack back into position and fill the holes with anchoring cement.
4. Wipe away any excess before it cures.

MANUFACTURER: LANDSCAPE FORMS (TRACY COOK - 800.430.6206 X 1345)  
PRODUCT: BOLA BIKE RACK  
FINISH: GUNMETAL FINE TEXTURED (MATTE)  
AS APPROVED BY CLIENT PRIOR TO ORDERING  
QUANTITY: SIX (6) TOTAL ON SITE

**\*\*OR OF APPROVED SUBSTITUTE**

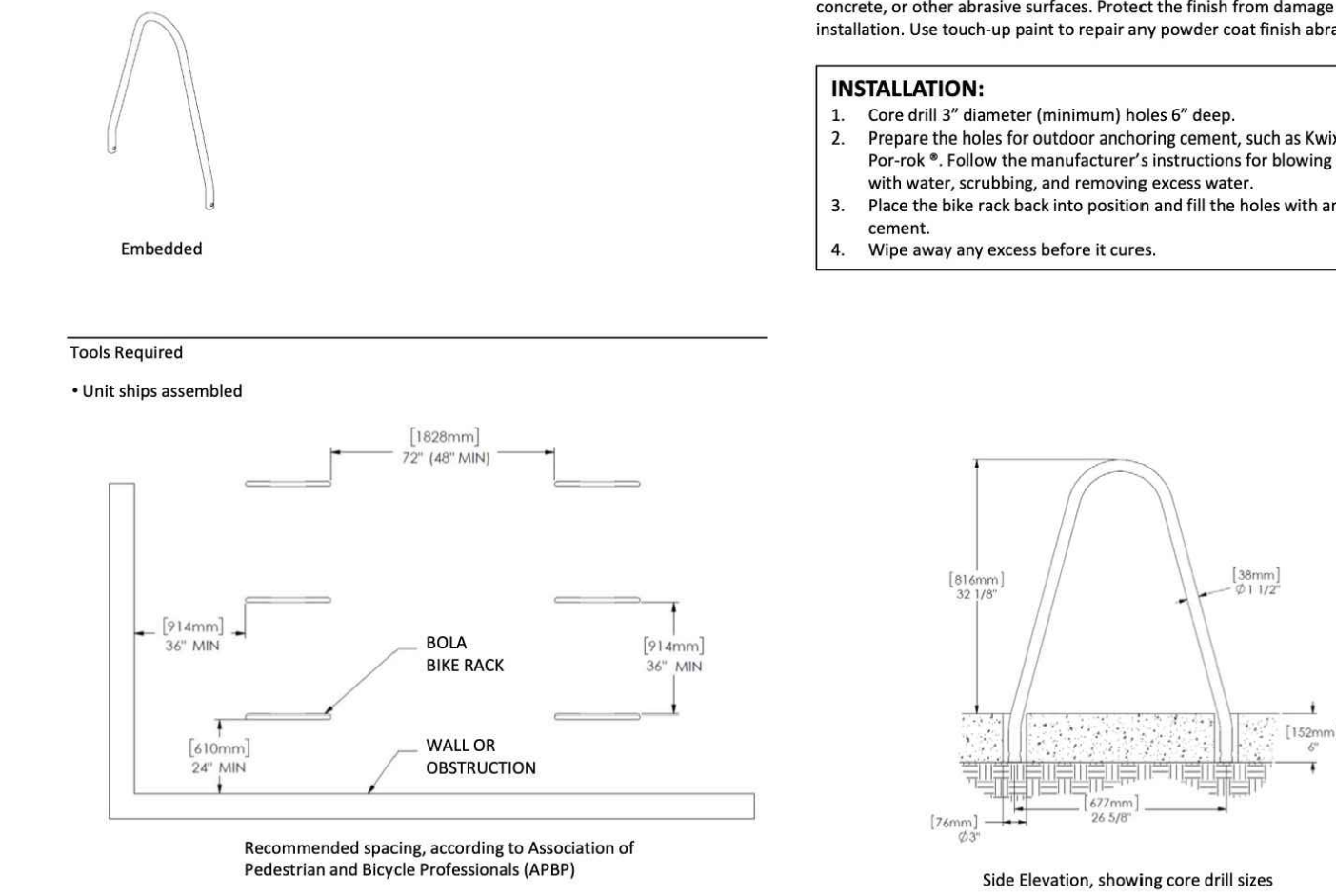

MANUFACTURER: LANDSCAPE FORMS (TRACY COOK - 800.430.6206 X 1345)  
PRODUCT: BOLA BIKE RACK  
FINISH: GUNMETAL FINE TEXTURED (MATTE)  
AS APPROVED BY CLIENT PRIOR TO ORDERING  
QUANTITY: SIX (6) TOTAL ON SITE

**\*\*OR OF APPROVED SUBSTITUTE**

MANUFACTURER: MEDALLION FENCE LTD.  
PRODUCT: SERIES - 9000S-AL STYLE - 9900S-AL  
COLOUR: "GUNMETAL" (GRAY) MAGLIN COLOUR TO MATCH SPECIFIED SITE FURNISHINGS.  
OR APPROVED SUBSTITUTE

