

## Appendix A: Photographs of Trees / Polygons



Image 1. From left to right, Trees 352 – 355



Image 2. Trees 356 (left) and 357 (right)

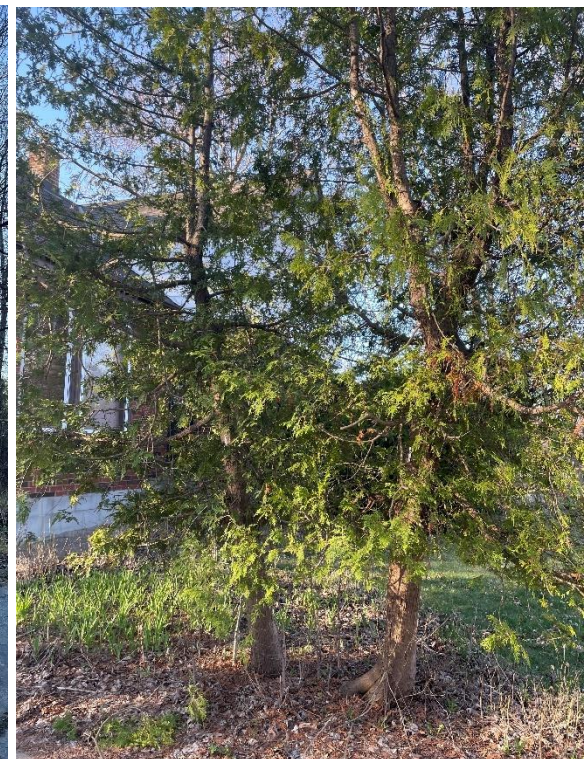

Image 3. Trees 358 (left) and 359 (right)





Image 4. Tree 360



Image 5. Trees 361 (right) and 352 (left)



Image 6. Trees 363 (midground) and 364 (foreground)





Image 7. Tree 365



Image 8. Polygon 366



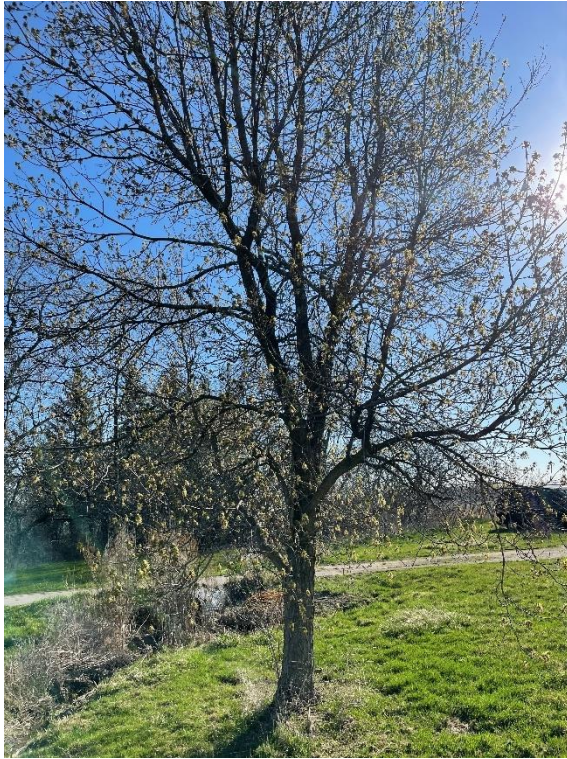

Image 9. Tree 367



Image 10. Tree 368





Image 11. From left to right, Trees 369 – 371

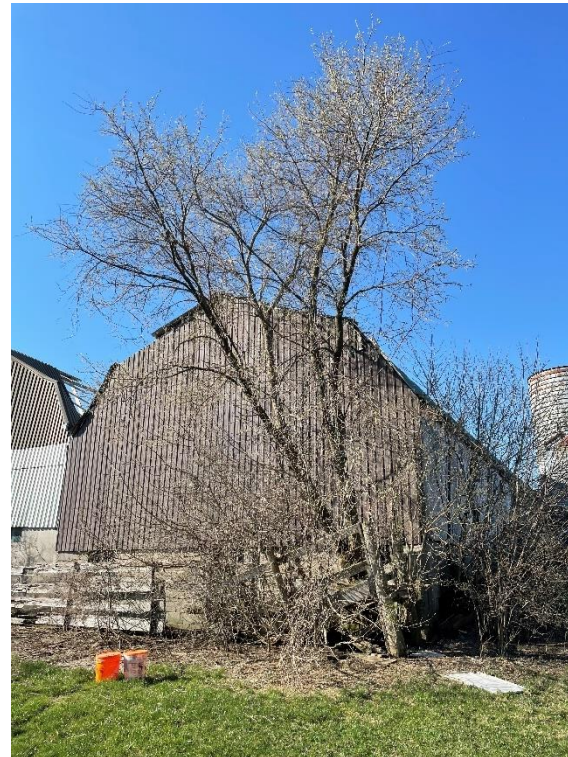

Image 12. Tree 372



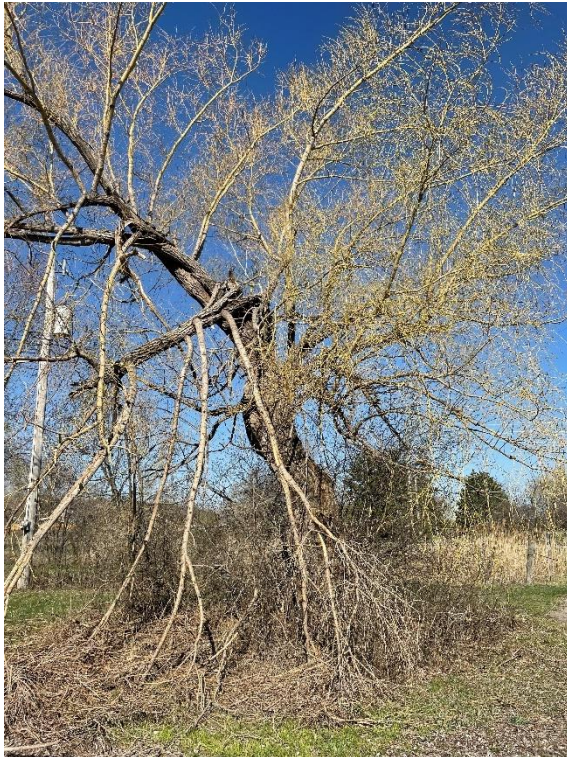

Image 13. Tree 373



Image 14. Tree 374



Image 15. From right to left, Trees 375 – 377





Image 16. From left to right, Trees 378 – 380



Image 17. Trees 381 (left) and 382 (right)



Image 18. Tree 383





Image 19. From right to left, Trees 384 – 386, 388, and A



Image 20. Polygon 387





Image 21. Tree 389



Image 22. Trees 390 (left) and 391 (right)



Image 23. Trees 392 (back, right), 393 (front), and D (back, left)



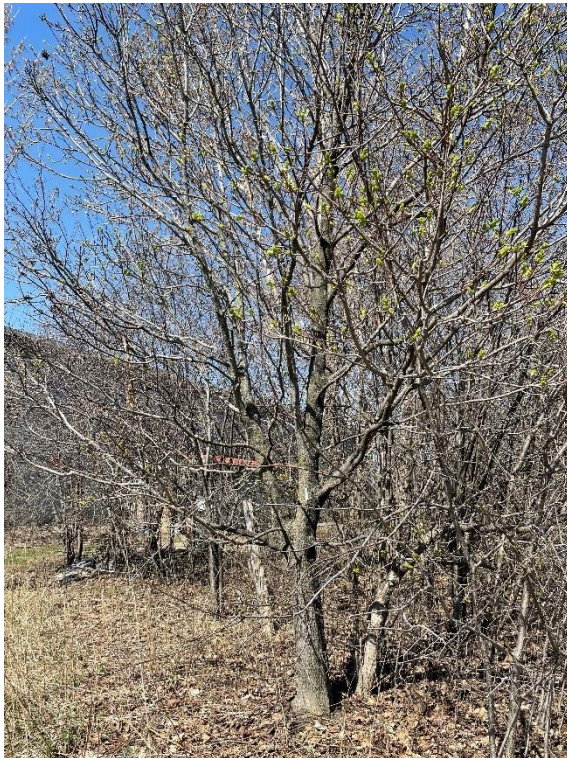

Image 24. Tree 394



Image 25. Tree 395

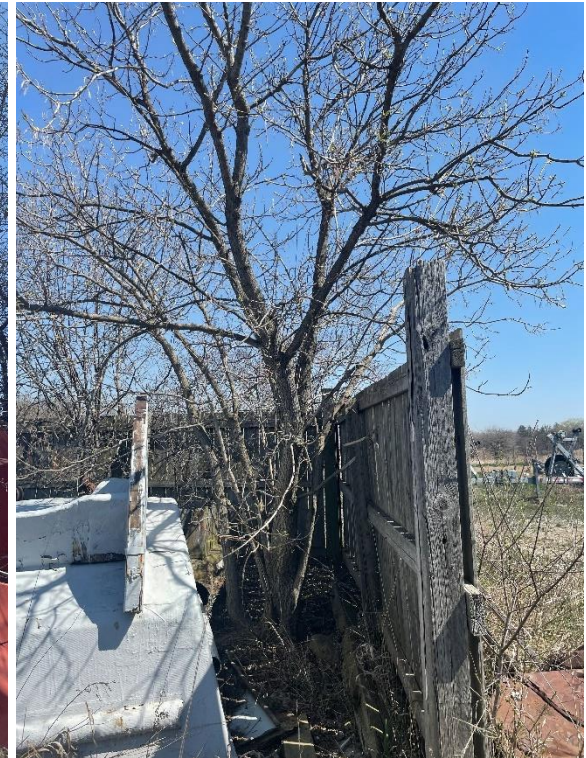

Image 26. Tree 396





Image 27. Tree 397



Image 28. Tree 398



Image 29. Tree 399





Image 30. Tree 400



Image 31. Tree 402





Image 32. Tree 403



Image 33. Tree 404



Image 34. Tree 405





Image 35. Tree 406



Image 36. Portion of Polygon 408





Image 37. Portion of Polygon 408



Image 38. Portion of Polygon 408





Image 39. Portion of Polygon 409



Image 40. Portion of Polygon 409





Image 41. Tree 410



Image 42. Tree 411



Image 43. Tree 412





Image 44. Tree 413



Image 45. Trees 414 (left) and 415 (right)



Image 46. Tree C





Image 47. Tree E



Image 48. Tree F



Image 49. Tree G





Image 50. Tree H

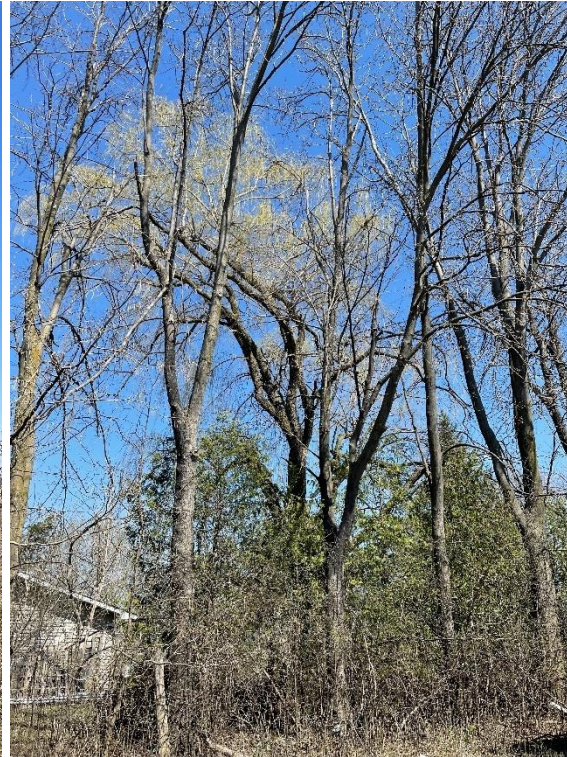

Image 51. Tree J (behind row of trees)

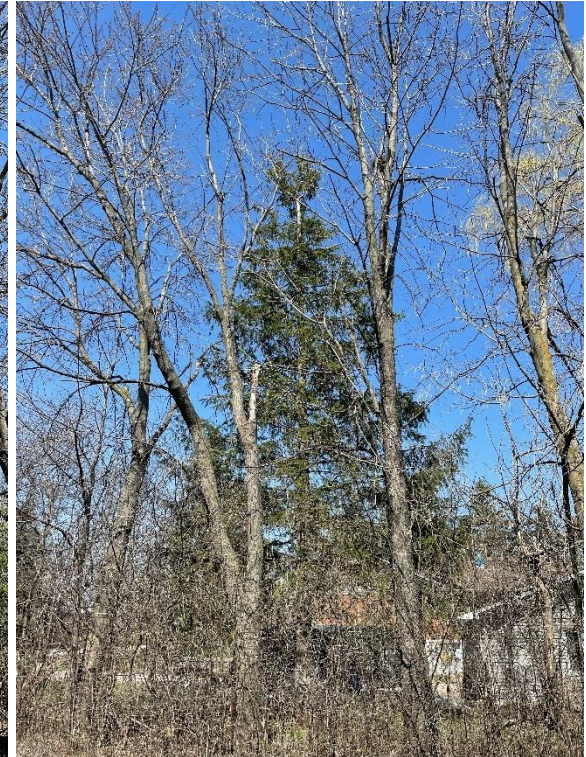

Image 52. Tree K (behind row of trees)





Image 53. Tree L (centre)

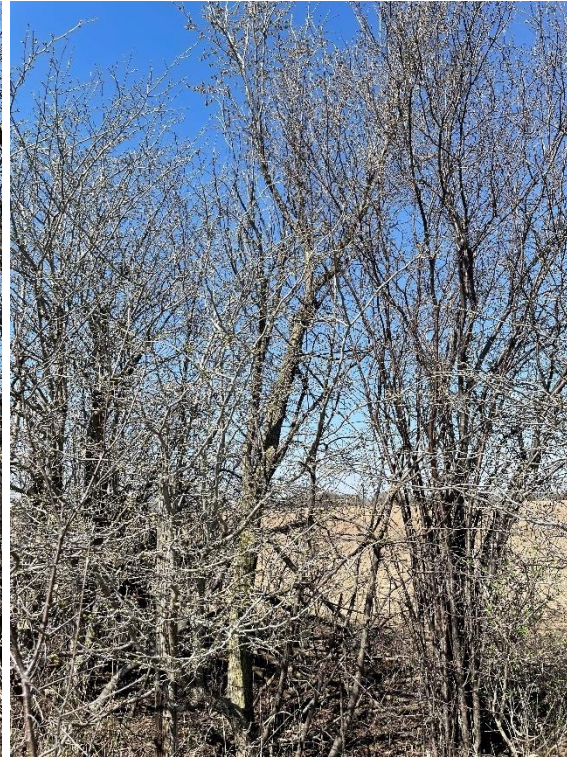

Image 54. Tree M (centre)



Image 55. Tree N





Image 56. Tree O



Image 57. Facing southwest towards NHS feature





Image 58. Facing southeast towards NHS feature