

**Tree Inventory Assessment**

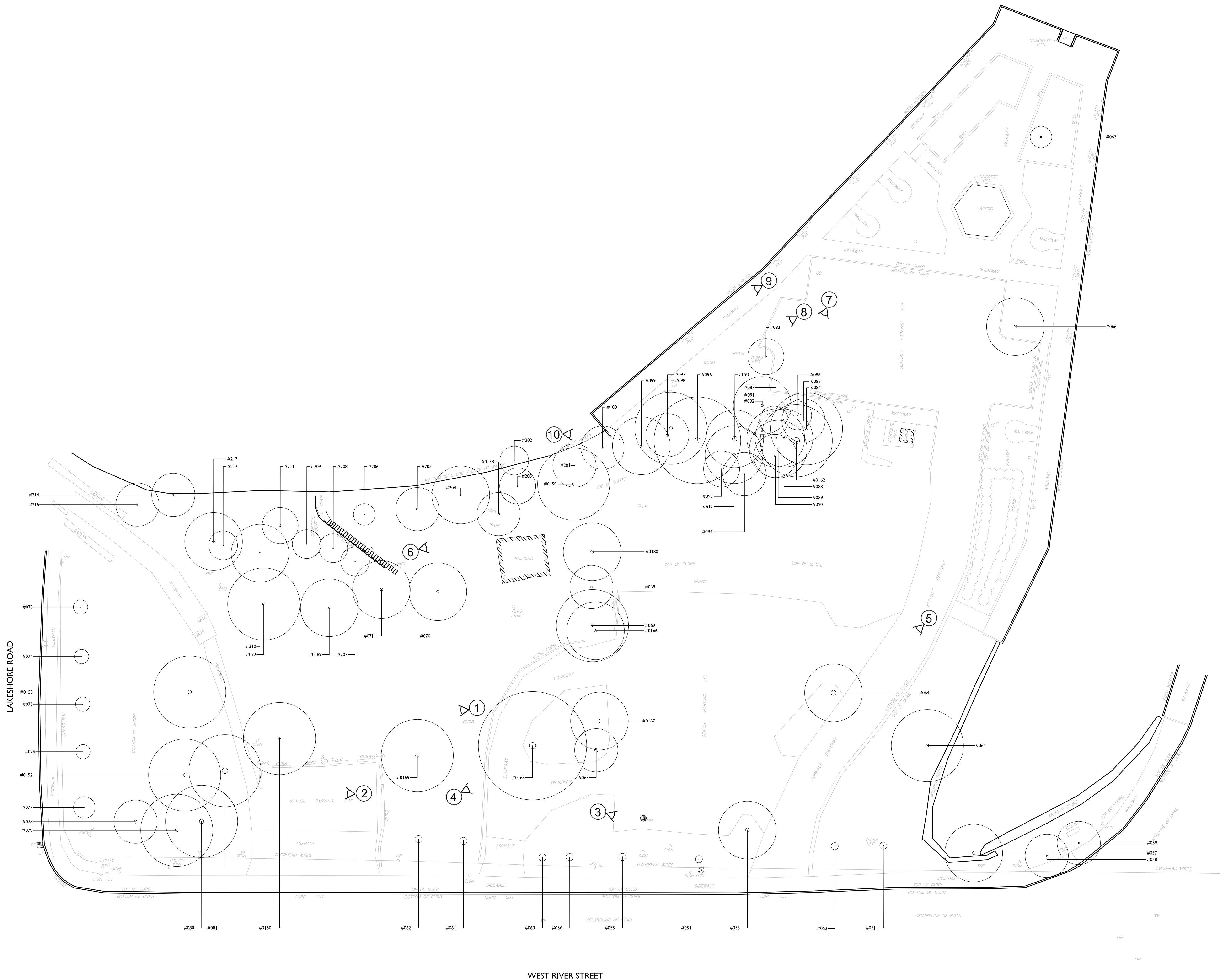

Key Plan

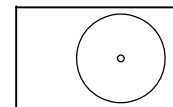
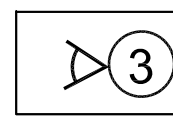

Legend

-  EXISTING TREE
-  PHOTO LOCATION



Inspection Conducted on October 30th, 2020 By Mike Hukezalie - ISA Certified Arborist No. ON-2408A

SURVEY INFORMATION PROVIDED BY J.H. GELBLOOM SURVEYING LTD. SURVEY INFORMATION AS OF OCTOBER 1, 2020

No	Date	Revisions	By

I	03-19-2021	Issued for Review	JSI
---	------------	-------------------	-----

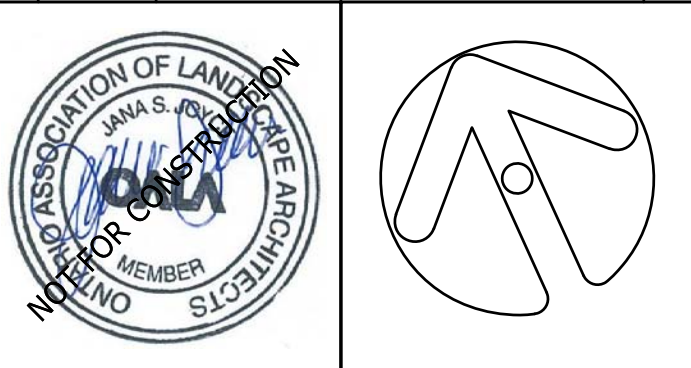

**the mbtw group**  
 landscape architecture urban design interior design construction project management  
 255 Woodbine Ave., Unit 1A, Toronto, Ontario, Canada M4M 1B8  
 Tel: (416) 447-7787 Fax: (416) 448-1883 www.mbtw.com

Project Name:  
**Berta Point Park**  
 Bronte Creek, Oakville, ON

Municipality: **Town of Oakville**

Sheet Title:  
**Tree Preservation Plan**

Designed:	Drawn:	Scale:	Drawing No.:
	MH / GM	1:250	TP-1A
Date of Drawing:	Job No.:		
November 18, 2020	SHE006		





PHOTO #1



PHOTO #2



PHOTO #3



PHOTO #4



PHOTO #5



PHOTO #6



PHOTO #7



PHOTO #8



PHOTO #9



PHOTO #10

TAG #	BOTANICAL NAME	COMMON NAME	DBH (cm)	CNPKY (m)	COND.	REMARKS	PRES. STATUS
051	<i>Tilia cordata</i>	Little Leaf Linden	8	1	Good	New planting	TBD
052	<i>Tilia cordata</i>	Little Leaf Linden	6	1	Good	New planting	TBD
053	<i>Fraxinus sp.</i>	Ash	55	8	Fair	Few dead twigs	TBD
054	<i>Tilia cordata</i>	Little Leaf Linden	8	1	Good	New planting	TBD
055	<i>Tilia cordata</i>	Little Leaf Linden	8	1	Good	New planting	TBD
056	<i>Tilia cordata</i>	Little Leaf Linden	6	1	Good	New planting	TBD
057	<i>Acer saccharinum</i>	Silver Maple	42	8	Fair	Half of crown is missing on one side	TBD
058	<i>Malva sp.</i>	Apple	20	6	Fair	Lean, signs of decay, adjacent to water edge	TBD
059	<i>Malva sp.</i>	Apple	19	6	Fair	Lean, signs of decay	TBD
060	<i>Tilia cordata</i>	Little Leaf Linden	8	1	Good	New planting	TBD
061	<i>Tilia cordata</i>	Little Leaf Linden	8	1	Good	New planting; minor trunk damage at base	TBD
062	<i>Tilia cordata</i>	Little Leaf Linden	9	1	Good	New planting	TBD
069	<i>Acer negundo</i>	Manitoba maple	50	10	Fair	Slight lean, minor damage at base, twisted canopy	TBD
068	<i>Acer negundo</i>	Manitoba maple	50	10	Fair	Large split at codominant stems @ 1.5m from grade, many burrs, slight decay at base and few upper branches	TBD
067	<i>Acer negundo</i>	Manitoba maple	44	8	Fair	Few dead branches, slight lean	TBD
063	<i>Fraxinus sp.</i>	Ash	49	6	Fair	Extended upper canopy, slight lean	TBD
064	<i>Fraxinus sp.</i>	Ash	70	8	Good	Canopy slightly to one side, minor damaged base on south side	TBD
065	<i>Juglans nigra</i>	Black Walnut	42	10	Good	Good overall condition, growing adjacent to old stumps	TBD
066	<i>Robinia pseudacacia</i>	Black Locust	41	8	Good	Good overall condition, few dead branches	TBD
067	<i>Pinus nigra</i>	Austrian Pine	20	3	Good	Slight lean in stem at base	TBD
068	<i>Acer negundo</i>	Manitoba maple	42	8	Fair	Lean, few dead branches	TBD
069	<i>Acer negundo</i>	Manitoba maple	27	6	Fair	Lean, few dead branches	TBD
069	<i>Acer negundo</i>	Manitoba maple	27	10	Fair	Lean, few dead branches	TBD
066	<i>Acer negundo</i>	Manitoba maple	39	10	Fair	Extreme lean to north	TBD
070	<i>Acer platanoides</i>	Norway Maple	35	8	Good	Many branch unions at 2.5m height	TBD
071	<i>Acer saccharinum</i>	Silver Maple	38	8	Fair	Large burr at trunk flare, minor damage to exposed roots	TBD
069	<i>Acer platanoides</i>	Norway Maple	27	8	Good	Slight lean	TBD
072	<i>Acer platanoides</i>	Norway Maple	37	10	Good	Good overall condition	TBD
073	<i>Acer saccharum</i>	Sugar Maple	6	2	Good	New planting	TBD
074	<i>Acer saccharum</i>	Sugar Maple	8	2	Good	New planting	TBD
075	<i>Acer saccharum</i>	Sugar Maple	8	2	Good	New planting	TBD
076	<i>Tilia americana</i>	Basewood	8	2	Good	Few suckers	TBD
077	<i>Ulmus Morton</i>	Accolade Elm	11	3	Good	New planting - planted too high	TBD
078	<i>Juglans regia</i>	English Walnut	42	6	Poor	Center decayed at base up 1m	TBD
079	<i>Acer platanoides</i>	Norway Maple	41	10	Fair	Slight lean and damage to trunk, corks in upper canopy	TBD
080	<i>Acer negundo</i>	Manitoba maple	60	10	Poor	Slime flux on one side, twisted stem and lean	TBD
080	<i>Acer negundo</i>	Manitoba maple	41, 34	10	Fair	Codominant stems at base, signs of decay, significant lean	TBD
081	<i>Acer negundo</i>	Manitoba maple	80	10	Poor	Significant twist and lean in upper canopy, decay and corks, dead	TBD
083	<i>Acer negundo</i>	Manitoba maple	50	10	Fair	Signs of decay, dead branches	TBD
080	<i>Acer platanoides</i>	Norway Maple	34	10	Fair	Few dead twigs, slight lean	TBD
082	<i>Acer negundo</i>	Manitoba maple	28, 30	12	Fair	Codominant stems at base, significant lean	TBD
083	<i>Robinia pseudacacia</i>	Black Locust	22	5	Terminal Decline	Significant lean and decay	TBD
082	<i>Acer negundo</i>	Manitoba maple	90	10	Fair	Significant lean, few dead branches	TBD
084	<i>Acer negundo</i>	Manitoba maple	35, 30	10	Fair	Significant lean, few dead branches, codominant stems at base	TBD
085	<i>Acer negundo</i>	Manitoba maple	18	6	Fair	Significant lean, few dead branches	TBD
086	<i>Acer platanoides</i>	Norway Maple	15	4	Good	Good overall condition	TBD
087	<i>Acer negundo</i>	Manitoba maple	30	8	Fair	Significant lean, few dead branches	TBD
088	<i>Acer negundo</i>	Manitoba maple	23	8	Fair	Significant lean, few dead branches	TBD
089	<i>Acer negundo</i>	Manitoba maple	30, 18	8	Fair	Significant lean, few dead branches	TBD
080	<i>Quercus rubra</i>	Red Oak	25	6	Good	Good overall condition, combined with tree #089 at 3m height	TBD
091	<i>Malva sp.</i>	Apple	25	4	Poor	Signs of decay, dead branches	TBD
092	<i>Acer negundo</i>	Manitoba maple	32	8	Fair	Significant lean, few dead branches	TBD
093	<i>Acer negundo</i>	Manitoba maple	65	8	Fair	Significant lean, few dead branches	TBD
092	<i>Acer negundo</i>	Manitoba maple	40	8	Fair	Significant lean, few dead branches	TBD
084	<i>Acer platanoides</i>	Norway Maple	15	6	Good	Good overall condition	TBD
095	<i>Juglans nigra</i>	Black Walnut	15	5	Good	Good overall condition	TBD
096	<i>Quercus rubra</i>	Red Oak	75	12	Good	Good overall condition, growing on slope, few dead twigs	TBD
097	<i>Quercus rubra</i>	Red Oak	33	6	Fair	Trunk damage at base, combined at base with tree #098, on slope	TBD
098	<i>Acer platanoides</i>	Norway Maple	44	10	Good	Significant lean	TBD
099	<i>Acer platanoides</i>	Norway Maple	24	8	Fair	Hollow in base	TBD
100	<i>Picea abies</i>	Norway Spruce	20	6	Fair	On steep slope	TBD
099	<i>Acer platanoides</i>	Norway Maple	39	10	Good	Codominant stems at 1.5m, on steep slope	TBD
201	<i>Acer platanoides</i>	Norway Maple	20	6	Fair	On steep slope	TBD
202	<i>Juglans nigra</i>	Black Walnut	15	4	Fair	On river bank, lean over dock	TBD
203	<i>Juglans nigra</i>	Black Walnut	17	5	Good	On slope	TBD
098	<i>Picea abies</i>	Norway Spruce	28	6	Good	Chain attached to trunk to secure dock in river	TBD
204	<i>Juglans nigra</i>	Black Walnut	20	8	Good	On slope	TBD
205	<i>Picea abies</i>	Norway Spruce	28	6	Good	Chain attached to trunk to secure dock in river	TBD
206	<i>Ulmus americana</i>	American Elm	9, 9	3	Fair	Codominant stems at 1.5m height	TBD
207	<i>Acer platanoides</i>	Norway Maple	10	4	Good	Good overall condition	TBD
208	<i>Crateagus sp.</i>	Hawthorn	15	4	Good	Codominant stems at 1m height	TBD
209	<i>Acer platanoides</i>	Norway Maple	10	4	Good	On slope	TBD
210	<i>Acer platanoides</i>	Norway Maple	27	8	Good	On slope	TBD
211	<i>Thuja occidentalis</i>	Eastern White Cedar	27	5	Good	Chain attached to trunk to secure dock in river	TBD
212	<i>Juglans nigra</i>	Black Walnut	11	4	Good	On slope	TBD
213	<i>Juglans nigra</i>	Black Walnut	31	8	Good	On slope	TBD
214	<i>Acer negundo</i>	Manitoba maple	20	6	Dead	Significant lean over water	TBD
215	<i>Acer negundo</i>	Manitoba maple	18	6	Fair	Significant lean over water	TBD

1 Tree Inventory Table



Inspection Conducted on October 30th, 2020 by Mike Hukozala - ISA Certified Arborist No. ON-2408A

SURVEY INFORMATION PROVIDED BY J.H. GELBLOOM SURVEYING LTD. SURVEY INFORMATION AS OF OCTOBER 1, 2020

03-19-2021 Issued for Review JSJ

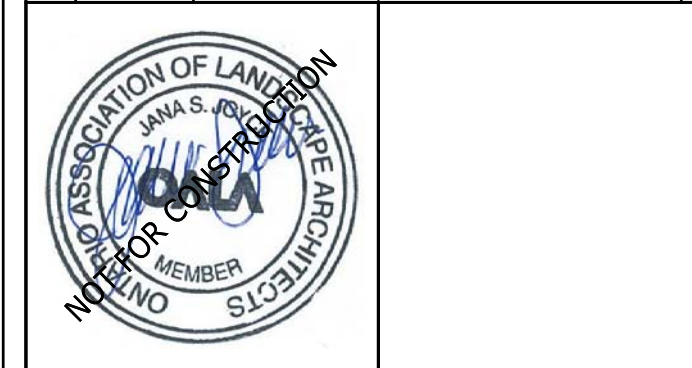

the mbtw group

Project Name: Berta Point Park Bronte Creek, Oakville, ON Municipality: Town of Oakville Sheet Title: Tree Preservation Plan

Designed: MH / GM Scale: 1:250 Drawing No.: TP-1B Date of Drawing: November 18, 2020 Job No.: SHE006