

PLANT SCHEDULE BLDG XY					
DECIDUOUS TREES	QTY	BOTANICAL NAME	COMMON NAME	SIZE	CONTAINER
CO	2	CELTIS OCCIDENTALIS	COMMON HACKBERRY	70MM CAL.	B&B
QR	6	QUERCUS RUBRA	RED OAK	70MM CAL.	B&B
DECIDUOUS SHRUBS	QTY	BOTANICAL NAME	COMMON NAME	SIZE	CONTAINER
pom	42	PHYSOCARPUS OPULIFOLIUS 'MINDIA' TM	COPPERTINA NINEBARK	3 GAL.	POT
pon	14	PHYSOCARPUS OPULIFOLIUS 'NANUS'	DWARF NINEBARK	1 GAL.	POT
pos	77	PHYSOCARPUS OPULIFOLIUS 'SMNPOTWG'	TINY WINE® GOLD NINEBARK	1 GAL.	POT
EVERGREEN SHRUB	QTY	BOTANICAL NAME	COMMON NAME	SIZE	CONTAINER
bgm	66	BUXUS X 'GREEN MOUNTAIN'	GREEN MOUNTAIN BOXWOOD	1 GAL.	POT
PERENNIALS	QTY	BOTANICAL NAME	COMMON NAME	SIZE	CONTAINER
cak	48	CALAMAGROSTIS X ACUTIFLORA 'KARL FOERSTER'	KARL FOERSTER FEATHER REED GRASS	1 GAL.	POT
ep	71	ECHINACEA PURPUREA	CONEFLOWER	1 GAL.	POT
pv	96	PANICUM VIRGATUM	SWITCH GRASS	1 GAL.	POT
sy	107	SALVIA YANGII	RUSSIAN SAGE	1 GAL.	POT
sa	122	SESLERIA AUTUMNALIS	AUTUMN MOOR GRASS	1 GAL.	POT

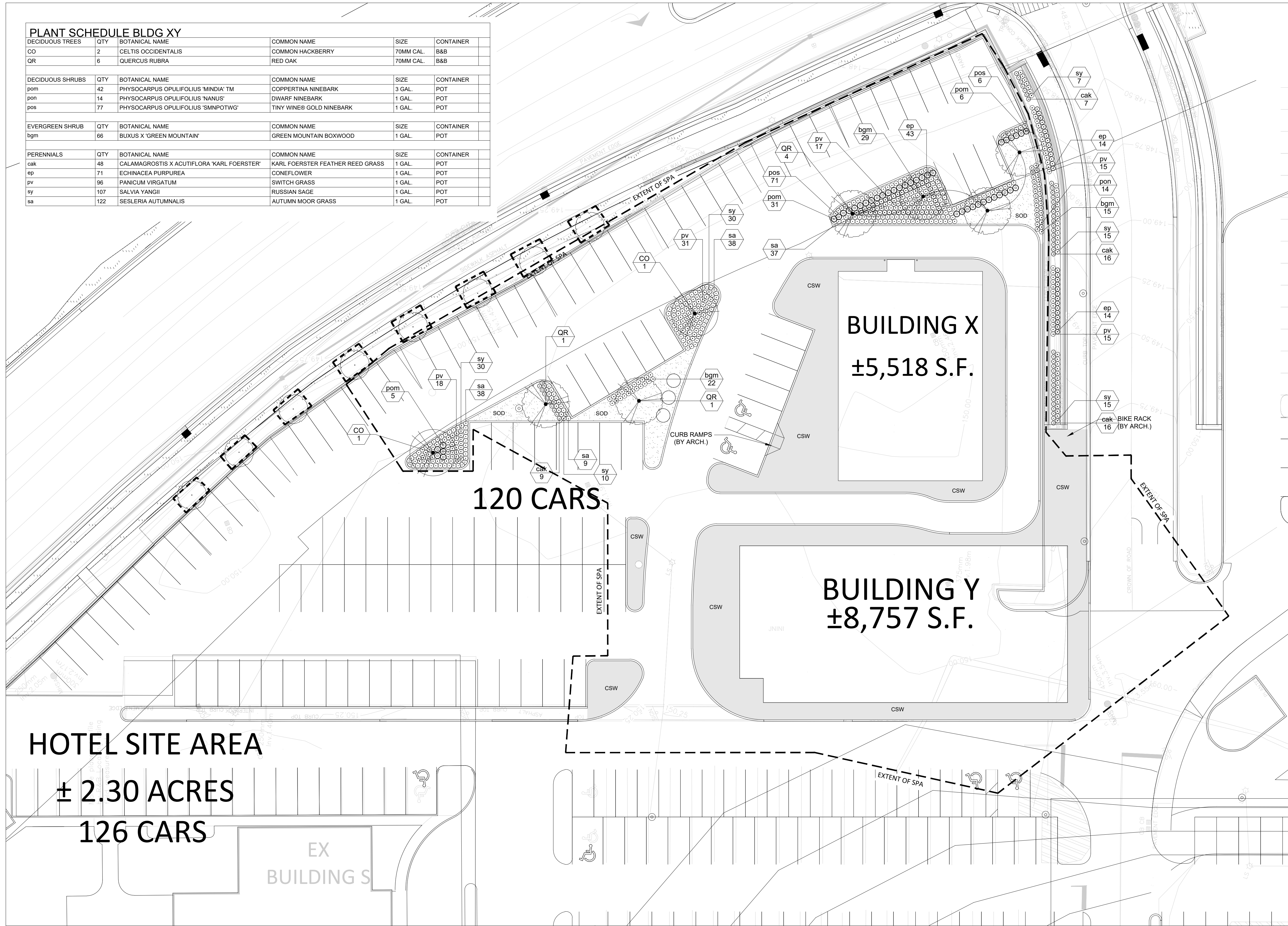

**LEGEND**

- PROPOSED DECIDUOUS TREE
- PERENNIAL AND SHRUB BED
- SODDED AREA
- CONCRETE WALKWAY
- EXISTING DECIDUOUS TREE TO REMAIN
- TREE PROTECTION FENCING
- EXTENT OF SPA

**GENERAL NOTES**

1. Do not scale the drawings. All dimensions are in millimetres unless noted otherwise.
2. This drawing is to be read in conjunction with the overall master plan and engineering drawings prepared by the project engineer and site plans prepared by the project architect.
3. The contractor shall check and verify all existing and proposed grading and conditions on the project and immediately report any discrepancies to the consultant before proceeding with any work.
4. The contractor is to be aware of all existing and proposed services and utilities. The contractor is responsible for having all underground services and utility lines staked by each agency having jurisdiction prior to commencing work.
5. This drawing is to be used for development approval only. For layout of all work refer to construction drawings.
6. Plant quantities indicated on the plan supercede the quantities from the plant list (report any discrepancies to the landscape architect).
7. Do not leave any holes open overnight.
8. Keep area outside construction zone clean and useable by others at all times. Contractor shall thoroughly clean areas surrounding the construction zone at the end of each work day.
9. Contractor to make good any and all damages outside of the development area that may occur as a result of construction at no extra cost.
10. This drawing is Copyright MHBC 2022

2.	October 20, 2023	ISSUED FOR SPA	RF
1.	November 29, 2022	ISSUED FOR SPA	BT
REVISION NO.	DATE	ISSUED / REVISION	BY

**PLANNING URBAN DESIGN & LANDSCAPE ARCHITECTURE**  
230-7030 WESTON ROAD WOODBRIDGE, ON, L4L 6G7 | P: 905.761.5588 F: 905.761.5589 | WWW.MHBCPLAN.COM

 ISSUED FOR SPA ONLY NOT FOR CONSTRUCTION <small>All drawings and specifications are instruments of service and all remain the property of MHBC Planning and must be returned at the completion of the work. This drawing shall not be used for construction purposes unless the drawings are marked "Issued for Construction" and the professional seal is signed and dated by the landscape architect.</small>	DATE	NOV 2022
	DRAWN BY	BT
PLAN SCALE	1 : 250	
FILE NO.	10179 AC	
CHECKED BY	G.C.	
OTHER		
PROJECT		
FILE NAME	DWG NO.	L1
LANDSCAPE PLAN		
<small>SOURCE N:\10179 AC - Oakville Entertainment Buildings X, Y Retire\02 Drawings\4 Landscape\2023-10-17\10179 AC - Landscape Plan.dwg</small>		