

GENERAL NOTES:

- MAINTENANCE and ACCEPTANCE:**
- ALL PLANT MATERIAL SHALL BE MAINTAINED BY THE CONTRACTOR IMMEDIATELY AFTER ANY PLANTING HAS BEEN INSTALLED AND SHALL BE STAMPED IN THE DATE OF FINAL ACCEPTANCE.
 - SUCH MAINTENANCE SHALL INCLUDE ALL MEASURES NECESSARY TO ESTABLISH AND MAINTAIN ALL PLANTS IN AN ACCEPTABLE, VIGOROUS AND HEALTHY GROWING CONDITION INCLUDING CULTIVATING AND WEEDING, WATERING WHEN REQUIRED, PRUNING AND MAINTENANCE OF ALL ACCESSORIES.
 - AT TIME OF INSPECTION FOR INITIAL & FINAL ACCEPTANCE, ALL PLANTING BEDS AND TREE PITS SHALL BE FRESHLY CULTIVATED, FREE OF WEEDS, LEAVES, BROKEN BRANCHES AND RUBBISH AND SHALL BE IN A NEAT AND TIDY CONDITION.
 - ALL PLANT MATERIAL SHALL BE GUARANTEED FOR A PERIOD OF 2 (TWO) YEARS FROM THE DATE OF ACCEPTANCE BY THE LANDSCAPE ARCHITECT AND LOCAL AUTHORITY UNLESS OTHERWISE NOTED. MAINTAIN PLANTING BEDS AND TREE PITS FREE OF WEEDS THROUGHOUT THE GUARANTEE PERIOD.
 - THE DEVELOPER SHALL REGULARLY REMOVE DEBRIS FROM THE WEILAND UNTIL THE COMPLETION OF ALL BUILDING CONSTRUCTION WITHIN THE DEVELOPMENT.

- UTILITIES:**
- APPLICANT IS RESPONSIBLE FOR OBTAINING NECESSARY APPROVALS FROM THE UTILITY COMPANIES FOR WORKS WITHIN THE MUNICIPAL BOULEVARD.
 - ALL UTILITIES WITHIN THE BOULEVARDS MUST BE LOCATED PRIOR TO COMMENCING CONSTRUCTION WITHIN THE BOULEVARDS.

RODENT PROTECTION:

- THE CONTRACTOR SHALL BE RESPONSIBLE FOR THE PROTECTION OF ALL TREES AND SHRUBS FROM RODENT INJURY FOR THE DURATION OF THE GUARANTEE PERIOD.
- PROTECTIVE WIRE MESH GUARDS SHALL BE EMPLOYED AROUND ALL DECIDUOUS TREES. GUARDS SHALL BE INSTALLED PRIOR TO THE APPLICATION OF MULCH AND SHOULD BE PLACED A MINIMUM OF 500mm OUT FROM THE TREE TRUNK ON ALL SIDES. SUFFICIENT MESH SHOULD BE CUT TO COMPLETE THIS CIRCUMFERENCE AS WELL AS TO PROVIDE A MINIMUM OF 20mm OVERLAP.
- THE WIRE MESH GUARDS MUST BE GALVANIZED STEEL 12mm SQUARE MESH, 19 GAUGE AND SUPPLIED IN 600mm ROLLS. THE WIRE MESH CAN BE FASTENED WITH ANY ACCEPTABLE GALVANIZED WIRE TIE. ALL SHRUBS AND CONIFEROUS TREES SHALL HAVE AN APPLICATION OF "SKOOT" OR APPROVED EQUIVALENT RODENT FORMULA TO BE APPLIED AT THE END OF OCTOBER. FOLLOW MANUFACTURER'S DIRECTIONS FOR APPLICATION.

UNIT PAVING:

- PAVERS SHALL BE PRECAST CONCRETE UNIT PAVERS WITH MIN. 5685 M.P.A. (8500 P.S.I.) COMPRESSIVE STRENGTH, AND A WATER ABSORPTION NOT EXCEEDING 5% AND A FRICTION-TANK RESISTANCE EQUAL TO C.S.A.-A82-2 (1967).
- SETTING BED SHALL CONSIST OF SAND, CLEAN, COARSE, CRUSHED STONE OR ROCK. SAND OR ROCK SHALL BE PLACED TO A MINIMUM DEPTH OF 50mm (2") MIN. SPECIFIED DEPTH AS DETAILED, HAS BEEN ESTABLISHED.
- LOOSELY PLACED CONCRETE SAND OR SCREENINGS TO A UNIFORM DEPTH OF 50mm (2") MIN.
- MAINTAIN JOINTS UNIFORM AND CLOSELY BUTTED THROUGHOUT.
- WHERE NECESSARY, SAW OUT PAVERS TO PRODUCE A SHARP, VERTICAL CUT WITHOUT DAMAGED EDGES, AND TO FIT ACCURATELY.
- AFTER COMPLETION OF INSTALLATION, COMPACT PAVING BY MEANS OF A VIBRATING PLATE TAMPER.
- FILL THE JOINTS WITH FINE SAND, BY BRUSHING AND SWEEPING, HOSE PAVING WITH FINE WATER SPRAY.

CARPENTRY

- ALL LUMBER SHALL BE No. 1 GRADE WESTERN CEDAR UNLESS OTHERWISE STATED, AND SHALL BE STAMPED IN ACCORDANCE WITH THE CURRENT REQUIREMENTS OF THE LATEST NLGA STANDARD GRADING RULES.
- PRESSURE TREATED WOOD SHALL BE EITHER PINE, SPRUCE, OR FIR. THIS WOOD SHALL BE PRESSURE TREATED WITH A.C.Q.-8 (ALKALINE COPPER QUAT TYPE B) OR OTHER APPROVED WATERBORNE CHEMICAL IN ACCORDANCE WITH THE LATEST REQUIREMENTS OF C.S.A.-080.
- ALL CEDAR LUMBER IS TO BE STAINED WITH ONE COAT OF A LATEX STAIN AS APPROVED BY THE LANDSCAPE ARCHITECT BEFORE APPLICATION.
- ALL WOOD SHALL BE SELECTED FOR UNIFORM APPEARANCE AND SIZE. SHALL BE STRUCTURALLY SOUND AND SHALL BE FREE OF SPLITS, CRACKS AND LOOSE AND KNOTS.
- ALL WOOD SHALL BE DRESSED FOUR SIDES.
- ALL SPIKES AND NAILS SHALL BE "ARDOX" SPIRAL SHANK.
- ALL SPIKES, NAILS, BOLTS, NUTS AND ANY OTHER METAL FASTENERS AND CONNECTORS SHALL BE HOT DIPPED, GALVANIZED IN ACCORDANCE WITH C.S.A.-064.
- CONCRETE FOR FOOTINGS SHALL HAVE A COMPRESSIVE STRENGTH OF 20.7 M.P.A. (IN 28 DAYS (MIN.)).
- MAKE ALL TIMBER CUTS STRAIGHT AND PLUMB TO INSURE A TIGHTLY BUTTED FLUSH JOINT/PANT ALL CUTS TO PRESSURE TREATED WOOD, WITH ONE COAT OF APPROVED PRESERVATIVE PRIOR TO ASSEMBLY.
- COUNTERSINK ALL BOLTS, NUTS, PLATES, ANCHORS, ETC. IN ORDER TO BE FLUSH WITH WOOD SURFACE AND AS DETAILED.

PLANTING:

- PREPARE PLANTING SOIL BY EVENLY MIXING FOUR PARTS SANDY TOPSOIL, ONE PART COMBINED FERTILIZER AND 500g BONE MEAL AND 750g ADDITIVE WITH 500g BONE MEAL AND 750g ADDITIVE. FOREGOING RATES ARE SUBJECT TO ADJUSTMENT ON RECEIPT OF TOPSOIL ANALYSIS REPORT.
- EXCAVATE AND PROVIDE PLANTING SOILS AS PER PLANTING DETAILS.
- PROVIDE ALL SHRUBS AND TREES ACCORDING TO THE GUIDE SPECIFICATIONS FOR NURSERY STOCK OF THE CANADIAN NURSERY TRADE ASSOCIATION WITH REGARD TO QUALITY AND GRADING AND LEAF WITH REGARD TO LIST.
- SPRAY ALL PLANTINGS IN SIZE WITH ANTIDESICCANT. PROMOTE TREES WITH STAKES.
- PLANTS ARE TO BE No. 1 NURSERY CROWN, UNDER PROPER CULTURAL PRACTICES, IN PARTICULAR WITH RESPECT TO AMPLE SPACING, PEST AND DISEASE CONTROL, AND BRANCH AND ROOT PRUNING.
- TREES ARE TO HAVE STURDY, STRAIGHT TRUNKS.
- TREES SHALL BE WELL BRANCHED AND BALANCED WITH A STRONG CENTRAL LEADER.
- DECIDUOUS SHADE TREES SHALL BE FREE OF CRANIOUS NOT LESS THAN 1.8m ABOVE THE GROUND.
- ALL SHRUBS ARE TO BE PLANTED IN CONTINUOUS BEDS. DO NOT SOD BETWEEN PLANTS. EXCAVATE ENTIRE AREA OF SHRUB BED UNIFORMLY TO SPECIFIED DEPTH AND FILL WITH SPECIFIED PLANTING SOIL.

TOPSOIL:

- USE EVENLY MIXED TOPSOIL OF FERTILE, FRAMBLE MATERIAL LEAM CONTAINING NOT LESS THAN 4% ORGANIC MATTER FOR CLAY LOAMS AND 2% MINIMUM ORGANIC MATTER FOR SAND LOAMS WITH AN ACIDITY RANGE OF 5.5 TO 7.5 pH.
- ALL TOPSOIL SHOULD BE FREE OF SUBSOLS, CLAY, STONES, ROOTS, EXCESS WATER, FROST AND OTHER EXTRANEOUS MATTER.

HYDRO SEEDING:

- MULCH ALL DISTURBED AREAS AS WELL AS AREAS INDICATED ON PLANS.
- USE APPROPRIATE SEED MIX IN AREAS AS SPECIFIED. ENSURE THAT AREAS TO BE SEEDED HAVE BEEN CULTIVATED TO A DEPTH OF 25mm AND ARE MOST TO DEPTH OF 150mm BEFORE SEEDING. FINE GRADE AREA FREE OF HUMPS AND HOLLOW'S IF REQUIRED.
- OBTAIN LANDSCAPE ARCHITECT'S APPROVAL OF TOPSOIL GRADE AND DEPTH BEFORE STARTING TO SEED.
- FERTILIZER TO BE 3-2-16 AND TO BE APPLIED AT A RATE OF 300 KG/HECTARE.
- TACKIFIER, IF REQUIRED, TO BE APPLIED AT A RATE OF 88 KG/HECTARE.
- INDICATE AREAS OF TACKIFIER USE TO LANDSCAPE ARCHITECT PRIOR TO APPLICATION.
- APPLY SEED MIX AT A RATE OF 150kg/HECTARE.
- SEEDING TO BE COMPLETED BETWEEN APRIL 1 AND MAY 15 OR BETWEEN AUGUST 15 AND SEPTEMBER 30.

TREE LOCATION:

- NO TREES SHALL BE PLANTED UNDER OVERHEAD WIRES OR OVER UNDERGROUND SERVICES.
- TREES ARE NOT TO BE PLANTED LESS THAN 1M FROM CURBS, UNDERGROUND UTILITIES, SIDEWALKS AND DRIVEWAYS, 2m FROM FIRE HYDRANTS AND TRANSFORMERS, AND 4m FROM LIGHT STANDARDS.
- THE CONTRACTOR IS TO STAKE OUT LOCATIONS OF TREE PITS. THIS STAKE OUT IS TO BE INSPECTED BEFORE THE EXCAVATION OF ANY TREE PITS.
- BEFORE THIS STAKE OUT, THE CONTRACTOR IS TO REQUEST A STAKE OUT FROM THE MUNICIPALITY MAY, AT THEIR DISCRETION REDISTRIBUTE TREE LOCATIONS, PRIOR TO PLANTING, IN ORDER TO MINIMIZE CONFLICTS WITH UTILITIES, DRIVEWAYS AND INTERSECTION VISIBILITY.

SODDING:

- PREPARE A MINIMUM 200mm DEPTH OF TOPSOIL WITH A 10-6-4 COMMERCIAL FERTILIZER AT 7.3kg/100sq.m. AND SUPER PHOSPHATE AT 9kg/100sq.m. THE PROPORTIONS SPECIFIED ARE SUBJECT TO ADJUSTMENT DEPENDING ON TOPSOIL ANALYSIS REPORT.
- LAY No. 1 NURSERY SOD ON ALL AREAS OF THE PROJECT NOT COVERED BY BUILDINGS OR PAVING.
- IMMEDIATELY AFTER INSTALLATION, SOD MUST BE WATERED AND ROLLED.

CONIFEROUS SHRUBS:

- KEY QUANT BOTANICAL NAME COMMON NAME HEIGHT SPREAD CALIPER SPACING COND. REMARKS DT ON PO
- AR 05 Acer rubrum Red Maple 4000 2000 60 as shown WB FULL FORM YES YES -
- AS 04 Acer saccharum Sugar Maple 4000 2000 60 as shown WB FULL FORM YES YES -
- LT 06 Liriodendron tulipifera Tulip Tree 4000 2000 60 as shown MB FULL FORM YES YES YES
- OR 03 Quercus rubra Red Oak 4000 2000 60 as shown WB FULL FORM YES YES -

PAVING SCHEDULE & LEGEND

PAVERS SUPPLIED BY OAKS OR APPROVED EQUAL.

NOTE: FINAL COLOUR SELECTION FOR PAVERS TO BE DONE ON SITE FROM SAMPLES BY LANDSCAPE ARCHITECT.

LEGEND

TYPE: (PAVE 'A')	FRONT WALKS	TYPE: (PAVE 'B')	AMENITY AREAS	TYPE: (PAVE 'C')	PERMEABLE PAVERS (VEHICULAR)	TYPE: (PAVE 'D')	LAKESHORE ROAD WEST
	FIELD MODEL: NUBEAR 60mm SLAB PATTERN: RUNNING BOND SIZE: 600x600, 400x800 COLOUR: CHAMPAGNE		FIELD MODEL: NUBEAR 60mm SLAB PATTERN: RUNNING BOND SIZE: 200x400, 300x600, 400x800 COLOUR: CHAMPAGNE		FIELD MODEL: HYDROPAU PAVE PATTERN: MOTIF A SIZE: 1000x1000, 2000x2000 COLOUR: SILVER SAND		FIELD MODEL: BEAUMONT 80mm PATTERN: HERRINGBONE SIZE: 800x800, 1000x1000 COLOUR: TIMBERWOOD
	FIELD MODEL: NUBEAR 60mm Slab PATTERN: RUNNING BOND SIZE: 200x400 (60mm THICK) COLOUR: ONYX		FIELD MODEL: NUBEAR 60mm Slab PATTERN: RUNNING BOND SIZE: 200x400 (60mm THICK) COLOUR: ONYX		FIELD MODEL: HYDROPAU PAVE PATTERN: MOTIF B SIZE: 1000x1000, 2000x2000 COLOUR: ONYX		FIELD MODEL: BEAUMONT 80mm PATTERN: SOLDIER COURSE (SINGLE ROW) SIZE: 800x800, 1000x1000 COLOUR: NATURAL

3 PAVING SCHEDULE

BOULEVARD PLANT LIST (GARDEN DRIVE)

KEY	QUANT	BOTANICAL NAME	COMMON NAME	HEIGHT	SPREAD	CALIPER	SPACING	COND.	REMARKS	DT	ON	PO
AFB	04	Acer x freemontii 'Autumn Blaze' (sterile)	Autumn Blaze maple	4000	2000	60	as shown	WB	FULL FORM	YES	YES	-
COB	02	Celtis occidentalis	Hackberry	4000	2000	60	as shown	WB	FULL FORM	YES	YES	-
AS	04	Platanus x acerifolia	London Planetree	3500	1000	60	as shown	WB	FULL FORM	YES	YES	YES
LTB	02	Liriodendron tulipifera	Tulip Tree	4000	2000	60	as shown	WB	FULL FORM	YES	YES	YES
ORB	03	Quercus rubra	Red Oak	4000	2000	60	as shown	WB	FULL FORM	YES	YES	YES

SITE PLANT LIST

KEY	QUANT	BOTANICAL NAME	COMMON NAME	HEIGHT	SPREAD	CALIPER	SPACING	COND.	REMARKS	DT	ON	PO
AR	05	Acer rubrum	Red Maple	4000	2000	60	as shown	WB	FULL FORM	YES	YES	-
AS	04	Acer saccharum	Sugar Maple	4000	2000	60	as shown	WB	FULL FORM	YES	YES	-
LT	06	Liriodendron tulipifera	Tulip Tree	4000	2000	60	as shown	WB	FULL FORM	YES	YES	YES
OV	03	Ostrya virginiana	Ironwood	4000	2000	60	as shown	WB	FULL FORM	YES	YES	-
AC	02	Amelanchier canadensis	Serviceberry	1500	-	750	as shown	WB	FULL FORM	YES	YES	YES
CC	05	Cercis canadensis	Eastern Redbud	1500	-	750	as shown	WB	FULL FORM	YES	YES	YES
CF	08	Cornus alternifolia	Pagoda Dogwood	1500	-	750	as shown	WB	FULL FORM	YES	YES	YES
CK	04	Cornus kousa 'Wolf Eyes'	Wolf Eyes Japanese Dogwood	1500	-	750	as shown	WB	FULL FORM	YES	YES	YES

DECIDUOUS SHRUBS

KEY	QUANT	BOTANICAL NAME	COMMON NAME	HEIGHT	SPREAD	CALIPER	SPACING	COND.	REMARKS	DT	ON	PO
DI	38	Dierilla lanicola	Bush Honeysuckle	600	-	750	CC	Full Form	YES	YES	YES	YES
HP	16	Higaronum salicifolium	Pat O Gold	600	-	750	CC	Full Form	YES	YES	YES	YES
HP	24	Hydrangea paniculata 'Little Lime Punch'	Little Lime Punch Hydrangea	700	-	750	CC	Full Form	YES	YES	YES	YES
Ro	12	Rhus aromatica 'Gro-Low'	Gro Low Sumac	600	-	900	CC	Full Form	YES	YES	-	YES
Sj	27	Spiraea japonica 'Lemon Princess'	Lemon Princess Spiraea	600	-	750	CC	Full Form	YES	YES	-	YES
Sz	27	Symphoricarpos albus	Snowberry	600	-	750	CC	Full Form	YES	YES	YES	YES

PERENNIALS AND ORNAMENTAL GRASS

KEY	QUANT	BOTANICAL NAME	COMMON NAME	HEIGHT	SPREAD	CALIPER	SPACING	COND.	REMARKS	DT	ON	PO
gt	17	Asclepias tuberosa	Butterfly Milkweed	450	200	200	200	200	Full Form	YES	YES	YES
ep	24	Echinacea purpurea	Purple Coneflower	500	200	200	200	200	Full Form	YES	YES	YES
gm	24	Geranium x 'Rozanne'	Rozanne Cranebill	600	200	200	200	200	Full Form	YES	YES	YES
hg	29	Hemerocallis 'Stella de Oro'	Stella D'Ora Daylily	450	200	200	200	200	Full Form	YES	YES	YES
hp	13	Hemerocallis 'Purple D'Oro'	Purple D'Oro Daylily	450	200	200	200	200	Full Form	YES	YES	YES
hg	07	Hosta 'Golden Variegated'	Golden Variegated Hosta	450	200	200	200	200	Full Form	YES	YES	YES
ht	32	Hosta 'Touch of Class'	Touch of Class Hosta	500	200	200	200	200	Full Form	YES	YES	YES
pv	48	Panicum virgatum	Switch Grass	600	200	200	200	200	Full Form	YES	YES	YES
rh	10	Rudbeckia hirta	Black Eyed Susan	450	200	200	200	200	Full Form	YES	YES	YES
ss	22	Schizanthus scaberrimus	Little Bluestem	750	200	200	200	200	Full Form	YES	YES	YES
sh	07	Sporobolus heterostachys	Prairie Dropseed	450	200	200	200	200	Full Form	YES	YES	YES

PLANTING NOTES:

- CHECK ALL QUANTITIES
- REPORT ANY DISCREPANCIES TO THE LANDSCAPE ARCHITECT
- THE QUANTITIES INDICATED ON THE PLAN SUPERSEDE THE TOTALS OF THE PLANT LIST
- THE LAYOUT OF ALL PLANT MATERIAL IS TO BE APPROVED BY THE LANDSCAPE ARCHITECT PRIOR TO PLANTING.

DT DROUGHT TOLERANT
ON ONTARIO NATIVE
PO POLLINATOR

TREE PLANTING

A MINIMUM HORIZONTAL CLEARANCE OF 1.2 m IS RECOMMENDED BETWEEN THE EDGE OF THE ROOT BALL OR OPEN BOTTOM CONTAINER AND ADJACENT EDGE OF THE EXISTING GAS INFRASTRUCTURE. IN CASES WHERE THE RECOMMENDED CLEARANCE CANNOT BE ACHIEVED, A MINIMUM CLEARANCE OF 0.6 m CAN BE PERMITTED PROVIDED A ROOT DEFLECTOR IS INSTALLED ON THE SIDES OF THE ROOT BALL. REFER TO SECTION 3.8 IN THE THIRD PARTY REQUIREMENTS IN VICINITY OF NATURAL GAS FACILITIES.

VERTICAL AND HORIZONTAL CLEARANCE REQUIREMENTS:

ENBRIDGE GAS DISTRIBUTION STRUCTURE	VERTICAL DIST.	HORIZONTAL DIST.
GAS MAIN LESS THAN 12" Ø - OPEN TRENCH/HYDROVAC METHOD	300mm	600mm
GAS MAINS LESS THAN 12" Ø - NON-CERAMIC VITL MAIN - DIRECTIONAL DRILLING/BORING/MICRO TRENCH METHOD	300mm*	1000mm
CER. PIPELINES AND VITAL MAINS - OPEN TRENCH/HYDROVAC METHOD	600mm	600mm
GAS MAIN 12" Ø AND GREATER, CER. PIPELINES AND VITAL MAINS - DIRECTIONAL DRILLING/BORING/MICRO TRENCH METHOD	1000mm	1000mm
REGULATOR STATIONS	-	1000mm

*NOTE: CLEARANCE MUST BE FROM THE ADJACENT EDGE OF THE GAS INFRASTRUCTURE TO THE EDGE OF ANY PROPOSED STRUCTURE
*CLEARANCE TO BE DETERMINED ON A CASE BY CASE BASIS
**LANDSCAPING IS REQUIRED WHEN CROSSING GAS MAIN

GAS MAINS TO BE FIELD LOCATED CALL FOR GAS LOCATES BEFORE YOU DIG
ONTARIO ONE CALL 1-800-400-2255
FREE LOCATE SERVICE

ENBRIDGE GAS DISTRIBUTION

CONFLICT YES NO

BEFORE DIGGING ENBRIDGE GAS MAINS/SERVICES MUST BE LOCATED ON SITE. CALL ONTARIO ONE CALL (1-800-400-2255) 5 DAYS IN ADVANCE.

TEST HOLES ARE REQUIRED TO DETERMINE ACTUAL LOCATION OF GAS MAIN. "MARK-UPS" (mark-ups@enbridge.com) MUST BE CONTACTED IF THE MINIMUM HORIZONTAL AND VERTICAL CLEARANCES FROM OUR GAS MAIN CANNOT BE MET. AS REFERENCED IN THE ATTACHED "THIRD PARTY REQUIREMENTS IN THE VICINITY OF NATURAL GAS FACILITIES" DOCUMENT.

STANDARD NOTE PRIVATE PROPERTY

Enbridge Gas Distribution does not provide information regarding gas infrastructure in Private Properties. We suggest that a field locate be performed through Ontario One Call (1-800-400-2255). If further details are still required, it is suggested that test holes be performed by an outside party in order to determine the actual gas infrastructure.

1 LANDSCAPE GENERAL NOTES

2 PROPOSED PLANT LIST

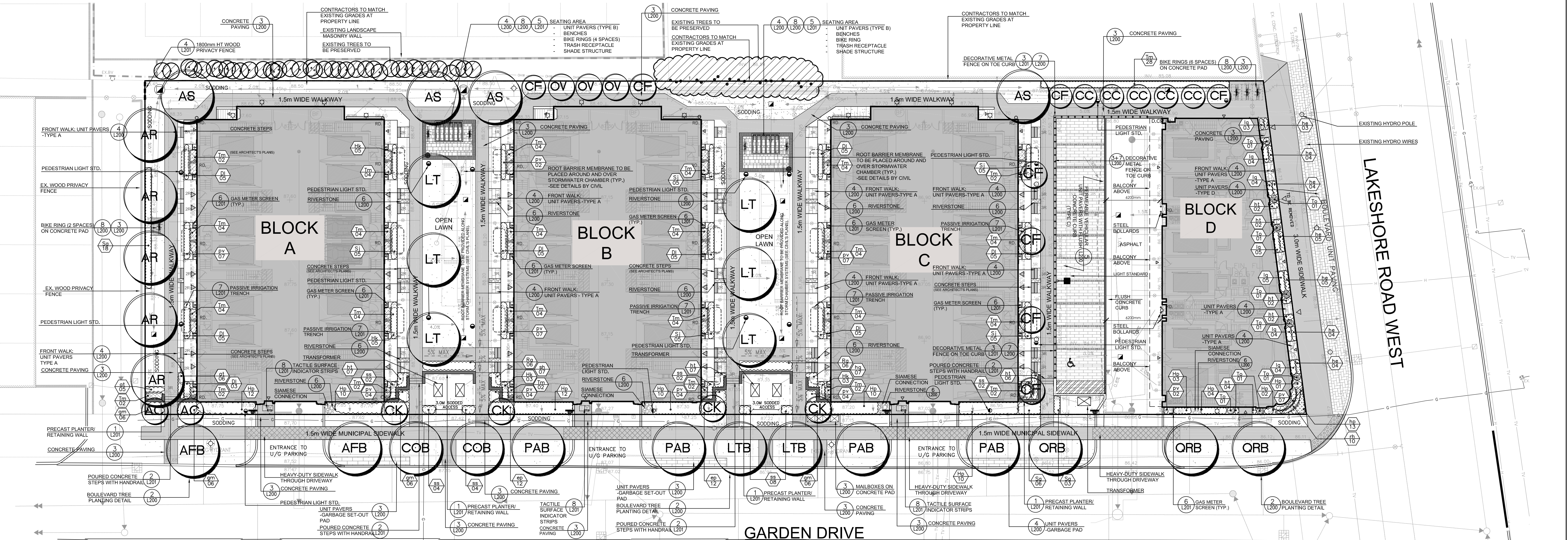

GENERAL NOTES

- VERIFY ALL DIMENSIONS.
- DO NOT SCALE DRAWINGS.
- REPORT ANY DISCREPANCIES, DISCOVERED ERRORS, OR OMISSIONS TO THE LANDSCAPE ARCHITECT BEFORE PROCEEDING.
- IT IS ADVISED THAT CONTRACTORS CONTACT THE LANDSCAPE ARCHITECT PRIOR TO CONSTRUCTION TO ENSURE THE USE OF THE LATEST REVISED DRAWINGS.
- DRAWINGS AND SPECIFICATIONS ARE THE PROPERTY OF THE LANDSCAPE ARCHITECT.

KEY PLAN

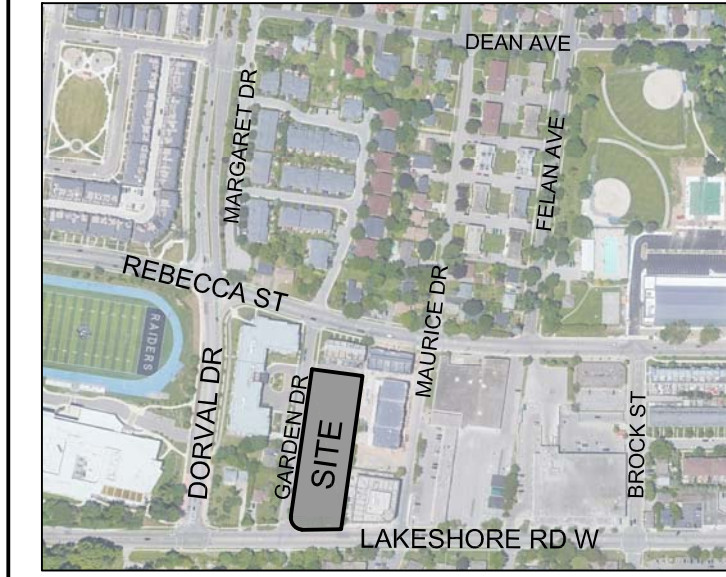

LEGEND

- EXISTING TREES TO BE PRESERVED
- PROPOSED DECIDUOUS TREE
- PROPOSED CONIFEROUS TREE
- PROPOSED SHRUBS
- PROPOSED GRASSES + PERENNIALS
- PROPOSED HEDGE
- SODDING
- RIVERSTONE
- UNIT PAVERS
- PEDESTRIAN LIGHTING STD
- LIGHT STD
- BENCH
- BIKE RING (2 SPACES)
- GAS METER SCREEN
- PASSIVE IRRIGATION TRENCH

No.	DATE	REVISION	BY
9	FEB 19th, 2026	ISSUED FOR 3RD SPA SUBMISSION	BB
8	JULY 30th, 2025	ISSUED FOR SPA SUBMISSION	BB
7	APR 9th, 2025	ISSUED FOR SPA SUBMISSION	BB
6	DEC 5th, 2024	ISSUED FOR SPA SUBMISSION	BB
5	NOV 20th, 2024	ISSUED FOR 2BA SUBMISSION	BB
4	NOV 8th, 2024	ISSUED FOR 2BA RESUBMISSION/ SPA 1st SUBMISSION	BB
3	AUG 1st, 2024	ISSUED FOR SPA SUBMISSION	BB
2	JULY 3rd, 2024	ISSUED FOR SUBMISSION	BB
1	MAY 24, 2024	ISSUED FOR COORDINATION	BB

It is the responsibility of the Contractor and/or Owner to ensure that the drawings with the latest revisions are used for construction.

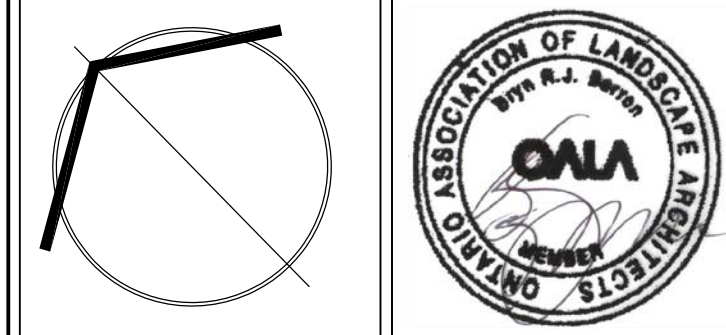

SBK 5770 HURONTARIO STREET, SUITE 320
MISSISSAUGA, ONTARIO, L4R 3S6
T: 416.695.4949 F: 905.712.3101
WWW.STRYBOS.COM

STRYBOS BARRON KING
LANDSCAPE ARCHITECTURE

PROJECT:
PROPOSED MIXED USE DEVELOPMENT
OAKVILLE GARDEN RESIDENCES CORP
109 GARDEN DRIVE
OAKVILLE, ONTARIO
SP.1617.058.02

DRAWING TITLE:
LANDSCAPE PLAN

SCALE:	PROJECT No.
1 : 200	24-6010
DATE:	DRAWING No.
MAY 2024	L100
DRAWN BY:	CHECKED BY:
T.S./S.S.	B.B.