

BLOCK 2 CONDOMINIUM TOWNHOUSES & SEMI-DETACHED DWELLINGS 32 units

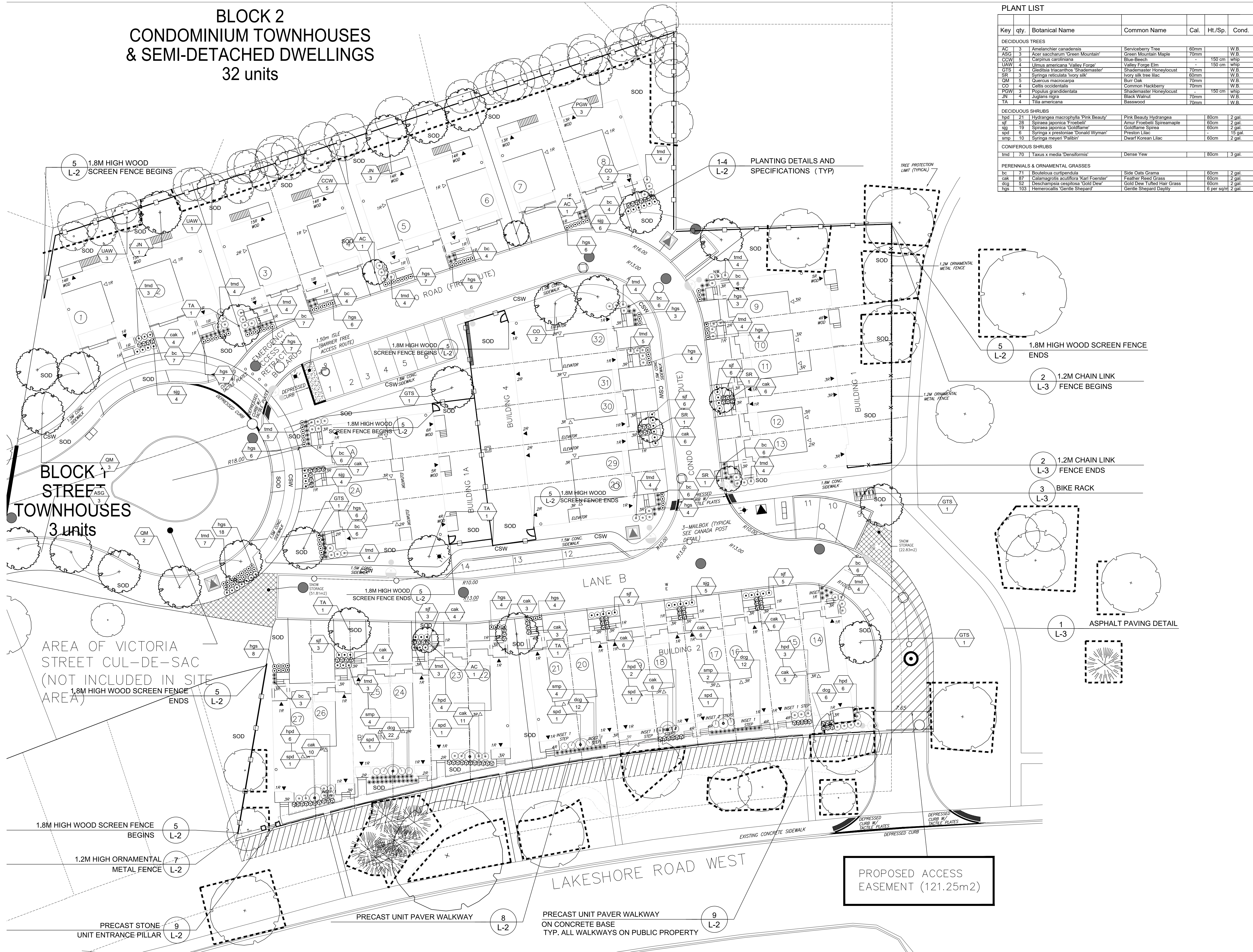

PLANT LIST

Key	qty.	Botanical Name	Common Name	Cal.	Ht./Sp.	Cond.
DECIDUOUS TREES						
AC	3	Amelanchier canadensis	Serviceberry Tree	60mm	W.B.	
ASG	3	Acer saccharum 'Green Mountain'	Green Mountain Maple	70mm	W.B.	
CCW	5	Carpinus caroliniana	Blow-Beech	-	150 cm whip	
UAW	4	Ulmus americana 'Valley Forge'	Valley Forge Elm	-	150 cm whip	
GTS	4	Gleditsia triacanthos 'Shademaster'	Shademaster Honeylocust	70mm	W.B.	
SR	3	Syringa reticulata 'Ivory Silk'	Ivory Silk Tree Lilac	60mm	W.B.	
OM	5	Quercus macrocarpa	Burr Oak	70mm	W.B.	
CO	4	Celtis occidentalis	Common Hackberry	70mm	W.B.	
PQW	3	Populus grandidentata	Shademaster Honeylocust	-	150 cm whip	
JN	4	Juglans nigra	Black Walnut	70mm	W.B.	
TA	4	Tilia americana	Blisswood	70mm	W.B.	
DECIDUOUS SHRUBS						
hpd	21	Hydrangea macrophylla 'Pink Beauty'	Pink Beauty Hydrangea	80cm	2 gal.	
sif	28	Spiraea japonica 'Froebelii'	Amur Froebell Spireamaple	60cm	2 gal.	
sgj	19	Spiraea japonica 'Goldflame'	Goldflame Spirea	60cm	2 gal.	
spj	6	Syringa x prestonian 'Donald Wyman'	Preston Lilac	-	15 gal.	
smp	10	Syringa meyeri 'Palibin'	Dwarf Korean Lilac	60cm	2 gal.	
CONIFEROUS SHRUBS						
tmd	70	Taxus x media 'Densiformis'	Dense Yew	80cm	3 gal.	
PERENNIALS & ORNAMENTAL GRASSES						
bc	71	Bouteloua curtipendula	Side Oats Grama	60cm	2 gal.	
cok	67	Calamagrostis acutiflora 'Karl Foerster'	Foerster Reed Grass	60cm	2 gal.	
dsg	52	Deschampsia cespitosa 'Gold Dew'	Gold Dew Tufted Hair Grass	60cm	2 gal.	
hgs	103	Hemerocallis 'Gentle Shepard'	Gentle Shepard Daylily	6 per sqm	2 gal.	

LEGEND

- EXISTING DECIDUOUS TREE
- EXISTING CONIFEROUS TREE
- PROPOSED DECIDUOUS TREE
- PROPOSED CONIFEROUS TREE
- PROPOSED CONTINUOUS SHRUB BED
- PROPOSED CONTINUOUS PERENNIAL/GRASSES BED
- PROPOSED SODDED AREA
- PROPOSED PEDESTRIAN CONCRETE
- PLANTING REFERENCE KEY
- DETAIL REFERENCE KEY
- 1.8 M WOOD PRIVACY FENCE
- 1.2M CHAIN LINK FENCE
- 1.2M ORNAMENTAL METAL FENCE
- TREE PROTECTION ZONE PER TOWN OF OAKVILLE STANDARDS.

- ### GENERAL NOTES
- Do not scale the drawings. All dimensions are in millimetres unless noted otherwise.
 - This drawing is to be read in conjunction with the overall master plan and engineering drawings prepared by the project engineer and site plans prepared by the project architect.
 - The contractor shall check and verify all existing and proposed grading and conditions on the project and immediately report any discrepancies to the consultant before proceeding with any work.
 - The contractor is to be aware of all existing and proposed services and utilities. The contractor is responsible for having all underground services and utility lines staked by each agency having jurisdiction prior to commencing work.
 - This drawing is to be used for development approval only. For layout of all work refer to construction drawings.
 - Plant quantities indicated on the plan supercede the quantities from the plant list (report any discrepancies to the landscape architect).
 - Do not leave any holes open overnight.
 - Keep area outside construction zone clean and useable by others at all times. Contractor shall thoroughly clean areas surrounding the construction zone at the end of each work day.
 - Contractor to make good any and all damages outside of the development area that may occur as a result of construction at no extra cost.
 - This drawing is Copyright MHBC 2022.

6.	OCTOBER 14, 2022	ISSUED FOR SPA	CC
5.	JANUARY 17, 2022	ISSUED FOR SPA	CC
4.	JANUARY 12, 2021	ISSUED FOR SPA	CC
3.	NOVEMBER 11, 2020	ISSUED FOR SPA	CC
2.	AUGUST 13, 2019	ISSUED FOR SPA	CC
REVISION NO.	DATE	ISSUED / REVISION	BY

230-7050 WESTON ROAD WOODBRIDGE, ON, L4L 6G7 | P: 905 761 5386 F: 905 761 5389 | WWW.MHBCPLAN.COM

STAMP	DATE	JULY 2019
	DRAWN BY	CC
ISSUED FOR SPA ONLY NOT FOR CONSTRUCTION	PLAN SCALE	1:250
All drawings and specifications are instruments of service and will remain the property of MHBC. Planning and must be returned at the completion of the work. This drawing shall not be used for construction purposes unless the drawings are marked 'Issued for Construction' and the professional seal is signed and dated by the landscape architect.	FILE NO.	11161E
PROJECT	CHECKED BY	N.M.
3171 LAKESHORE ROAD WEST OAKVILLE, ON	OTHER	
FILE NAME	DWG NO.	L1
LANDSCAPE PLAN		
SOURCE		
N:\1161E - Customer's Nursery\2022\October\Cornell Restore\11161E - Landscape Plan - 10-12-2022.dwg		

LANDSCAPE SPECIFICATIONS:

All sod shall conform to the standards of the Nursery Sod Growers Association of Ontario. All sodded areas shall be prepared with a minimum of 100mm of topsoil and sodded with #1 bluegrass - fescue nursery sod.

Unless soil tests suggest otherwise, fertilizer shall be applied as follows:
Sodded areas: 11-8-4 (11% nitrogen, 8% phosphorus, 4% potash) at 4.5 kg/m².
Planting beds: 7-7-7 (7% nitrogen, 7% phosphorus, 7% potash) at 0.12 kg/m³, and bone meal at 0.58 kg/m³ of planting soil mixture as outlined below.

All planting beds are to be continuous, and excavated to a minimum depth of 450mm unless noted otherwise. Planting beds are to be filled with a soil mixture composed of six (6) parts sand loam, two (2) parts well rotted manure, and one (1) part peat moss, in addition to the fertilizers specified above.

All plant material shall conform to the standards of the Canadian Nursery Trades Association. All plant material is to be clay grown stock. Install all plant material as shown on the planting plan and details. Use only viable nursery stock grown in strict accordance with proper horticultural practices which is free from damage, pests, and disease.

All beds are to be covered with a 75mm depth of clean, shredded pine bark mulch (black colour - submit sample for approval prior to installation) by Gro-Bark or approved equal unless noted otherwise. Guying and staking of trees shall conform to the planting details. Wrap all deciduous trees as per the specifications of the Ontario Landscape Contractors Association.

The contractor will observe proper maintenance procedures for all newly constructed landscape work as per Section 1E (Maintenance Work) of Landscape Ontario's specifications. Unless otherwise noted, this will apply during the construction period only. The contractor shall maintain all planting and sodding until final acceptance is granted by the Landscape Architect.

The contractor will be responsible for the protection of all plant material from damages resulting from winter conditions as well as rodents during the warranty period. Apply "Skoat" rodent deterrent formula (or approved equal) to all coniferous trees and all shrubs in late October as per manufacturer's directions.

The contractor shall provide a full one year guarantee (or two years if required by the municipality or owner) on all landscape works, beginning on the date that final acceptance is granted by the Landscape Architect.

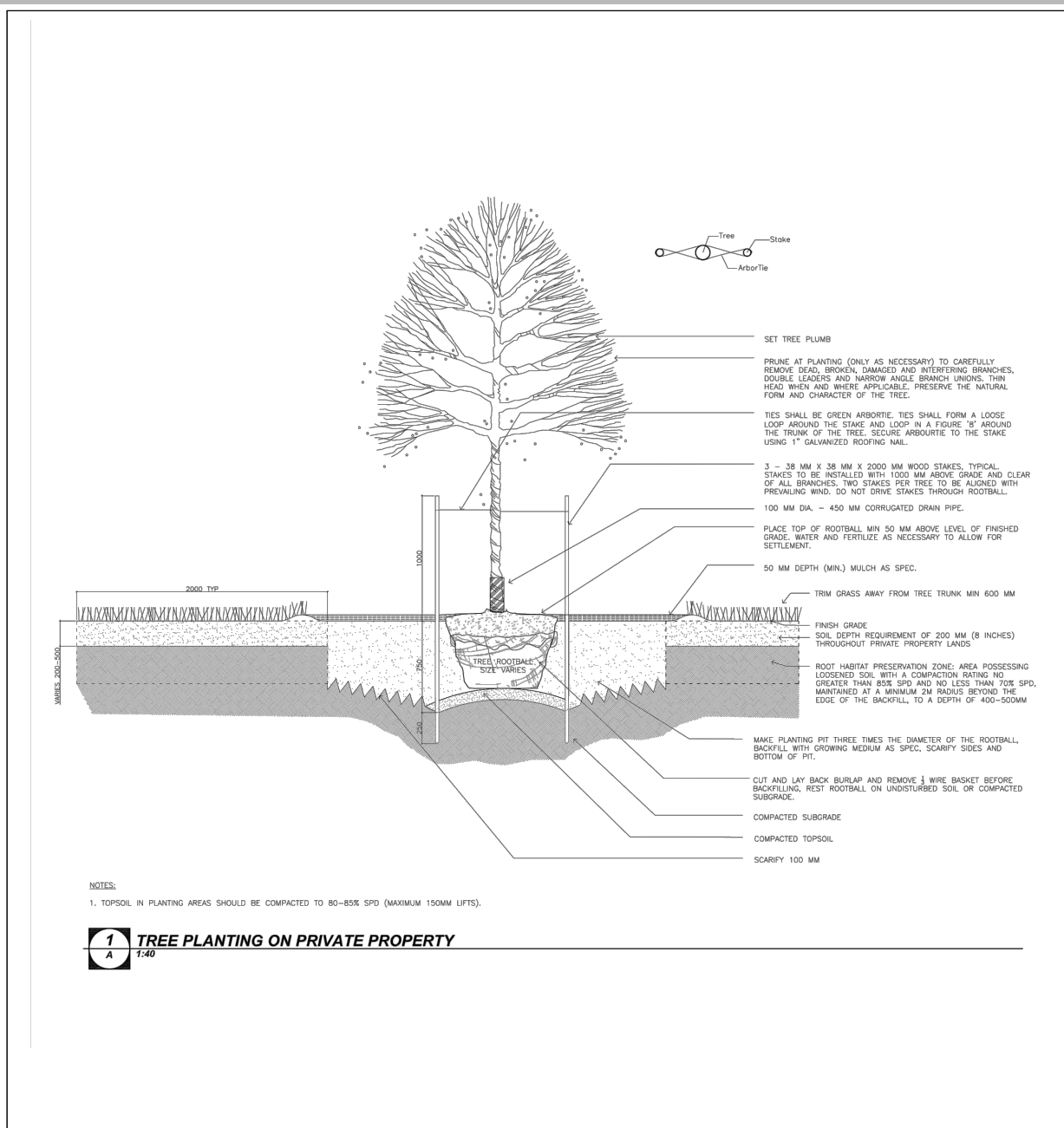

2 Deciduous Tree Planting on Private Property Detail
n.t.s.

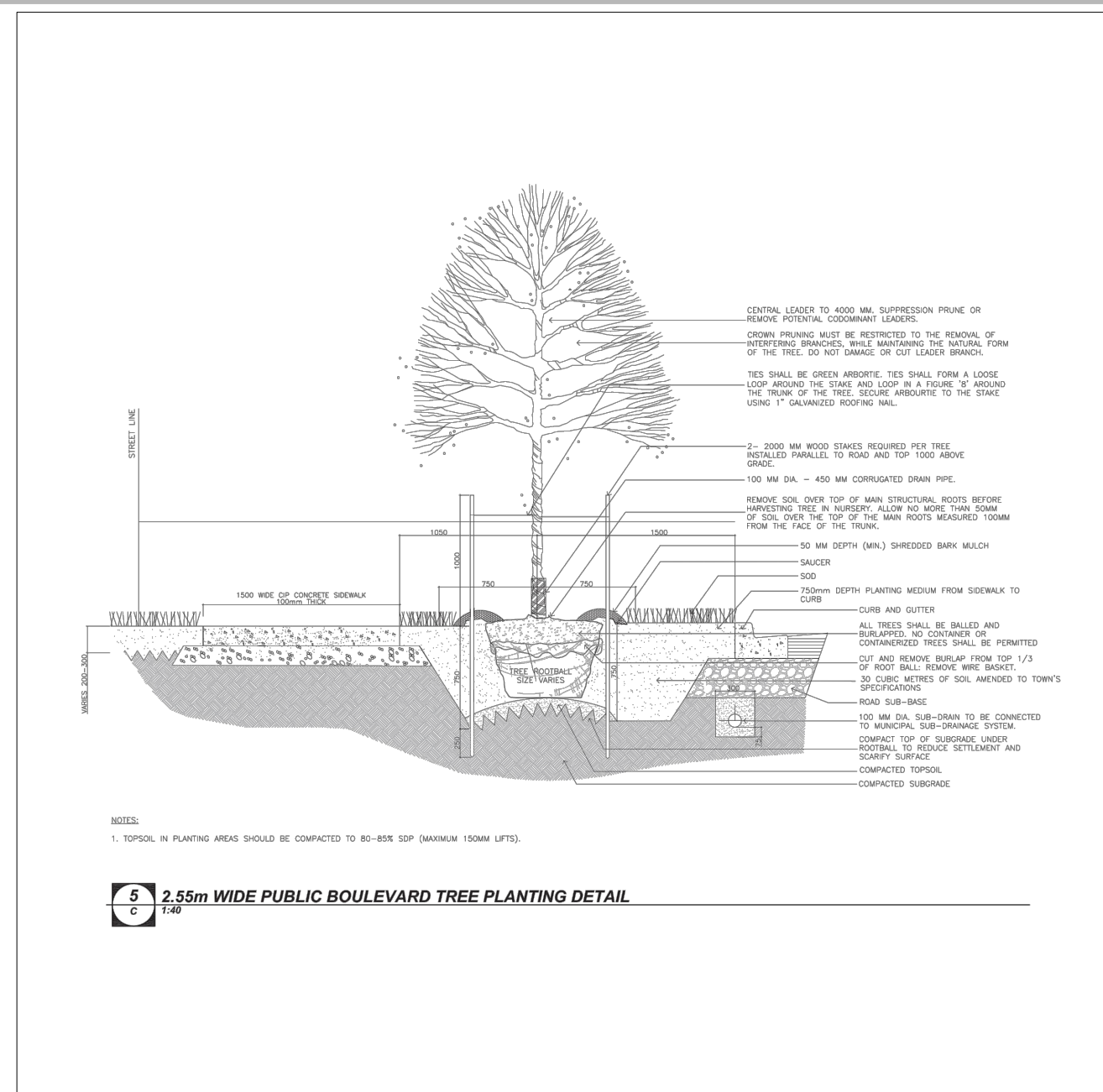

3 Deciduous Tree Planting on Public Property Detail
n.t.s.

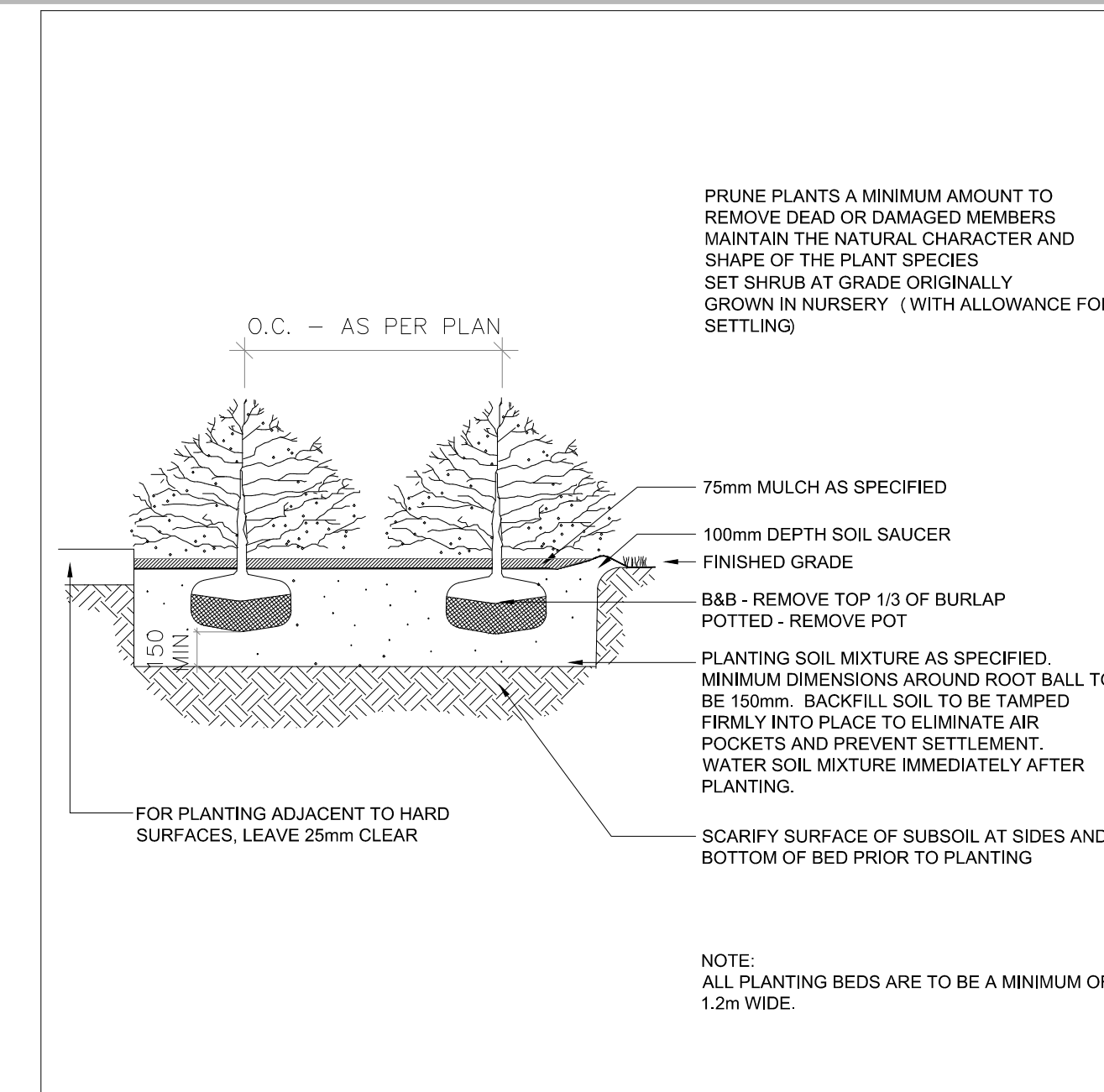

4 Shrub Planting Detail
n.t.s.

1 Landscape Specifications
n.t.s.

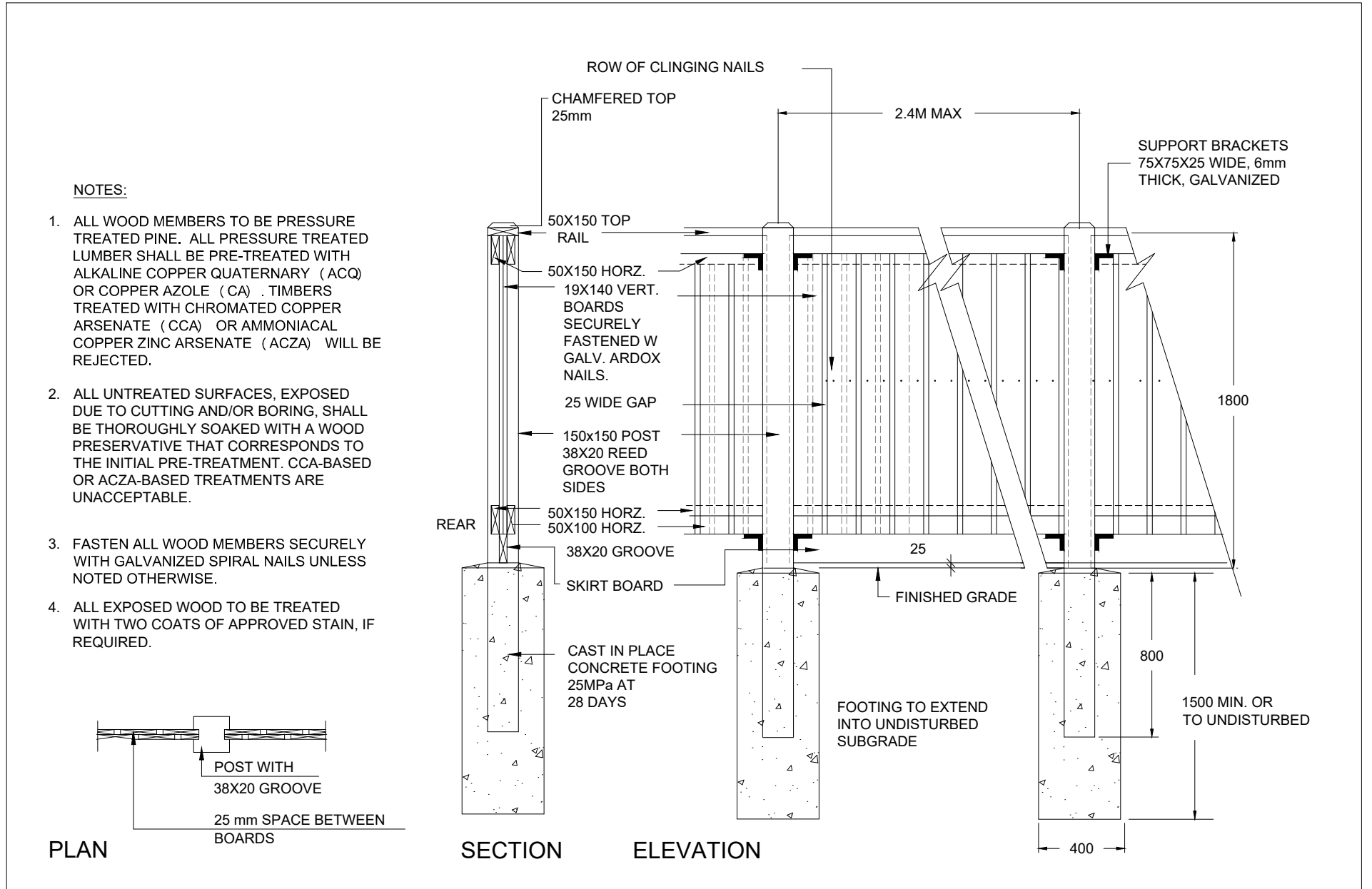

5 1.8m High Wood Screen Fence
n.t.s.

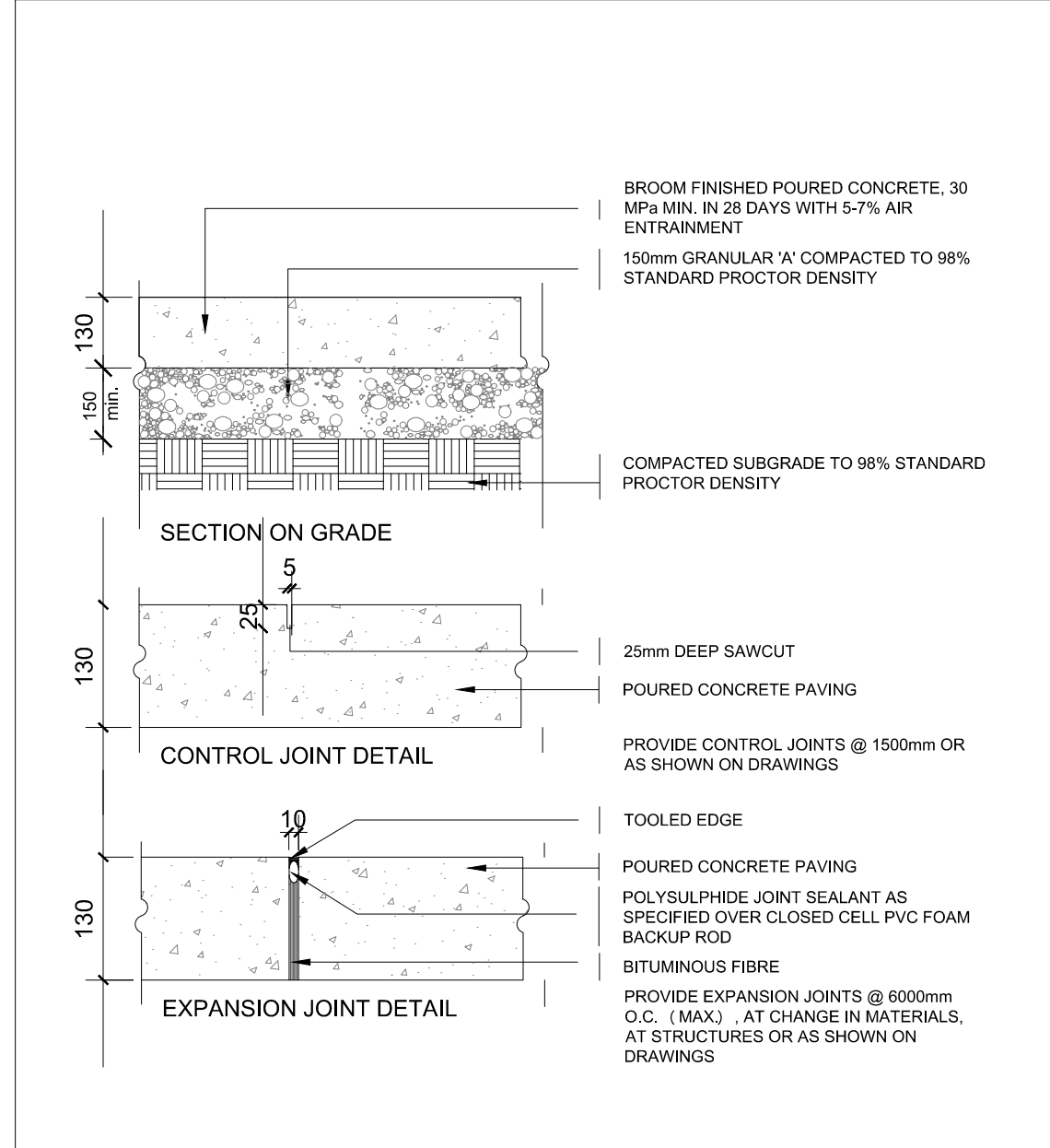

6 Concrete Paving Details
n.t.s.

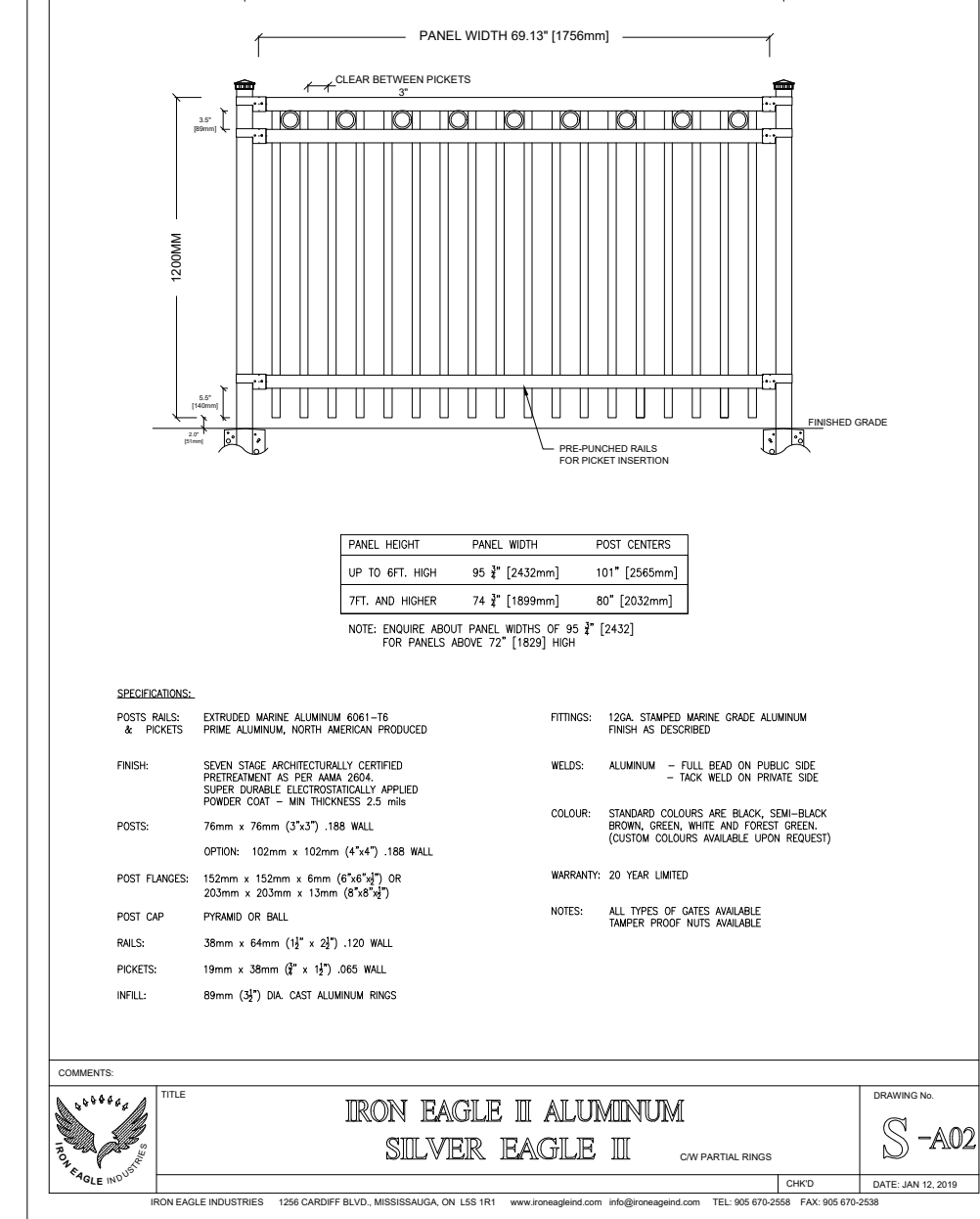

7 1.2m High Ornamental Metal Fence
n.t.s.

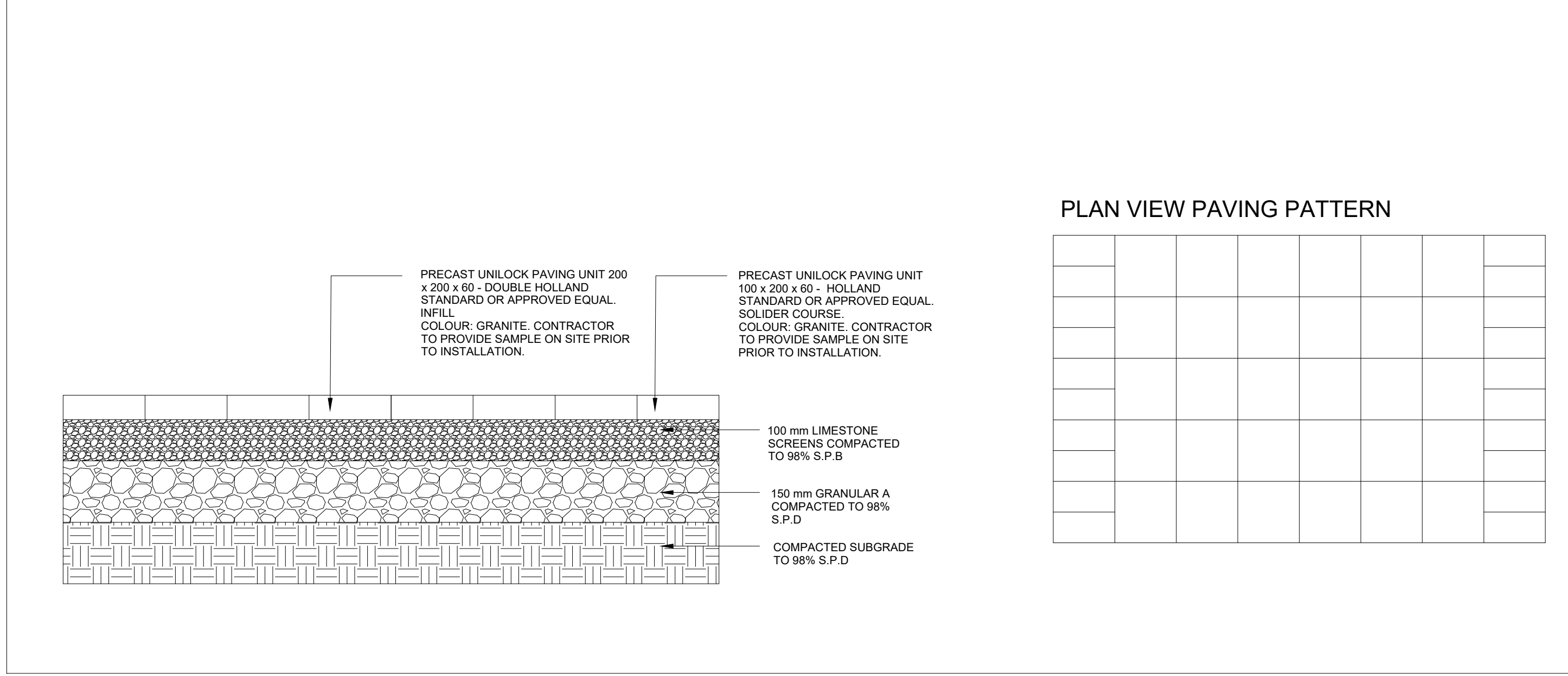

8 Precast Unit Paver Walkway
n.t.s.

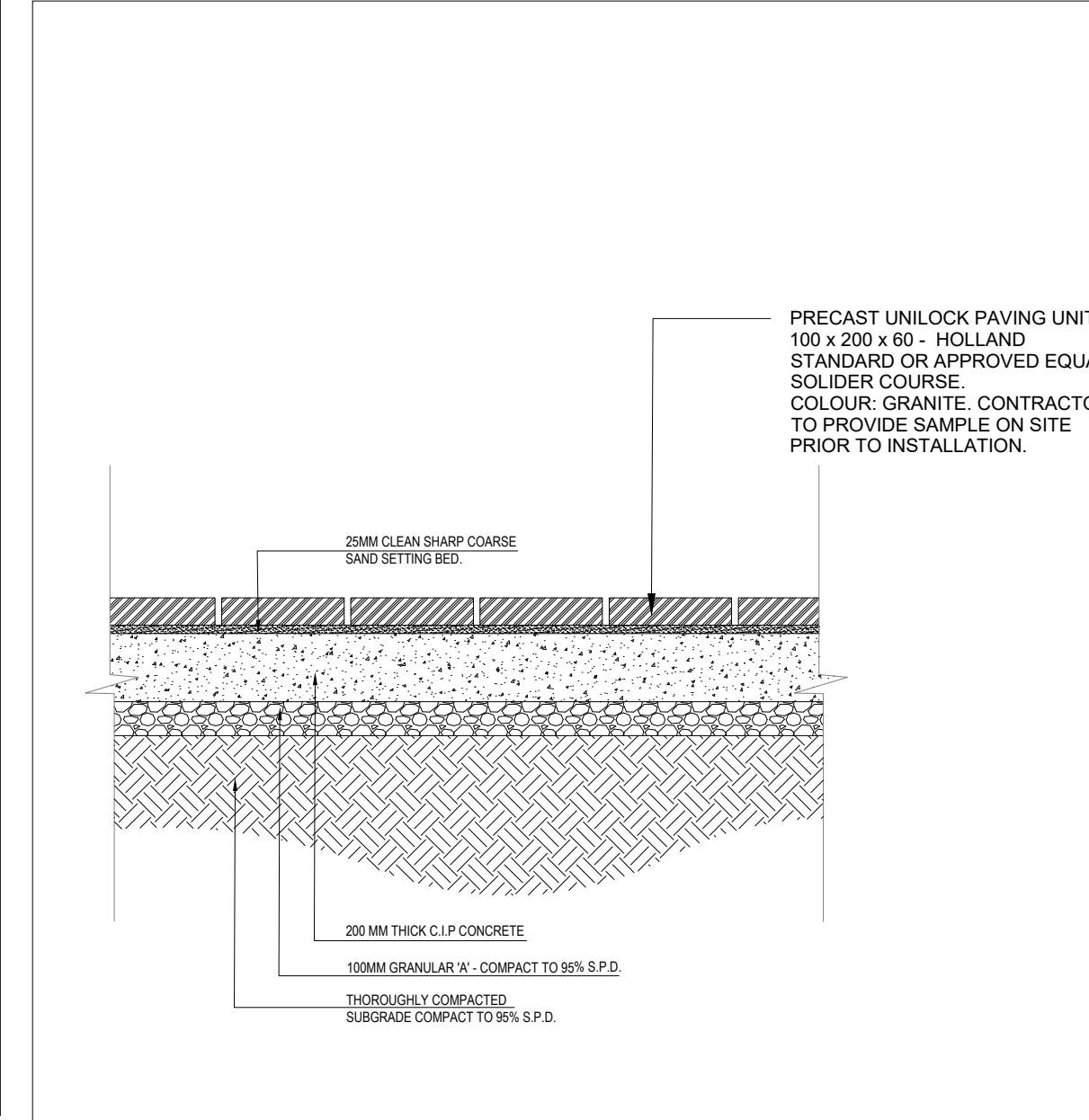

9 Precast Unit Paver Walkway - On Concrete Base
n.t.s.

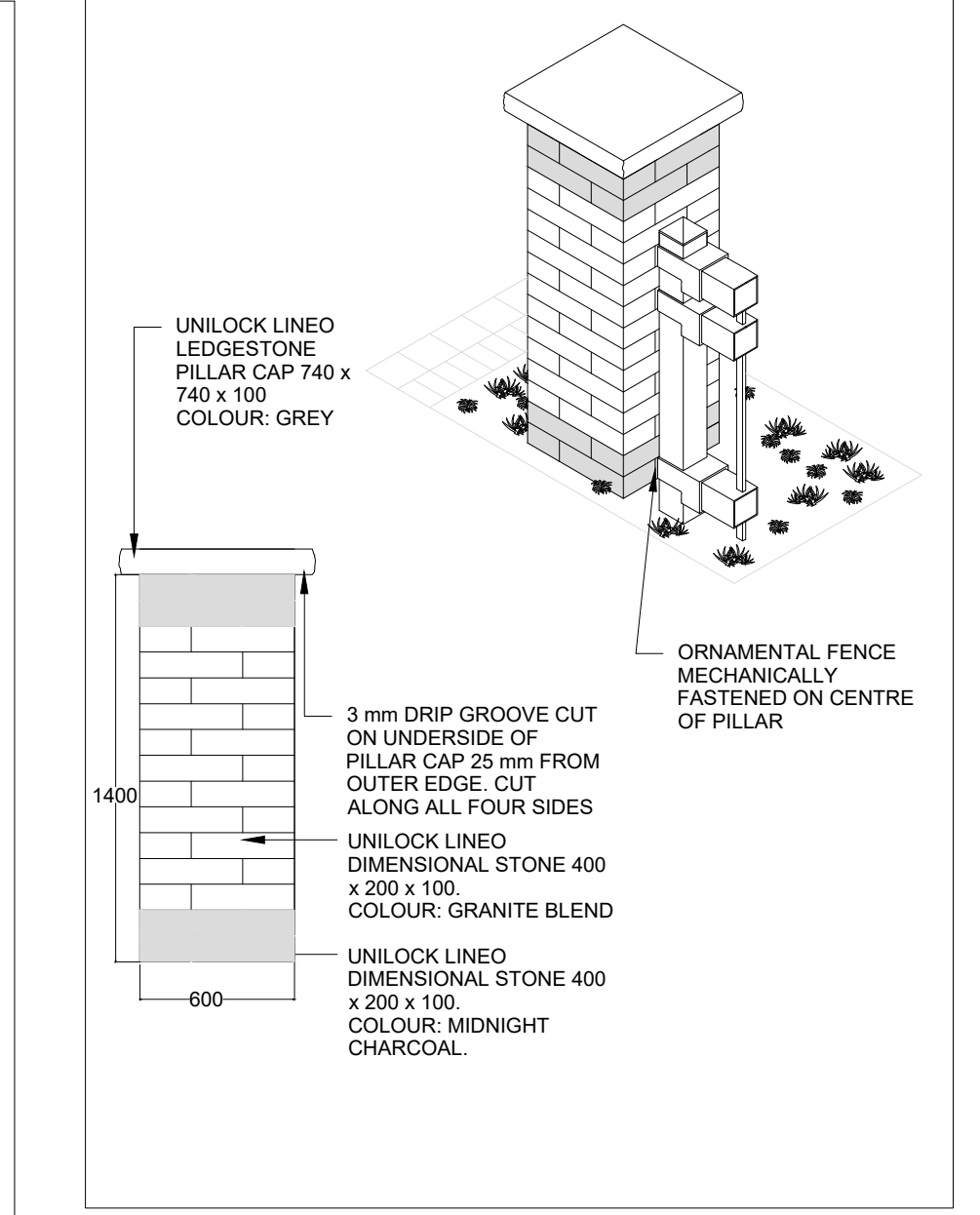

10 1.5m Precast Stone Unit Entrance Pillar
PART OF SEPARATE PERMIT APPLICATION THROUGH ENFORCEMENT SERVICES

GENERAL NOTES

- Do not scale the drawings. All dimensions are in millimetres unless noted otherwise.
- This drawing is to be read in conjunction with the overall master plan and engineering drawings prepared by the project engineer and site plans prepared by the project architect.
- The contractor shall check and verify all existing and proposed grading and conditions on the project and immediately report any discrepancies to the consultant before proceeding with any work.
- The contractor is to be aware of all existing and proposed services and utilities. The contractor is responsible for having all underground services and utility lines staked by each agency having jurisdiction prior to commencing work.
- This drawing is to be used for development approval only. For layout of all work refer to construction drawings.
- Plant quantities indicated on the plan supercede the quantities from the plant list (report any discrepancies to the landscape architect).
- Do not leave any holes open overnight.
- Keep area outside construction zone clean and useable by others at all times. Contractor shall thoroughly clean areas surrounding the construction zone at the end of each work day.
- Contractor to make good any and all damages outside of the development area that may occur as a result of construction at no extra cost.
- This drawing is Copyright MHBC 2022

REVISION NO.	DATE	ISSUED / REVISION	BY
6.	OCTOBER 14, 2022	ISSUED FOR SPA	CC
5.	JANUARY 17, 2022	ISSUED FOR SPA	CC
4.	JANUARY 12, 2021	ISSUED FOR SPA	CC
3.	NOVEMBER 11, 2020	ISSUED FOR SPA	CC
2.	AUGUST 13, 2019	ISSUED FOR SPA	CC



**PLANNING
URBAN DESIGN
& LANDSCAPE
ARCHITECTURE**

230-7050 WESTON ROAD WOODBRIDGE, ON L4L 6C7 | P: 905.761.5588 F: 905.761.5589 | WWW.MHBCPLAN.COM

STAMP	DATE JULY 2019
DRAWN BY CC	PLAN SCALE 1:250
FILE NO. 11161E	CHECKED BY N.M.
PROJECT 3171 LAKESHORE ROAD WEST OAKVILLE, ON	
FILE NAME LANDSCAPE DETAILS	DWG NO. L2

ISSUED FOR SPA ONLY
NOT FOR CONSTRUCTION

All drawings and specifications are instruments of service and will remain the property of MHBC Planning and must be returned at the completion of the work. This drawing shall not be used for construction purposes unless the drawings are marked "Issued for Construction" and the professional seal is signed and dated by the landscape architect.

SOURCE
N:\1161\1E - Oudmore's Nursery\2022\October\Connell Restore\1161E - Landscape Plan - 10-12-2022.dwg

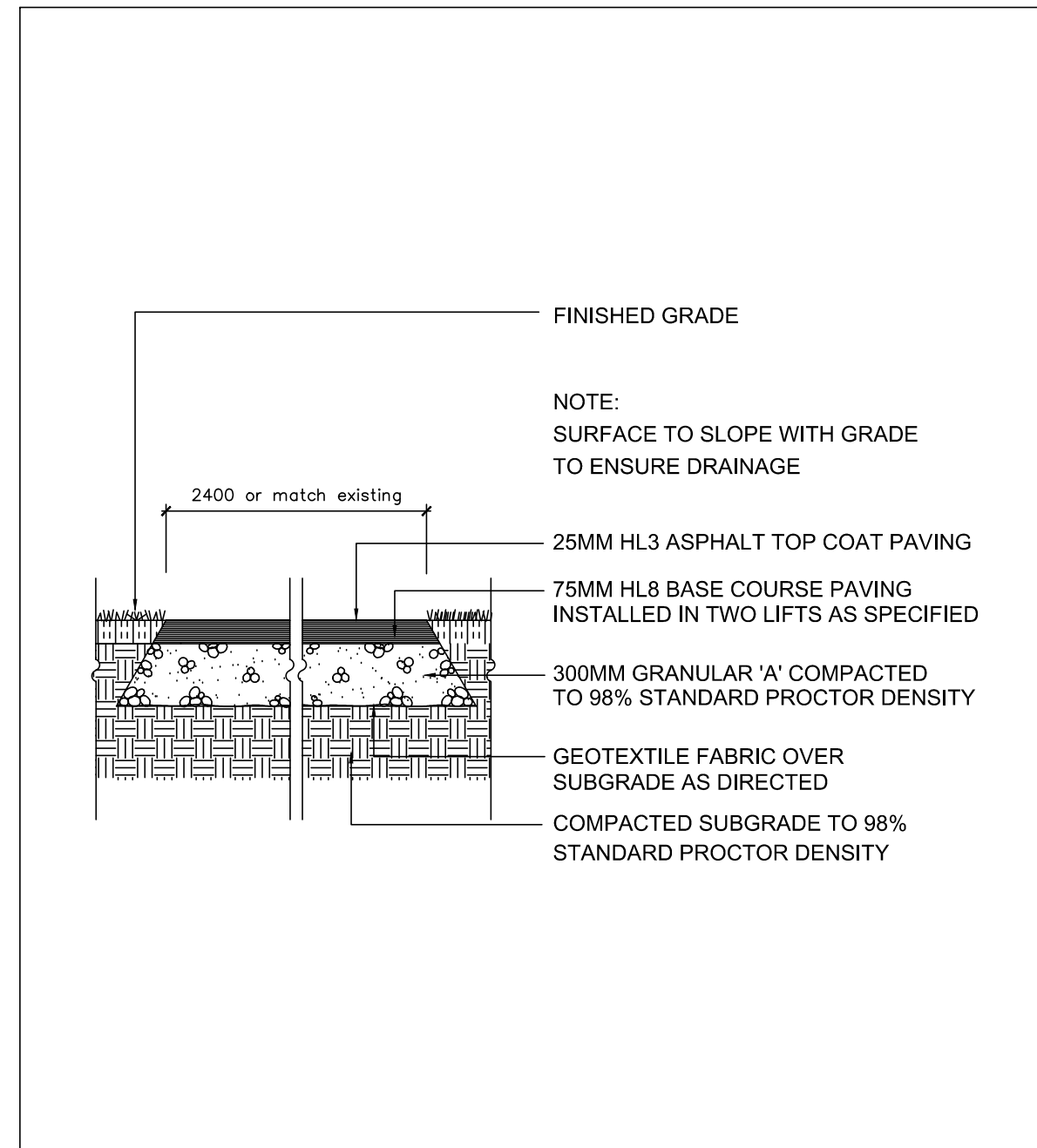

1 Asphalt Paving Detail
n.t.s.

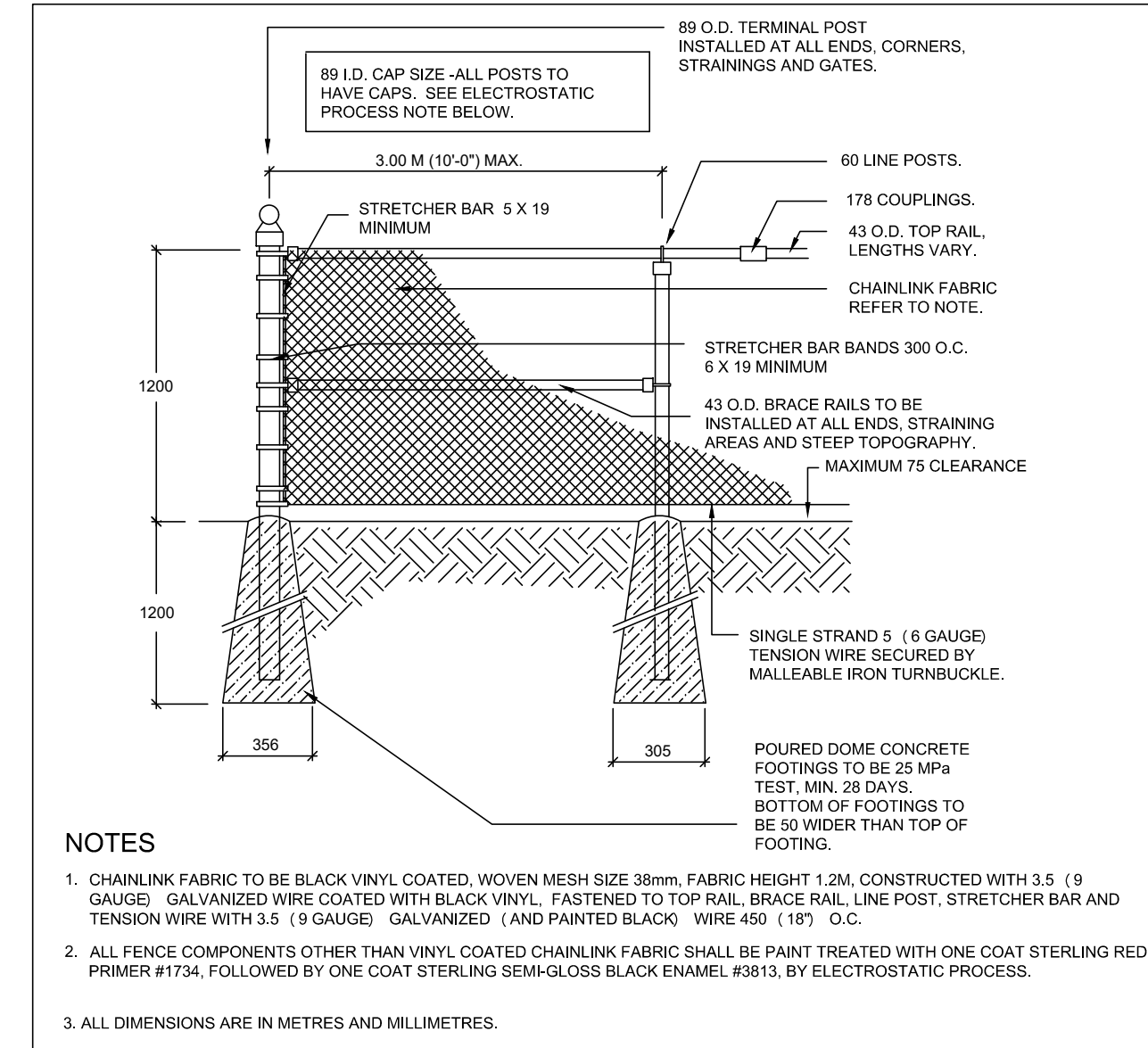

2 1.2m Chain Link Fence
n.t.s.

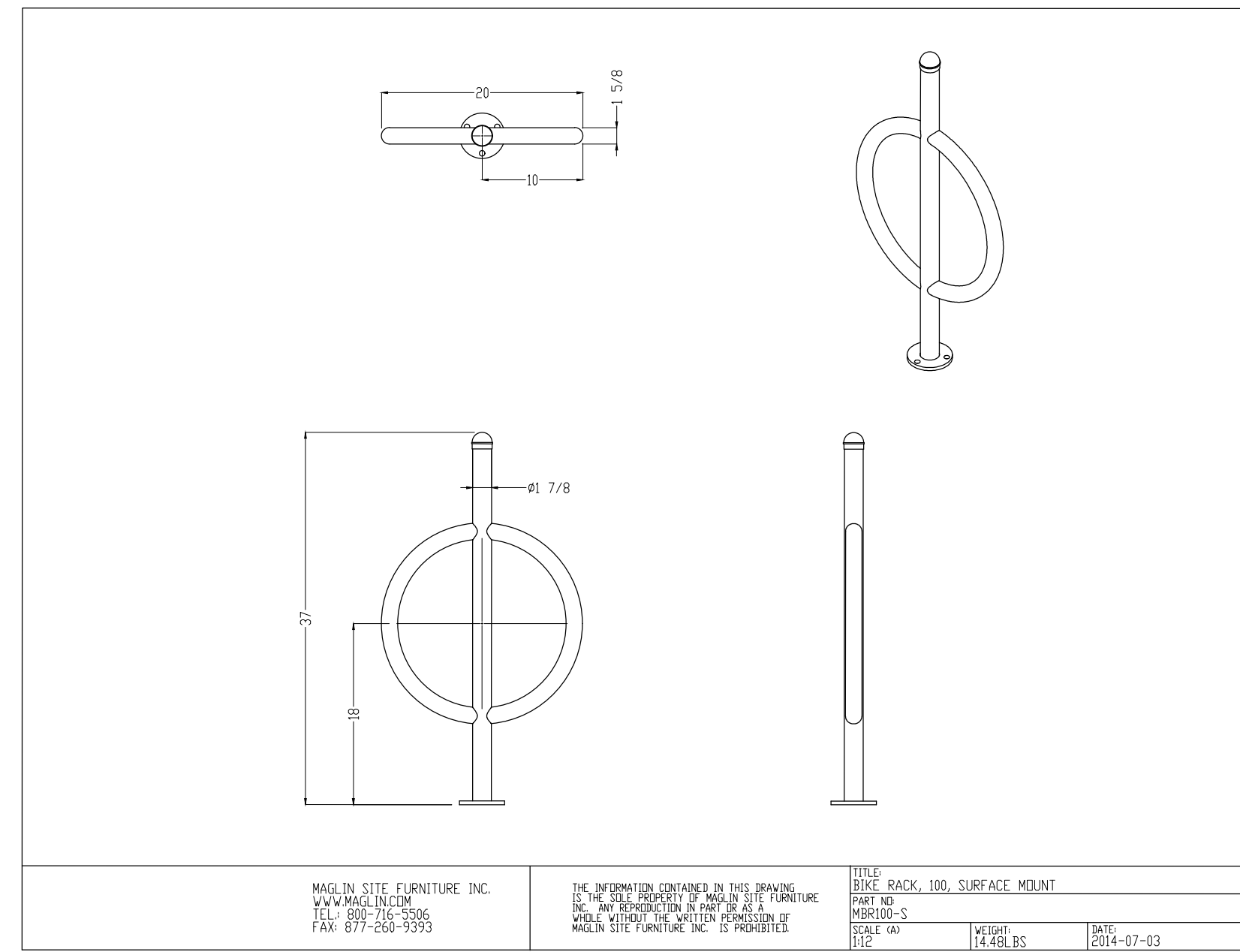

3 Maglin BR100 Bike Rack
n.t.s.

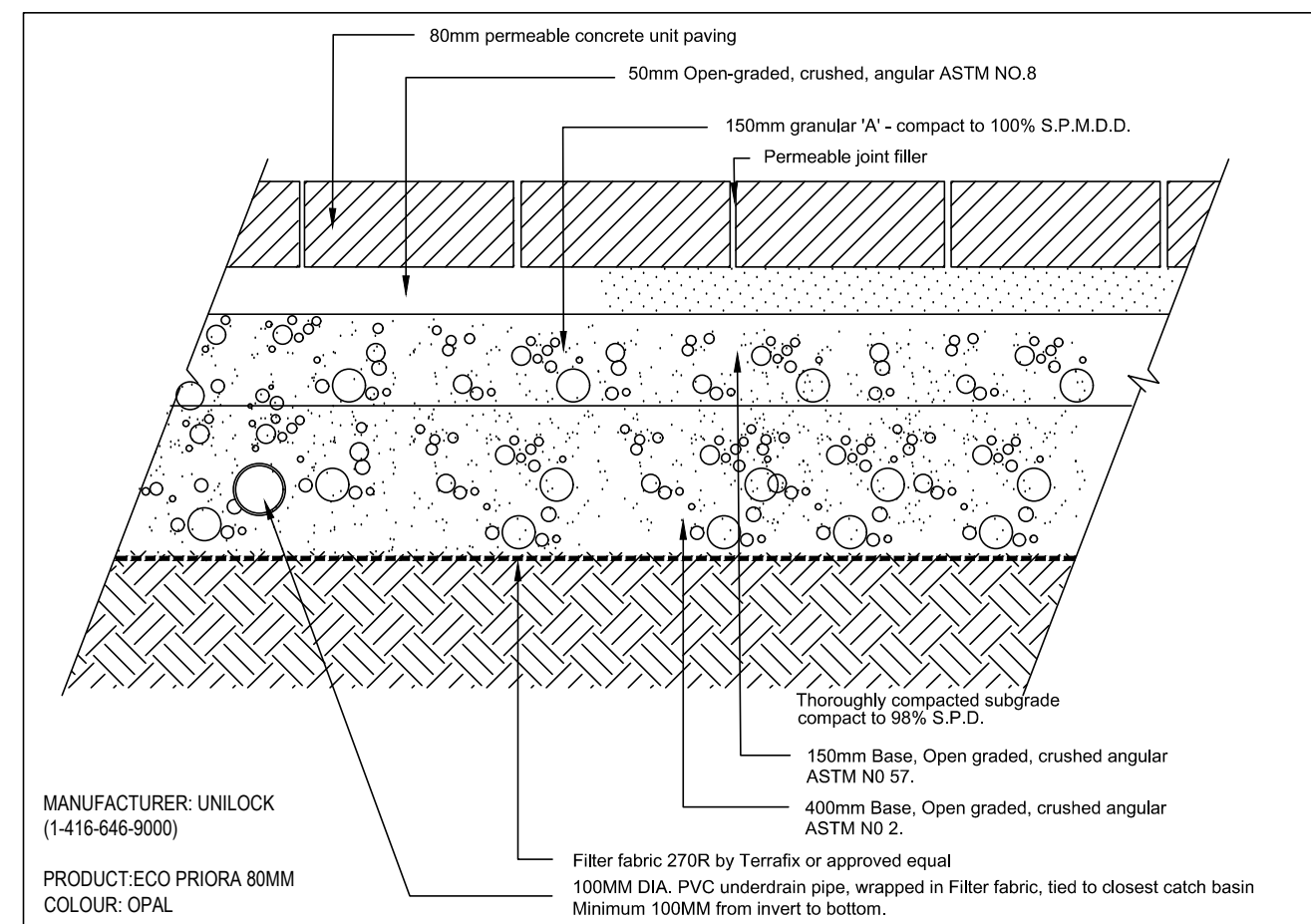

4 Permeable Unit Paver
n.t.s.

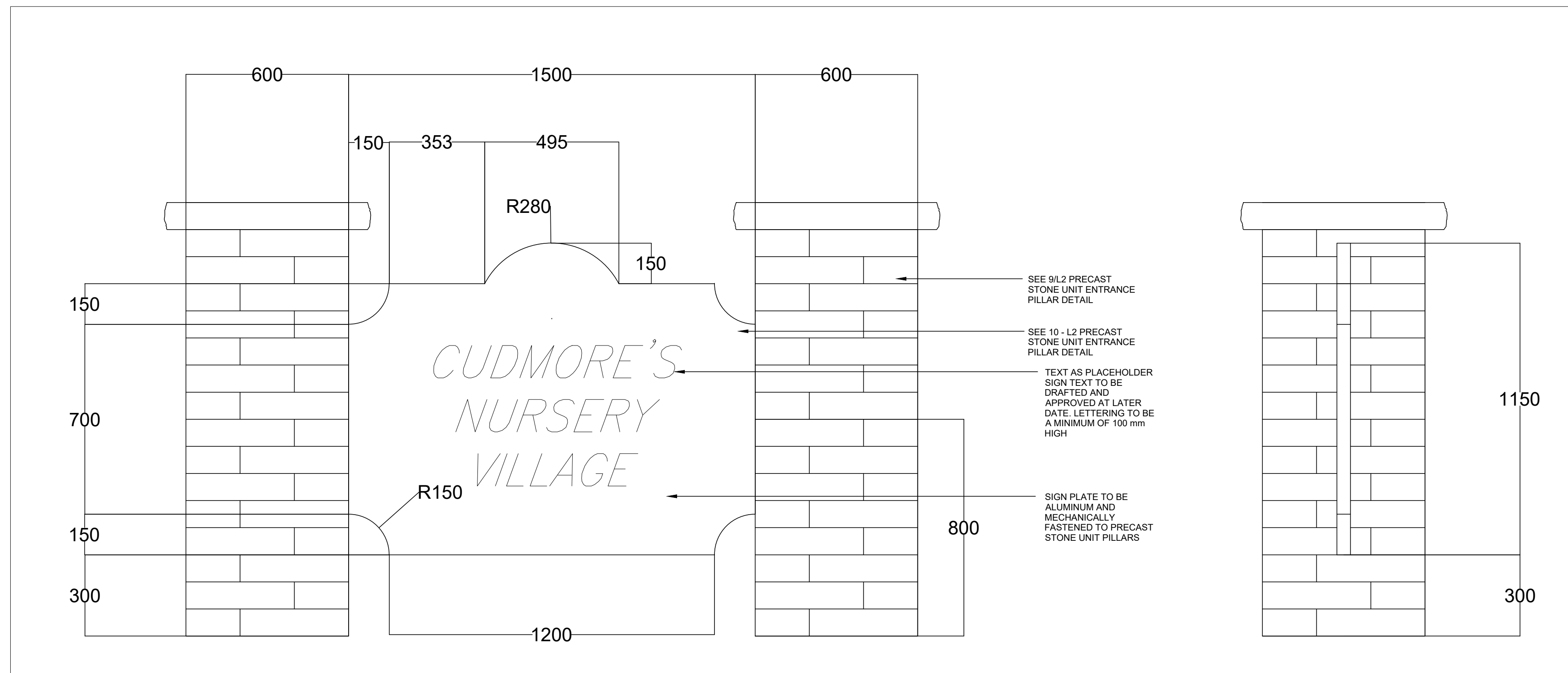

5 Community Identification Signage
PART OF SEPARATE PERMIT APPLICATION THROUGH ENFORCEMENT SERVICES

GENERAL NOTES

- Do not scale the drawings. All dimensions are in millimetres unless noted otherwise.
- This drawing is to be read in conjunction with the overall master plan and engineering drawings prepared by the project engineer and site plans prepared by the project architect.
- The contractor shall check and verify all existing and proposed grading and conditions on the project and immediately report any discrepancies to the consultant before proceeding with any work.
- The contractor is to be aware of all existing and proposed services and utilities. The contractor is responsible for having all underground services and utility lines staked by each agency having jurisdiction prior to commencing work.
- This drawing is to be used for development approval only. For layout of all work refer to construction drawings.
- Plant quantities indicated on the plan supercede the quantities from the plant list (report any discrepancies to the landscape architect).
- Do not leave any holes open overnight.
- Keep area outside construction zone clean and useable by others at all times. Contractor shall thoroughly clean areas surrounding the construction zone at the end of each work day.
- Contractor to make good any and all damages outside of the development area that may occur as a result of construction at no extra cost.
- This drawing is Copyright MHBC 2022

REVISION NO.	DATE	ISSUED / REVISION	BY
6.	OCTOBER 14, 2022	ISSUED FOR SPA	CC
5.	JANUARY 17, 2022	ISSUED FOR SPA	CC
4.	JANUARY 12, 2021	ISSUED FOR SPA	CC
3.	NOVEMBER 11, 2020	ISSUED FOR SPA	CC
2.	AUGUST 13, 2019	ISSUED FOR SPA	CC

MHBC PLANNING URBAN DESIGN & LANDSCAPE ARCHITECTURE
230-7050 WESTON ROAD WOODBRIDGE, ON, L4L 8C7 | P: 905.761.5588 F: 905.761.5589 | WWW.MHBCPLAN.COM

STAMP	DATE	
<p>ISSUED FOR SPA ONLY NOT FOR CONSTRUCTION</p> <p>All drawings and specifications are instruments of service and will remain the property of MHBC Planning and must be returned at the completion of the work. This drawing shall not be used for construction purposes unless the drawings are marked 'Issued for Construction' and the professional seal is signed and dated by the landscape architect.</p>	JULY 2019	
	DRAWN BY	CC
	PLAN SCALE	1:250
	FILE NO.	11161E
	CHECKED BY	N.M.
PROJECT		
3171 LAKESHORE ROAD WEST OAKVILLE, ON		
FILE NAME	DWG NO.	
LANDSCAPE DETAILS	L3	
SOURCE		
N:\11161E - Cudmore's Nursery\2022\October\Cornell Restora\11161E - Landscape Plan - 10-12-2022.dwg		