

# KAITTING TRAIL

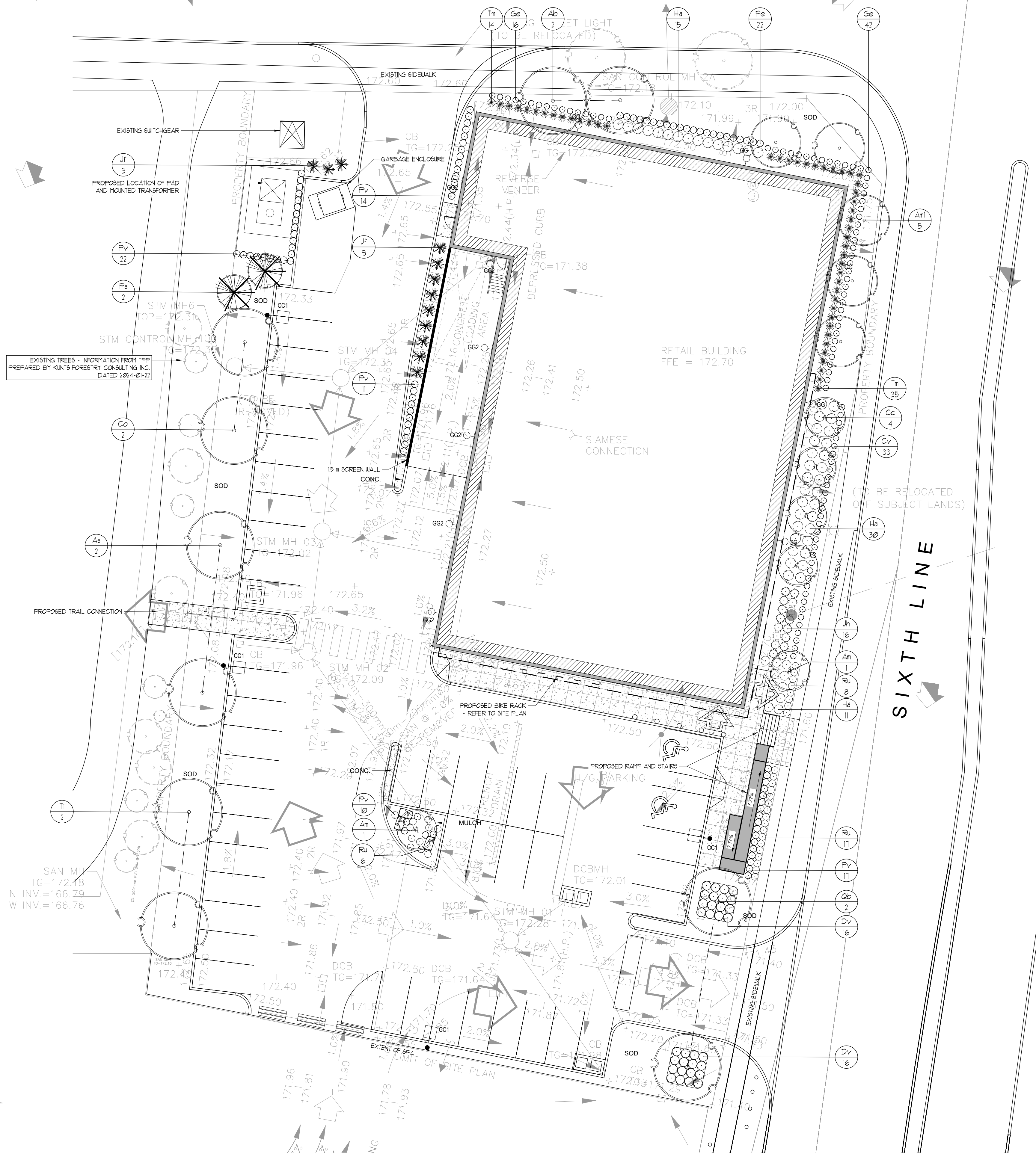

### PLANT MATERIAL

KEY	COMMON NAME	BOTANICAL NAME	QTY	SIZE	COND.
Ab	AUTUMN BLAZE MAPLE	Acer freemanii 'Autumn Blaze'	2	60cmal	UB
Am	MULTI-STEM SERV/CEBERRY	Azalea canadensis multi-stem	2	50cm	POT
Am	TREE FORM SERV/CEBERRY	Azalea canadensis 'tree form'	5	50cmal	UB
As	SUGAR MAPLE	Acer saccharum	2	60cmal	UB
Cc	MULTI-STEM REDBUD	Cercis canadensis multi-stem	4	30cm	POT
Co	HACKBERRY TREE	Celtis occidentalis	2	60cmal	UB
Cv	PURPLE CONE FLOWER	Echinacea purpurea	33	2ygal	POT
Dv	BUSH MONTSUCKLE	Diervilla lonicera	32	40cm	POT
De	ROZANE CRANESBILL	Geranium 'Rozanne'	58	2ygal	POT
Ha	ANNABELLE HYDRANGEA	Hydrangea arborescens 'Annabelle'	56	2ygal	POT
Jf	RED CEDAR	Juniperus virginiana	2	10cm	POT
Jh	PRINCE OF WALES JUNIPER	Juniperus horizontalis 'Prince of Wales'	16	40cm	POT
Pe	LITTLE BUNNY FOUNTAIN GRASS	Pennisetum alopecuroides 'Little Bunny'	22	2ygal	POT
Pf	WHITE PINE	Pinus strobus	2	200cm	UB
Pv	SHENANDOAH BUTCH GRASS	Panicum virgatum 'Shenandoah'	14	2ygal	POT
Qb	BURR OAK	Quercus macrocarpa	2	60cmal	UB
Ru	BLACKEYED SUSAN	Rudbeckia fulgida 'Goldsum'	31	2ygal	POT
Ti	LITTLELEAF LINDEN	Tilia cordata	2	60cmal	UB
Tn	DENSE YEW	Taxus x media 'Densiformis'	49	40cm	POT

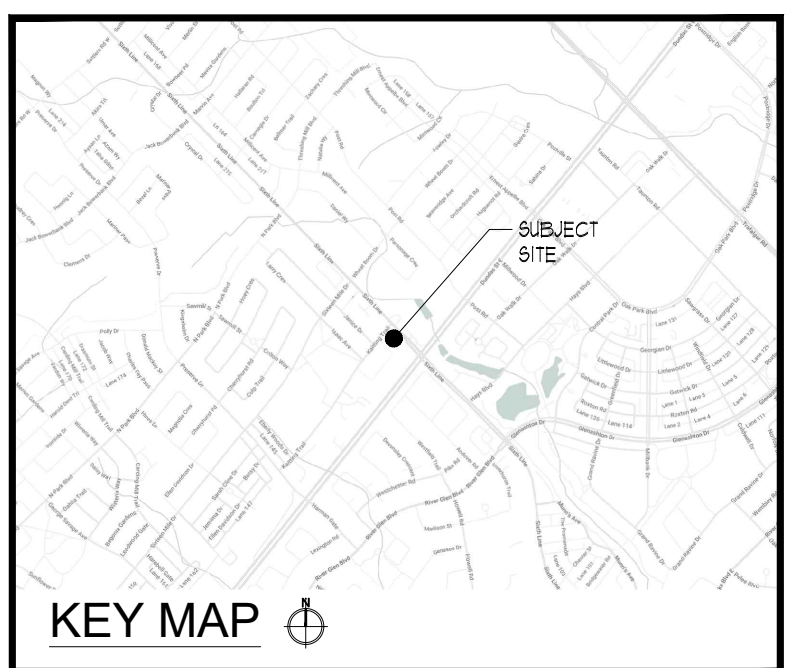
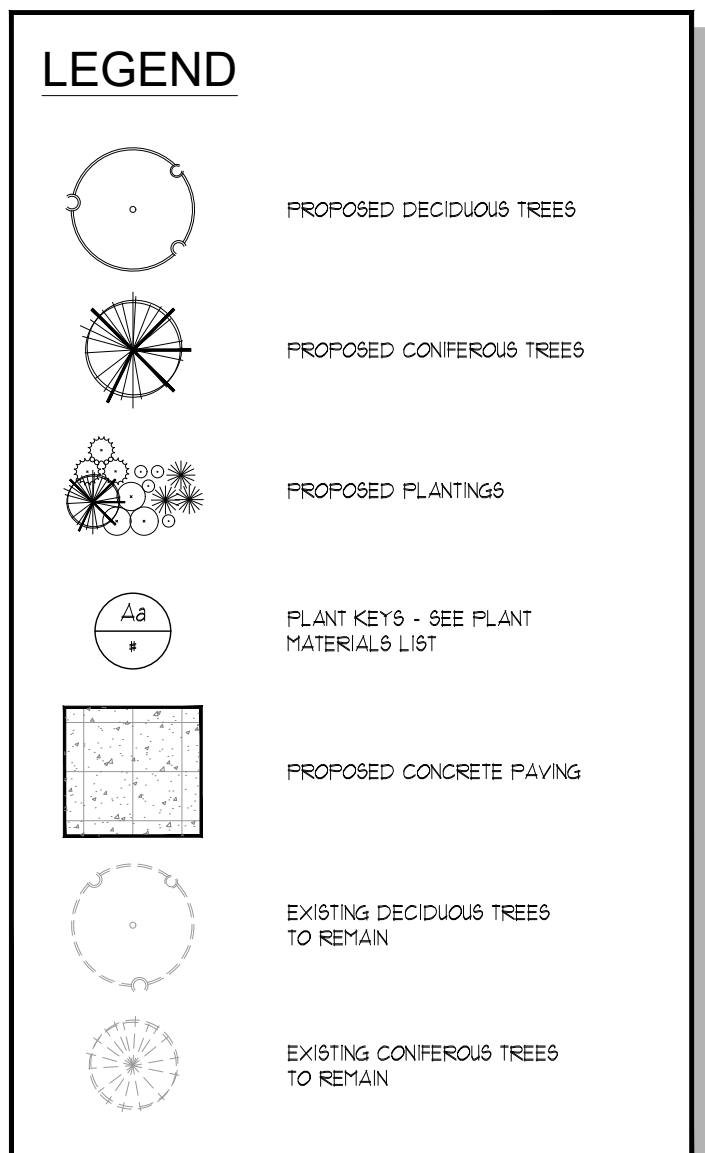

**RON KOUDYSE LANDSCAPE ARCHITECTS INC.**

ALL DRAWINGS REMAIN THE PROPERTY OF THE LANDSCAPE ARCHITECT AND SHALL NOT BE REPRODUCED OR REUSED WITHOUT THE LANDSCAPE ARCHITECTS WRITTEN PERMISSION.

THIS DRAWING SHALL NOT BE USED FOR CONSTRUCTION OR TENDER PURPOSES UNLESS SIGNED AND DATED BY BARRY R. MURPHY, O.A.L.A. C.S.L.A. LANDSCAPE ARCHITECT, LONDON, ONTARIO (519) 867-3322.

Barry R. Murphy, O.A.L.A. C.S.L.A. DATE

DATE	DESCRIPTION	No.
2016-05-12	ISSUED FOR SPA	4
2016-05-08	ISSUED FOR REVIEW	3
2016-04-22	ISSUED FOR DRAFT	2
2016-04-13	ISSUED FOR REVIEW	1

PLOTTING INFORMATION:  
 PLOTTED DATE: 2016-05-12  
 PLOTTED SCALE: 1/1

PROJECT TITLE:  
**DUNDAS STREET WEST & SIXTH LINE**  
 OAKVILLE, ON

DRAWING TITLE:  
**LANDSCAPE PLAN**

DATE: MAY 2016	SCALE: AS NOTED	DRAWING No. <b>L-1</b>
DRAWN: RKL/A Inc.	CHECKED BY: RJK	
PROJECT No. 26-117Lf		

**LANDSCAPE PLAN**  
 SCALE = 1:200

# KAITTING TRAIL

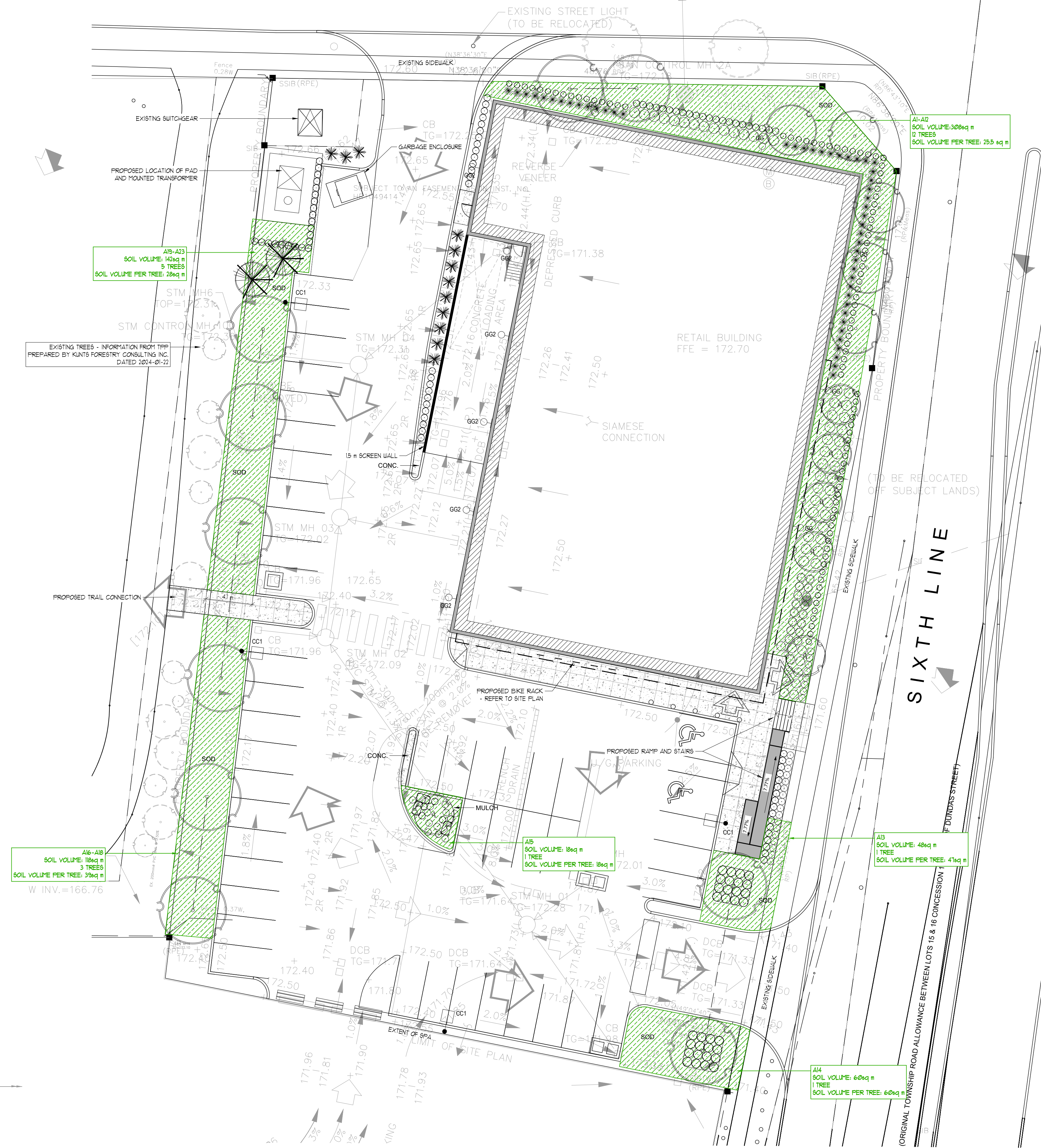

### CANOPY COVER & SOIL VOLUME CALCULATIONS

# of Trees	Species	Category (S,M,L)	Soil Volume per Tree (CU meters)	Canopy Area (Sq meters)
P1	Autumn Blaze Maple	L	25	64
P2	Autumn Blaze Maple	L	25	64
P3	Single-stem Serviceberry	S	25	20
P4	Single-stem Serviceberry	S	25	20
P5	Single-stem Serviceberry	S	25	20
P6	Single-stem Serviceberry	S	25	20
P7	Single-stem Serviceberry	S	25	20
P8	Multi-stem Redbud	S	25	20
P9	Multi-stem Redbud	S	25	20
P10	Multi-stem Redbud	S	25	20
P11	Multi-stem Redbud	S	25	20
P12	Multi-stem Redbud	S	25	20
P13	Burr Oak	L	48	64
P14	Burr Oak	L	60	64
P15	Multi-stem Serviceberry	S	18	20
P16	Littleleaf Linden	L	39	64
P17	Littleleaf Linden	L	39	64
P18	Sugar Maple	L	38	64
P19	Sugar Maple	L	28.4	64
P20	Hackberry	L	28.4	64
P21	Hackberry	L	28.4	64
P22	White Pine	M	28.4	20
P23	White Pine	M	28.4	20
<b>Subtotal of Proposed Canopy</b>				<b>900</b>
<b>Existing Canopy</b>				<b>0</b>
<b>Existing Canopy overhanging site</b>				<b>0</b>
<b>Canopy Summary</b>				
Total Site Area			<b>4,572</b>	
Canopy Cover Target by Land Use			<b>15%</b>	
Proposed Site Canopy Cover			<b>20%</b>	
<b>Parking Area Summary</b>				
Total Parking Spaces Proposed			<b>46</b>	
Total # of Trees in or within 5 meters of Parking Area			<b>8</b>	

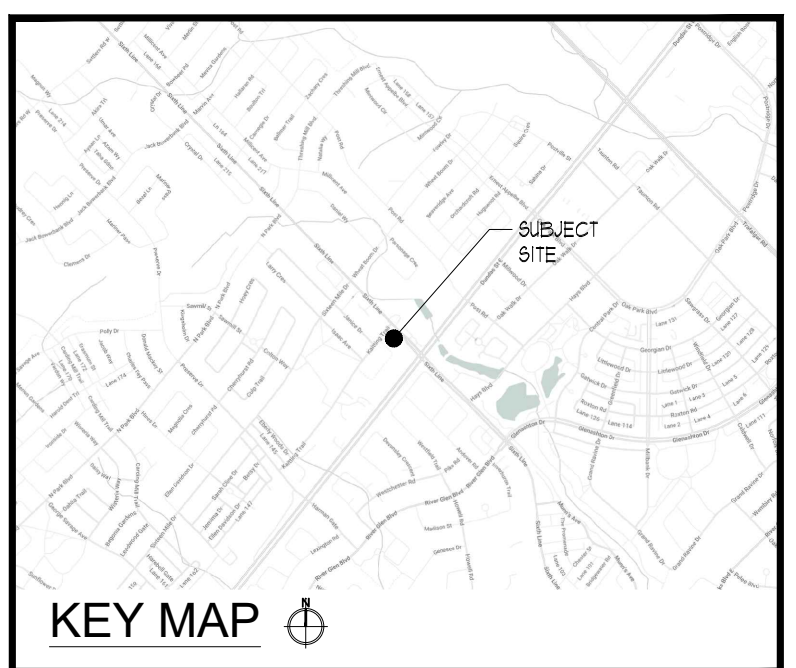

ALL DRAWINGS REMAIN THE PROPERTY OF THE LANDSCAPE ARCHITECT AND SHALL NOT BE REPRODUCED OR REUSED WITHOUT THE LANDSCAPE ARCHITECTS WRITTEN PERMISSION.

THIS DRAWING SHALL NOT BE USED FOR CONSTRUCTION OR TENDER PURPOSES UNLESS SIGNED AND DATED BY BARRY R. MURPHY, O.A.L.A. C.S.L.A. LANDSCAPE ARCHITECT, LONDON, ONTARIO (519) 667-3322.

Barry R. Murphy, O.A.L.A. C.S.L.A. DATE

DATE	DESCRIPTION	No.
2016-05-12	ISSUED FOR SPA	4
2016-05-08	ISSUED FOR REVIEW	3
2016-04-22	ISSUED FOR DRAFT	2
2016-04-13	ISSUED FOR REVIEW	1

PLOTTING INFORMATION:  
 PLOTTED DATE: 2016-05-12  
 PLOTTED SCALE: 1:1

PROJECT TITLE:  
**DUNDAS STREET WEST & SIXTH LINE**  
 OAKVILLE, ON

DRAWING TITLE:  
**CANOPY COVERAGE & SOIL VOLUME PLAN**

DATE: MAY 2016	SCALE: AS NOTED	DRAWING No. <b>L-2</b>
DRAWN: RKL/A Inc.	CHECKED BY: RJK	
PROJECT No. 26-117Lf		

**CANOPY COVERAGE & SOIL VOLUME PLAN**  
 SCALE = 1:200

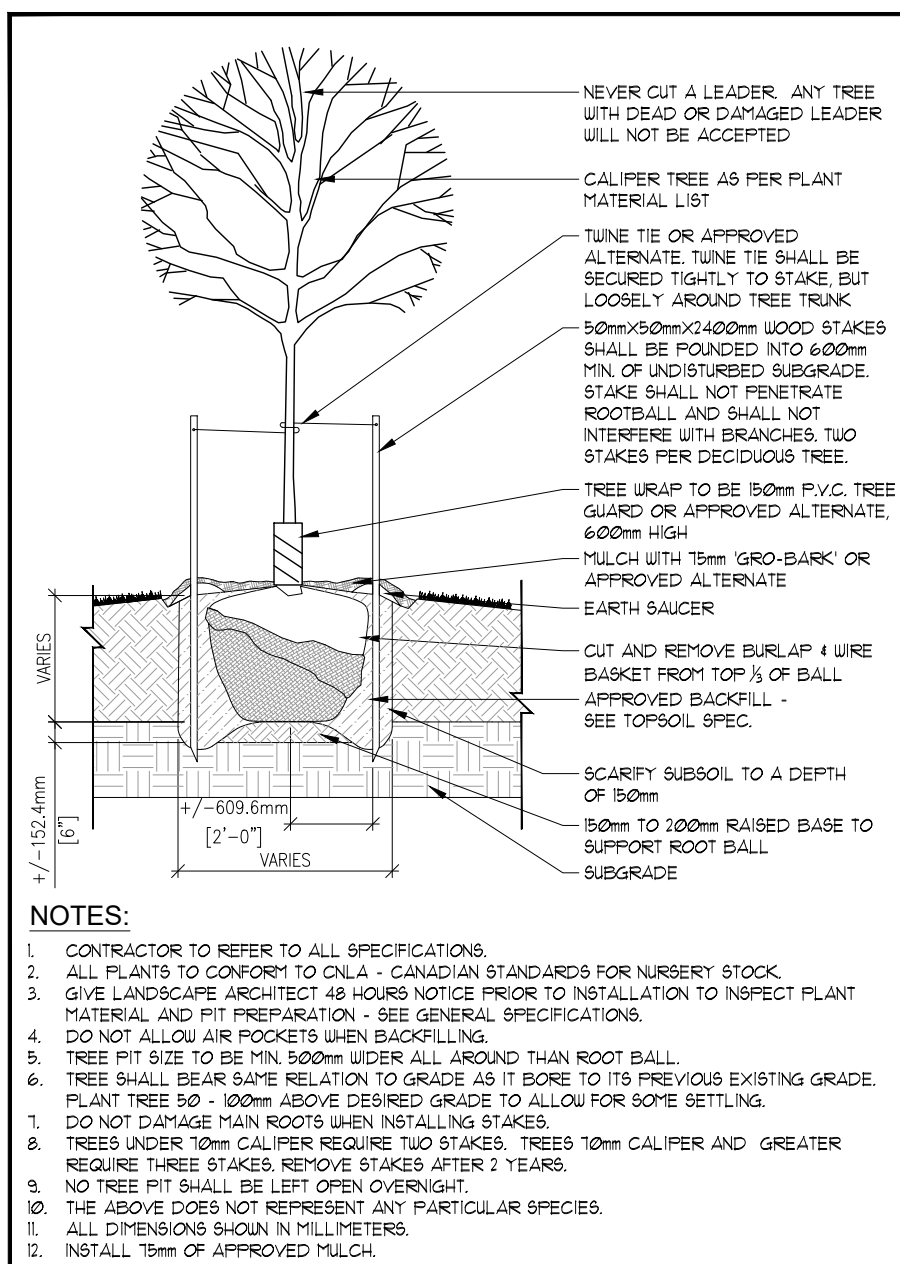

DECIDUOUS TREE PLANTING DETAIL - N.T.S.

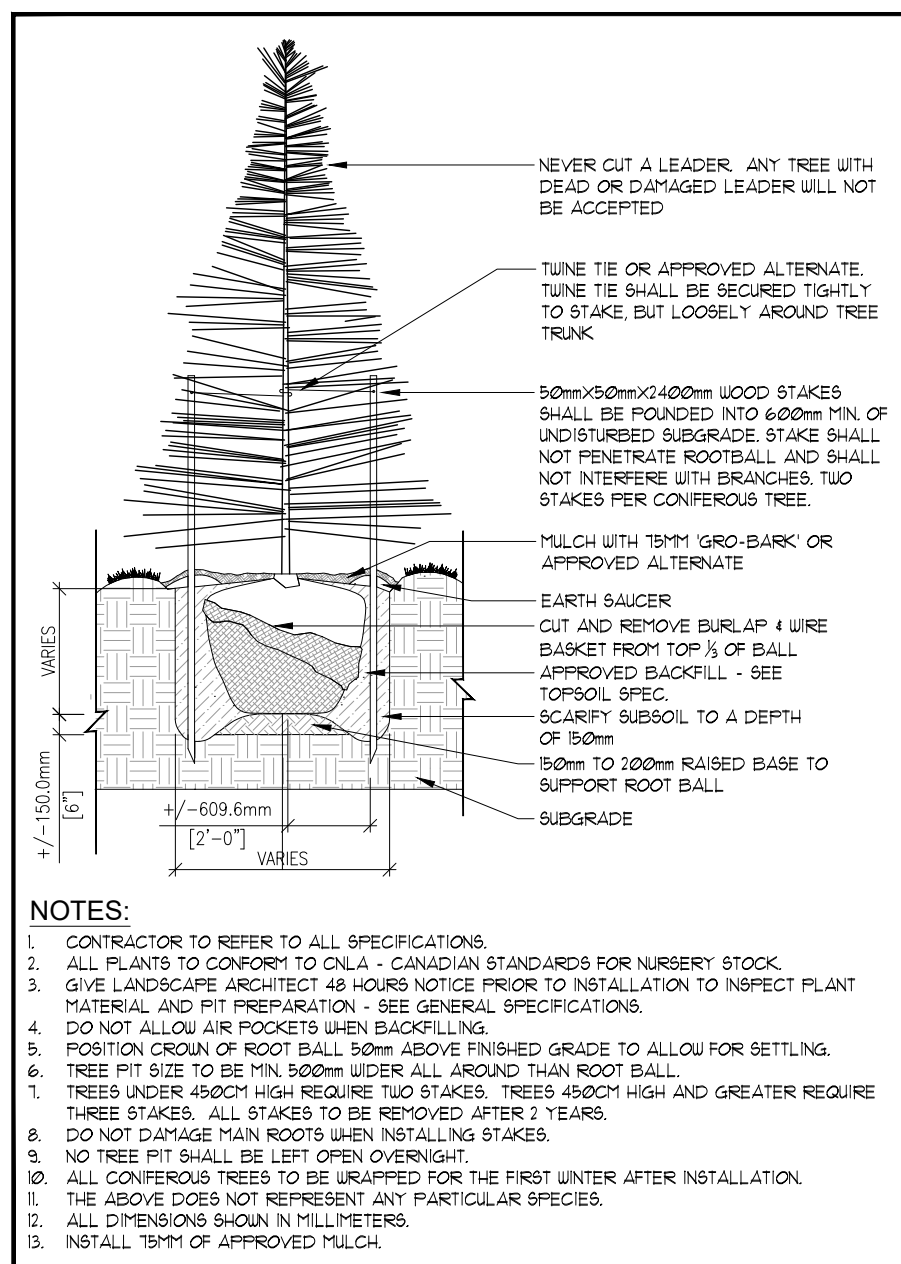

CONIFEROUS TREE PLANTING DETAIL - N.T.S.

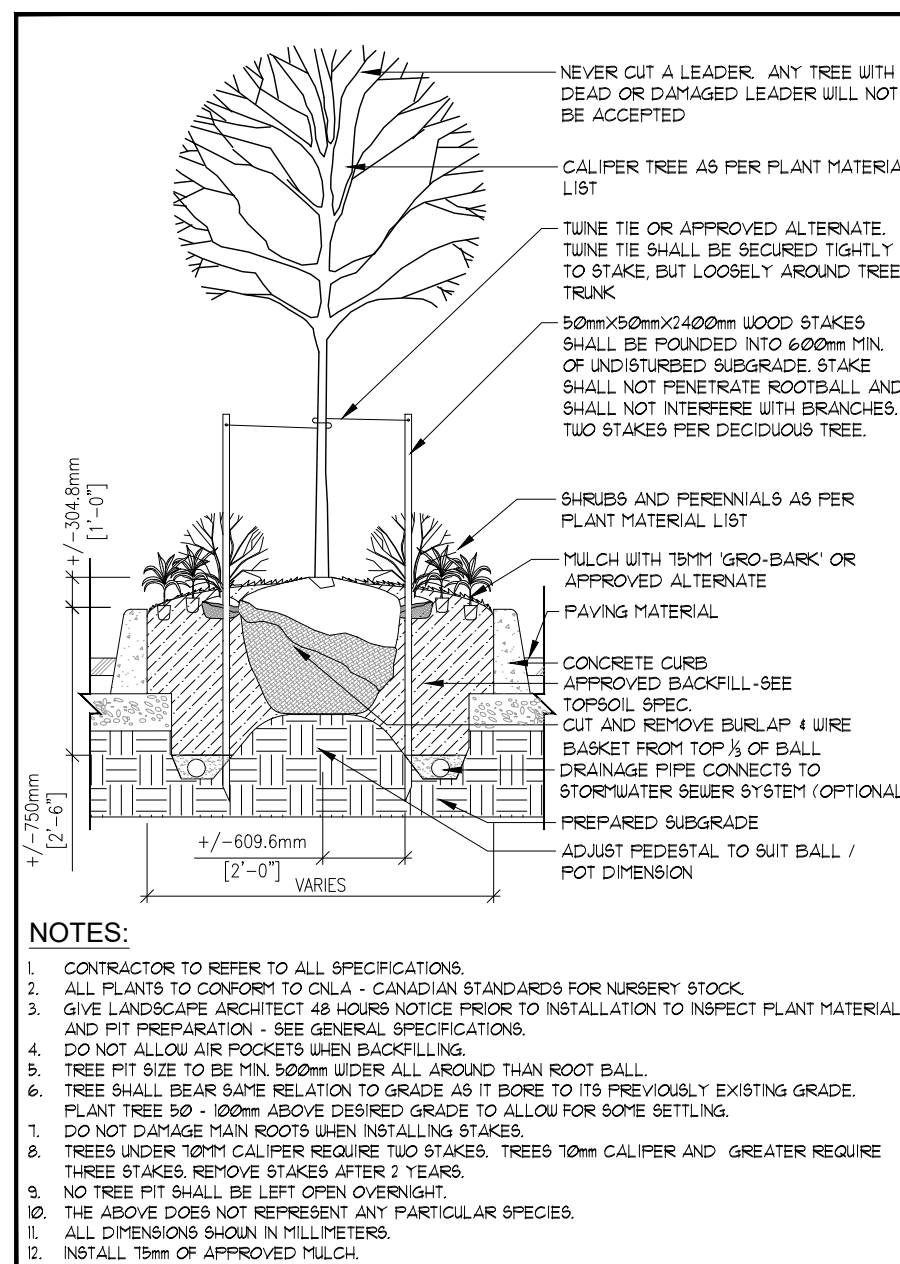

TYPICAL ISLAND PLANTING DETAIL - N.T.S.

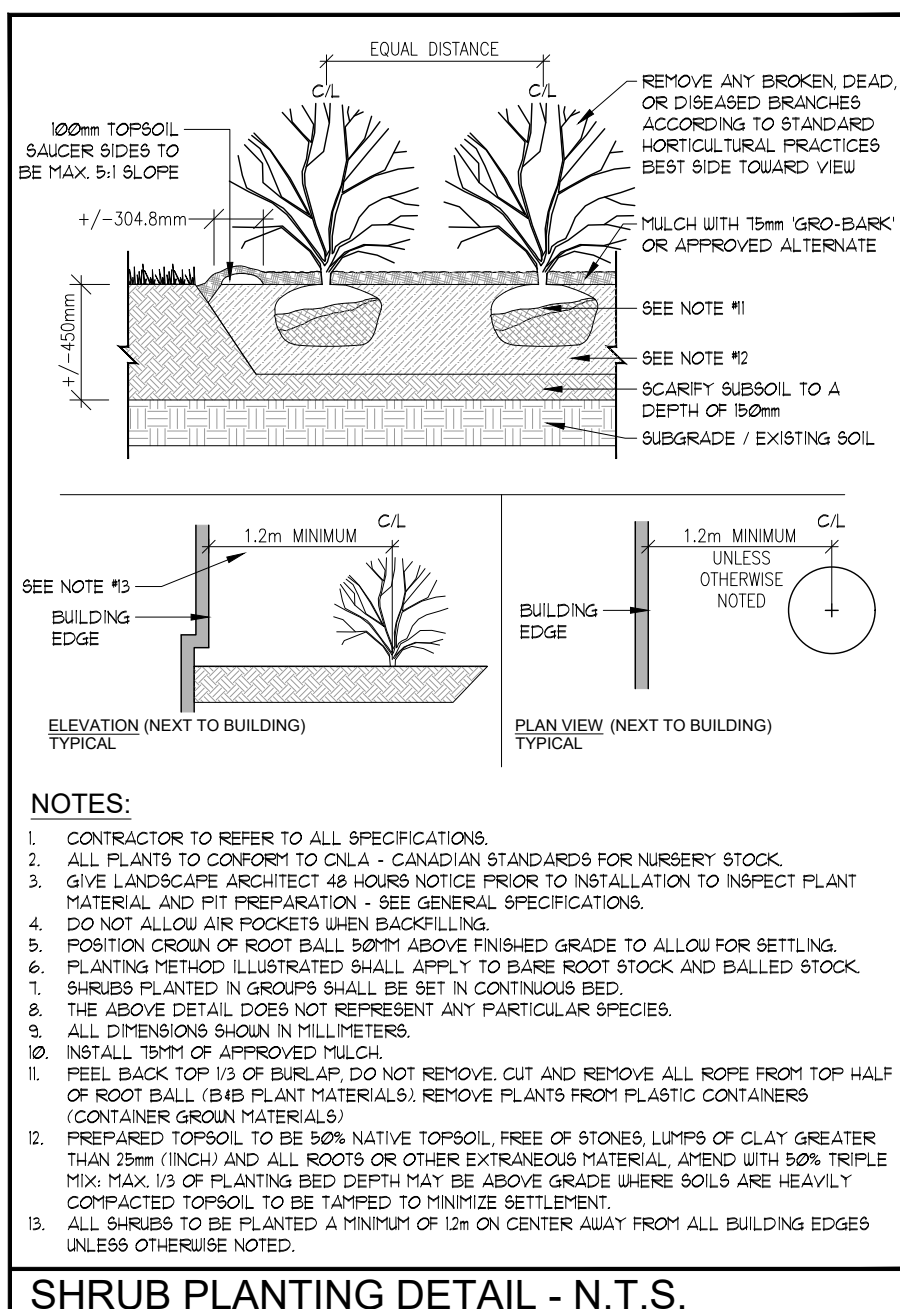

SHRUB PLANTING DETAIL - N.T.S.

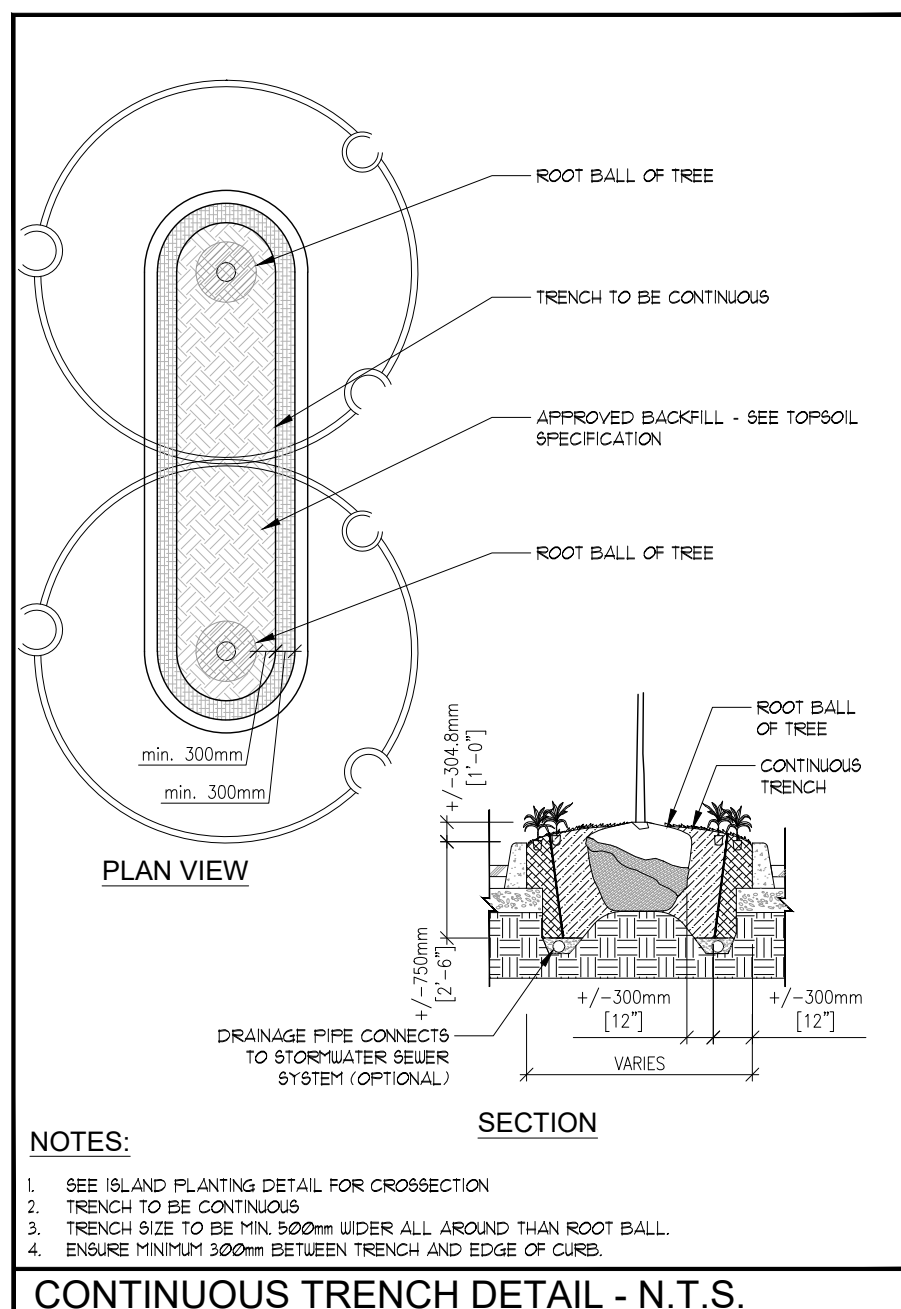

CONTINUOUS TRENCH DETAIL - N.T.S.

GENERAL PLANTING SPECIFICATIONS:

- BASE INFORMATION SUPPLIED BY TURNER FLEISCHER.
- ENGINEERING INFORMATION SUPPLIED BY TRAFALGAR ENGINEERING.
- CONTRACTOR TO MAKE THEMSELVES FAMILIAR WITH ALL RELATED SPECIFICATIONS.
- CONTRACTORS ARE RESPONSIBLE FOR REVIEW OF ALL SPECIFICATIONS AND RELATED DRAWINGS WITH SELECTED SUB-CONTRACTORS AS THEY PERTAIN TO WORK AS OUTLINED ON LANDSCAPE ARCHITECTURAL WORKING DRAWINGS AND SPECIFICATIONS.
- REPORT ALL DISCREPANCIES TO THE LANDSCAPE ARCHITECT DURING TENDERING PROCESS. ERRORS AND/OR OMISSIONS WILL BE THE RESPONSIBILITY OF THE CONTRACTOR.
- CONTRACTOR SHALL MAINTAIN LANDSCAPED AREAS UNTIL OWNER ACCEPTANCE OF PROJECT. CONTRACTOR TO NOTIFY LANDSCAPE ARCHITECT IN WRITING ON COMPLETION OF PROJECT FOR A SITE WORK COMPLETION CERTIFICATE AS WELL AS THE COMMENCEMENT OF THE ACCEPTANCE OF PROJECT.
- ALL WORKMANSHIP TO BE GUARANTEED FOR ONE YEAR UNLESS OTHERWISE STATED. WARRANTY PERIOD WILL BEGIN ON FINAL ACCEPTANCE OF PROJECT.
- ALL WORKMANSHIP TO COMPLY WITH THE CANADIAN LANDSCAPE STANDARDS.
- ALL NURSERY STOCK TO BE # NURSERY GROWN AND MUST COMPLY WITH THE CANADIAN NURSERY LANDSCAPE ASSOCIATION'S 'CANADIAN NURSERY STOCK STANDARDS' LATEST EDITION.
- ALL LANDSCAPING IS TO BE INSTALLED PRIOR TO THE END OF THE FIRST GROWING SEASON FOLLOWING THE OCCUPANCY OF THE SITE DEVELOPMENT UNLESS OTHERWISE STATED.
- CONTRACTOR IS RESPONSIBLE FOR ALL UNDERGROUND UTILITIES AND MUST SUPPLY THE LANDSCAPE ARCHITECT WITH COPIES OF LOCATE CERTIFICATES PRIOR TO COMMENCEMENT OF WORK.

- GRADING
- CONTRACTOR TO ENSURE POSITIVE DRAINAGE IN ALL AREAS.
  - ALL GRADING TO BE IN ACCORDANCE WITH SITE ENGINEERS DRAWINGS.
  - SOIL SHALL BE SCARIFIED FREE OF ALL STONES, ROOTS, BRANCHES LARGER THAN 1" (25MM) AND COMPACTED TO 85% R.P.D.
  - ALL SUBSOIL TO BE SCARIFIED TO A DEPTH OF 6" (150MM) PRIOR TO THE INSTALLATION OF TOPSOIL TO ENSURE NO HARDSPAN CONDITIONS.
  - CONTRACTOR TO NOTIFY LANDSCAPE ARCHITECT PRIOR TO INSTALLATION OF TOPSOIL TO APPROVE SUBBASE.
  - DIRECT ALL RAINLEADERS AND SUMP LEADERS AWAY FROM PLANTING BEDS AND TO DESIGNATED SWALES.
  - NOTIFY LANDSCAPE ARCHITECT IN WRITING OF ANY SUBSTANTIAL VIET CONDITIONS.

- TOPSOIL
- AT THE CONTRACTORS EXPENSE A SOIL TEST IS TO BE COMPLETED BY A REPUTABLE LABORATORY. THE SOIL TEST IS TO BE COMPLETED AND IF NECESSARY, RECOMMENDATIONS FROM THE LABORATORY ARE TO BE INCLUDED. THE RESULTS OF SOIL TESTS AND RECOMMENDATIONS ARE TO BE PROVIDED TO THE LANDSCAPE ARCHITECT FOR APPROVAL ONE WEEK PRIOR TO WORK COMMENCING.
  - TOPSOIL FOR PLANTING BEDS IS TO BE A FERTILE, FRIABLE, NATURAL LOAM TO A MINIMUM DEPTH OF 8" (600MM) AND A MINIMUM DEPTH OF 4" (100MM) FOR TURF AREAS - UNLESS OTHERWISE STATED - TOPSOIL SHALL CONTAIN NOT LESS THAN 4% ORGANIC MATTER FOR CLAY LOAMS AND NOT LESS THAN 2% ORGANIC MATTER FOR SANDY LOAM TO A MAXIMUM OF 8% AND CAPABLE OF SUSTAINING VIGOROUS PLANT GROWTH. FREE OF SUBSOIL, CONTAMINATION, ROOTS AND STONES OVER 50mm DIAMETER. REASONABLY FREE OF WEEDS, AS DETERMINED BY THE LANDSCAPE ARCHITECT, AND HAVING A pH RANGING FROM 6.0 TO 7.0.
  - TOPSOIL IS TO BE STOCKPILED FOR USE ON SITE DEVELOPMENT. AVOID MIXING TOPSOIL WITH SUBSOIL. LIMIT HEIGHT OF STOCKPILE TO 2m TO RETAIN SOIL MICROORGANISMS AND SOIL VIABILITY AND FERTILITY.
  - IF APPLICABLE, ALL WORK IN ANY ROAD ALLOWANCE SHALL MEET THE MINIMUM SPECIFICATIONS OF THE MUNICIPALITY. ENSURE A MINIMUM OF 100MM TOPSOIL IS INSTALLED IN BOULEVARDS.
  - PROTECT THE MUNICIPALITY OWNED ROAD ALLOWANCE(S)/BOULEVARD(S) FROM COMPACTION OR SOIL CONTAMINATION.

- MULCH
- ALL TREES/SHRUB PITS AND PLANTING AREAS ARE TO BE MULCHED UNLESS OTHERWISE NOTED.
  - CONTRACTOR TO INSTALL 2" (51MM) OF GKO-BARK MEDIUM MULCH IN ALL AREAS.
  - ALTERNATIVES MAY BE ACCEPTED - CONTRACTOR TO PROVIDE 3 SAMPLES FOR WRITTEN APPROVAL TO THE LANDSCAPE ARCHITECT.

- PLANT MATERIALS
- CONTRACTOR TO VERIFY ALL PLANT MATERIAL ON DRAWING(S) AND PLANT MATERIAL LIST(S) REPORT ALL DISCREPANCIES AT TENDERING PROCESS.
  - SUBSTITUTIONS WILL NOT BE ACCEPTED WITHOUT WRITTEN CONFIRMATION BY THE LANDSCAPE ARCHITECT.
  - PLANTINGS MAY BE ADJUSTED TO SUIT UTILITIES STRUCTURES AND AESTHETIC CONCERNS. ADJUSTMENTS ARE TO BE MADE UNDER THE DIRECTION OF THE LANDSCAPE ARCHITECT. ADJUSTMENTS TO PLANTING WITHOUT CONSENT OF LANDSCAPE ARCHITECT AND/OR PROJECT MANAGER MAY NOT MEET INTENT OF DESIGN AND/OR MUNICIPAL APPROVALS. PLANT MATERIAL THAT HAS TO BE RELOCATED AS A RESULT WILL BE AT THE COST OF THE CONTRACTOR.
  - LANDSCAPE ARCHITECT TO INSPECT ALL PLANT MATERIAL ON SITE OR AT ITS SOURCE PRIOR TO INSTALLATION. CONTRACTOR IS TO GIVE LANDSCAPE ARCHITECT 48 (48H) NOTICE FOR INSPECTION.
  - CONTRACTOR TO NOTIFY LANDSCAPE ARCHITECT IN WRITING IF ADVERSE WEATHER MAY IMPACT THE HEALTH OF THE PLANT MATERIALS AT TIME OF PLANTING - I.E. TEMPERATURE, PRECIPITATION.
  - ALL TREE PITS SHALL BE AT LEAST 2 FT. (600MM) WIDER THAN BALL OF THE TREE TO BE PLANTED AND SHALL BE DEEP ENOUGH SO THAT THE TOP OF BALL IS AT THE SAME LEVEL AS SURROUNDING GRADE. A MINIMUM OF 6" (150MM) OF BACKFILL SHALL BE PLACED UNDER BALL. TREE PITS ARE NOT TO BE LEFT OPEN OVER NIGHT.
  - SHRUB BEDS SHALL BE EXCAVATED TO A DEPTH OF 8" (400MM) AND FILLED WITH APPROVED BACKFILL MATERIAL. SHRUB BEDS ARE NOT TO BE LEFT OPEN OVER NIGHT.
  - ALL TREES SHALL HAVE AN EARTH SAUCER AT ITS BASE WITH A DIAMETER AS LARGE AS EXCAVATED AREA AND SHAPED TO RETAIN WATER (SEE DETAIL). EARTH SAUCER TO HAVE APPROVED MULCH INSTALLED TO A MINIMUM DEPTH OF 25" (630MM).
  - ALL BURLAP SHALL BE CUT AND BURIED BELOW SURFACE DURING PLANTING.
  - ALL EVERGREENS ARE TO UNWRAP THE FIRST WINTER AT THE EXPENSE OF THE LANDSCAPE CONTRACTOR.
  - ALL SHRUBS PLANTED WITHIN 1m OF SALTED ROADWAYS, PARKING AND SIDEWALKS TO BE PROTECTED WITH SILT FENCING THROUGHOUT THE FIRST WINTER AFTER INSTALLATION AT THE EXPENSE OF THE LANDSCAPE CONTRACTOR (OPTIONAL).
  - DIRECT ALL RAINLEADERS AND SUMP LEADERS AWAY FROM PLANTING BEDS AND TO DESIGNATED DRAINAGE SWALES.
  - DO NOT INSTALL PLANT MATERIAL IN DRAINAGE SWALES.
  - CONTRACTOR IS TO REMOVE ALL STAKES AND GUY WIRES AFTER 2 FULL GROWING SEASONS.

- SOIL
- ALL LANDSCAPED AREAS TO BE SOODED TO THE STREET CURB (S) UNLESS OTHERWISE STATED.
  - CONTRACTOR TO ENSURE (WHERE APPLICABLE) ALL PLANTING BEDS ADJACENT TO TRAFFIC ISLANDS, INTERIOR SITE CURBING, AND SIDEWALKS HAVE A 3" (75MM) SOIL MAINTENANCE STRIP INSTALLED.
  - ANY SODDING OR WORKS ON LANDS ADJUTING THE PROPERTY FROM THE LOTLINES TO SIDEWALK AND CURBING SHALL BE COMPLETED OR REPAIRED TO THE SATISFACTION OF THE LANDSCAPE ARCHITECT, CITY, AND/OR REGIONAL MUNICIPALITY UNLESS OTHERWISE STATED.
  - SOIL SHALL BE CERTIFIED #1 CULTIVATED TURF GRASS GROWN AND SOLD IN ACCORDANCE WITH THE CLASSIFICATIONS OF THE NURSERY SOIL GROWERS ASSOCIATION OF ONTARIO AT TIME OF SALE. IT SHALL HAVE A STRONG FIBROUS ROOT SYSTEM AND SHALL BE CUT IN PIECES APPROXIMATELY ONE SOYD (300MM) IN AREA WITH THE SOIL PORTION BEING 3/4" (19MM).
  - SOIL TO BE FERTILIZED AT THE APPROPRIATE RATES AS INDICATED BY SOIL TESTS COMPLETED BY A REPUTABLE SOILS LABORATORY.
  - UPON INSTALATION AREAS SHOULD BE WATERED SO AS TO SATURATE SOIL AND THE UPPER 4" (100MM) OF BACKFILL TOPSOIL. AFTER SOIL AND SOIL HAVE DRIED SUFFICIENTLY TO PREVENT DAMAGE, IT SHALL BE ROLLED WITH A ROLLER PROVIDING 1500 LBS. (680KG) PRESSURE PER SOFT.
  - CONTRACTOR TO REPAIR ALL DAMAGED AREAS TO THE SATISFACTION OF THE LANDSCAPE ARCHITECT AND/OR CLIENT.

- WATERING
- DURING THE WARRANTY PERIOD, BETWEEN MAY 15 AND SEPTEMBER 30 OF EACH YEAR, WATERING OF ALL PLANTS SHALL BE CARRIED OUT NO LESS THAN 6 TIMES PER YEAR IN ACCORDANCE WITH THE WATERING SCHEDULE TO BE DETERMINED BY THE OWNER UNLESS OTHERWISE STATED ON THE DRAWINGS. CRITICAL WATERING MONTHS ARE JUNE, JULY & AUGUST.
  - IF NO AUTOMATED IRRIGATION SYSTEM HAS BEEN PROVIDED FOR WATERING OPERATIONS, CONTRACTOR TO PROVIDE WATER TO THE SITE. F HOSE BIBS WITHIN THE BUILDING ENVELOPE ARE NOT AVAILABLE.
  - MANUAL WATERING SHOULD ENSURE DEEP WATERING OF TREES, SHRUBS, GROUND COVERS AND GRASSSED AREAS. WATERING OF GRASSSED AREAS TO COMMENCE ON A REGULAR BASIS AND CONTINUE WITH INTENSITY DEPENDING ON AMOUNT OF RAINFALL. NEW SOIL THAT HAS BEEN LAID SHOULD BE KEPT MOIST FOR 4-10 DAYS UNTIL IT HAS FIRMLY ROOTED INTO THE EXISTING SOIL.
  - ALL CONIFEROUS TREES SHALL BE WATERED IN LATE FALL, JUST PRIOR TO FREEZE-UP.
  - WATER SHALL BE APPLIED SO THAT THE WASHING OF THE SOIL OR DISLODGING OF MULCH OR TREE GUARDS DOES NOT OCCUR. DAMAGE SHALL BE IMMEDIATELY REPAIRED TO THE SATISFACTION OF THE OWNER AT NO ADDITIONAL COST.

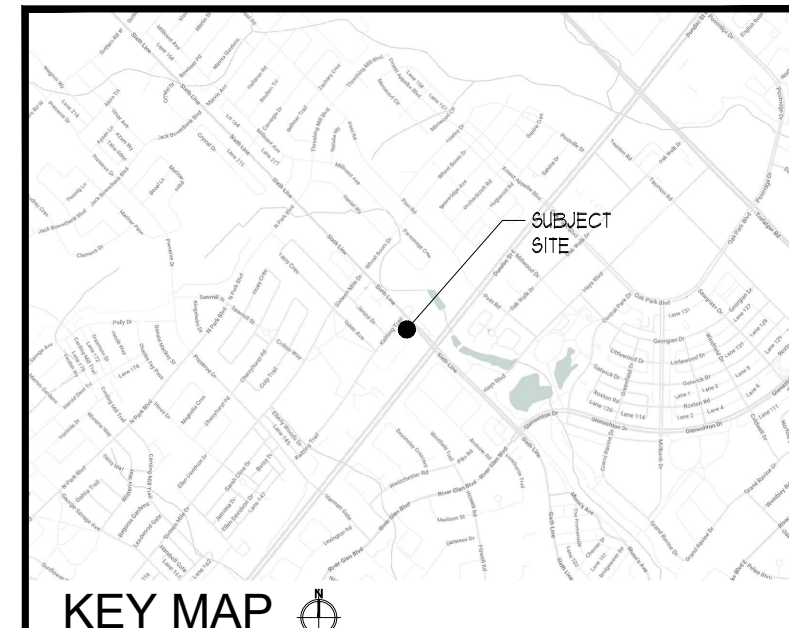

KEY MAP

CONTRACTOR TO VERIFY ALL PLANT MATERIAL ON DRAWING(S) AND PLANT MATERIAL LIST(S) REPORT ALL DISCREPANCIES AT TENDERING PROCESS.

CONTRACTOR TO VERIFY ALL PLANT MATERIAL ON DRAWING(S) AND PLANT MATERIAL LIST(S) REPORT ALL DISCREPANCIES AT TENDERING PROCESS.

CONTRACTOR TO VERIFY ALL PLANT MATERIAL ON DRAWING(S) AND PLANT MATERIAL LIST(S) REPORT ALL DISCREPANCIES AT TENDERING PROCESS.

RON KOUUDYS LANDSCAPE ARCHITECTS INC.

ALL DRAWINGS REMAIN THE PROPERTY OF THE LANDSCAPE ARCHITECT AND SHALL NOT BE REPRODUCED OR REUSED WITHOUT THE LANDSCAPE ARCHITECTS WRITTEN PERMISSION.

THIS DRAWING SHALL NOT BE USED FOR CONSTRUCTION OR TENDER PURPOSES UNLESS SIGNED AND DATED BY BARRY R. MURPHY, O.A.L.A. C.S.L.A. LANDSCAPE ARCHITECT, LONDON, ONTARIO (519) 667-3322.

DATE	DESCRIPTION	No.
2016-05-12	ISSUED FOR SPA	4
2016-05-08	ISSUED FOR REVIEW	3
2016-04-22	ISSUED FOR DRAFT	2
2016-04-13	ISSUED FOR REVIEW	1

PLOTTING INFORMATION:  
 PLOTTED DATE: 2016-05-12  
 PLOTTED SCALE: 1:1



PROJECT TITLE:  
 DUNDAS STREET WEST & SIXTH LINE  
 OAKVILLE, ON

DRAWING TITLE:  
 LANDSCAPE DETAILS

DATE: MAY 2016	SCALE: AS NOTED	DRAWING No.:
DRAWN: RKL/ Jkc	CHECKED BY: RJK	L-3
PROJECT No.:		