

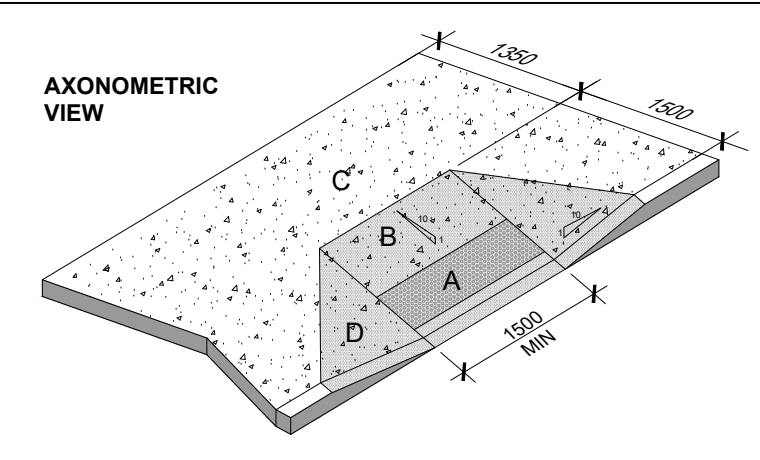

CURB RAMP DETAIL



- CURB RAMP MUST HAVE A MINIMUM CLEAR WIDTH OF 1500mm, EXCLUSIVE OF ANY FLARED SIDES.
- THE RUNNING SLOPE OF THE CURB MUST:
 - BE A MAX OF 1:8, WHERE ELEVATION IS LESS THAN 75mm, AND
 - BE A MAX OF 1:10, WHERE ELEVATION IS LESS THAN 75mm OR GREATER AND 200mm OR LESS.
- THE MAX SLOPE ON THE FLARED SIDE OF THE CURB RAMP MUST BE NO MORE THAN 1:10.
- CURB RAMP MUST HAVE A TACTILE WALKING SURFACE INDICATOR THAT:
 - HAVE RAISED TACTILE PROFILES COMPOSED OF TRIANGULAR DOMES,
 - HAVE A HIGH TONAL CONTRAST WITH THE ADJACENT SURFACE,
 - ARE LOCATED AT THE BOTTOM OF THE CURB RAMP,
 - ARE SET BACK BETWEEN 150mm AND 200mm FROM THE CURB EDGE,
 - EXTEND THE FULL WIDTH OF THE CURB RAMP,
 - ARE A MIN OF 610mm IN DEPTH, AND
 - BE SLIP-RESISTANT.

A TACTILE SURFACE / DETECTABLE HAZARD INDICATOR
150mm FROM EDGE OF CURB AND 610mm IN DEPTH

B SLOPE SURFACE @ 1:10 (max)

C LANDING / UNINTERRUPTED SPACE OF NOT LESS THAN 1100mm

D FLARED SIDES WITH MAX SLOPE OF 1:10

THE INFORMATION PROVIDED HERE WAS ASSEMBLED FROM **OMB 3.8.3.2**, AND **REG. 19111** INTEGRATED ACCESSIBILITY STANDARDS UNDER THE ACCESSIBILITY FOR ONTARIANS WITH DISABILITIES ACT, 2005 (updated JUL 2016).

TREE PROTECTION LEGEND (REFER TO ARBORIST DWGS)

- EXISTING TREE TO BE PROTECTED BY TPZ.
- EXISTING TREE TO BE REMOVED AND RELOCATED.
- TRANSPLANT LOCATION FOR REMOVED TREES.

TRAFFIC SIGNS SCHEDULE

| SIGN | COLOURS |
|------|---|
| | Ra-1 (600x600) WHITE REFL. LEGEND & BORDER, RED REFL. BACKGROUND. |
| | FR (300x450) BLACK LEGEND & BORDER, RED REFL. ANNUAL BAND AND INTERDICTIONARY STROKE, WHITE REFL. BACKGROUND. |
| | Rb-25 (600x750) BLACK SYMBOL & BORDER, WHITE REFL. BACKGROUND. |

TRAFFIC SIGNS LEGEND

- POST-MOUNTED SIGN
- POST-MOUNTED SIGN/ BACK TO BACK

KEY PLAN CITY OF OAKVILLE



LEGAL DESCRIPTION

PLAN OF SUBDIVISION OF PART OF LOTS 14 AND 15, CONCORDA-110N 2, NORTH OF DUNDAS STREET (GEOGRAPHIC TOWNSHIP OF TRAFALGAR) TOWN OF OAKVILLE REGIONAL MUNICIPALITY OF HALTON

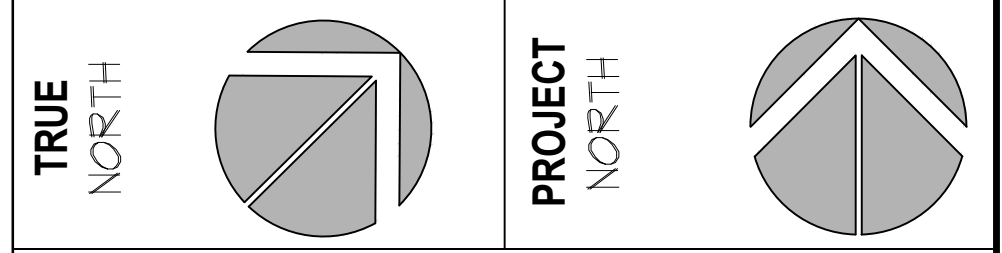

SITE STATISTICS

| ZONING | REQUIRED | PROVIDED |
|--|--|---------------|
| TOTAL SITE AREA | 77,682.75 m ² or 19.20 acres | |
| FRONT YARD SETBACK | 6.00 m | 18.51 m |
| EAST SIDE YARD SETBACK | 3.00 m | 36.46 m |
| WEST SIDE YARD SETBACK | 3.00 m | 38.45 m |
| REAR YARD SETBACK | 7.50 m | 13.46 m |
| BUILDING G.F.A. | | |
| BUILDING A | 16,600.30 m ² or 178,684 sq.ft. | |
| BUILDING B | 17,024.00 m ² or 183,245 sq.ft. | |
| TOTAL BUILDING G.F.A. | 33,624.30 m ² or 361,929 sq.ft. | |
| SITE COVERAGE | 33,624.30 m ² or 43.28% | |
| LANDSCAPED AREA (MIN 10%) | 8,194.76 m ² or 10.55% | |
| PAVED AREA | 35,863.69 m ² or 46.17% | |
| SNOW STORAGE AREA | SNOW TO BE REMOVED OFF SITE | |
| PARKING | REQUIRED | PROVIDED |
| WAREHOUSING LEASABLE AREA | | |
| BLDG A: 16,327.31 m ² | | |
| BLDG B: 16,864.71 m ² | | |
| TOTAL LEASABLE AREA > 5000m ² | 166 spaces | |
| 1 space / 200m ² = 33,192.02 / 200 = 166 | | |
| TOTAL | 166 spaces | 508 spaces |
| H/C PARKING SPACES (151 - 200 spaces = 6 required) (500+ spaces = 11 required) | 6 spaces | 15 spaces |
| LOADING SPACES | 4 spaces | 56 spaces |
| BIKE RACKS (2 bike spaces) | 6 bike racks | 21 bike racks |
| BIKE SPACES (7% of automobile spaces) | 12 spaces | 42 spaces |

SYMBOL LEGEND

- MAN DOOR LOCATIONS
- LOADING DOCK LOCATIONS
- DRIVE-IN OR OVERHEAD DOORS
- FIRE HYDRANT & VALVE
- CATCH BASIN
- DOUBLE CATCH BASIN
- SANITARY MANHOLE
- CATCH BASIN / MANHOLE
- STORM MANHOLE
- HYDRO POLE STANDARD / UTILITY POLE
- BICYCLE RING | 0.6m x 1.8m x 1.9m H.
- ACCERA-TIBLE PARKING SPACE | A & B TYPES
- LIGHT STANDARD (TYP)
- WALL MOUNTED LIGHT
- CURB RAMP (REF: CURB RAMP DETAIL)
- LOADING SPACE 9.0 m x 3.5 m x 4.2 m H
- CONC. FILLED STEEL BOLLARD
- FIRE DEPARTMENT/SIAMESE CONNECTION
- BARRIER FREE PARKING SIGN
- FIRE ROUTE SIGN < 30°-45° to line parallel to traffic flow mounted on a pole or mounted to building face.
- BUILDING LINE CLEAN OUT
- REFUSE STORAGE BINS TO BE STORED INTERNALLY AND REMOVED OFF-SITE BY PRIVATE CONTRACTORS

| No. | ISSUED | DATE |
|-----|-------------------------|-------------|
| 8 | ISSUED FOR PAC | NOV 25 2021 |
| 9 | ISSUED FOR REVIEW | JAN 5 2022 |
| 10 | ISSUED FOR SPA | MAR 14 2022 |
| 11 | SUBMITTED FOR SPA | APR 24 2022 |
| 12 | ISSUED FOR COORDINATION | NOV 28 2022 |

| No. | REVISION | DATE |
|-----|--------------------------------|-------------|
| 13 | RE-ISSUED FOR SPA | JAN 18 2023 |
| 14 | RE-ISSUED FOR MUNICIPAL REVIEW | MAY 5 2023 |
| 15 | RE-ISSUED FOR SPA | MAY 18 2023 |

| No. | REVISION | DATE |
|-----|------------------|-------------|
| 2 | REVISED AS NOTED | NOV 22 2021 |
| 3 | REVISED AS NOTED | NOV 23 2021 |
| 4 | REVISED AS NOTED | JAN 04 2022 |
| 5 | REVISED AS NOTED | JAN 06 2022 |
| 6 | REVISED AS NOTED | FEB 04 2022 |

| No. | REVISION | DATE |
|-----|---------------------------------|-------------|
| 7 | REVISED AS NOTED | FEB 01 2022 |
| 8 | REVISED AS NOTED | FEB 16 2022 |
| 9 | REVISED AS PER CIVIL | FEB 25 2022 |
| 10 | REVISED AS NOTED | OCT 26 2022 |
| 11 | REVISED AS NOTED | NOV 28 2022 |
| 12 | REVISED LIGHTING POLE LOCATIONS | JAN 10 2023 |

BALDASSARRA
Architects Inc.

30 Great Gulf Drive, Unit 20 | Concord ON | L4K 0K7
T. 905.660.0722 | www.baldassarra.ca

OWNERS INFORMATION:

North Oakville
Block 6

45 & 55 WILLIAM HALTON PARKWAY E.
Oakville, ON

Site Plan

DATE: MAR. 2022 DRAWN BY: MM CHECKED BY: MB SCALE: 1:600
PROJECT No. DRAWING No.

21-49 **A-1.0**

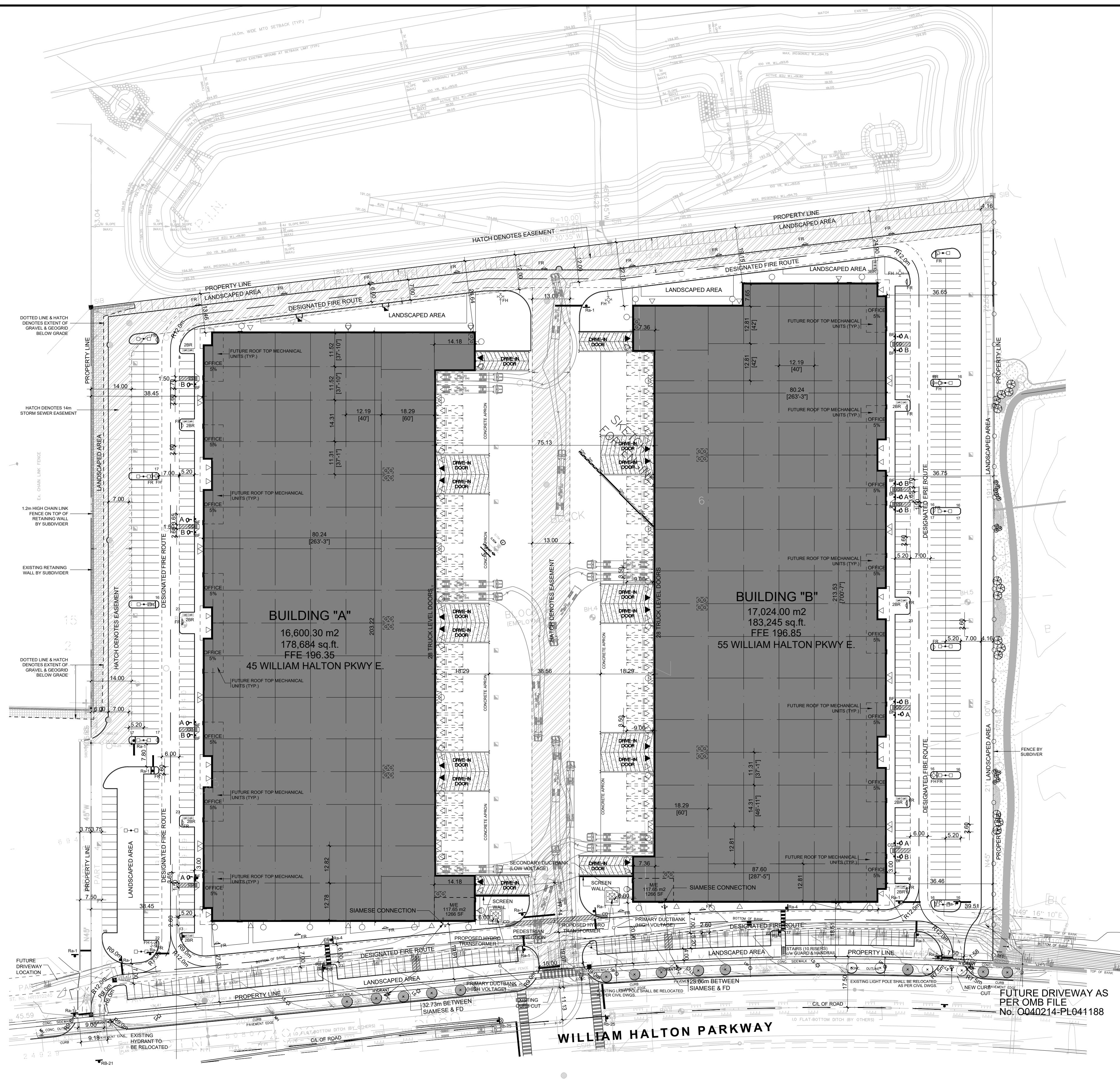

CURB RAMP DETAIL

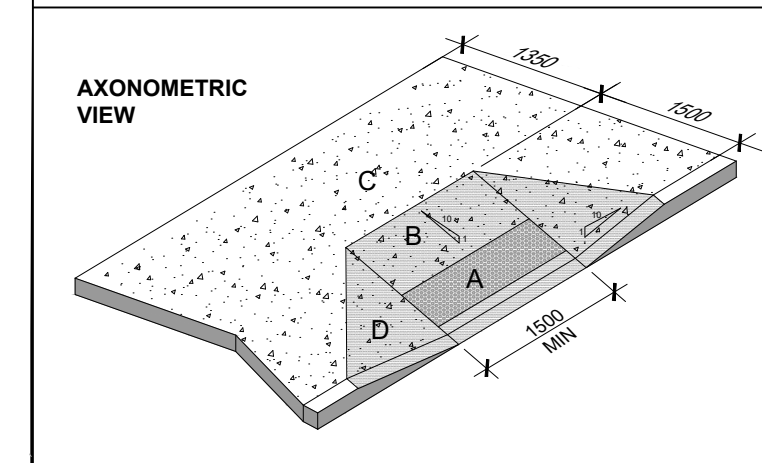

- CURB RAMP MUST HAVE A MINIMUM CLEAR WIDTH OF 1000mm, EXCLUSIVE OF ANY FLARED SIDES.
- THE RUNNING SLOPE OF THE CURB MUST:
 - BE A MAX OF 1:8, WHERE ELEVATION IS LESS THAN 75mm, AND
 - BE A MAX OF 1:10, WHERE ELEVATION IS LESS THAN 75mm OR GREATER AND 200mm OR LESS.
- THE MAX SLOPE ON THE FLARED SIDE OF THE CURB RAMP MUST BE NO MORE THAN 1:10.
- CURB RAMP MUST HAVE A TACTILE WALKING SURFACE INDICATOR THAT:
 - HAVE RAISED TACTILE PROFILES COMPOSED OF TRUNCATED DOMES,
 - HAVE A HIGH TONAL CONTRAST WITH THE ADJACENT SURFACE,
 - ARE LOCATED AT THE BOTTOM OF THE CURB RAMP,
 - ARE SET BACK BETWEEN 150mm AND 200mm FROM THE CURB EDGE,
 - EXTEND THE FULL WIDTH OF THE CURB RAMP,
 - ARE A MIN OF 610mm IN DEPTH, AND
 - BE SURF-RESISTANT.

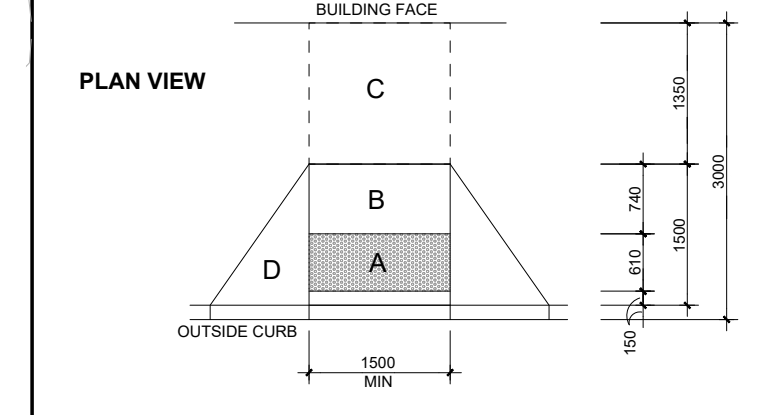

- A** TACTILE SURFACE / DETECTABLE HAZARD INDICATOR 150mm FROM EDGE OF CURB AND 610mm IN DEPTH
- B** SLOPE SURFACE @ 1:10 (max)
- C** LANDING / UNINTERRUPTED SPACE OF NOT LESS THAN 1100mm
- D** FLARED SIDES WITH MAX SLOPE OF 1:10

THE INFORMATION PROVIDED HERE WAS ASSEMBLED FROM OBC 3.3.3.2 AND O. REG. 1911.11. INTEGRATED ACCESSIBILITY STANDARDS UNDER THE ACCESSIBILITY FOR ONTARIANS WITH DISABILITIES ACT, 2005 UPDATED JUL 2018.

TREE PROTECTION LEGEND (REFER TO ARBORIST DWGS)

- EXISTING TREE TO BE PROTECTED BY TPZ.
- EXISTING TREE TO BE REMOVED AND RELOCATED.
- TRANSPLANT LOCATION FOR REMOVED TREES.

TRAFFIC SIGNS SCHEDULE

| SIGN | COLOURS | REQUIRED | PROVIDED |
|------|---|--------------|---------------|
| | Ra-1 (600x600) WHITE REFL. LEGEND & BORDER. RED REFL. BACKGROUND. | 166 spaces | 508 spaces |
| | FR (300x450) BLACK LEGEND & BORDER. RED REFL. ANNULAR BAND AND INTERDICTIONAL STROKE. WHITE REFL. BACKGROUND. | 6 spaces | 15 spaces |
| | Rb-25 (600x750) BLACK SYMBOL & BORDER. WHITE REFL. BACKGROUND. | 4 spaces | 56 spaces |
| | | 6 bike racks | 21 bike racks |
| | | 12 spaces | 42 spaces |

TRAFFIC SIGNS LEGEND

- POST-MOUNTED SIGN
- POST-MOUNTED SIGN/ BACK TO BACK

KEY PLAN CITY OF OAKVILLE

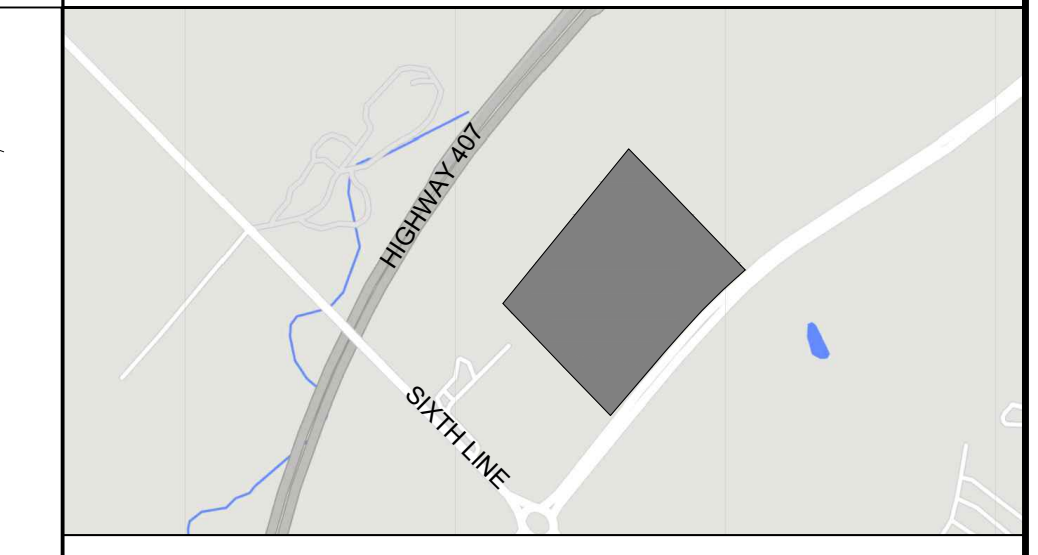

LEGAL DESCRIPTION

PLAN OF SUBDIVISION OF PART OF LOTS 14 AND 15, CONCERNA-1ION 2 NORTH OF DUNDAS STREET (GEOGRAPHIC TOWNSHIP OF TRAFALGAR) TOWN OF OAKVILLE REGIONAL MUNICIPALITY OF HALTON

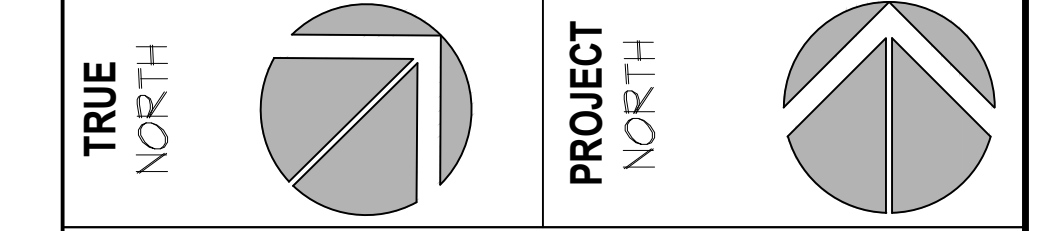

SITE STATISTICS

| TOTAL SITE AREA | 77,682.75 m ² | or | 19.20 acres |
|--|---|----|----------------|
| ZONING | REQUIRED | | PROVIDED |
| FRONT YARD SETBACK | 6.00 m | | 18.51 m |
| EAST SIDE YARD SETBACK | 3.00 m | | 36.46 m |
| WEST SIDE YARD SETBACK | 3.00 m | | 38.45 m |
| REAR YARD SETBACK | 7.50 m | | 13.46 m |
| BUILDING G.F.A. | | | |
| BUILDING A | 16,600.30 m ² | or | 178,684 sq.ft. |
| BUILDING B | 17,024.00 m ² | or | 183,245 sq.ft. |
| TOTAL BUILDING G.F.A. | 33,624.30 m ² | or | 361,929 sq.ft. |
| SITE COVERAGE | 33,624.30 m ² | or | 43.28% |
| LANDSCAPED AREA (MIN 10%) | 8,194.76 m ² | or | 10.55% |
| PAVED AREA | 35,863.69 m ² | or | 46.17% |
| SNOW STORAGE AREA | SNOW TO BE REMOVED OFF SITE | | |
| PARKING | REQUIRED | | PROVIDED |
| WAREHOUSING LEASABLE AREA | | | |
| BLDG A: 16,327.31 m ² | | | |
| BLDG B: 16,864.71 m ² | | | |
| TOTAL LEASABLE AREA > 5000m ² | 1 space / 200m ² = 33,192.02 / 200 = 166 | | 166 spaces |
| H/C PARKING SPACES (151 - 200 spaces = 6 required) (500+ spaces = 11 required) | 6 spaces | | 15 spaces |
| LOADING SPACES | 4 spaces | | 56 spaces |
| BIKE RACKS (2 bike spaces) | 6 bike racks | | 21 bike racks |
| BIKE SPACES (7% of automobile spaces) | 12 spaces | | 42 spaces |

SYMBOL LEGEND

| | |
|--|---|
| | MAN DOOR LOCATIONS |
| | LOADING DOCK LOCATIONS |
| | DRIVE-IN OR OVERHEAD DOORS |
| | FIRE HYDRANT & VALVE |
| | CATCH BASIN |
| | DOUBLE CATCH BASIN |
| | SANITARY MANHOLE |
| | CATCH BASIN / MANHOLE |
| | STORM MANHOLE |
| | HYDRO POLE STANDARD / UTILITY POLE |
| | BICYCLE RING 0.6m x 1.8m x 1.9m H. |
| | ACCER-a-IBLE PARKING SPACE A & B TYPES |
| | LIGHT STANDARD (TYP) |
| | WALL MOUNTED LIGHT |
| | CURB RAMP (REF: CURB RAMP DETAIL) |
| | LOADING SPACE 9.0 m x 3.5 m x 4.2 m H |
| | CONC. FILLED STEEL BOLLARD |
| | FIRE DEPARTMENT/SIAMESE CONNECTION |
| | BARRIER FREE PARKING SIGN |
| | FIRE ROUTE SIGN < 30°-45° to line parallel to traffic flow mounted on a pole or mounted to building face. |
| | BUILDING LINE CLEAN OUT |
| | REFUSE STORAGE BINS TO BE STORED INTERNALLY AND REMOVED OFF-SITE BY PRIVATE CONTRACTORS |

| No. | ISSUED | DATE |
|-----|-------------------|---------------|
| 1 | ISSUED FOR REVIEW | JAN. 6, 2022 |
| 2 | ISSUED FOR SPA | MAR. 14, 2022 |
| 3 | SUBMITTED FOR SPA | APR. 29, 2022 |
| 4 | RE-ISSUED FOR SPA | JAN. 18, 2023 |
| 5 | RE-ISSUED FOR SPA | MAY 18, 2023 |

| No. | REVISION | DATE |
|-----|----------|------|
| | | |

BALDASSARRA
Architects Inc.

30 Great Gulf Drive, Unit 20 | Concord ON | L4K 0K7
T. 905.660.0722 | www.baldassarra.ca

OWNERS INFORMATION:

North Oakville
Block 6

45 & 55 WILLIAM HALTON PARKWAY E.
Oakville, ON

Site Plan
Overall

| DATE: | DRAWN BY: | CHECKED: | SCALE: |
|----------|-----------|----------|--------|
| MAR 2022 | MM | MB | 1:750 |

| PROJECT No. | DRAWING No. |
|-------------|-------------|
| 21-49 | A-1.1 |