

KEY PLAN
N.T.S.

PLANT LIST

Botanical Name	Common Name	Qty.	Cal.	Ht. Spr.	Cond.
TREES					
<i>Acer x freemanii</i>	Freeman Maple	2		60mm	B&B or WB
<i>Acer saccharum</i>	Sugar Maple	6		60mm	B&B or WB
<i>Celtis occidentalis</i>	Common Hackberry	2		60mm	B&B or WB
<i>Gleditsia triacanthos var. inermis 'Skyline'</i>	Skyline Honeylocust	4		60mm	B&B or WB
<i>Prunus serotina</i>	Black Cherry	4		60mm	B&B or WB
<i>Quercus macrocarpa</i>	Burr Oak	5		60mm	B&B or WB
<i>Quercus rubra</i>	Red Oak	11		60mm	B&B or WB
SHRUBS					
<i>Clethra alnifolia 'Hummingbird'</i>	Hummingbird Summersweet	86			
<i>Cornus sericea 'Arctic Fire'</i>	Arctic Fire Dogwood	128		60cm ht.	Pot
<i>Diervilla lonicera</i>	Bush Honeysuckle	52		60cm ht.	Pot
<i>Juniperus sabina 'Blue Danube'</i>	Blue Danube Juniper	110		60cm ht.	Pot
<i>Physocarpus opulifolius 'Diabolo'</i>	Diabolo Ninebark	52		60cm ht.	Pot
<i>Thuja occidentalis 'Holmstrup'</i>	Holmstrup Cedar	3		60cm ht.	Pot
PERENNIALS, GRASSES, AND GROUND COVER					
<i>Anemone canadensis</i>	Canada Anemone	147			1 g pot
<i>Calamagrostis acutiflora 'Karl Foerster'</i>	Feather Reed Grass	18			1 g pot
<i>Crocus x 'Lucifer'</i>	Monbretia	54			1 g pot
<i>Nepeta faassenii 'Purrsain Blue'</i>	Purrsain Blue Catmint	67			1 g pot
<i>Symphotrichum novae-angliae</i>	New England Aster	114			1 g pot

NOTES:

- Plant material to conform to the Canadian Nursery Trades association metric Guide Specifications for Nursery Stock, latest edition.
- Contractor to verify quantities listed: plant quantities to be supplied as shown in plan in case of discrepancies between plan and quantities listed.
- All plant material to be sourced from nurseries with an 800km radius.
- Provide 2 year warranty for all plant material.

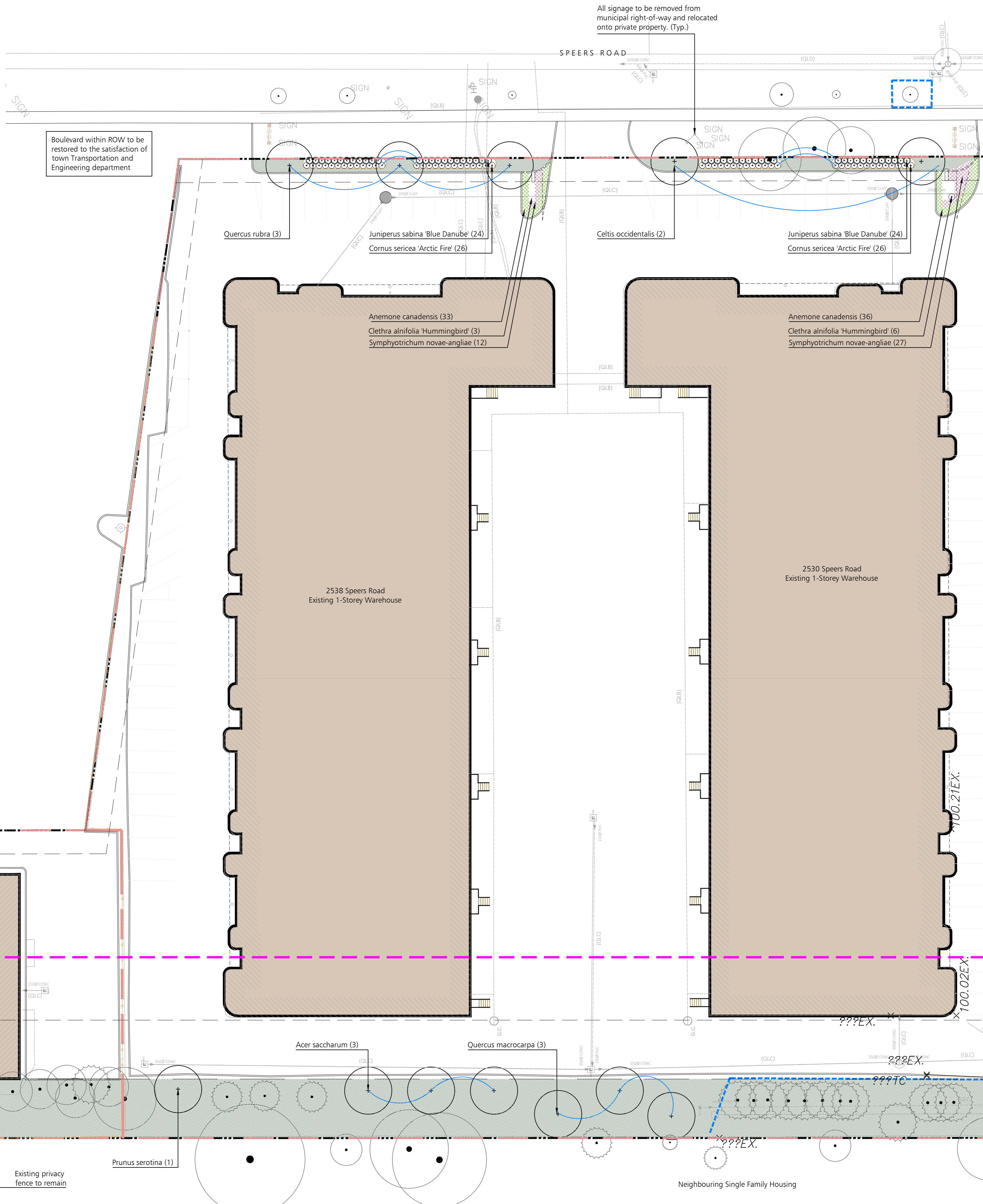
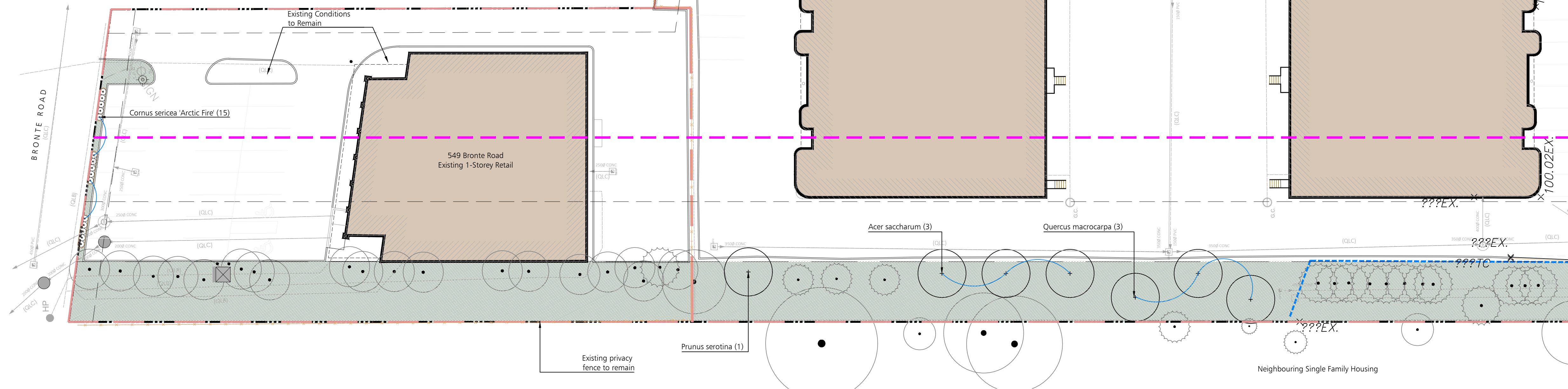

LANDSCAPE PLAN A
1:300



Pearce McCluskey Architects
2203 Durwin Drive • Mississauga, Ontario L5L 1X2
www.pmarchitects.ca L905.807.2444



BTi
Landscape Architecture | Site Design



This drawing is not to be used for construction unless signed by partner in charge.

Contractors must verify all dimensions and be responsible for same. Report any discrepancies to the architect before commencing the work.

Prints are not to be scaled.

All drawings and related documents are the sole copyright property of the architects and must be returned upon request. Any reproduction of drawings and related documents in part or in whole is forbidden without the architects written permission.

detail number key to details
sheet number



SOUTHDOWN BUILDERS LIMITED
OWNER:
SOUTH DOWN BUILDERS LIMITED
2041 Avenue Road
Toronto | Ontario | M5M 4A5

APPLICANT:

Site Plan Application File No.
Town of Oakville - SPA-2022-XXXX

LEGEND

- Existing Tree to Remain
- Proposed Trees
- Existing Tree to be Removed
- Property Line
- Tree Protection Hoarding
- 1.8m ht. Wood Screen Fence - Heavy Duty
- Proposed Evergreen Shrubs
- Proposed Deciduous Shrubs
- 150 mm min compacted depth Topsoil Finegrade & Sod
- Existing Sod
- Ornamental Grasses
- Seeded area
- Mulch
- Perennials
- Concrete Paving
- Bike Ring

Speers Road
Redevelopment

2538, 2530, 2526 Speers Road
Oakville, Ontario

LANDSCAPE
PLAN A

Project Number:

21067

Drawn By: AS, JW
Checked By: MT
Date: Apr. 21, 2023 Issued for SPA
Scale: As Shown
Sheet Number:

L.2