

**SCHEDULE 1
TREE PROTECTION BARRIER**

OAKVILLE

Tree Protection Barriers

- Tree protection barriers must be 1.2m (4ft) high, waferboard hoarding or an equivalent approved by Urban Forestry Services.
- Tree protection barriers for trees situated on the Town road allowance where visibility must be maintained can be 1.2m (4ft.) high and consist of plastic web snow fencing on a wood frame made of 2"x 4"s.
- Where some excavate or fill has to be temporarily located near a tree protection barrier, plywood must be used to ensure no material enters the Tree Protection Zone.
- All supports and bracing should be outside the Tree Protection Zone. All such supports should minimize damaging roots outside the Tree Protection Barrier.
- No construction activity, grade changes, surface treatment or excavations of any kind is permitted within the Tree Protection Zone.

DETAIL TP-1

A minimum of 1.5 M of well drained soil depth is required for the growth of a tree to maturity. A tree's root system grows mainly within the top 60 cm of the surface and extends outward 2 to 3 times the dripline dimension. The root system of a tree has three main parts: The large "anchor roots" providing structural support; a framework of "transport roots"; and a complex network of "feeder roots" that grow outward and upward from the transport roots. These non-woody roots branch out to form fans of thousands of slender roots with fine root hairs. These tiny roots provide the major portion of the absorption surface of a tree's root system.

Note: Graphic and technical information supplied by the City of Toronto, Urban Forestry Services.

The Crown and Root Structure of a Tree in an Optimum Growing Environment

Name: _____
Date: November 2016
Scale: N.T.S.
File No: _____

OAKVILLE

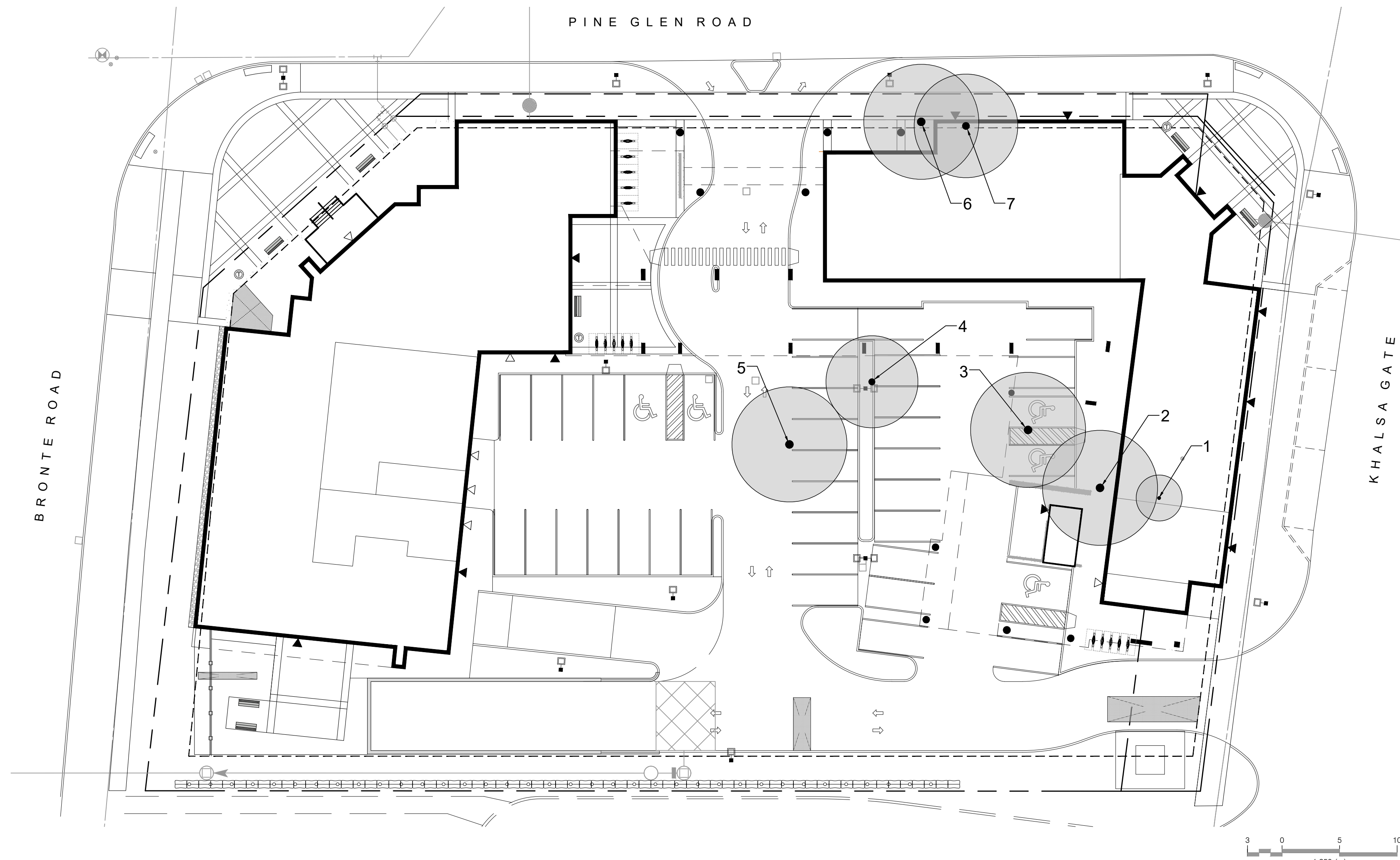

TREE MANAGEMENT NOTES - GENERAL

- THE PREPARATION OF THE TREE PRESERVATION PLAN HAS BEEN COORDINATED WITH THE PREPARATION OF THE GRADING CONTROL PLAN AND EROSION & SEDIMENT CONTROL PLAN. THE PLANS HAVE BEEN REVIEWED BY THE LANDSCAPE ARCHITECT AND ENGINEERING CONSULTANTS. THE RELEVANT FEATURES OF THESE PLANS ARE IN CONFORMITY WITH EACH OTHER.
- NO SERVICING, GRADING OR OTHER CONSTRUCTION ACTIVITY IS TO BEGIN UNTIL THE INSTALLATION OF THE TREE PROTECTION FENCING AND ANY OTHER PROTECTION MEASURES HAVE BEEN CERTIFIED BY THE LANDSCAPE ARCHITECT. PROTECTION FENCING SHALL NOT BE ALTERED OR RELOCATED UNLESS AUTHORIZED IN WRITING BY THE LANDSCAPE ARCHITECT.
- IT IS THE RESPONSIBILITY OF THE CONTRACTOR TO ENSURE THAT THEY ARE AWARE OF ALL MEASURES BEING TAKEN TO PROTECT ALL TREES IDENTIFIED.
- ALL DAMAGE TO TREES WILL BE REPORTED TO THE CONSULTANT IMMEDIATELY BY THE CONTRACTOR'S FOREPERSON.
- FOR SILT FENCING DETAILS REFER TO EROSION AND SEDIMENT CONTROL PLAN BY LANHACK CONSULTANTS INC. / S. LLEWELLYN & ASSOCIATES LTD.
- FOR SERVICING AND GRADING INFORMATION, REFER TO DRAWINGS BY LANHACK CONSULTANTS INC. / S. LLEWELLYN & ASSOCIATES LTD.

Tree Inventory-Table 1 (Updated from inventory completed on January 26th, 2017)

Site Date: Dec.11, 2017
Field Personnel: GSP Group- Richard Turner, Justin Whalen

Tree #	Botanical Name	Common Name	Stems	DBH	Crown Dia.	Condition	Comments	Environment	Recommendations
1	Acer negundo	Manitoba Maple	1	300	4	Fair	Irregular canopy	Co-Dominant	Remove (Construction)
2	Fraxinus americana	Ash	1	400	8	Poor	Emerald Ash Borer	Co-Dominant	Remove (Construction)
3	Acer saccharinum	Silver Maple	1	400	12	Fair	Irregular canopy	Co-Dominant	Remove (Construction)
4	Acer saccharinum	Silver Maple	1	350	10	Fair	Uniform Specimen	Dominant	Remove (Construction)
5	Fraxinus americana	Ash	1	300	10	Poor	Emerald Ash Borer	Dominant	Remove (Construction)
6	Acer saccharinum	Silver Maple	1	400	10	Good	Irregular canopy	Co-Dominant	Remove (Construction)
7	Acer saccharum	Sugar Maple	1	350	10	Good	Uniform Specimen	Co-Dominant	Remove (Construction)

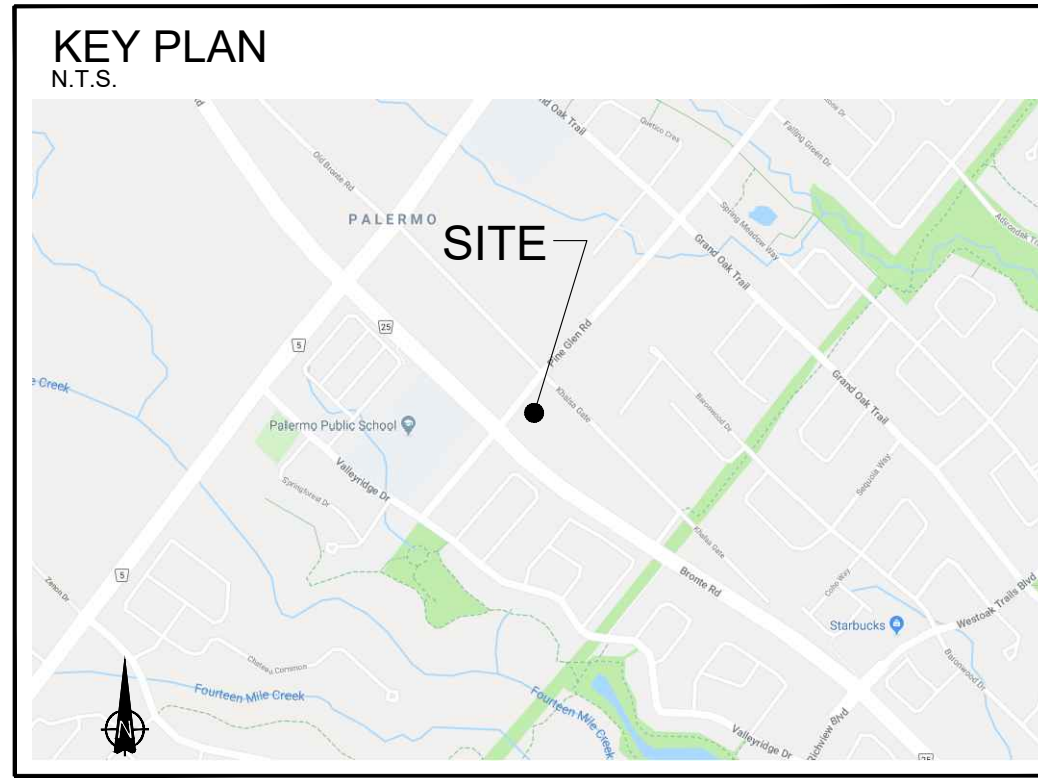

Legend

- EXISTING TREE TO REMAIN
- EXISTING TREE TO BE REMOVED
- 23 TREE TAG NUMBER
- PROJECT BOUNDARY

- GENERAL NOTES:**
- DRAWINGS NOT TO BE USED FOR CONSTRUCTION UNLESS AUTHORIZED BY THE LANDSCAPE ARCHITECT
 - CONTRACTOR SHALL REPORT ANY DISCREPANCIES BETWEEN THE DRAWINGS AND SITE CONDITIONS PRIOR TO COMMENCEMENT OF THE WORK
 - ALL UTILITY LOCATES ARE THE RESPONSIBILITY OF THE CONTRACTOR. HAND DIG WITHIN THE LIMITS RECOMMENDED BY THE SERVICE UTILITY. UTILITY CONFLICTS WITH PROPOSED TREE LOCATIONS MUST BE REPORTED IMMEDIATELY TO THE LANDSCAPE ARCHITECT
 - BASE DRAWING PROVIDED BY KNYMH INC.
 - FOR GRADING INFORMATION REFER TO DRAWING BY LLEWELLYN & ASSOCIATES LTD. FOR SERVICING INFORMATION REFER TO DRAWINGS BY S. LLEWELLYN & ASSOCIATES LTD.
 - LANDSCAPE DRAWINGS SHOW ENGINEERING INFORMATION FOR DESIGN PURPOSES ONLY. DO NOT CONSTRUCT ENGINEERING WORKS FROM THESE DRAWINGS.

**VEGETATION
MANAGEMENT PLAN**
2418 KHALSA GATE
OAKVILLE, ON.

ISSUED FOR SITE PLAN APPROVAL, NOT FOR CONSTRUCTION.

DATE	ISSUED FOR	BY
Jan 30, 2018	Issued for Review	JW
Feb 23, 2018	Issued for Review	JW
Mar 21, 2018	Issued for SPA	JW

DATE	REVISIONS	BY

GSP group

20-72 Victoria Street South
Richmond Hill, Ontario L4B 1K4
T 905 882 5199
F 905 882 5198

162 Louisa Street South, Suite 200
Hamilton, Ontario L8R 4A8
T 905 572 1477
F 905 572 1478

www.gspgroup.ca

Date: March 14, 2018
Scale: 1:200

Drawn By: JW
Project No.: 17251

0.01

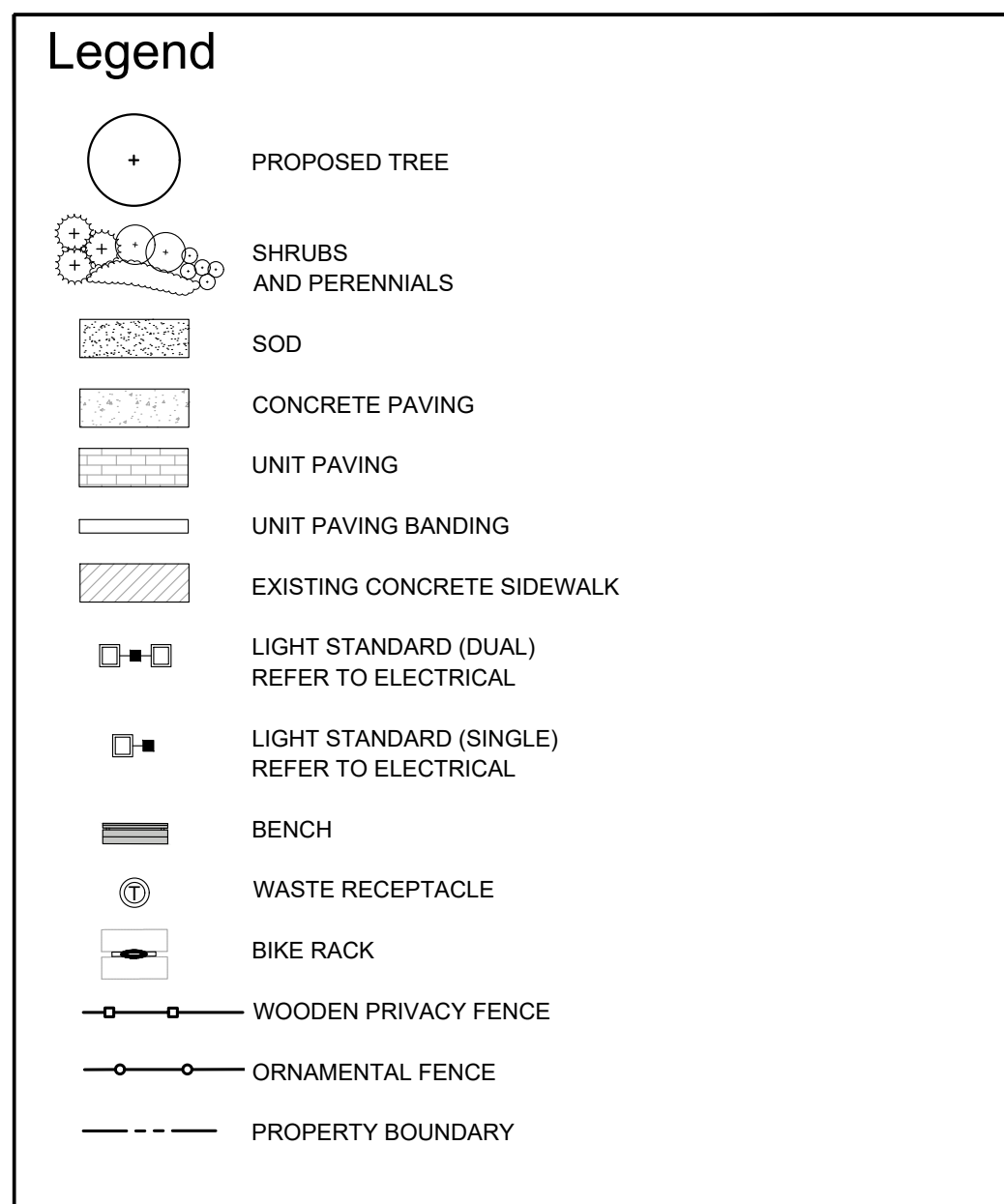
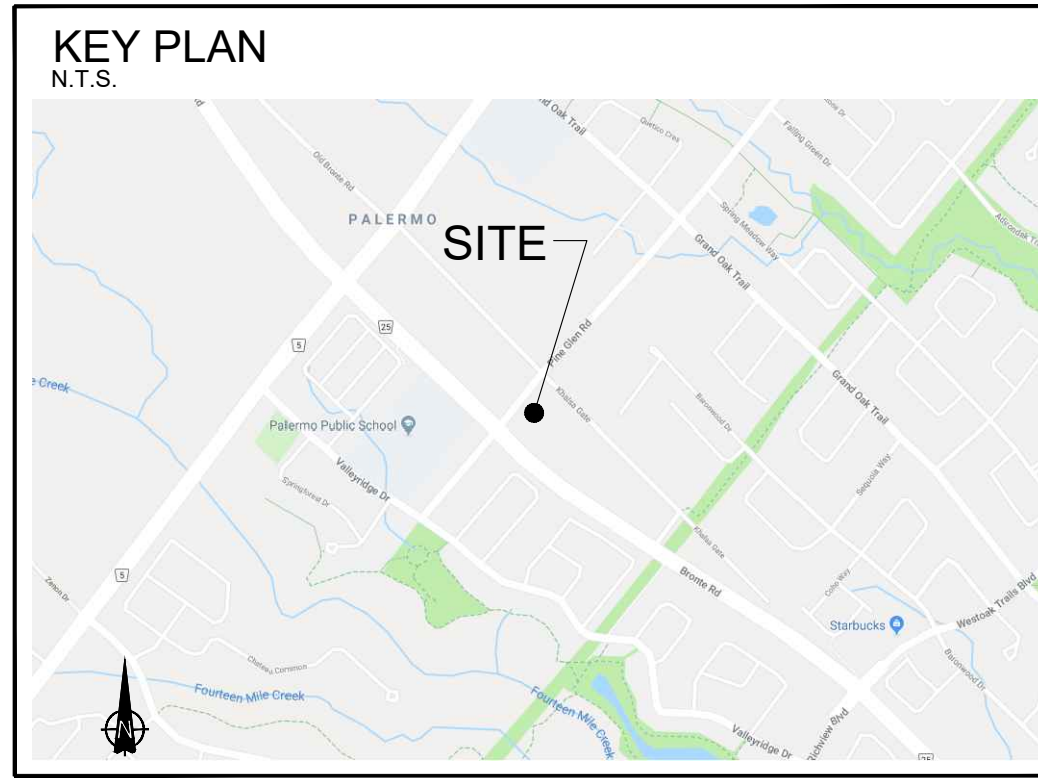
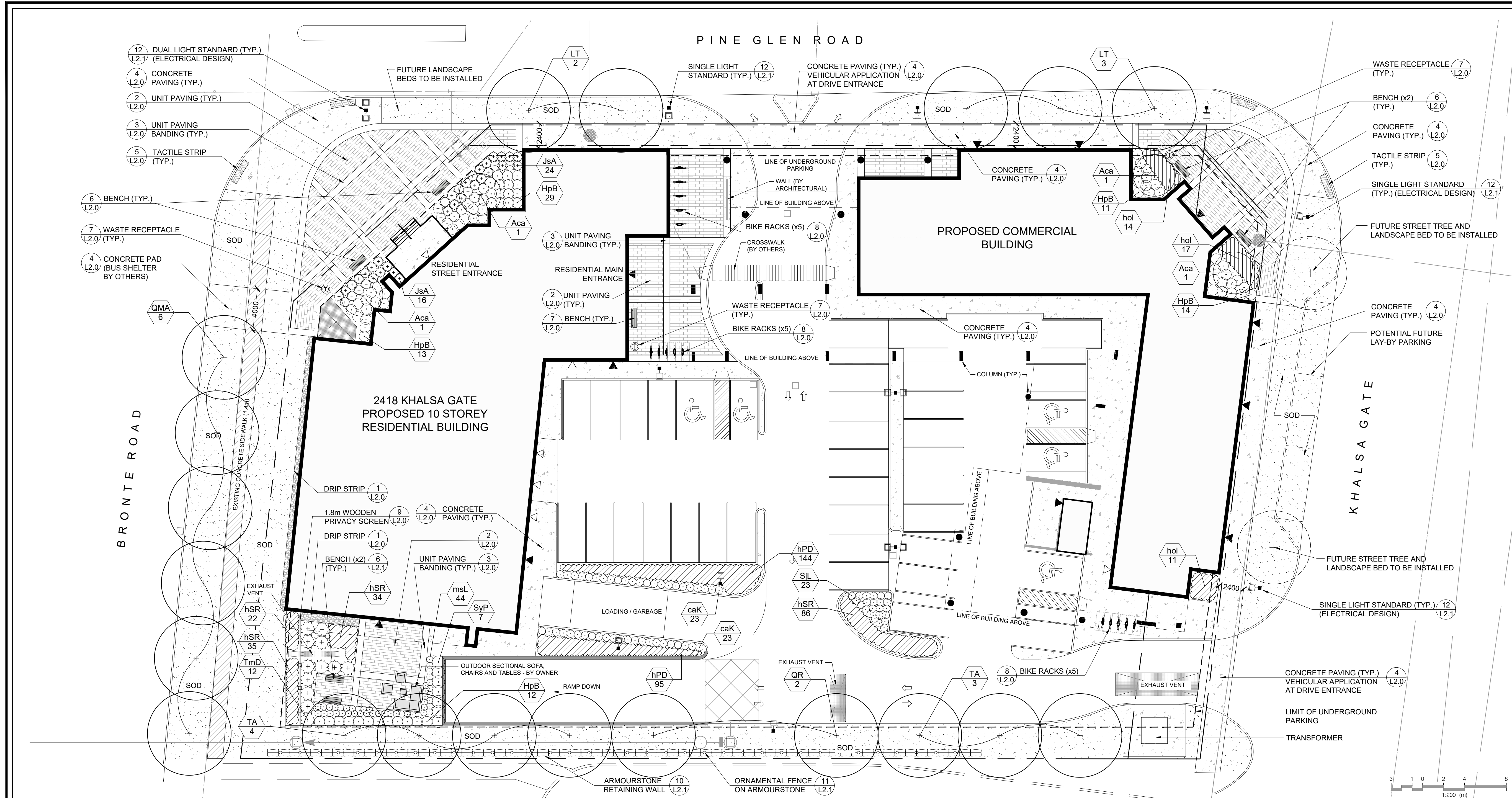

GENERAL NOTES:

- DRAWINGS NOT TO BE USED FOR CONSTRUCTION UNLESS AUTHORIZED BY THE LANDSCAPE ARCHITECT
- CONTRACTOR SHALL REPORT ANY DISCREPANCIES BETWEEN THE DRAWINGS AND SITE CONDITIONS PRIOR TO COMMENCEMENT OF THE WORK
- ALL UTILITY LOCATES ARE THE RESPONSIBILITY OF THE CONTRACTOR. HAND DIG WITHIN THE LIMITS RECOMMENDED BY THE SERVICE UTILITY. UTILITY CONFLICTS WITH PROPOSED TREE LOCATIONS MUST BE REPORTED IMMEDIATELY TO THE LANDSCAPE ARCHITECT
- BASE DRAWING PROVIDED BY KNYMH INC.
- FOR GRADING INFORMATION REFER TO DRAWING BY LLEWELLYN & ASSOCIATES LTD. FOR SERVICES INFORMATION REFER TO DRAWINGS BY S. LLEWELLYN & ASSOCIATES LTD.
- LANDSCAPE DRAWINGS SHOW ENGINEERING INFORMATION FOR DESIGN PURPOSES ONLY. DO NOT CONSTRUCT ENGINEERING WORKS FROM THESE DRAWINGS.

STREETSCAPE AND LANDSCAPE PLAN

2418 KHALSA GATE
OAKVILLE, ON.

ISSUED FOR SITE PLAN APPROVAL, NOT FOR CONSTRUCTION.

DATE	ISSUED FOR	BY
Jan 30, 2018	Issued for Review	JW
Feb 23, 2018	Issued for Review	JW
Mar 21, 2018	Issued for SPA	JW

DATE	REVISIONS	BY

201-721-1000
102 Lakeshore Blvd. Suite 200
North York, Ontario M2N 6L6
T 416 593-8883 F 416 593-8883

www.gspgroup.ca

Date: March 14, 2018
Scale: 1:200
Drawn By: JW
Project No.: 17251

PLANTING NOTES:

- ALL PLANT MATERIAL SHALL BE NO 1 NURSERY GROWN, MEETING SPECIFICATIONS FOR SIZE, HEIGHT, SPREAD, GRADING, QUALITY, METHOD OF CULTIVATION, AND BALLING AND BURLAP SPECIFICATIONS AS SET OUT IN THE LATEST EDITION OF THE GUIDE SPECIFICATION FOR NURSERY STOCK PREPARED BY THE CNLA.
- NO SUBSTITUTIONS IN SPECIES, CULTIVAR, QUANTITY, SIZE OR CONDITION WILL BE PERMITTED WITHOUT THE WRITTEN APPROVAL OF THE CONSULTANT. ANY UNAPPROVED SUBSTITUTED MATERIAL WILL BE REQUIRED TO BE REMOVED FROM THE SITE AT THE EXPENSE OF THE CONTRACTOR.
- ANY INCONSISTENCIES FOUND IN THE QUANTITIES AS SHOWN ON THE PLAN AND THE PLANT LIST SHALL BE IMMEDIATELY REPORTED TO THE CONSULTANT.
- LAYOUT SHALL BE THE RESPONSIBILITY OF THE CONTRACTOR. LAYOUT, PLANT STAKE-OUT AND DELIVERED PLANT MATERIAL SHALL BE APPROVED BY THE CONSULTANT PRIOR TO INSTALLATION.
- NATIVE OR IMPORTED TOPSOIL SHALL BE TESTED AS SPECIFIED AND APPROVED BY THE CONSULTANT PRIOR TO ADDING ANY AMENDMENTS AND PLACEMENT. PLANTING MIX, WHERE INDICATED, SHALL FOLLOW THE MIX SPECIFICATIONS.
- PROVIDE 450MM MINIMUM DEPTH OF APPROVED TOPSOIL OR PLANTING MIX IN ALL BEDS, UNLESS OTHERWISE NOTED. ALL BEDS SHALL BE MULCHED WITH APPROVED MULCH TO A MINIMUM DEPTH OF 100MM, UNLESS OTHERWISE NOTED. DEPTHS SHALL BE THOSE ACHIEVED UNDER LIGHT COMPACTION. AREAS TO BE SODDED OR SEEDED SHALL BE PROVIDED WITH 150 MM OF APPROVED TOPSOIL, COMPACTED TO 85% SPD.
- NO BARE-ROOT PLANTING SHALL BE PERMITTED BETWEEN MAY 15 AND OCTOBER 15.
- PLANT MATERIAL SHALL BE THOROUGHLY WATERED AT THE TIME OF PLANTING.
- THOSE AREAS NOT SPECIFICALLY IDENTIFIED FOR PLANTING, OR OTHERWISE NOTED, SHALL BE SODDED. SODDING SHALL BE MAINTAINED AND WARRANTED UNTIL FIRST CUT. SEEDING SHALL BE MAINTAINED AND WARRANTED UNTIL OCTOBER 1 FOR SPRING SEEDING AND JUNE 1 FOR FALL SEEDING.
- ALL TREES AND SHRUBS SHALL BE UNDER WARRANTY FOR A PERIOD OF 24 MONTHS COMMENCING ON THE DATE OF ACCEPTANCE.
- THE CONTRACTOR SHALL PROVIDE MAINTENANCE IMMEDIATELY AFTER THE PLANTS ARE INSTALLED AND CONTINUE THROUGHOUT THE ENTIRE WARRANTY PERIOD. MAINTENANCE REQUIREMENTS SHALL INCLUDE ALL PROCEDURES CONSISTENT WITH PROPER HORTICULTURAL PRACTICES TO ENSURE NORMAL, VIGOROUS, AND HEALTHY GROWTH OF ALL MATERIAL PLANTED. ALL STAKES, WIRE, HOSE, AND OTHER ACCESSORIES MUST BE REMOVED PRIOR TO FINAL WARRANTY INSPECTION.
- ALL PLANT MATERIAL USED AS REPLACEMENTS FOR UNACCEPTABLE MATERIAL SHALL BE OF THE SAME QUALITY AND REQUIREMENTS PRESCRIBED FOR THE ORIGINAL MATERIAL. REPLACEMENTS SHALL BE MADE ONCE UNDER THE WARRANTY.

GROWING MEDIUM NOTES:

- GROWING MEDIUM TESTING:**
 - GROWING MEDIUMS (TOPSOIL, PLANTING MIXES) AND ORGANIC AMENDMENTS MUST BE TESTED BY AN OMAFRA ACCREDITED AGENCY AND APPROVED PRIOR TO USE. TEST TOPSOIL FOR P, K, CA AND MG, MINOR ELEMENT VALUES, SOLUBLE SALT CONTENT, ORGANIC MATTER, TEXTURE AND PH VALUE APPROPRIATE FOR THE ESTABLISHMENT AND GROWTH OF ORNAMENTAL NURSERY STOCK. SUBMIT TEST RESULTS AND ANALYSIS INCLUDING RECOMMENDATIONS FOR AMENDMENTS AND FERTILIZER TO THE CONSULTANT.
- TOPSOIL:**
 - TOPSOIL SHALL BE FERTILE, FRIABLE, TOPSOIL, FREE OF: FRAGMENTS LARGER THAN 75MM IN SIZE; STONES OVER 30MM IN DIAMETER; DEBRIS; PLANTS OR THEIR ROOTS; STICKS; NOXIOUS SEED PLANTS; STOLONS; SEEDS; SALTS; SOIL STERILANTS; CHEMICAL CONTAMINANTS; OR OTHER MATERIALS DETRIMENTAL TO PLANT GROWTH.
 - FERTILIZER AND AMENDMENTS: MUST BE MADE AS PER SOIL TESTING AGENCY RECOMMENDATIONS.
 - ALL TOPSOIL FOR THE INTENSIVE USE LAWN AREAS SHALL BE SANDY LOAM CLASS ONLY.
 - TOPSOIL: SHALL NOT BE MOVED, DELIVERED OR WORKED ON WHILE IN A FROZEN STATE OR CONDITION.
- GROWING MEDIUM - PLANTING MIXES:**
 - PLANTING MIX (WHERE SPECIFIED) SHALL BE THOROUGHLY COMBINED PRIOR TO PLACEMENT IN PLANTING BED AREAS TO THE FOLLOWING PROPORTIONS: 4 PARTS APPROVED TOPSOIL, 1 PART COMPOST, 1 PART SHREDDED PEAT MOSS AND AN APPLICATION OF HIGH PHOSPHOROUS FERTILIZER (0-20-0).
 - MIXES CONTAINING A SIGNIFICANT AMOUNT OF PEAT MOSS SHALL NOT BE PERMITTED TO DRY OUT. THE MOISTURE CONTENT OF THE PEAT MOSS AT THE TIME OF MIXING SHALL BE NOT LESS THAN 60% TO 75%.

FERTILIZER AND AMENDMENTS:

- ORGANIC SOIL ADDITIVE: "GRO-BARK" FINE COMPOSTED PINE MULCH OR AN APPROVED ALTERNATIVE.
- FERTILIZER: COMPLETE COMMERCIAL FERTILIZER WITH 50% OF THE ELEMENTS DERIVED FROM ORGANIC SOURCES.
- PEAT MOSS: DECOMPOSED PLANT MATERIAL, FAIRLY ELASTIC AND HOMOGENOUS, FREE OF DECOMPOSED COLLOIDAL RESIDUE, WOOD, SULPHUR AND IRON AND OF BROWN COLOUR CONTAINING MINIMUM 60% ORGANIC MATTER BY WEIGHT, MOISTURE CONTENT NOT EXCEEDING 15% AND PH VALUE OF 3.4 - 5.5.
- COMPOST AND MANURE: SHALL MEET THE STANDARDS FOUND IN THE INTERIM GUIDELINES FOR THE PRODUCTION AND USE OF AEROBIC COMPOST IN ONTARIO PUBLISHED BY THE ONTARIO MINISTRY OF ENVIRONMENT AND ENERGY (MOEE) AND SHALL BE VIRTUALLY FREE FROM ALL VIABLE WEED SEEDS, OR OTHER PLANT REPRODUCTIVE PARTS, PATHOGENS, CHEMICALS OR TOXIC CONTAMINANTS. MANURE SHALL BE WELL ROTTED, UNBLEACHED CATTLE MANURE, FREE FROM HARMFUL CHEMICALS AND OTHER INJURIOUS SUBSTANCES, AT LEAST EIGHT MONTHS OLD, BUT NOT MORE THAN TWO YEARS OLD AND WITH NO MORE THAN 25% STRAW, LEAVES OR OTHER MATERIALS. PHYSICAL CONTAMINANTS SUCH AS ROCK, PLASTIC, METAL OR GLASS SHALL BE LESS THAN 0.5% TOTAL CARBON TO NITROGEN RATIO IN THE RESULTING GROWING MEDIUM SHALL NOT EXCEED 30:1.
- LIME: LIMESTONE CONTAINING NOT LESS THAN 8% OF CALCIUM AND MAGNESIUM CARBONATES COMBINED, FINELY GROUND TO PASS A 10 MESH SIEVE WITH AT LEAST ONE HALF PASSING A 100 MESH SIEVE. RATE OF APPLICATION SHALL BE DETERMINED AFTER THE PH OF THE TOPSOIL.
- BONEMEAL: RAW, FINELY GROUND WITH A MINIMUM ANALYSIS OF 4% NITROGEN AND 20% PHOSPHOROUS ACID.
- SAND: SHARP, CLEAN SAND, TO OPSS 1002-3.

PLANT SCHEDULE

DECIDUOUS TREES	QTY	BOTANICAL NAME	COMMON NAME	CONT	CAL	REMARKS
LT	5	Liriodendron tulipifera	Tulip Tree	W.B.	60mm Cal	
QMA	6	Quercus macrocarpa	Burr Oak	W.B.	60mm Cal	
QR	2	Quercus rubra	Red Oak	W.B.	60mm Cal	
TA	7	Tilia americana	Basswood	W.B.	60mm Cal	

CONIFEROUS SHRUBS	QTY	BOTANICAL NAME	COMMON NAME	CONT	SPACING	REMARKS
JsA	40	Juniperus sabina 'Arcadia'	Arcadia Juniper	50cm, 3 gal.	1m	
TmD	12	Taxus x media 'Densiformis'	Dense Yew	50cm, 3 gal.	1.50m	

DECIDUOUS SHRUBS	QTY	BOTANICAL NAME	COMMON NAME	CONT	SPACING	REMARKS
Aca	4	Amelanchier canadensis	Canadian Serviceberry	Clump 150cm 7 gal	4m	multi-stem clump
HpB	79	Hydrangea paniculata 'Bombshell'	Bombshell Hydrangea	60cm, 3 gal.	1m	
SjL	23	Spiraea japonica 'Little Princess'	Little Princess Japanese Spirea	60cm, 3 gal.	0.70m	
SyP	7	Syringa meyeri 'Palibin'	Dwarf Korean Lilac	60cm, 3 gal.	1.20m	

ORNAMENTAL GRASSES	QTY	BOTANICAL NAME	COMMON NAME	CONT	SPACING	REMARKS
caK	46	Calamagrostis acutiflora 'Karl Foerster'	Feather Reed Grass	1 gal	0.70m	
msL	44	Miscanthus sinensis 'Little Kitten'	Little Kitten Eulalia Grass	1 gal	0.60m	

PERENNIALS	QTY	BOTANICAL NAME	COMMON NAME	CONT	SPACING	REMARKS
hol	42	Hosta lancifolia	Narrow Leaved Hosta	1 gal	750mm	
hPD	239	Hemerocallis x 'Purple D'oro'	Purple D'oro Daylily	1 gal	450mm	
hSR	177	Hemerocallis x 'Stella In Red'	Stella In Red Daylily	1 gal	450mm	

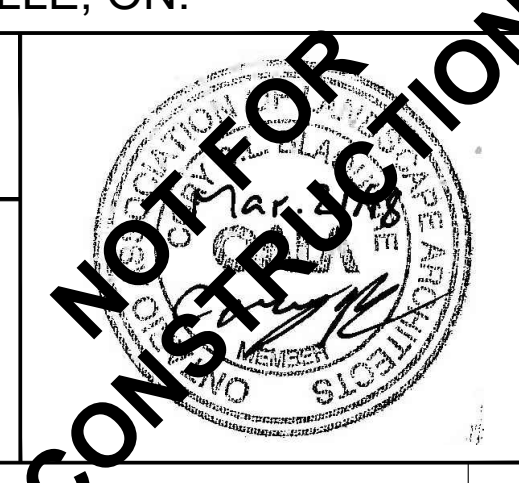

L1.0

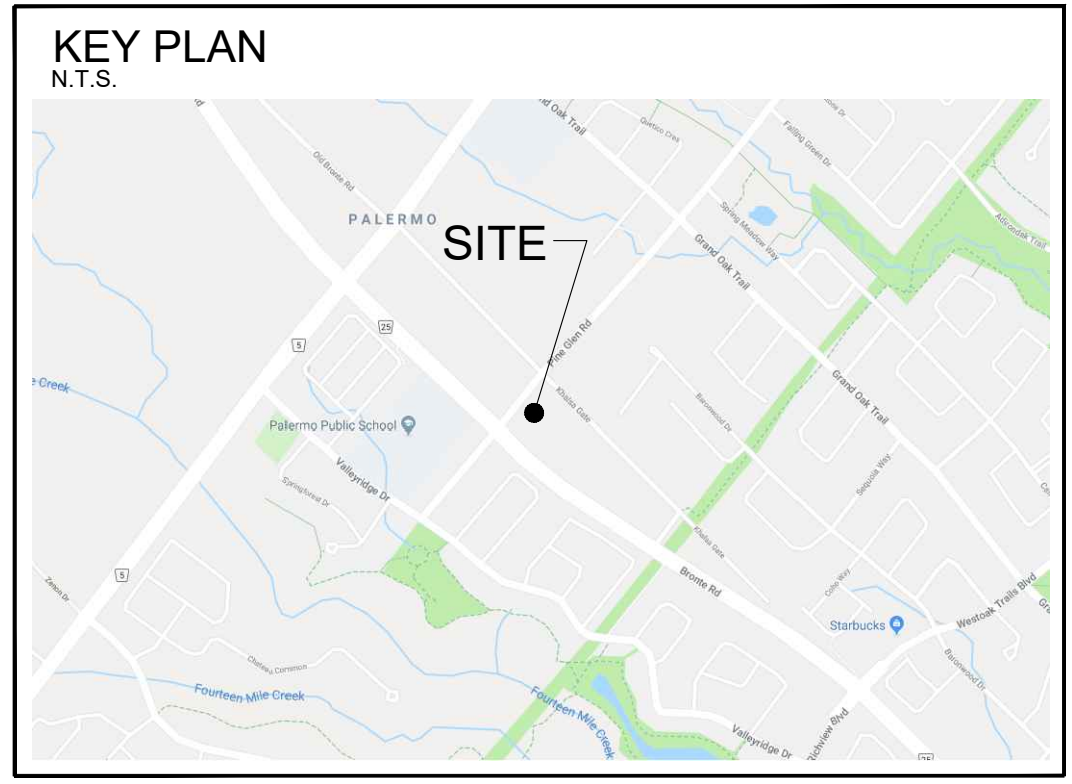
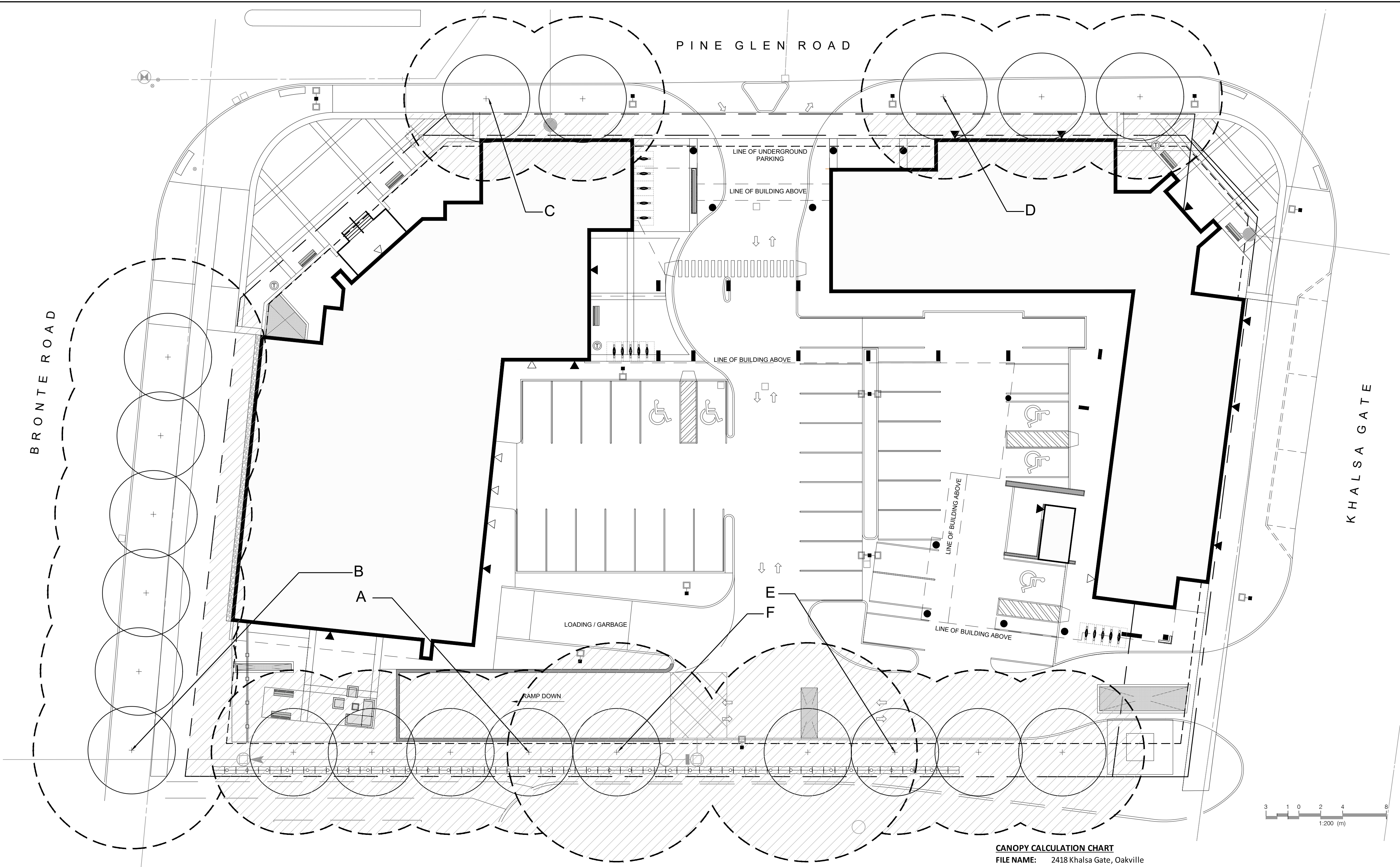

- Legend**
- PROPOSED TREE
 - PROPOSED LARGE STATURE TREE CROWN AREA
 - PROPOSED MEDIUM STATURE TREE CROWN AREA
 - PROPOSED SMALL STATURE TREE CROWN AREA
 - PROJECTED CANOPY COVERAGE
 - PROPERTY LINE

- GENERAL NOTES:**
1. DRAWINGS NOT TO BE USED FOR CONSTRUCTION UNLESS AUTHORIZED BY THE LANDSCAPE ARCHITECT
 2. CONTRACTOR SHALL REPORT ANY DISCREPANCIES BETWEEN THE DRAWINGS AND SITE CONDITIONS PRIOR TO COMMENCEMENT OF THE WORK
 3. ALL UTILITY LOCATES ARE THE RESPONSIBILITY OF THE CONTRACTOR. HAND DIG WITHIN THE LIMITS RECOMMENDED BY THE SERVICE UTILITY. UTILITY CONFLICTS WITH PROPOSED TREE LOCATIONS MUST BE REPORTED IMMEDIATELY TO THE LANDSCAPE ARCHITECT
 4. BASE DRAWING PROVIDED BY KNYMH INC.
 5. FOR GRADING INFORMATION REFER TO DRAWING BY LLEWELYN & ASSOCIATES LTD. FOR SERVICING INFORMATION REFER TO DRAWINGS BY S. LLEWELYN & ASSOCIATES LTD.
 6. LANDSCAPE DRAWINGS SHOW ENGINEERING INFORMATION FOR DESIGN PURPOSES ONLY. DO NOT CONSTRUCT ENGINEERING WORKS FROM THESE DRAWINGS.

CANOPY COVER PLAN
2418 KHALSA GATE
OAKVILLE, ON.

ISSUED FOR SITE PLAN APPROVAL, NOT FOR CONSTRUCTION.

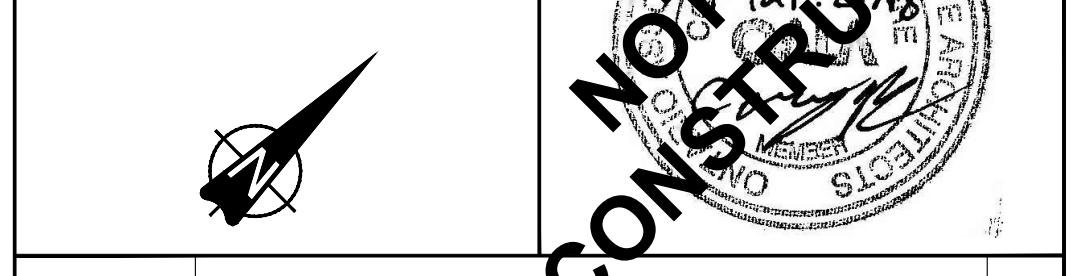

DATE	ISSUED FOR	BY
Jan 30, 2018	Issued for Review	JW
Feb 23, 2018	Issued for Review	JW
Mar 21, 2018	Issued for SPA	JW

DATE	REVISIONS	BY

CANOPY CALCULATION CHART
FILE NAME: 2418 Khalsa Gate, Oakville
FILE NUMBER: 17251

Tree # (single or cluster)	Tree Species	# of Trees	Soil Volume (m ³) per Tree	Crown Area (m ²) per Tree	Canopy Area Sub-total (m ²)
Large Stature Trees (14+ m spread)					
A	Tilia americana	4	29	177	384
B	Quercus macrocarpa*	6	60	254	128
C	Liriodendron tulipifera*	2	26	177	118
D	Liriodendron tulipifera*	3	29	177	163
E	Tilia americana	3	29	177	293
F	Quercus rubra	2	29	314	612

*Trees located off property. Canopy extending onto property collected only.

Medium Stature Trees (10-13m spread)

Small Stature Trees (3-9m spread)

Existing Trees

Subtotal of existing tree crown area
Subtotal of existing tree bonus factor of 1.5

Total # of Trees	20
Total Canopy Area (m²)	1698

Canopy Summary

Site Area (m ²)	5250
Site Canopy Cover	32.34%
Land Use Canopy Cover Target	20.00%

Parking Area Summary

Total Parking Spaces Proposed	38
Total # of Trees in or within 5m of Parking Area	0

20170 Humber Street South
Oakville, Ontario L6M 4V9
T 905 885 8883
F 905 885 8843
www.gspgroup.ca

162 Lakeshore Street East, Suite 200
Hamilton, Ontario L8P 4A8
T 905 572 7477
F 905 572 7477

Date: March 14, 2018
Scale: 1:200

Drawn By: JW
Project No.: 17251

L1.1

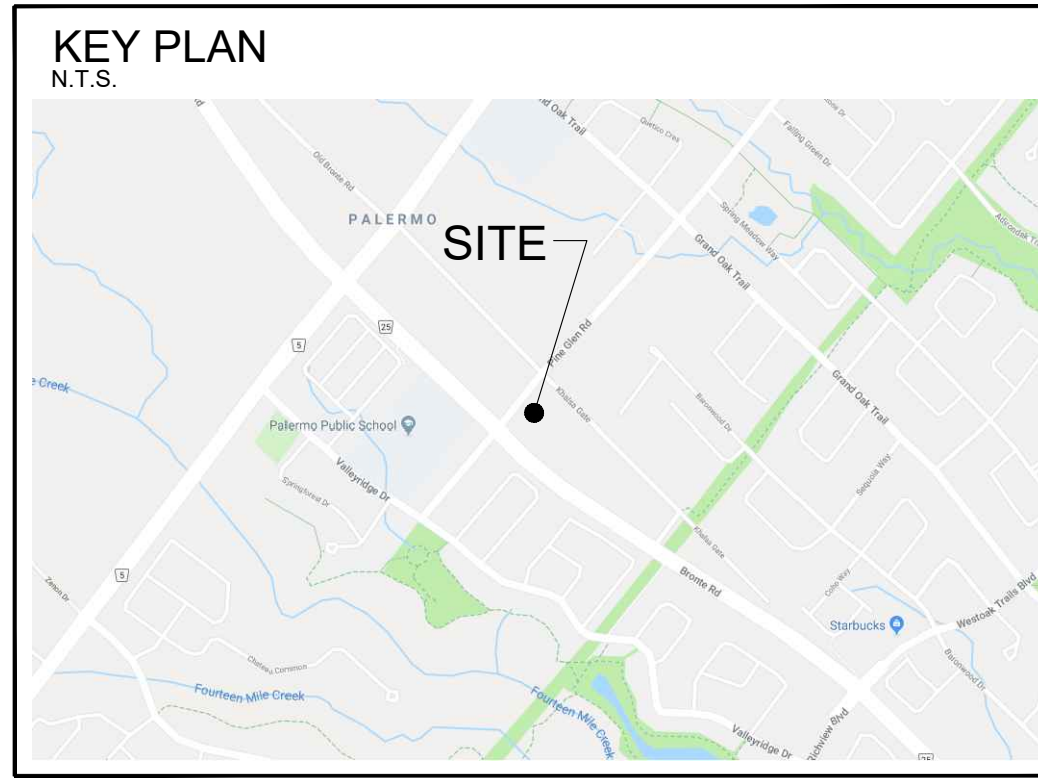
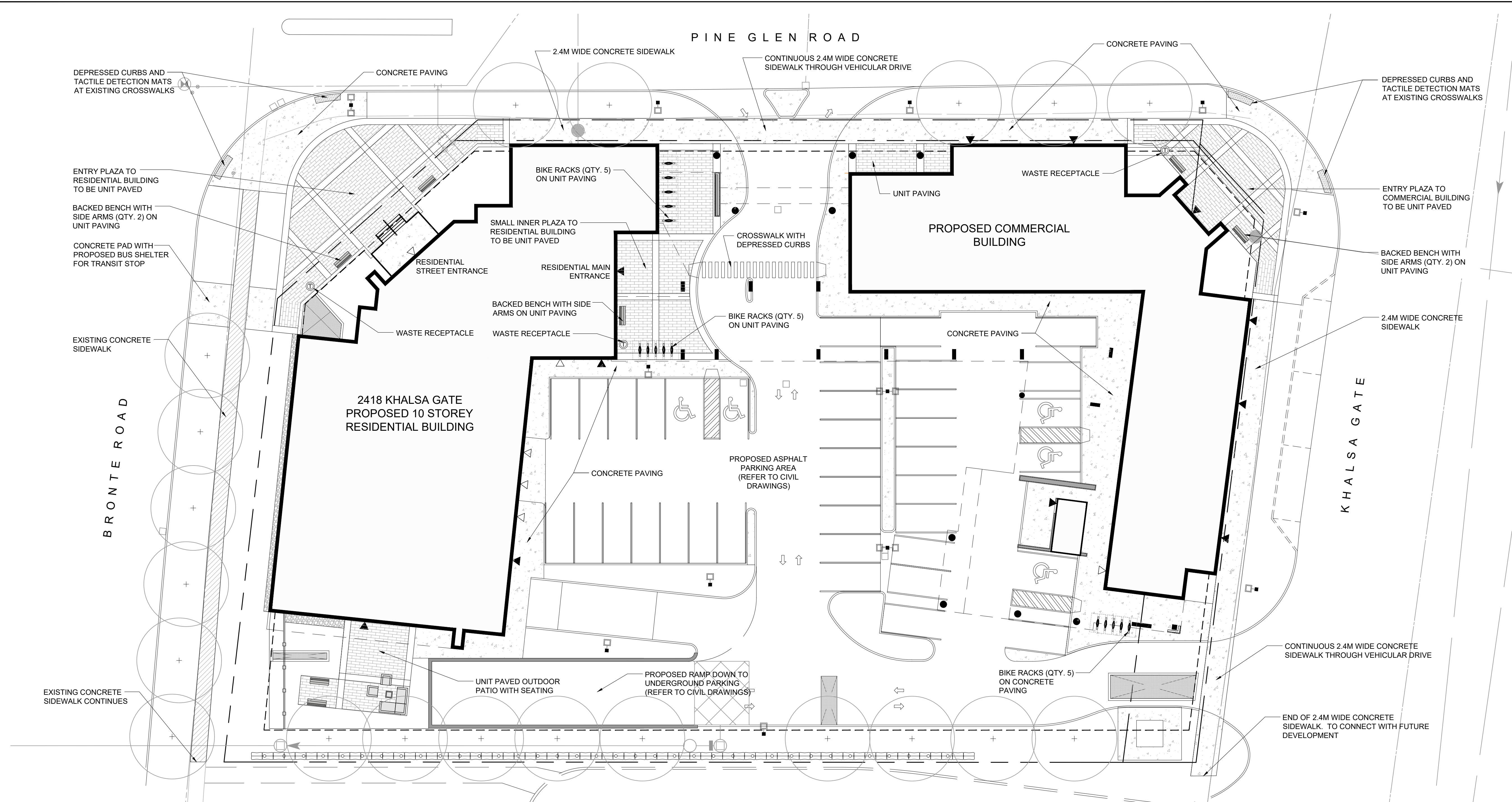

Legend

- PROPOSED TREE
- CONCRETE PAVING
- UNIT PAVING
- UNIT PAVING BANDING
- EXISTING CONCRETE SIDEWALK
- LIGHT STANDARD (DUAL) REFER TO ELECTRICAL
- LIGHT STANDARD (SINGLE) REFER TO ELECTRICAL
- BENCH
- WASTE RECEPTACLE
- BIKE RACK
- PROPERTY BOUNDARY

- ### GENERAL NOTES:
- DRAWINGS NOT TO BE USED FOR CONSTRUCTION UNLESS AUTHORIZED BY THE LANDSCAPE ARCHITECT
 - CONTRACTOR SHALL REPORT ANY DISCREPANCIES BETWEEN THE DRAWINGS AND SITE CONDITIONS PRIOR TO COMMENCEMENT OF THE WORK
 - ALL UTILITY LOCATES ARE THE RESPONSIBILITY OF THE CONTRACTOR. HAND DIG WITHIN THE LIMITS RECOMMENDED BY THE SERVICE UTILITY. UTILITY CONFLICTS WITH PROPOSED TREE LOCATIONS MUST BE REPORTED IMMEDIATELY TO THE LANDSCAPE ARCHITECT
 - BASE DRAWING PROVIDED BY KNYMH INC.
 - FOR GRADING INFORMATION REFER TO DRAWING BY LLEWELLYN & ASSOCIATES LTD. FOR SERVICING INFORMATION REFER TO DRAWINGS BY S. LLEWELLYN & ASSOCIATES LTD.
 - LANDSCAPE DRAWINGS SHOW ENGINEERING INFORMATION FOR DESIGN PURPOSES ONLY. DO NOT CONSTRUCT ENGINEERING WORKS FROM THESE DRAWINGS.

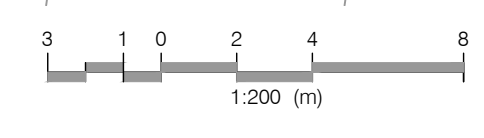

PEDESTRIAN CIRCULATION PLAN

2418 KHALSA GATE
OAKVILLE, ON.

ISSUED FOR SITE PLAN APPROVAL, NOT FOR CONSTRUCTION.

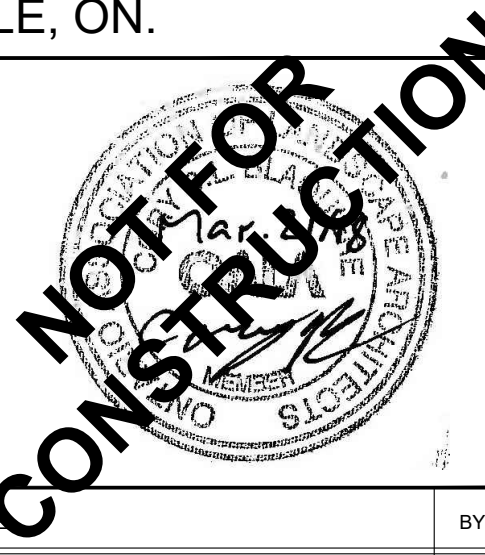
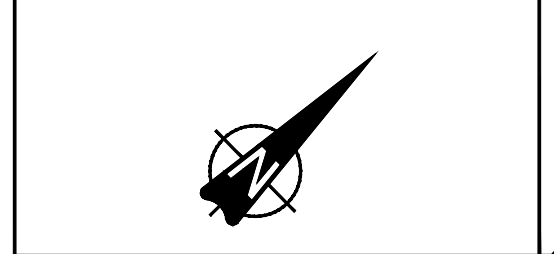

DATE	ISSUED FOR	BY
Jan 30, 2018	Issued for Review	JW
Feb 23, 2018	Issued for Review	JW
Mar 21, 2018	Issued for SPA	JW

DATE	REVISIONS	BY

201-721-8888
www.gspgroup.ca

905-888-8888
www.gspgroup.ca

Date: March 14, 2018 Drawn By: JW
Scale: 1:200 Project No.: 17251

L1.2

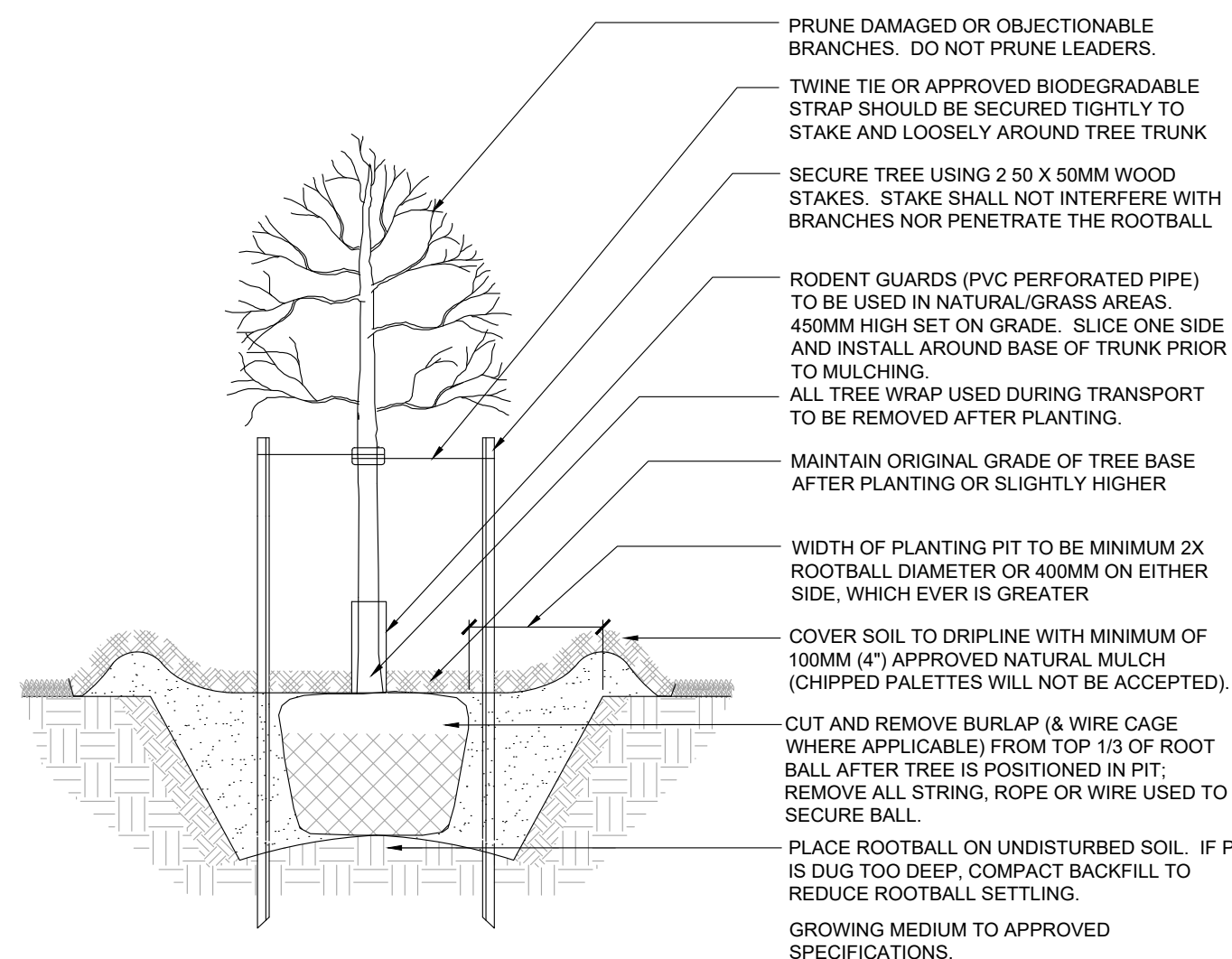

- NOTES**
- GROWING MEDIUM MIX: 4 PARTS TOPSOIL, 1 PART COMPOST, 1 PART SHREDDED PEAT & APPLICATION OF HIGH PHOSPHOROUS FERTILIZER (0-20-0)
 - PLANT MATERIAL SHALL BE THOROUGHLY WATERED AT TIME OF PLANTING.
 - PLANT MATERIAL SHALL BE SET PLUMB IN THE MIDDLE OF THE PIT.
 - TREE SHALL BEAR SAME RELATION OR SLIGHTLY HIGHER TO FINISHED GRADE AS ORIGINALLY GROWN.
 - PLANT STOCK MOVED WHILE IN LEAF SHALL BE COVERED WHILE IN TRANSIT. ROOTS SHOULD BE KEPT MOIST UNTIL PLANTED. TREES IN LEAF TO BE TREATED WITH ANTI-DESICANT.
 - DIMENSIONS ARE IN MILLIMETERS UNLESS OTHERWISE NOTED.
 - STAKING IS TO OCCUR ONLY AT THE DIRECTION OF THE LANDSCAPE ARCHITECT.
 - 100MM HIGH SAUCER EXCEPT WHEN PLANTING IN BED.

DECIDUOUS TREE PLANTING B.W.B - UP TO 80mm CALIPER
N.T.S.

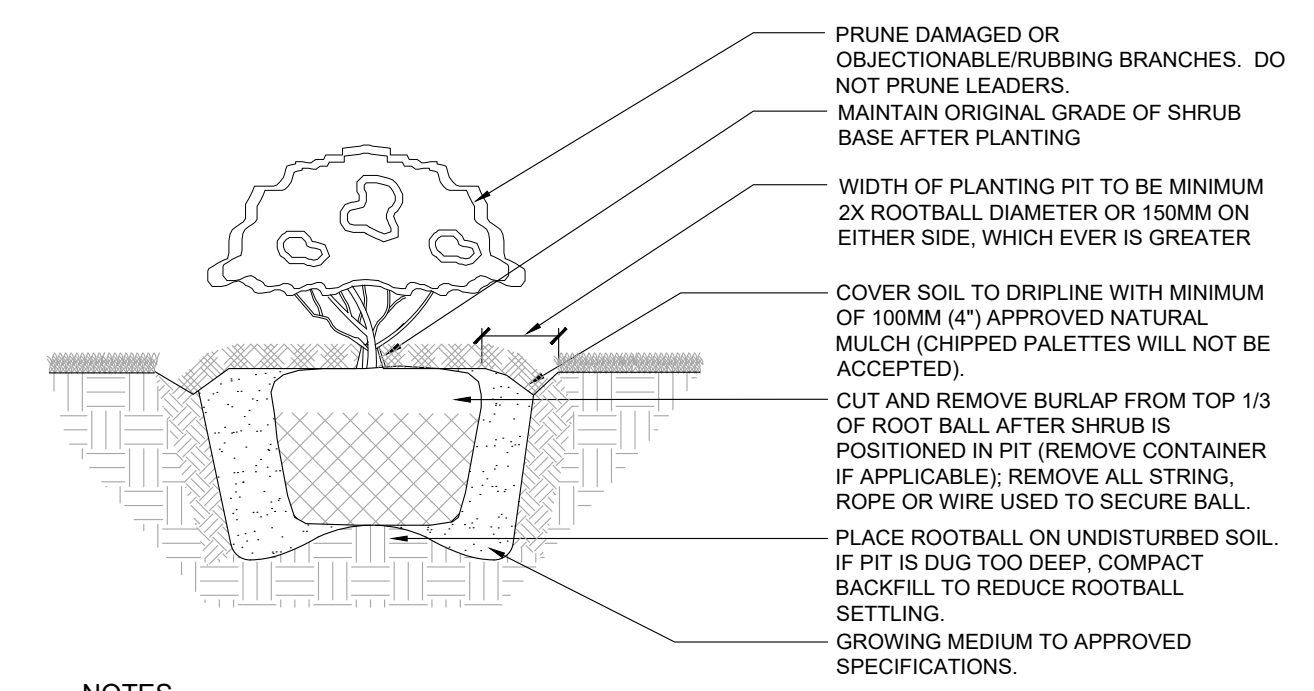
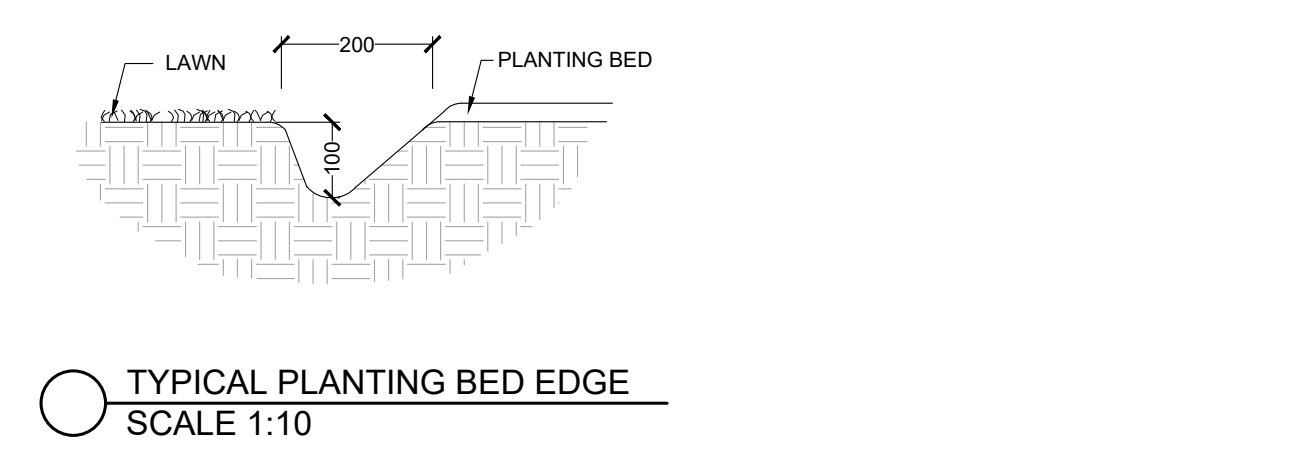

- NOTES**
- GROWING MEDIUM MIXTURE: 4 PARTS TOPSOIL, 1 PART COMPOST, 1 PART SHREDDED PEAT & APPLICATION OF HIGH PHOSPHOROUS FERTILIZER (0-20-0)
 - PLANTING BED SHALL BE THOROUGHLY WATERED IMMEDIATELY AFTER PLANTING & PRIOR TO MULCHING.
 - FOR POTTED SHRUBS, SATURATE CONTAINER/ROOTS/SOIL PRIOR TO REMOVAL OF CONTAINER BEFORE PLANTING.
 - SHRUBS ARE TO BE SPACED AS DIRECTED.
 - ALL DIMENSIONS ARE IN MILLIMETERS.

B&B/CONTAINER STOCK SHRUB PLANTING
N.T.S.

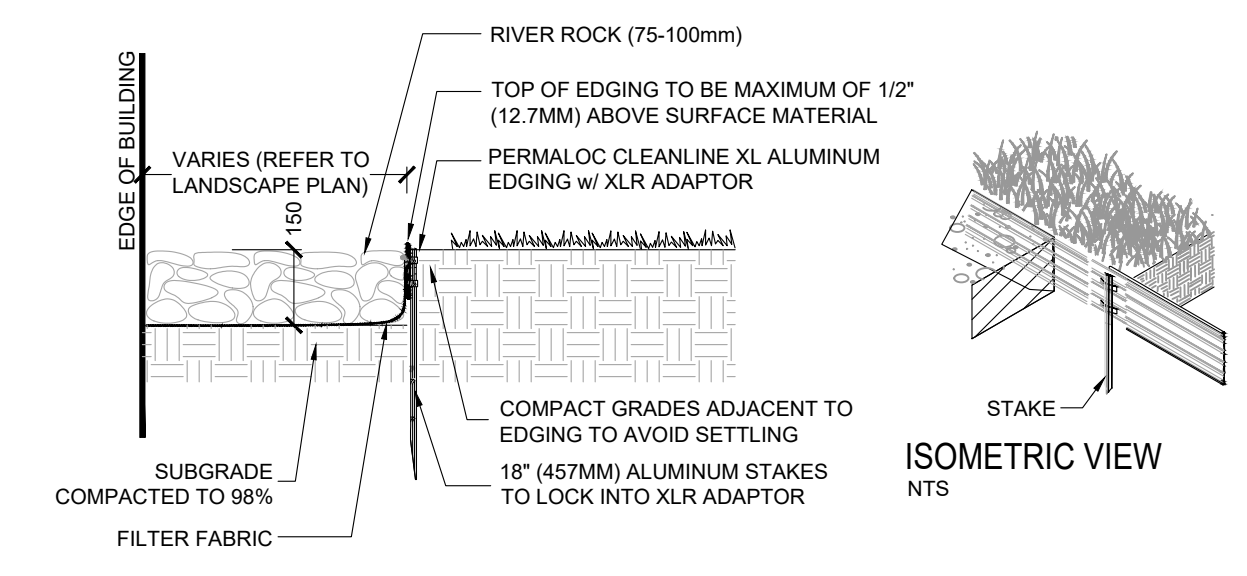

- NOTES**
- INSTALL PER MANUFACTURER'S "INSTALLATION GUIDELINES"
 - 8'-0" (2.44 M) SECTIONS TO INCLUDE (3) 18" (457 MM) ALUMINUM STAKES AND (3) XLR ADAPTORS.
 - 16'-0" (4.88 M) SECTIONS TO INCLUDE (5) 18" (457 MM) ALUMINUM STAKES AND (3) XLR ADAPTORS.
 - CORNERS - CUT BASE EDGING UP HALFWAY AND FORM A CONTINUOUS CORNER.
 - PERMALOC CLEANLINE XL AS MANUFACTURED BY PERMALOC CORPORATION, HOLLAND MI. (800) 356-9660, (616) 399-9600
 - CONTRACTOR'S NOTE: FOR PRODUCT AND PURCHASING INFORMATION VISIT: WWW.PERMALOC.COM

DRIP STRIP AT BUILDING
Scale 1:15

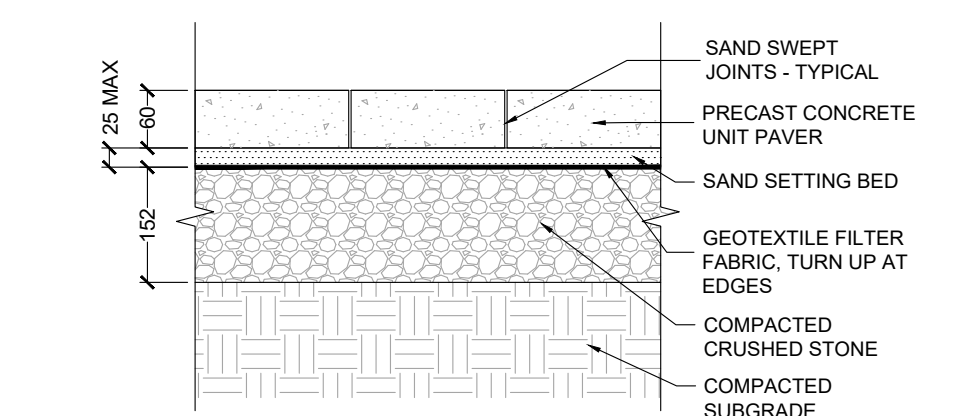

UNIT PAVING
1:10

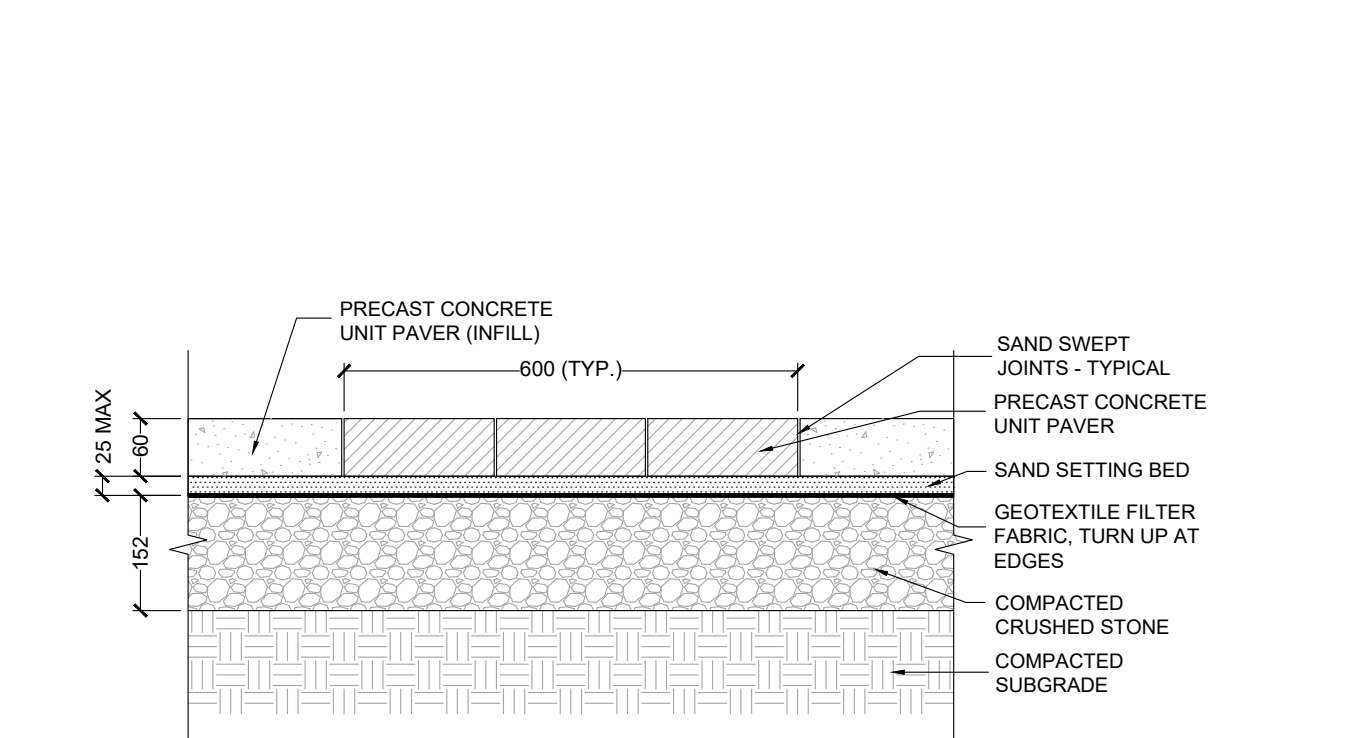

UNIT PAVING BANDING
1:10

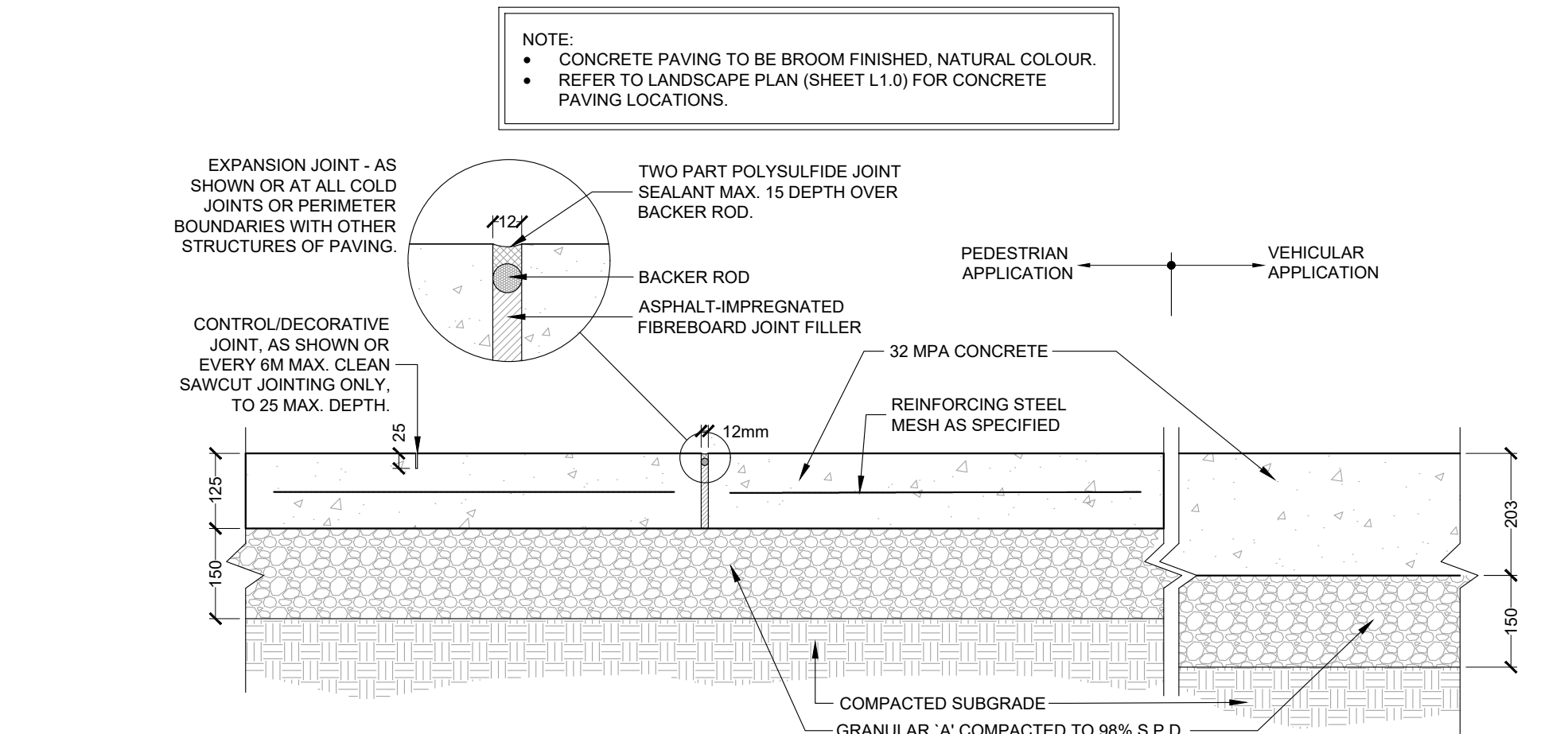

CONCRETE PAVING (PEDESTRIAN AND VEHICULAR)
Scale 1:10

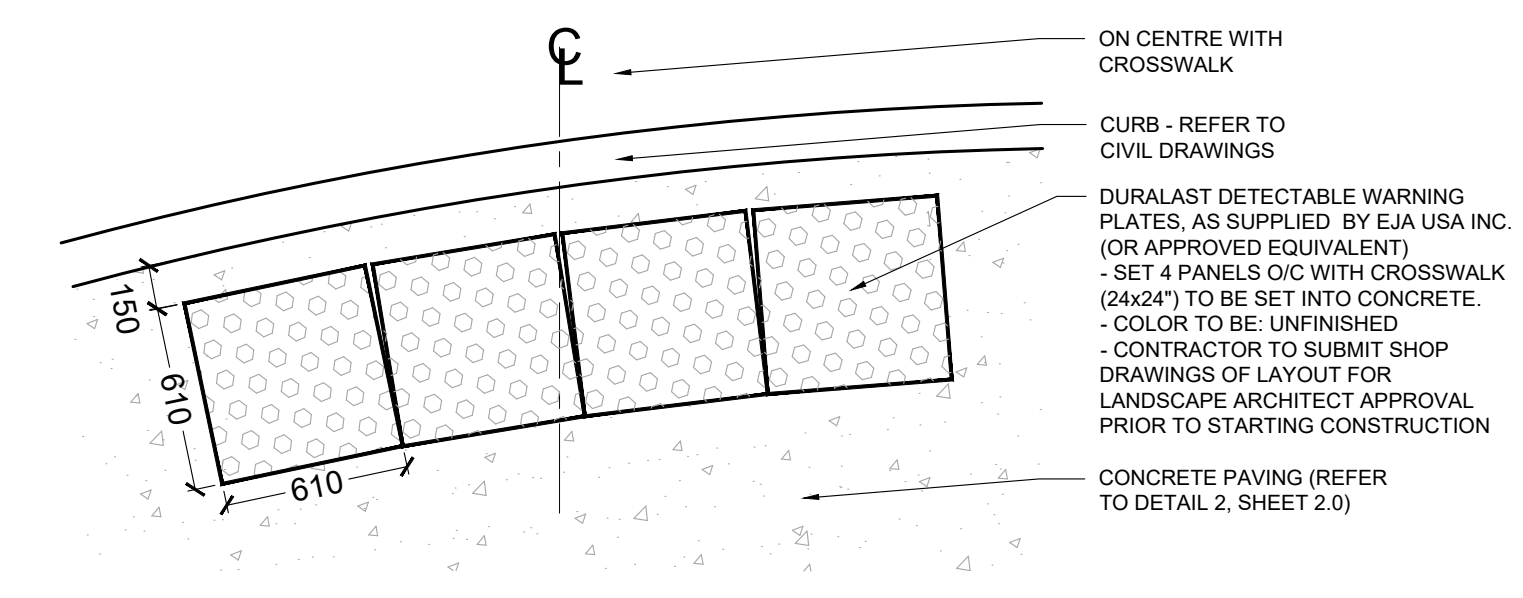

TACTILE WARNING PLATES (IN CONCRETE) LAYOUT
1:25

- GENERAL NOTES:**
- DRAWINGS NOT TO BE USED FOR CONSTRUCTION UNLESS AUTHORIZED BY THE LANDSCAPE ARCHITECT
 - CONTRACTOR SHALL REPORT ANY DISCREPANCIES BETWEEN THE DRAWINGS AND SITE CONDITIONS PRIOR TO COMMENCEMENT OF THE WORK
 - ALL UTILITY LOCATES ARE THE RESPONSIBILITY OF THE CONTRACTOR. HAND DIG WITHIN THE LIMITS RECOMMENDED BY THE SERVICE UTILITY. UTILITY CONFLICTS WITH PROPOSED TREE LOCATIONS MUST BE REPORTED IMMEDIATELY TO THE LANDSCAPE ARCHITECT
 - BASE DRAWING PROVIDED BY KNYMH INC.
 - FOR GRADING INFORMATION REFER TO DRAWING BY LLEWELLYN & ASSOCIATES LTD. FOR SERVICING INFORMATION REFER TO DRAWINGS BY S. LLEWELLYN & ASSOCIATES LTD.
 - LANDSCAPE DRAWINGS SHOW ENGINEERING INFORMATION FOR DESIGN PURPOSES ONLY. DO NOT CONSTRUCT ENGINEERING WORKS FROM THESE DRAWINGS.

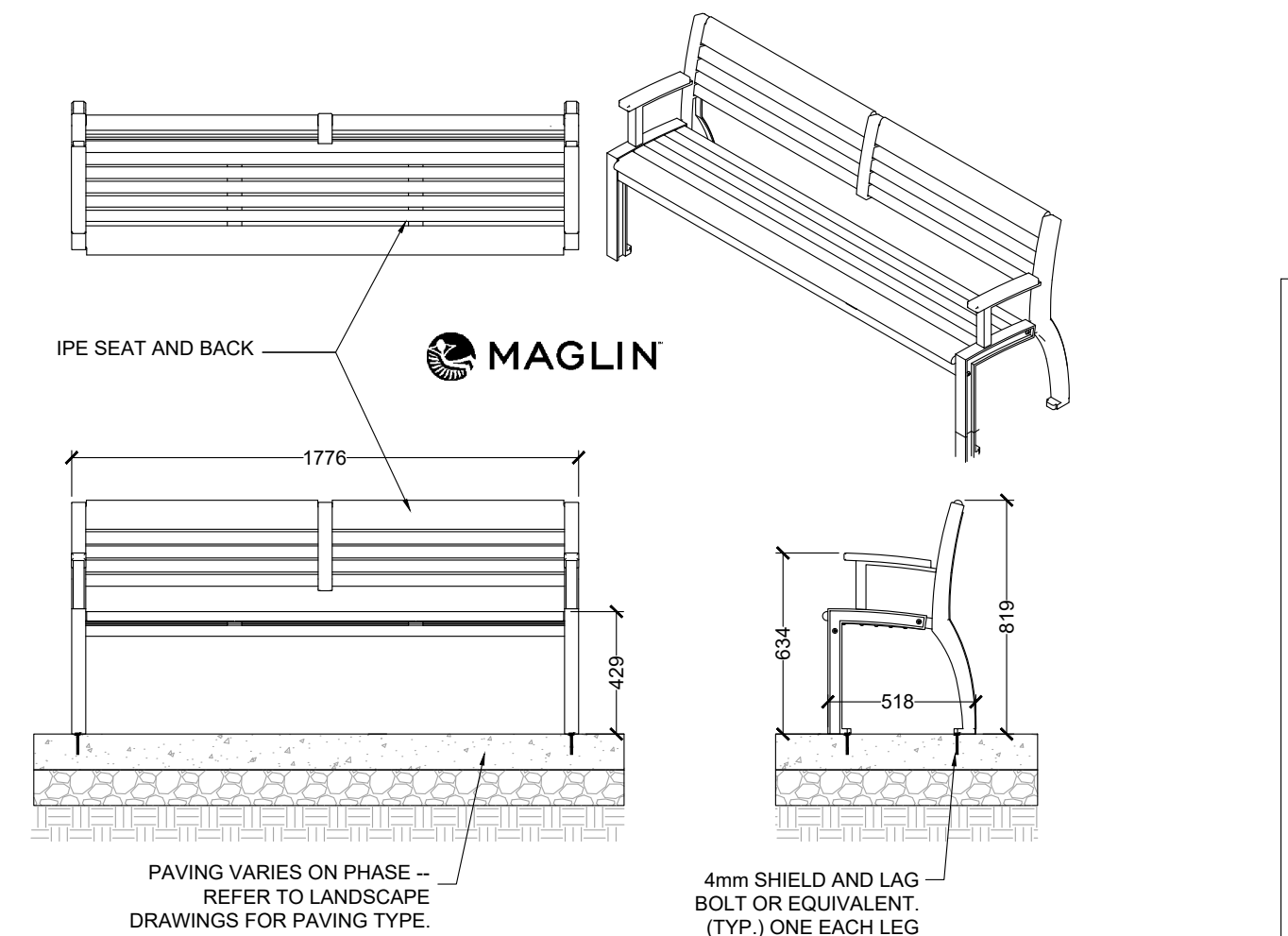

- NOTES:**
- BENCH TYPE 'B', NO. MLB700-W-A, BACKED WITH SIDE ARMS, BY MAGLIN SITE FURNITURE OR APPROVED EQUAL, 27 BYSHAM PARK DRIVE, WOODSTOCK, ON N4T 1P1
- BENCH TYPE 'A', NO. MLB700-W-A, BACKED WITHOUT SIDE ARMS, WITH CENTER ARM, BY MAGLIN SITE FURNITURE OR APPROVED EQUAL, 27 BYSHAM PARK DRIVE, WOODSTOCK, ON N4T 1P1
- 1-800-716-6606 WWW.MAGLIN.COM
 ARM POWDERCOAT COLOUR: BLACK FINETEX
 SURFACE MOUNT TO CONCRETE PAD THROUGH HOLES IN FEET AS PER MANUFACTURER'S RECOMMENDATIONS.

BACKED WOOD BENCH - MAGLIN 700-W-A
N.T.S.

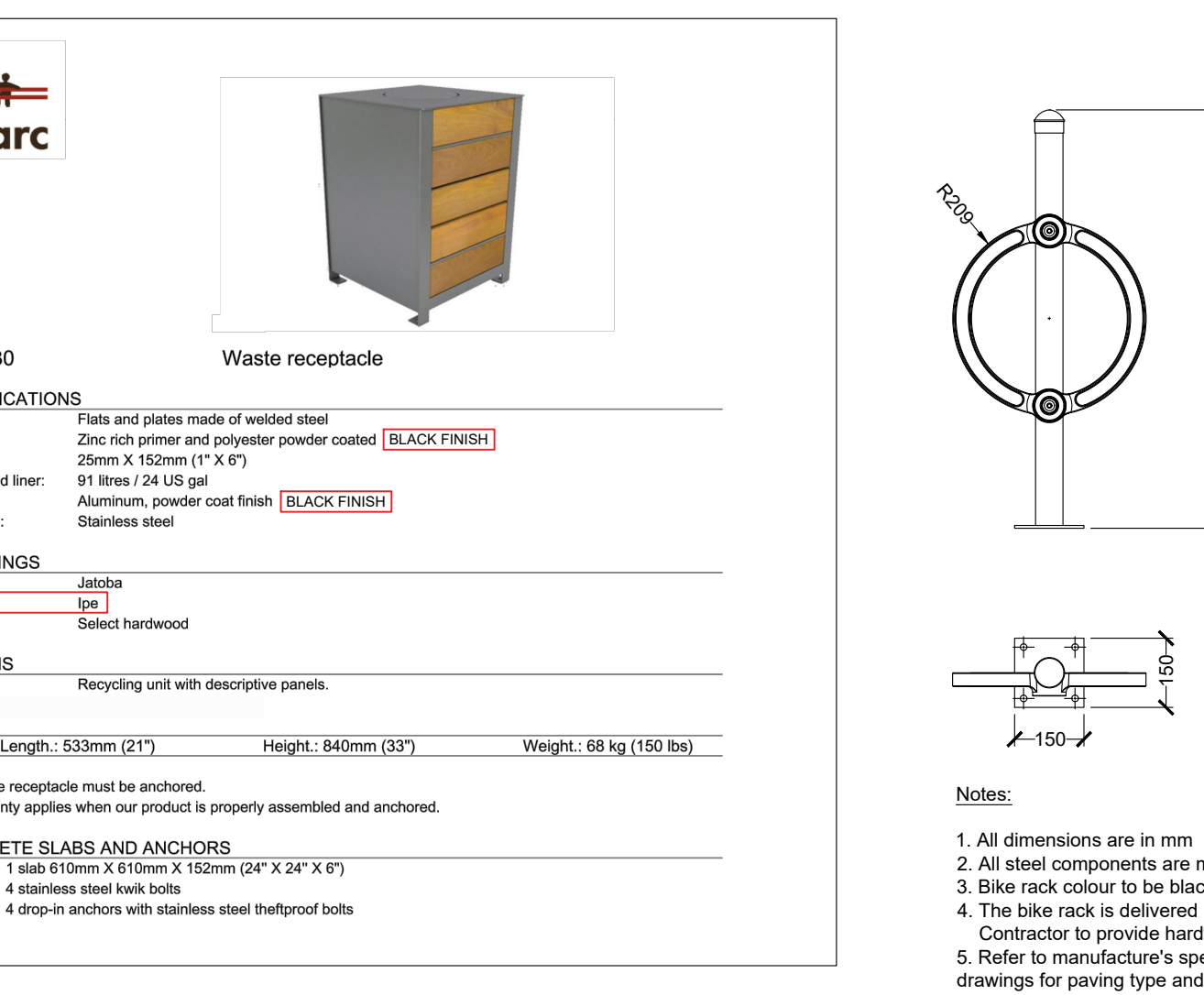

EP3630 WASTE RECEPTACLE
N.T.S.

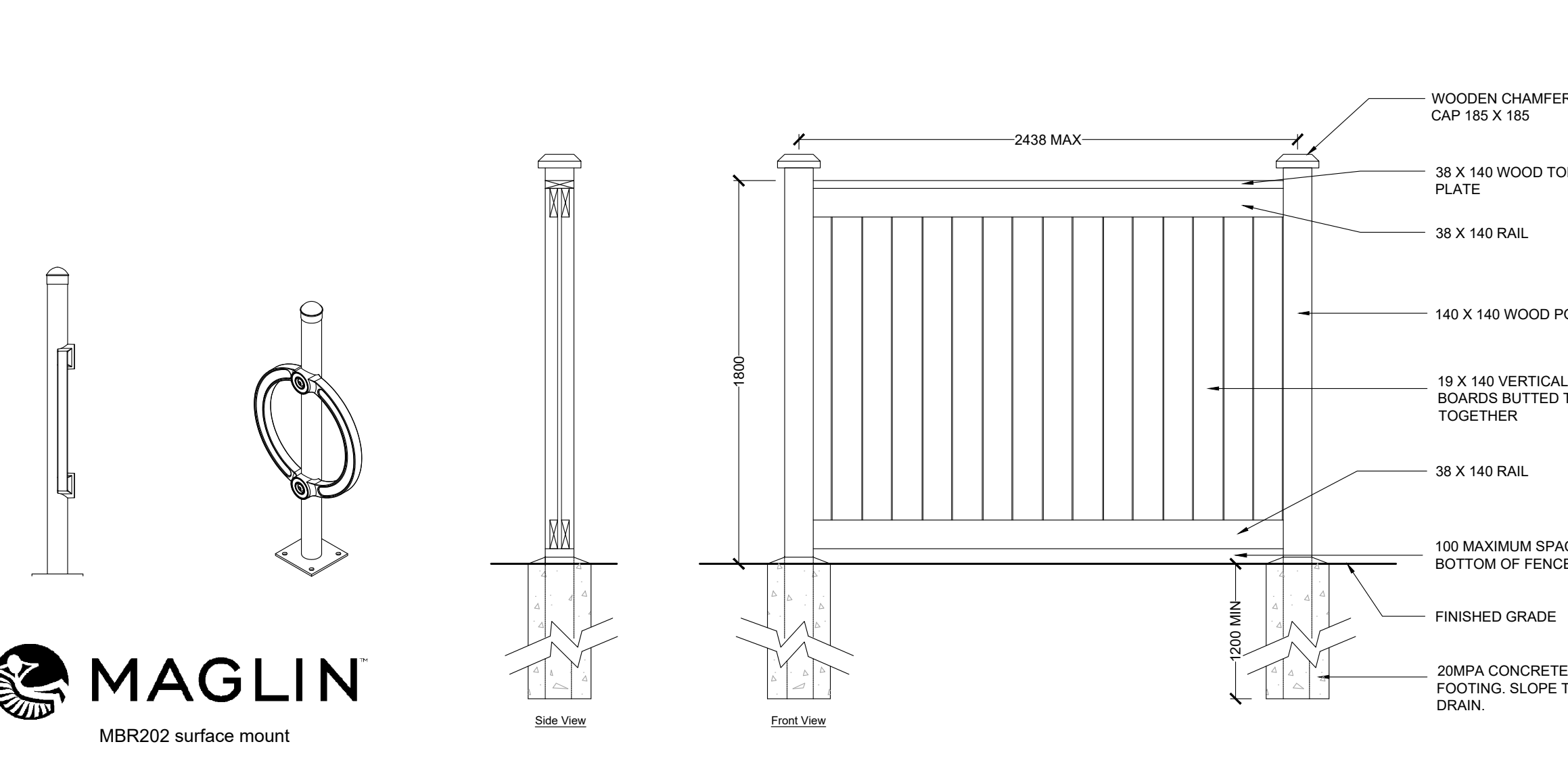

- NOTES:**
- All dimensions are in mm
 - All steel components are maglin powder coated as per manufacturers specifications.
 - Bike rack colour to be black. Colour sample to be approved by Landscape Architect prior to installation.
 - The bike rack is delivered pre-assembled. Holes (8mm) are provided in each foot for securing to base. Contractor to provide hardware for installation.
 - Refer to manufacturer's specification on installation. Paving varies on phase; refer to landscape drawings for paving type and layout.
- SPECIFICATIONS:**
- ALL WOOD TO BE NO. 1 CONSTRUCTION GRADE CEDAR, OR PRESSURE-TREATED AS DETERMINED BY OWNER, AND FREE OF EXCESSIVE CHIPS, CRACKS, WARPS OR KNOTS.
 - ALL FASTENERS TO BE HOT DIPPED GALVANIZED
 - ALL CUTS TO PRESSURE-TREATED WOOD MUST BE TREATED WITH TWO LIBERAL BRUSH COATS OF COPPER-BASED PRESERVATIVE. PRESSURE-TREATED FENCING WITHOUT SUCH TREATMENT WILL NOT BE ACCEPTED.
- | Dimensional | Metric (Nominal) |
|-------------|------------------|
| 1" | 25mm |
| 1.5" | 38mm |
| 2" | 51mm |
| 4" | 102mm |
| 6" | 153mm |
| 8" | 204mm |

BIKE RACK - MAGLIN MBR202
1:15

WOOD PRIVACY FENCE
Scale 1:25

DETAILS
2418 KHALSA GATE
OAKVILLE, ON.

ISSUED FOR SITE PLAN APPROVAL, NOT FOR CONSTRUCTION.

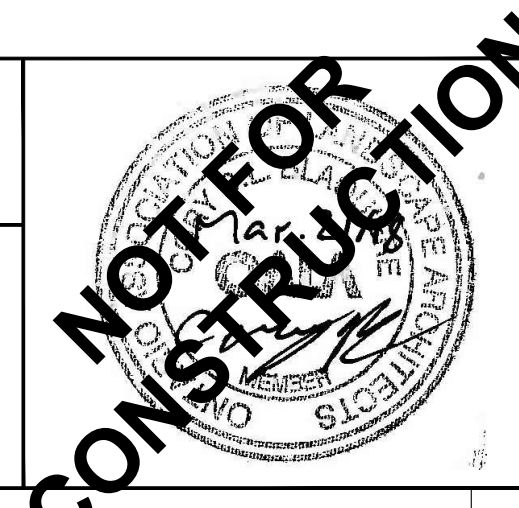

DATE	ISSUED FOR	BY
Jan 30, 2018	Issued for Review	JW
Feb 23, 2018	Issued for Review	JW
Mar 21, 2018	Issued for SPA	JW
DATE	REVISIONS	BY

GSP group
 20-72 Victoria Street South
 #1000, Oakville, ON L6M 4K8
 T 905 883 7177
 F 905 883 7177
 www.gspgroup.ca
 162 Loyal Street South, Suite 200
 Hamilton, Ontario L8P 4A8
 T 905 572 1477
 F 905 572 1477

L2.0

