

**BRONTE ROAD**

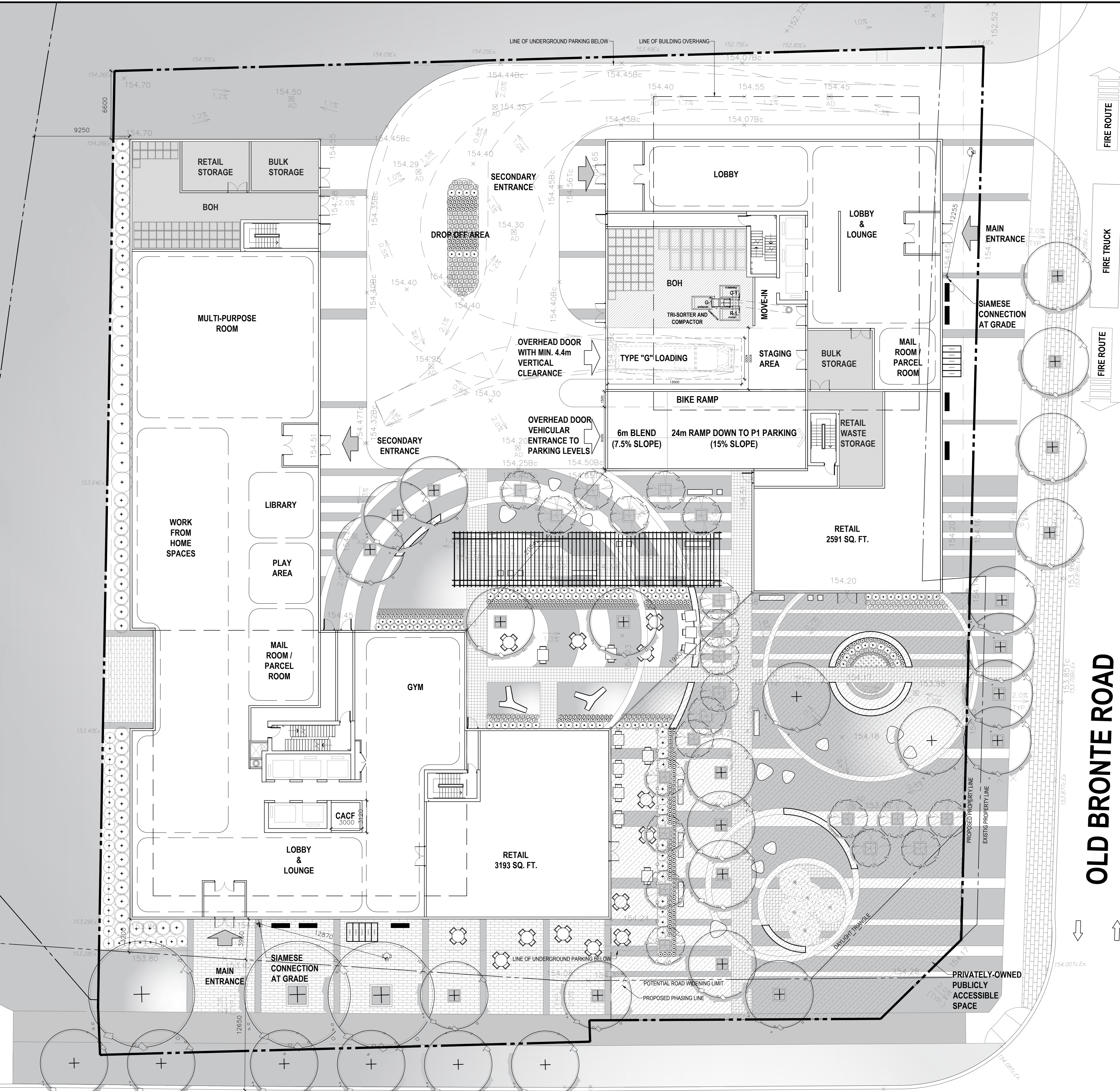

**OLD BRONTE ROAD**

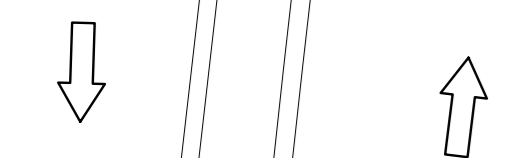

**DUNDAS STREET WEST**

FIRE TRUCK

FIRE ROUTE

FIRE ROUTE

BUILDING A WASTE COLLECTION (308 UNITS)	
GARBAGE ROOM (m <sup>2</sup> )	145.38
BULK STORAGE (m <sup>2</sup> )	38.51
GARBAGE STORAGE (G) (COMPACTED BIN SIZE 3 yd <sup>3</sup> )	
BINS PROVIDED (200+ UNITS)	3
RECYCLING STORAGE (R) (BLUE BIN 306L)	
BINS PROVIDED 1/7 UNITS	44
ORGANICS STORAGE (O) (GREENCART 360L)	
BINS PROVIDED 1/25 UNITS	12
STAGING AREA (m <sup>2</sup> )	34.92
*RETAIL STORAGE AREA (m <sup>2</sup> )	48.47
REFER TO NOTE 6.	
BUILDING B WASTE COLLECTION (382 UNITS)	
GARBAGE ROOM (m <sup>2</sup> )	168.33
BULK STORAGE (m <sup>2</sup> )	36.00
GARBAGE STORAGE (G) (COMPACTED BIN SIZE 3 yd <sup>3</sup> )	
BINS PROVIDED (200+ UNITS)	3
RECYCLING STORAGE (R) (BLUE BIN 306L)	
BINS PROVIDED 1/7 UNITS	55
ORGANICS STORAGE (O) (GREENCART 360L)	
BINS PROVIDED 1/25 UNITS	15
*RETAIL STORAGE AREA (m <sup>2</sup> )	36.00
REFER TO NOTE 6.	
NOTES	
*CALCULATIONS BASED FROM "DEVELOPMENT DESIGN GUIDELINES FOR SOURCE SEPARATION OF SOLID WASTE REGIONAL OFFICIAL PLAN GUIDELINES" (REVISED 2019)	
1) TYPE 'G' LOADING SPACES WILL PROVIDE A MIN 4m x 13m AREA WITH MIN. 6.1m VERTICAL CLEARANCE. MIN. BASE OF 300MM OF COMPACTED 20MM CRUSHER RUN-LIMESTONE AND FINISHED TO A MIN. 200 DEPTH OF CONCRETE WITH FLOOR GRADE +/- 2% IN LOADING SPACE AND STAGING AREA.	
2) WARNING FLASHING BEACON SYSTEM AND CAUTION SIGNAGE WILL BE PROVIDED TO CAUTION MOTORISTS LEAVING THE PARKING GARAGE OF HEAVY VEHICLE ACTIVITIES AT GRADE NEAR THE RAMP ENTRANCE.	
3) A TRAINED ON-SITE STAFF MEMBER WILL BE AVAILABLE TO MANUEVER BINS FOR CITY PICK UP AND ALSO ASSIST AS A FLAGMEN WHEN THE GARBAGE TRUCK IS REVERSING.	
4) ALL OF THE ACCESS DRIVEWAYS TO BE USED BY THE CITY WASTE COLLECTION VEHICLES HAVE GRADES LESS THAN 8% AND HAVE A MIN. VERTICAL CLEARANCE OF 4.4m. A MIN. WIDTH OF 4.5m AND BE 6m WIDE AT POINT OF INGRESS AND EGRESS.	
5) WASTE DIVERSION SYSTEM: ONE CHUTE PER BUILDING WITH TRI-SORTER.	
6) RETAIL WASTE WILL BE STORED IN RETAIL STORAGE ROOM AND TRANSPORTED TO TYPE 'G' LOADING AREA AT TIME OF COLLECTION ON DIFFERENT DAYS FROM THE COLLECTION DAYS FOR THE RESIDENTIAL COMPONENT TO ENSURE THAT THE TYPE 'G' LOADING SPACE WILL BE VACANT FOR CITY WASTE COLLECTION.	
7) STRUCTURE UNDER COLLECTION VEHICLES SAFELY SUPPORTS FULLY LOADED VEHICLES (35,000KG) AND CONFORMS TO THE FOLLOWING: A. DESIGN CODE- ONTARIO BUILDING CODE B. DESIGN LOAD - CITY BULK LIFT VEHICLE IN ADDITION BUILDING CODE REQUIREMENTS C. IMPACT FACTOR - 5% FOR MAXIMUM VEHICULAR SPEEDS TO 15KM/H AND 30% FOR HIGHER SPEEDS	

Plot Time: May 17, 2023 - 6:39pm  
 Drawing Name: \\wzmh\Projects\8196\_VB\_Drawings\10\_Drawings-Design (SD-00)\CAD\CAD Sheets\A-201-210\_Floor Plans.dwg

ISSUES/REVISIONS			ISSUES/REVISIONS		
ISSUE	TITLE	DATE	ISSUE	TITLE	DATE
			B	ISSUED FOR OPAL/20A	05/23/2023

KEY PLAN

Project North

Seal

MMDDYYYY

05/17/2023

DATE

05/17/2023

Scale

1:150

Checked By

Author

Drawn By

Author

Plot No

08196.000

Sheet No

08196.000

**ENIRO GROUP**

REAL ESTATE DEVELOPMENT

**WZMH**

WZMH Architects  
 95 St. Clair Ave W., Suite 1500  
 Toronto, Ontario, Canada M5V 1W6  
 Tel: 416-961-4111  
 www.wzmh.com

3005 DUNDAS  
 3005 DUNDAS STREET WEST,  
 OAKVILLE, ON, L6M 4J4

Drawing Title  
**GROUND LEVEL  
 FLOOR PLAN**

Date

05/17/2023

Scale

1:150

Checked By

Author

Drawn By

Author

Plot No

08196.000

Sheet No

08196.000

**A-201**