

KEY	BOTANICAL NAME	COMMON NAME
<b>DECIDUOUS TREE PLANTING</b>		
CC	CERCIS CANADENSIS	EASTERN REDBUD
GD	GYMNOCLADUS DIOICUS	KENTUCKY COFFEE TREE
LT	LIRIODENDRON TULIPIFERA	TULIP TREE
<b>ORNAMENTAL TREE PLANTING</b>		
PD	AMELANCHIER X GRANDIFLORA 'PRINCESS DIANA'	PRINCESS DIANA SERVICEBERRY
<b>EVERGREEN SHRUBS</b>		
jcv	JUNIPERUS CHINENSIS 'SARGENTII VIRIDIS'	GREEN SARGENT JUNIPER
tmd	TAXUS X MEDIA 'DENSIFORMIS'	DENSE YEW
<b>DECIDUOUS SHRUBS</b>		
csk	CORNUS SERICEA 'KELSEY'	KELSEY RED OSIER DOGWOOD
ram	RIBES ALPINUM	ALPINE CURRANT
ror	ROSA RUGOSA	RUGOSA ROSE
sfn	SALIX PURPUREA 'NANA'	BLUE ARCTIC WILLOW
<b>PERENNIALS &amp; GRASSES</b>		
cak	CALAMAGROSIS ACUTIFLORA 'KARL FOERSTER'	KARL FOERSTER FEATHER REED GRASS
hsd	HEMEROCALLIS 'STELLA D'ORO'	STELLA D'ORO DAYLILY
pall	PENNISETUM ALOPECUROIDES 'LITTLE BUNNY'	MINITURE FOUNTAIN GRASS

**NOTE:**  
 \* BOULEVARD TREE PLANTINGS ALONG BADGER CRESCENT, MERTON ROAD, AND CHARLES CORNWALL BOULEVARD FRONTAGES SHALL BE COORDINATED AND COMPLETED UNDER THE SUBDIVISION AGREEMENT.

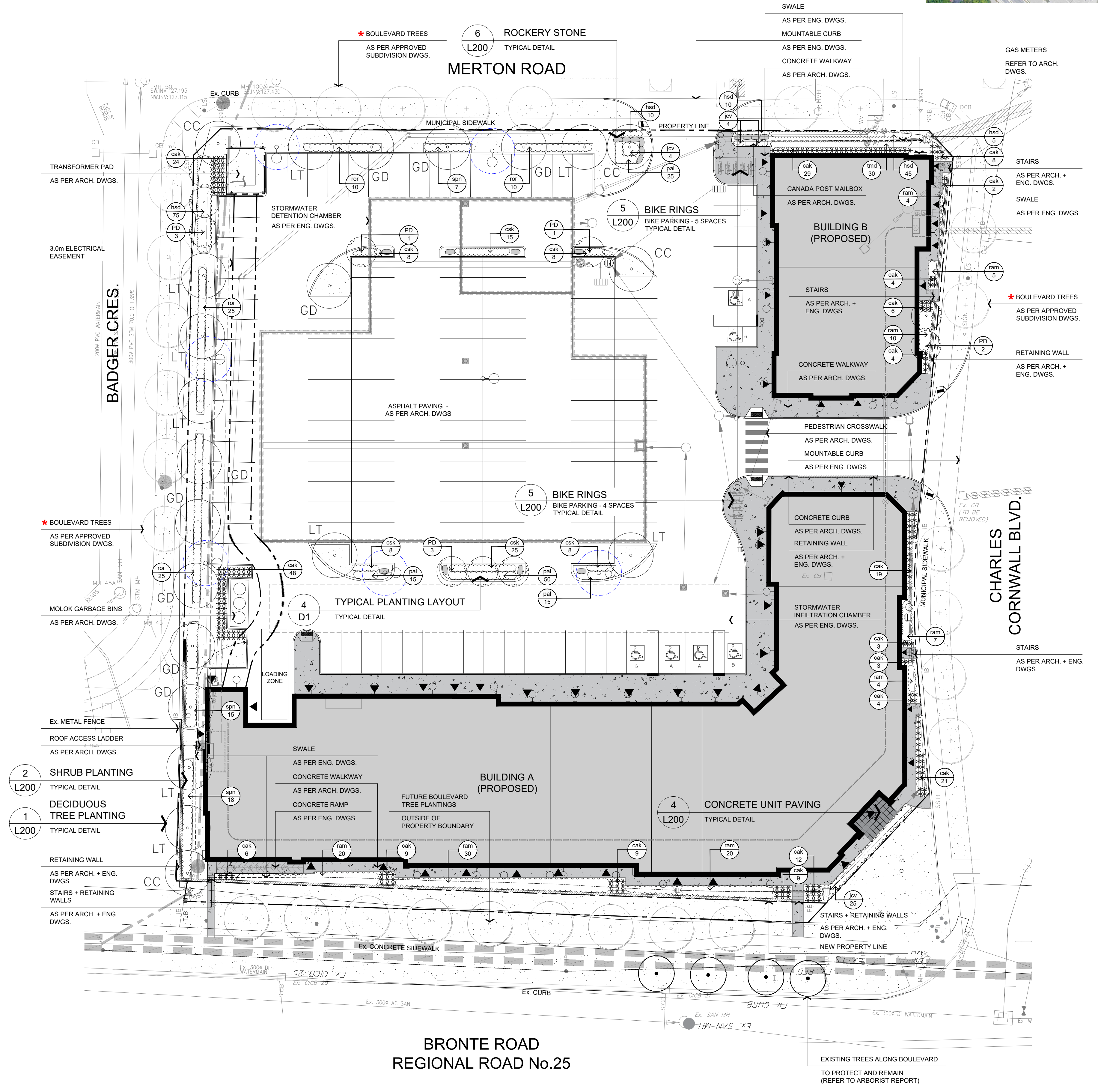

**APPROVAL BLOCK**

no.	date	revision	by
3	MAY 4 2026	ISSUED FOR SPA RE-SUBMISSION	MB
2a	DEC 2 2025	ISSUED FOR SPA RE-SUBMISSION	MB
	SEPT 23 2025	ISSUED FOR SPA RE-SUBMISSION	MB
2	JULY 10 2025	ISSUED FOR SPA RE-SUBMISSION	MB
1	DEC 19 2024	ISSUED FOR SPA SUBMISSION	SG

**LEGEND**

- EXISTING DECIDUOUS TREE TO REMAIN
- BOULEVARD TREE (AS PER APPROVED SUBDIVISION DWGS.)
- FUTURE BOULEVARD TREE PLANTING
- PROPOSED DECIDUOUS TREE
- PROPOSED ORNAMENTAL TREE
- PROPOSED CONIFEROUS TREE
- SHRUB PLANTING
- TOPSOIL + SOD
- 3.0m OFFSET FROM LIGHT STANDARD POLE TO PROPOSED TREES

**byPATH:**  
 landscape architecture

4933 Old Brock Road  
 Clarendon, Ontario  
 info@bypath.ca  
 647-545-5809



These plans are the property of byPATH: landscape architecture inc. They may not be altered, revised, or modified in any way without the written consent of byPATH: landscape architecture inc. All information hereon to be checked and verified on site by the landscape contractor. Any discrepancies must be reported to, and clarified by the landscape architect before commencing work.

project  
**COMMERCIAL DEVELOPMENT**  
 BRONTE AND CHARLES CORNWALL  
 OAKVILLE, ONTARIO

drawing  
**LANDSCAPE PLAN**

file start date	NOVEMBER, 2024	by	SG
scale*	1:300	file	2298 V3-260504
direction		project no.	2298
		sheet no.	L100

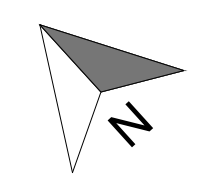



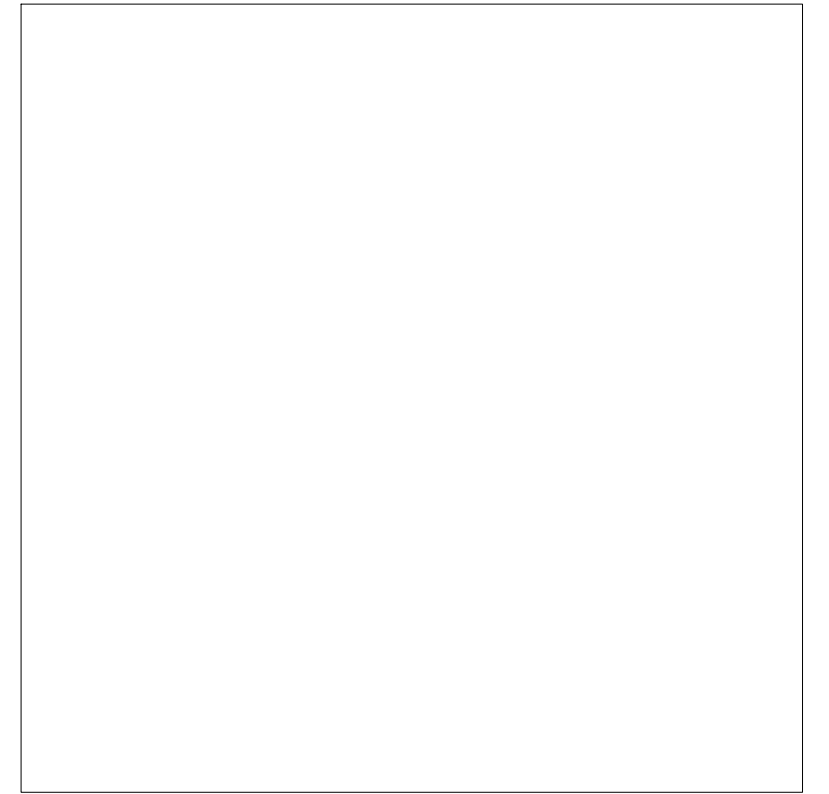

\*NOTED SCALE IS APPLICABLE ONLY WHEN PRINTED ON ARCH D (24"x36") SIZE SHEET

APPROVAL BLOCK



LEGEND

-  SMALL (5m) DECIDUOUS TREE CANOPY
-  MEDIUM (7m) DECIDUOUS TREE CANOPY
-  LARGE (9m) DECIDUOUS TREE CANOPY
-  SOIL VOLUME AREA

no.	date	revision	by
3	MAY 4 2026	ISSUED FOR SPA RE-SUBMISSION	MB
2a	DEC 2 2025	ISSUED FOR SPA RE-SUBMISSION	MB
	SEPT 23 2025	ISSUED FOR SPA RE-SUBMISSION	MB
2	JULY 10 2025	ISSUED FOR SPA RE-SUBMISSION	MB
1	DEC 19 2024	ISSUED FOR SPA SUBMISSION	SG

**byPATH:**  
landscape architecture

4933 Old Brock Road  
Claremont, Ontario  
info@bypath.ca  
647-545-5809



These plans are the property of byPATH: landscape architecture inc. They may not be altered, revised, or modified in any way without the written consent of byPATH: landscape architecture inc. All information hereon to be checked and verified on site by the landscape contractor. Any discrepancies must be reported to, and clarified by the landscape architect before commencing work.

project  
**COMMERCIAL DEVELOPMENT**

BRONTE AND CHARLES CORNWALL  
OAKVILLE, ONTARIO

drawing  
**CANOPY COVERAGE AND  
SOIL VOLUME PLAN**

file start date **NOVEMBER, 2024** by **SG**  
scale\* **1:300** file **2298 V3-260504**  
direction project no.

**2298**  
sheet no.  
**L101**

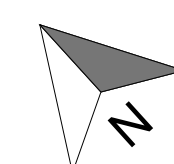

BRONTE ROAD  
REGIONAL ROAD No.25

**NOTE**  
THE FOLLOWING SOIL VOLUME AREA NUMBERS HAVE BEEN OMITTED FROM THE CHART BELOW DUE TO CHANGES TO THE LANDSCAPE PLAN: 1, 2, 4, 5, 8.

SOIL AREA	TREE No. (SINGLE OR CLUSTER)	SIZE OF AREA (m2)	No. OF TREES IN AREA	SOIL DEPTH (m)	AVAILABLE SOIL VOLUME (m3)	SOIL SIZE PER TREE (SM, MED, LG)	SOIL VOLUME PER TREE (m3)	TREE STATURE (SM, MED, LG) SEE LEGEND FOR DIA.	CANOPY AREA (m2)
3	CLUSTER	12.00 m2	2	1.0m	12.00 m3	2 SM	6.00 m3 (6 m3 MIN. SHARED REQUIRED)	2 SM	39.26 m2
6	CLUSTER	324.00 m2	21	1.0m	324.00 m3	3 SM, 3 MED, 15 LG	6.00 m3 SM, 12.00 m3 MED, 18.00 m3 LG (24 m3 TOTAL SHARED REQUIRED)	3 SM, 3 MED, 15 LG	1,126.61 m2
7	CLUSTER	18.00 m2	2	1.0m	18.00 m3	1 SM, 1 MED	6.00 m3 SM, 12.00 m3 MED (18 m3 TOTAL SHARED REQUIRED)	1 SM, 1 MED	58.12 m2
9	CLUSTER	24.00 m2	2	1.0m	24.00 m3	1 SM, 1 LG	6.00 m3 SM, 18.00 m3 LG (24 m3 TOTAL SHARED REQUIRED)	1 SM, 1 LG	83.25 m2
10	SINGLE	24.00 m2	1	1.0m	24.00 m3	LG	24.00 m3 (24 m3 REQUIRED)	1 LG	63.61 m2
11	CLUSTER	18.00 m2	3	1.0m	18.00 m3	3 SM	6.00 m3 (6 m3 MIN. SHARED REQUIRED)	3 SM	58.90 m2
12	SINGLE	20.00 m2	1	1.2m	24.00 m3	LG	24.00 m3 (24 m3 REQUIRED)	1 LG	63.61 m2
CANOPY OVERLAP									60.86 m2
<b>TOTAL</b>									1,434.50 m2
<b>CANOPY SUMMARY</b>									
SITE AREA (within property boundary)									9,841.48 m2
SITE CANOPY COVER									14.57%

**NOTES:**

APPROVED COLOUR AND STYLE OF PRECAST PAVERS AS SPECIFIED ON PLAN

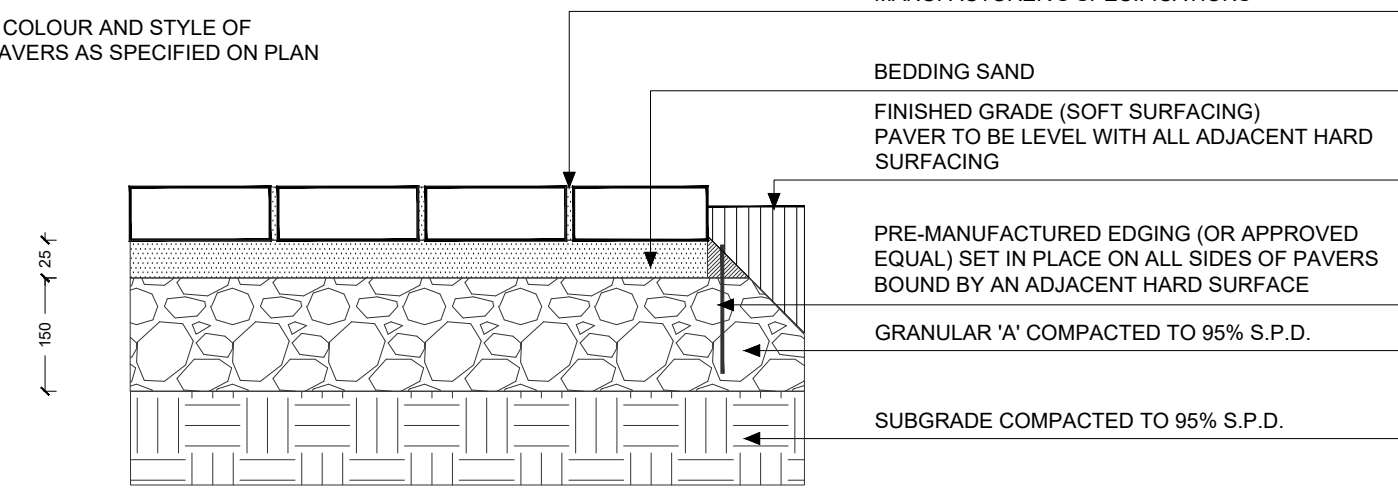

BUTT JOINTS TIGHT IN LAYING PATTERN AS DICTATED BY DESIGN  
BROOM SWEEP POLYMERIC SAND INTO ALL JOINTS AFTER INSTALLATION AS PER MANUFACTURER'S SPECIFICATIONS

FINISHED GRADE (SOFT SURFACING) PAVES TO BE LEVEL WITH ALL ADJACENT HARD SURFACING

PRE-MANUFACTURED EDGING (OR APPROVED EQUAL) SET IN PLACE ON ALL SIDES OF PAVERS BOUND BY AN ADJACENT HARD SURFACE

GRANULAR 'A' COMPACTED TO 95% S.P.D.

SUBGRADE COMPACTED TO 95% S.P.D.

ALL DIMENSIONS IN MILLIMETRES UNLESS OTHERWISE NOTED

**4 CONCRETE UNIT PAVER DETAIL**

TYPICAL PEDESTRIAN INSTALLATION ON GRANULAR BASE  
NTS

BPD HS101-230105

**NOTES:**

REMOVE ALL STRAPS, ROPES, TAGS, CONTAINERS, AND TREE WRAP ARE REMOVED PRIOR INSTALLATION

ALL STAKES, HOSES AND WIRES ARE TO BE REMOVED BY THE CONTRACTOR PRIOR TO FINAL ACCEPTANCE

ALL DIMENSIONS ARE IN MILLIMETERS UNLESS OTHERWISE NOTED

SET ROOT BALL IN TREE PIT AND ENSURE TRUNK FLARE IS 50mm ABOVE FINISHED GRADE

FINISHED GRADE

CUT AND REMOVE TOP 1/3 OF BURLAP. ROPE AND WIRE FROM ROOT BALL ONCE TREE IS POSITIONED

SCARIFY, IRRIGATE AND FERTILIZE THE TREE PIT PRIOR TO PLANTING

PROVIDE 75mm SOIL MOUND AT BASE OF PIT AS SHOWN

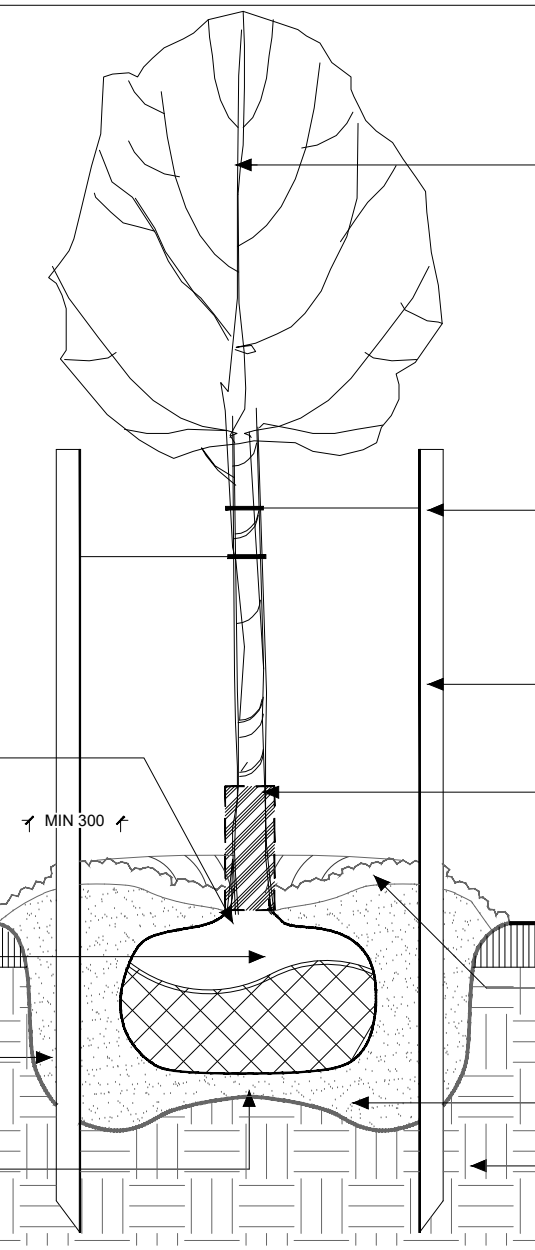

DO NOT CUT LEADER  
PRUNE DEAD OR DYING BRANCHES USING INDUSTRY STANDARD METHODS  
MAINTAIN ORIGINAL SHAPE OF TREE

SECURE TREE STAKES TO TREE USING 12 Ga. WIRE IN 12mm dia. RUBBER HOSE OR ARBORITE

INSTALL TWO SPRUCE STAKES (38mm x 38mm) MIN 2100mm LONG ON THE PREVAILING WIND SIDE  
STAKES TO BE VERTICAL AND DRIVEN INTO THE UNDISTURBED SOIL OUTSIDE OF THE ROOT BALL AS SHOWN

PROVIDE APPROVED RODENT GUARD WHERE REQUIRED

CONSTRUCT 100mm SOIL SAUCER AROUND TREE AND COVER WITH 75mm SHREDED WOOD MULCH  
KEEP MULCH BACK 50mm FROM TRUNK FLARE

BACKFILL SOIL MIXTURE AND FIRMLY COMPACT TO ELIMINATE AIR POCKETS AND PREVENT SETTLEMENT

COMPACTED SUBGRADE

**1 DECIDUOUS TREE PLANTING DETAIL**

TYPICAL INSTALLATION FOR 75mm CALIPER TREES OR LESS  
NTS

BPD P101-230105

**NOTES:**

SHRUBS SHALL BE IN CONTINUOUS BEDS AS SHOWN ON PLAN WITH SPACING AS NOTED IN THE PLANT LIST

SHRUBS HEIGHT SHALL BE MEASURED FROM FINISHED GRADE TO UPPER BRANCHES OF THE MAIN MASS

ALL DIMENSIONS ARE IN MILLIMETERS UNLESS OTHERWISE NOTED

**INSTALLATION METHOD:**

CONTAINER: CUT AND REMOVE ALL CONTAINERS, STRINGS, BURLAP ETC.

BARE ROOT: SPREAD ROOTS EVENLY OVER TAMPED SOIL. WORK SOIL INTO THE ROOTS.

BURLAP: CUT AND REMOVE TOP 1/3 OF BURLAP. ROPE AND WIRE FROM THE ROOT BALL ONCE SHRUB IS POSITIONED.

SET SHRUB 50mm HIGHER THAN ADJACENT FINISHED GRADE TO ALLOW FOR SETTLEMENT

FINISHED GRADE

SCARIFY, IRRIGATE AND FERTILIZE THE PIT PRIOR TO PLANTING

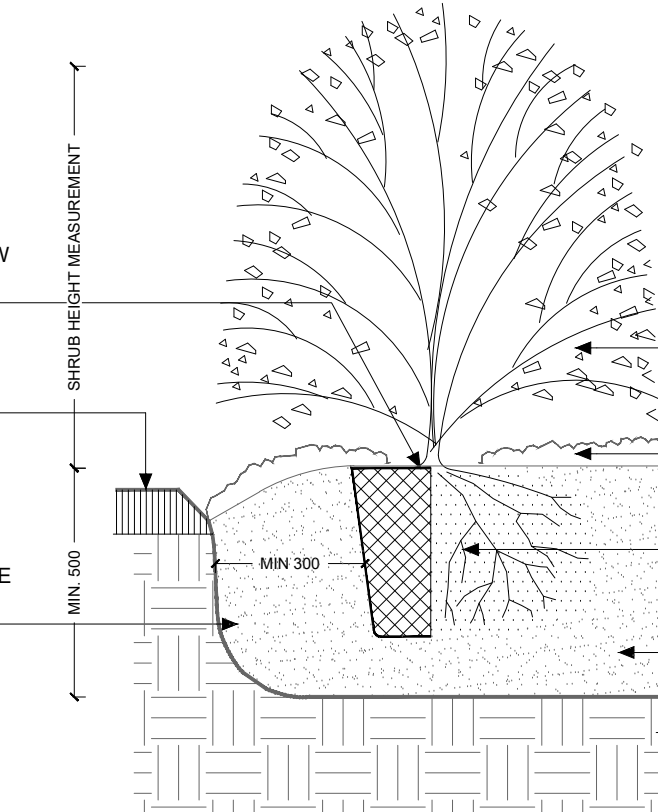

PRUNE DEAD OR DYING BRANCHES USING INDUSTRY STANDARD METHODS  
MAINTAIN ORIGINAL SHAPE OF SHRUB

COVER WITH 75mm SHREDED WOOD MULCH OVER ENTIRE PLANTING BED  
KEEP MULCH 50mm BACK FROM STEMS

REMOVE POTS AND PLANT WRAP  
LOOSEN ROOTS IF PLANT IS CONTAINER OR BURLAP GROWN

BACKFILL SOIL MIXTURE AND FIRMLY COMPACT TO ELIMINATE AIR POCKETS AND PREVENT SETTLEMENT

COMPACTED SUBGRADE

**2 SHRUB PLANTING DETAIL**

TYPICAL INSTALLATION  
NTS

BPD P103-230105

**NOTES:**

MODEL & COLOUR - TBD (UPON SPA APPROVAL AND PRIOR TO CONSTRUCTION)

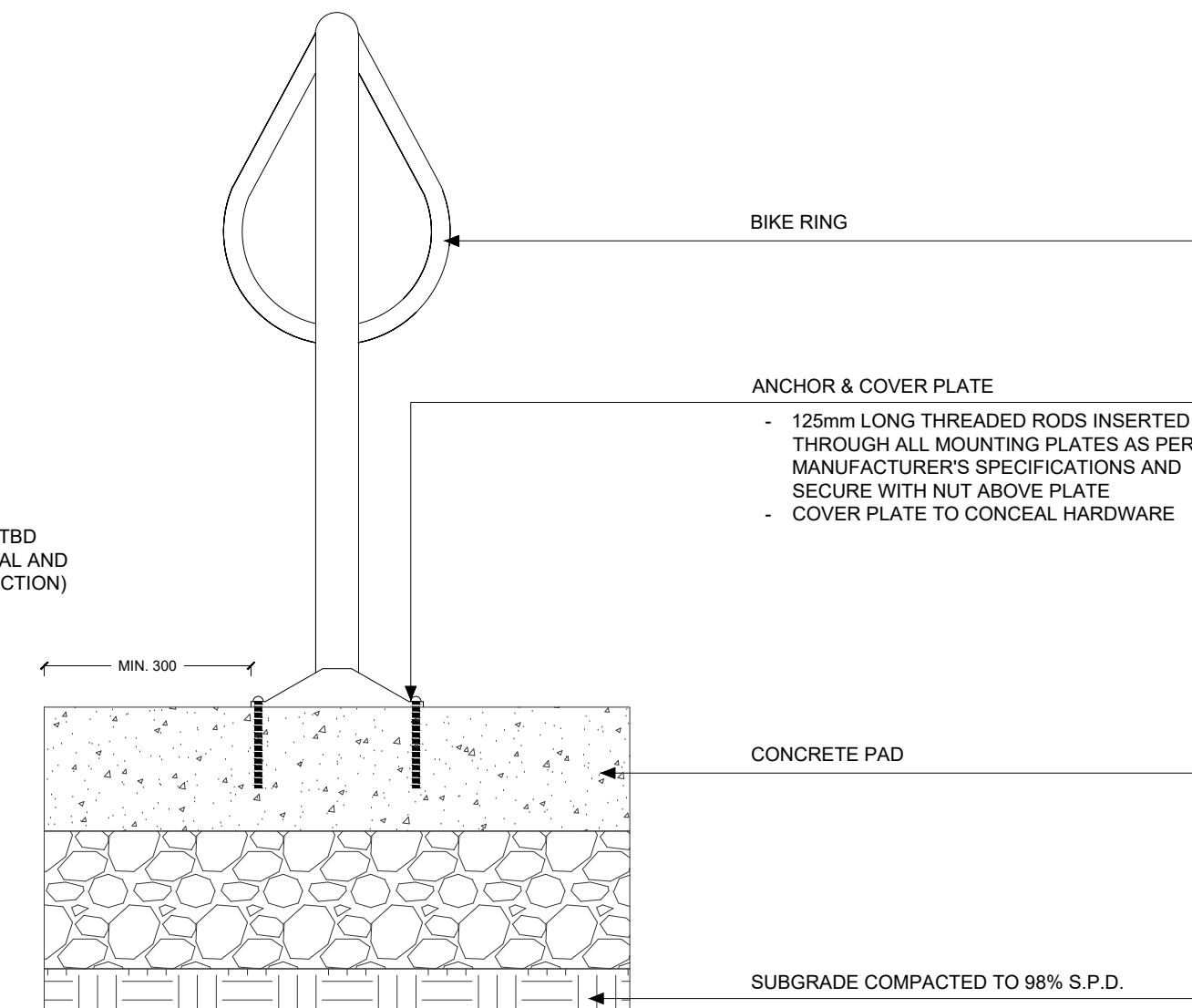

ANCHOR & COVER PLATE  
- 125mm LONG THREADED RODS INSERTED THROUGH ALL MOUNTING PLATES AS PER MANUFACTURER'S SPECIFICATIONS AND SECURE WITH NUT ABOVE PLATE  
- COVER PLATE TO CONCEAL HARDWARE

CONCRETE PAD

SUBGRADE COMPACTED TO 98% S.P.D.

ALL DIMENSIONS IN MILLIMETERS UNLESS OTHERWISE NOTED

**5 BIKE RING - SURFACE MOUNT (CONCRETE PAVING)**

TYPICAL INSTALLATION ON UNIT PAVERS  
NTS

BPD AM103-241218

**NOTES:**

ADJUST PLANT BED SIZE TO SUIT PLANT QUANTITIES.

SOD SHALL NOT ENCROACH MINIMUM SETBACK DIMENSIONS NOTED.

PLANTING BED / SOD EDGE SHALL BE A CONTINUOUS, CLEAN CUT, UNWAVERING LINE.

ALL DIMENSIONS ARE IN MILLIMETERS

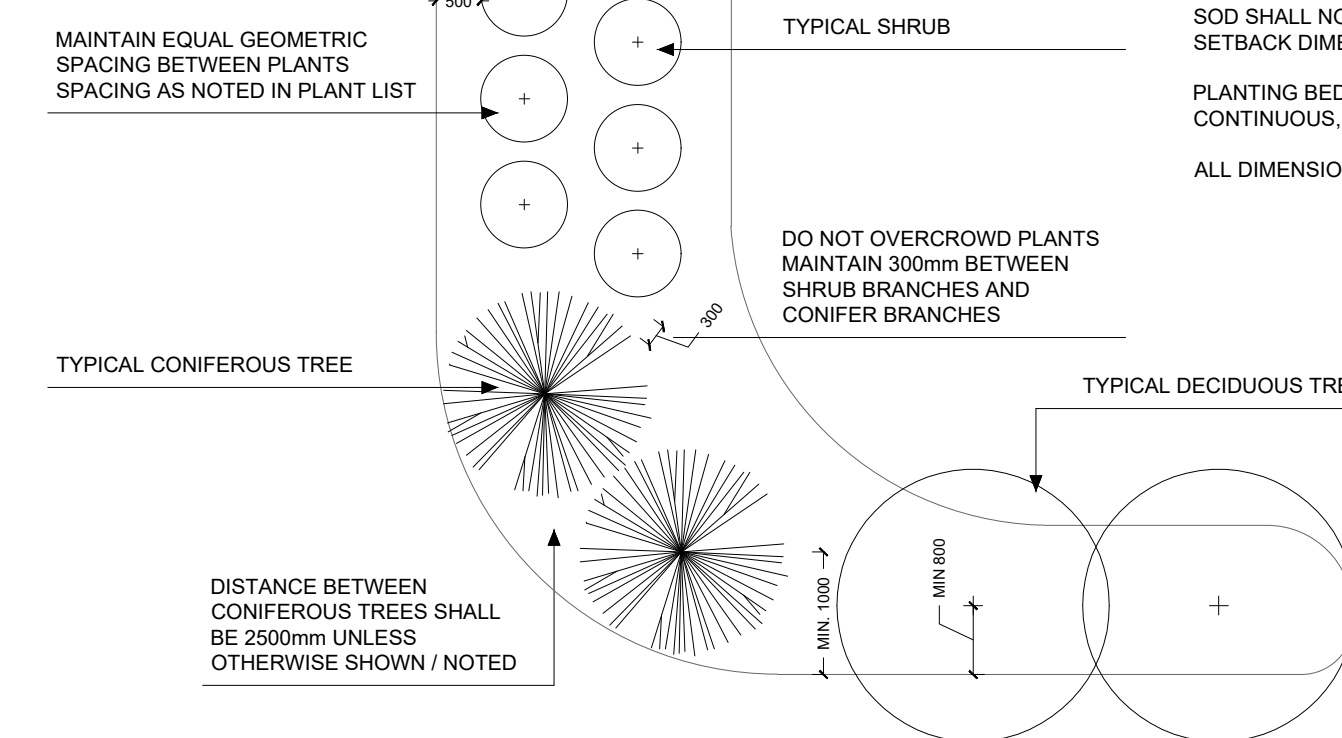

DO NOT OVERCROWD PLANTS  
MAINTAIN 300mm BETWEEN SHRUB BRANCHES AND CONIFER BRANCHES

DISTANCE BETWEEN CONIFEROUS TREES SHALL BE 2500mm UNLESS OTHERWISE SHOWN / NOTED

**3 TYPICAL PLANTING LAYOUT - LAWN AREA**

SYMBOLS REPRESENT INSTALLED PLANT SIZE  
NTS

BPD P100-230106

**NOTES:**

ROCKS TO BE ARMOUR STONE.

FULL SIZE: MIN. 800 WIDE x 1000 LONG x 700 HIGH  
HALF SIZE: MIN. 600 WIDE x 600 LONG x 700 HIGH

NATURAL GREY COLOUR FROM LOCAL QUARRY  
NATURAL FACE OUTWARD AND POSITION TO THE APPROVAL OF OWNER

ALL DIMENSIONS ARE IN MILLIMETERS UNLESS OTHERWISE NOTED

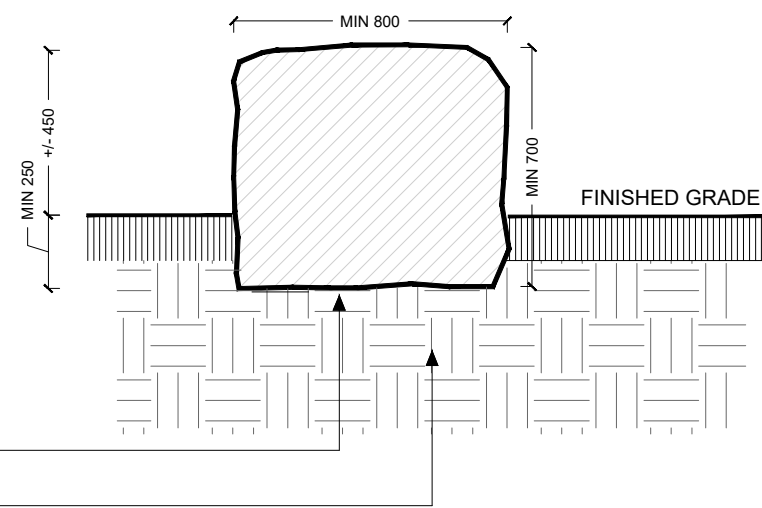

**6 ROCKERY STONE DETAIL**

SINGLE TIER AT GRADE  
NTS

BPD HS100-230105

**APPROVAL BLOCK**

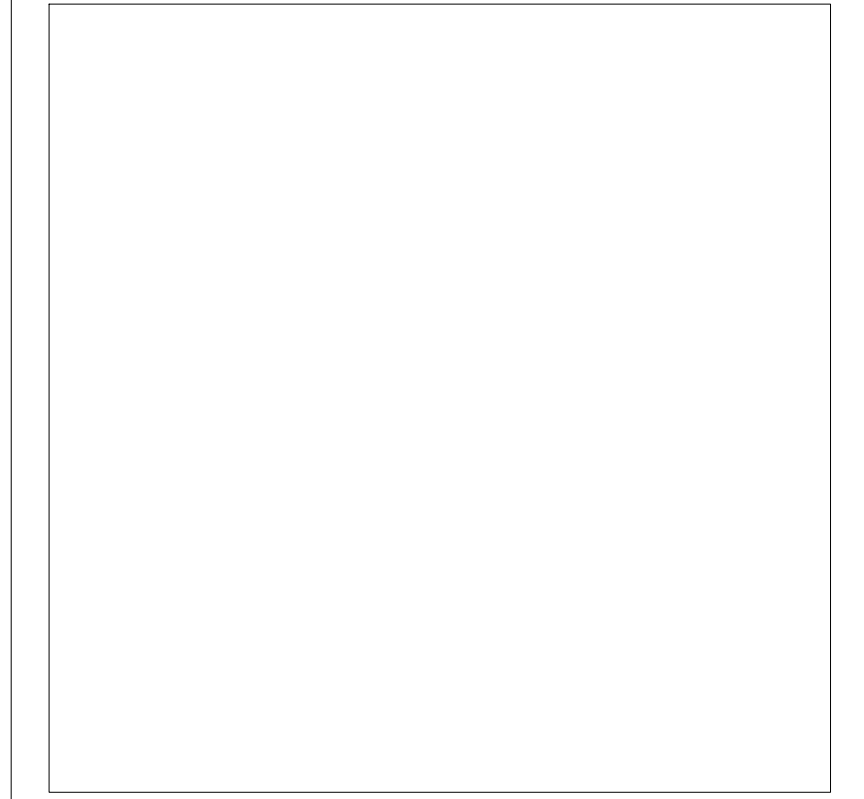

no.	date	revision	by
3	MAY 4 2026	ISSUED FOR SPA RE-SUBMISSION	MB
2a	DEC 2 2025	ISSUED FOR SPA RE-SUBMISSION	MB
	SEPT 23 2025	ISSUED FOR SPA RE-SUBMISSION	MB
2	JULY 10 2025	ISSUED FOR SPA RE-SUBMISSION	MB
1	DEC 19 2024	ISSUED FOR SPA SUBMISSION	SG

**byPATH:**  
landscape architecture

4933 Old Brock Road  
Claremont, Ontario  
info@bypath.ca  
647-545-5809



These plans are the property of byPATH: landscape architecture inc. They may not be altered, revised, or modified in any way without the written consent of byPATH: landscape architecture inc.  
All information hereon to be checked and verified on site by the landscape contractor. Any discrepancies must be reported to, and clarified by the landscape architect before commencing work.

project  
**COMMERCIAL DEVELOPMENT**

BRONTE AND CHARLES CORNWALL  
OAKVILLE, ONTARIO

drawing  
**LANDSCAPE DETAILS**

file start date	NOVEMBER, 2024	by	SG
scale*	AS SHOWN	file	2298 V3-260504
direction		project no.	2298
		sheet no.	L200

**SPECIFICATIONS:**

**GENERAL:**

These specifications are to be read in conjunction with the general conditions of the contract as prepared by the consultant team.

Prior to commencing work, the contractor shall:

1. Familiarize himself with the plans, details, and specifications of this contract
2. Visit the site to complete an inventory of existing conditions and provide written documentation, to the Landscape Architect, of any deviations from the plans in work by others,
3. Review and document the condition of curbs, sidewalks, street trees and utilities located in the right-of-way prior to the start of construction, and
4. Finalize any design alternatives in consultation with the Landscape Architect.

All work shall be performed in accordance with the Occupational Health and Safety Act. All work shall conform to the Canadian National Master Construction Specifications.

The contractor shall make every effort to protect all iron bars. Any disturbed bars shall be replaced by the owner at the contractors expense. All temporary protective and sediment control fencing shall be maintained by the contractor for the duration of construction.

The contractor shall be responsible for the roadway being cleaned daily.

The site shall be maintained in a clean and orderly fashion for the duration of construction.

It is the responsibility of the contractor to contact utility companies for all utility locates prior to construction. The contractor shall be responsible for any damage caused to existing utilities, structures, facilities etc. during the performance of his work, and repair any damage at his own expense.

In the event of a conflict between a proposed tree and a utility, both above or below grade, the exact location of the tree shall be determined on site by the Landscape Architect.

**SOFT LANDSCAPING:**

Plant Material:

All plants shall be installed true to specified names, sizes, quantities and remarks in the plant list. Any substitution shall be approved by the Landscape Architect in writing prior to the delivery of the material on site.

All plant material shall be nursery grown, in accordance with the Canadian Nursery Trades Association "Canadian Standards and Specifications for Nursery Stock" (current edition).

The Landscape Architect reserves the right to inspect all plant material prior to installation and reject any plant material that does not meet the standards listed. Any rejected plant material shall be replaced at the expense of the contractor.

Upon completion of work, the Landscape Architect may reject plant material that does not conform to the specifications.

The contractor shall use standard industry methods for planting trees, and they shall be in accordance with the typical planting details provided herein. Trees shall possess one central, straight leader and shall be turned to give the best appearance.

All plant material shall be structurally sound, healthy, in vigorous growing condition, well branched and densely foliated when in leaf. Plant material shall be free of any disease, decay, or damage.

Bed Preparation

The contractor shall backfill tree pits and planting beds to specified depths with nursery grade triple mix or soil with evenly mixed 6 parts sandy loam, 1 part peat moss and 1 part well rotted farm manure. The topsoil shall be fertile and capable of supporting healthy plant growth. The contractor shall construct tree pits and shrub beds in accordance with the typical planting details herein.

The topsoil shall be fine-graded to achieve a uniform surface.

The contractor shall construct shrub beds in continuous forms.

Topsoil and Fine Grading:

The contractor shall place 150mm of topsoil on approved sub grades. Topsoil shall be imported when required. Minor grade irregularities shall be eliminated prior to sodding.

Sodding:

The contractor shall sod all areas as specified on the drawings. Sod shall be 50-75mm thick, freshly cut no. 1 grade nursery grown turf.

Sod for sunny, exposed areas:

- 50% Kentucky Bluegrass
- 50% Merino Bluegrass

Sod for shaded areas:

- 50% Nugget Kentucky Bluegrass
- 50% Creeping Red Fescue

Sod shall be placed on prepared topsoil. Joints shall be tightly abutted and staggered. Freshly laid sod shall be machine rolled and watered immediately after installation.

Sod on slopes shall be pegged where required.

Hydroseeding:

The contractor shall apply the specified seed mixture using accepted industry methods for hydroseeding. The type and rate of fertilizer application shall be as recommended by the supplier.

The area seeded in a single day shall not exceed the area that can be mulched in the same day.

The contractor shall apply fibre mulch over the newly seeded area to form a uniform ground cover that allows the percolation of water.

Seeded areas are to be kept moist for 4-6 weeks during the period of germination.

Follow-up overseeding is part of this work.

Terraseeding

The contractor shall apply the specified seed mixture using accepted industry methods for terraseeding. The type and rate of fertilizer application shall be as recommended by the supplier.

Seed depth shall be as follows:

- 0-5% slope: 10-15mm depth
- 5-10% slope: 15-20mm depth
- 10-25% slope: (4:1) 20-25mm depth
- 25-35% slope: (3:1) 25-40mm depth
- 35-45% slope: 40-50mm depth

Seeded areas are to be kept moist for 4-6 weeks during the period of germination.

Follow-up overseeding is part of this work.

**MAINTENANCE, GUARANTEE AND COMPLETION:**

Maintenance:

The contractor shall maintain all landscaped areas for a period of four growing months from the date of substantial completion.

Maintenance shall include all necessary measures to ensure the health and vitality of all plant material and soft landscaping. Maintenance shall include, but not be limited to, irrigation, grass mowing, weeding, pruning of dead branches, maintenance of all accessories (ie: tree stakes and guy wires), insect and disease control.

At the end of the maintenance period, provided all plant material is alive and in good growing condition, the owner will assume the responsibility of maintaining the landscape work.

Performance Acceptance (Substantial Completion):

The Landscape Architect shall provide written notice of performance acceptance for substantial completion. This shall mark the start of the guarantee period.

If required by the municipality, the Landscape Architect will submit a notice of substantial completion, so the municipality may proceed to inspect, issue their performance acceptance certificate, and reduce the amount of securities.

At the time of inspection by both the Landscape Architect and the municipality, all tree pits and planting beds shall be freshly cultivated, well mulched, free of any damaged branches and weeds, and have a clean spade bed edge.

Guarantee:

Plant material and all other soft landscaping shall be guaranteed for one year from the date on the Landscape Architect's performance acceptance certificate.

Plant material and soft landscaping that has expired or fails to thrive during the guarantee period shall be replaced at the expense of the contractor.

All other landscape work performed under this contract shall be fully guaranteed for one year from the date on the Landscape Architect's performance acceptance certificate.

Final Acceptance:

All work shall be inspected at the end of the guarantee period by the Landscape Architect. Any deficiencies shall be rectified by the contractor to the satisfaction of the Landscape Architect and the owner. Once satisfactorily complete, the Landscape Architect shall issue a final acceptance certificate.

If required by the municipality, the Landscape Architect will submit a notice of final acceptance, so that the municipality may inspect, issue their final acceptance certificate, and release any outstanding landscape securities.

All tree stakes, guy wires, tree wrap, and any other accessories shall be removed prior to final inspections.

At the time of inspection by both the Landscape Architect and the municipality, all tree pits and planting beds shall be freshly cultivated, well mulched, free of any damaged branches and weeds, and have a clean spade bed edge.

**APPROVAL BLOCK**

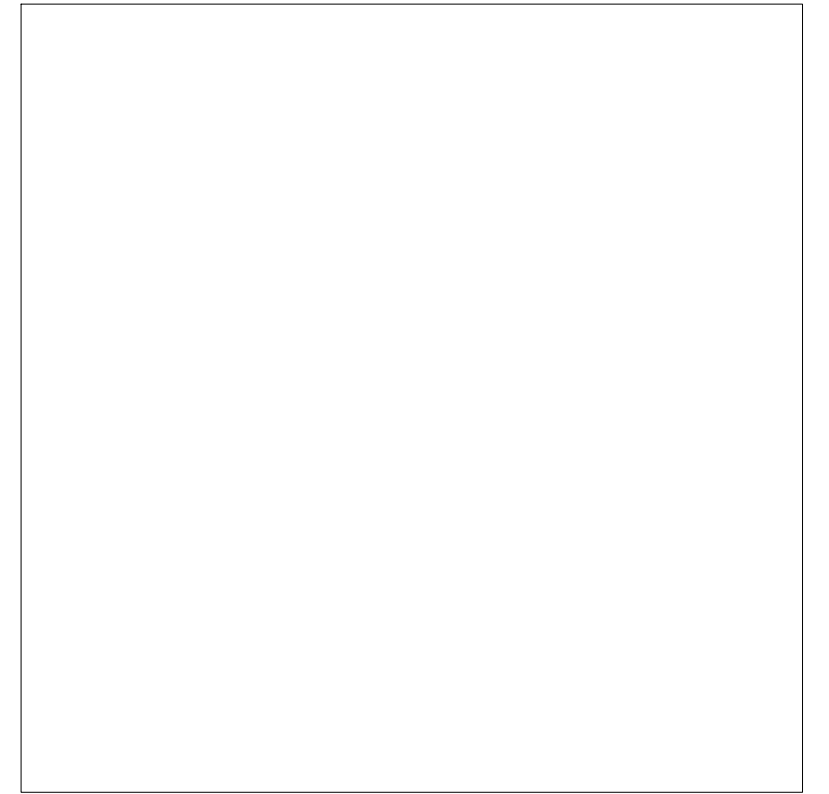

no.	date	revision	by
3	MAY 4 2026	ISSUED FOR SPA RE-SUBMISSION	MB
2a	DEC 2 2025	ISSUED FOR SPA RE-SUBMISSION	MB
	SEPT 23 2025	ISSUED FOR SPA RE-SUBMISSION	MB
2	JULY 10 2025	ISSUED FOR SPA RE-SUBMISSION	MB
1	DEC 19 2024	ISSUED FOR SPA SUBMISSION	SG

**byPATH: landscape architecture**

4933 Old Brock Road  
Claremont, Ontario  
info@bypath.ca  
647-545-6809



These plans are the property of byPATH: landscape architecture inc. They may not be altered, revised, or modified in any way without the written consent of byPATH: landscape architecture inc. All information hereon to be checked and verified on site by the landscape contractor. Any discrepancies must be reported to, and clarified by the landscape architect before commencing work.

**project**  
**COMMERCIAL DEVELOPMENT**

**BRONTE AND CHARLES CORNWALL  
OAKVILLE, ONTARIO**

**drawing**  
**LANDSCAPE NOTES  
AND SPECIFICATIONS**

file start date	NOVEMBER, 2024	by	SG
scale*	AS SHOWN	file	2298 V3-260504
direction	project no.  2298 sheet no. <b>L201</b>		

**MASTER PLANT LIST**

KEY	QTY.	BOTANICAL NAME	COMMON NAME	CALIPER	HEIGHT	SPREAD	ROOT	NOTES	SPACING	NATIVE
<b>DECIDUOUS TREE PLANTING</b>										
CC	4	CERCIS CANADENSIS	EASTERN REDBUD	60mm	3000mm	1200mm	SB	EQUAL FORM	----	YES
GD	9	GYMNOCLADUS DIOICUS	KENTUCKY COFFEE TREE	60mm	3000mm	1200mm	SB	EQUAL FORM	----	YES
LT	9	LIRIODENDRON TULIPIFERA	TULIP TREE	60mm	3000mm	1200mm	SB	EQUAL FORM	----	YES
<b>ORNAMENTAL TREE PLANTING</b>										
PD	10	AMELANCHIER X GRANDIFLORA 'PRINCESS DIANA'	PRINCESS DIANA SERVICEBERRY	40mm	2500mm	1000mm	SB	MULTI-STEM	----	NO
<b>EVERGREEN SHRUBS</b>										
jcv	33	JUNIPERUS CHINENSIS SARGENTI 'VIRIDIS'	GREEN SARGENT JUNIPER	----	600mm	----	POTTED	MIN. 15 CANDLES	850mm	NO
tmd	30	TAXUS X MEDIA 'DENSIFORMIS'	DENSE YEW	----	600mm	----	POTTED	MIN. 15 CANDLES	850mm	YES
<b>DECIDUOUS SHRUBS</b>										
csk	72	CORNUS SERICEA 'KELSEY'	KELSEY RED OSIER DOGWOOD	----	----	500mm	POTTED	MIN 10 STEMS	600mm	YES
ram	100	RIBES ALPINUM	ALPINE CURRANT	----	----	500mm	POTTED	MIN 10 STEMS	850mm	NO
ror	70	ROSA RUGOSA	RUGOSA ROSE	----	----	500mm	POTTED	MIN 10 STEMS	700mm	NO
spn	40	SALIX PURPUREA 'NANA'	BLUE ARCTIC WILLOW	----	----	500mm	POTTED	MIN 10 STEMS	700mm	YES
<b>PERENNIALS &amp; GRASSES</b>										
cak	220	CALAMAGROSTIS ACUTIFLORA 'KARL FOERSTER'	KARL FOERSTER FEATHER REED GRASS	----	----	----	1 GAL POT	MIN 2 YRS GTH	750mm	NO
hsd	145	HEMEROCALLIS 'STELLA D'ORO'	STELLA D'ORO DAYLILY	----	----	----	1 GAL POT	MIN 2 YRS GTH	500mm	NO
pal	105	PENNISETUM ALOPECUROIDES 'LITTLE BUNNY'	MINITURE FOUNTAIN GRASS	----	----	----	1 GAL POT	MIN 2 YRS GTH	450mm	NO

*\*IN THE EVENT OF A DISCREPANCY BETWEEN THE PLANTING PLAN AND THE PLANT LIST, THE PLANTING PLAN SHALL GOVERN*