

Park Development Drawings - NOT FOR CONSTRUCTION

North Park Development: Community Centre, Library and Sports Park

Town of Oakville

MBTW Job No.: TOA039

LIST OF DRAWINGS

LANDSCAPE DRAWINGS (MBTW)	
C-1	COVER SHEET
TP-1	TREE PRESERVATION AND REMOVALS PLAN
TP-2	TREE INVENTORY AND PRESERVATION DETAILS
TP-3	TREE INVENTORY AND PRESERVATION DETAILS
L-1	LAYOUT PLAN
L-2	GRADING PLAN
L-3	SUB-DRAINAGE PLAN
L-4	PARK PLANTING PLAN
L-5	TREE CANOPY PLAN
L-6	COURTS AREA PLAN
D-1	LANDSCAPE DETAILS
D-2	LANDSCAPE DETAILS
D-3	LANDSCAPE DETAILS
D-4	LANDSCAPE DETAILS
D-5	LANDSCAPE DETAILS
D-6	LANDSCAPE DETAILS
D-7	LANDSCAPE DETAILS
D-8	LANDSCAPE DETAILS

REFERENCE PLAN



SCALE - N.T.S.

KEY PLAN



SUBMISSIONS AND REVISIONS

- | | |
|---------------|---------------------------------|
| 1. 01.26.2022 | Issued for Coordination |
| 2. 02.04.2022 | Issued for SPA (1st Submission) |

CLIENT:



CONSULTANTS:

LANDSCAPE ARCHITECT (PRIME CONSULTANT)



CIVIL & ELECTRICAL ENGINEER



IRRIGATION CONSULTANT



ARCHITECT



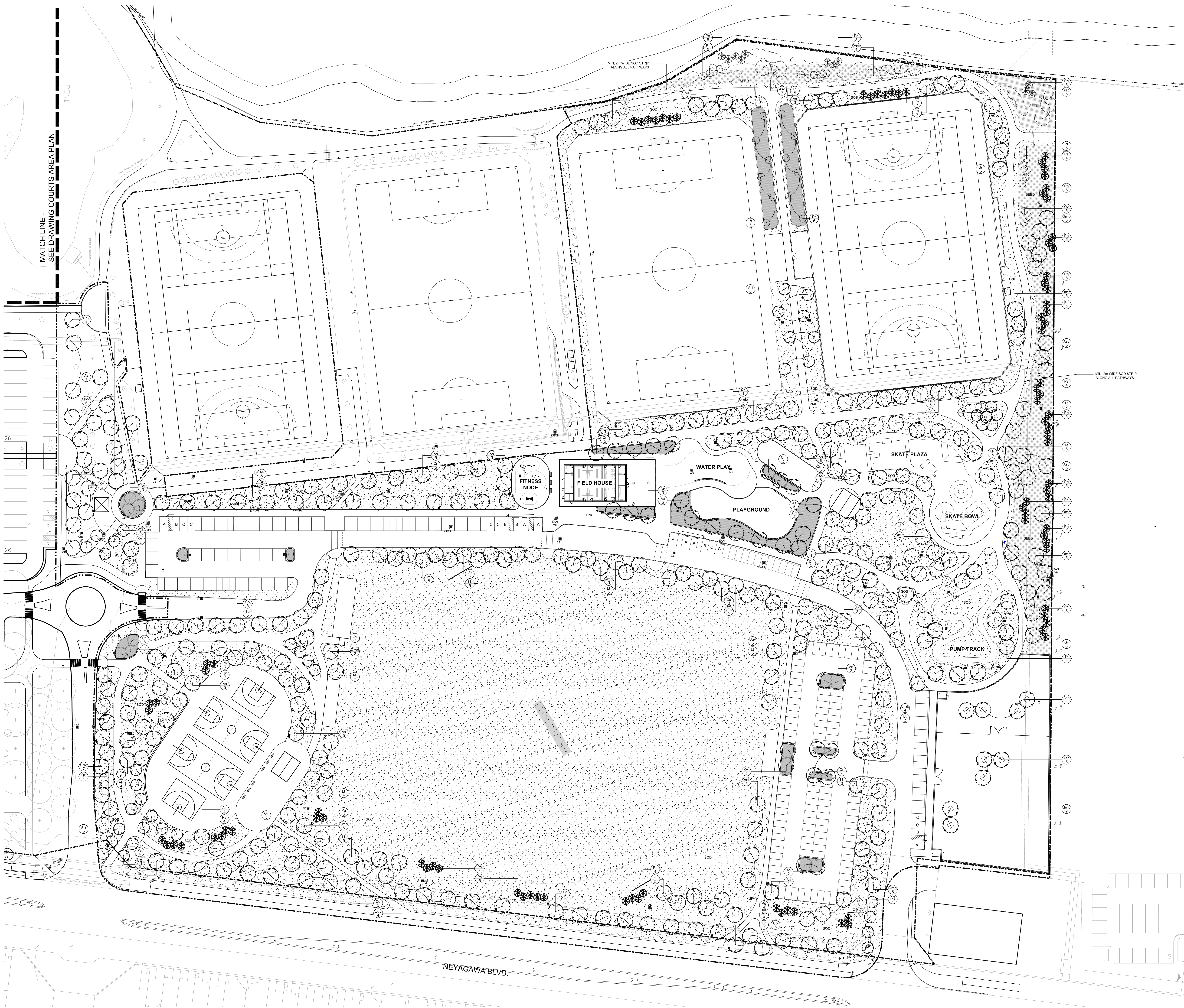

Key Plan - N.T.S.



- Legend
- DEVELOPMENT BOUNDARY
 - - - LIMIT OF WORK
 - EXISTING DECIDUOUS TREE TO REMAIN
 - EXISTING CONIFEROUS TREE TO REMAIN
 - PROPOSED DECIDUOUS TREE
 - ⊗ PROPOSED CONIFEROUS TREE
 - PROPOSED AREA OF SOD
 - SEED PROPOSED AREA OF SEED
 - ▨ SHRUB BED EDGE

No	Date	Revisions	By
2	02/04/2022	Issued for SPA (1st Submission)	JJ
1	01/26/2022	Issued for Coordination	JJ

This drawing, as an instrument of service, is provided by, and is the property of, the MBTW Group. The recipient shall check and verify all dimensions and notes. All errors and omissions in the Landscape Architect's plans shall be corrected by the recipient before proceeding with the work. This drawing is not to be copied.

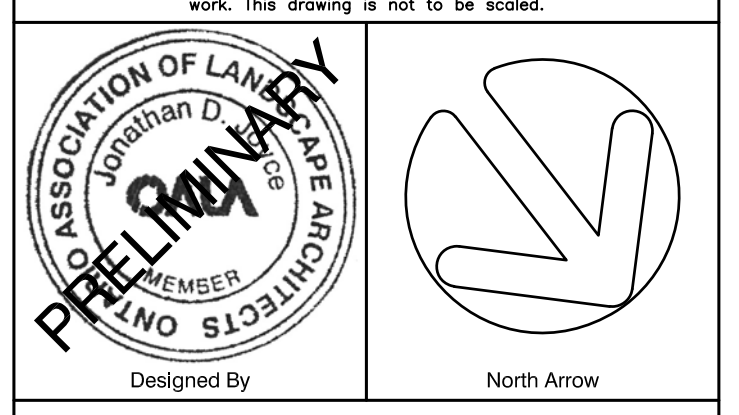

Client: **OAKVILLE**

Consultant: **the mbtw group**

Project Name: **NORTH PARK DEVELOPMENT: COMMUNITY CENTRE, LIBRARY AND SPORTS PARK**

Municipality: **Town of Oakville**

Sheet Title: **PARK PLANTING PLAN**

Designed: JJ	Drawn: OL	Scale: 1:500	Drawing No: L-4
Date of Drawing: November 2021	Job No: TOA039		

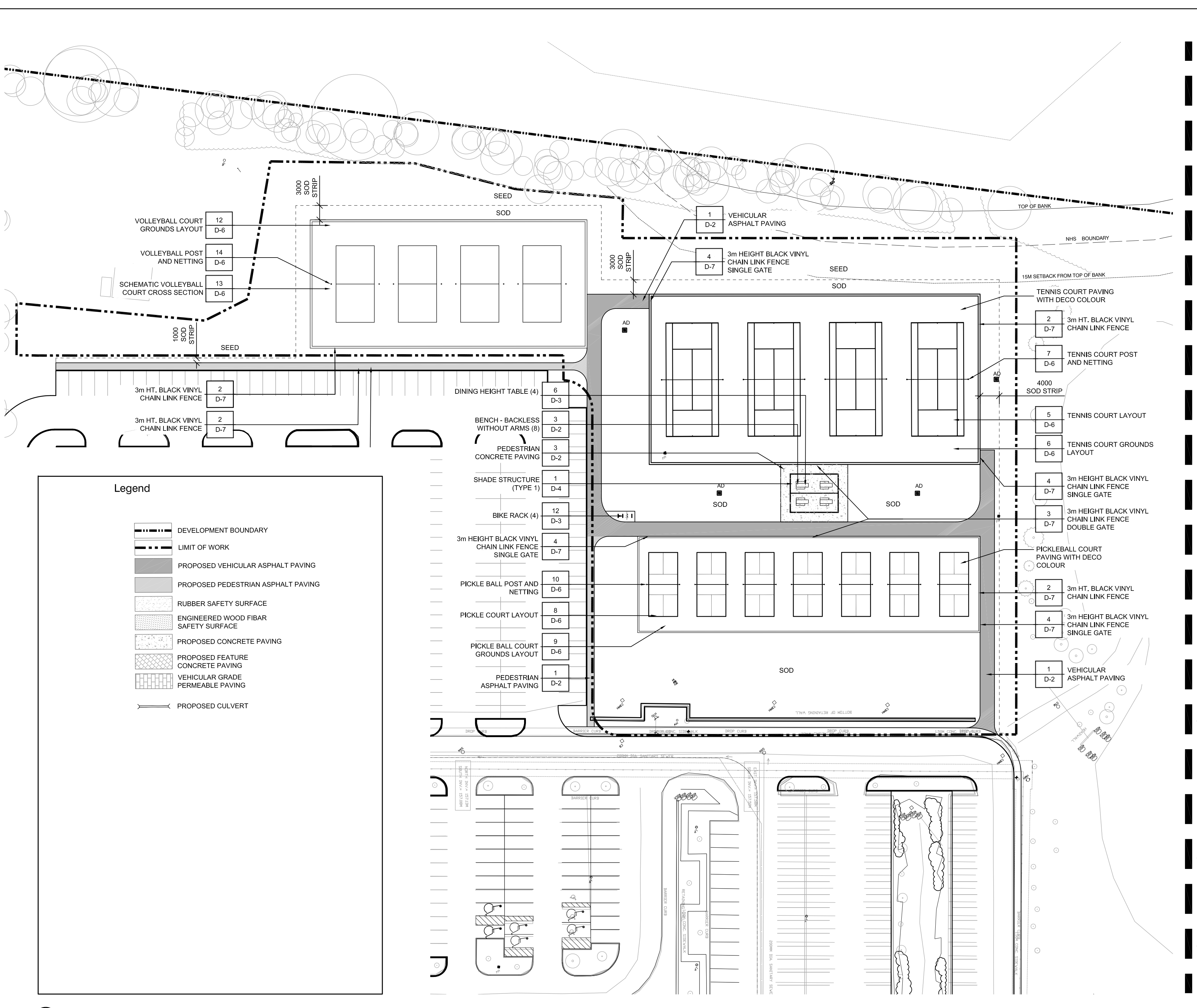

1 COURTS AREA LAYOUT PLAN 1:500

MATCHLINE - SEE PARK LAYOUT PLAN

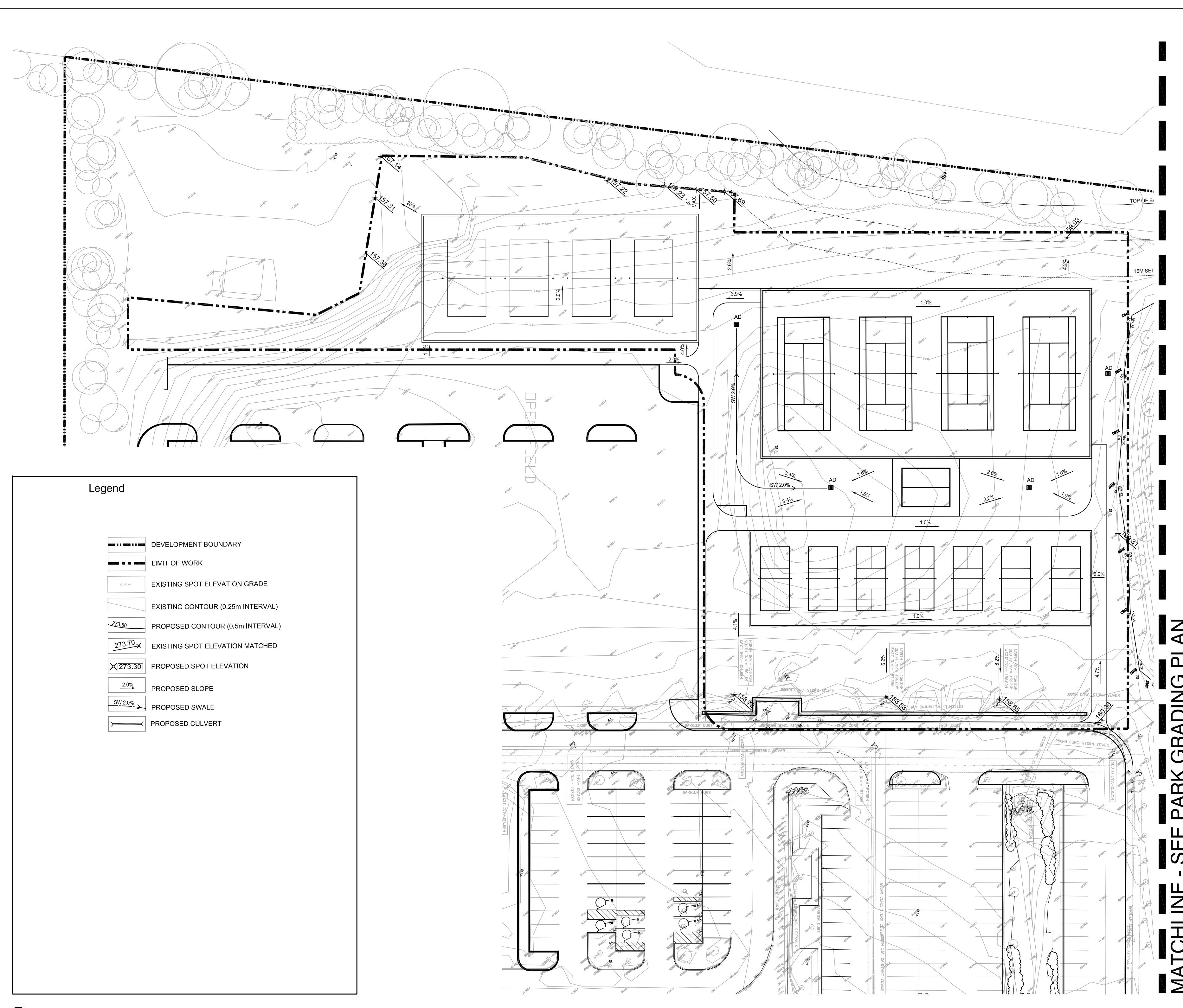

2 COURTS AREA GRADING PLAN 1:500

MATCHLINE - SEE PARK GRADING PLAN

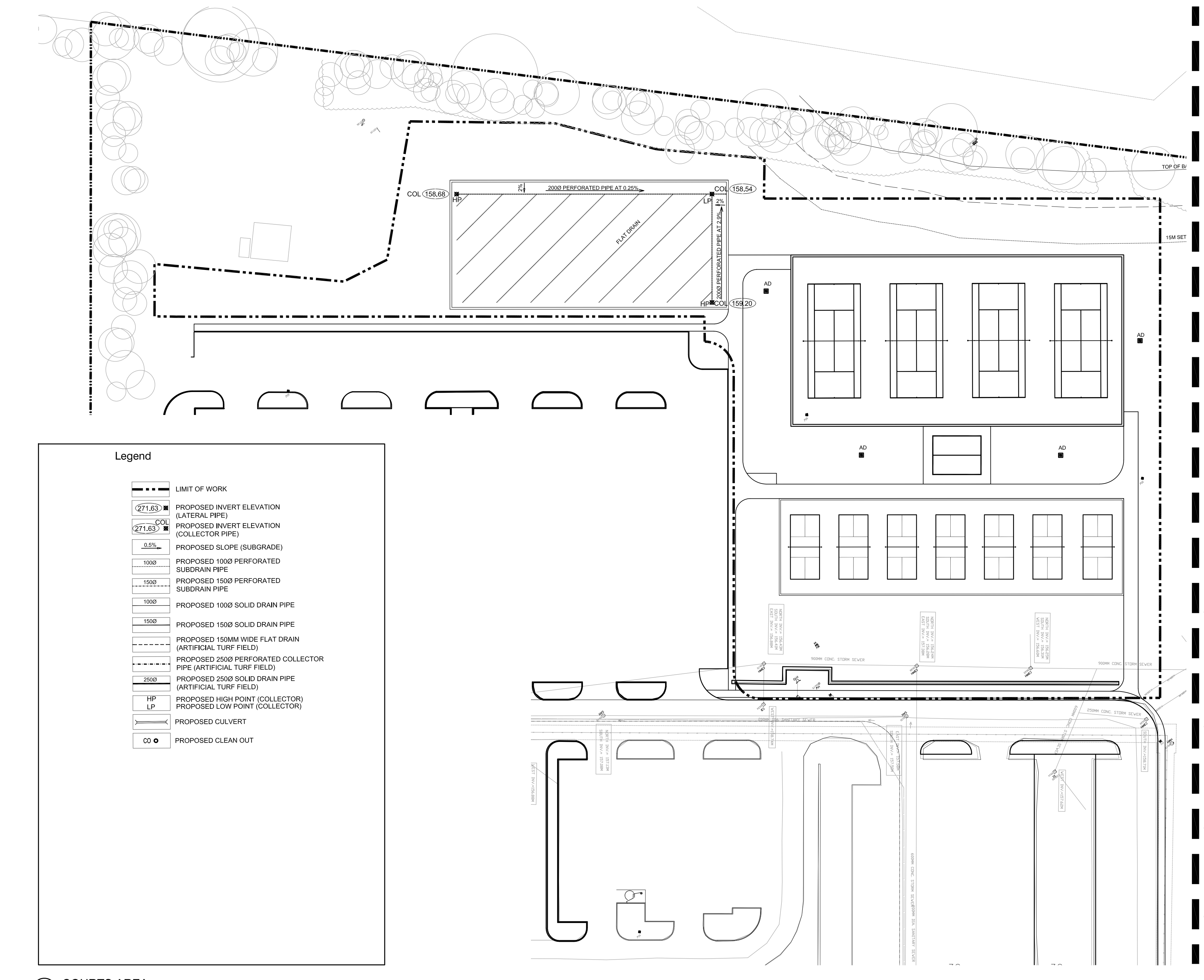

3 COURTS AREA SUBDRAINAGE PLAN 1:500

MATCHLINE - SEE PARK SUBDRAINAGE PLAN

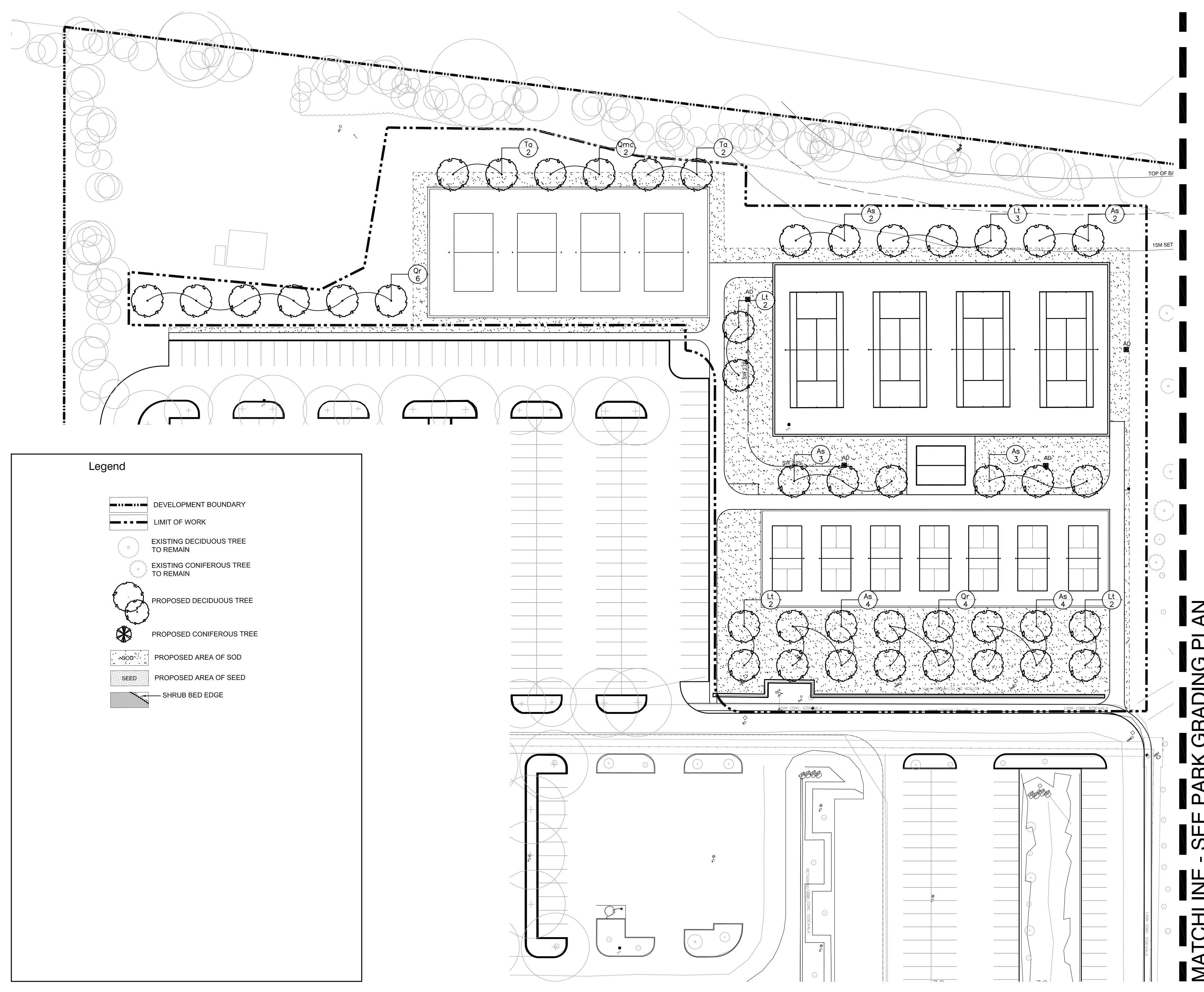

4 COURTS AREA PLANTING PLAN 1:500

MATCHLINE - SEE PARK GRADING PLAN



No.	Date	Revisions	By
2.	02/04/2022	Issued for SPA (1st Submission)	JJ
1.	01/26/2022	Issued for Coordination	JJ

This drawing, as an instrument of service, is provided to, and is the property of, the client. The contractor shall check and verify all dimensions and notes. All errors and omissions in the Landscape Architect's work shall be corrected by the contractor at their expense. All alterations and notes shall be referred to the drawing before proceeding with the work. This drawing is not to be scaled.

DESIGNATION OF LABELS

 Client: OAKVILLE
 Consultant: the mbt w group
 Project Name: NORTH PARK DEVELOPMENT: COMMUNITY CENTRE, LIBRARY AND SPORTS PARK
 Municipality: Town of Oakville
 Sheet Title: COURTS AREA PLAN

Designed: JJ	Drawn: OL	Scale: AS SHOWN	Drawing No.: L-6
Date of Drawing: November 2021	Job No.: TOA039		

LEGEND	
	CONCRETE SKATEPARK FOOTPRINT
	ASPHALT PUMP TRACK FOOTPRINT

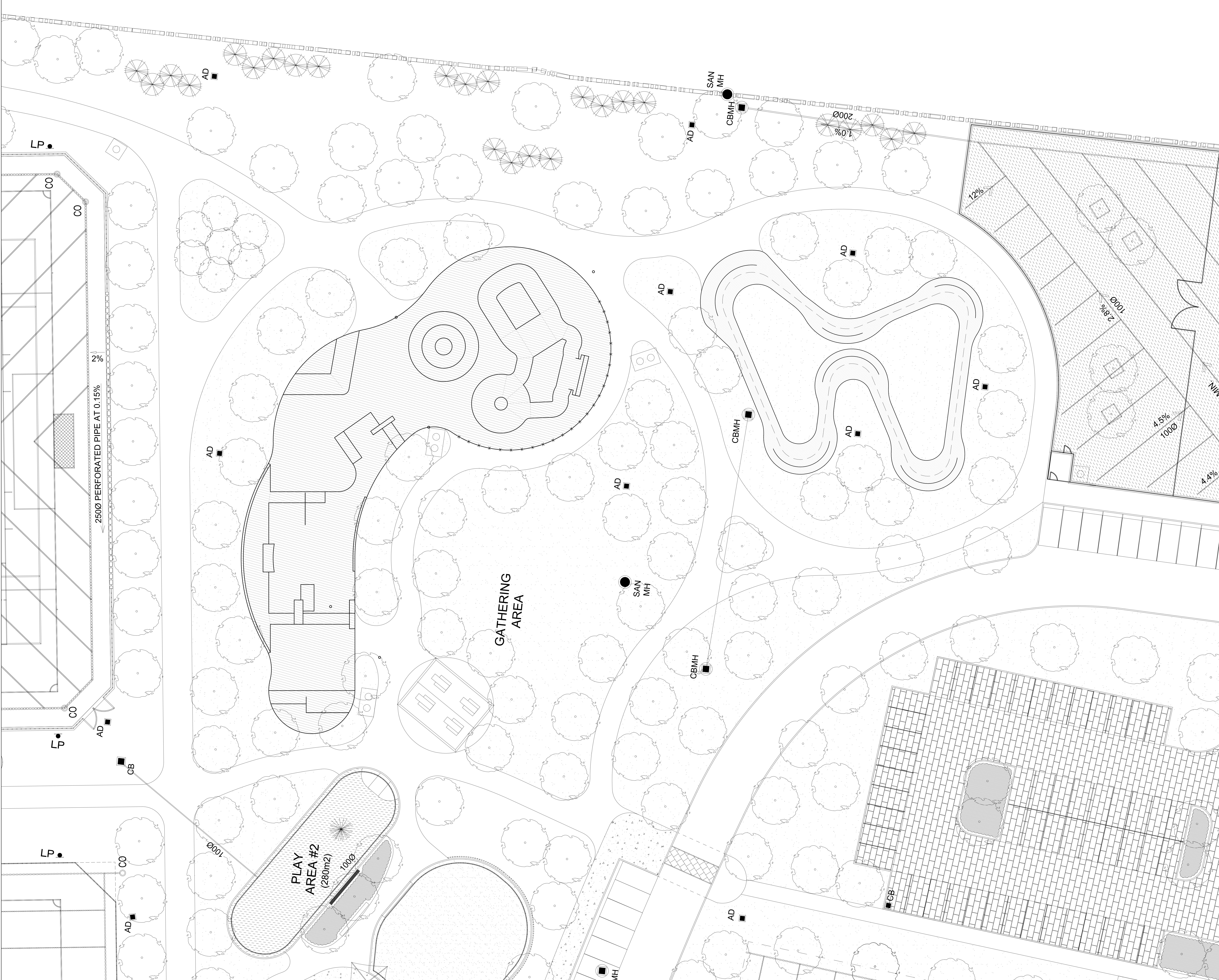

DATE	22.02.04	BY	JP	ISSUED FOR	SITE PLAN APPROVAL
<small>CONTRACTOR SHALL CHECK ALL DIMENSIONS ON THE WORK AND REPORT ANY DISCREPANCY TO THE CONSULTANT BEFORE PROCEEDING. ALL DRAWINGS AND SPECIFICATIONS ARE THE EXCLUSIVE PROPERTY OF NEW LINE SKATEPARKS INC. AND MUST BE RETURNED AT THE COMPLETION OF THE WORK.</small>					
PROJECT: NORTH PARK OAKVILLE SKATEPARK & PUMP TRACK					
LOCATION: OAKVILLE, ONTARIO					
DRAWN	JP	START			
CHECKED	SO	DATE	22.01.14		
APPROVED	BG				
DRAWING TITLE: SITE PLAN					
SCALE:	1:150	PAGE SIZE:	36"x48"		
PROJECT NUMBER:	CAN2020-024				
DRAWING NUMBER:	SK-003	REV	A		