

GENERAL NOTES:

- MAINTENANCE AND ACCEPTANCE:**
- ALL PLANT MATERIAL SHALL BE MAINTAINED BY THE CONTRACTOR IMMEDIATELY AFTER ANY PLANTING HAS BEEN INSTALLED AND SHALL CONTINUE UNTIL THE DATE OF FINAL ACCEPTANCE.
 - SUCH MAINTENANCE SHALL INCLUDE ALL MEASURES NECESSARY TO ESTABLISH AND MAINTAIN ALL PLANTS IN AN ACCEPTABLE, VIGOROUS AND HEALTHY GROWING CONDITION INCLUDING CULTIVATING AND WEEDING, WATERING, WHEN REQUIRED, PRUNING AND MAINTENANCE OF ALL ACCESSORIES.
 - AT TIME OF SPECIFICATIONS FOR NURSERY STOCK OF THE CANADIAN NURSERY TRADE ASSOCIATION WITH REGARD TO QUALITY AND GRADING AND SIZES AS PER PLANT LIST.
 - SPRAY ALL PLANTINGS IN LEAF WITH ANTIDESICCANT. PROVIDE TREES WITH STAKES.
 - PLANTS ARE TO BE PLANTED IN CONTINUOUS BEDS UNDER PROPER CULTURAL PRACTICES, IN PARTICULAR WITH RESPECT TO APPLICABLE PEST AND DISEASE CONTROL AND BRANCH AND ROOT TRAINING.
 - TREES ARE TO HAVE STURDY, STRAIGHT TRUNKS. TREES SHALL BE WELL BRANCHED AND BALANCED WITH A STRONG CENTRAL LEADER.
 - DECIDUOUS SHADE TREES SHALL BE FREE OF BRANCHES NOT LESS THAN 1.8m ABOVE THE GROUND.
 - ALL SHRUBS ARE TO BE PLANTED IN CONTINUOUS BEDS. DO NOT SOO BETWEEN PLANTS. EXCAVATE ENTIRE AREA OF SHRUB BED UNIFORM TO SPECIFIED DEPTH AND FILL WITH SPECIFIED PLANTING SOIL.

- UTILITIES:**
- APPLICANT IS RESPONSIBLE FOR OBTAINING NECESSARY APPROVALS FROM THE UTILITY COMPANIES FOR WORKS WITHIN THE MUNICIPAL BOULEVARD.
 - ALL UTILITIES WITHIN THE BOULEVARDS MUST BE LOCATED PRIOR TO COMMENCING CONSTRUCTION WITHIN THE BOULEVARD.

- UNIT PAVING:**
- PAVERS SHALL BE PRECAST CONCRETE UNIT PAVERS WITH MIN. 58.65 M.P.A. (8500 P.S.I.) COMPRESSIVE STRENGTH, AND A WATER ABSORPTION NOT EXCEEDING 0.5% AND A FREEZE-THAW RESISTANCE EQUAL TO C.S.A.-A82-2 (1987).
 - SETTING BED SHALL CONSIST OF SHARP, CLEAN, COARSE CONCRETE SAND OR APPROVED LIMESTONE SCREENINGS. SAND FOR JOINTS SHALL BE A CLEAN, NATURAL GRAVEL, CRUSHED STONE OR ROCK.
 - INSTALL GRANULAR BASE AND COMPACT TO A MINIMUM 98% STANDARD PROCTOR DENSITY UNTIL THE MIN. SPECIFIED DEPTH AS DETAILED, HAS BEEN ESTABLISHED. LOOSELY PLACED CONCRETE SAND OR SCREENINGS TO A UNIFORM DEPTH OF 50mm (2") MIN.
 - MAINTAIN JOINTS UNIFORM AND CLOSELY BUTTED THROUGHOUT.
 - WHERE NECESSARY, SAW OUT PAVERS TO PRODUCE A SHARP, VERTICAL CUT WITHOUT DAMAGED EDGES, AND TO FIT ACCURATELY.
 - AFTER COMPLETION OF INSTALLATION, COMPACT PAVING BY MEANS OF A VIBRATING PLATE TAMPER.
 - FILL THE JOINTS WITH FINE SAND, BY BRUSHING AND SWEEPING, HOSE PAVING WITH FINE WATER SPRAY.

1 LANDSCAPE GENERAL NOTES

SITE PLAN PLANT LIST

KEY	QTY.	BOTANICAL NAME	COMMON NAME	HEIGHT	SPREAD	CAL.	SPACING	COND.	REMARKS	ON	DT	ST	CAUTION
DECIDUOUS TREES													
OM	04	Quercus macrocarpa	Burr Oak	4000	2000	60	as shown	WB	FULL FORM	✓	✓	✓	✓
DECIDUOUS SHRUBS													
Ra	49	Thuja occidentalis 'Dre-Low'	Fragrant Sumac	600	-	900	CG	FULL FORM	✓	✓	✓	✓	✓
EVERGREEN SHRUBS													
Jsa	27	Juniperus sibirica 'Arcadia'	Arcadia Juniper	-	-	900	CG	FULL FORM	✓	✓	✓	✓	✓
PERENNIALS and GRASSES													
ca	18	Calamagrostis x acutiflora 'Kari Foerster'	Kari Foerster Feather Reed Grass	2GAL	-	600	CG2	FULL FORM	✓	✓	✓	✓	✓
hnd	63	Hemerocallis 'Stella D'Oro'	Stella D'Oro Daylily	2GAL	-	600	CG2	FULL FORM	✓	✓	✓	✓	✓

BUFFER PLANT LIST

KEY	QTY.	BOTANICAL NAME	COMMON NAME	HEIGHT	SPREAD	CAL.	SPACING	COND.	REMARKS	ON	DT	ST	CAUTION
DECIDUOUS TREES													
CO1	03	Celtis occidentalis	Hackberry	4000	2000	60	as shown	WB	FULL FORM	✓	✓	✓	✓
OM1	02	Quercus macrocarpa	Burr Oak	4000	2000	60	as shown	WB	FULL FORM	✓	✓	✓	✓
AR2	03	Acer rubrum	Red Maple	2500	1000	-	as shown	WB	FULL FORM	✓	✓	✓	✓
CO2	02	Celtis occidentalis	Hackberry	2500	1000	-	as shown	WB	FULL FORM	✓	✓	✓	✓
OV2	04	Ostrya virginiana	Ironwood	2500	1000	-	as shown	WB	FULL FORM	✓	✓	✓	✓
OM2	02	Quercus macrocarpa	Burr Oak	2500	1000	-	as shown	WB	FULL FORM	✓	✓	✓	✓
EVERGREEN SHRUBS													
TO	18	Thuja occidentalis	Swamp White Cedar	1000	-	-	as shown	WB	FULL FORM	✓	✓	✓	✓
DECIDUOUS SHRUBS													
Cs2	21	Cornus serica	Red Osier Dogwood	600	-	900	CG	FULL FORM	✓	✓	✓	✓	✓
Hk2	19	Hypericum kalmianum	Shrubby St. John's Wort	600	-	900	CG	FULL FORM	✓	✓	✓	✓	✓
Fr2	17	Physocarpus opulifolius	Common Ninesilk	600	-	900	CG	FULL FORM	✓	✓	✓	✓	✓
Va2	20	Viburnum dentatum	Arrowwood Viburnum	600	-	900	CG	FULL FORM	✓	✓	✓	✓	✓

6 PROPOSED PLANT LIST

- 7% WILD GRASS-BELL (SEBASTIUM MACULATUM)
- 1% FALSE SOLIDAGO (MAIANTHEMUM RAEMOSUM)
- 1% GIANT BLUE COGON (CAULOPHYLLUM THIGMOCOM)
- 2% CANADA GOLDENROD (SOLIDAGO CANADENSIS)
- 22% BOTTLEBRUSH GRASS (ELYMUS HYSTRIC)
- 1% BLUEBERRY (SAMBUCUS INDIANA)
- 4% WOODLAND SUNDOWER (HELIANTHUS DIVARICATUS)
- 20% RIVERBANK WILD RYE (ELYMUS RIPARIUS)
- 1% ROUGH AVEEN (SOLIDAGO VIGORIANA)
- 1% SENSITIVE FERN (ONOCLEA SENSIBILIS)
- 1% BLUE WOOD (ASTER COOPERII)
- 20% ZIG ZAG GOLDENROD (SOLIDAGO FLEXICAULIS)

7 SEED MIX

- SEED MIXTURE SUPPLIED BY ONTARIO SEED COMPANY LTD. OR APPROVED EQUAL.
- ONTARIO SEED COMPANY
330 PHILIP STREET, WATERLOO, ONT. N2J 3Z6
TEL (519) 886-0557 FAX (519) 886-0605
- NOTE:
-CHECK ALL QUANTITIES
-REPORT ANY DISCREPANCIES TO THE LANDSCAPE ARCHITECT
-THE QUANTITIES INDICATED ON THE PLAN SUPERSEDE THE TOTAL ON THE PLANT LIST
-THE LAYOUT OF ALL PLANT MATERIAL IS TO BE APPROVED BY THE LANDSCAPE ARCHITECT PRIOR TO PLANTING

10 PEDESTRIAN BOLLARD



11 GARBAGE ENCLOSURE SCREEN



- PLANTING:**
- (UNLESS OTHERWISE SPECIFIED)
 - PREPARE PLANTING SOIL BY EVENLY MIXING FOUR PARTS SANDY TOPSOIL, ONE PART ORGANIC SOIL 5kg/100sqm. THE PROPORTIONS SPECIFIED ARE SUBJECT TO ADJUSTMENT DEPENDING ON TOPSOIL ANALYSIS REPORT.
 - EXCAVATE AND PROVIDE PLANTING SIZES AS PER PLANTING DETAILS.
 - PROVIDE ALL SHRUBS AND TREES ACCORDING TO THE GUIDE SPECIFICATIONS FOR NURSERY STOCK OF THE CANADIAN NURSERY TRADE ASSOCIATION WITH REGARD TO QUALITY AND GRADING AND SIZES AS PER PLANT LIST.
 - SPRAY ALL PLANTINGS IN LEAF WITH ANTIDESICCANT. PROVIDE TREES WITH STAKES.
 - PLANTS ARE TO BE PLANTED IN CONTINUOUS BEDS UNDER PROPER CULTURAL PRACTICES, IN PARTICULAR WITH RESPECT TO APPLICABLE PEST AND DISEASE CONTROL AND BRANCH AND ROOT TRAINING.
 - TREES ARE TO HAVE STURDY, STRAIGHT TRUNKS. TREES SHALL BE WELL BRANCHED AND BALANCED WITH A STRONG CENTRAL LEADER.
 - DECIDUOUS SHADE TREES SHALL BE FREE OF BRANCHES NOT LESS THAN 1.8m ABOVE THE GROUND.
 - ALL SHRUBS ARE TO BE PLANTED IN CONTINUOUS BEDS. DO NOT SOO BETWEEN PLANTS. EXCAVATE ENTIRE AREA OF SHRUB BED UNIFORM TO SPECIFIED DEPTH AND FILL WITH SPECIFIED PLANTING SOIL.

- RODENT PROTECTION:**
- THE CONTRACTOR SHALL BE RESPONSIBLE FOR THE PROTECTION OF ALL TREES AND SHRUBS FROM RODENT INJURY FOR THE DURATION OF THE GUARANTEE PERIOD. PROTECTIVE WIRE MESH GUARDS SHALL BE EMPLOYED AROUND ALL DECIDUOUS TREES. GUARDS SHOULD BE INSTALLED PRIOR TO THE APPLICATION OF MULCH AND SHOULD BE PLACED A MINIMUM OF 50mm OUT FROM THE TREE TRUNK ON ALL SIDES. EQUIVALENT MESH SHOULD BE CUT TO COMPLETE THIS CIRCUMFERENCE AS WELL AS TO PROVIDE A MINIMUM OF 25mm OVERLAP.
 - THE WIRE MESH GUARDS MUST BE OF GALVANIZED STEEL 12mm SQUARE MESH, 19 GAUGE AND SUPPLIED IN 600mm ROLLS. THE WIRE MESH CAN BE FASTENED WITH ANY ACCEPTABLE GALVANIZED WIRE TIE. ALL SHRUBS AND CONIFERUS TREES SHALL HAVE AN APPLICATION OF "SKOAT" OR APPROVED EQUIVALENT RODENT PROTECTANT TO BE APPLIED AT THE END OF OCTOBER. FOLLOW MANUFACTURER'S DIRECTIONS FOR APPLICATION.

- TOPSOIL:**
- WHERE NECESSARY MIXED TOPSOIL OF FERTILE, FRABLE NATURAL LOAM CONTAINING NOT LESS THAN 4% ORGANIC MATTER FOR SANDY SOILS AND 2% MINIMUM ORGANIC MATTER FOR SAND LOAMS WITH AN ACIDITY RANGE OF 5.5 TO 7.5 pH.
 - ALL TOPSOIL SHOULD BE FREE OF SUBSOILS, CLAY, STONES, ROOTS, EXCESS WATER, FROST AND OTHER EXCESSIVE MATTER.

- SODDING:**
- PREPARE A MINIMUM 100mm DEPTH OF TOPSOIL WITH A 10-5-4 COMMERCIAL FERTILIZER AT 7.5kg/100sqm. AND SUPER PHOSPHATE AT 5kg/100sqm. THE PROPORTIONS SPECIFIED ARE SUBJECT TO ADJUSTMENT DEPENDING ON TOPSOIL ANALYSIS REPORT.
 - LAY NO. 1 NURSERY SOO ON ALL AREAS OF THE PROJECT NOT COVERED BY BUILDINGS OR PAVING. IMMEDIATELY AFTER INSTALLATION, SOO MUST BE WATERED AND ROLLED.

- HYDRO SEEDING:**
- HYDROSEED ALL DISTURBED AREAS AS WELL AS AREAS INDICATED ON PLANS.
 - USE APPROPRIATE SEED MIX IN AREAS AS SPECIFIED.
 - ENSURE THAT AREAS TO BE SEEDING HAVE BEEN CULTIVATED TO A DEPTH OF 20mm AND ARE MOST TO DEPTH OF 150mm BEFORE SEEDING. FINE GRADE AREA FREE OF HUMPS AND HOLLOWES IF REQUIRED.
 - OBTAIN LANDSCAPE ARCHITECT'S APPROVAL OF TOPSOIL GRADE AND DEPTH BEFORE STARTING TO SEED.
 - FERTILIZER TO BE 8-32-16 AND TO BE APPLIED AT A RATE OF 300 kg/HECTARE.
 - TACKIFIER, IF REQUIRED, IS TO BE APPLIED AT A RATE OF 88 kg/HECTARE.
 - INDICATE AREAS OF TACKIFIER USE TO LANDSCAPE ARCHITECT PRIOR TO APPLICATION.
 - APPLY SEED MIX AT A RATE OF 150kg/HECTARE.
 - SEEDING TO BE COMPLETED BETWEEN APRIL 1 AND MAY 15 OR BETWEEN AUGUST 15 AND SEPTEMBER 30.

- TREE LOCATION:**
- TREES SHALL BE PLANTED UNDER OVERHEAD WIRES OR OVER UNDERGROUND SERVICES.
 - TREES ARE NOT TO BE PLANTED LESS THAN 1M FROM THE EXCAVATION OF ANY TREE PITS.
 - 2m FROM FIRE HYDRANTS AND TRANSFORMERS, AND 4m FROM LIGHT STANDARDS.
 - THE CONTRACTOR IS TO STAKE OUT LOCATIONS OF TREE PITS. THIS STAKE OUT IS TO BE INSPECTED BEFORE THE EXCAVATION OF ANY TREE PITS.
 - BEFORE THIS STAKE OUT, THE CONTRACTOR IS TO REQUEST A STAKE OUT ALL UNDERGROUND SERVICES.
 - THE LANDSCAPE ARCHITECT AND THE MUNICIPALITY MAY, AT THEIR DISCRETION REDISTRIBUTE TREE LOCATIONS, PRIOR TO PLANTING, IN ORDER TO MINIMIZE CONFLICTS WITH UTILITIES, DRIVEWAYS AND INTERSECTION VISIBILITY.

- CONCRETE CURB:**
- RANGE 25-50mm DIA. RIVER STONE
 - NON-WOVEN FILTER CLOTH
 - FINISHED GRADE
 - COMPACTED SUBGRADE TO 98% SPD.

4 DECORATIVE UNIT PAVERS

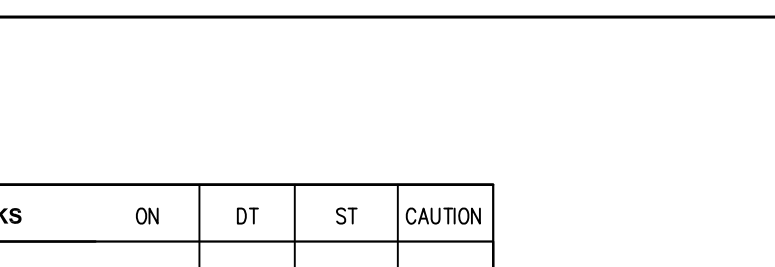

5 RIVERSTONE

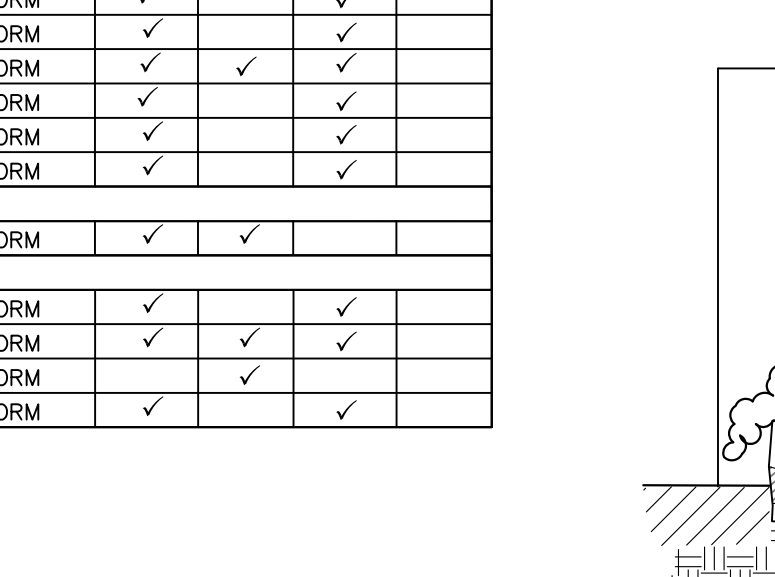
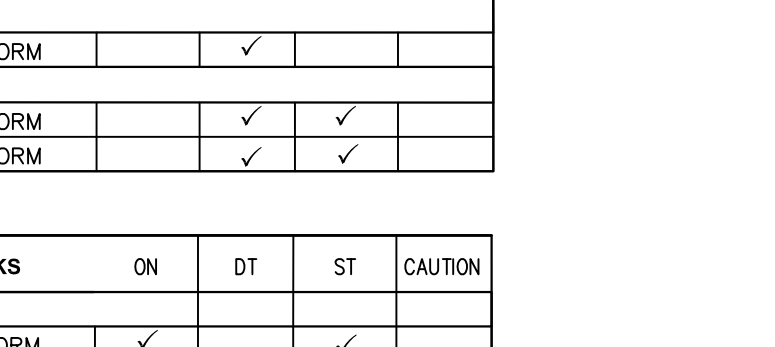

8 ARMOURSTONE ROCKERY AND PLANTING

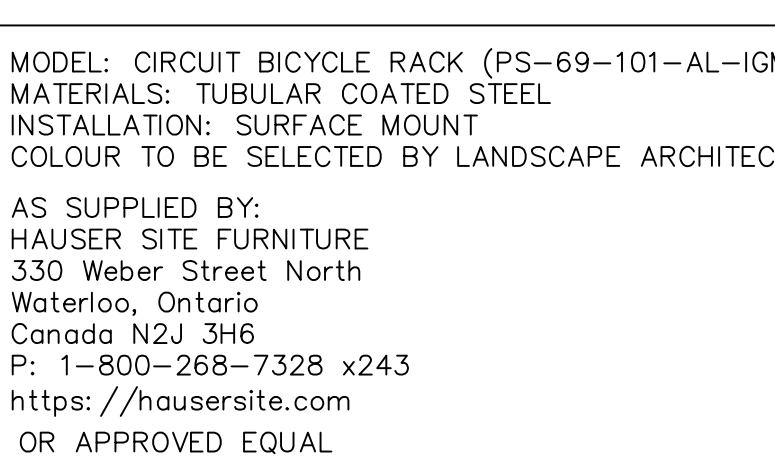

9 BICYCLE RACK

OMEGA 80 PANEL MOUNTED ON FLANGED POST (HEIGHT 77"H)

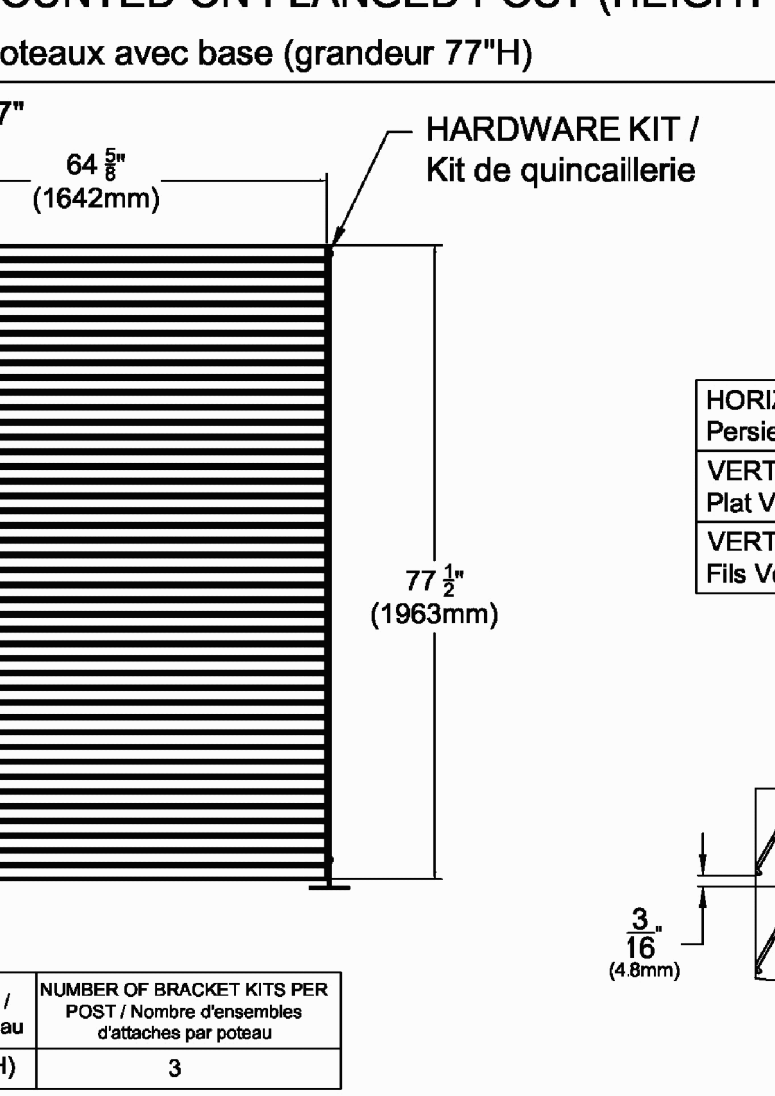

11 GARBAGE ENCLOSURE SCREEN

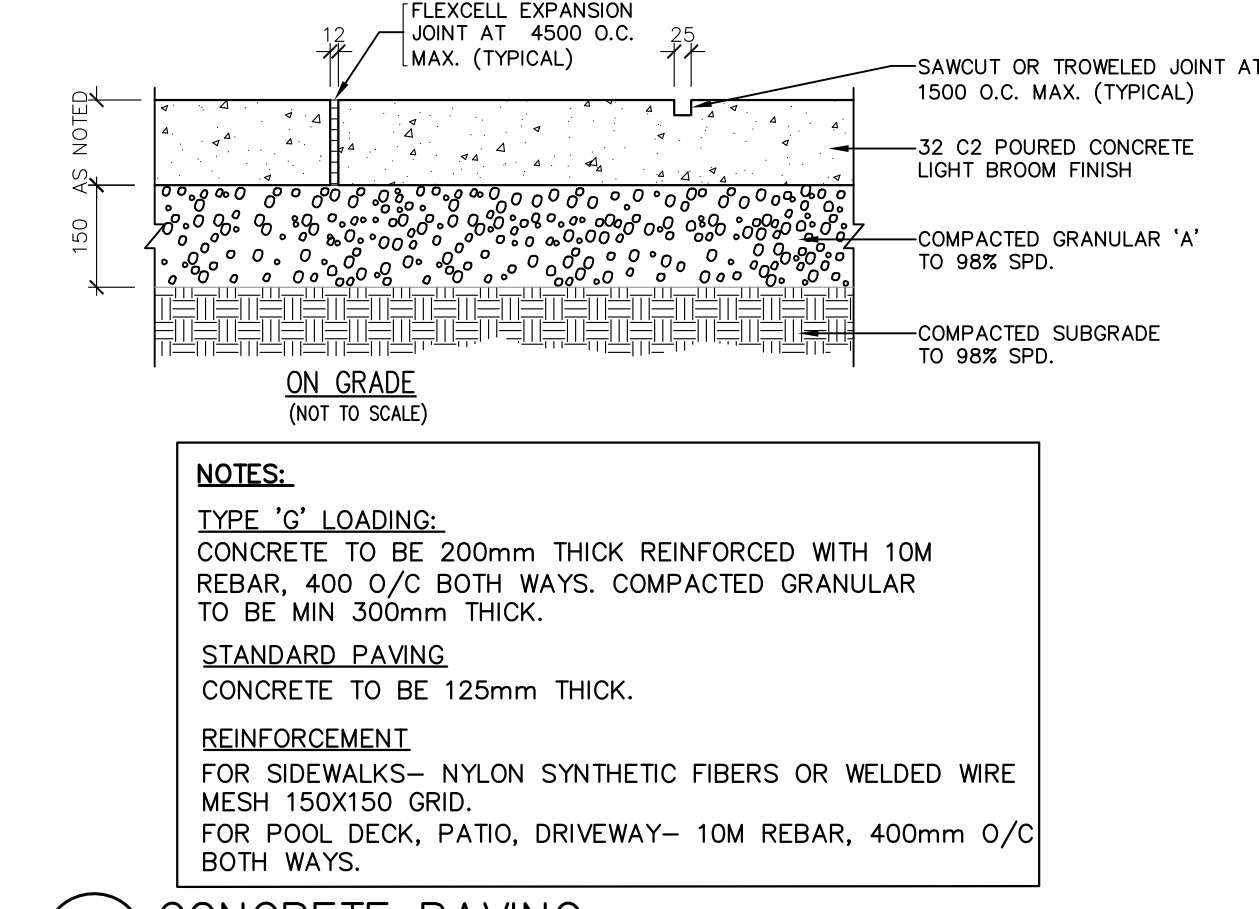
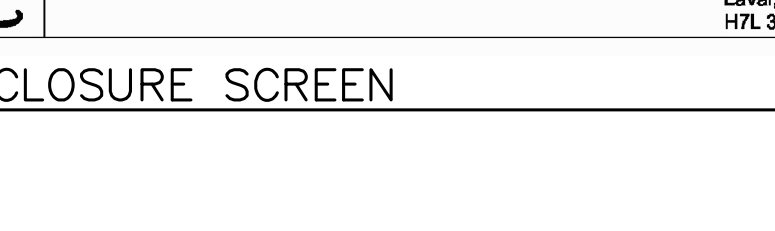

3 CONCRETE PAVING

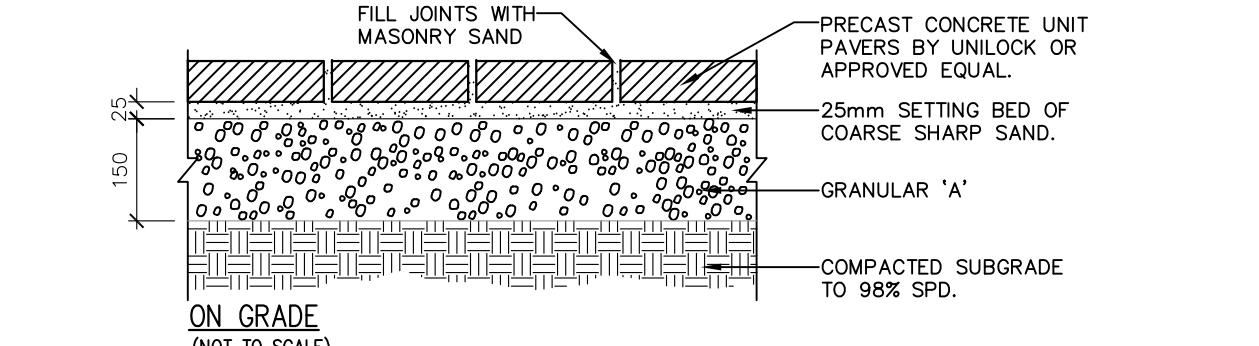

4 DECORATIVE UNIT PAVERS

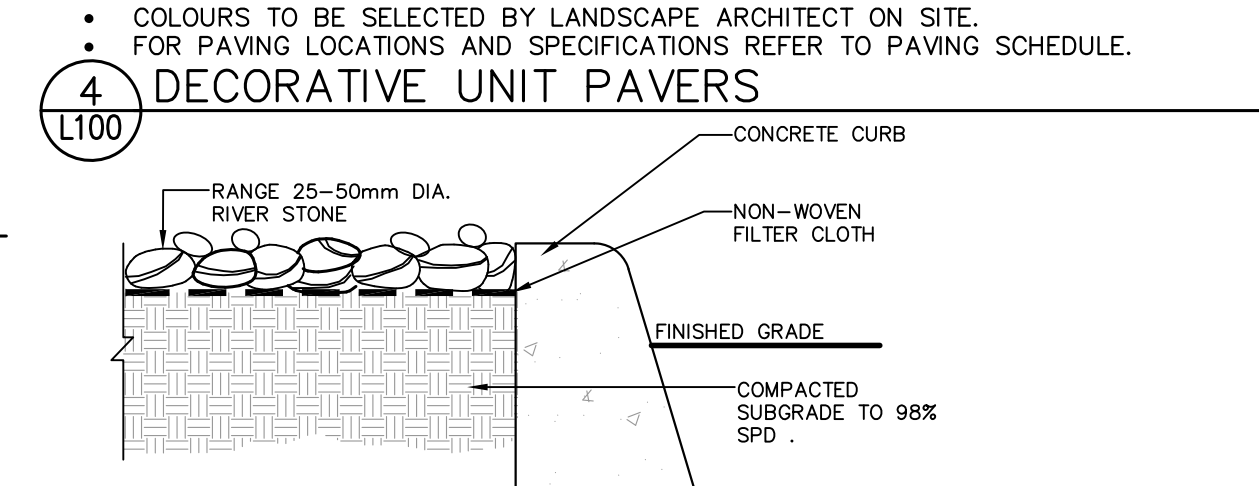

5 RIVERSTONE

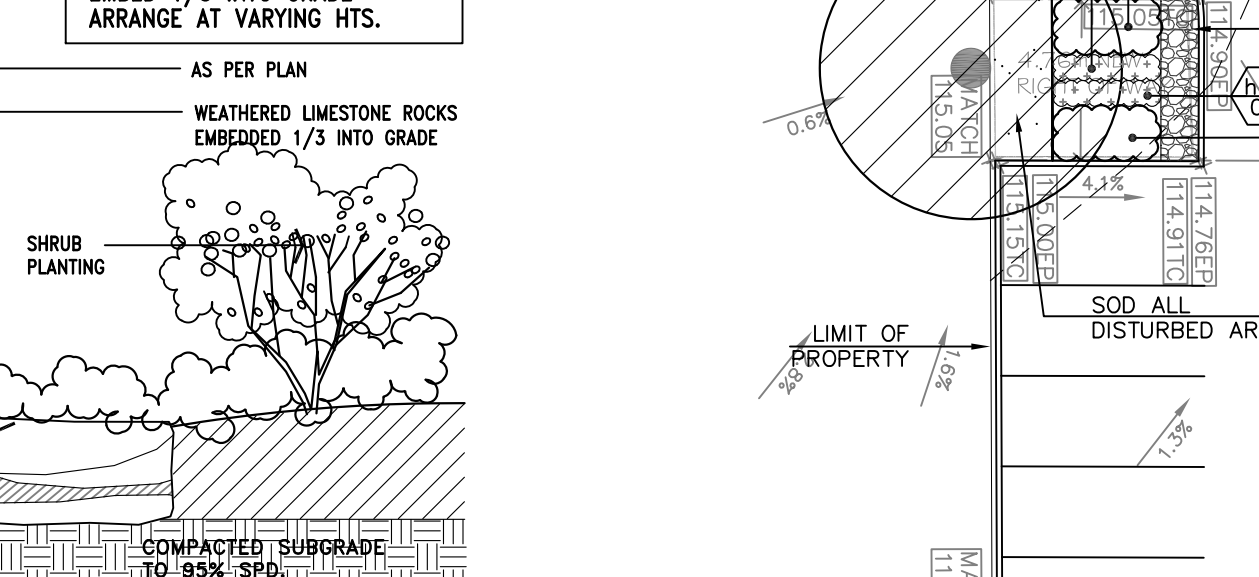

8 ARMOURSTONE ROCKERY AND PLANTING

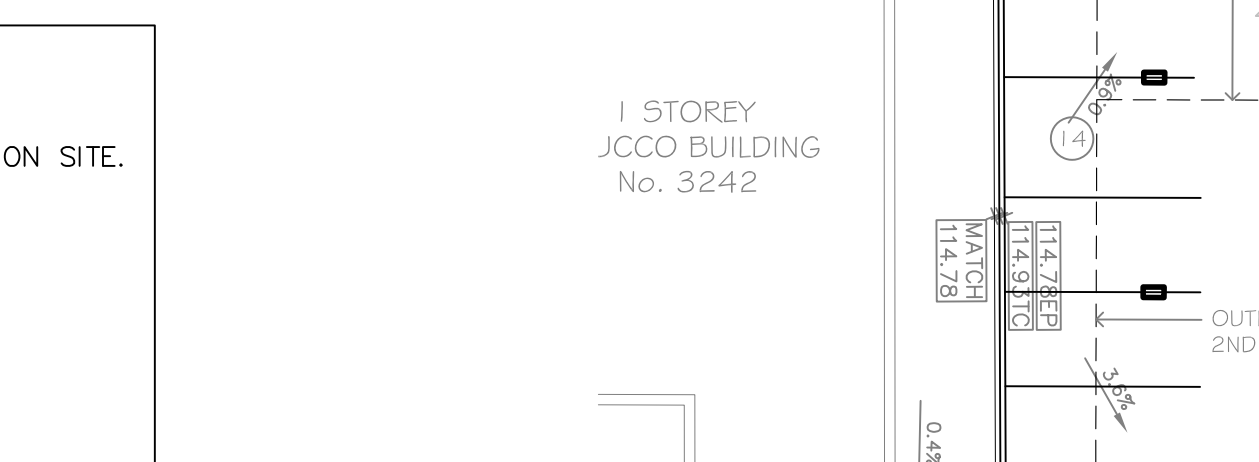

9 BICYCLE RACK

OMEGA 80 PANEL MOUNTED ON FLANGED POST (HEIGHT 77"H)

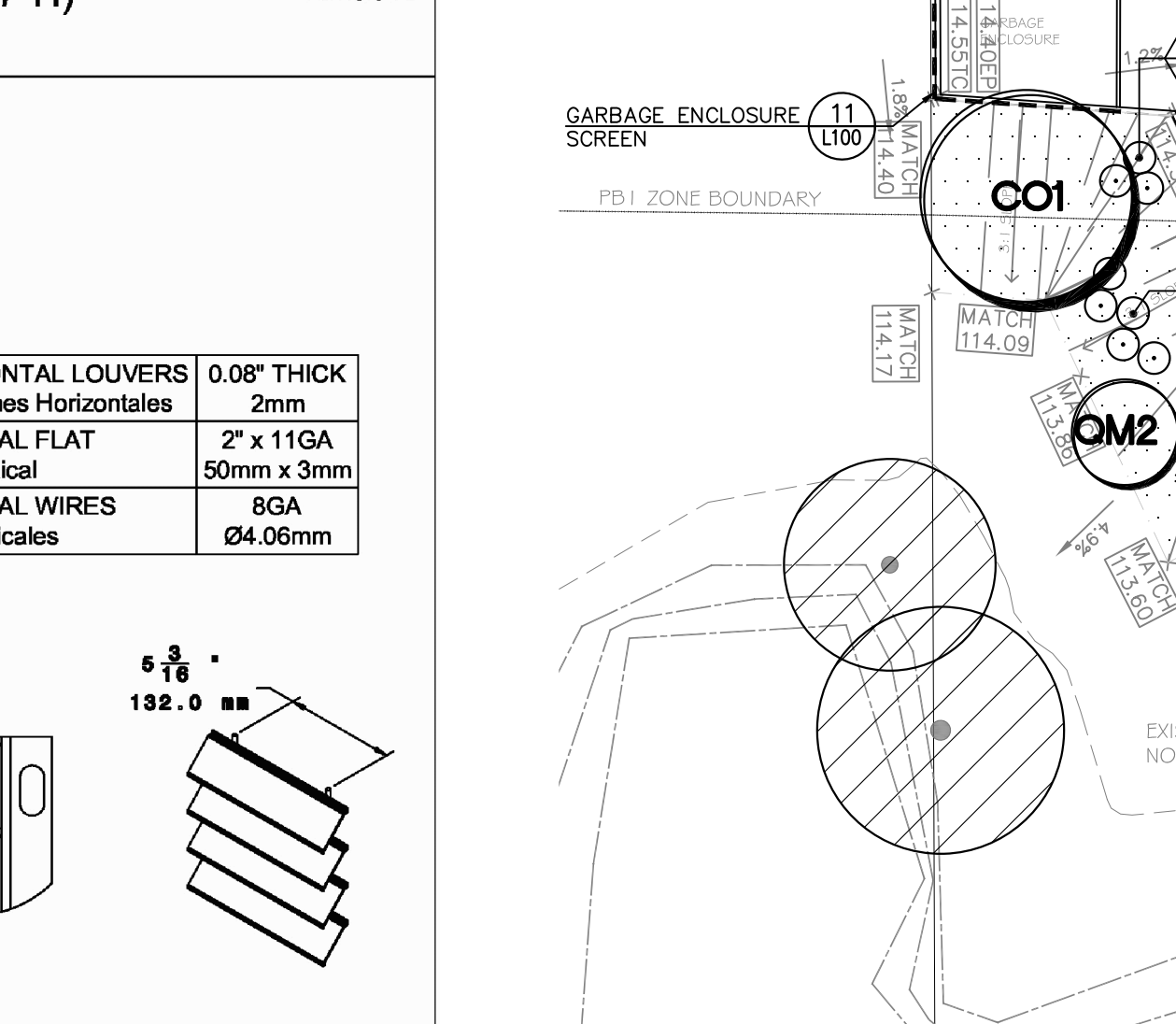

11 GARBAGE ENCLOSURE SCREEN

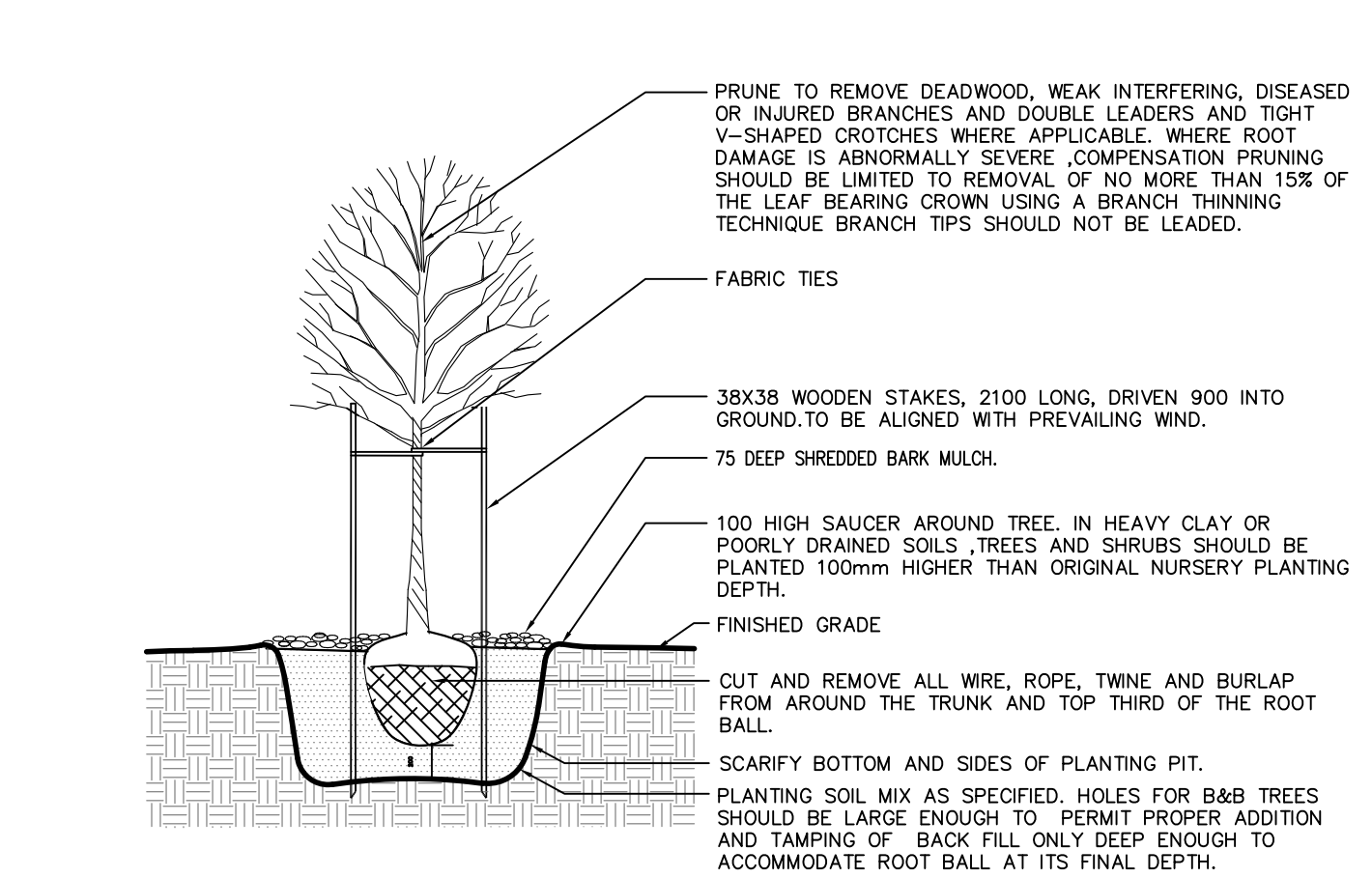

DECIDUOUS TREE PLANTING DETAIL

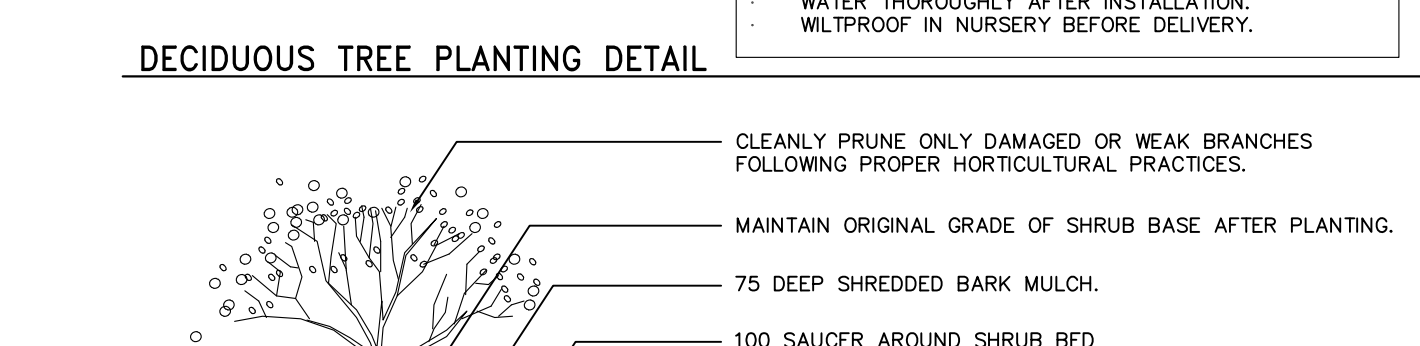

2 PLANTING DETAILS

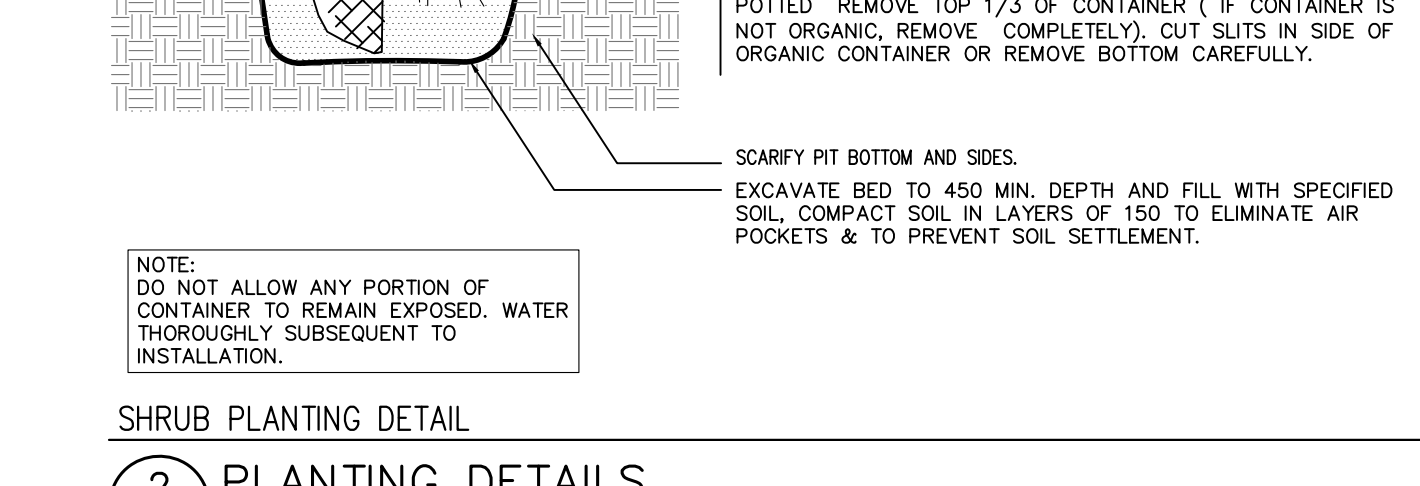

2 PLANTING DETAILS

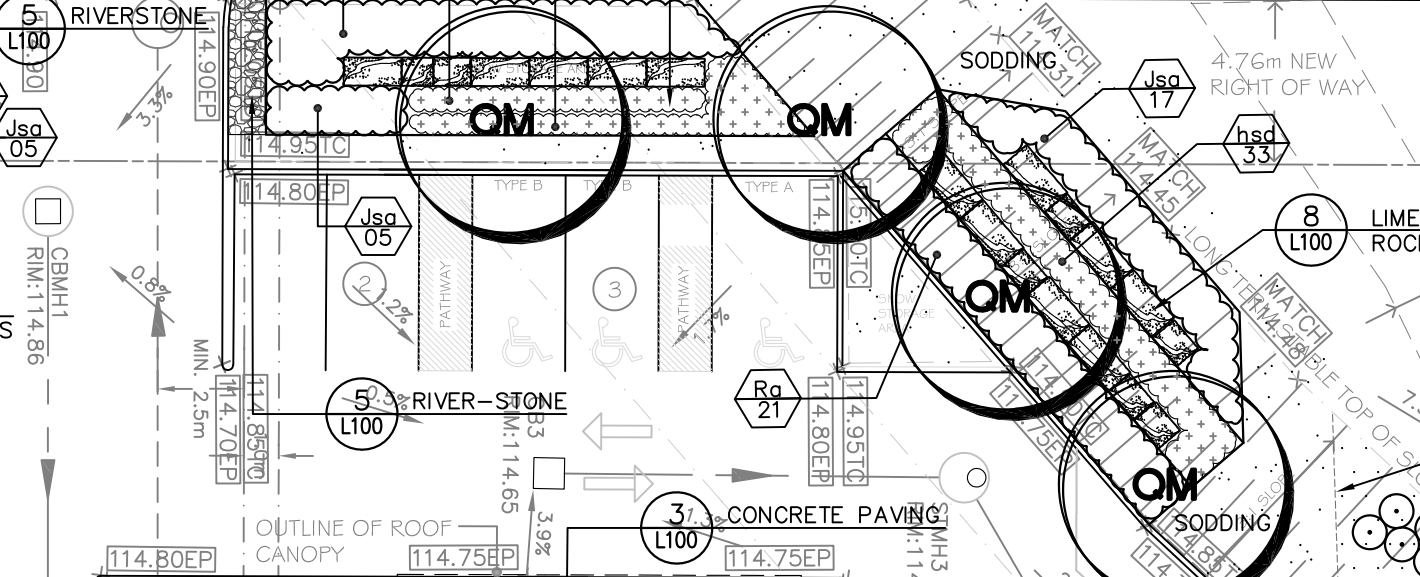
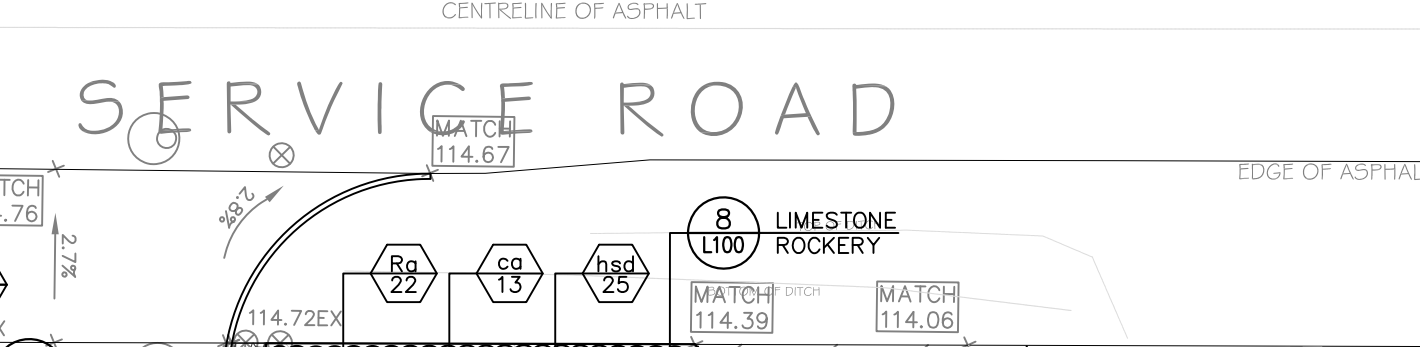

2 PLANTING DETAILS

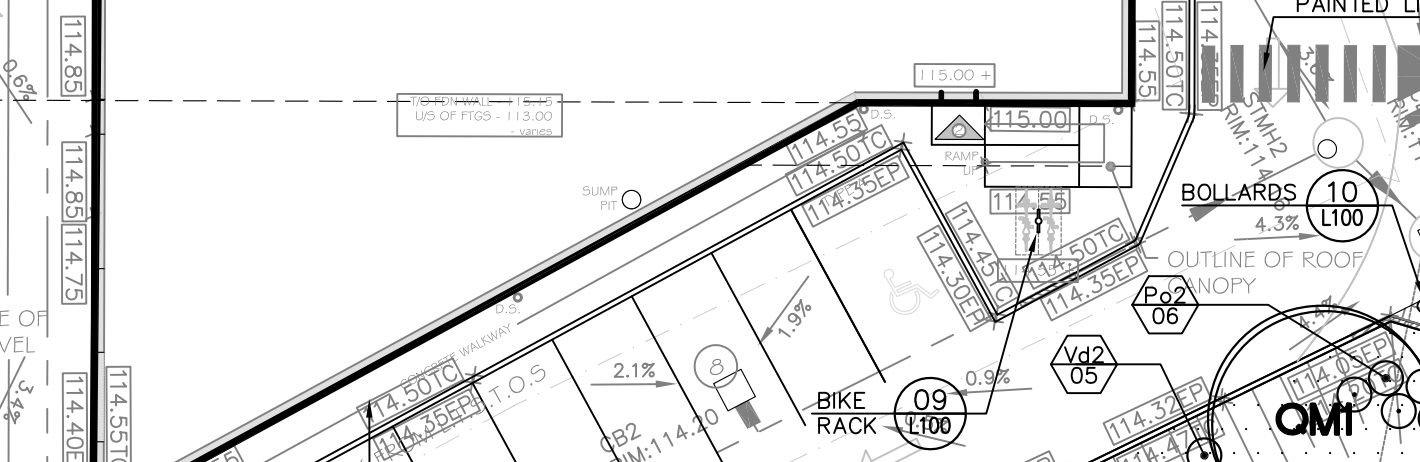
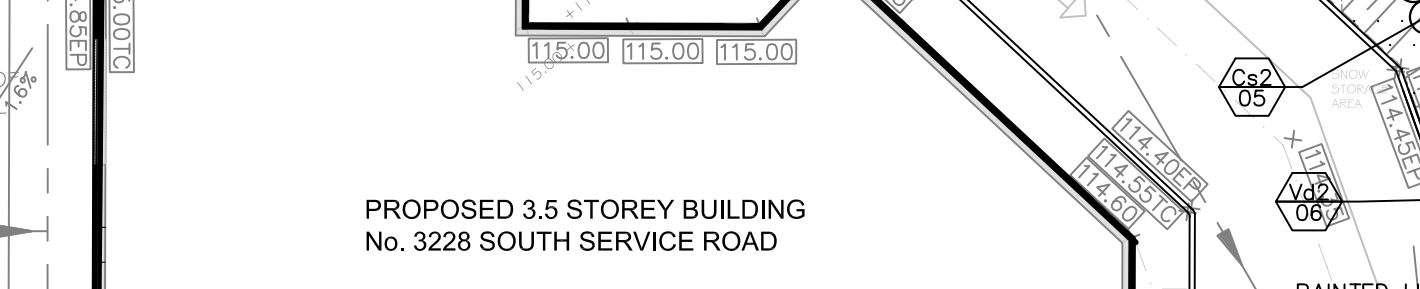

2 PLANTING DETAILS

2 PLANTING DETAILS

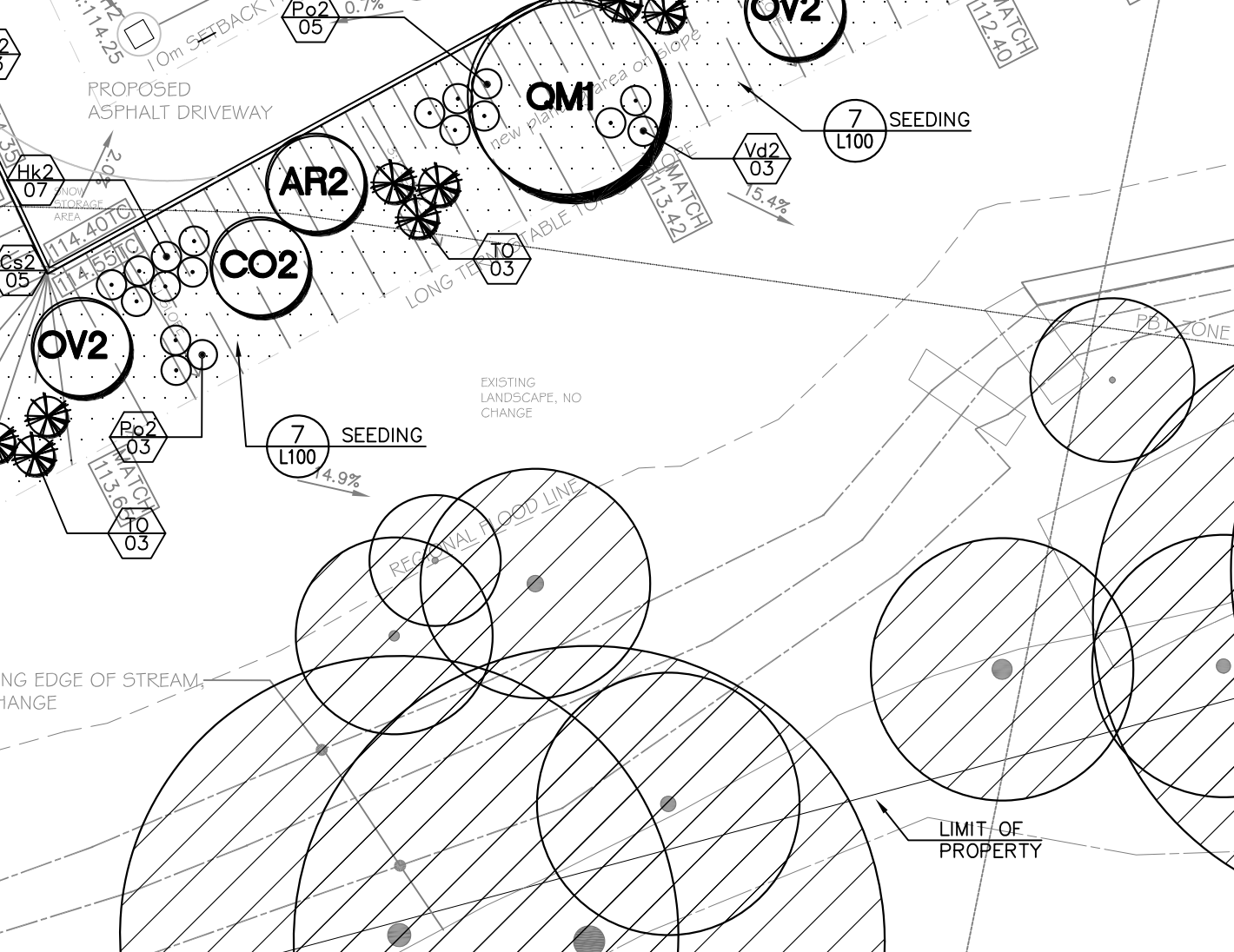

2 PLANTING DETAILS

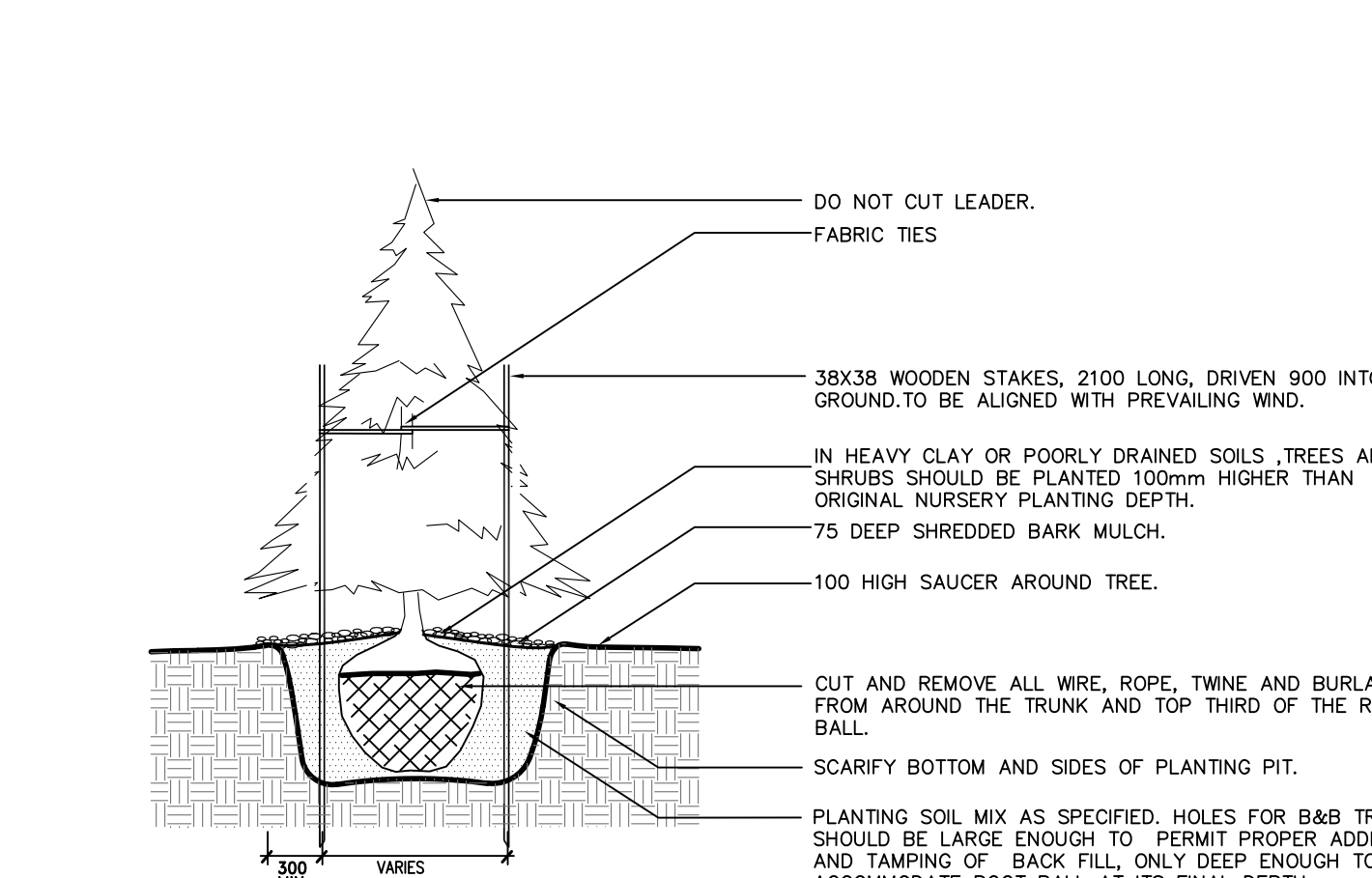

CONIFEROUS TREE PLANTING DETAIL

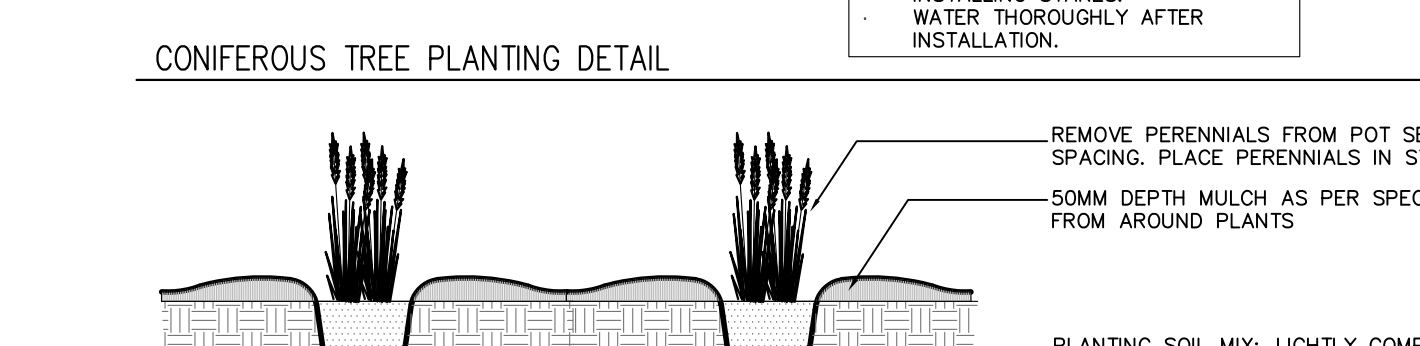

2 PLANTING DETAILS

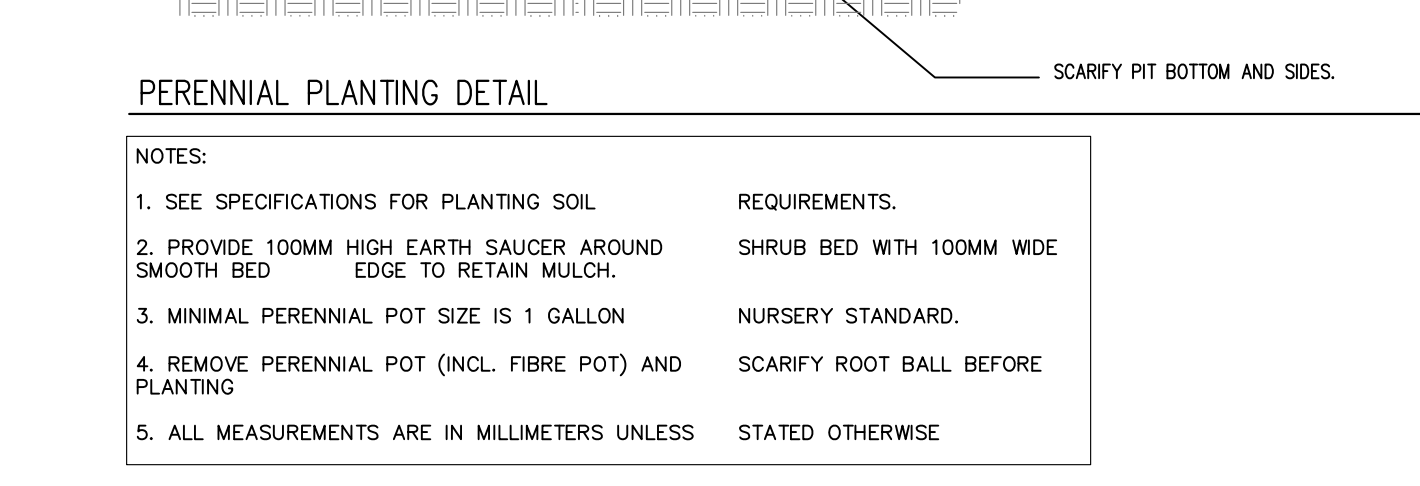

2 PLANTING DETAILS

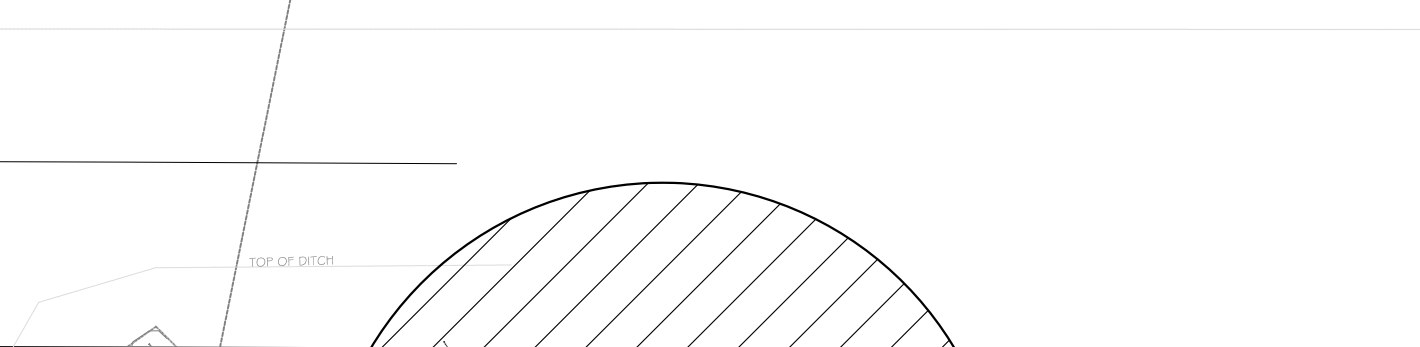

2 PLANTING DETAILS

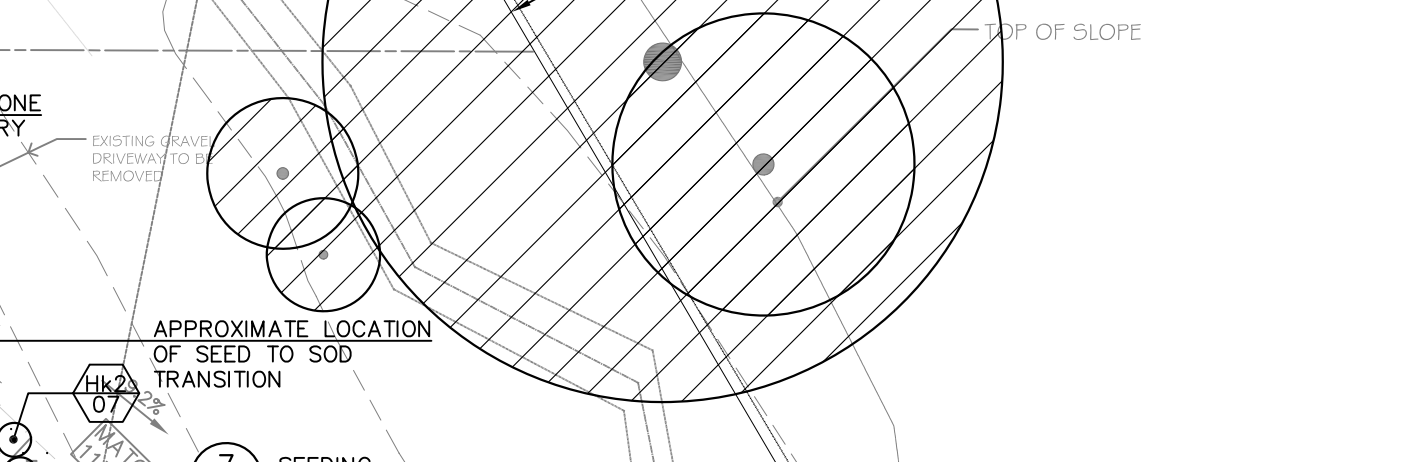

2 PLANTING DETAILS

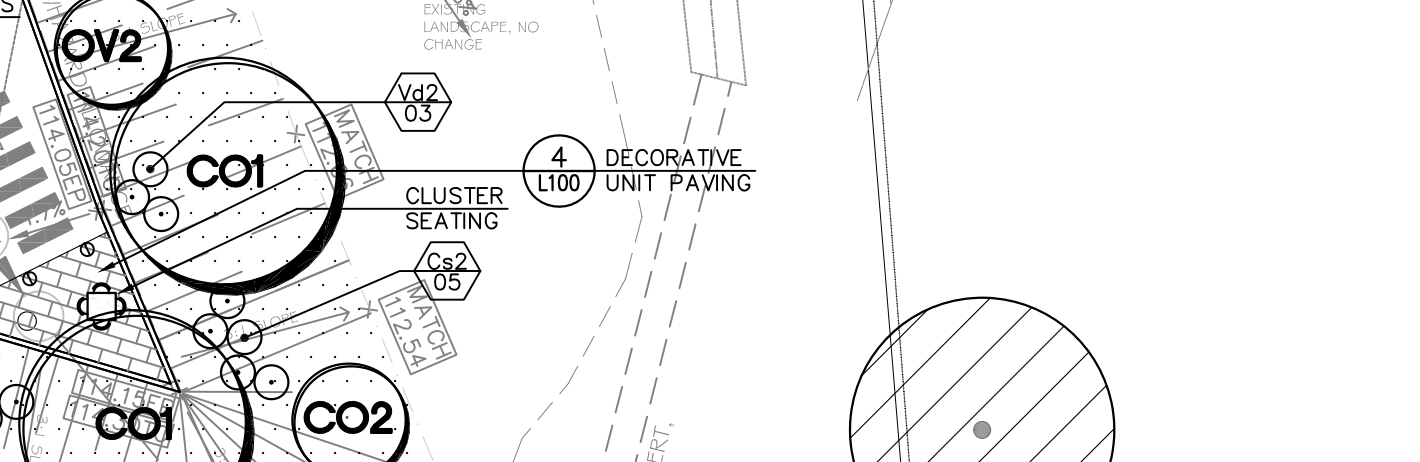
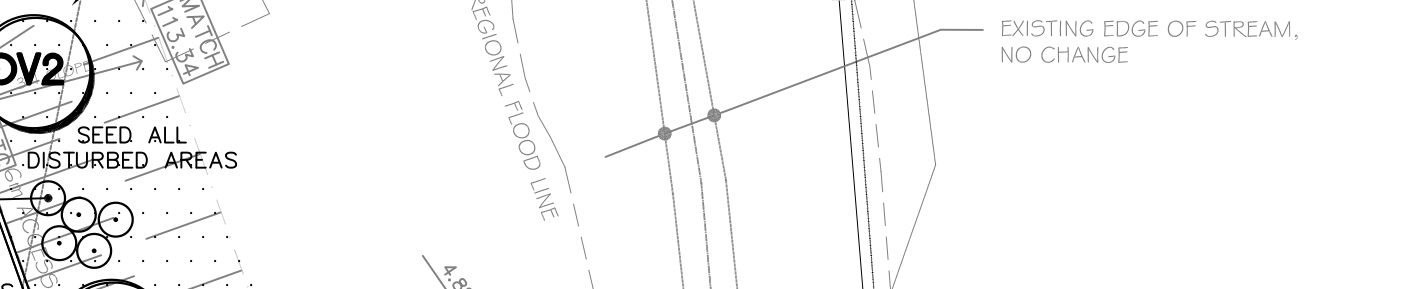

2 PLANTING DETAILS

2 PLANTING DETAILS

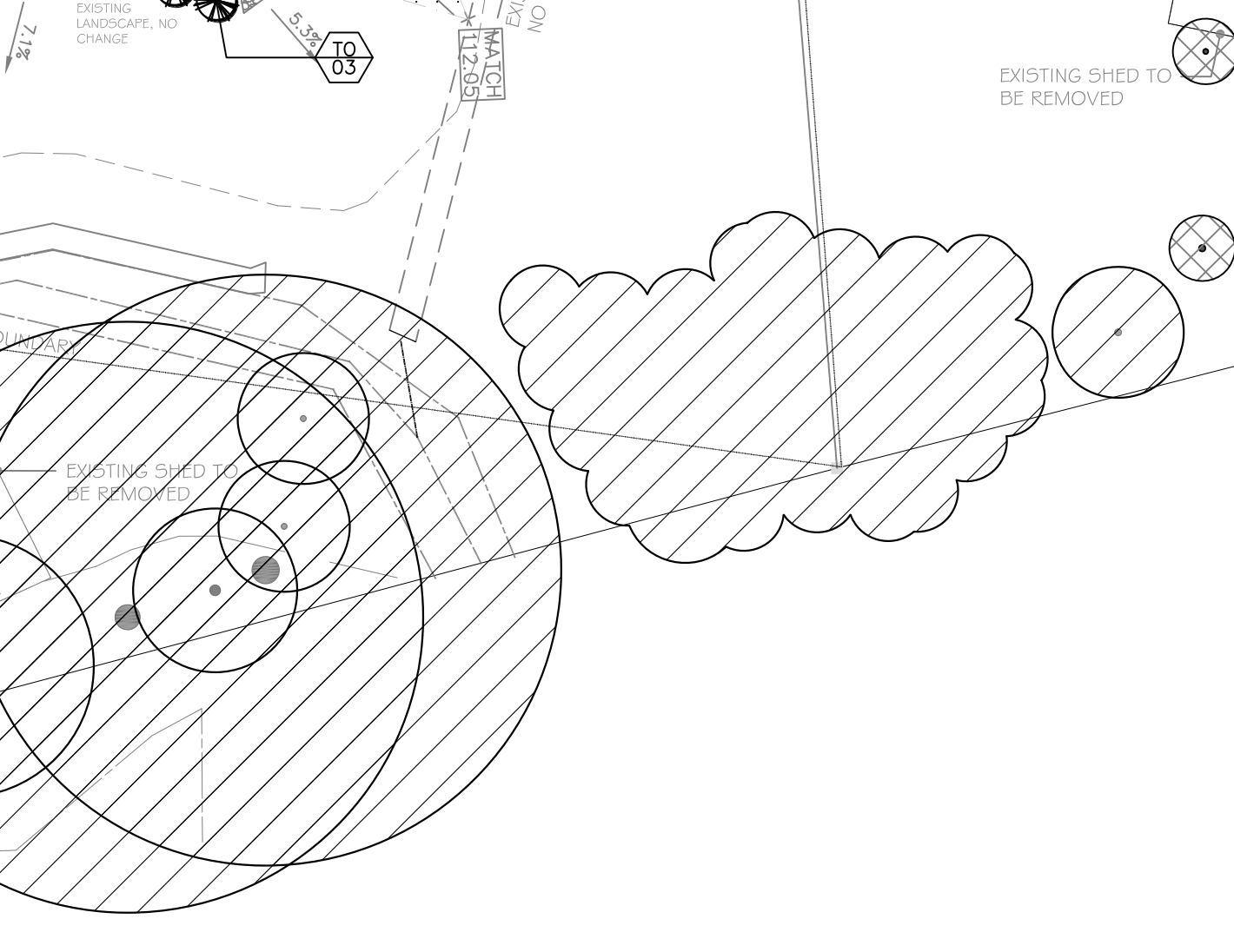

2 PLANTING DETAILS

