

PRELIMINARY ON-STREET PARKING ANALYSIS
Mattamy (Joshua Creek) Limited
PHASE 3

PART OF LOT 8 AND 9
 CONCESSION 1, NORTH OF DUNDAS STREET

GEOGRAPHIC TOWNSHIP OF TRAFALGAR
 NOW IN THE
 TOWN OF OAKVILLE
 REGIONAL MUNICIPALITY OF HALTON

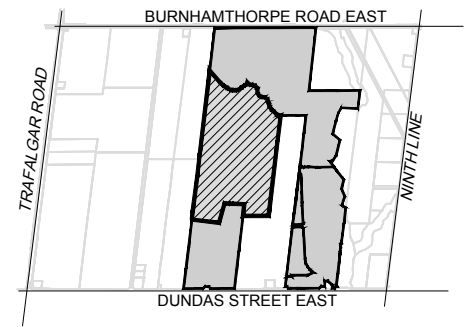

KEY MAP
 N.T.S.

Subject Lands
 Additional Lands Owned by Applicant

- ± 561 On-street parking spaces
- ± 1054 Residential units
- ± 0.53 Visitor parking space/unit

TYPICAL ON-STREET PARKING SPACE*

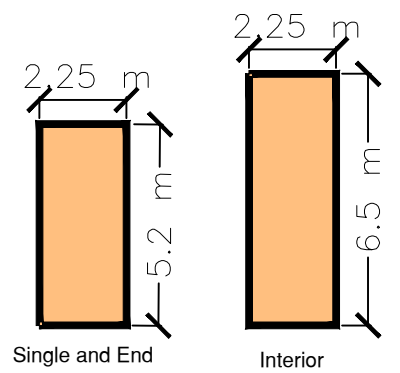

* Subject to adjustment during detailed engineering design

** Per North Oakville Parking Strategy

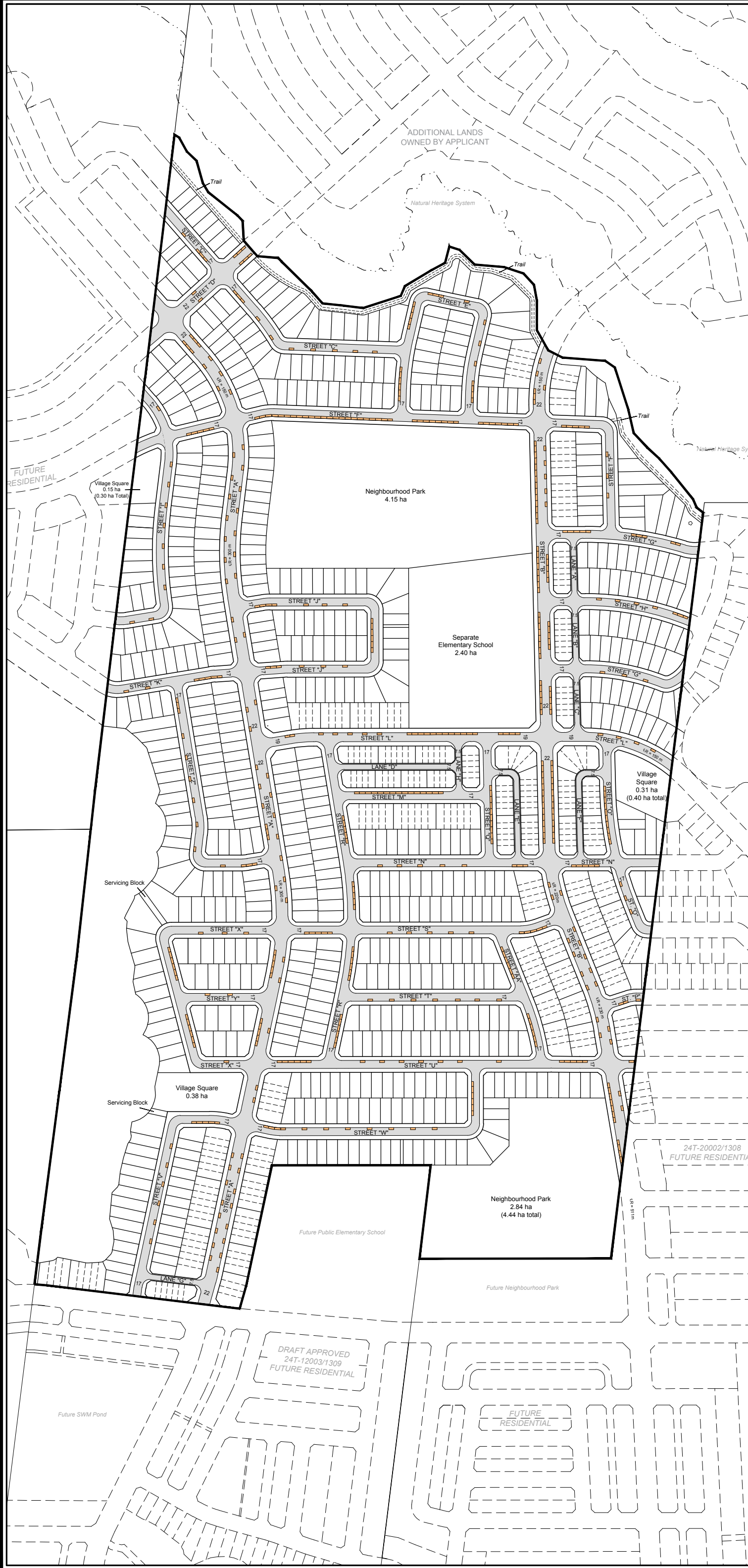

SCALE 1:4000
 May 9, 2022

KORSIAK Urban Planning

206-277 Lakeshore Road East
 Oakville, Ontario L6J 1H9
 T: 905-257-0227
 info@korsiak.com