

KEY MAP - NOT TO SCALE

During Landscape Phase, remove existing hoarding within proposed driveway and install Phase 2 hoarding along west edge of proposed driveway

Installation of GEO-WEB load support system with permeable pavers to prevent damage to structural roots of tree no. T3

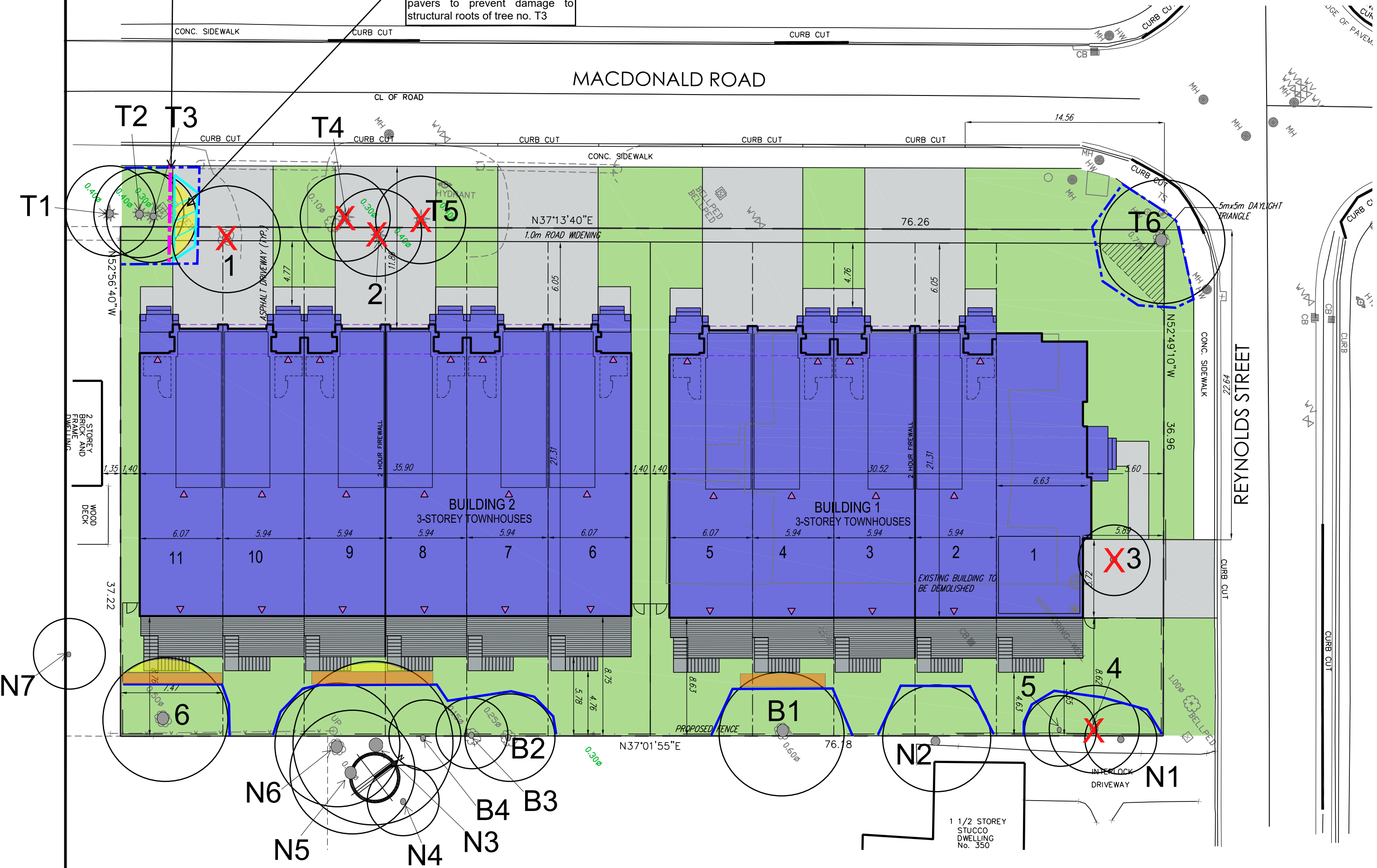

SITE STATISTICS

SITE AREA:
 GROSS SITE AREA = 2827.03 s.m. (0.283 HA)
 ROAD WIDENING = 76.26 s.m.
 DAYLIGHT TRIANGLE = 12.44 s.m.
 NET SITE AREA = 2738.33 S.M. (0.274 HA)

TOTAL UNITS:
 11 UNITS (38.9 UNITS/HA)

PROPOSED ZONING STANDARDS:
 MINIMUM FRONT YARD: 6.0m
 MINIMUM REAR YARD: 7.5m
 MINIMUM INTERIOR SIDE YARD: 1.2m
 MINIMUM EXTERIOR SIDE YARD: 3.0m
 MAXIMUM BUILDING HEIGHT : 14.0m

| LOT | AREA CALCULATIONS | | UNIT COVERAGE | | | |
|-----|-------------------|------------------|---------------|--------|--------|-------|
| | LOT AREA (S.M.) | UNIT AREA (S.M.) | (S.F.) | (S.M.) | (S.F.) | (%) |
| 1 | 439.93 | 344.58 | 3709 | 134.62 | 1449 | 30.6% |
| 2 | 213.91 | 281.59 | 3031 | 129.69 | 1396 | 60.6% |
| 3 | 214.03 | 281.59 | 3031 | 129.69 | 1396 | 60.6% |
| 4 | 214.15 | 281.59 | 3031 | 129.69 | 1396 | 60.6% |
| 5 | 269.48 | 284.75 | 3065 | 132.57 | 1427 | 49.2% |
| 6 | 269.72 | 281.59 | 3031 | 132.57 | 1427 | 49.2% |
| 7 | 214.58 | 281.59 | 3031 | 129.69 | 1396 | 60.4% |
| 8 | 214.70 | 281.59 | 3031 | 129.69 | 1396 | 60.4% |
| 9 | 214.82 | 281.59 | 3031 | 129.69 | 1396 | 60.4% |
| 10 | 214.94 | 281.59 | 3031 | 129.69 | 1396 | 60.3% |
| 11 | 270.52 | 284.75 | 3065 | 132.57 | 1427 | 49.0% |



| Legend | |
|--------|-------------------------------------|
| ● | Regulated tree |
| ○ | TPZ |
| X | Tree Removal |
| - - - | Mesh Tree Protection Hoarding |
| — | Solid Tree Protection Hoarding |
| ▭ | Horizontal Tree Protection Hoarding |
| ▭ | Area of Encroachment |
| - - - | Phase 2 Hoarding |
| ▭ | GEOWEB Load support system |



| SCALE | SHEET NUMBER |
|-------------------------------|--------------|
| 1:250 | TPP-1 |
| PLOT DATE | |
| 10/20/2023 | |
| DRAWING TITLE | |
| Tree Preservation Plan | |
| PROJECT | |
| 358 Reynolds Street, Oakville | |

THE UNDERSIGNED HAS REVIEWED AND TAKES RESPONSIBILITY FOR THIS DESIGN AND HAS THE QUALIFICATIONS AND MEETS THE REQUIREMENTS SET OUT IN THE ONTARIO BUILDING CODE TO BE A DESIGNER.
 QUALIFICATION INFORMATION
 NAME: _____ SIGNATURE: _____ BCIN: _____
 REGISTRATION INFORMATION
 HUNT DESIGN ASSOCIATES INC. 19695



SITE PLAN
 Street Name: 358 REYNOLDS STREET, OAKVILLE, ON. Plan No.:
ROSEHAVEN HOMES - 223005
 Drawn By: DC Checked By: DC Scale: 1:250 File Number: 223005DSP Lot / Page Number: A1