

NOTE:
1. PAVING STONES SHALL HAVE A FLUSH AND STABLE PAVING CONDITION WITH NO SURFACE DEFLECTION.
2. JOINTS SHALL BE NO GREATER THAN 5mm WIDE AND EXPANSION JOINTS NO HIGHER THAN 13mm.

PAVER TYPE
TECHNOLOGIA INDUSTRIA GRANITEX COMMERCIAL
COLOUR: SHALE GREY
SIZE (mm): 300 x 150 x 100

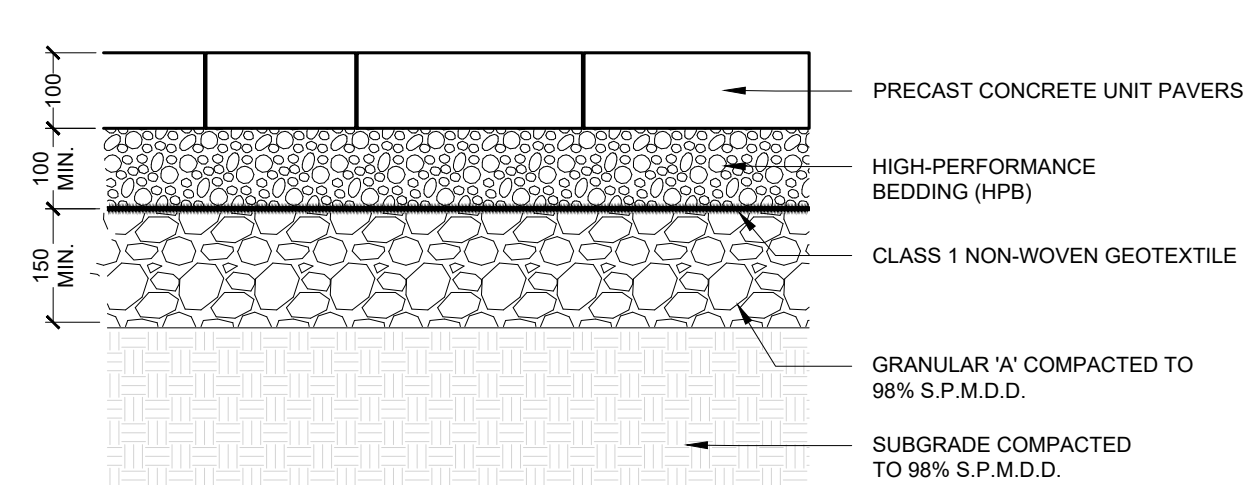

1 THRESHOLD UNIT PAVING
Scale 1:10

NOTE:
1. SURFACE CONDITION VARIES. REFER TO LANDSCAPE PLAN AND PAVING TYPE.

PAVING TYPE
• FIELD PAVING: NATURAL COLOUR WITH BROOM FINISH
• PLAZA PAVING (TYPE 1): NATURAL COLOUR LIGHT SANDBLAST FINISH
• PLAZA PAVING (TYPE 2): NATURAL COLOUR WITH MEDIUM SANDBLAST FINISH
• PLAZA PAVING (TYPE 3): INTEGRAL COLOUR WITH MEDIUM SANDBLAST FINISH

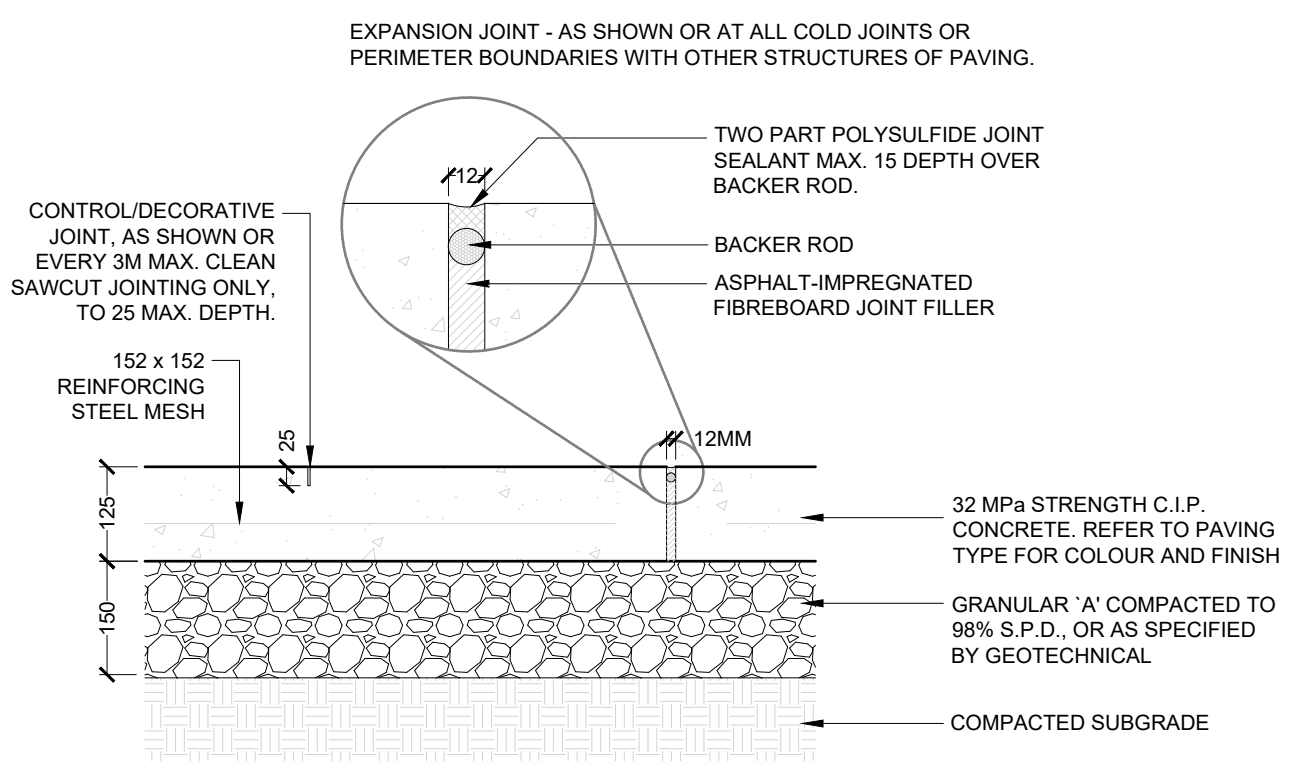

2 CONCRETE PAVING
Scale 1:10

ARTIFICIAL TURF
PRODUCT: SANITOGA 80 SERIES
(AVAILABLE FROM AGI GRASS (OR APPROVED ALTERNATE))

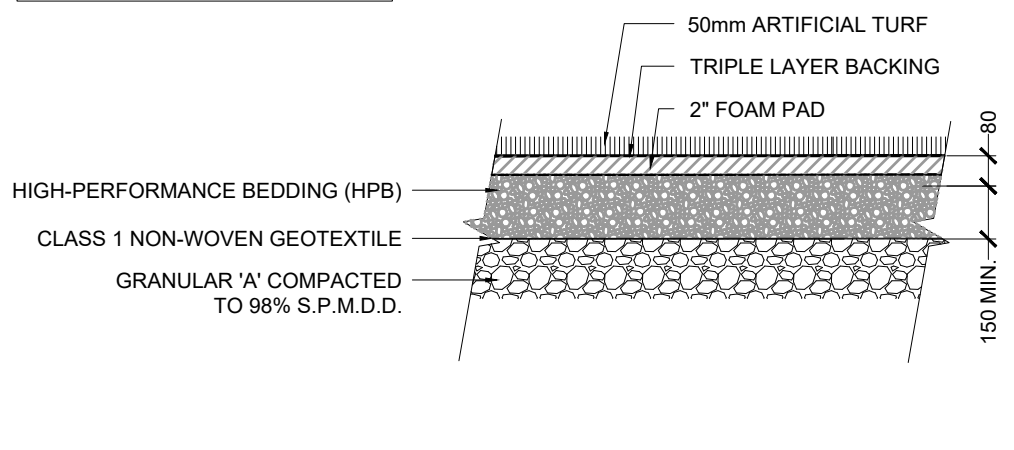

3 ARTIFICIAL TURF
1:20

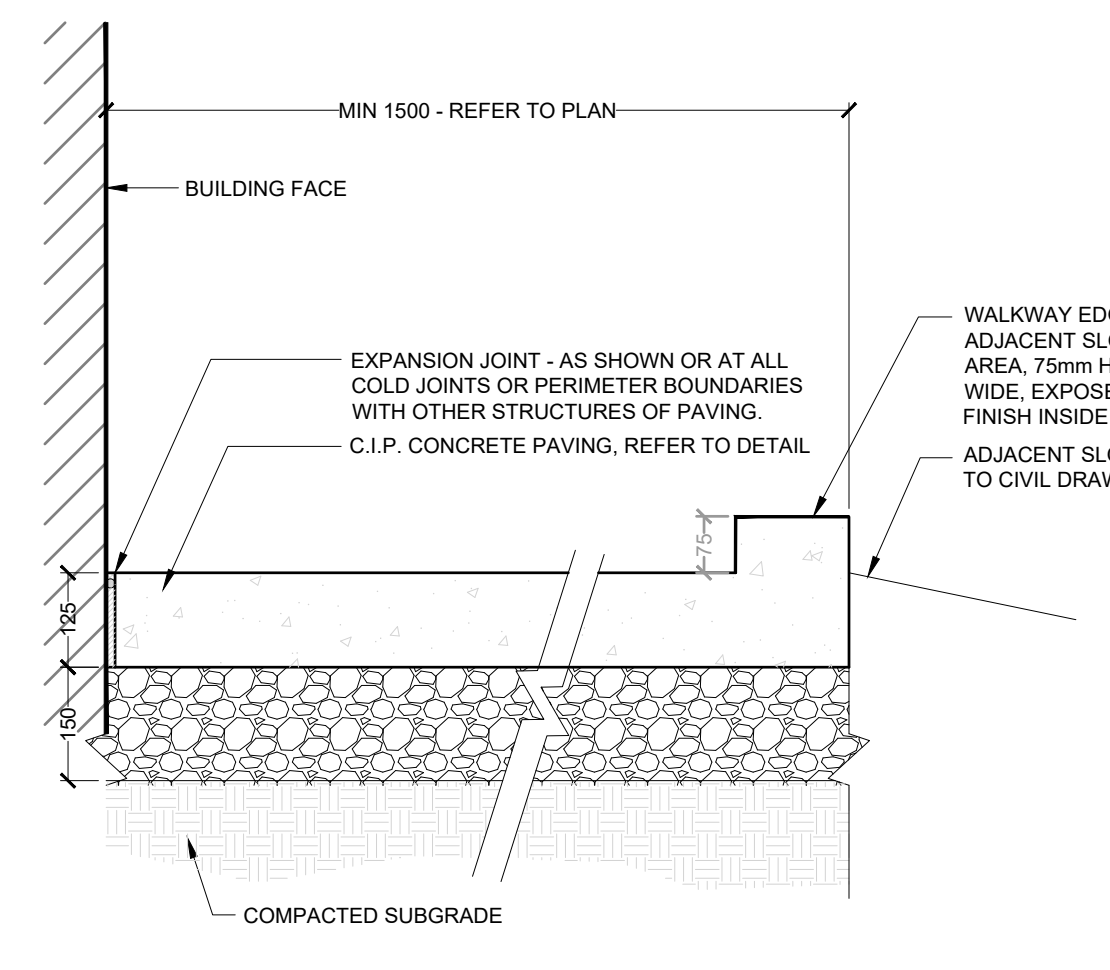

4 CONCRETE PAVING EDGE PROTECTION
Scale 1:10

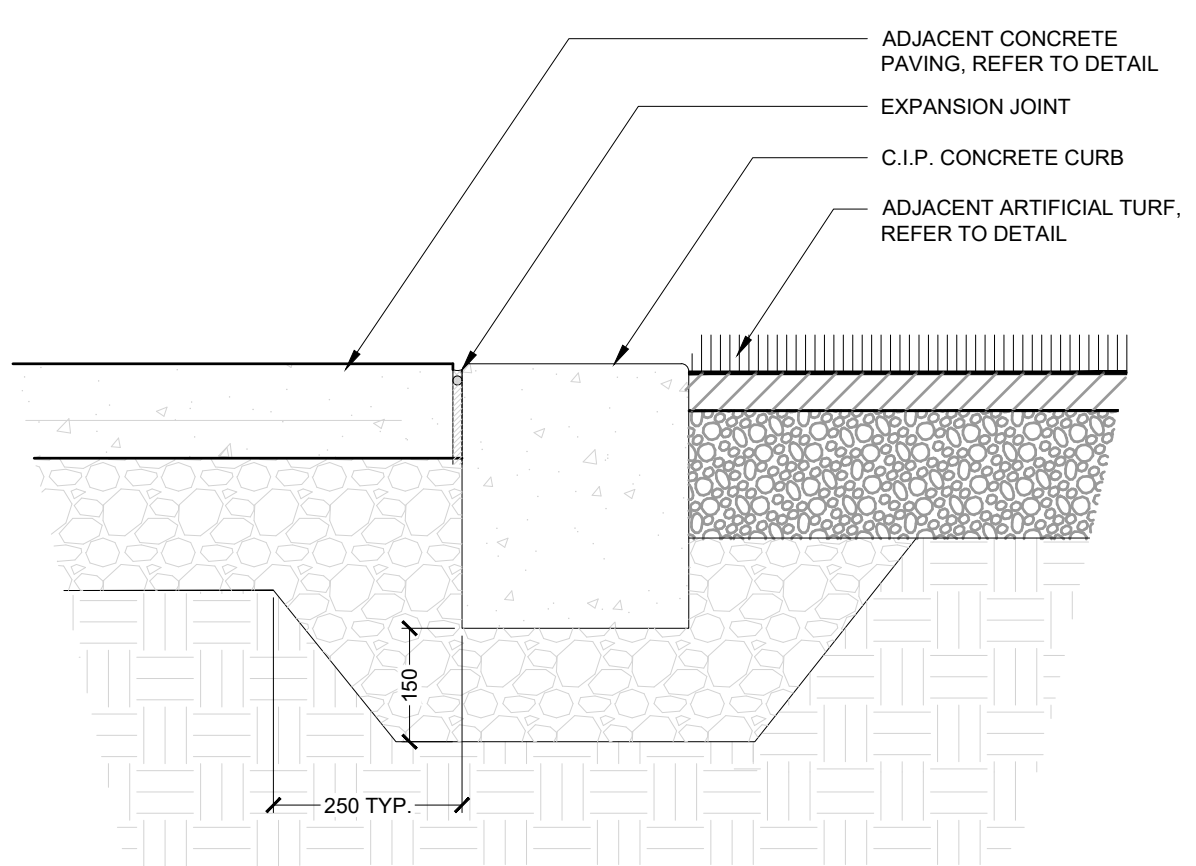

5 FLUSH CONCRETE CURB
Scale 1:10

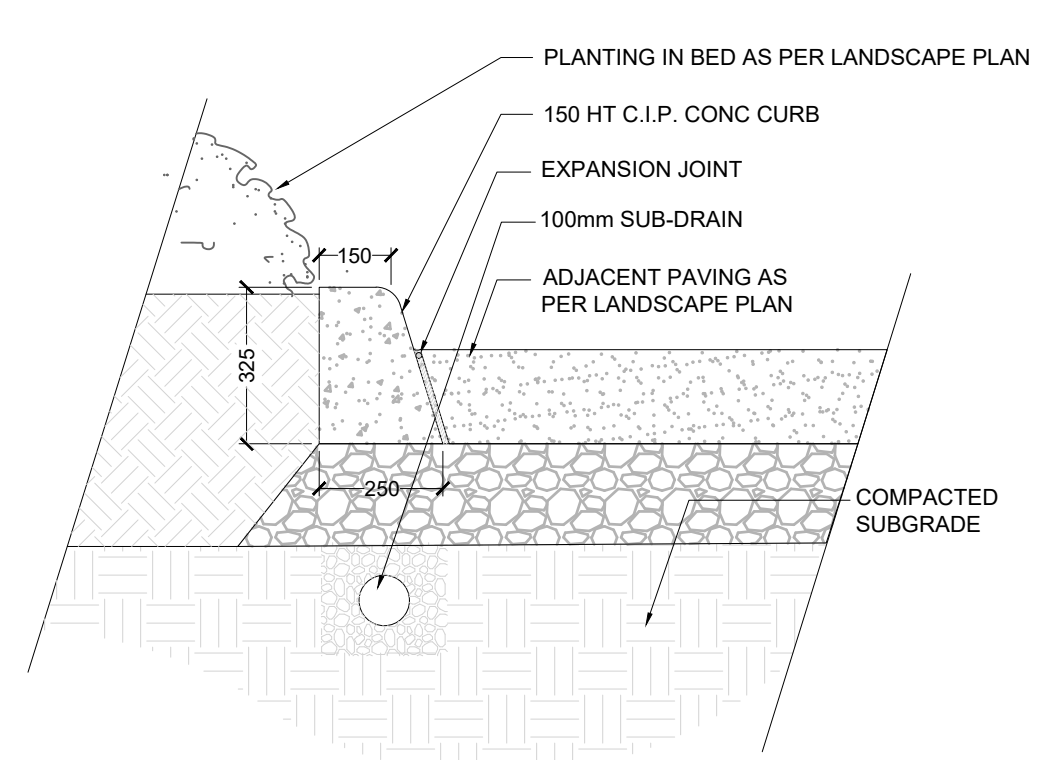

6 CONCRETE PLANTER CURB
1:15

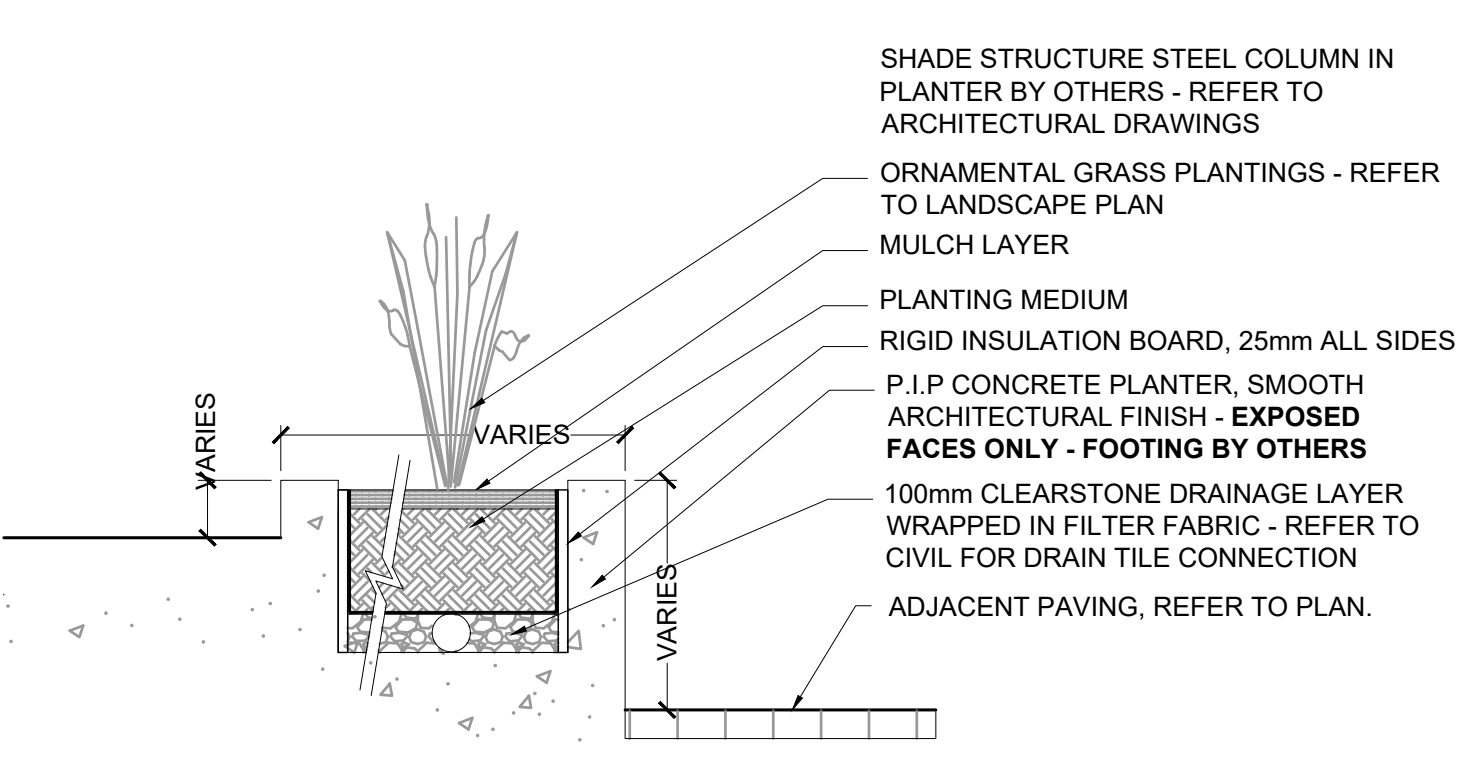

7 C.I.P. CONCRETE PLANTER WALL

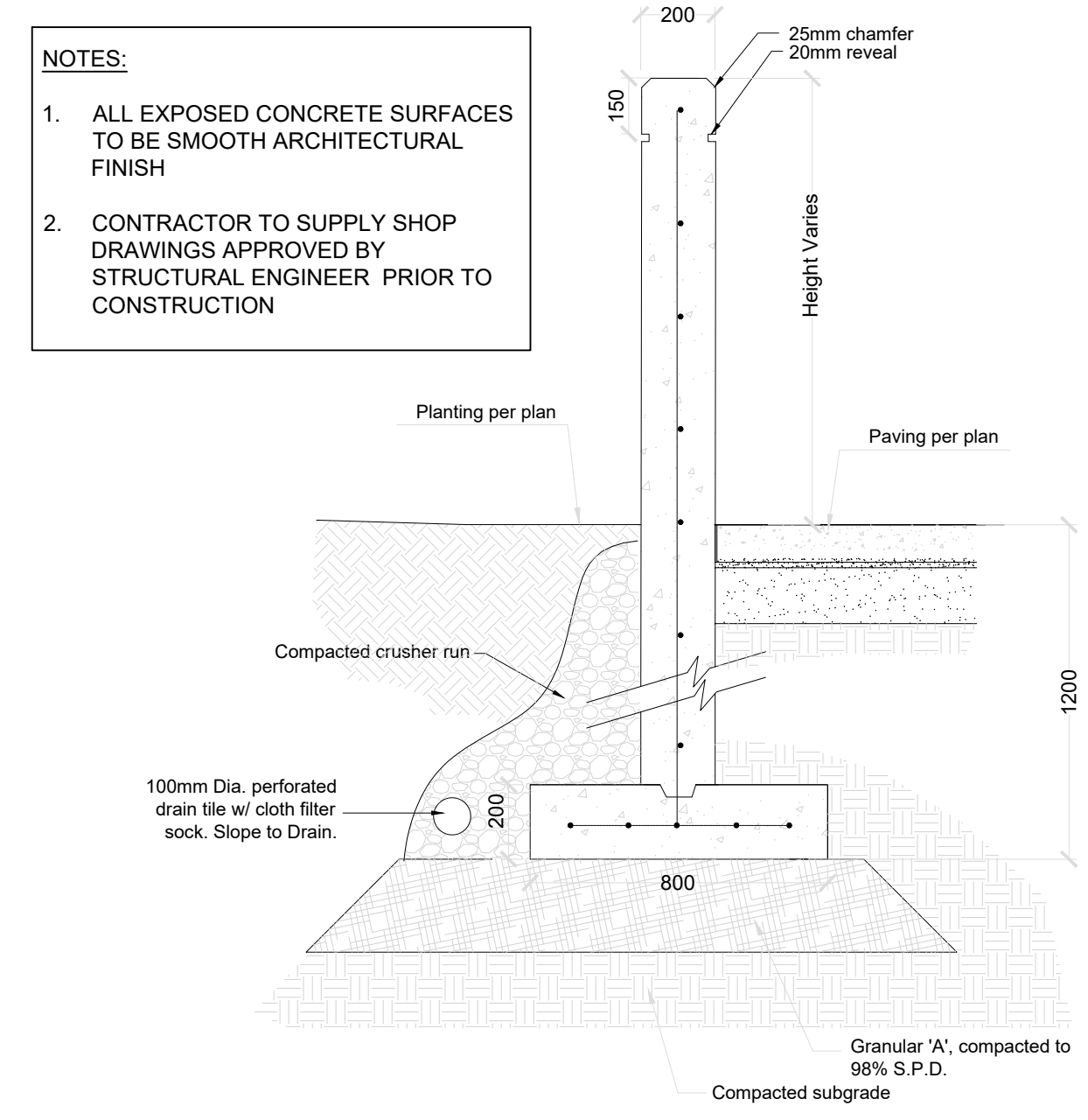

8 C.I.P. CONCRETE RETAINING WALL

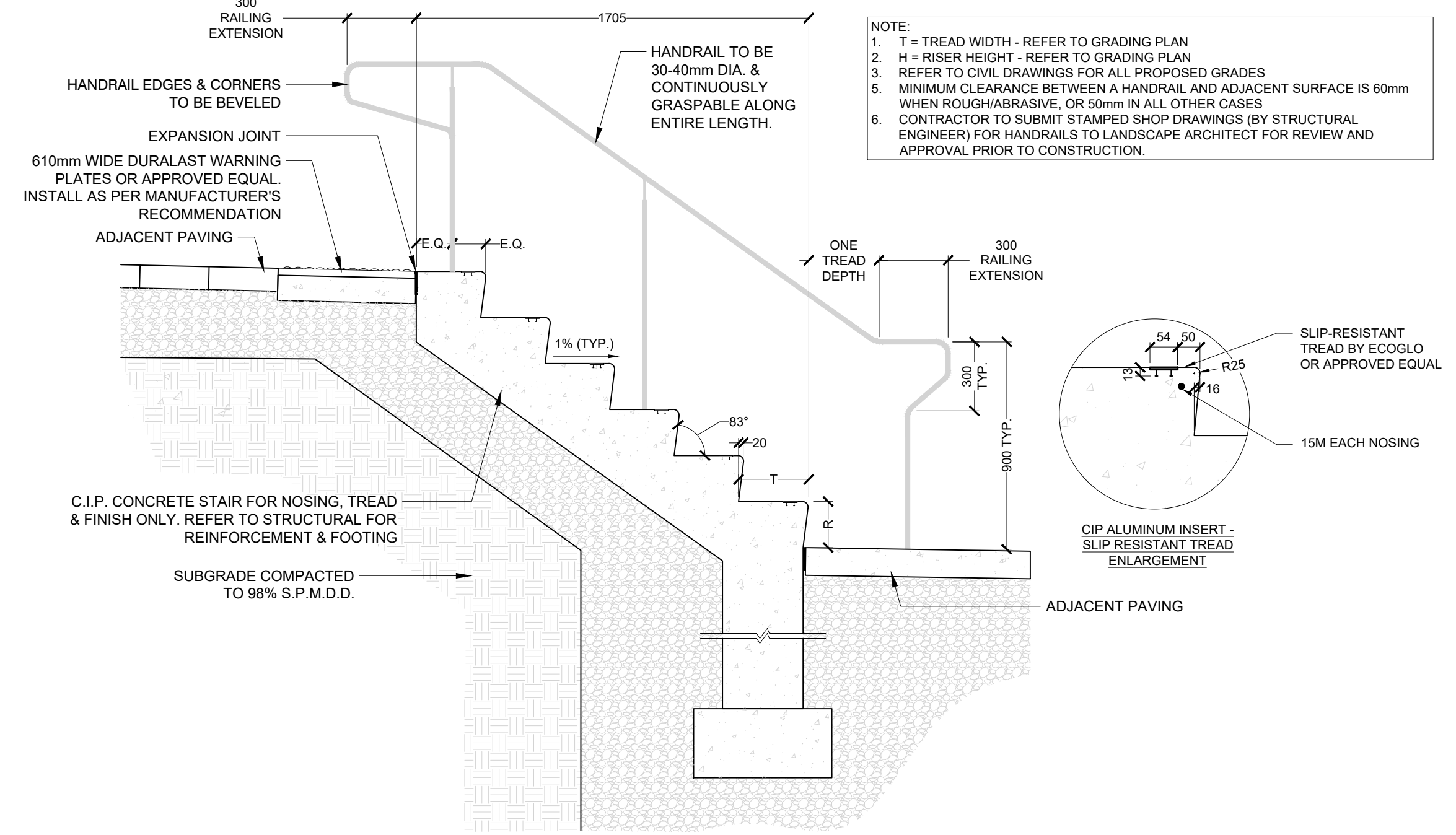

9 C.I.P. CONCRETE STAIR

NOTE: REFERENCE IMAGE FOR ILLUSTRATIVE PURPOSES ONLY.

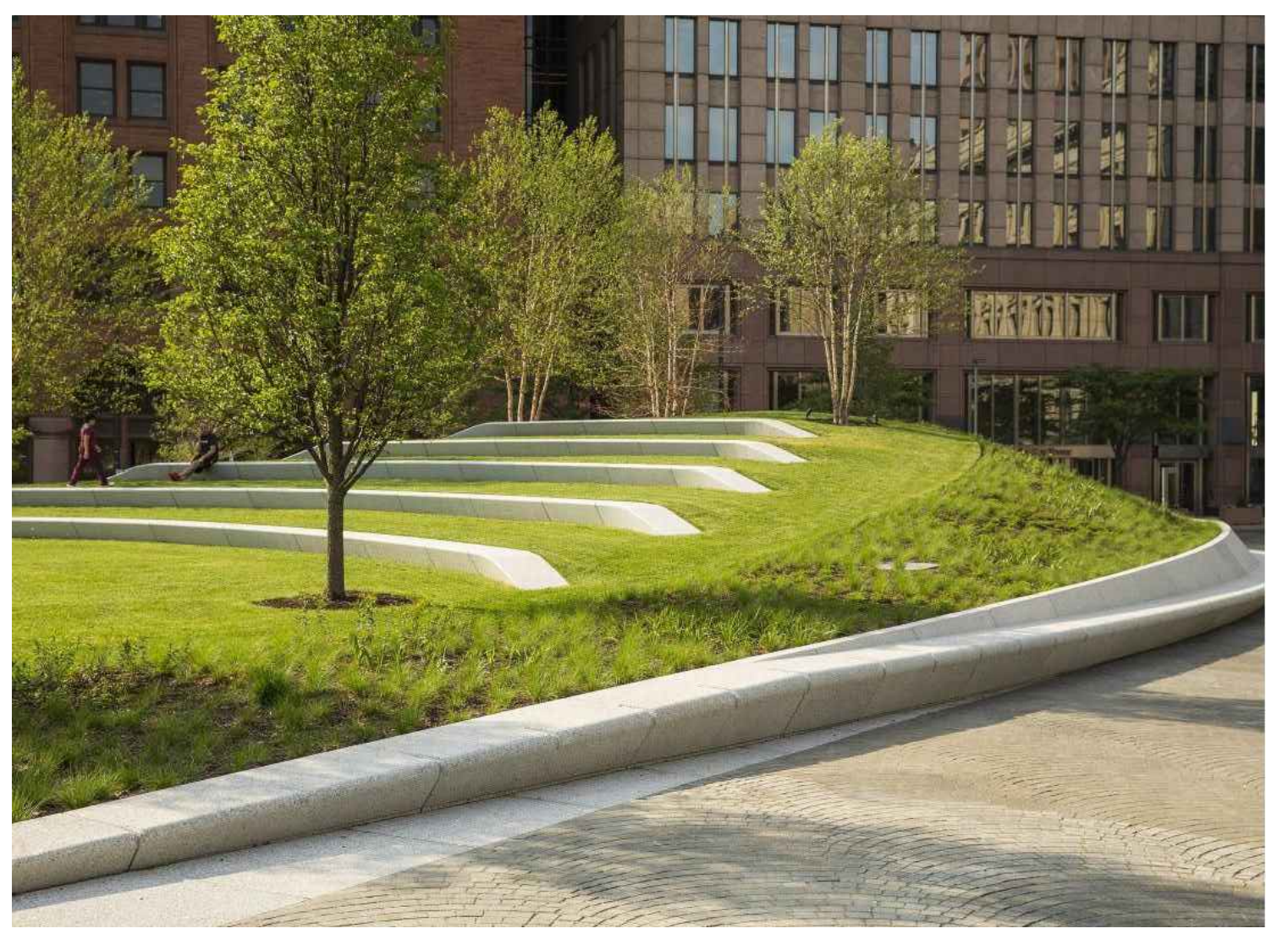

11 BENCH (TYPE 4) - AMPHITHEATRE SEATING

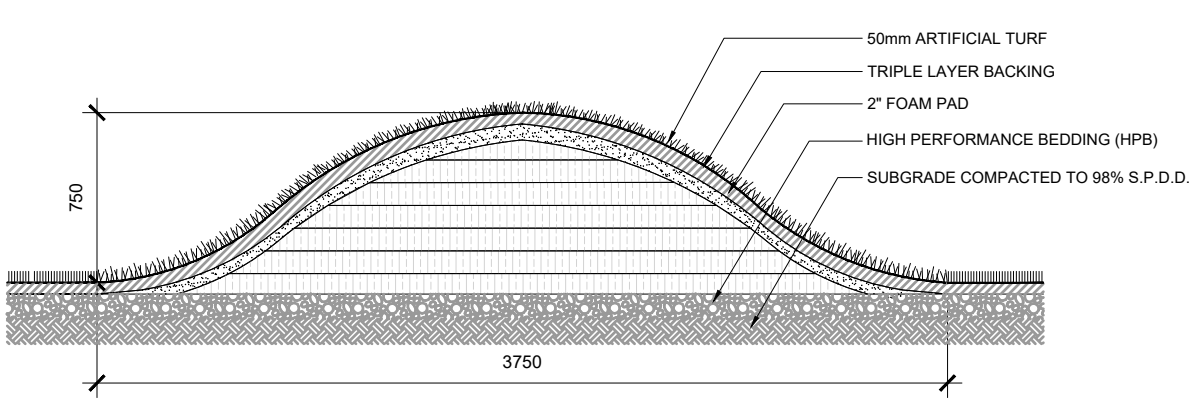

12 CHILDREN'S PLAY MOUND

NOTE: FOR MATERIAL REFERENCE ONLY. REFER TO STRUCTURAL DRAWINGS.



13 GABION WALL

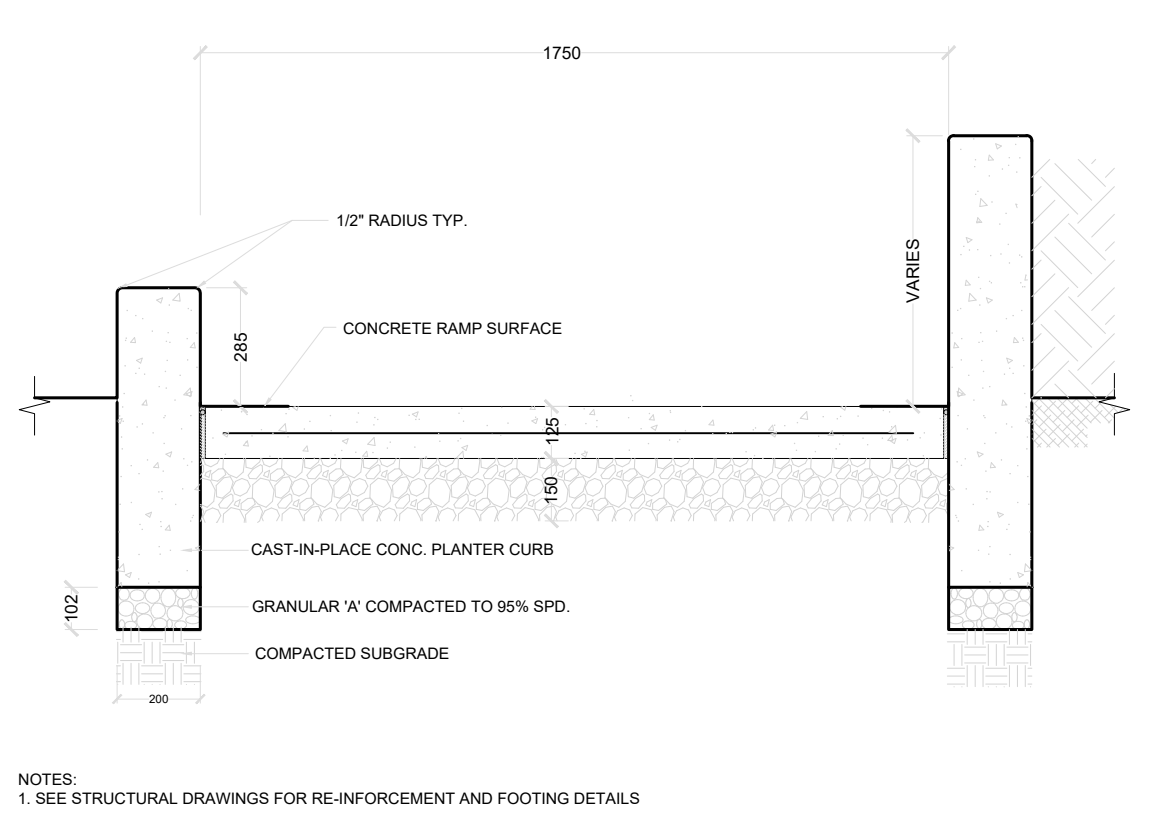

10 C.I.P. CONCRETE RAMP

Legend

GENERAL NOTES:
1. Drawings not to be used for construction unless authorized by the Landscape Architect.
2. Contractor shall report any discrepancies between the drawings and site conditions prior to commencement of the work.
3. All utility locations are the responsibility of the Contractor. Hand dig within the limits recommended by the service utility. Utility conflicts with proposed tree locations must be reported immediately to the Landscape Architect.
4. Sixteen Mile Community Centre & Library base drawing provided by Diamond Schmitt Architects.
5. For Sixteen Mile Community Centre grading information refer to drawing by MTE Consultants.
6. North Park Sports Park base drawings provided by The MBTW Group.
7. Landscape drawings show engineering information for design purposes only. Do not construct engineering works from these drawings.

HARDSCAPE DETAILS

North Park Development: Community Centre, Library and Sports Park, Oakville, ON

ISSUED FOR SITE PLAN APPROVAL. NOT FOR CONSTRUCTION.

DATE	ISSUE	BY
DATE	REVISIONS	BY
Jan-27-2022	Issue for Coordination	EL

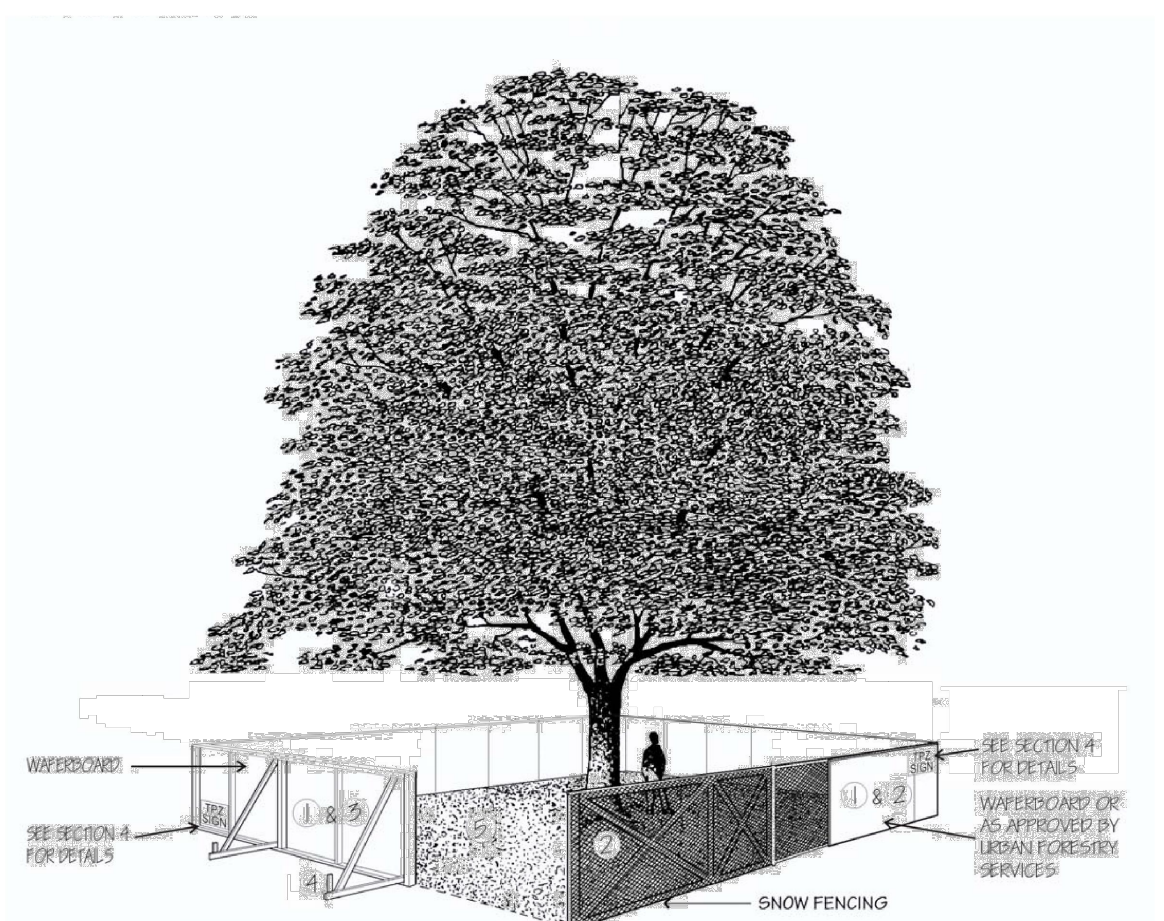

- Tree Protection Barriers**
- Tree protection barriers must be 1.2m (4ft) high, waistboard hoarding or an equivalent approved by Urban Forestry Services.
 - Tree protection barriers for trees situated on the Town road alignment where visibility must be maintained shall be 1.2m (4ft) high and consist of plastic web snow fencing on a wood frame made of 2" x 4"s.
 - When some activities or it has to be temporarily isolated and a tree protection barrier, it should be used to ensure the minimal extent the Tree Protection Zone.
 - All supports and bracing should be outside the Tree Protection Zone. All such supports should minimize damaging roots outside the Tree Protection Barrier.
 - No construction activity, grade change, surface treatment or excavations of any kind is permitted within the Tree Protection Zone.

1 TOWN OF OAKVILLE TREE PROTECTION BARRIER DETAIL

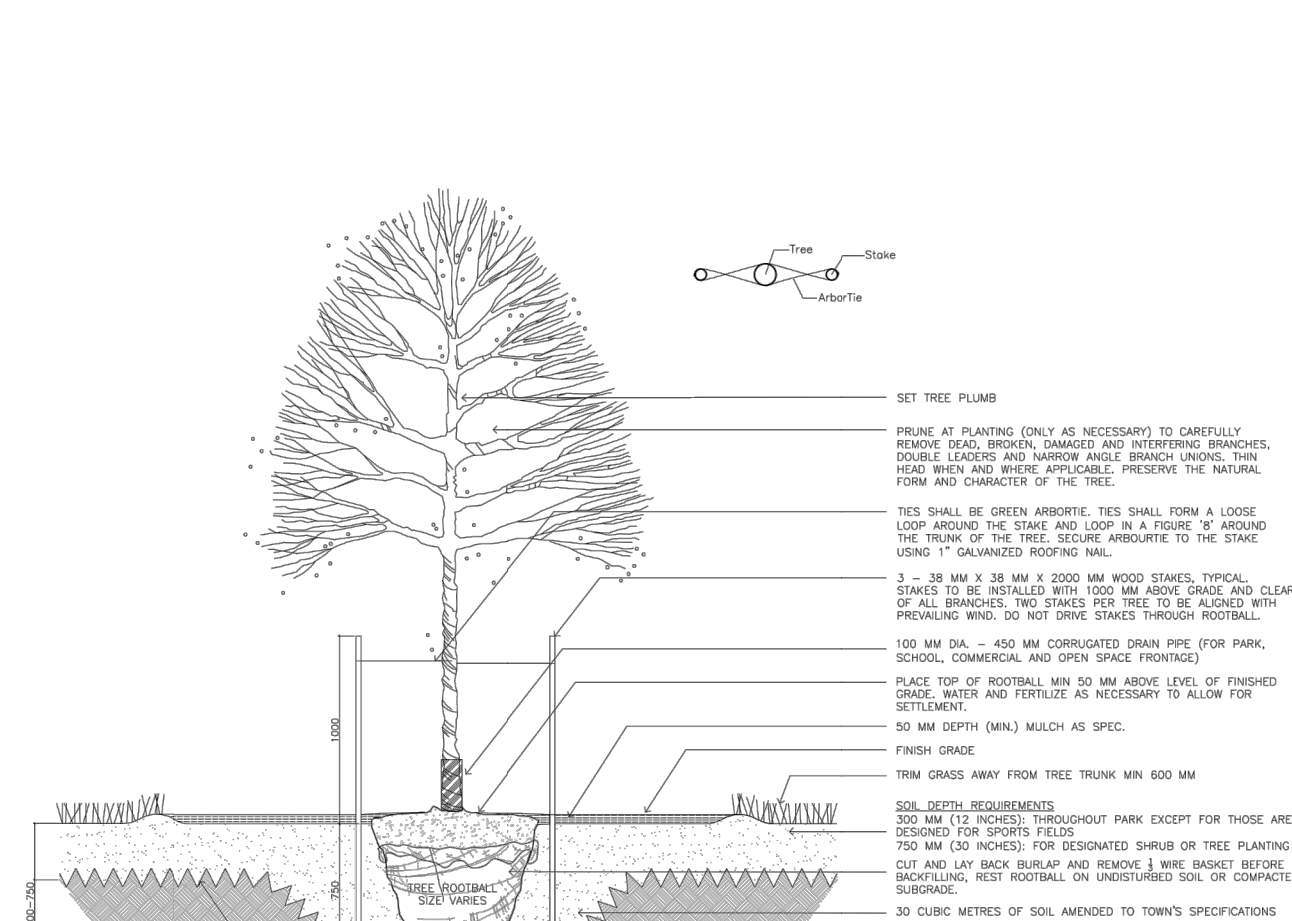

- Tree Planting Details**
- Special in planting area should be considered to be used by Barber (see Note 1).
 1. GROWING MEDIUM: 4 PARTS TOPSOIL, 1 PART COMPOST, 1 PART SHREDDED PEAT & APPLICATION OF HIGH PHOSPHOROUS FERTILIZER (30-0-0)
 2. PLANTING BED SHALL BE THOROUGHLY WATERED IMMEDIATELY AFTER PLANTING PRIOR TO MULCHING.
 3. FOR POTTER SHRUBS, SATURATE CONTAINER ROOTS/SOIL PRIOR TO REMOVAL OF CONTAINER BEFORE PLANTING.
 4. SHRUBS ARE TO BE SPACED AS DIRECTED.
 5. ALL DIMENSIONS ARE IN MILLIMETERS.

2 TOWN OF OAKVILLE TREE PLANTING DETAIL

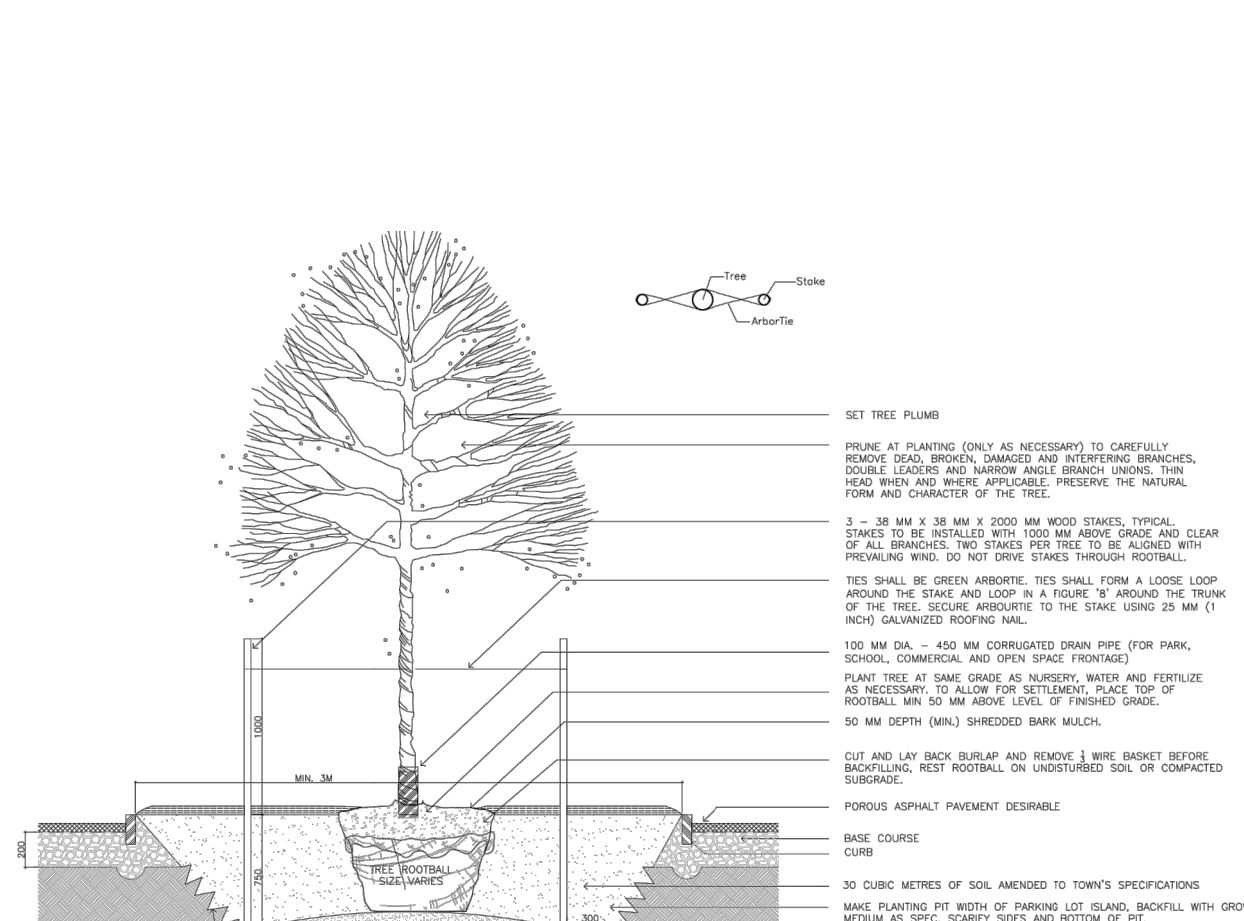

- Tree Planting in Parking Lot Detail**
1. GROWING MEDIUM: 4 PARTS TOPSOIL, 1 PART COMPOST, 1 PART SHREDDED PEAT & APPLICATION OF HIGH PHOSPHOROUS FERTILIZER (30-0-0)
 2. PLANTING BED SHALL BE THOROUGHLY WATERED IMMEDIATELY AFTER PLANTING PRIOR TO MULCHING.
 3. FOR POTTER SHRUBS, SATURATE CONTAINER ROOTS/SOIL PRIOR TO REMOVAL OF CONTAINER BEFORE PLANTING.
 4. SHRUBS ARE TO BE SPACED AS DIRECTED.
 5. ALL DIMENSIONS ARE IN MILLIMETERS.

3 TOWN OF OAKVILLE TREE PLANTING IN PARKING LOT DETAIL

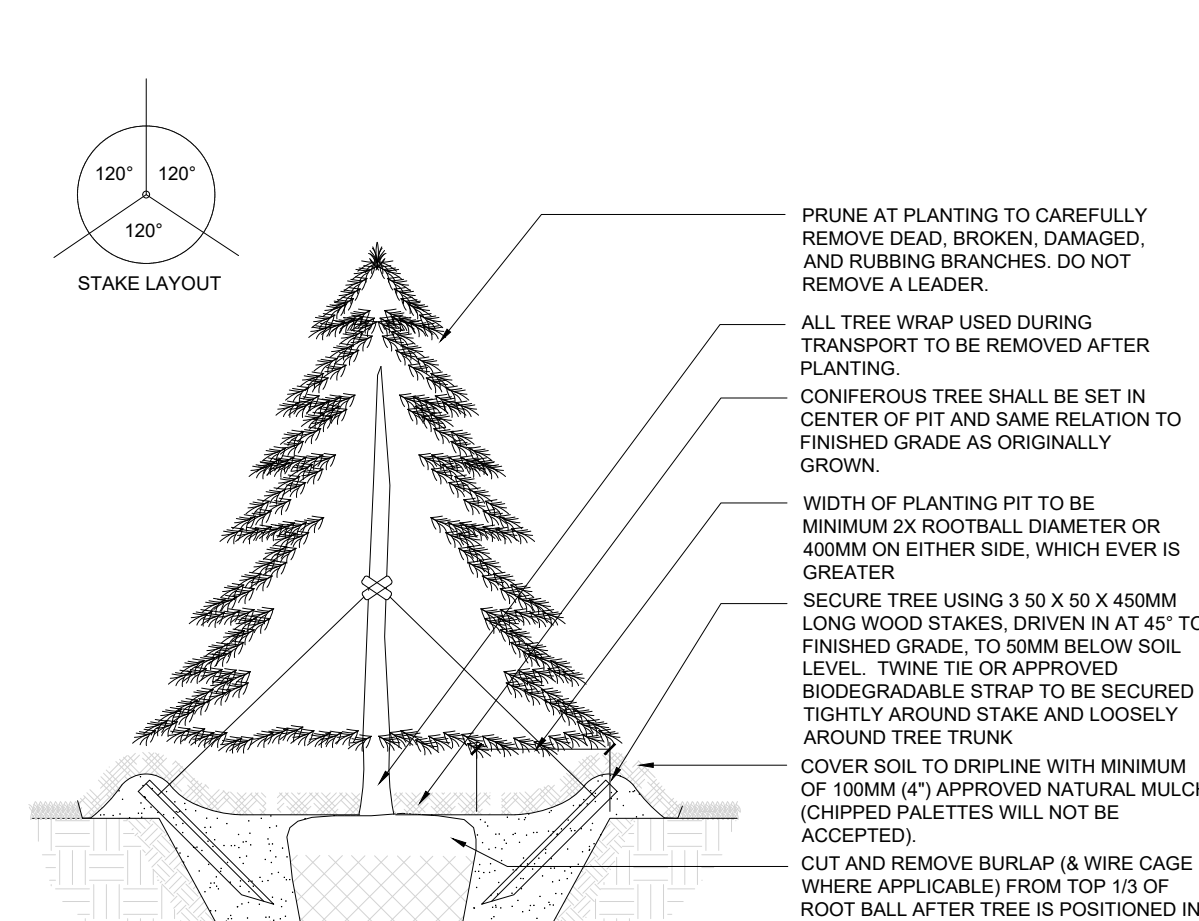

- Coniferous Tree Planting - Up to 2.5m Height (B.W/B)**
1. GROWING MEDIUM: 4 PARTS TOPSOIL, 1 PART COMPOST, 1 PART SHREDDED PEAT & APPLICATION OF HIGH PHOSPHOROUS FERTILIZER (30-0-0)
 2. PLANT MATERIAL SHALL BE THOROUGHLY WATERED AT TIME OF PLANTING.
 3. PLANT MATERIAL SHALL BE SET PLUMB IN THE MIDDLE OF THE PIT.
 4. TREE SHALL BEAR SAME RELATION TO EXISTING GRADE AS ORIGINALLY GROWN.
 5. PLANT STOCK SHALL BE COVERED WHILE IN TRANSIT. ROOTS SHOULD BE KEPT MOIST UNTIL PLANTED. TREES TO BE TREATED WITH ANTI-DESICANT.
 6. DIMENSIONS ARE IN MILLIMETERS UNLESS OTHERWISE NOTED.
 7. STAKING IS TO OCCUR ONLY AT THE DIRECTION OF THE LANDSCAPE ARCHITECT.
 8. 100MM HIGH SAUCER EXCEPT WHERE NOTED IN RED.

4 CONFEROUS TREE PLANTING - UP TO 2.5M HEIGHT (B.W/B) N.T.S.

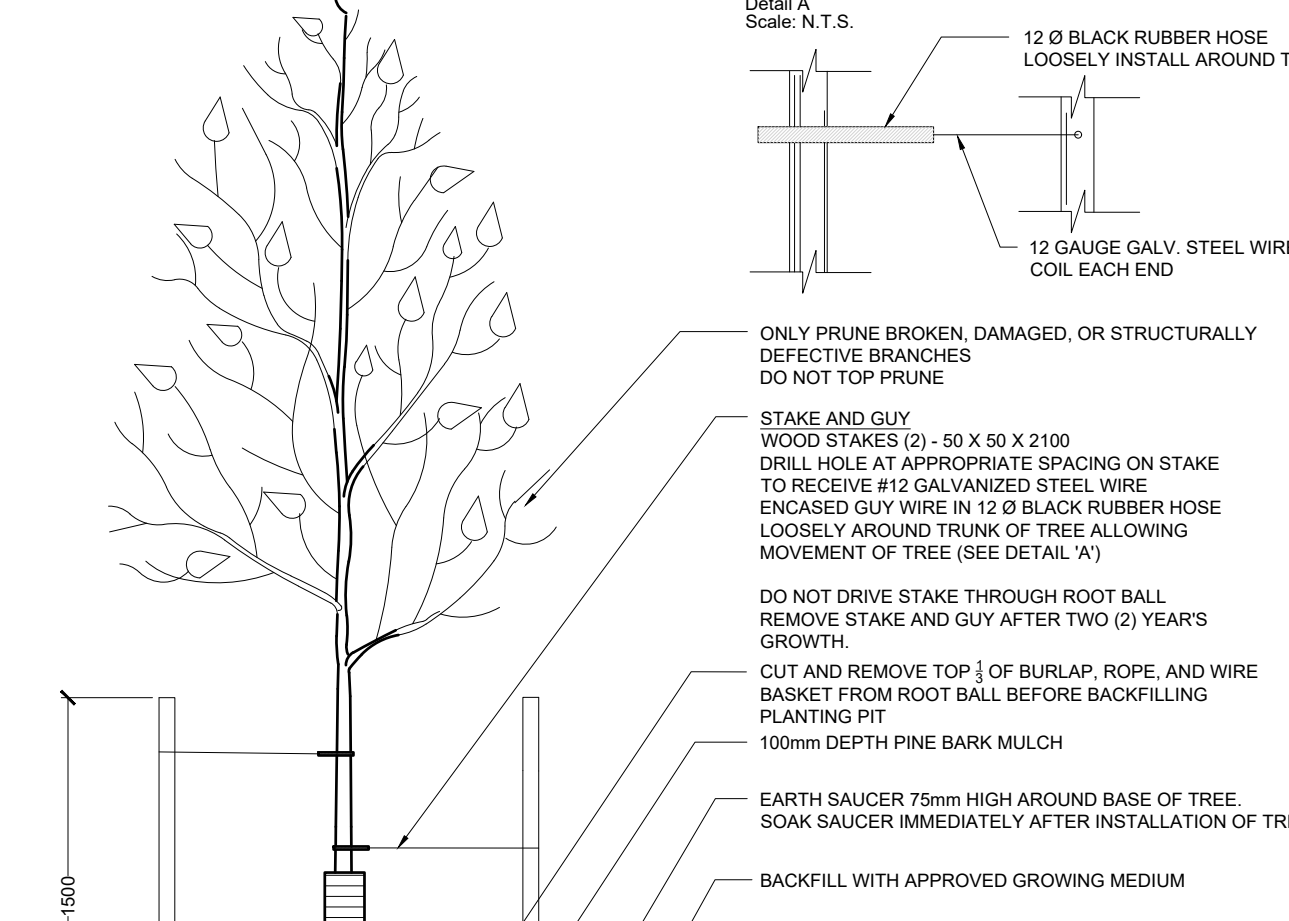

- Deciduous Tree Planting On A Slope N.T.S.**
1. ALL DIMENSIONS IN MILLIMETERS UNLESS OTHERWISE NOTED.
 2. BACKFILL WITH APPROVED GROWING MEDIUM.
 3. PLANTING PIT DEPTH SHALL BE THE SAME DEPTH AS THE ROOT BALL AND 900 OR 1.5 TIMES THE WIDTH - WHICHEVER IS GREATER.
 4. WIRE TWISTED AROUND TREE GUARD WILL BE TWISTED BACK TO TREE SIDE OF GUARD.
 5. PLANT TREE TO ABOVE EXISTING ADJACENT GRADE TO ACCOMMODATE FOR SETTLEMENT.
 6. PROVIDE DRAINAGE FOR PLANTING PIT IN IMPERMEABLE SOIL.

5 Deciduous Tree Planting On A Slope N.T.S.

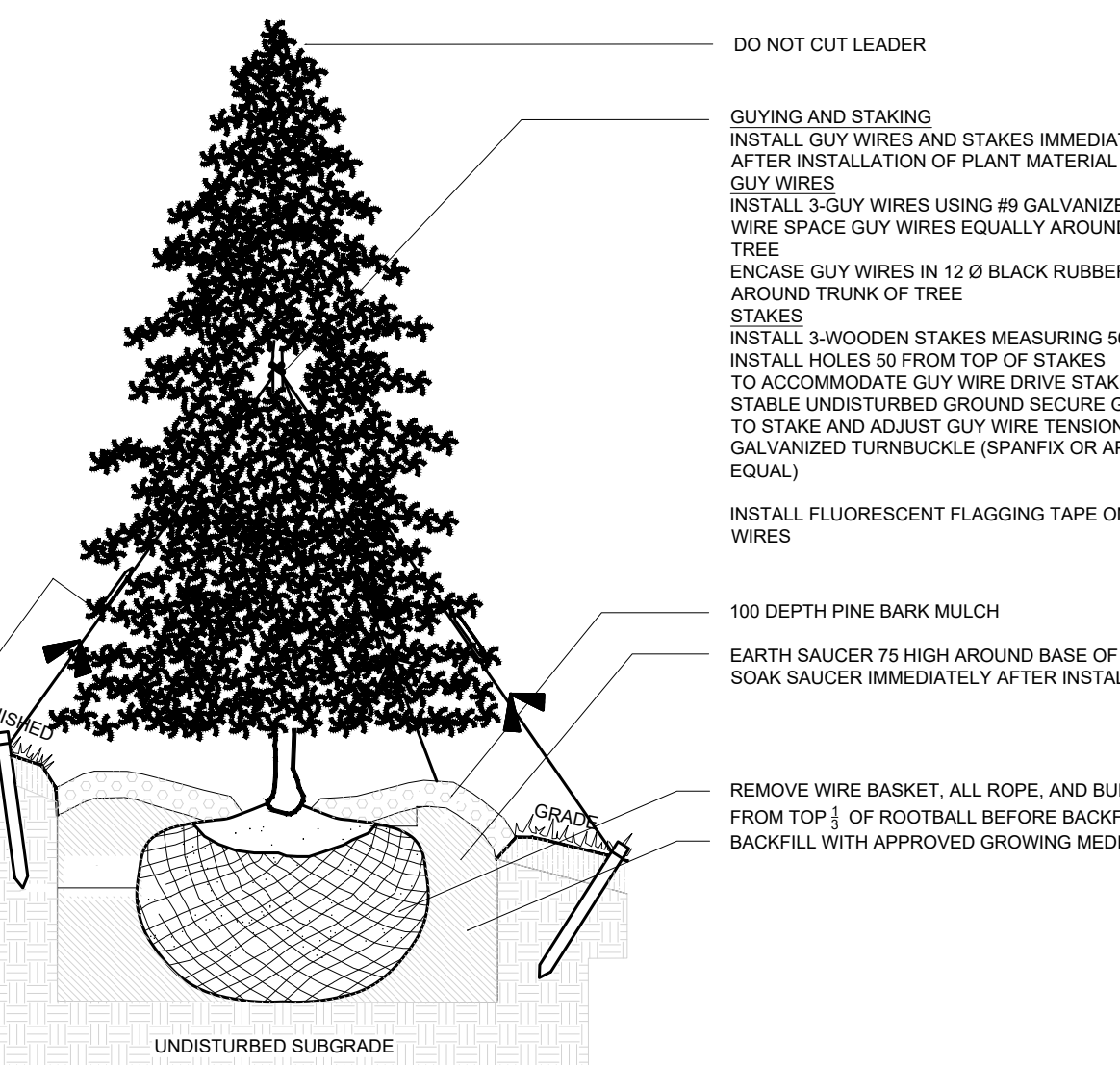

- Coniferous Tree Planting On A Slope N.T.S.**
1. ALL DIMENSIONS IN MILLIMETERS UNLESS OTHERWISE NOTED.
 2. BACKFILL WITH APPROVED GROWING MEDIUM.
 3. PLANTING PIT DEPTH SHALL BE THE SAME DEPTH AS THE ROOT BALL AND 900 OR 1.5 TIMES THE WIDTH - WHICHEVER IS GREATER.
 4. WIRE TWISTED AROUND TREE GUARD WILL BE TWISTED BACK TO TREE SIDE OF GUARD.
 5. TREE BANK AT TRUNK WILL BEAR SAME RELATION TO FINISHED GRADE AS IT BORE TO PREVIOUS EXISTING GRADE.
 6. SOAK COMPLETELY WITH WATER AND MULCH IMMEDIATELY.
 7. PLANT TREE TO ABOVE EXISTING ADJACENT GRADE TO ACCOMMODATE SETTLEMENT.

6 Coniferous Tree Planting On A Slope N.T.S.

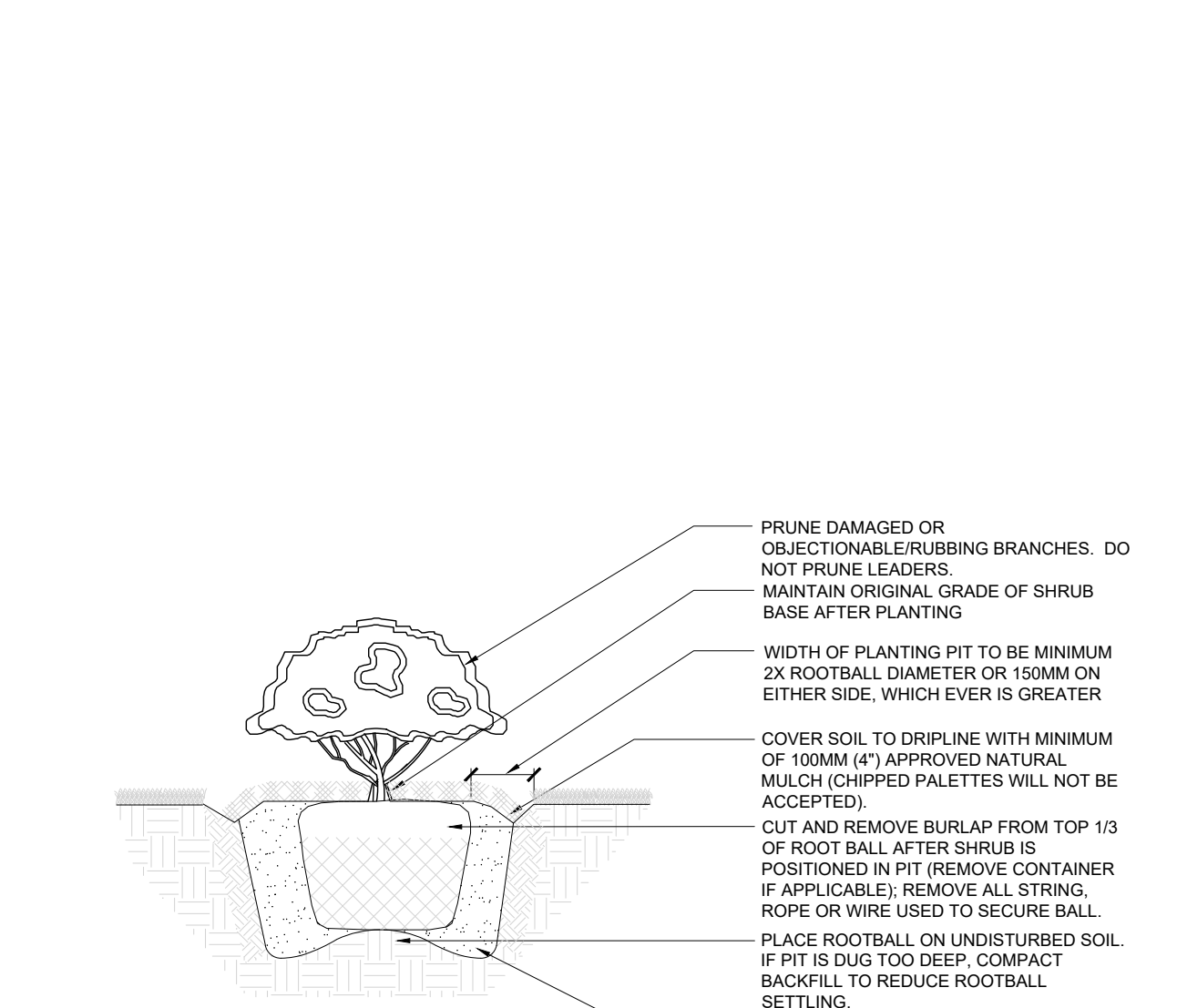

- B&B/CONTAINER STOCK SHRUB PLANTING N.T.S.**
1. GROWING MEDIUM: 4 PARTS TOPSOIL, 1 PART COMPOST, 1 PART SHREDDED PEAT & APPLICATION OF HIGH PHOSPHOROUS FERTILIZER (30-0-0)
 2. PLANTING BED SHALL BE THOROUGHLY WATERED IMMEDIATELY AFTER PLANTING PRIOR TO MULCHING.
 3. FOR POTTER SHRUBS, SATURATE CONTAINER ROOTS/SOIL PRIOR TO REMOVAL OF CONTAINER BEFORE PLANTING.
 4. SHRUBS ARE TO BE SPACED AS DIRECTED.
 5. ALL DIMENSIONS ARE IN MILLIMETERS.

7 B&B/CONTAINER STOCK SHRUB PLANTING N.T.S.

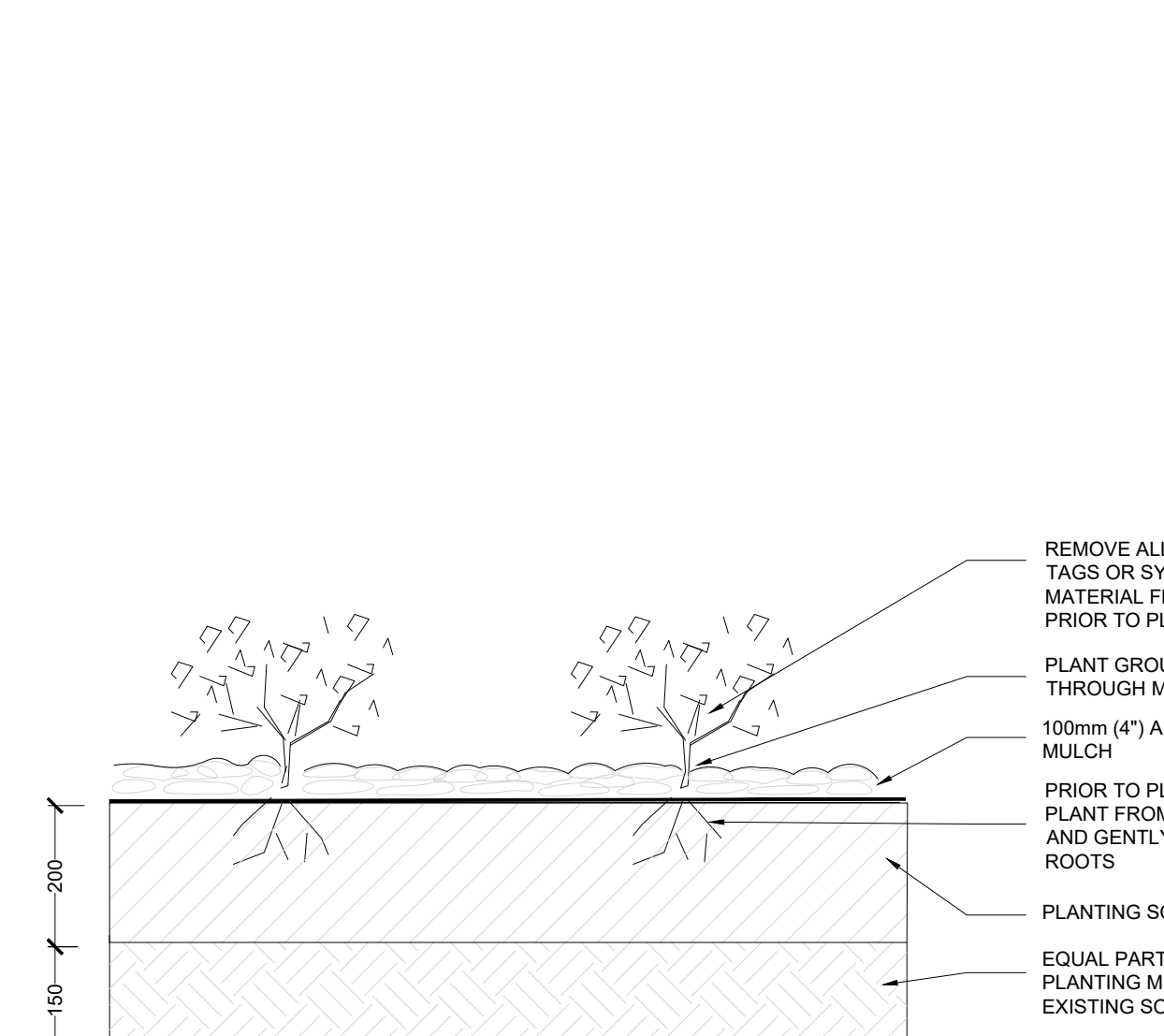

- ORNAMENTAL GRASS PLANTING N.T.S.**
1. DO NOT ALLOW ROOTS TO DRY OUT DURING THE INSTALLATION PROCESS.

8 ORNAMENTAL GRASS PLANTING N.T.S.

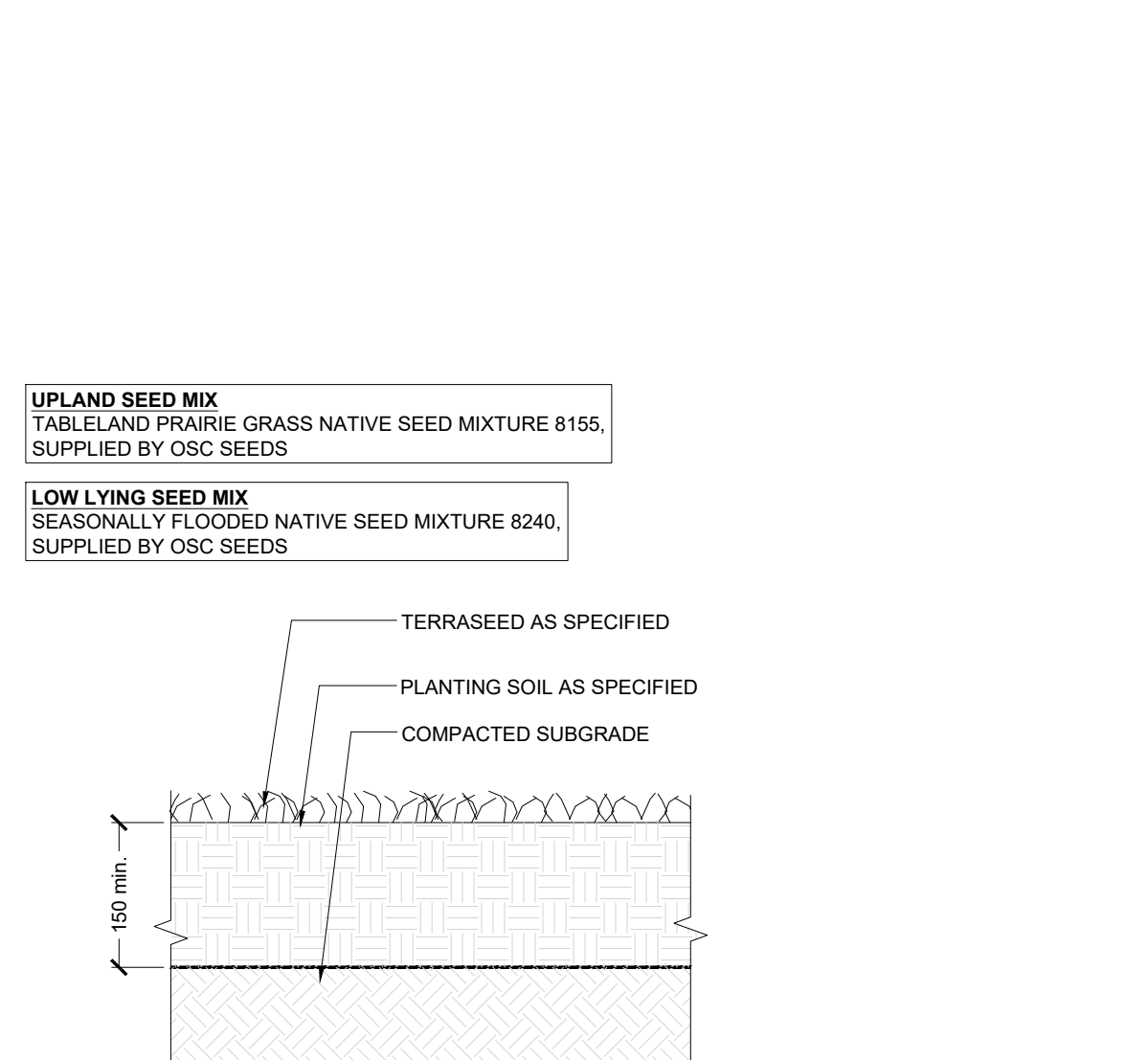

- SEEDING Scale 1:15**
1. DO NOT ALLOW ROOTS TO DRY OUT DURING THE INSTALLATION PROCESS.

9 SEEDING Scale 1:15

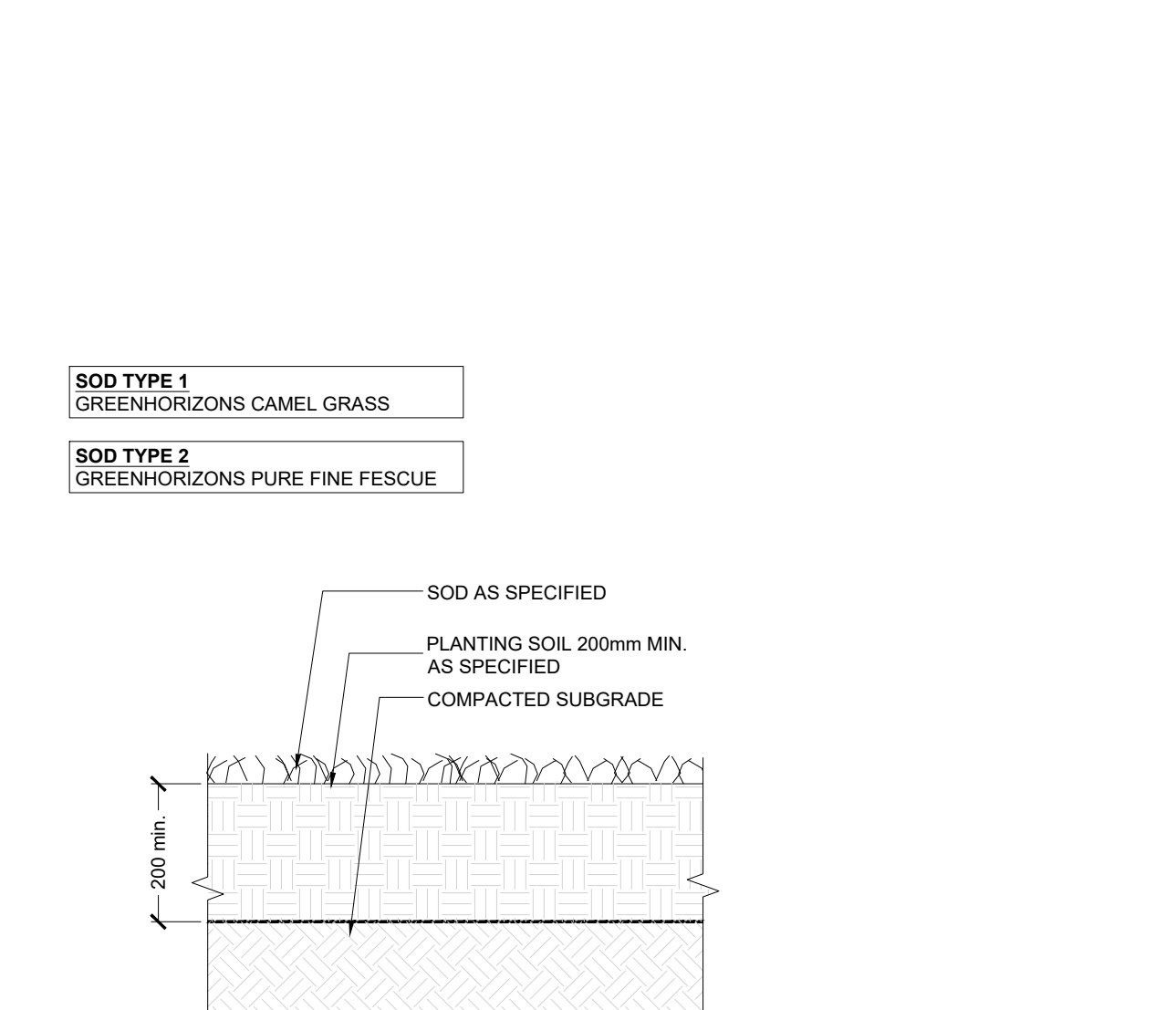

- SOD Scale 1:15**
1. DO NOT ALLOW ROOTS TO DRY OUT DURING THE INSTALLATION PROCESS.

10 SOD Scale 1:15

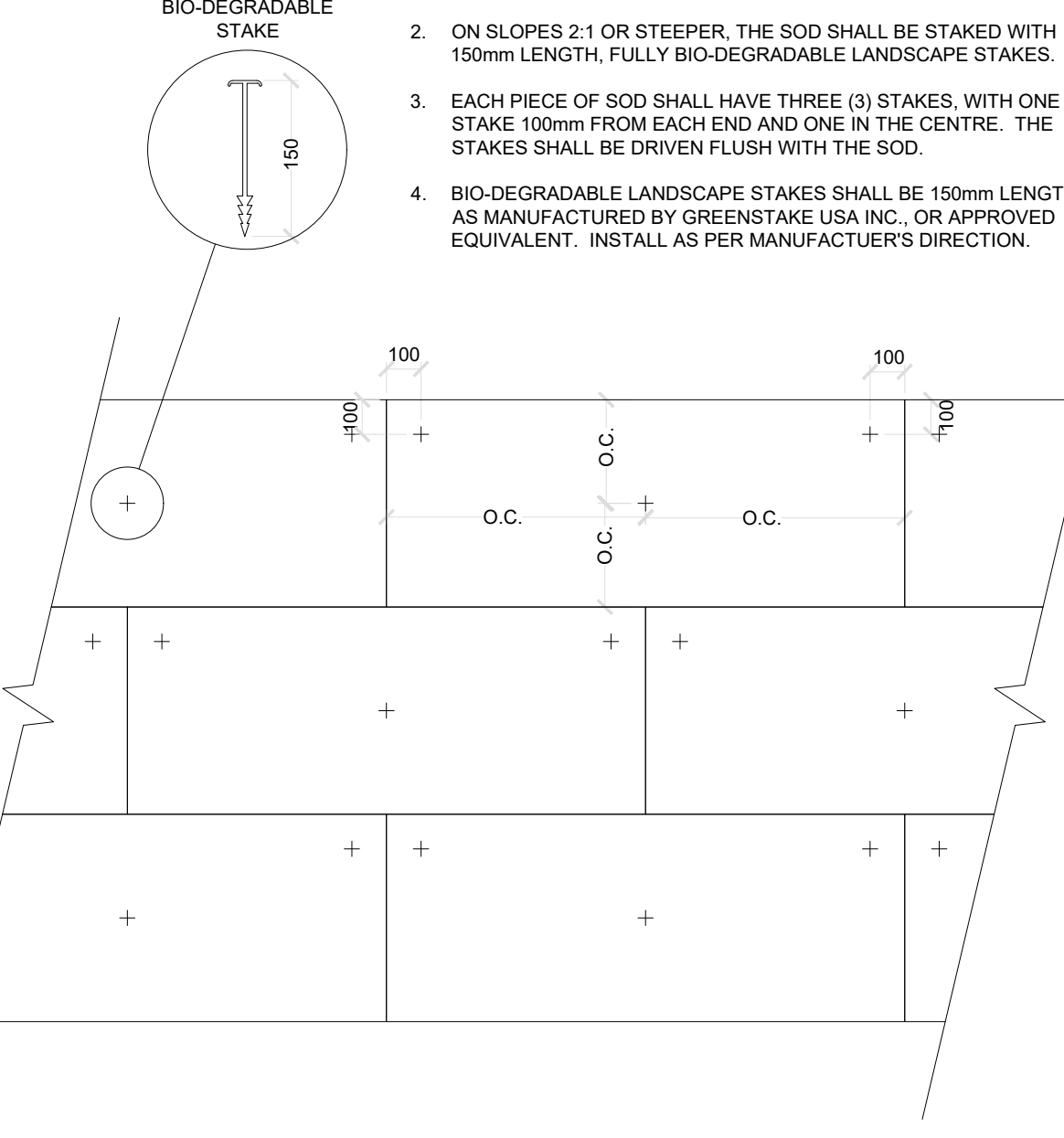

- SOD ON SLOPE INSTALLATION N.T.S.**
1. SOD SHALL BE PLACED LENGTHWISE ACROSS THE FACE OF SLOPES AND PARALLEL TO THE CENTRE LINE OF SWALES AND AS PER SPECIFICATIONS.
 2. ON SLOPES 2:1 OR STEEPER, THE SOD SHALL BE STAKED WITH 150mm LENGTH FULLY BIO-DEGRADABLE LANDSCAPE STAKES.
 3. EACH PIECE OF SOD SHALL HAVE THREE (3) STAKES, WITH ONE STAKE 100mm FROM EACH END AND ONE IN THE CENTRE. THE STAKES SHALL BE DRIVEN FLUSH WITH THE SOD.
 4. BIO-DEGRADABLE LANDSCAPE STAKES SHALL BE 150mm LENGTH AS MANUFACTURED BY GREENSTAKE USA, INC. OR APPROVED EQUIVALENT. INSTALL AS PER MANUFACTURER'S DIRECTION.

11 SOD ON SLOPE INSTALLATION N.T.S.

Legend

1. GROWING MEDIUM: 4 PARTS TOPSOIL, 1 PART COMPOST, 1 PART SHREDDED PEAT & APPLICATION OF HIGH PHOSPHOROUS FERTILIZER (30-0-0)
2. PLANTING BED SHALL BE THOROUGHLY WATERED IMMEDIATELY AFTER PLANTING PRIOR TO MULCHING.
3. FOR POTTER SHRUBS, SATURATE CONTAINER ROOTS/SOIL PRIOR TO REMOVAL OF CONTAINER BEFORE PLANTING.
4. SHRUBS ARE TO BE SPACED AS DIRECTED.
5. ALL DIMENSIONS ARE IN MILLIMETERS.

- GENERAL NOTES:**
- Drawings not to be used for construction unless authorized by the Landscape Architect.
 - Contractor shall report any discrepancies between the drawings and site conditions prior to commencement of the work.
 - All utility locates are the responsibility of the Contractor. Hand dig within the limits recommended by the service utility. Utility conflicts with proposed tree locations must be reported immediately to the Landscape Architect.
 - Sixteen Mile Community Centre & Library base drawing provided by Diamond Schmidt Architects.
 - For Sixteen Mile Community Centre grading information refer to drawing by MTE Consultants.
 - North Park Sports Park base drawings provided by The MBTW Group.
 - Landscape drawings show engineering information for design purposes only. Do not construct engineering works from these drawings.

PLANTING DETAILS

North Park Development: Community Centre, Library and Sports Park, Oakville, ON

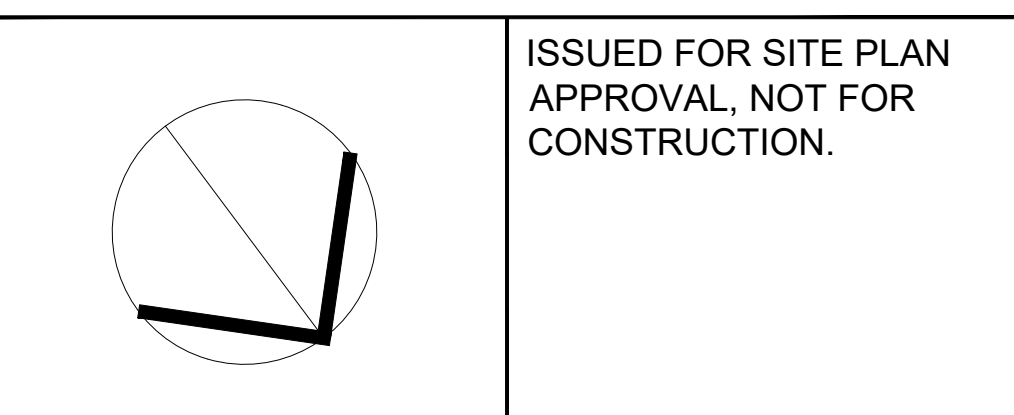

ISSUED FOR SITE PLAN APPROVAL. NOT FOR CONSTRUCTION.

DATE	ISSUE	BY
DATE	REVISIONS	BY
Jan-27-2022	Issue for Coordination	EL

GSP group

15000 Steeles Ave. East, Suite 201
Markham, Ontario L3R 0Y9
Tel: 905.477.1111
www.gspgroup.ca

15000 Steeles Ave. East, Suite 201
Markham, Ontario L3R 0Y9
Tel: 905.477.1111
www.gspgroup.ca

Date: October 2021
Scale: AS SHOWN
Drawn By: MZ, BL
Project No.: 21337

L5.40