

## **Appendix J: Utility Consultation**

- Oakville Hydro
- One Call

## **Oakville Hydro**

## Vijayakumar, Roslyn

---

**From:** Talpur, Mir  
**Sent:** Monday, July 4, 2022 8:56 AM  
**To:** Dan Steele  
**Cc:** Syed Rizvi; Jill MacInnes; Sinke, David; Felker, Bob; Daniela Motoc; Vijayakumar, Roslyn  
**Subject:** RE: McCraney Creek Bridge Replacement - Notice of Study Commencement and Online Public Information Centre

Good Morning Dan,

Thank you for sharing this information. We will document this in the Project File Report and will identify the need for future consultation and coordination with Oakville Hydro.

Sincerely,

Mir

**Mir Ahsan Talpur, M.Env.Sc., EP**

Environmental Planner

Mobile: +1 (647) 545 8974

[www.woodplc.com](http://www.woodplc.com)

The logo for Wood PLC, featuring the word "wood." in a bold, dark blue, lowercase sans-serif font. The period is a solid dot.

---

**From:** Dan Steele <dsteede@oakvillehydro.com>  
**Sent:** Thursday, June 30, 2022 1:55 PM  
**To:** Talpur, Mir <mir.talpur@woodplc.com>  
**Cc:** Syed Rizvi <syed.rizvi@oakville.ca>; Jill MacInnes <jill.macinnes@oakville.ca>; Sinke, David <david.sinke@woodplc.com>; Felker, Bob <bob.felker@woodplc.com>; Daniela Motoc <dmotoc@oakvillehydro.com>  
**Subject:** RE: McCraney Creek Bridge Replacement - Notice of Study Commencement and Online Public Information Centre

**CAUTION:** External email. Please do not click on links/attachments unless you know the content is genuine and safe.

Hi Mir,

I'm sure this was noted on your field evaluations/inspections, but to confirm, Oakville Hydro has an overhead pole line on Lakeshore Rd W in this area. There are two overhead high voltage circuits as well as a neutral conductor and low voltage wires crossing the bridge area between poles #1623 and #1621. This is shown in the GIS screen shot below. The two circuits, neutral and low voltage lines will need to remain in service during the bridge replacement/reconstruction. Please consider this once you move to detailed design, and keep us informed of any progress. The main contact for the project will Daniela Motoc, Chief Engineer, Distribution, copied here.

Thanks,

Dan

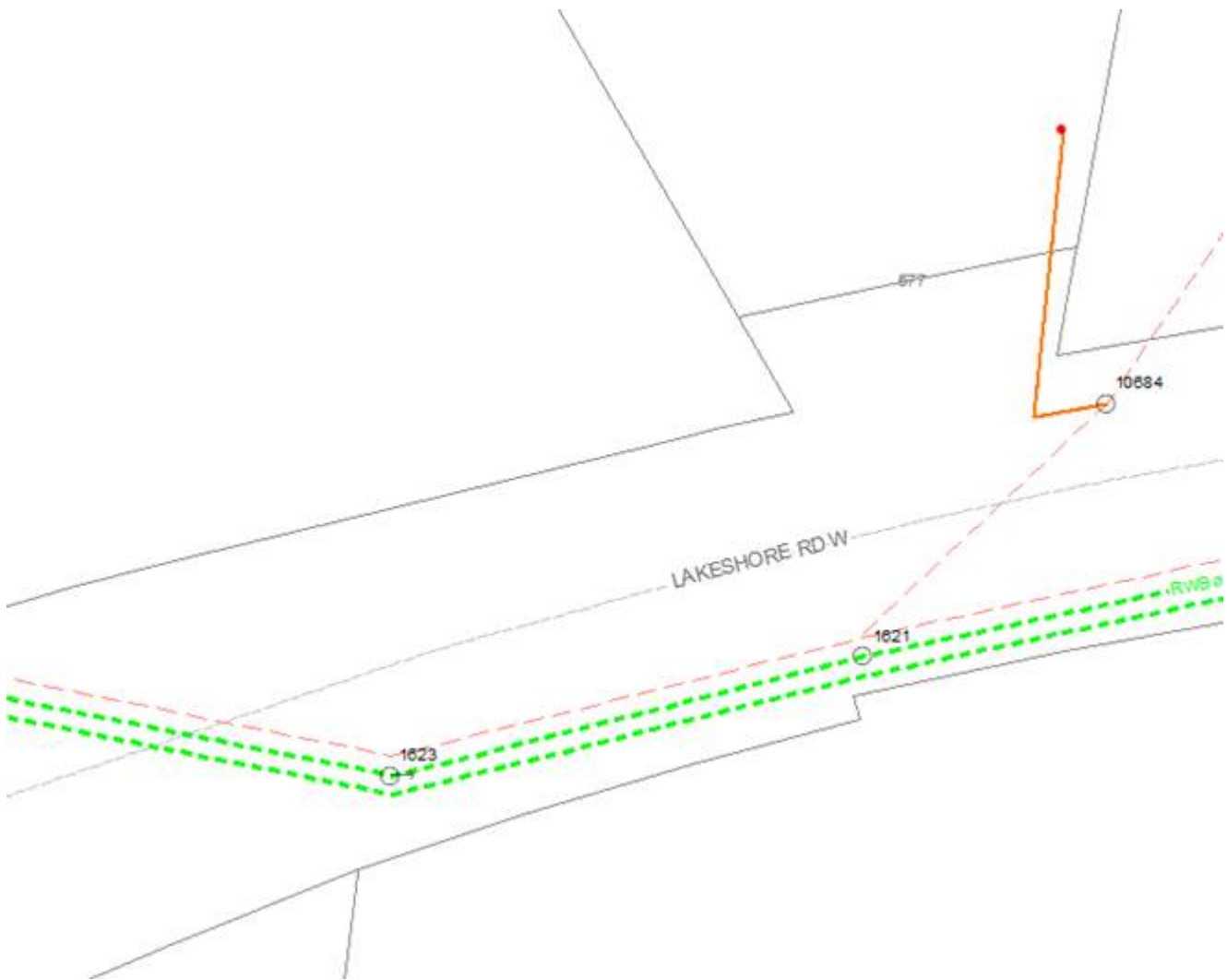

**OAKVILLE HYDRO**

*Daniel P. Steele, P.Eng., MBA*  
Director, Engineering and Construction  
Oakville Hydro

Direct: 905-825-4474  
[dstele@oakvillehydro.com](mailto:dstele@oakvillehydro.com)  
[www.oakvillehydro.com](http://www.oakvillehydro.com)

861 Redwood Square  
Oakville, ON  
L6L 6R6

*Lead • Innovate • Commit To Excellence*

---

**From:** Talpur, Mir <[mir.talpur@woodplc.com](mailto:mir.talpur@woodplc.com)>  
**Sent:** Friday, June 24, 2022 10:11 AM  
**To:** Talpur, Mir <[mir.talpur@woodplc.com](mailto:mir.talpur@woodplc.com)>  
**Cc:** Syed Rizvi <[syed.rizvi@oakville.ca](mailto:syed.rizvi@oakville.ca)>; Jill MacInnes <[jill.macinnes@oakville.ca](mailto:jill.macinnes@oakville.ca)>; Sinke, David <[david.sinke@woodplc.com](mailto:david.sinke@woodplc.com)>; Felker, Bob <[bob.felker@woodplc.com](mailto:bob.felker@woodplc.com)>  
**Subject:** RE: McCraney Creek Bridge Replacement - Notice of Study Commencement and Online Public Information Centre

Good Morning,

This is a gentle reminder regarding the ongoing Public Information Centre for McCraney Creek Bridge Replacement Municipal Class Environmental Assessment (Schedule 'B'). Comments are being requested by **June 30, 2022**. Please refer to the [project webpage](#) for more information.

Sincerely,

Mir

**Mir Ahsan Talpur, M.Env.Sc., EP**  
Environmental Planner  
Mobile: +1 (647) 545 8974  
[www.woodplc.com](http://www.woodplc.com)

The logo for Wood PLC, featuring the word "wood." in a bold, lowercase, sans-serif font. The period is a solid dot.

---

**From:** Talpur, Mir  
**Sent:** Monday, June 6, 2022 1:50 PM  
**To:** Talpur, Mir <[mir.talpur@woodplc.com](mailto:mir.talpur@woodplc.com)>  
**Cc:** Syed Rizvi <[syed.rizvi@oakville.ca](mailto:syed.rizvi@oakville.ca)>; Jill MacInnes <[jill.macinnes@oakville.ca](mailto:jill.macinnes@oakville.ca)>; Sinke, David <[david.sinke@woodplc.com](mailto:david.sinke@woodplc.com)>; Felker, Bob <[bob.felker@woodplc.com](mailto:bob.felker@woodplc.com)>  
**Subject:** McCraney Creek Bridge Replacement - Notice of Study Commencement and Online Public Information Centre

6 June 2022

## **McCraney Creek Bridge Replacement Notice of Study Commencement and Online Public Information Centre Municipal Class Environmental Assessment**

The Town of Oakville has initiated an environmental assessment for the replacement of the McCraney Creek Bridge that is located over McCraney Creek, on Lakeshore Road West immediately to the east

of Fourth Line. The bridge was built in 1940. Due to its deteriorating condition, ongoing erosion and risk of flooding, the bridge requires replacement. The purpose of this email is to share the attached notice with you and invite you to participate in the upcoming Public Information Centre (PIC).

The Town is hosting a Public Information Centre to share the recommended solution for bridge replacement. Information materials will be available on the [project webpage](#), from **June 16 to June 30, 2022**. We encourage you to participate in the PIC by reviewing the information materials and providing any comments on the online comment form by **June 30, 2022**. You are also invited to attend the **Online Presentation on Tuesday, June 21, 2022, at 6 p.m.** where there will be an opportunity to ask any questions of the study team and provide comments. Please refer to the attached notice and visit project webpage for further details.

Sincerely,

Mir

**Mir Ahsan Talpur, M.Env.Sc., EP**

Environmental Planner

Mobile: +1 (647) 545 8974

**[www.woodplc.com](http://www.woodplc.com)**

The logo for Wood, featuring the word "wood." in a bold, dark blue, lowercase sans-serif font. The period is a solid dot.

---

This message is the property of John Wood Group PLC and/or its subsidiaries and/or affiliates and is intended only for the named recipient(s). Its contents (including any attachments) may be confidential, legally privileged or otherwise protected from disclosure by law. Unauthorized use, copying, distribution or disclosure of any of it may be unlawful and is strictly prohibited. We assume no responsibility to persons other than the intended named recipient(s) and do not accept liability for any errors or omissions which are a result of email transmission. If you have received this message in error, please notify us immediately by reply email to the sender and confirm that the original message and any attachments and copies have been destroyed and deleted from your system.

If you do not wish to receive future unsolicited commercial electronic messages from us, please forward this email to: [unsubscribe@woodplc.com](mailto:unsubscribe@woodplc.com) and include "Unsubscribe" in the subject line. If applicable, you will continue to receive invoices, project communications and similar factual, non-commercial electronic communications.

Please click <http://www.woodplc.com/email-disclaimer> for notices and company information in relation to emails originating in the UK, Italy or France.

As a recipient of an email from a John Wood Group Plc company, your contact information will be on our systems and we

may hold other personal data about you such as identification information, CVs, financial information and information contained in correspondence. For more information on our privacy practices and your data protection rights, please see our privacy notice at <https://www.woodplc.com/policies/privacy-notice>

---

Project File Report  
McCraney Creek Bridge Replacement  
Municipal Class Environmental  
Assessment

**One Call**



**From:** [solutions@on1call.com](mailto:solutions@on1call.com)  
**To:** [Talpur, Mir](#)  
**Subject:** Request 20222918400  
**Date:** Thursday, July 14, 2022 9:21:08 AM  
**Attachments:** [MapSelection\\_14072022\\_09175644.jpg](#)

---

**CAUTION:** External email. Please do not click on links/attachments unless you know the content is genuine and safe.



## LOCATE REQUEST CONFIRMATION

<b>REQUEST #:</b> 20222918400	<b>REQUEST PRIORITY:</b> PLANNING	<b>REQUEST TYPE:</b> REGULAR	<b>WORK TO BEGIN DATE:</b> 07/21/2022
<b>Update of Request #</b>	<b>Project #:</b>	<b>Call Date:</b> 07/14/2022 09:15:03 AM	<b>Transmit Date:</b> 07/14/2022 09:20:23 AM

### REQUESTOR'S CONTACT INFORMATION

**Contractor ID:** 367651

**Contact Name:** MIR AHSAN TALPUR

**Company Name:** WOOD E&IS

**Address:** 3450 HARVESTER ROAD (SUITE 100), BURLINGTON, ON,  
L7N 3W5

**Email:** [mir.talpur@woodplc.com](mailto:mir.talpur@woodplc.com)

**Primary Phone #:** (647) 545-8974

**Cell Phone #:**

**Contact Name:**

**Contact #:**

### DIG INFORMATION

**Region/County:** HALTON

**Community:**

**City:** OAKVILLE

**Address:** LAKESHORE RD W

**Intersecting Street 1:** FOURTH LINE

**Intersecting Street 2:** WHITTINGTON  
PLACE

**Reason for Work:** DESIGN AND  
PLANNING

**Work End Date:**

ADDITIONAL INFORMATION	QUALIFYING INFORMATION
BRIDGE REPLACEMENT AND CREEK REALIGNMENT	

**MEMBERS NOTIFIED: The following owners of underground infrastructure in the area of your excavation site have been notified.**

Member Name	Station Code	Initial Status
BELL CANADA - PLANNING (BCPRE)	BCPRE	Notification sent
G-TEL FOR ENBRIDGE GAS PRE-ENGINEERING (LEGACY UNION) (ENPHAL)	ENPHAL	Notification sent

**MAP SELECTION: Map Selection provided by the excavator through Ontario One Call's map tool or through agent interpretation by phone**



## **IMPORTANT INFORMATION: Please read.**

### **Defining "NC" - Non-Compliant**

- Non-compliant members have not met their obligations under section 5 of the Ontario Underground Infrastructure Notification Act. ON1Call has notified these members to ensure they are aware of your excavation. In this circumstance, should the member not respond, the excavator should contact the member directly to obtain their locates or request a status. ON1Call will not be provided with a locate status from the member regarding this request and therefore, cannot provide further information at this time. For locate status contact information please refer to our website.

### **You have a valid locate when...**

- You have reviewed your locate request information for accuracy. UPDATE your request IMMEDIATELY if changes are needed and obtain a corrected locate request confirmation.

**NOTE: Intersecting streets are often suggested by Ontario One Call's system, in some circumstances they may not reflect the closest intersecting streets to your excavation. You can change the intersecting streets before submitting the request by going through the "Review" page of your locate request, and editing any inaccurate information. Intersecting streets are for reference only, and unless you change the streets manually, you will not be asked to correct them if they are chosen by the system. If you don't agree with a street name, make sure to edit the request before you submit it, if you found a mistake after submitting the request, update your requests immediately on the web portal.**

- You have obtained locates or clearances from all ON1Call members listed in this request before beginning your dig.

#### **You've met your obligations when...**

- You respect the marks and instructions provided by the locators and dig with care; the marks and locator instructions MUST MATCH. You must wait for responses from all members notified on your locate request before beginning to dig..
- You have obtained any necessary permits from the municipality in which you are digging.
- You have made Ontario One Call aware if you have come across any new or unlisted infrastructure in the public right of way AND stopped digging to prevent damages while we review.
- You have arranged for locates for your private lines on your private property - where applicable.

#### **What does "Cleared" mean in the "Initial Status" section?**

1. The information that you have provided about your dig will not affect that member's underground infrastructure and they have provided you with a clearance, if anything about your excavation changes, please ensure that you update your request immediately.

#### **What are the images under "Map Selection"?**

1. A drawing created by an excavator directly within Ontario One Call's Web request tool, this is expected to be an accurate rendition of the dig site, and it is the excavator's responsibility to ensure the location matches the information they provide under the 'Dig Location'; section OR;
2. A drawing created by an Ontario One Call agent, this drawing is based on a verbal description by phone of the area by the excavator. Agents may create drawings that are larger than the proposed dig to minimize risk of interpretation. It is the excavator's responsibility to review these map selections for accuracy. Changes can be made by the excavator through the Web request tool, to learn how visit [www.ontarioonecall.ca](http://www.ontarioonecall.ca).
3. All drawings dictate which members are notified.