



Project
49 FIRST STREET LANDSCAPE

Address
49 FIRST STREET, OAKVILLE

Project no.
16-019-01

Issued for
SPA APPLICATION

Date
September 24th, 2021
Resubmission September 1st, 2022

Landscape Drawing List	
Materials Plan	L3-01
Layout Plan	L4-01
Softscape Plan	L9-01
Canopy Cover Plan	L9-02
Softscape Details	L10-02

Prepared for:
Mario Botelho and Kathy Giankos



E.R.A. Architects Inc., 625 Church St, Suite 600, Toronto, Canada, M4Y 2G1
T: (416) 963-4497 F: (416) 963-8761 info@eraarch.ca www.eraarch.ca

GENERAL NOTES:

1. ALL FENCING SCREENS, AND GATES WILL COMPLY WITH FENCE BY-LAW 2002-034 AS AMENDED.
2. REFER TO CIVIL ENGINEER'S REPORT AND DRAWINGS FOR STORM WATER MANAGEMENT (SWM) FACILITIES, GRADING AND SERVICING PLAN, AND THE EROSION AND SEDIMENT CONTROL AND CONSTRUCTION MANAGEMENT PLAN.
3. REFER TO STRUCTURAL ENGINEER'S DRAWING FOR THE DRIVEWAY RETAINING WALL IN THE FLANKAGE.
4. INVENTORY AND LOCATION OF EXISTING TREES UPDATED PER ARBORIST REPORT DATED JUNE 18, 2022

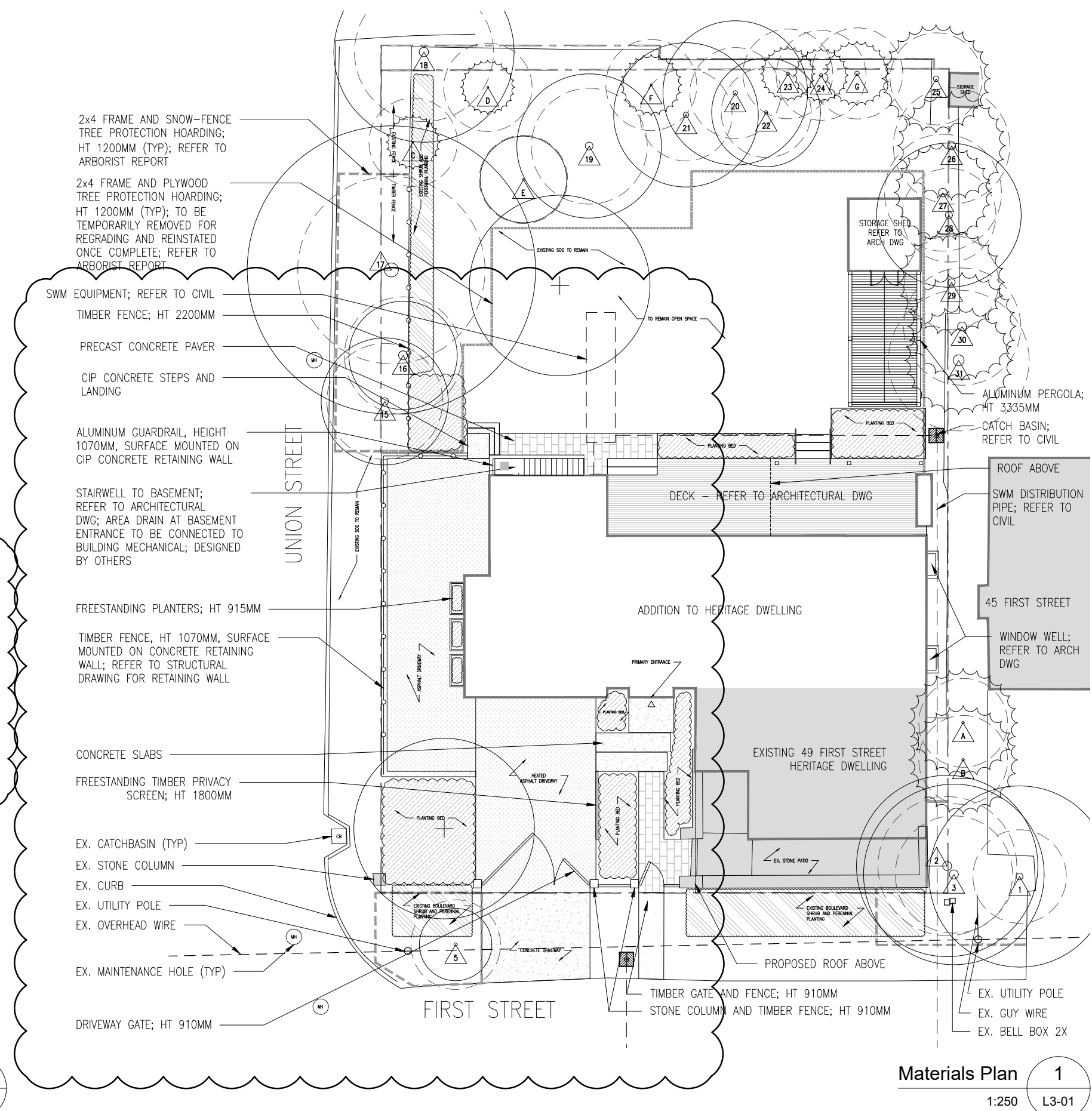

General Notes **2**
L3-01

Materials Plan **1**
1:250 L3-01

LEGEND

- EXISTING
- NEW CONSTRUCTION
- PROPERTY LINE
- EXISTING FENCE LINE
- PROPOSED FENCE LINE
- SWM EQUIPMENT
- EXISTING CONIFEROUS TREE - REFER TO ARBORIST REPORT
- EXISTING DECIDUOUS TREE - REFER TO ARBORIST REPORT
- PROPOSED DECIDUOUS TREE
- 2X4 FRAME AND PLYWOOD - REFER TO ARBORIST REPORT
- 2X4 FRAME AND SNOW-FENCE - REFER TO ARBORIST REPORT
- CONCRETE
- PRECAST CONCRETE PAVER
- ASPHALT
- EXISTING SHRUB/PERENNIAL PLANTING BED
- PROPOSED SHRUB/PERENNIAL PLANTING BED

2022-09-01	SITE PLAN APPLICATION RESUBMISSION
2022-07-08	SITE PLAN APPLICATION RESUBMISSION
2021-09-24	SITE PLAN APPLICATION
DATE	ISSUED FOR

Project north

ONTARIO ASSOCIATION OF ARCHITECTS
PHILIP EVANS LICENCE 9096

E R A

E.R.A. Architects Inc., 625 Church St, Suite 600, Toronto, Canada, M4Y 2G1
T: (416) 963-4497 F: (416) 963-8761 info@eraarch.ca www.eraarch.ca

Project **49 FIRST STREET**

Address **49 FIRST STREET, OAKVILLE**

For **MARIO BOTELHO**

Project no. **16-019-01**

Scale **As Indicated**

Drawn by **SC**

Reviewed by **SL/PE**

Drawing title **Materials Plan**

Sheet no. **L3-01**

This drawing is the property of E.R.A. Architects Inc. and may not be used or reproduced without expressed approval. Refer to Engineering drawings before proceeding with work. The Contractor shall verify all dimensions and levels on site and report any discrepancies to E.R.A. before beginning work. Do not scale from the drawings. Use figured dimensions only. The Contractor is responsible for any changes made to the drawings without E.R.A.'s approval.

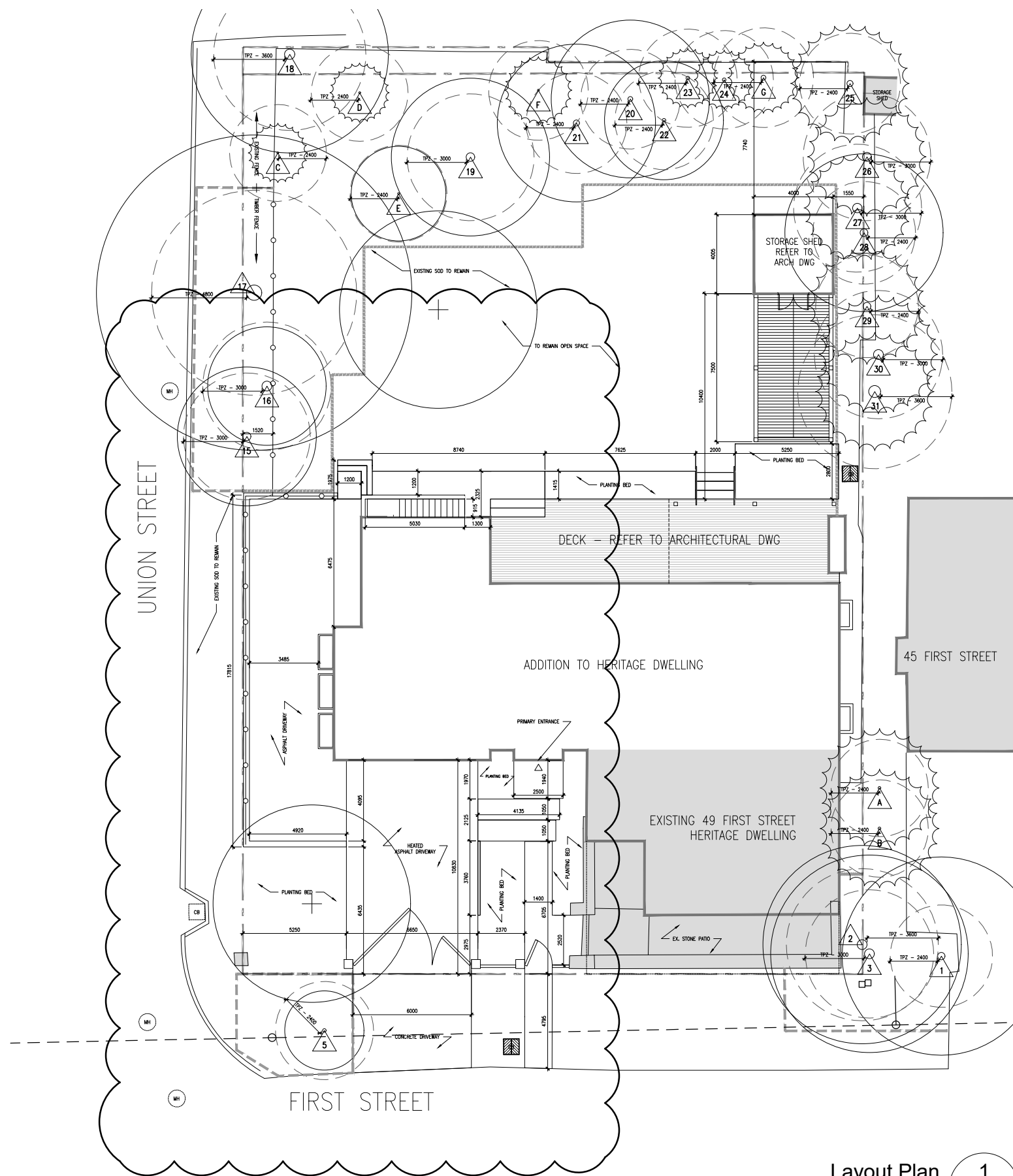

LEGEND

	EXISTING
	NEW CONSTRUCTION
	PROPERTY LINE
	EXISTING FENCE LINE
	PROPOSED FENCE LINE
	SWM EQUIPMENT
	EXISTING CONIFEROUS TREE - REFER TO ARBORIST REPORT
	EXISTING DECIDUOUS TREE - REFER TO ARBORIST REPORT
	PROPOSED DECIDUOUS TREE
	EXISTING TREE TAG
	2X4 FRAME AND PLYWOOD - REFER TO ARBORIST REPORT
	2X4 FRAME AND SNOW-FENCE - REFER TO ARBORIST REPORT

2022-09-01	SITE PLAN APPLICATION RESUBMISSION
2022-07-08	SITE PLAN APPLICATION RESUBMISSION
2021-09-24	SITE PLAN APPLICATION
DATE	ISSUED FOR

Project north

ONTARIO ASSOCIATION OF ARCHITECTS
PHILIPPEVANS LICENCE 9096



E.R.A. Architects Inc., 625 Church St. Suite 600, Toronto, Canada, M4Y 2G1
T: (416) 963-4497 F: (416) 963-8761 info@eraarch.ca www.eraarch.ca

Project	49 FIRST STREET
Address	49 FIRST STREET, OAKVILLE
For	MARIO BOTELHO
Project no.	16-019-01
Scale	As Indicated
Drawn by	SC
Reviewed by	SL/PE
Drawing title	Layout Plan

Sheet no.

L4-01

This drawing is the property of E.R.A. Architects Inc. and may not be used or reproduced without expressed approval. Refer to Engineering drawings before proceeding with work. The Contractor shall verify all dimensions and levels on site and report any discrepancies to E.R.A. before beginning work. Do not scale from the drawings. Use figured dimensions only. The Contractor is responsible for any changes made to the drawings without E.R.A.'s approval.

Layout Plan **1**
1:250 **L4-01**

PLANTING BED EXCAVATION IN THE VICINITY OF EXISTING TREE ROOTS

PLANTING BEDS SHALL BE EXCAVATED BY HAND DIGGING. EXISTING TREE ROOTS ARE NOT TO BE PRUNED. SHOULD TREE ROOTS INTERFERE WITH PROPOSED LAYOUT, THE CONSULTANT SHALL BE NOTIFIED PRIOR TO INSTALLATION OF PLANT MATERIAL.

PLANTING BED EXCAVATION NOTES

3

L9-01

PLANTING SCHEDULE

ITEM	BOTANICAL NAME	COMMON NAME	SIZE/CONDITION	SPACING (mm)	QTY
TREES					
NS	<i>Nyssa sylvatica</i>	Sourgum	CLUMP 250 BBC	NA	2
SHRUBS					
Ha	<i>Hydrangea aborescens</i> "Annabel"	Annabelle Hydrangea	3 GAL	900mm	14
Hq	<i>Hydrangea quercifolia</i> "Alice"	Alice Oakleaf Hydrangea	3 GAL	NA	1
Po	<i>Physocarpus opulifolius</i> "Diabolo"	Diabolo Ninebark	50CM 3 GAL	NA	1
EVERGREENS					
Js	<i>Juniperus sabina</i> "Skandia"	Skandia Juniper	50CM 3 GAL	1200mm	11
PERENNIALS, GRASSES, AND GROUND COVER					
Aai	<i>Astilbe arendsii</i> "Bridal Veil"	Bridal Veil False Spirea	1 GAL	450mm	135
Caa	<i>Calamagrostis acutiflora</i> "Karl Foerster"	Feather Reed Grass	1 GAL	450mm	12
Epa	<i>Echinacea pallida</i>	Pale Purple Cone Flower	1 GAL	300mm	90
Hoa	<i>Hosta 'Abiqua Drinking Gourd'</i>		1 GAL	600mm	5
Hof	<i>Hosta 'Fire Island'</i>		1 GAL	600mm	5
Mss	<i>Matteuccia struthiopteris</i>	Ostrich Fern	1 GAL	900mm	6
PAA	<i>Perovskia atriplicifolia</i>	Russian Sage	1 GAL	600mm	22
RHA	<i>Rudbeckia hirta</i>	Gloriosa Daisy	1 GAL	300mm	90

Planting Schedule

2

L9-01

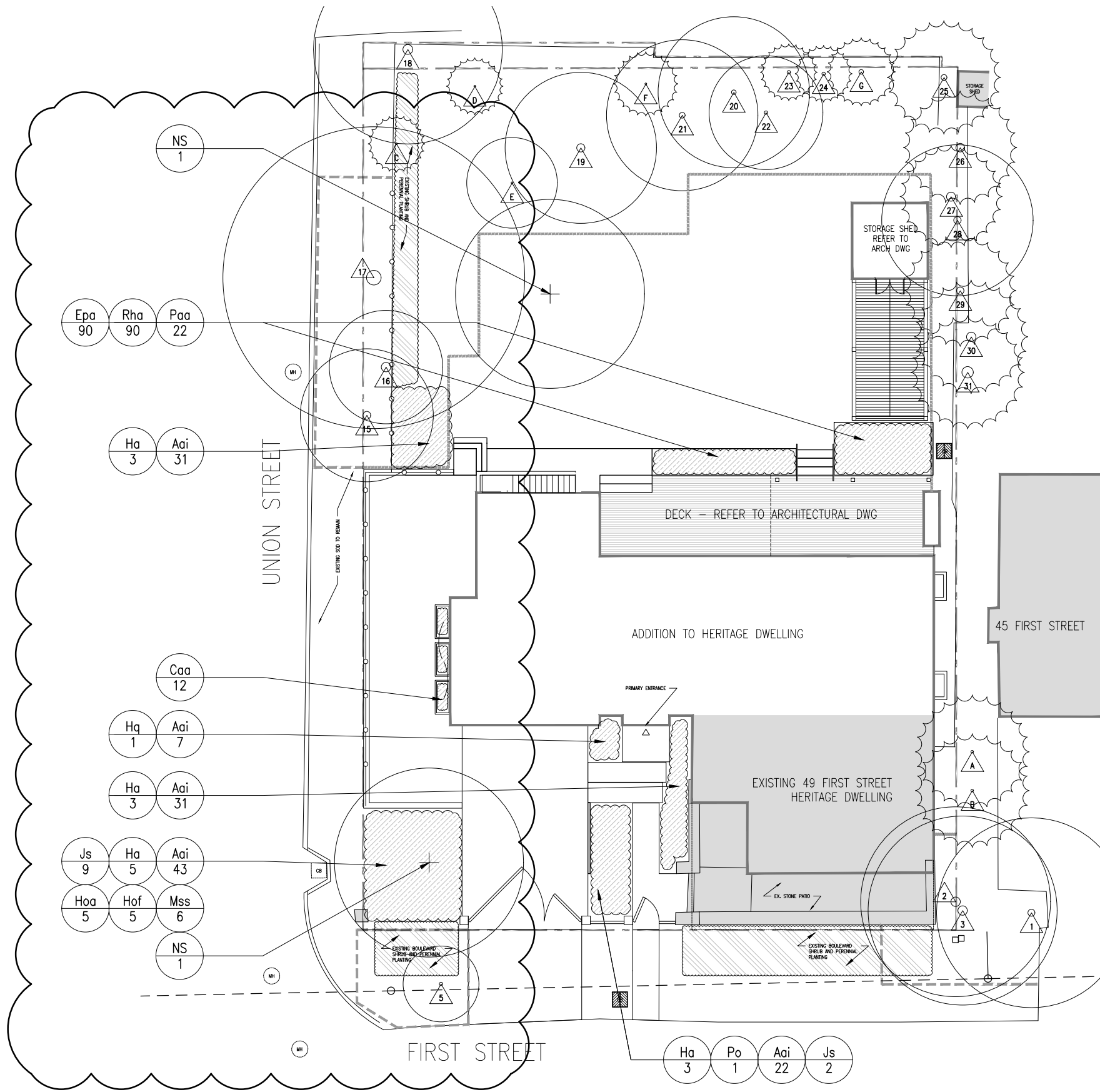

Softscape Plan

1

1:250

L9-01

LEGEND

- EXISTING
- NEW CONSTRUCTION
- PROPERTY LINE
- EXISTING FENCE LINE
- PROPOSED FENCE LINE
- SWM EQUIPMENT
- EXISTING CONIFEROUS TREE - REFER TO ARBORIST REPORT
- EXISTING DECIDUOUS TREE - REFER TO ARBORIST REPORT
- PROPOSED DECIDUOUS TREE
- 2X4 FRAME AND PLYWOOD - REFER TO ARBORIST REPORT
- 2X4 FRAME AND SNOW-FENCE - REFER TO ARBORIST REPORT
- EXISTING SHRUB/PERENNIAL PLANTING BED
- PROPOSED SHRUB/PERENNIAL PLANTING BED

2022-09-01	SITE PLAN APPLICATION RESUBMISSION
2022-07-08	SITE PLAN APPLICATION RESUBMISSION
2021-09-24	SITE PLAN APPLICATION
DATE	ISSUED FOR

Project north

ONTARIO ASSOCIATION OF ARCHITECTS
PHILIPPEVANS LICENCE 9096



E.R.A. Architects Inc., 625 Church St. Suite 600, Toronto, Canada, M4Y 2G1
T: (416) 963-4497 F: (416) 963-8761 info@eraarch.ca www.eraarch.ca

Project	
49 FIRST STREET	
Address	49 FIRST STREET, OAKVILLE
For	MARIO BOTELHO
Project no.	16-019-01
Scale	As Indicated
Drawn by	SC
Reviewed by	SL/PE
Drawing title	

Softscape Plan

Sheet no.

L9-01

This drawing is the property of E.R.A. Architects Inc. and may not be used or reproduced without expressed approval. Refer to Engineering drawings before proceeding with work. The Contractor shall verify all dimensions and levels on site and report any discrepancies to E.R.A. before beginning work. Do not scale from the drawings. Use figured dimensions only. The Contractor is responsible for any changes made to the drawings without E.R.A.'s approval.

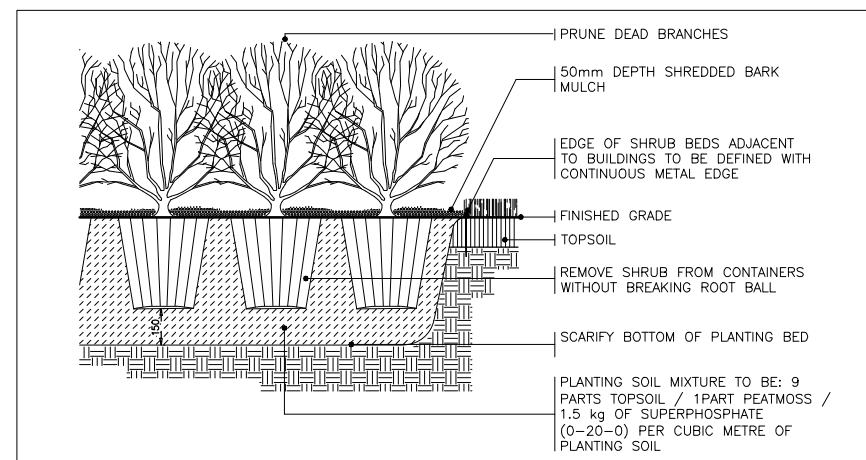

Perennial and Shrub Planting Detail **3**
1:20 L10-02

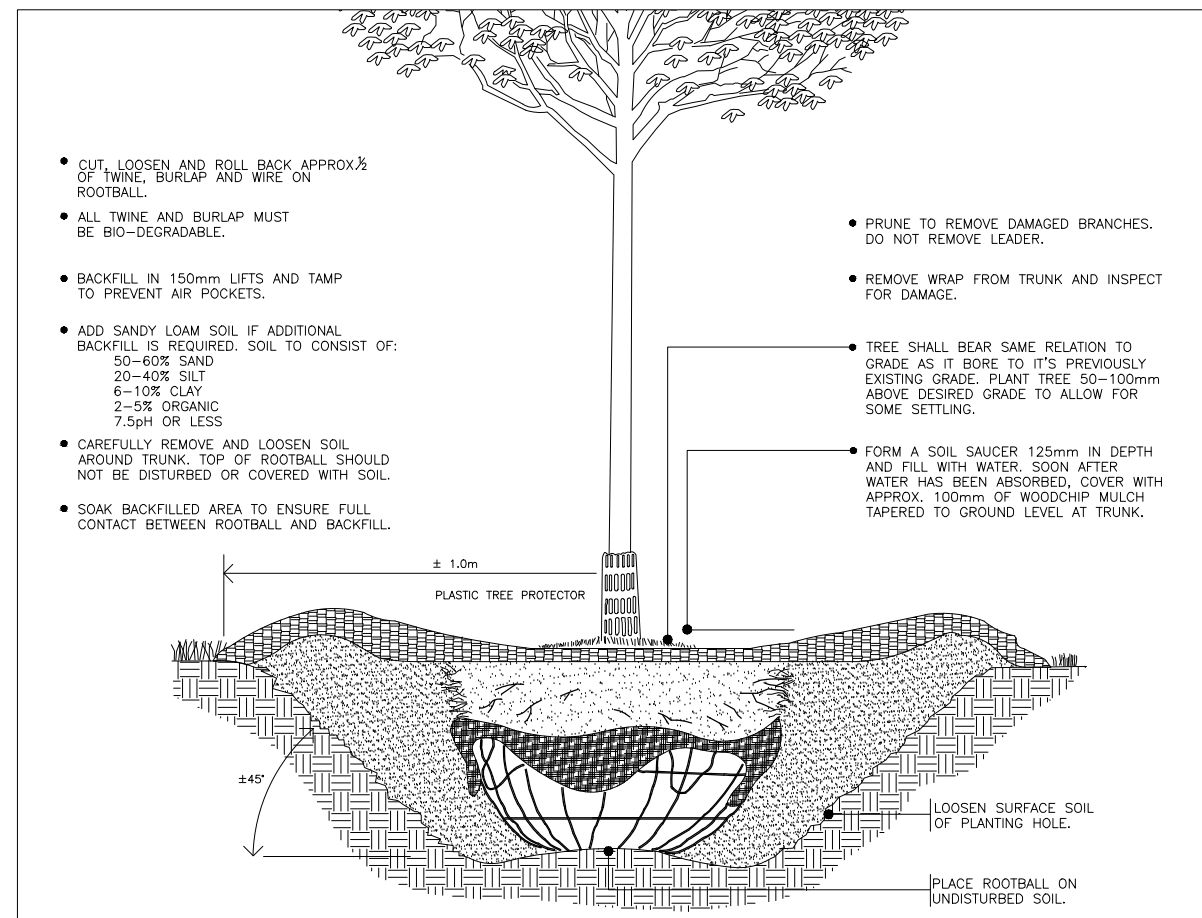

Deciduous Tree Planting Detail **1**
1:20 L10-02

LEGEND

DATE	ISSUED FOR
2022-09-01	SITE PLAN APPLICATION RESUBMISSION
2022-07-08	SITE PLAN APPLICATION RESUBMISSION
2021-09-24	SITE PLAN APPLICATION

Project north

E R A

E.R.A. Architects Inc., 625 Church St. Suite 600, Toronto, Canada, M4Y 2G1
T: (416) 963-4497 F: (416) 963-8761 info@eraarch.ca www.eraarch.ca

Project	49 FIRST STREET
Address	49 FIRST STREET, OAKVILLE
For	MARIO BOTELHO
Project no.	16-019-01
Scale	As Indicated
Drawn by	SC
Reviewed by	SL/PE
Drawing title	

Sheet no.
L10-02

This drawing is the property of E.R.A. Architects Inc. and may not be used or reproduced without expressed approval. Refer to Engineering drawings before proceeding with work. The Contractor shall verify all dimensions and levels on site and report any discrepancies to E.R.A. before beginning work. Do not scale from the drawings. Use figured dimensions only. The Contractor is responsible for any changes made to the drawings without E.R.A.'s approval.