

2264 TRAFALGAR ROAD THE ASHTON OAKVILLE, ON

LANDSCAPE ARCHITECTURAL DRAWING PACKAGE DRAWING INDEX

LANDSCAPE PLAN	L1
PLANTING PLAN / STREETSCAPE PLAN	L2
CANOPY COVER PLAN	L3
LANDSCAPE DETAILS	LD1
LANDSCAPE DETAILS	LD2
LANDSCAPE DETAILS	LD3
LANDSCAPE DETAILS	LD4

Landscape Architect:
Schollen & Company Inc.
30 Wertheim Court, Unit 15
Richmond Hill, Ontario L4B 1B9
TEL: 289-695-0009
FAX: 289-695-0010

Client:
Times Group Corporation
3985 Hwy 7, Unit 202
Markham, ON L3R 2A2

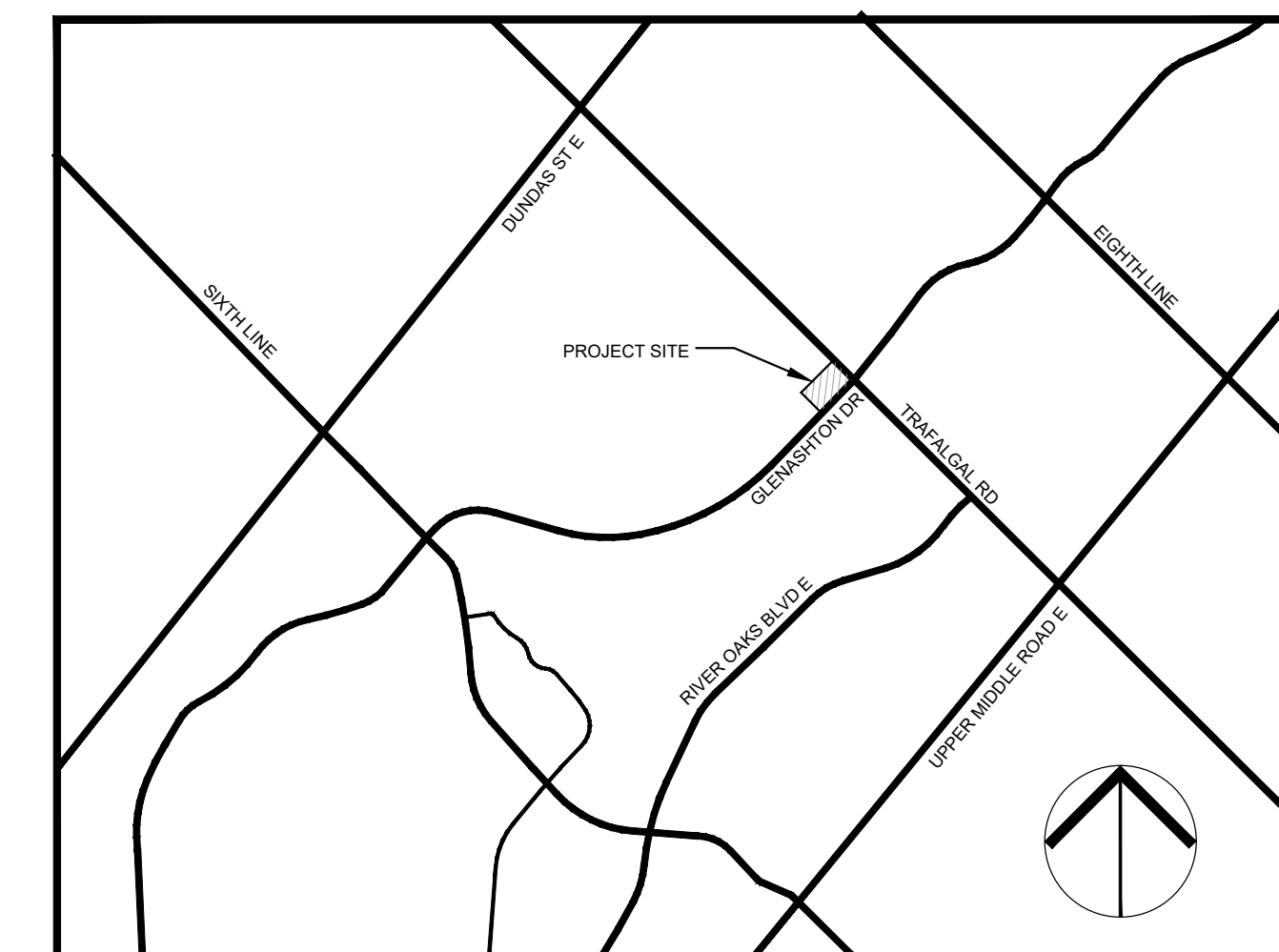

KEY PLAN - N.T.S.

No.	Revision	Date	By
1	Issued for Coordination	2022/02/22	RMS
2	Issued for Site Plan Approval	2022/02/23	RMS
3	Issued for Coordination	2022/08/26	RMS
4	Issued for Site Plan Approval	2022/09/02	RMS

This document is submitted by Schollen & Company Inc. to the client in confidence. The document contains confidential and/or technical information, and its unauthorized disclosure could reasonably result in significant professional and financial harm to Schollen & Company Inc. Any damages arising from unauthorized use of this document or the information contained therein shall be borne by the party making such unauthorized use.

No.	Revision	Date	By
1	Issued for Coordination	2022/02/22	RMS
2	Issued for Site Plan Approval	2022/02/23	RMS
3	Issued for Coordination	2022/08/26	RMS
4	Issued for Site Plan Approval	2022/09/02	RMS

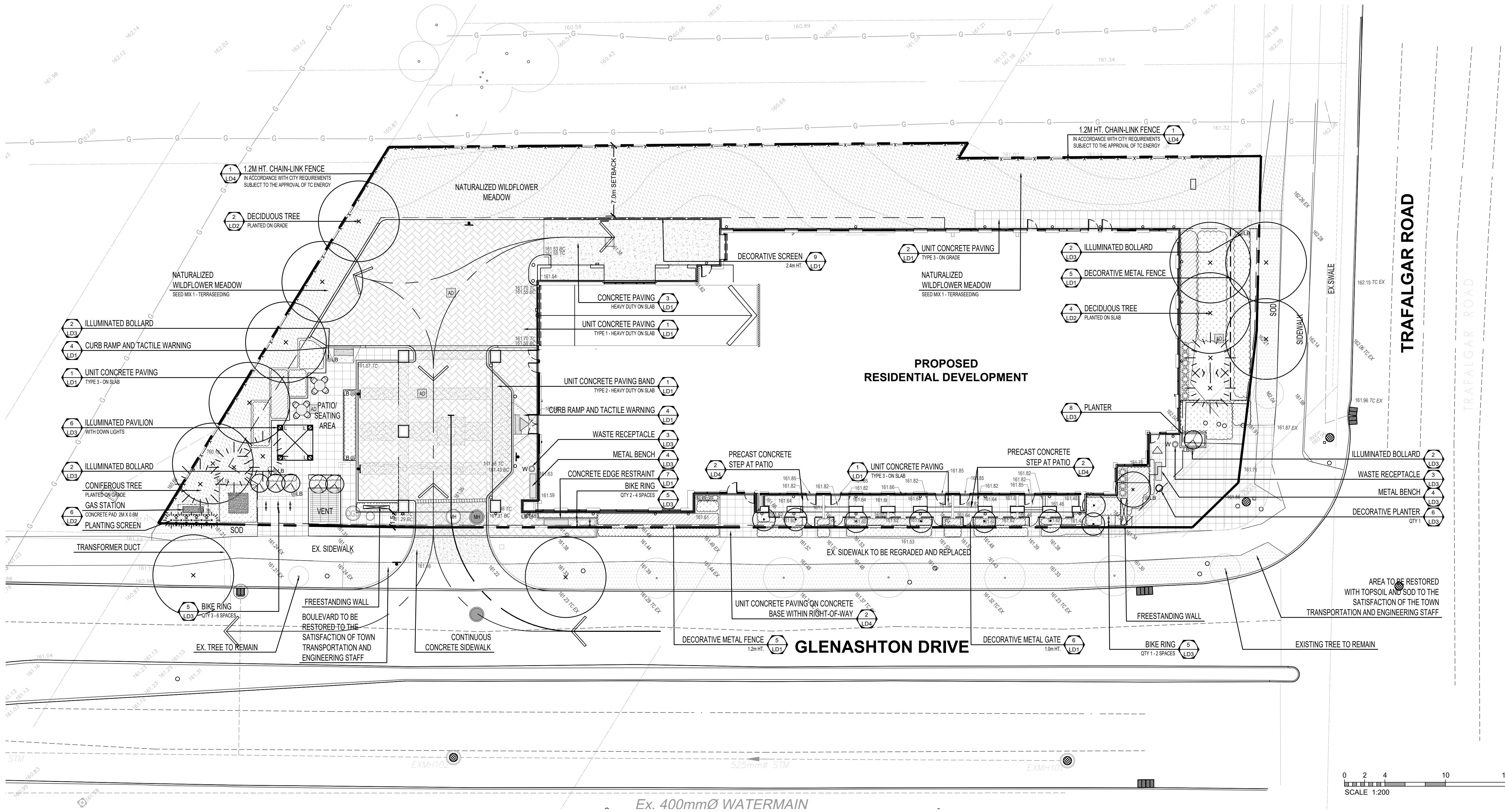

LEGEND

- UNIT CONCRETE PAVING
- POURED CONCRETE PAVING
- SEED MIX
- SOD
- PERENNIALS / GRASSES / GROUNDCOVER
- DECORATIVE METAL FENCE - 1.2m HT
- DECORATIVE METAL FENCE
- DOWNLIGHT
- LIGHT BOLLARD
- BIKE RING
- METAL BENCH
- DECIDUOUS TREE
- CONIFEROUS TREE
- SMALL MULTI-STEM TREE
- CONIFEROUS SHRUB
- EXISTING TREE TO REMAIN

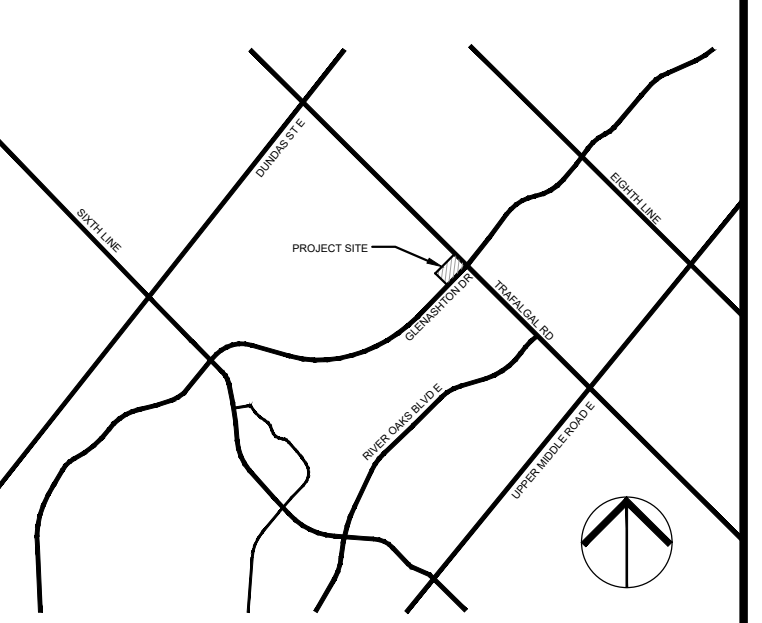

KEYPLAN
N.T.S.

Drawing Prepared By:
SCHOLLEN & Company Inc.
 30 Wertheim Court, Unit 15
 Richmond Hill, Ontario L4B 1B9
 T: 289-695-0009
 F: 289-695-0010

Client:
TIMES GROUP

Project Name:
2264 TRAFALGAR ROAD
 OAKVILLE, ON

Drawing Title:
LANDSCAPE PLAN

Scale: 1:200	Project No: 2021011	Drawing No.: L1
Drawn: NS	Checked: RMS	
Date: February 2022	Plot Date: 02/09/2022	

This document is submitted by Schollen & Company Inc. to the client in confidence. The document contains confidential and/or technical information, and its unauthorized disclosure could reasonably result in significant professional and financial harm to Schollen & Company Inc. Any damages arising from unauthorized use of this document or the information contained therein shall be borne by the party making such unauthorized use.

No.	Revision	Date	By
1	Issued for Coordination	2022/02/18	RMS
2	Issued for Site Plan Approval	2022/02/23	RMS
3	Issued for Site Plan Approval	2022/09/02	RMS

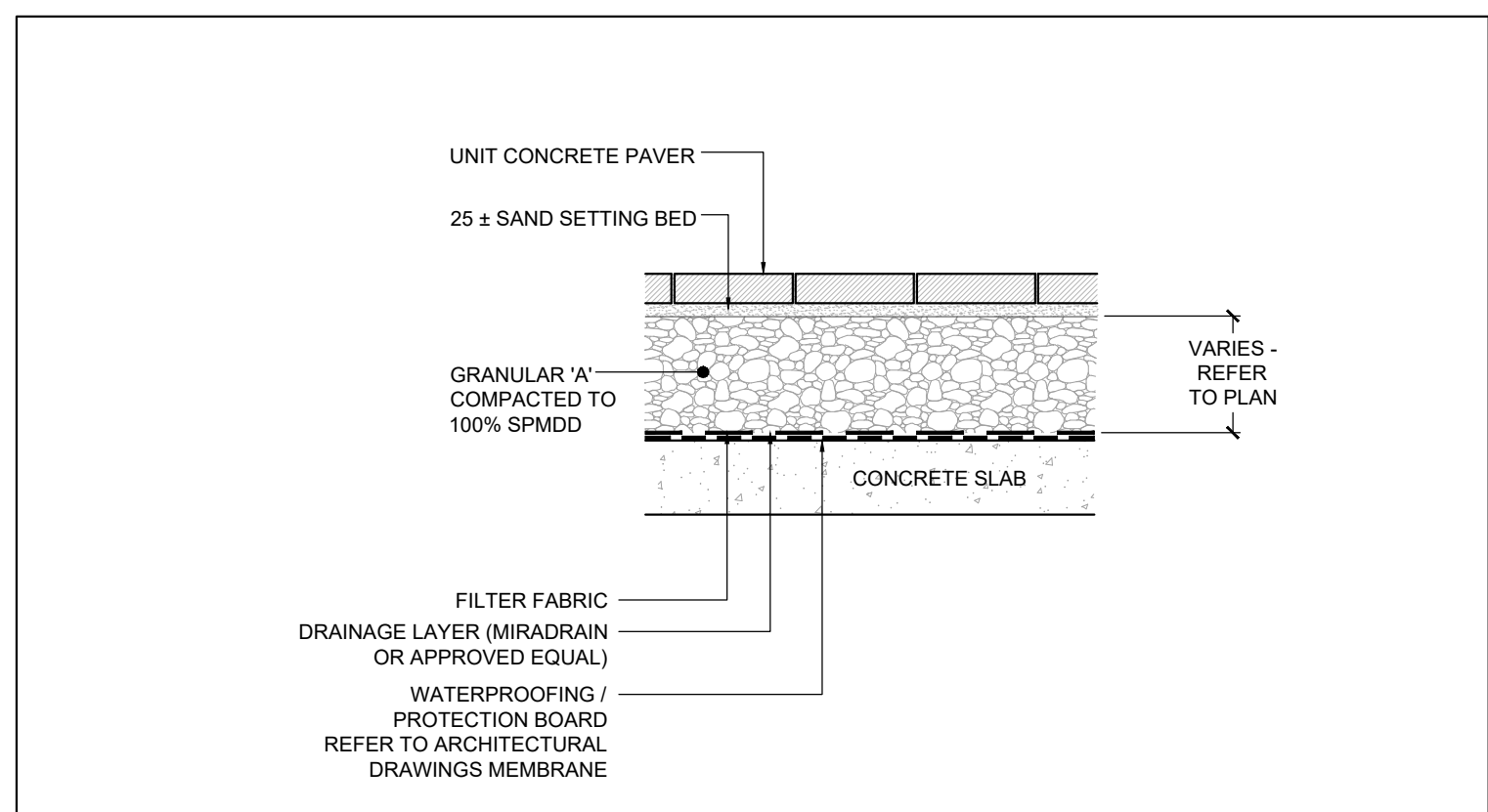

1 UNIT CONCRETE PAVING ON SLAB
 SCALE 1:25
 SCHOLLEN & Company Inc.
 30 Wertheim Court, Unit 15
 Richmond Hill, Ontario L4B 1B9
 T: 289-695-0009
 F: 289-695-0010

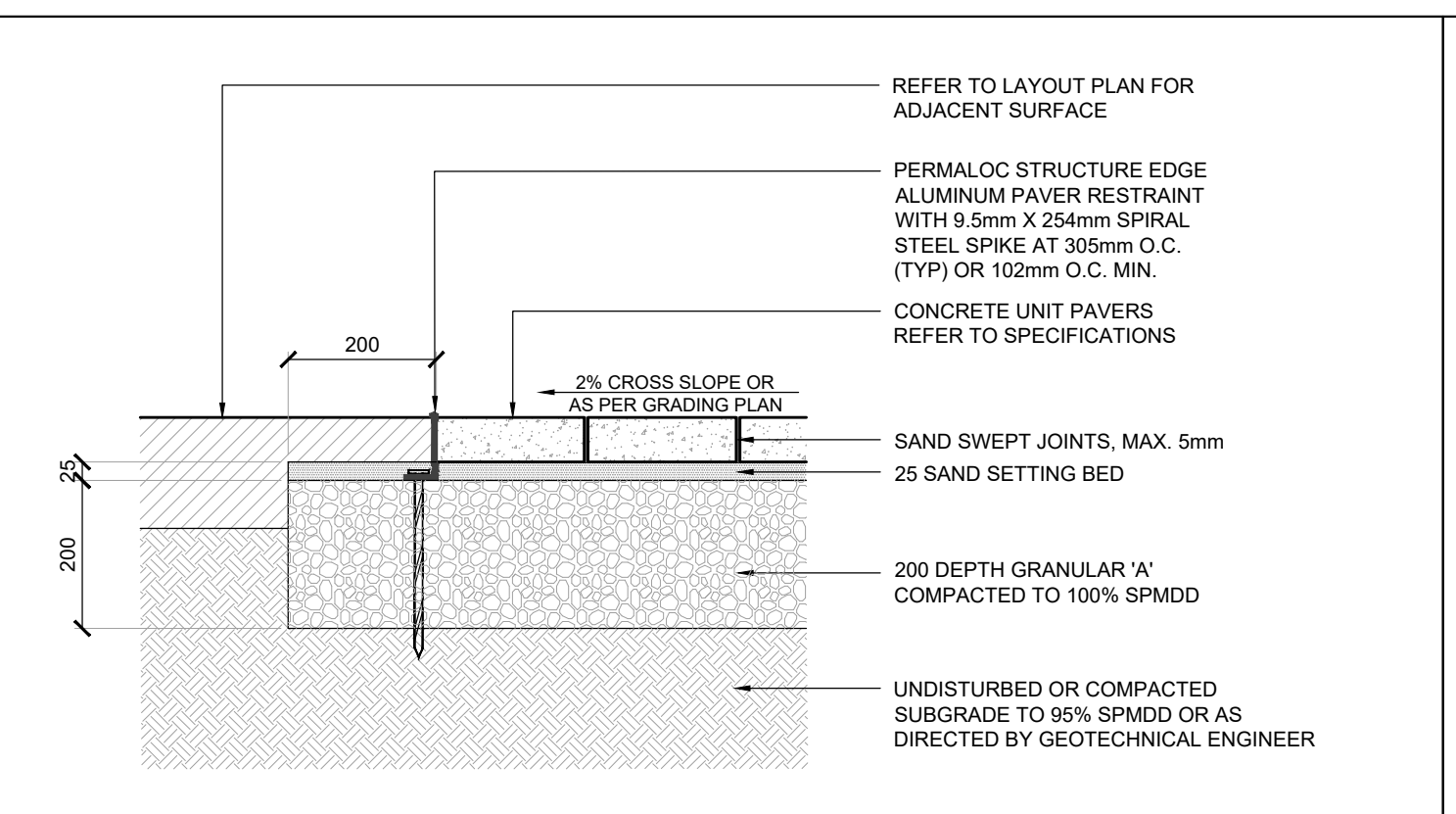

2 UNIT CONCRETE PAVING
 SCALE N.T.S.
 SCHOLLEN & Company Inc.
 30 Wertheim Court, Unit 15
 Richmond Hill, Ontario L4B 1B9
 T: 289-695-0009
 F: 289-695-0010

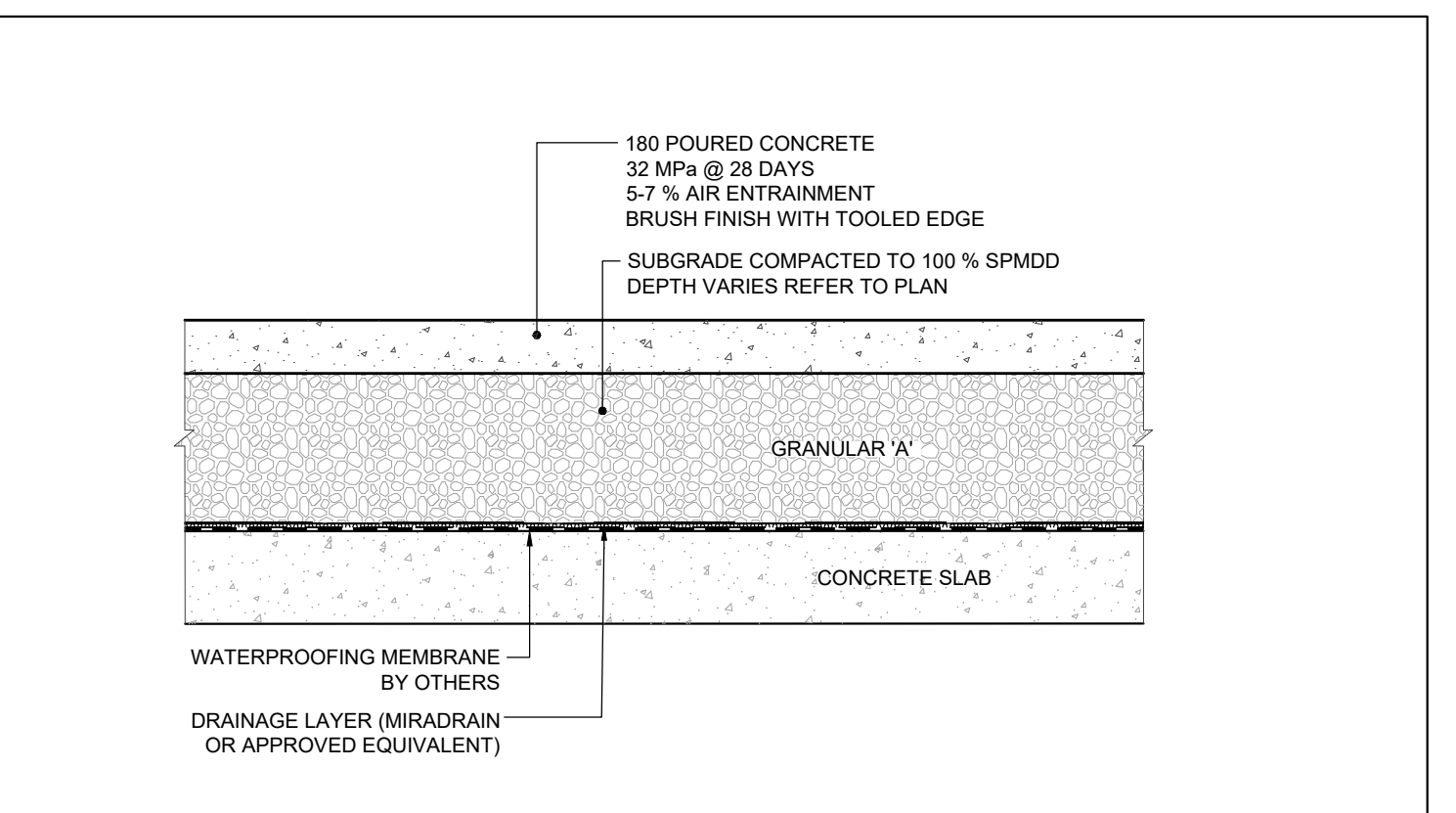

3 POURED CONCRETE PAVING - HEAVY DUTY
 SCALE 1:25
 SCHOLLEN & Company Inc.
 30 Wertheim Court, Unit 15
 Richmond Hill, Ontario L4B 1B9
 T: 289-695-0009
 F: 289-695-0010

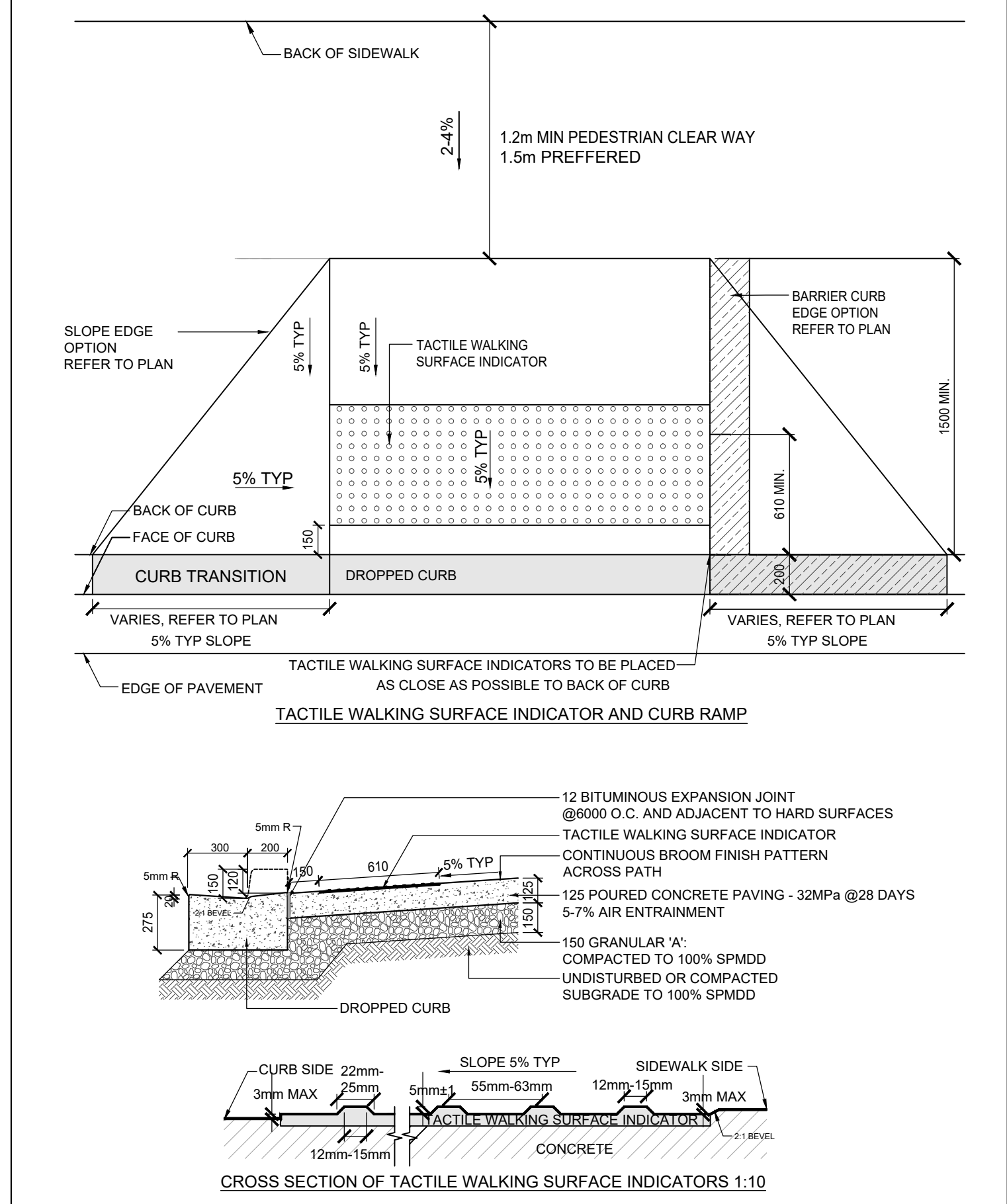

4 CURB RAMP WITH TACTILE INDICATOR
 SCALE 1:25
 SCHOLLEN & Company Inc.
 30 Wertheim Court, Unit 15
 Richmond Hill, Ontario L4B 1B9
 T: 289-695-0009
 F: 289-695-0010

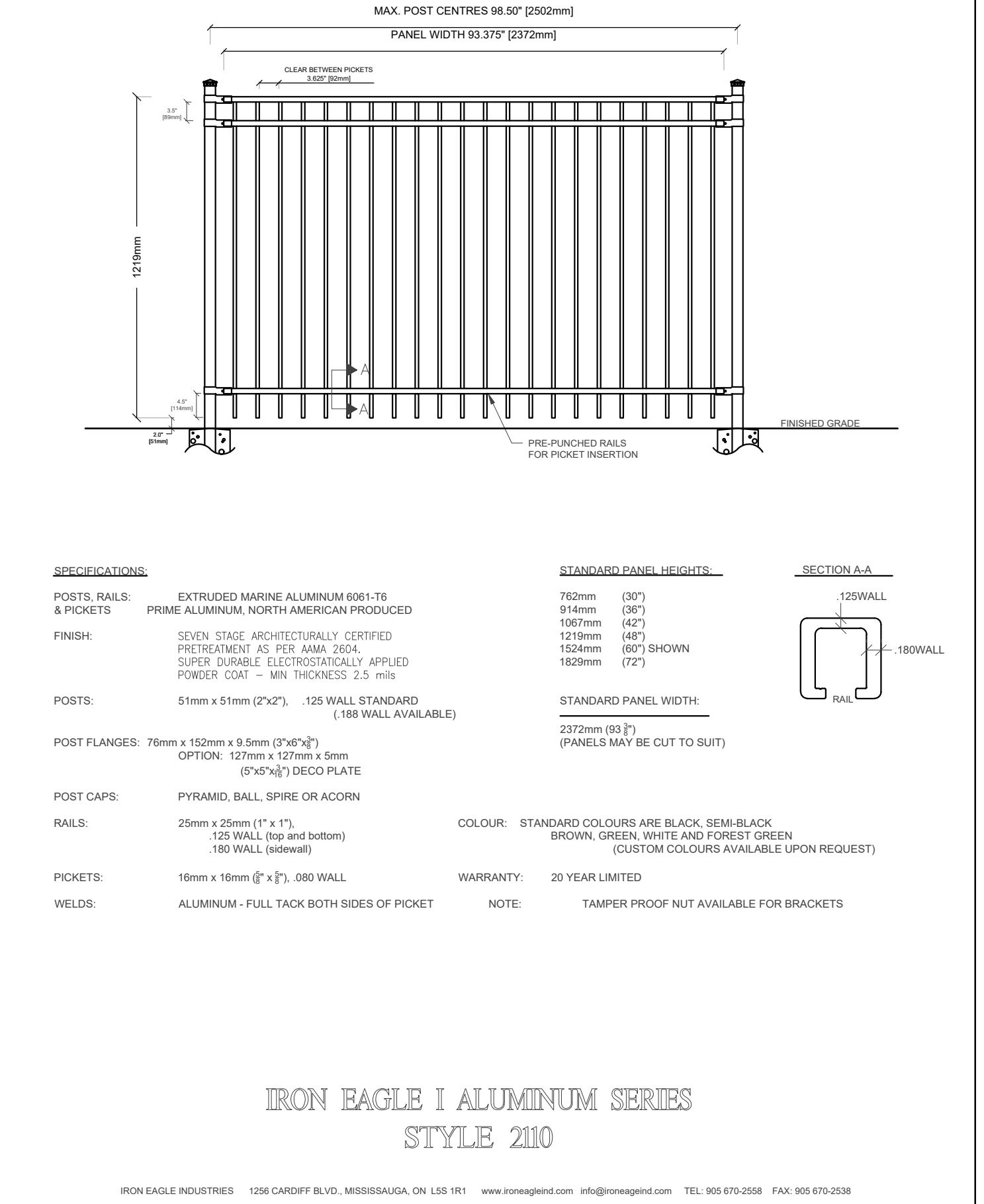

5 DECORATIVE METAL FENCE
 N.T.S.
 SCHOLLEN & Company Inc.
 30 Wertheim Court, Unit 15
 Richmond Hill, Ontario L4B 1B9
 T: 289-695-0009
 F: 289-695-0010

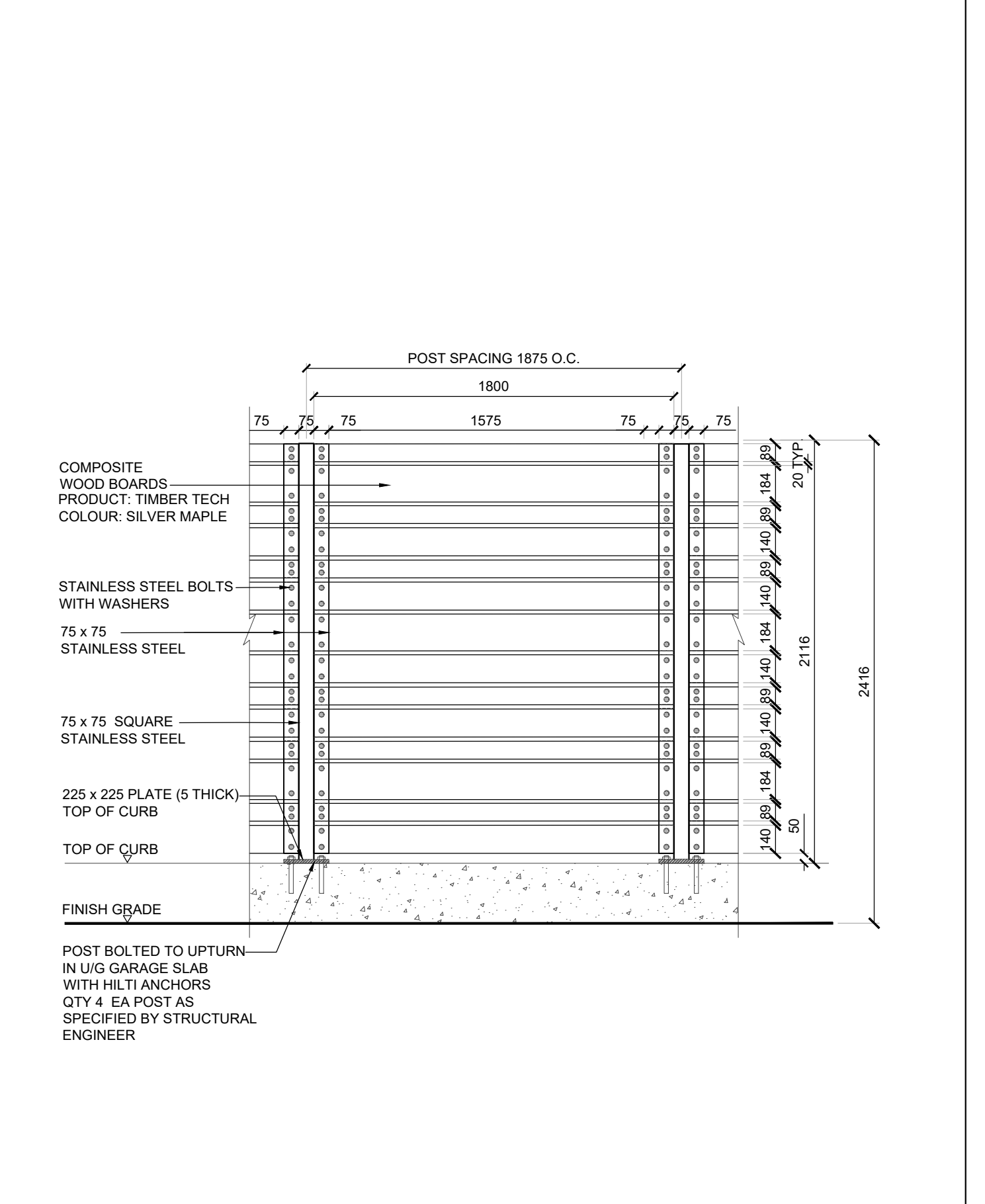

6 PRIVACY SCREEN - COMPOSITE WOOD - 2.1M
 SCALE 1:25
 SCHOLLEN & Company Inc.
 30 Wertheim Court, Unit 15
 Richmond Hill, Ontario L4B 1B9
 T: 289-695-0009
 F: 289-695-0010

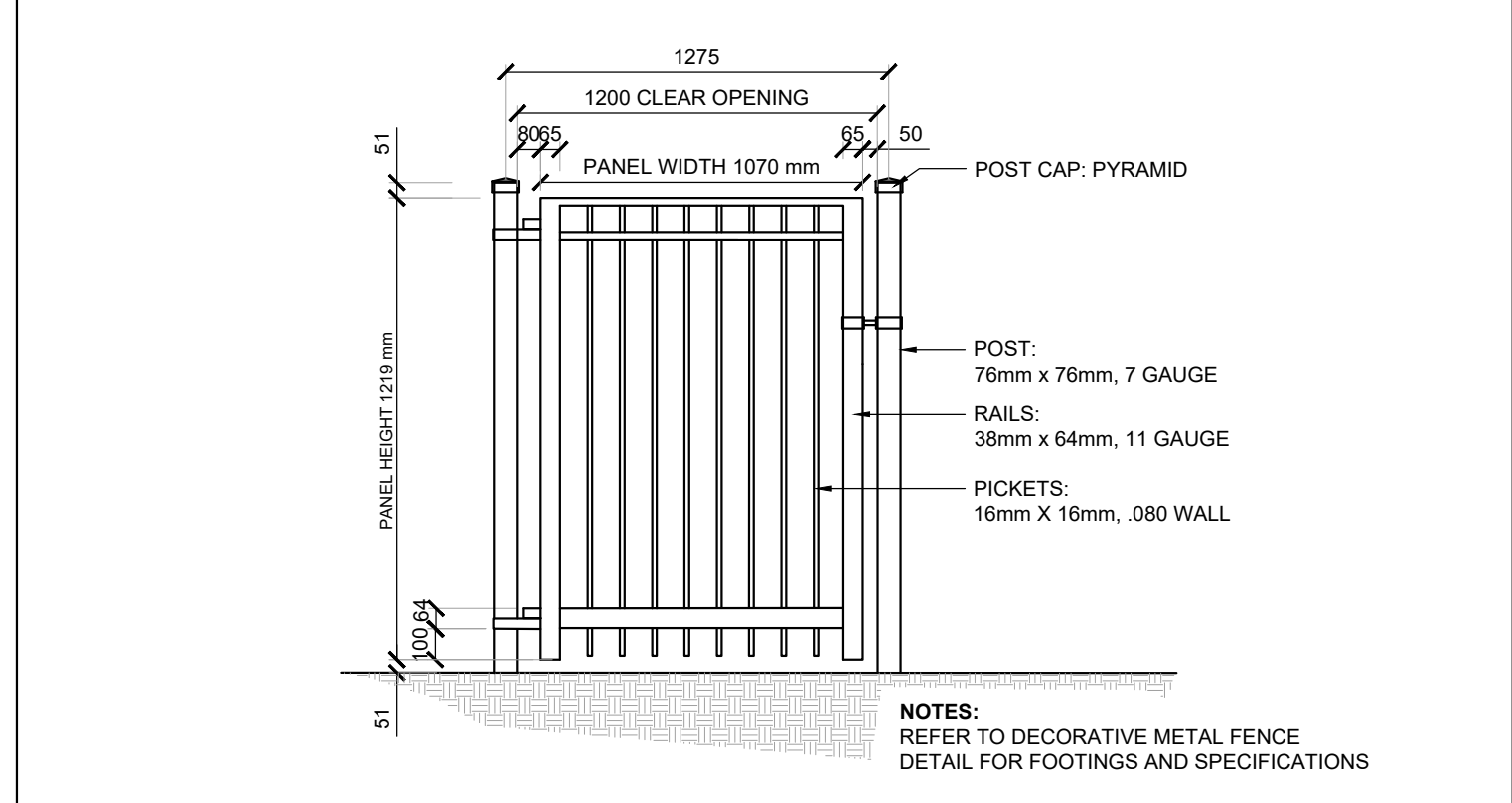

8 DECORATIVE METAL GATE - SINGLE
 SCALE 1:25
 SCHOLLEN & Company Inc.
 30 Wertheim Court, Unit 15
 Richmond Hill, Ontario L4B 1B9
 T: 289-695-0009
 F: 289-695-0010

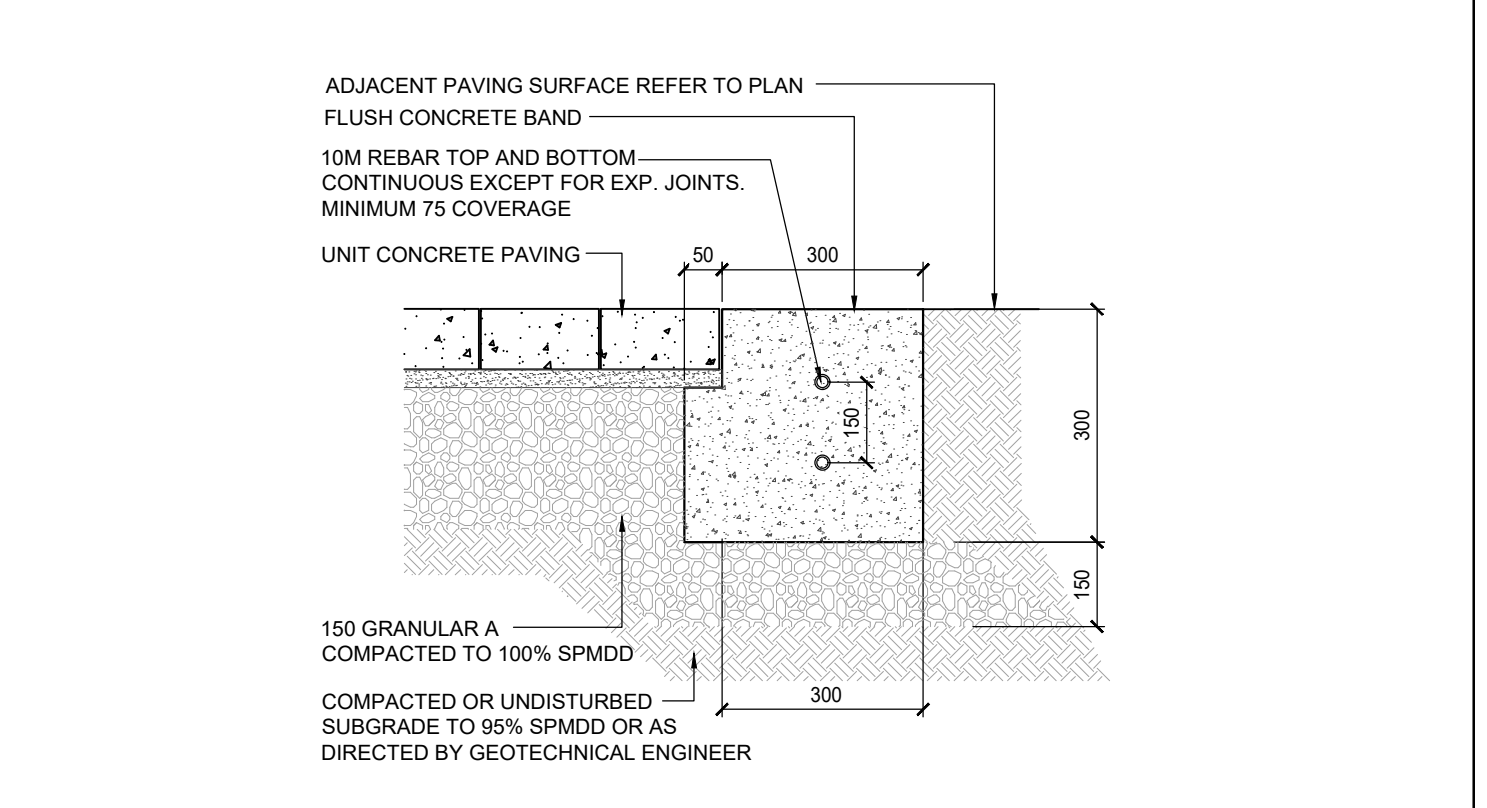

7 CONCRETE EDGE RESTRAINT
 SCALE 1:10
 SCHOLLEN & Company Inc.
 30 Wertheim Court, Unit 15
 Richmond Hill, Ontario L4B 1B9
 T: 289-695-0009
 F: 289-695-0010

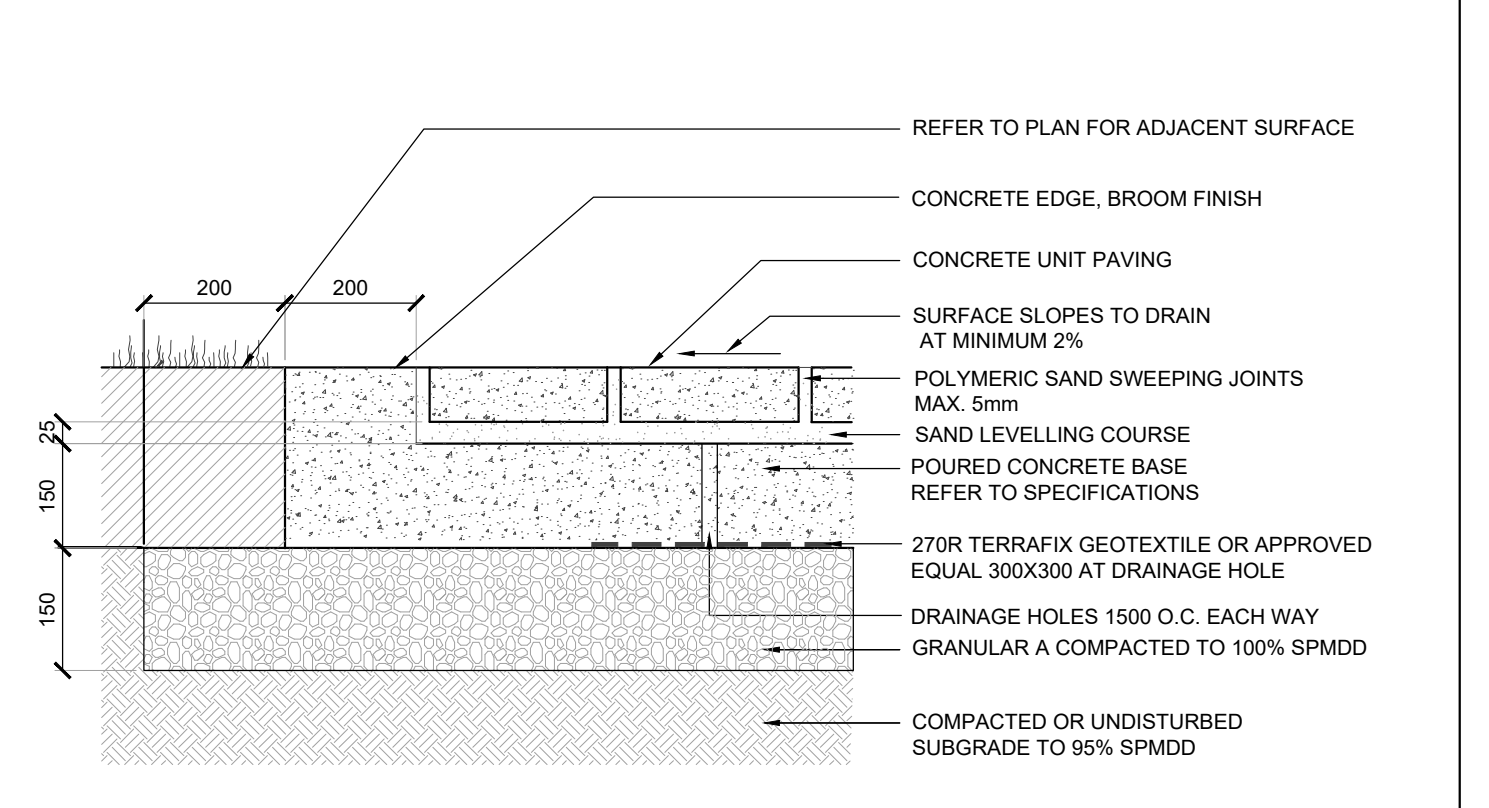

8 UNIT CONCRETE PAVING ON CONCRETE BASE
 SCALE 1:10
 SCHOLLEN & Company Inc.
 30 Wertheim Court, Unit 15
 Richmond Hill, Ontario L4B 1B9
 T: 289-695-0009
 F: 289-695-0010

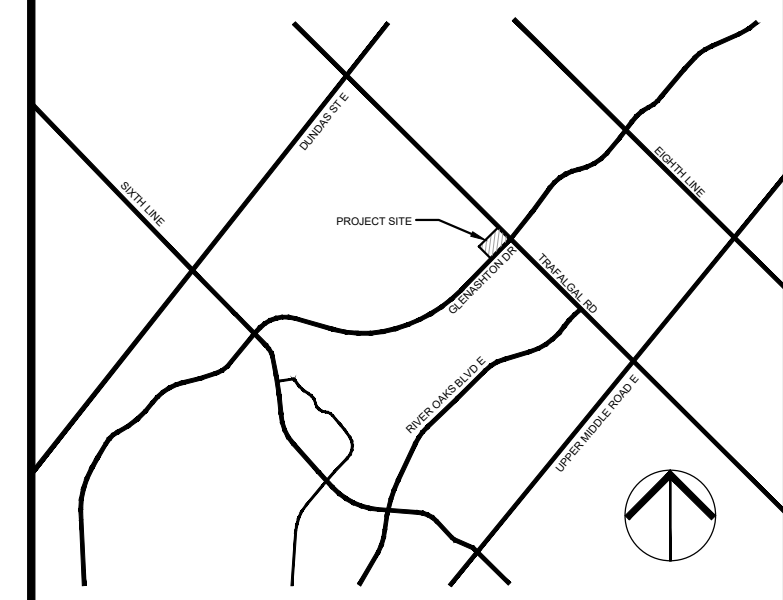

KEYPLAN
 N.T.S.



Drawing Prepared By:
SCHOLLEN & Company Inc.
 30 Wertheim Court, Unit 15
 Richmond Hill, Ontario L4B 1B9
 T: 289-695-0009
 F: 289-695-0010

Client:
TIMES GROUP

Project Name:
2264 TRAFALGAR ROAD

Drawing Title:
LANDSCAPE DETAILS

Scale: AS SHOWN	Project No.: 2021011	Drawing No.: LD1
Drawn: NS	Checked: RMS	
Date: February 2022	Plot Date: 02/09/2022	

This document is submitted by Schollen & Company Inc. to the client in confidence. The document contains confidential and/or technical information, and its unauthorized disclosure could reasonably result in significant professional and financial harm to Schollen & Company Inc. Any damages arising from unauthorized use of this document or the information contained therein shall be borne by the party making such unauthorized use.

No.	Revision	Date	By
1	Issued for Coordination	2022/02/18	RMS
2	Issued for Site Plan Approval	2022/02/23	RMS
3	Issued for Site Plan Approval	2022/09/02	RMS

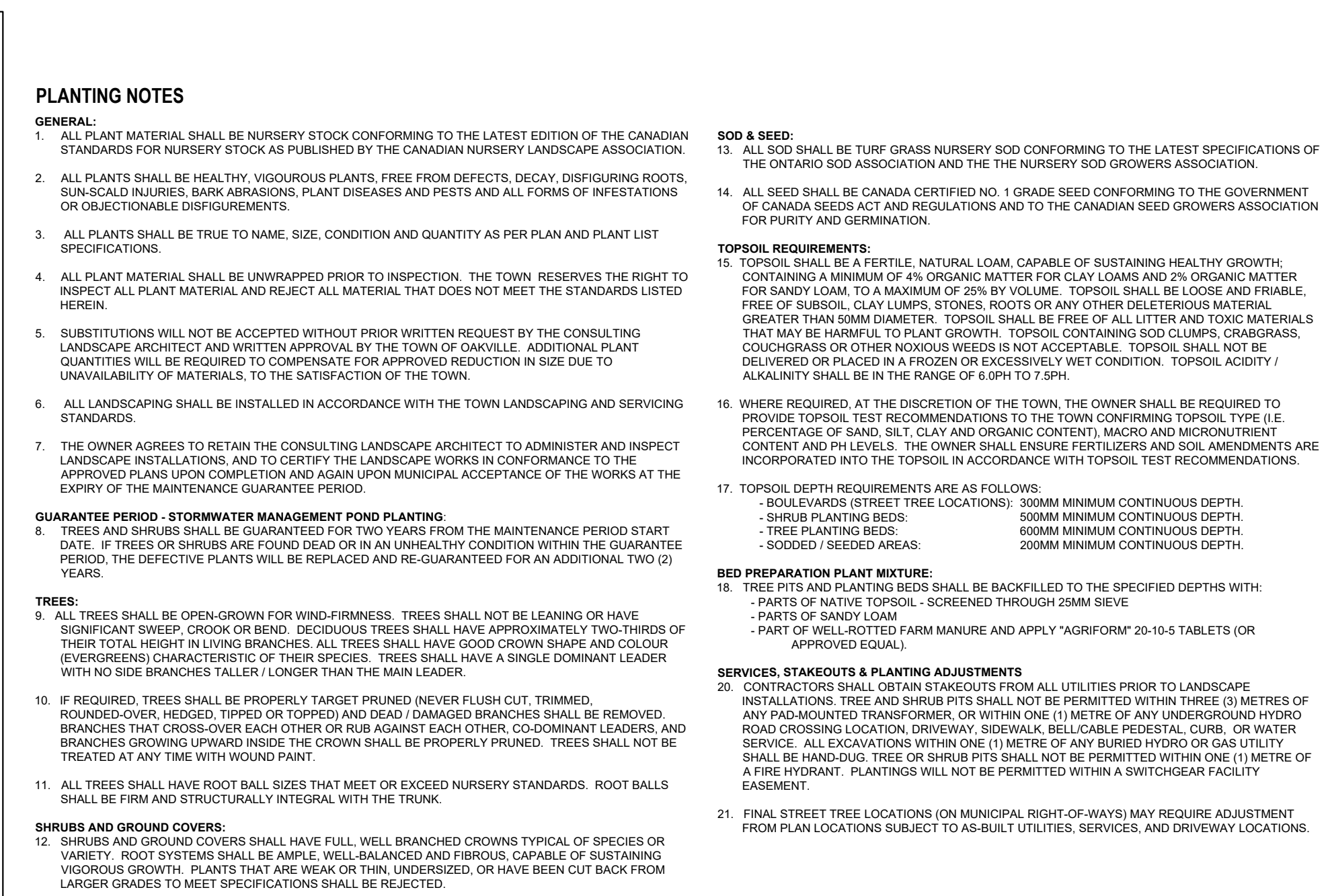
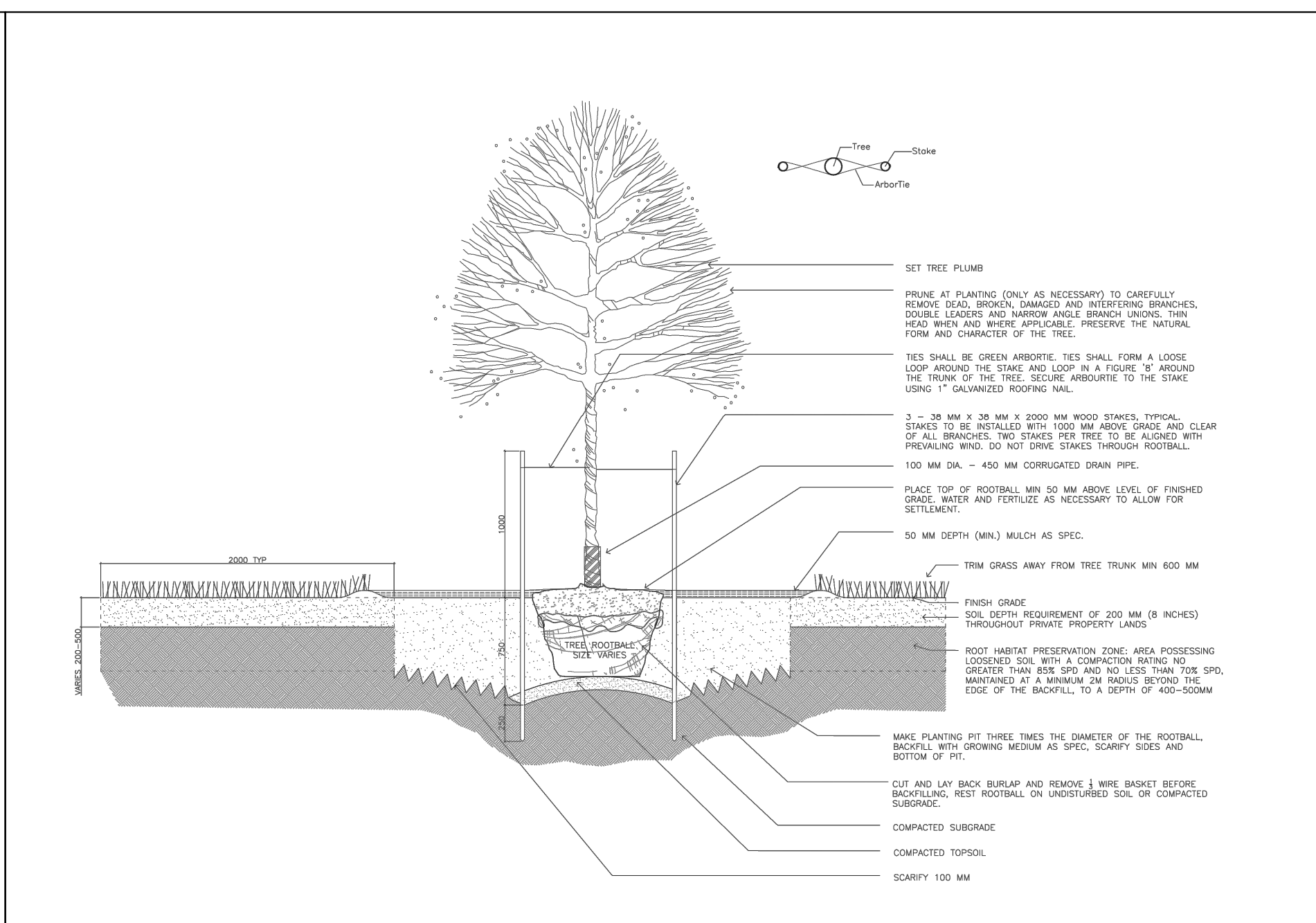
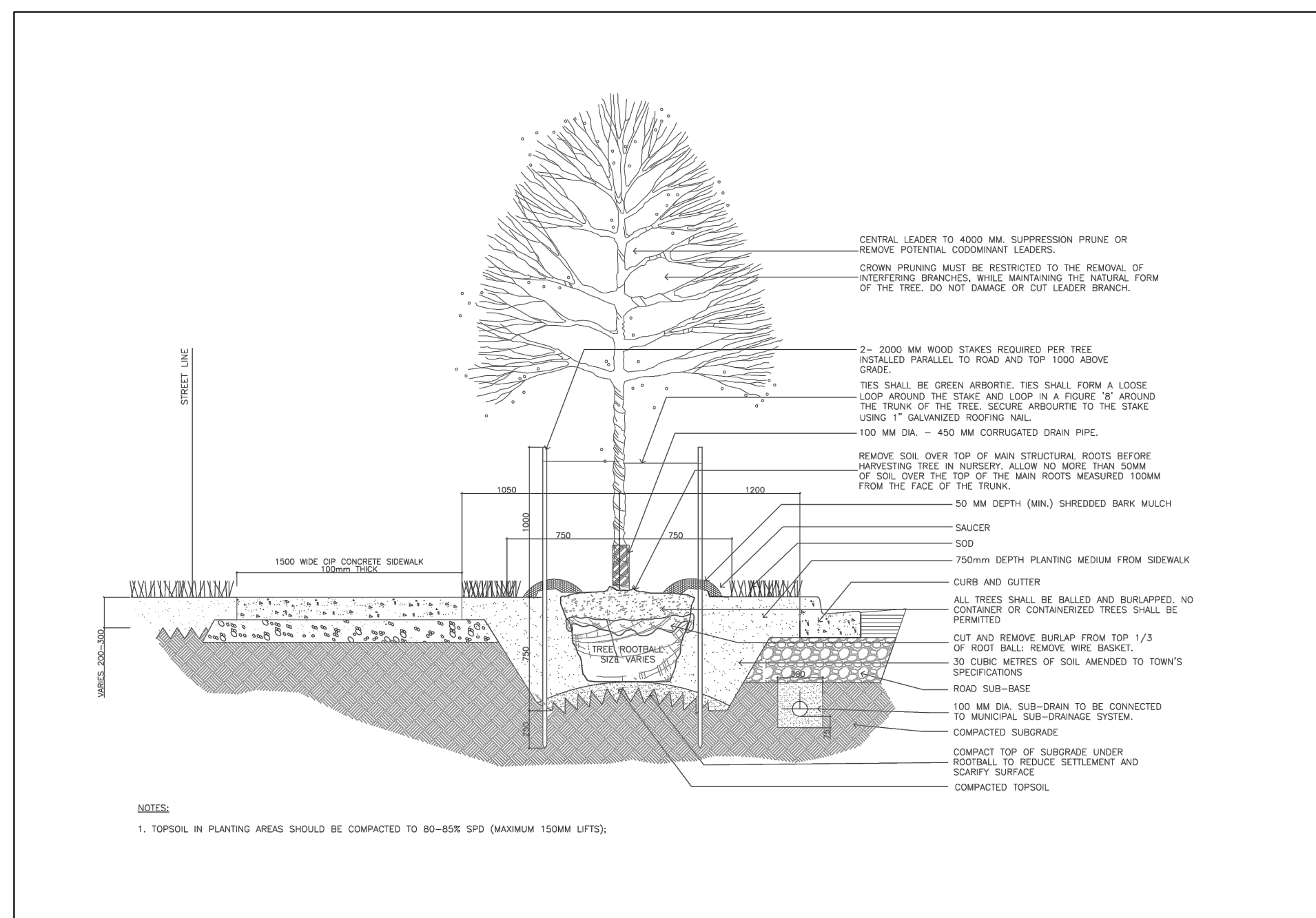

1 LD2 PUBLIC BOULEVARD TREE PLANTING DETAIL - NORTH OAKVILLE URBAN FOREST MANAGEMENT PLAN N.T.S.

2 LD2 SCHOLLEN & Company Inc. 30 Wertheim Court, Unit 15 Richmond Hill, Ontario L4B 1B9 T: 289-695-0009 F: 289-695-0010 DECIDUOUS TREE PLANTING ON PRIVATE PROPERTY - NORTH OAKVILLE URBAN FOREST MANAGEMENT PLAN PLANTING NOTES N.T.S.

3 LD2 SCHOLLEN & Company Inc. 30 Wertheim Court, Unit 15 Richmond Hill, Ontario L4B 1B9 T: 289-695-0009 F: 289-695-0010 CONFEROUS TREE PLANTING ON SLAB SCALE 1:25

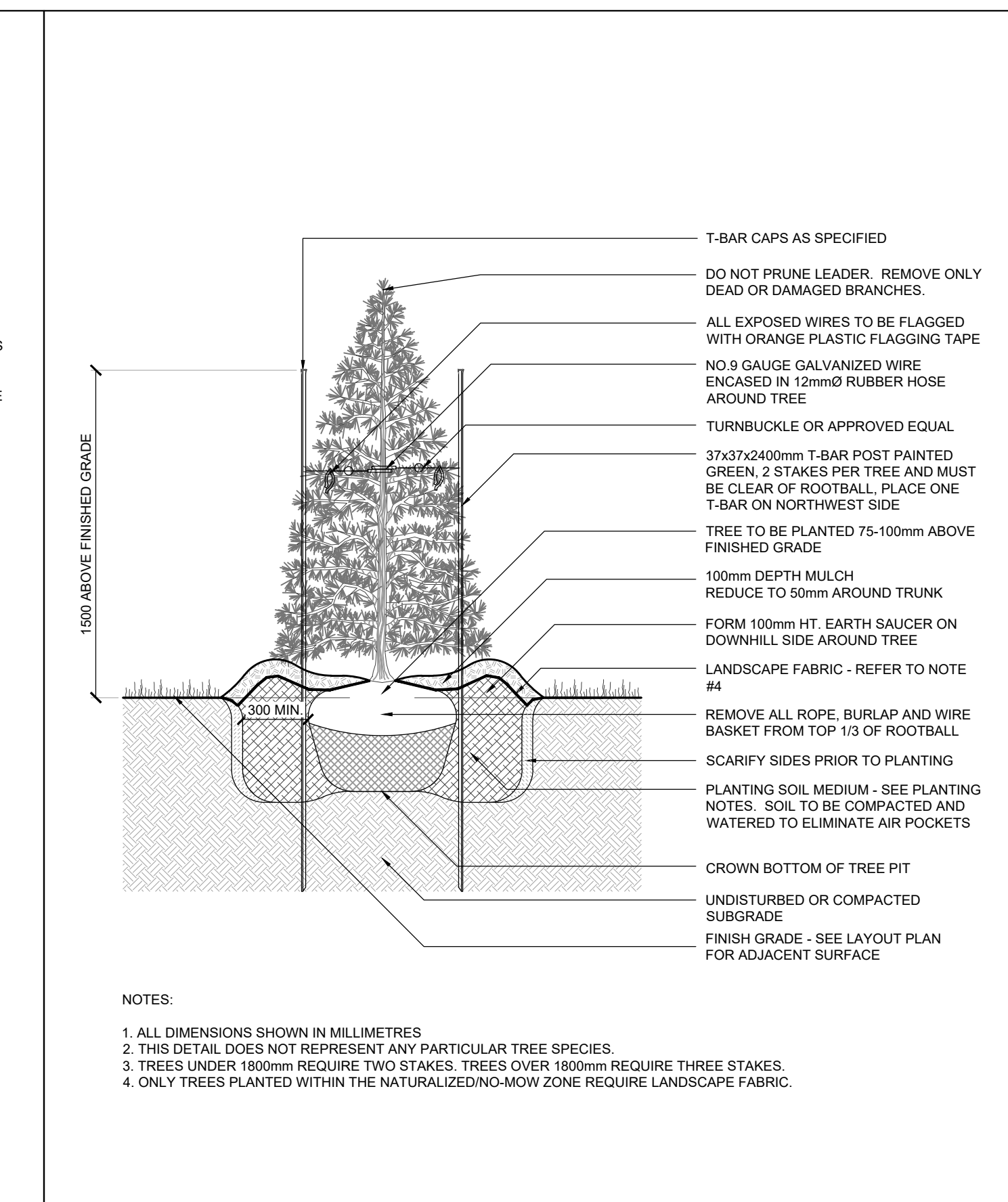
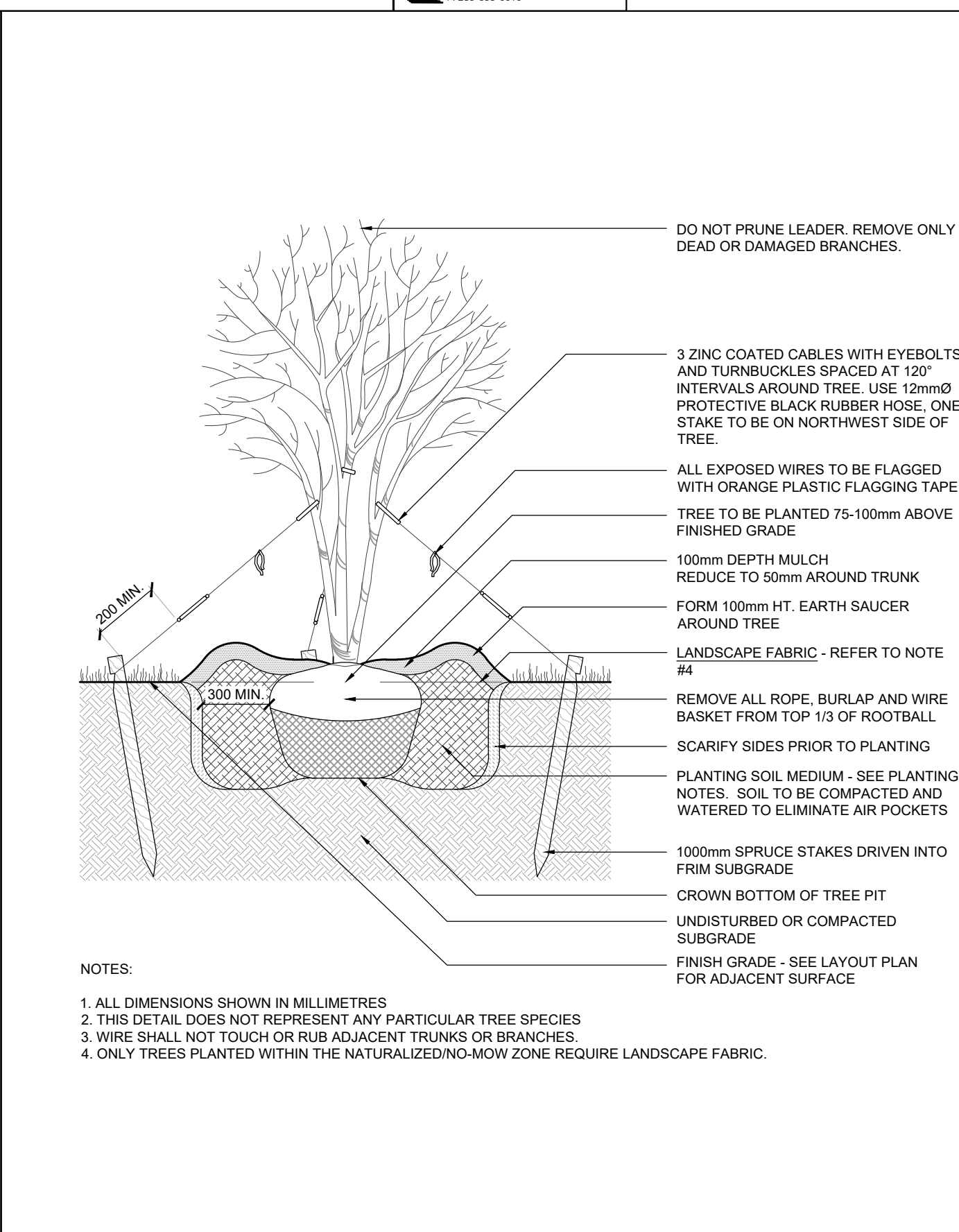
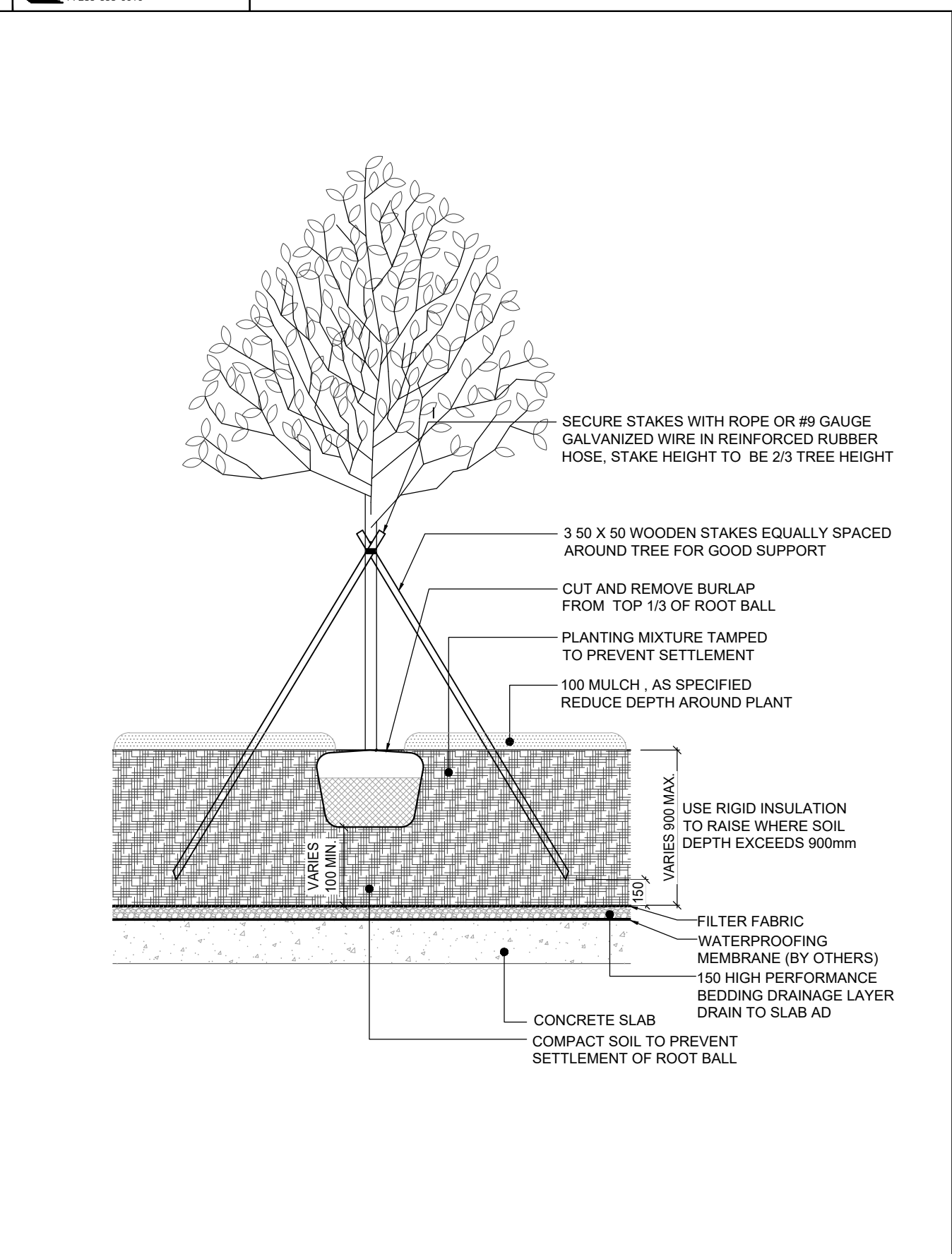
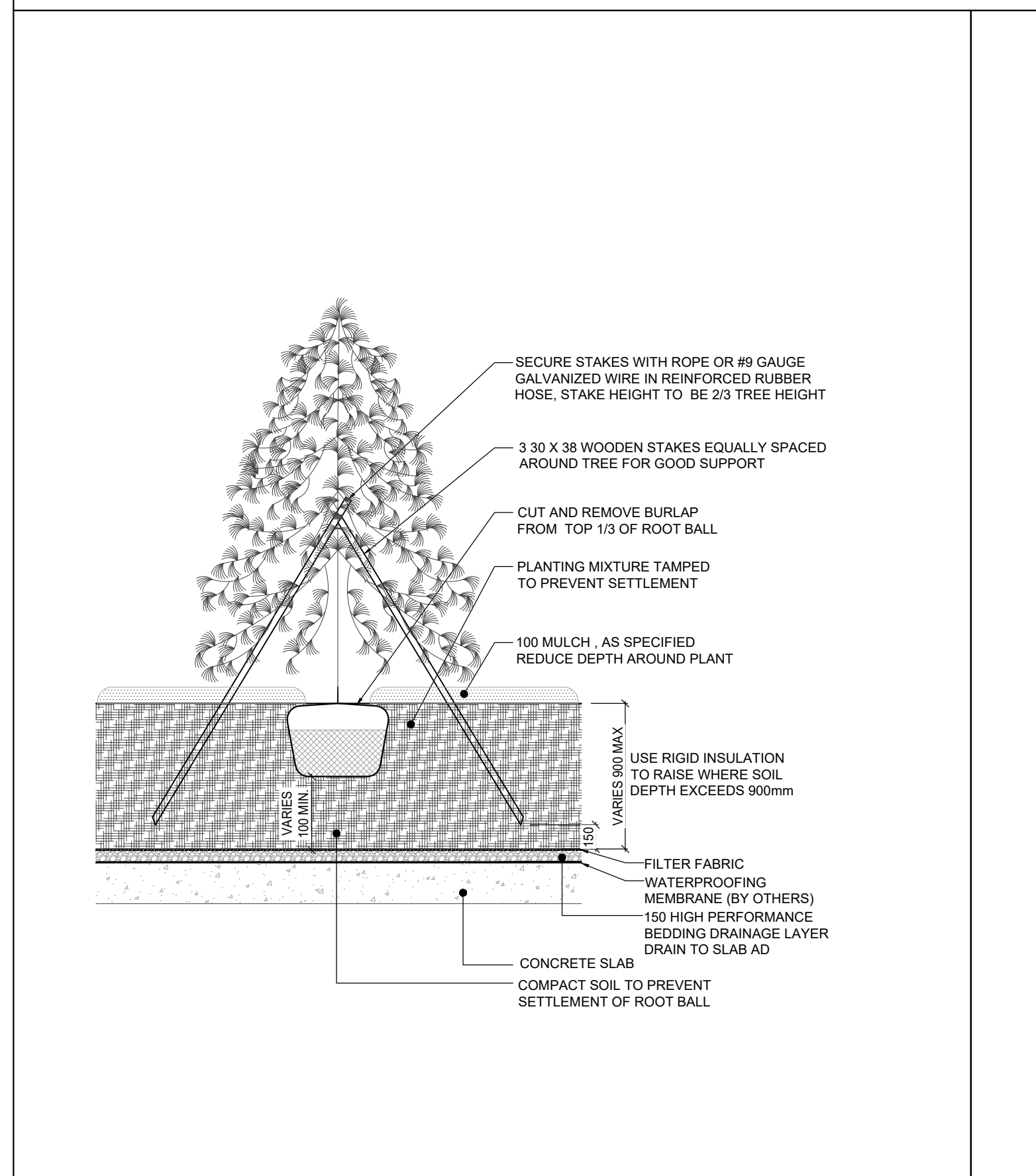

3 LD2 SCHOLLEN & Company Inc. 30 Wertheim Court, Unit 15 Richmond Hill, Ontario L4B 1B9 T: 289-695-0009 F: 289-695-0010 CONFEROUS TREE PLANTING ON SLAB SCALE 1:25

4 LD2 SCHOLLEN & Company Inc. 30 Wertheim Court, Unit 15 Richmond Hill, Ontario L4B 1B9 T: 289-695-0009 F: 289-695-0010 DECIDUOUS TREE PLANTING ON SLAB SCALE 1:25

5 LD2 SCHOLLEN & Company Inc. 30 Wertheim Court, Unit 15 Richmond Hill, Ontario L4B 1B9 T: 289-695-0009 F: 289-695-0010 DECIDUOUS TREE - MULTISTEM SCALE 1:25

6 LD2 SCHOLLEN & Company Inc. 30 Wertheim Court, Unit 15 Richmond Hill, Ontario L4B 1B9 T: 289-695-0009 F: 289-695-0010 CONFEROUS TREE PLANTING SCALE 1:25

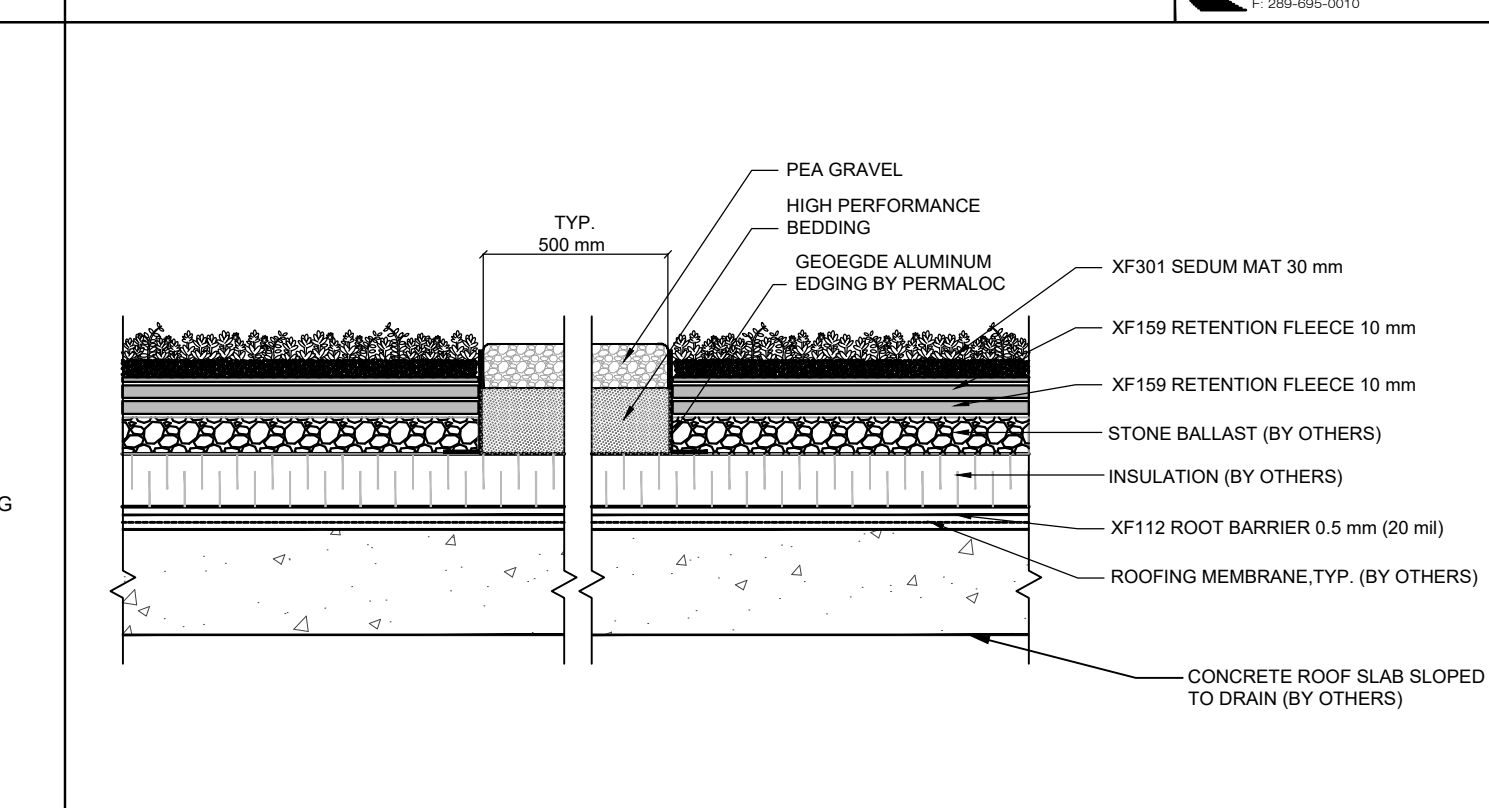
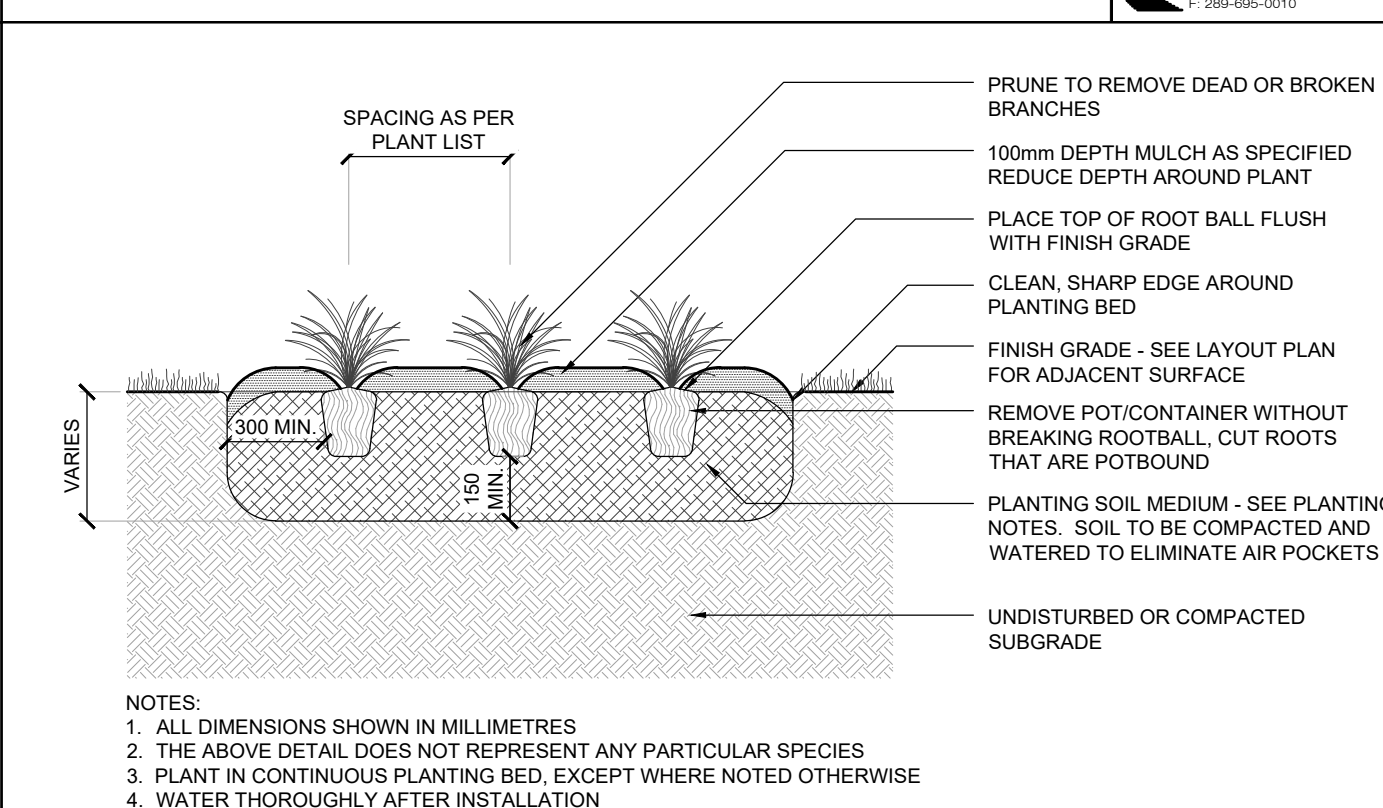
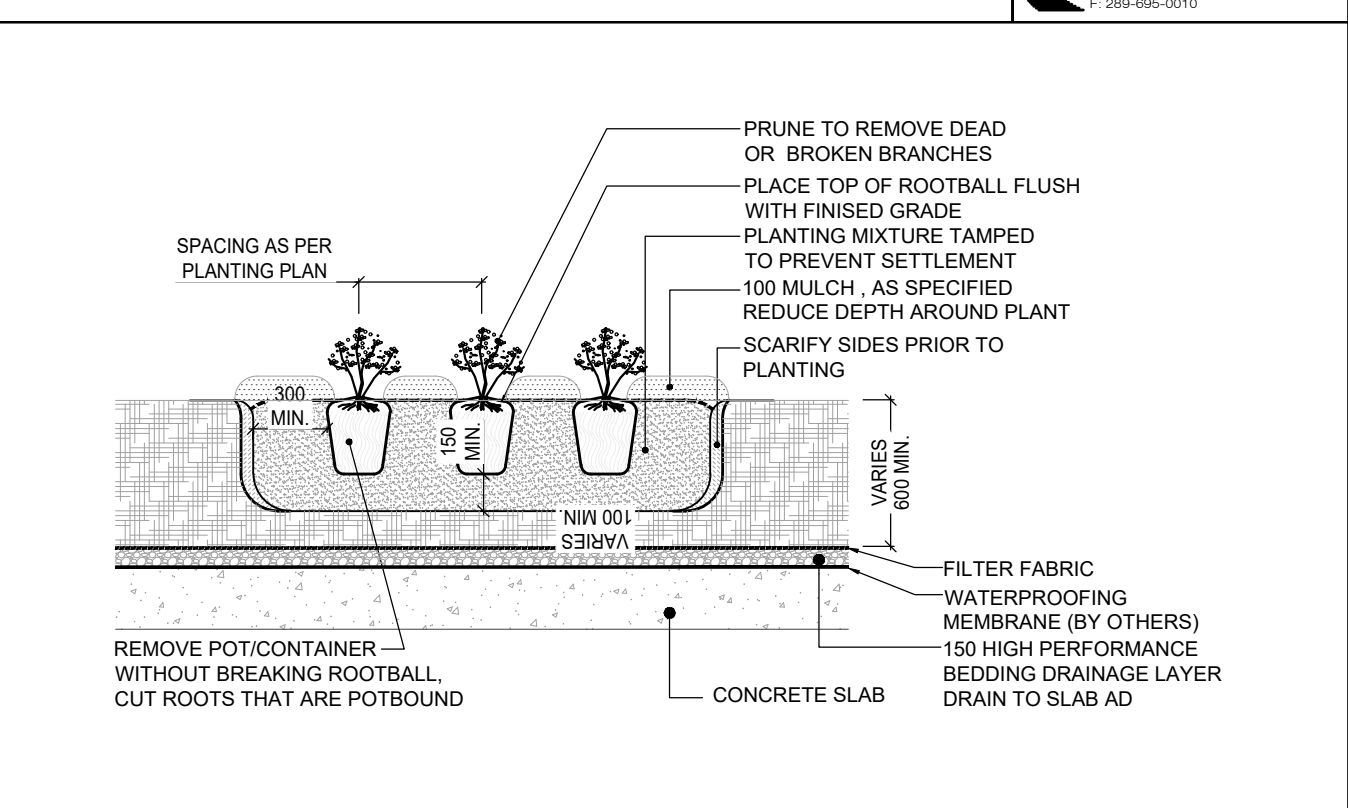
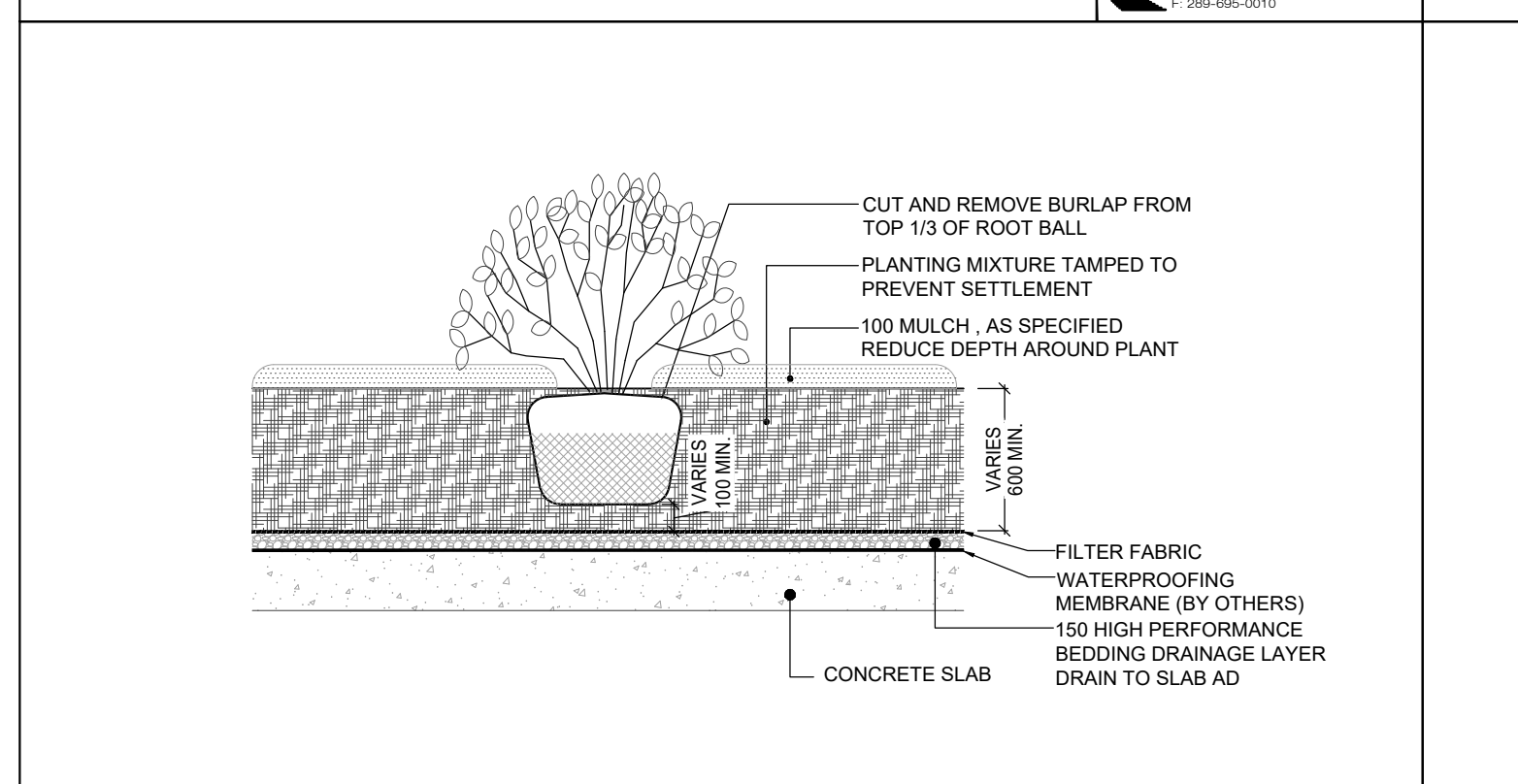

7 LD2 SCHOLLEN & Company Inc. 30 Wertheim Court, Unit 15 Richmond Hill, Ontario L4B 1B9 T: 289-695-0009 F: 289-695-0010 SHRUB PLANTING ON SLAB SCALE 1:25

8 LD2 SCHOLLEN & Company Inc. 30 Wertheim Court, Unit 15 Richmond Hill, Ontario L4B 1B9 T: 289-695-0009 F: 289-695-0010 PERENNIAL PLANTING ON SLAB SCALE 1:25

9 LD2 SCHOLLEN & Company Inc. 30 Wertheim Court, Unit 15 Richmond Hill, Ontario L4B 1B9 T: 289-695-0009 F: 289-695-0010 PERENNIAL & ORNAMENTAL GRASS PLANTING SCALE N.T.S.

10 LD2 SCHOLLEN & Company Inc. 30 Wertheim Court, Unit 15 Richmond Hill, Ontario L4B 1B9 T: 289-695-0009 F: 289-695-0010 GREEN ROOF N.T.S.

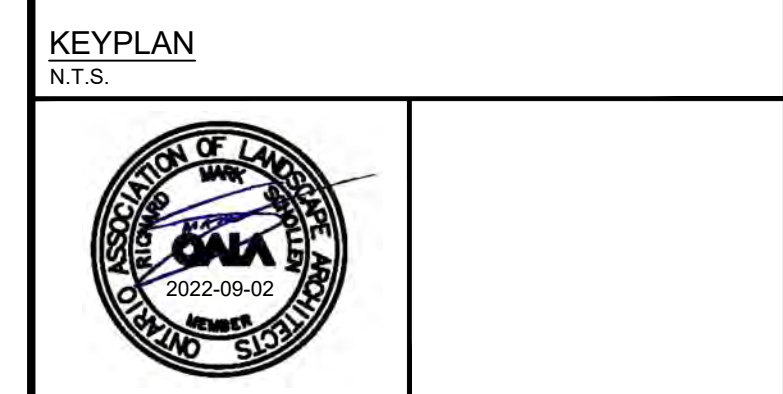

KEY PLAN N.T.S.

Drawing Prepared By: **SCHOLLEN & Company Inc.**
30 Wertheim Court, Unit 15
Richmond Hill, Ontario L4B 1B9
T: 289-695-0009
F: 289-695-0010

Client: **TIMES GROUP**

Project Name: **2264 TRAFALGAR ROAD**

Drawing Title: **LANDSCAPE DETAILS**

Scale: AS SHOWN Project No.: 2021011 Drawing No.: LD2

Drawn: NS Checked: RMS

Date: February 2022 Plot Date: 02/09/2022

UMV-30002
Marvik 1 Surface Downlight



20w COB 1676 Lumens
IP65 - Suitable For Wet Locations
IK08 - Impact Resistant (Vandal Resistant)
Weight: 3.5 lbs

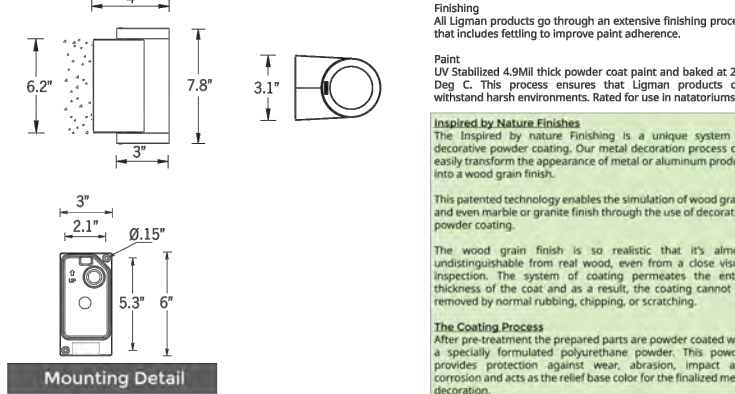

Construction
Marvik 1 is a copper contact - Marine Grade 6061 extruded & laser finished. High pressure die casting provides excellent mechanical strength. Clear anodized powder coat provides excellent UV protection.

Finish
The high pressure and phosphate process the tubular body and integrated driver housing. This smart mechanical modern designed luminaire with cylindrical body provides a stylish solution to wall mounted cylinders.

Thermal management
LUM Aluminum is used for its excellent mechanical strength and properties in low and high ambient temperatures. The superior thermal heat sink design for LUM Aluminum is used in conjunction with the driver, controls thermal below critical temperature range to ensure maximum Lumen flux output, as well as providing long LED service life and ensuring less than 10% lumen depreciation at 50,000 hours.

UV Stabilized 4.0MI thick powder coat paint and baked at 200°C. This process ensures that LUM Aluminum products can withstand harsh outdoor environments. Rated for use in natatoriums.

Hardware
Provided Hardware is Marine grade 316 Stainless steel.

Anti Seize Screw Holes
Tapped holes are filled with a special anti seize compound designed to prevent seizure of threaded connections, due to electrolysis from heat, corrosive atmospheres and moisture.

Crystal Clear Low Iron Glass Lens
Provided with tempered, impact resistant crystal clear low iron glass ensuring no green tinge.

Optics & LED
Precision optic design provides exceptional light control and precise distribution of light. LED CRI > 80

Lumen - Maintenance Life
180,000 hours (This means that at least 90% of the LED will achieve 80% of their original flux)

Additional Options (Consult Factory For Pricing)
SCOT - Scot Control Photocell Switch
RFA - Round Face Adapter
B - Baffle

UBE-10001
Benton 1 Bollard



21w COB 1096 Lumens 176° Optic
IP65 - Suitable For Wet Locations
IK08 - Impact Resistant (Vandal Resistant)
Weight: 15.4 lbs

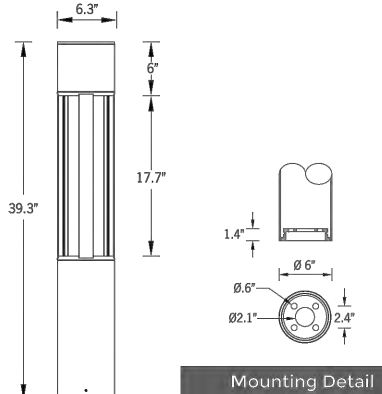

Construction
LUM Aluminum is used for its excellent mechanical strength and properties in low and high ambient temperatures. The superior thermal heat sink design for LUM Aluminum is used in conjunction with the driver, controls thermal below critical temperature range to ensure maximum Lumen flux output, as well as providing long LED service life and ensuring less than 10% lumen depreciation at 50,000 hours.

UV Stabilized 4.0MI thick powder coat paint and baked at 200°C. This process ensures that LUM Aluminum products can withstand harsh outdoor environments. Rated for use in natatoriums.

Hardware
Provided Hardware is Marine grade 316 Stainless steel.

Anti Seize Screw Holes
Tapped holes are filled with a special anti seize compound designed to prevent seizure of threaded connections, due to electrolysis from heat, corrosive atmospheres and moisture.

Crystal Clear Low Iron Glass Lens
Provided with tempered, impact resistant crystal clear low iron glass ensuring no green tinge.

Optics & LED
Precision optic design provides exceptional light control and precise distribution of light. LED CRI > 80

Lumen - Maintenance Life
180,000 hours (This means that at least 90% of the LED will achieve 80% of their original flux)

Additional Options (Consult Factory For Pricing)
SCOT - Scot Control Photocell Switch
RFA - Round Face Adapter
B - Baffle

Conic Waste/Recycle Receptacle
PS-951-CR-AL - Conic Waste/Recycle Receptacle



Our Conic Waste/Recycle Receptacle features an all-welded, powdercoated aluminum body, with a domed aluminum lid. The single stream receptacle is shown here with a custom powdercoat finish, and a polypropylene liner (34 gal / 128.7 L). It is available in a variety of powdercoat finishes.



Color temperature 2700K, 3000K, 3500K and 4000K. The minimalist shape provides distinctive lighting effects by night and decorative urban effect during the day. Suitable for pedestrian areas, precincts, building surrounds, shopping centers, squares and parks. The Benton bollard comes standard with a unique waterproof internal driver housing compartment that is situated at the top of the pole to stop water and dust from entering the electrical components. This feature is supplied completely sealed with powdercoat and waterproof gland from the driver enclosure to the base of the bollard to ensure quick trouble-free installation.

Custom bollard heights are available to suit customer design requirements, please specify. This luminaire is supplied complete with anchor bolts and top quality zinc-coated aluminum anchor bolt cover. Reduced custom wattages and dimming can be provided to suit the site and customer requirements. (Specify total watt requirement per fixture)

Designed to complement the Benton Light Column.

Surge Suppression
Standard 10kv surge suppressor provided with all fixtures.

IKC Rating
IKC1 - IKC2

Finish
All Ligman products go through an extensive finishing process that includes wetting to improve paint adherence.

UV Stabilized 4.0MI thick powder coat paint and baked at 200°C. This process ensures that Ligman products can withstand harsh outdoor environments. Rated for use in natatoriums.

Hardware
Provided Hardware is Marine grade 316 Stainless steel.

Anti Seize Screw Holes
Tapped holes are filled with a special anti seize compound designed to prevent seizure of threaded connections, due to electrolysis from heat, corrosive atmospheres and moisture.

Crystal Clear Low Iron Glass Lens
Provided with tempered, impact resistant crystal clear low iron glass ensuring no green tinge.

Optics & LED
Precision optic design provides exceptional light control and precise distribution of light. LED CRI > 80

Lumen - Maintenance Life
180,000 hours (This means that at least 90% of the LED will achieve 80% of their original flux)

Esplanade Bench
PS-840-AL-MW2-MW2-A Esplanade AL

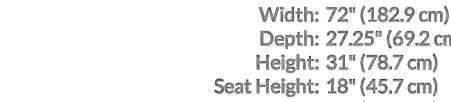

Our 'Esplanade' bench features an all-welded aluminum powdercoated frame, and aluminum slats. Shown here in our 'Pewter' powdercoat finish. Available in a variety of sizes and finishes, freestanding or bolt-down.



Width: 72" (182.9 cm)
Depth: 27.25" (69.2 cm)
Height: 31" (78.7 cm)
Seat Height: 18" (45.7 cm)
Arm Height: 27" (68.6 cm)

sales@hausersite.com
800-268-7328
hausersite.com

1 PAVILION LIGHT
N.T.S.

2 SCHOLLEN & Company Inc.
30 Wertheim Court, Unit 15
Richmond Hill, Ontario L4B 1B9
T: 289-695-0009
F: 289-695-0010

2 ILLUMINATED BOLLARD
N.T.S.

3 WASTE RECEPTACLE
N.T.S.

4 METAL BENCH
N.T.S.

SCHOLLEN & Company Inc.
30 Wertheim Court, Unit 15
Richmond Hill, Ontario L4B 1B9
T: 289-695-0009
F: 289-695-0010

Circuit Bicycle Rack
PS-69-101-AL-IGM - Circuit Bike Rack

Our Circuit Bicycle Rack features an all-welded, tubular coated steel construction. It is available in your choice of HauserKOTE powdercoat finishes, or HauserSHIELD Thermoplastic finishes.

Width: 2" (5.1 cm)
Diameter: 26" (66.0 cm)
Height: 30" (76.2 cm)

sales@hausersite.com | 1-800-268-7328 | hausersite.com

Pro Tapered Round Polyresin Planter
CHSVK1000-GY - Pro Tapered Round Polyresin Planter

The Pro Tapered Round Polyresin Planter is lightweight, fade resistant, weather & impact resistant, and environmentally friendly. The Pro Series planters are constructed out of rotomolded commercial grade polyethylene. They feature a ribbed texture, and double wall design for added insulation (frost resistant up to -30°C). Equipped with removable shelf. Available in 'Black' or 'Grey' finish. For indoor or outdoor use.

Diameter: 27" (68.6 cm)
Height: 30" (76.2 cm)

sales@hausersite.com | 1-800-268-7328 | hausersite.com

79" X 79" Urban Heavy Duty Planter
PS-210-HD-AL-PO-79x79x39 - Urban Heavy Duty Planter

The Urban Heavy Duty Planter features a heavy duty galvanized steel frame, aluminum clad powdercoated body and flush mount base. Includes poly liner with weeping drain. It is available in any HauserKOTE powdercoat finish, and in a variety of custom sizes.

Width: 79" (200.7 cm)
Depth: 79" (200.7 cm)
Height: 39" (99.1 cm)
Weight: 1100.0 lb (499.4 kg)

sales@hausersite.com | 1-800-268-7328 | hausersite.com

poligon

UMV-30002
Marvik 1 Surface Downlight
BY LIGMAN LIGHTING
ALL POSTS - QTY 4

MANUFACTURER:
POLIGON
STYLE:
SQR-12 WITH MULTI-RIB ROOF
COLOR: TO BE DETERMINED
FINISH: MAT
MOUNTING:
SURFACE MOUNTING TO CONCRETE FOOTING WITH COVERED BASE PLATE CONCRETE FOOTING TO BE INCLUDED AS PART OF CONTRACTORS INSTALLATION

COLORS SHOWN FOR ILLUSTRATIVE PURPOSES ONLY. FOR OTHER COLOR SELECTIONS, PLEASE SUBMIT AN I/E DRAWING REQUEST.

SQR-12

7 ILLUMINATED PAVILION
SCALE 1:25

SCHOLLEN & Company Inc.
30 Wertheim Court, Unit 15
Richmond Hill, Ontario L4B 1B9
T: 289-695-0009
F: 289-695-0010

5 BIKERING
N.T.S.

SCHOLLEN & Company Inc.
30 Wertheim Court, Unit 15
Richmond Hill, Ontario L4B 1B9
T: 289-695-0009
F: 289-695-0010

6 PLANTER - ROUND
N.T.S.

8 PLANTER - SQAURE
N.T.S.

SCHOLLEN & Company Inc.
30 Wertheim Court, Unit 15
Richmond Hill, Ontario L4B 1B9
T: 289-695-0009
F: 289-695-0010

Copyright Statement

This document is submitted by Schollen & Company Inc. to the client in confidence. The document contains confidential and/or technical information, and its unauthorized disclosure could reasonably result in significant professional and financial harm to Schollen & Company Inc. Any damages arising from unauthorized use of this document or the information contained therein shall be borne by the party making such unauthorized use.

No.	Revision	Date	By
1	Issued for Coordination	2022/02/18	RMS
2	Issued for Site Plan Approval	2022/02/23	RMS
3	Issued for Site Plan Approval	2022/09/02	RMS

1 PAVILION LIGHT
N.T.S.

2 ILLUMINATED BOLLARD
N.T.S.

3 WASTE RECEPTACLE
N.T.S.

4 METAL BENCH
N.T.S.

Drawing Prepared By:
SCHOLLEN & Company Inc.
30 Wertheim Court, Unit 15
Richmond Hill, Ontario L4B 1B9
T: 289-695-0009
F: 289-695-0010

Client:
TIMES GROUP

Project Name:
2264 TRAFALGAR ROAD

Drawing Title:
LANDSCAPE DETAILS

Scale: AS SHOWN	Project No.: 2021011	Drawing No.:
Drawn: NS	Checked: RMS	LD3
Date: February 2022	Plot Date: 02/09/2022	

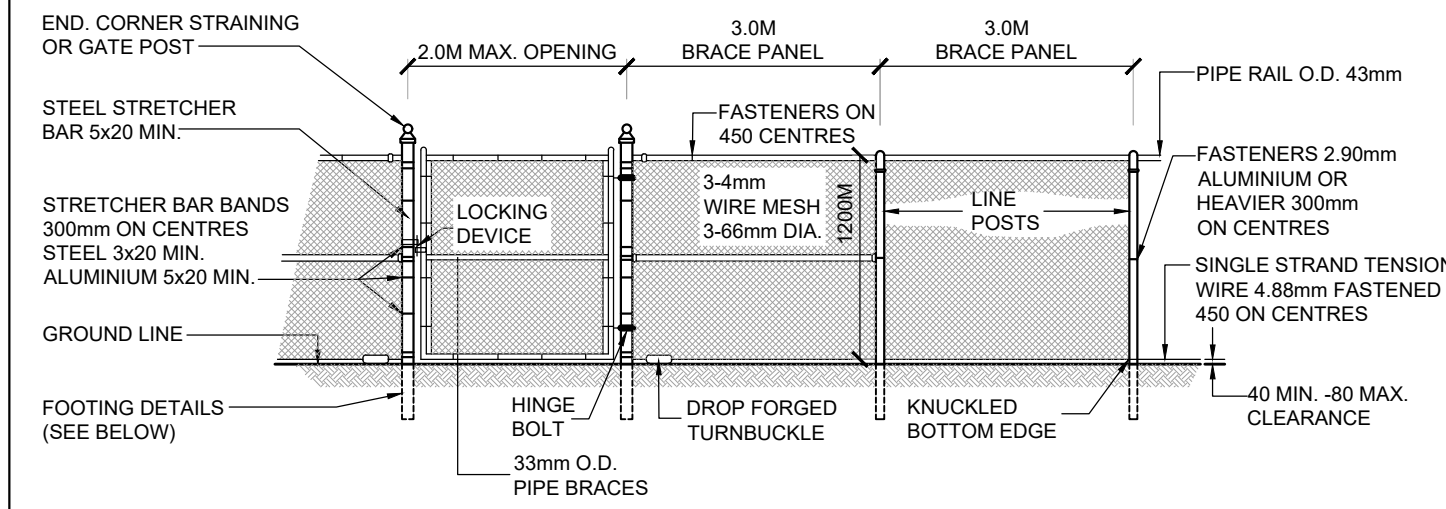

FENCE DETAILS

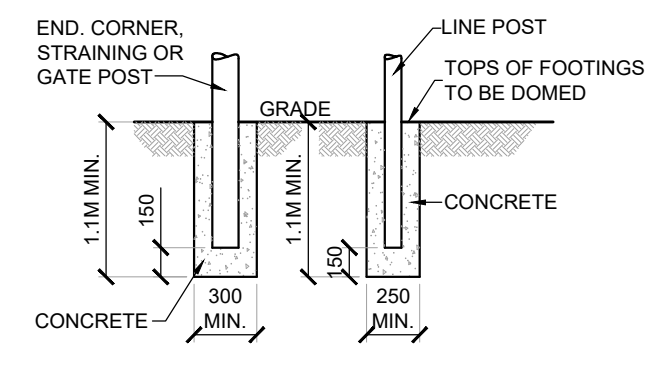

IN EARTH

DETAILED DESCRIPTION

NOTE: ALL POSTS, FABRIC, CAPS, BRACES TO BE BLACK VINYL COATED

DESCRIPTION	LENGTH								
	O.D.	FABRIC WIDTH 1.8M		FABRIC WIDTH 1.5M		FABRIC WIDTH 1.2M			
LINE POST	60	2670	2170	2360	1870	2060	1560		
END, CORNER, STRAINING AND GATE POST WITH OPENINGS MAX.	90	2900	2400	2590	2100	2290	1790		
RAIL, TOP & BRACE	43	RANDOM							

1 BLACK VINYL CHAINLINK FENCE 1.2 m HT
SCALE 1:5

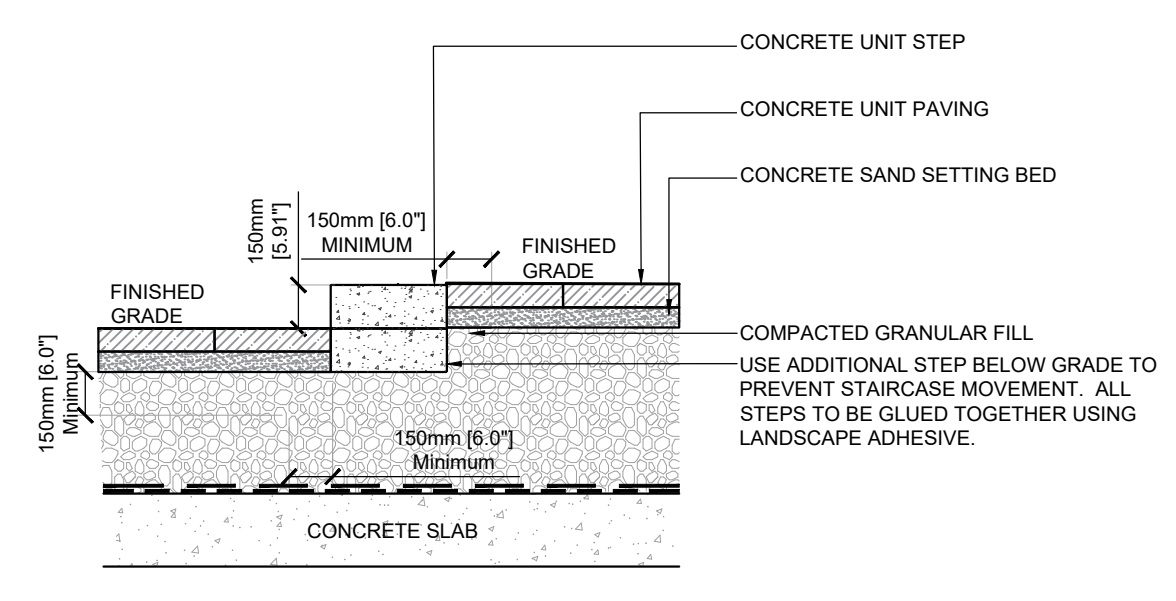

2 PRECAST UNIT CONCRETE STEP
SCALE 1:25



Copyright Statement
©2022 SCHOLLEN & COMPANY INC. All rights reserved. This document is protected under copyright law and may not be reproduced in any form without the prior written permission of Schollen & Company Inc. Drawings and Specifications are the property of the Landscape Architect.

This document is submitted by Schollen & Company Inc. to the client in confidence. The document contains confidential and/or technical information, and its unauthorized disclosure could reasonably result in significant professional and financial harm to Schollen & Company Inc. Any damages arising from unauthorized use of this document or the information contained therein shall be borne by the party making such unauthorized use.

No.	Revision	Date	By
1	Issued for Coordination	2022/02/18	RMS
2	Issued for Site Plan Approval	2022/02/23	RMS
3	Issued for Site Plan Approval	2022/09/02	RMS

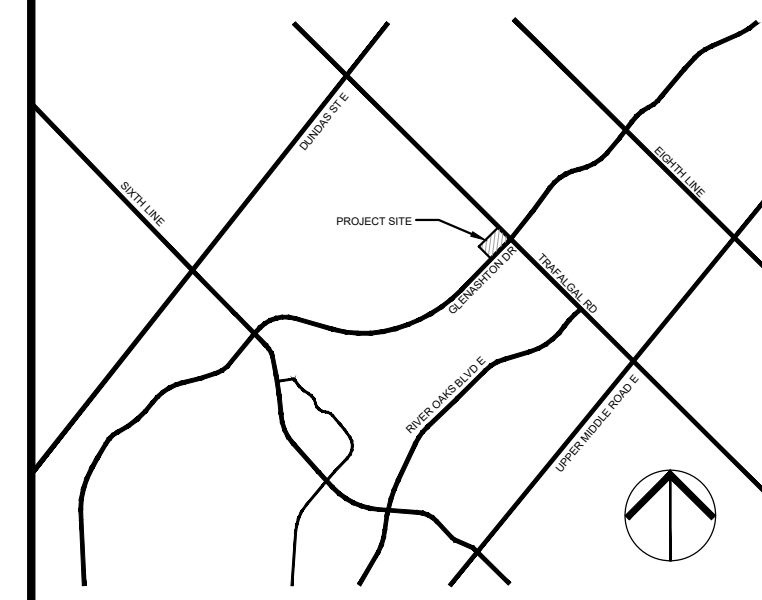

KEYPLAN
N.T.S.

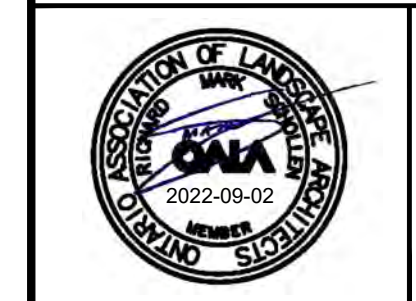

Drawing Prepared By:
SCHOLLEN & Company Inc.
30 Wertheim Court, Unit 15
Richmond Hill, Ontario L4B 1B9
T: 289-695-0009
F: 289-695-0010

Client:
TIMES GROUP

Project Name:
2264 TRAFALGAR ROAD

Drawing Title:
LANDSCAPE DETAILS

Scale: AS SHOWN	Project No.: 2021011	Drawing No.: LD4
Drawn: NS	Checked: RMS	
Date: February 2022	Plot Date: 02/09/2022	