



KEY-PLAN

- LEGEND**
- EXISTING PROPERTY LINE
 - EXISTING DECIDUOUS TREE TO BE RETAINED
 - EXISTING CONIFEROUS TREE TO BE RETAINED
 - PROPOSED DECIDUOUS TREE
 - PROPOSED CONIFEROUS TREE
 - PROPOSED DECIDUOUS SHRUB
 - PROPOSED CONIFEROUS SHRUB
 - PROPOSED SOD
 - PROPOSED SEED

SOURCE OF BASE INFORMATION:
Provided by CYNTHIA ZAHORUK ARCHITECTS,
Proposed Site Plan - Option A, dated 2023-05-23

PLOT DATE: August 24, 2023

No.	DATE	DESCRIPTION	BY
4	v2_2023-08-24	ISSUED FOR SPA	RG
3	08/11/2023	ISSUED FOR SPA	RG
2	07/07/23	ISSUED FOR SPA	RG
1	06/30/23	ISSUED FOR SPA	RG

REVISIONS

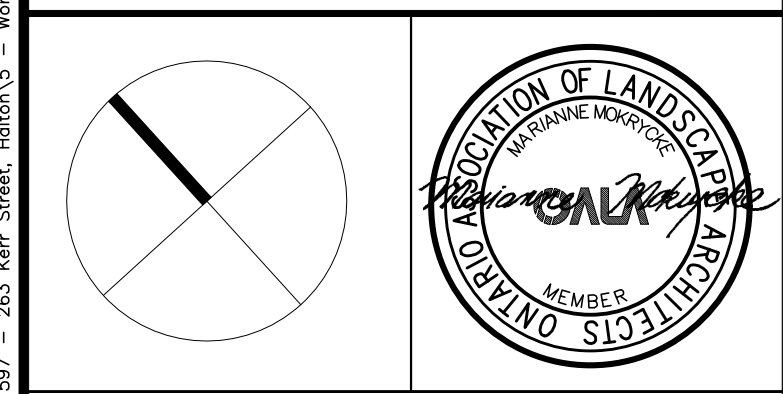

OMC LANDSCAPE ARCHITECTURE
Innovative. outside thinking.
270 Sherman Avenue North, Suite 315-MILL, Hamilton, ON L8L 6N4
Telephone: 905.681.7604 Fax: 905.681.2944 www.omcl.ca
LANDSCAPE ARCHITECTURE ENVIRONMENTAL PLANNING RESOURCE ANALYSIS

265 KERR STREET RESIDENCES
OAKVILLE, PROVINCE

06_LANDSCAPE
ISSUED FOR - SPA
SCALE: 1:150
DATE: 24-Aug-23
DRAWN: AS
CHECKED: MM
DRAWING: 06
PROJECT: 1597

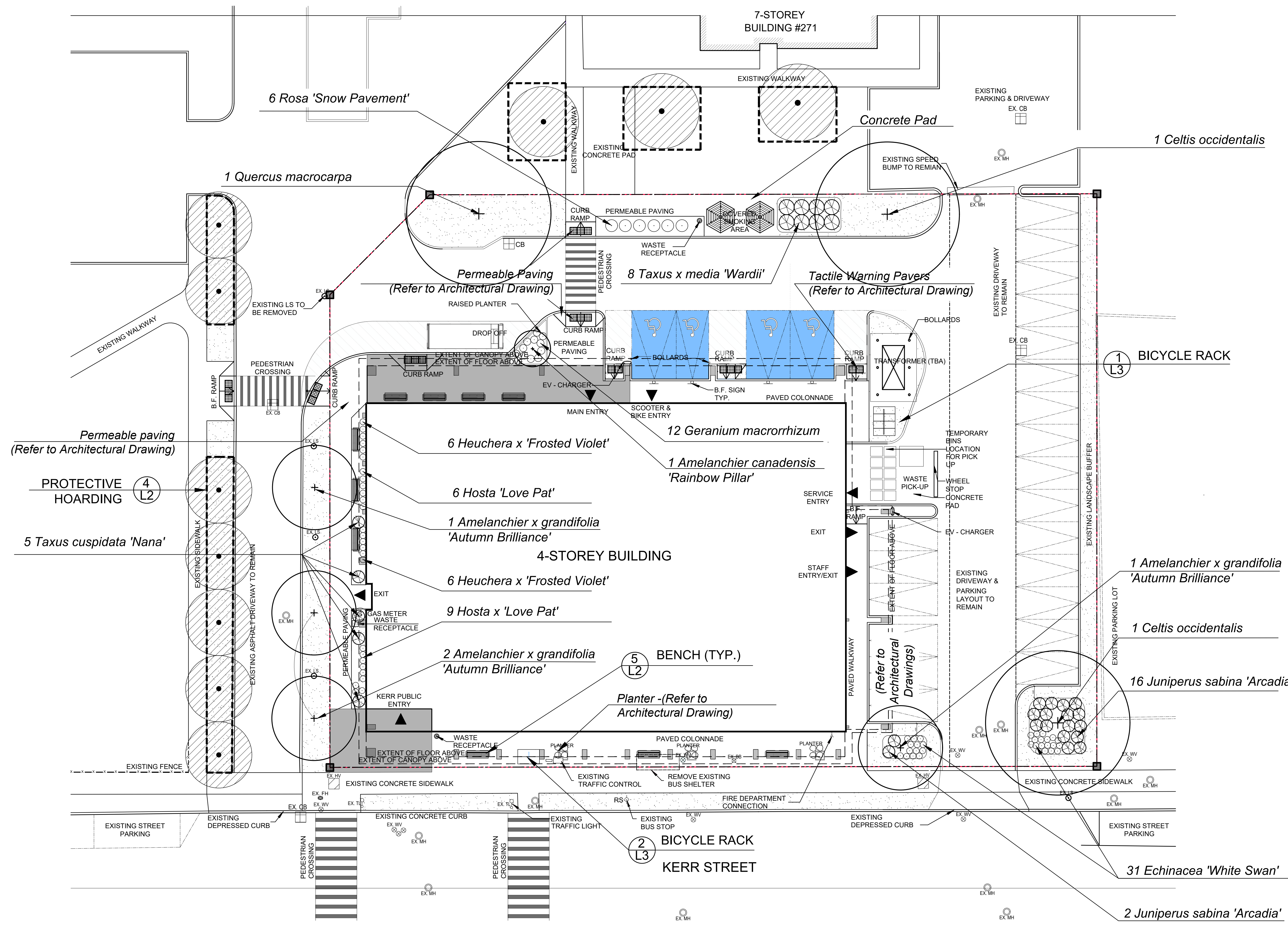

Plan Date: 1997 - L1 - PLANTING PLAN.dwg
Drawing Date: 1997 - PROJECT: 1597 - 265 Kerr Street, Hamilton, ON
Printed by: ingridia
Date: Aug. 24, 2023 - 4:28 pm

v2_2023-08-24