

**PLANT LEGEND**

A-CAREX BEBBII 'REBB'S SEDGE'	C-MONARDO FISTULOSA 'SOLDADO FISTULOSA'
B-CAREX HYSTERICINA 'PORCUPINE SEDGE'	D-DESCHAMPSIA CESPITOSA 'TUFTED HAIR GRASS'
C-CALAMAGROSTIS 'CANADA BLUEJOINT'	F-CERASTIUM ARVENSE 'SSP. STRICTUM'

**SWALE PLANTING (Install at 22kg/Ha)**

**PLANT LISTS:**

BOTANICAL NAME	COMMON NAME	CAL.	HEIGHT/SPREAD	COND.	REMARKS	QTY.
DECIDUOUS TREES						
ACER SACCHARUM	SUGAR MAPLE	70mm	-	-	W.B.	SPECIMEN 15
QUERCUS RUBRA	RED OAK	70mm	-	-	W.B.	SPECIMEN 10
LAMUS AMERICANA	AMERICAN ELM	70mm	-	-	W.B.	SPECIMEN 10
BETULA NORA	YELDER BIRCH	70mm	-	-	W.B.	SPECIMEN 7
QUERCUS VIRGINIANA	WHITE OAK	70mm	-	-	W.B.	SPECIMEN 7
ACER RUBRUM	RED MAPLE	70mm	-	-	W.B.	SPECIMEN 7
LIRODENDRON TULIPIFERA	TULIP TREE	70mm	-	-	W.B.	SPECIMEN 7
ACER FREEMANI	AUTUMN BLAZE FREEMAN MAPLE	70mm	-	-	W.B.	SPECIMEN 6
TILIA AMERICANA	COMMON LILAC	70mm	-	-	W.B.	SPECIMEN 4
TILIA CORDATA	LITTLELEAF LINDEN	70mm	-	-	W.B.	SPECIMEN 4
FRAXINUS VAGABUNDA	COMMON HAZEL	70mm	-	-	W.B.	SPECIMEN 12
SPRINGUS VAGABUNDA	BRANDYBERRY ORNAMENTAL PEAR	70mm	-	-	W.B.	SPECIMEN 5
FRAXINUS CALLENTANA 'BRADFORD'	BRADFORD ORNAMENTAL PEAR	70mm	-	-	W.B.	SPECIMEN 5
AMALANCHIER CANADENSIS	SERVICEBERRY	80mm	-	-	W.B.	SPECIMEN 3
BETULA PAPERIFERA	PAPER BIRCH CLUMP	80mm	-	-	W.B.	CLUMP 14
CONIFEROUS TREES						
PIEA GLAUCA	(A) WHITE SPRUCE	-	2m	-	W.B.	SPECIMEN 5
PIEA MARIANA	(B) BLACK SPRUCE	-	2m	-	W.B.	SPECIMEN 5
PRUNUS RESINOSA	(C) RED PINE	-	2m	-	W.B.	SPECIMEN 5
SPRUCES						
SYPHOCARPUS ALBUS	COMMON SNOWBERRY	-	600mm	-	2nd	WOODRUS 108
TARAXACUM	CANADA YEW	-	600mm	-	2nd	WOODRUS 255
GRASSES						
MISKATA CYMBRICA 'RED BARRON'	JAPANESE BLOOD GRASS	-	2-year	-	CO	WOODRUS 198

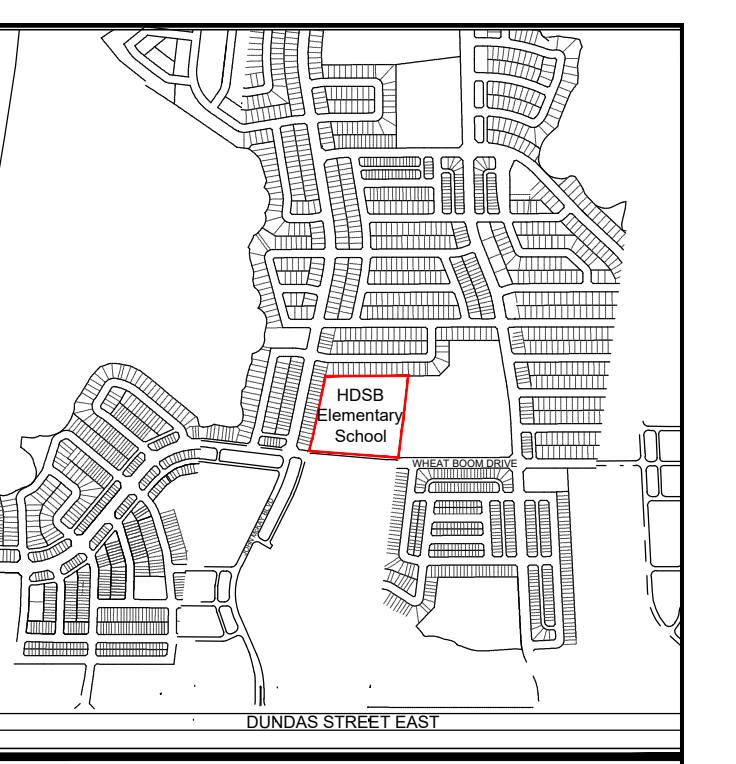

**KEY PLAN**  
N.T.S.

BASE INFORMATION TAKEN FROM DRAWINGS BY OTHERS. SA DOES NOT ASSUME ANY RESPONSIBILITY FOR ERRORS, OMISSIONS, OR ACCURACY OF THE INFORMATION. DRAWINGS SHALL ONLY BE USED FOR GUIDELINE PURPOSES ONLY.

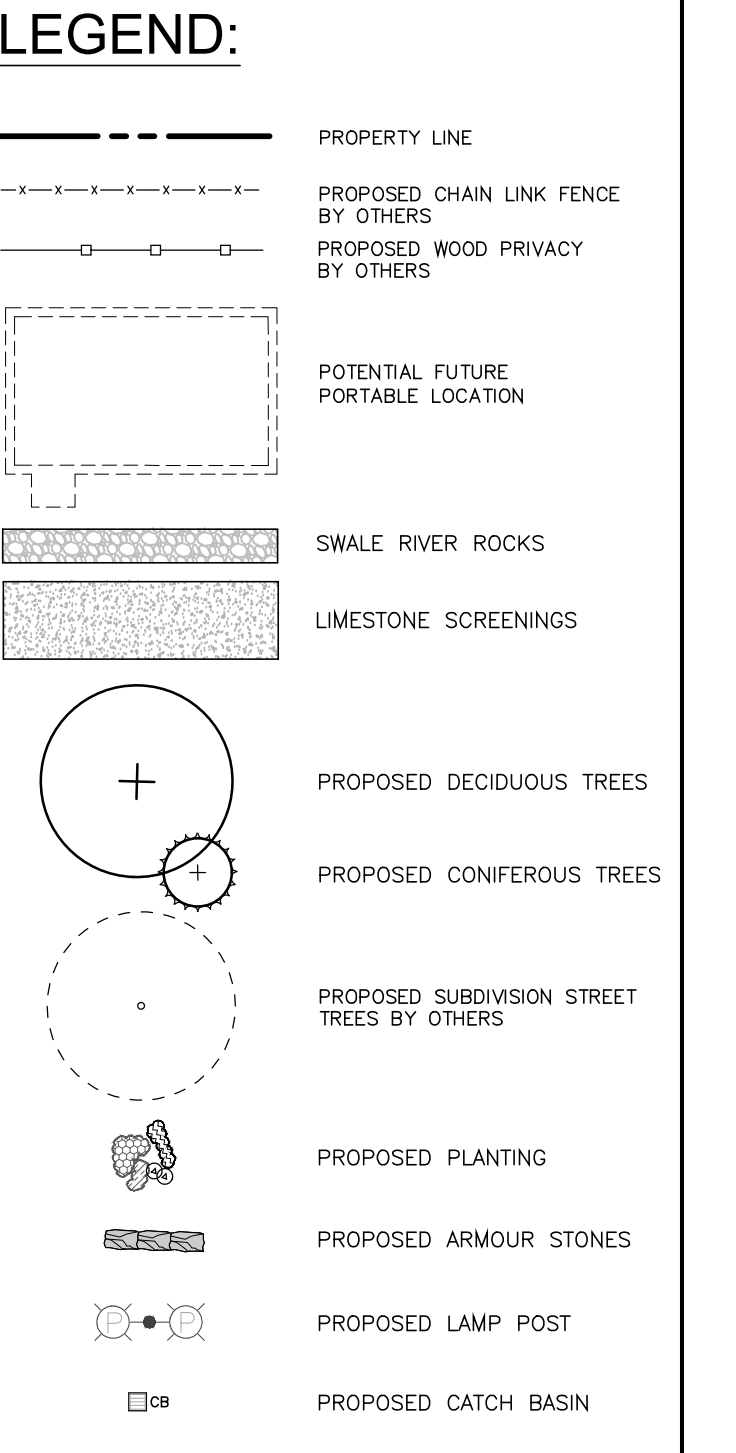

DATE	DESCRIPTION	CHECKED BY
AUG 29 2022	ISSUED FOR 2ND SITE PLAN APPLICATION CIRCULATION	S. JK
JUN 3 2022	ISSUED FOR BTE PLAN APPROVAL & RESPONSE TO BTE PLAN COMMENTS	A. JK
FEB 17 2022	ISSUED FOR BTE PLAN PRE-CONSULTATION	S. JK
DEC 8 2021	ISSUED TO TRAFFIC ENGINEER PRIOR TO ARGS & M&TARY REVIEW	Z. JK
NOV 24 2021	ISSUED TO H2SB TO PROVIDE TO ARCHITECTS	L. JK

**DATE DESCRIPTION CHECKED BY**

**REVISIONS**

NOTE: Contractor to check and verify all dimensions and conditions on the project. If any discrepancies report any discrepancies to the landscape architect before proceeding with the work.

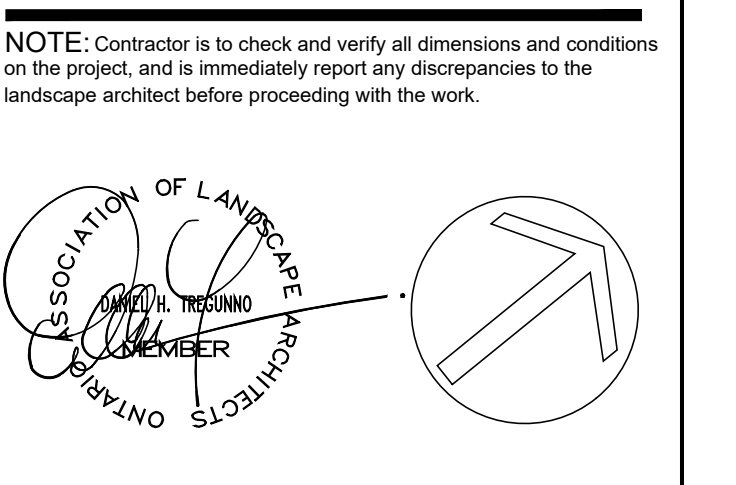

**HALTON DISTRICT SCHOOL BOARD**

**Strategy 4**  
Urban Transformation  
Urban Energy  
Urban World  
2620 Bristol Circle, Suite 100  
North Oakville, Ontario  
L6N 6K7  
(905) 829-2544

Project Name:  
**NORTH OAKVILLE #3 PUBLIC ELEMENTARY SCHOOL**  
NORTH OAKVILLE, ONTARIO

Sheet Description:  
**LANDSCAPE PLAN 'ULTIMATE'**

Date: SEPT. 2021  
Drawn By: S4 3076  
Scale: 1:250  
SHEET No.: LP.1

Issued: AUGUST 2022  
Checked By: ML  
Date: DT  
File No.: 3076LP1-220812.DWG