

CONDOMINIUM TOWNHOUSES & SEMI-DETACHED DWELLINGS

32 units

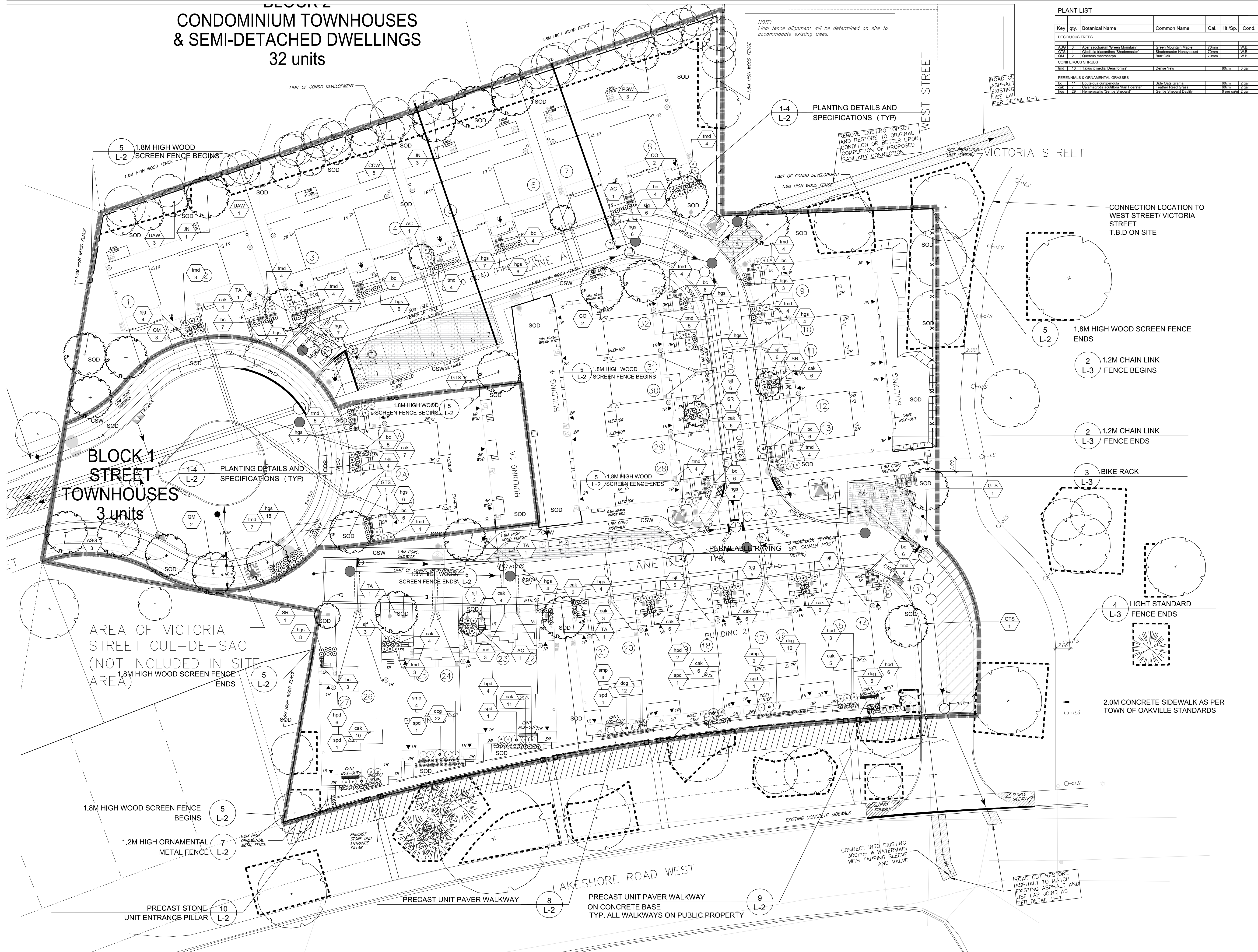

NOTE: Final fence alignment will be determined on site to accommodate existing trees.

Key	Botanical Name	Common Name	Cal.	Ht./Sp.	Cond.
DECIDUOUS TREES					
ASD	1	Acer saccharum 'Green Mountain'	Green Mountain Maple	10mm	W/B
QTR	2	Quercus macrocarpa	Red-tapered Blackoak	10mm	W/B
GM	3	Quercus macrocarpa	Blue Oak	10mm	W/B
CONIFEROUS TREES					
tmd	16	Taxus x media 'Dorsettorum'	Dorset Yew	85cm	3 gal
PERENNIALS & ORNAMENTAL GRASSES					
bc	11	Bouteloua curtipendula	Side oats grama	65cm	2 gal
slg	17	Scilla maritima 'Red Queen'	Red Queen Scilla	180cm	2 gal
hgs	29	Hemerocallis 'Vivid Orange'	Gentle Orange Daylily	6 per sqm	2 gal

Symbol	Description
(Circle with dot)	EXISTING DECIDUOUS TREE
(Circle with star)	EXISTING CONIFEROUS TREE
(Circle with dot and cross)	PROPOSED DECIDUOUS TREE
(Circle with cross)	PROPOSED CONIFEROUS TREE
(Circle with horizontal lines)	PROPOSED CONTINUOUS SHRUB BED
(Circle with vertical lines)	PROPOSED CONTINUOUS PERENNIAL/GRASSES BED
(Square with dot)	PROPOSED SODDED AREA
(Square with cross)	PROPOSED PEDESTRIAN CONCRETE
(Circle with 'XX')	PLANTING REFERENCE KEY
(Circle with '#')	DETAIL REFERENCE KEY
(Dashed line)	1.8 M WOOD PRIVACY FENCE
(Line with 'X')	1.2M CHAIN LINK FENCE
(Line with 'XXX')	1.2M ORNAMENTAL METAL FENCE
(Dashed line with 'X')	TREE PROTECTION ZONE PER TOWN OF OAKVILLE STANDARDS
(Circle with 'LS')	LIGHT STANDARD

- ### GENERAL NOTES
- Do not scale the drawings. All dimensions are in millimetres unless noted otherwise.
 - This drawing is to be read in conjunction with the overall master plan and engineering drawings prepared by the project engineer and site plans prepared by the project architect.
 - The contractor shall check and verify all existing and proposed grading and conditions on the project and immediately report any discrepancies to the consultant before proceeding with any work.
 - The contractor is to be aware of all existing and proposed services and utilities. The contractor is responsible for having all underground services and utility lines staked by each agency having jurisdiction prior to commencing work.
 - This drawing is to be used for development approval only. For layout of all work refer to construction drawings.
 - Plant quantities indicated on the plan supercede the quantities from the plant list (report any discrepancies to the landscape architect).
 - Do not leave any holes open overnight.
 - Keep area outside construction zone clean and useable by others at all times. Contractor shall thoroughly clean areas surrounding the construction zone at the end of each work day.
 - Contractor to make good any and all damages outside of the development area that may occur as a result of construction at no extra cost.
 - This drawing is Copyright MHBC 2023

REVISION NO.	DATE	ISSUED / REVISION	BY
8.	JUNE 07, 2023	ISSUED FOR SPA	CC
7.	JANUARY 20, 2023	ISSUED FOR SPA	CC
6.	OCTOBER 14, 2022	ISSUED FOR SPA	CC
5.	JANUARY 17, 2022	ISSUED FOR SPA	CC
4.	JANUARY 12, 2021	ISSUED FOR SPA	CC
3.	NOVEMBER 11, 2020	ISSUED FOR SPA	CC

MHBC PLANNING URBAN DESIGN & LANDSCAPE ARCHITECTURE
 232-7030 WESTON ROAD WOODBRIDGE, ON L4L 5E7 | P: 905.741.5388 F: 905.741.5387 | WWW.MHBCAN.COM

STAMP	DATE
	JUNE 2023
DRAWN BY	CC
PLAN SCALE	1:250
FILE NO.	11161E
CHECKED BY	N.M.
OTHER	
PROJECT	3171 LAKESHORE ROAD WEST OAKVILLE, ON
FILE NAME	LANDSCAPE PLAN
DWG NO.	L1